

SECTION A-A
(Span 1 - Looking South)

SPANS 1 & 2 ELEVATION
(Looking West)

SLAB HANGER DETAIL

HANGER DETAIL

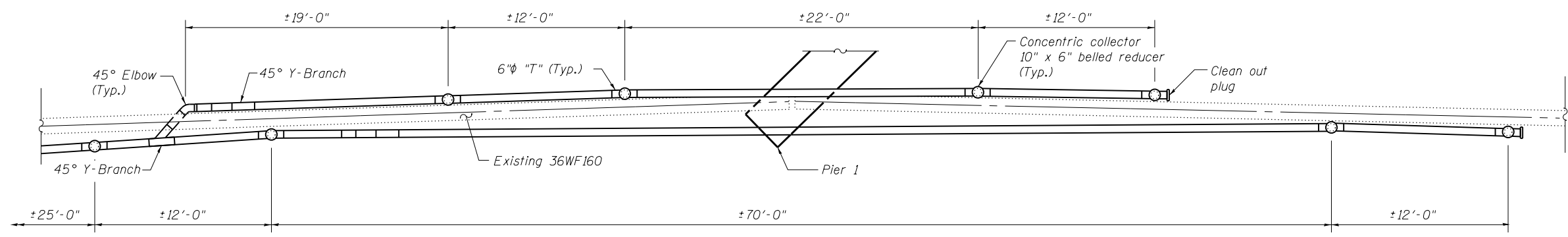

VIEW B-B

Notes:
Existing drain pipes to be cut for installation of drainage system. Care shall be taken to ensure the existing drains are properly braced against the exterior fascia beam.
The piping layout and transition locations shown are for reference. The Contractor shall provide the Engineer a schematic of the final proposed drainage system. Upon approval from the Engineer the drainage system may be installed.
See sheet 34 of 35 for additional notes and Bill of Material.

FILE NAME = 025009-74295-033.dgn  BERNARZEN LOCHMULLER & ASSOCIATES, INC. 3 OAK DRIVE MARYVILLE, IL 62442 PHONE (618) 284-4666 FAX (618) 284-4666	USER NAME = Illinois Design Firm Number 184,001670	DESIGNED - B.B. CHECKED - A.C.S.	REVISED - REVISED - REVISED - REVISED -	STATE OF ILLINOIS DEPARTMENT OF TRANSPORTATION	DRAINAGE SYSTEM STRUCTURE NO. 025-0019	F.A.I. R.T.E. = 57/70	SECTION (25-4HB)I-3	COUNTY EFFINGHAM	TOTAL SHEETS 1760	SHEET NO. 1738
	PLOT SCALE = PLOT DATE = 2:40:09 PM 8/15/2013	DRAWN - W.J.S. CHECKED - C.J.F. & B.B.	SHEET NO. 33 OF 35 SHEETS			CONTRACT NO. 74295 ILLINOIS FED. AID PROJECT				