

Bench Mark: Chiseled "□" Station 2345A+08, 44.0 ft. left of centerline of survey on light pole base north side of I-57/I-70 Elev. = 590.10.

Existing Structure: #025-0019 Constructed in 1960 & reconstructed in 1992 is a five simple span structure. The superstructure consist of R.C. slab and composite steel I-Beams which are 25'-8" out to out and 269'-11 1/16" back to back abutments along the long chord. The superstructure is supported by R.C. spill through abutments and 2-column piers with hammer head caps. Traffic shall be detoured during construction.

No salvage.

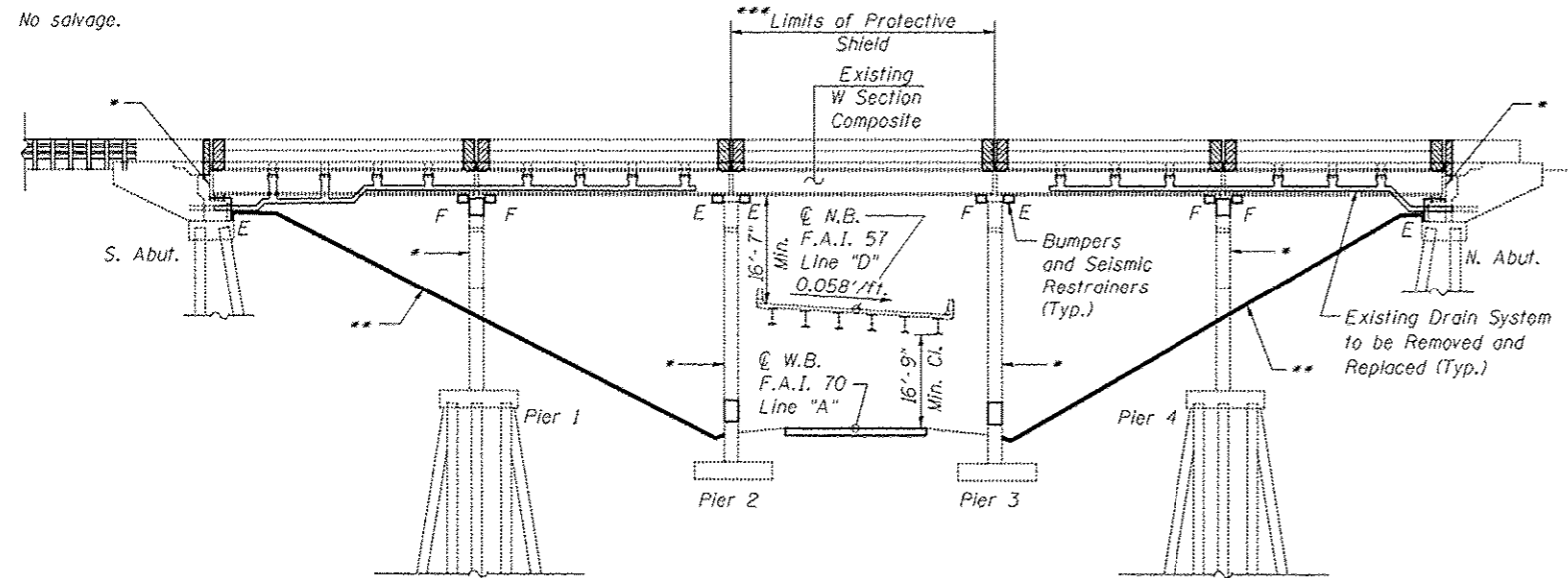

ELEVATION

▨ Indicates existing concrete and expansion devices to be removed and replaced.

\* For Limits of Concrete Removal (Special), Structural Repair of Concrete and Cleaning of existing rebars, see sheet 17, 20, 25, 27, 29 and 32 of 35.

\*\* See sheet 10 of 35 for Slopewall Details.

\*\*\* See sheet 3 of 35 for Transverse Limits.

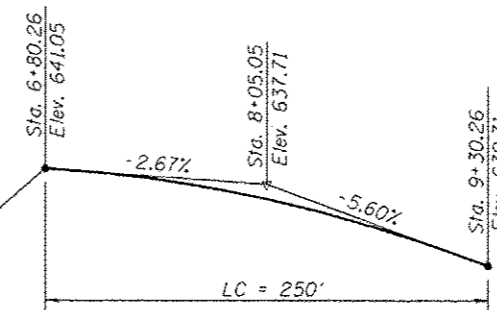

PROPOSED PROFILE GRADE

Sta. 10F+90.57 @ Ramp "F" =  
Sta. 5367D+22.93 @ NB  
F.A.I. Route 57 Line "D"  
& Sta. 2370A+11.04 @ WB  
F.A.I. Route 70 Line "A"

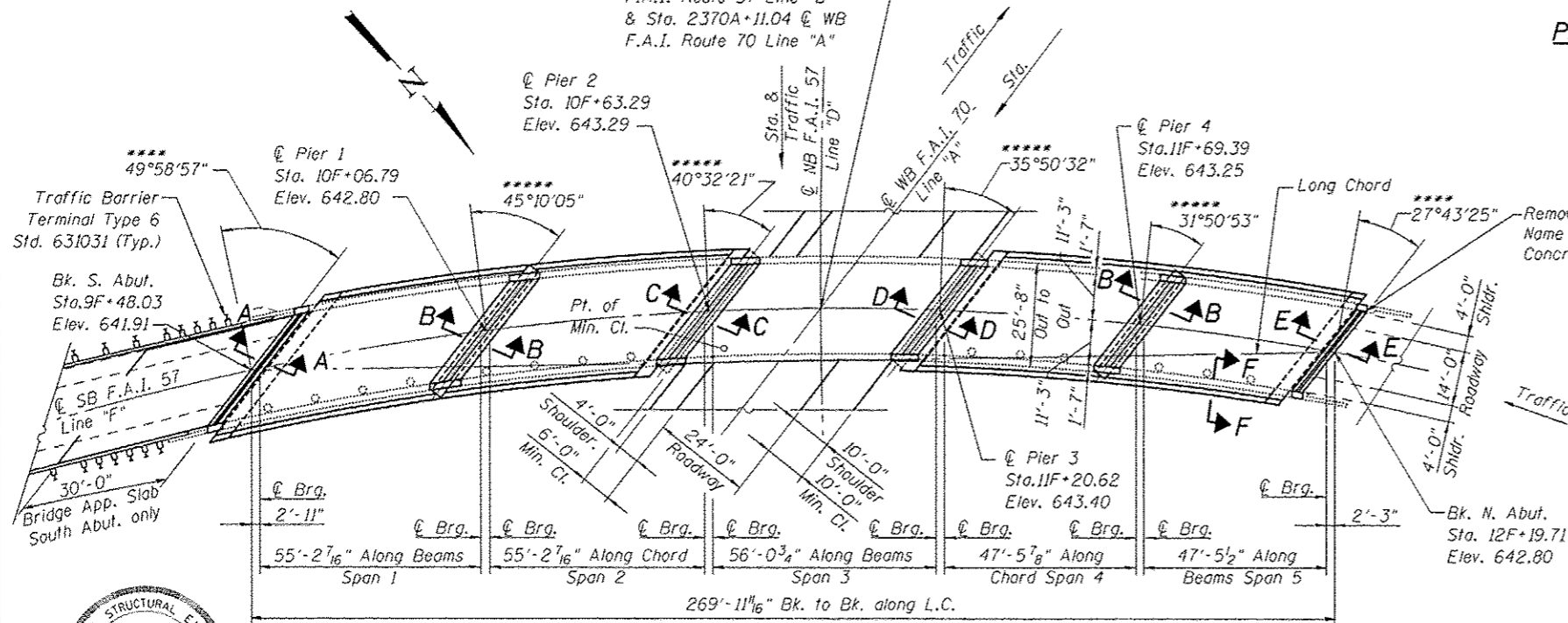

PLAN

DESIGN SPECIFICATIONS

2002 AASHTO Standard Specifications for Highway Bridges  
1995 F.H.W.A. Seismic Retrofitting Manual for Highway Bridges  
2006 F.H.W.A. Seismic Retrofitting Manual for Highway Structures Part I-Bridges (Reference Only)

DESIGN STRESSES

**New Construction**  
f'c = 3,500 psi  
fy = 60,000 psi (Reinforcement)  
fy = 50,000 psi (Structural Steel)  
(AASHTO M270 Grade 50)

**Existing Structure**  
f'c = 3,500 psi  
fy = 40,000 psi (Sub) (Reinforcement) (Abutments, Pier No. 1, Pier No. 4 & footings)  
fy = 33,000 psi (Structural Steel)  
fy = 60,000 psi (Super 1992) (Pier No. 2 & Pier No. 3) (Reinforcement)

SEISMIC DATA

Seismic Performance Category (SPC) = B  
Bedrock Acceleration Coefficient (A) = 0.075 g  
Site Coefficient = 1.0

LOADING HS20-44 & ALT.  
No Future Wearing Surface

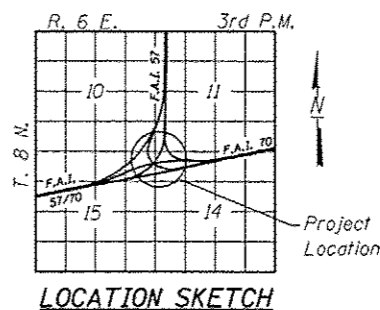

LOCATION SKETCH

GENERAL PLAN AND ELEVATION  
F.A.I. ROUTE 70 AND F.A.I. ROUTE 57  
INTERCHANGE RAMP "F" OVER  
WESTBOUND F.A.I. ROUTE 70  
STATION 10F+90.57  
STRUCTURE NO. 025-0019

\*\*\*\*\* Skew angle measured to tangent at intersection of roadway & Bk. of Abutment

\*\*\*\*\* Skew angle measured to tangent at intersection of roadway & substructure.

For Sections A-A, B-B, C-C, D-D, E-E and F-F see sheet 3 of 35.



EXP. 11-30-2014  
Chadwick J. Fuesting 6/13/13

FILE NAME = 0250019-74295-001.dgn

USER NAME =

DESIGNED - B.B.

REVISED -

Illinois Design Firm Number 184.001670

CHECKED - A.C.S.

REVISED -

PLOT SCALE =

DRAWN - W.J.S.

REVISED -

PLOT DATE = 10/12/26 AM 6/18/2013

CHECKED - C.J.F. & B.B.

REVISED -

STATE OF ILLINOIS  
DEPARTMENT OF TRANSPORTATION

SHEET NO. 1 OF 35 SHEETS

F.A.I. RTE.	SECTION	COUNTY	TOTAL SHEETS	SHEET NO.
57/70	(25-4HB)1-3	EFFINGHAM	1760	1706
			CONTRACT NO. 74295	

ILLINOIS FED. AID PROJECT