

• CUT OR BEND TO FIT
 MIN BAR LAP
 #4 1'-4"
 WORK THIS SHEET WITH
 SHEET 13 of 23

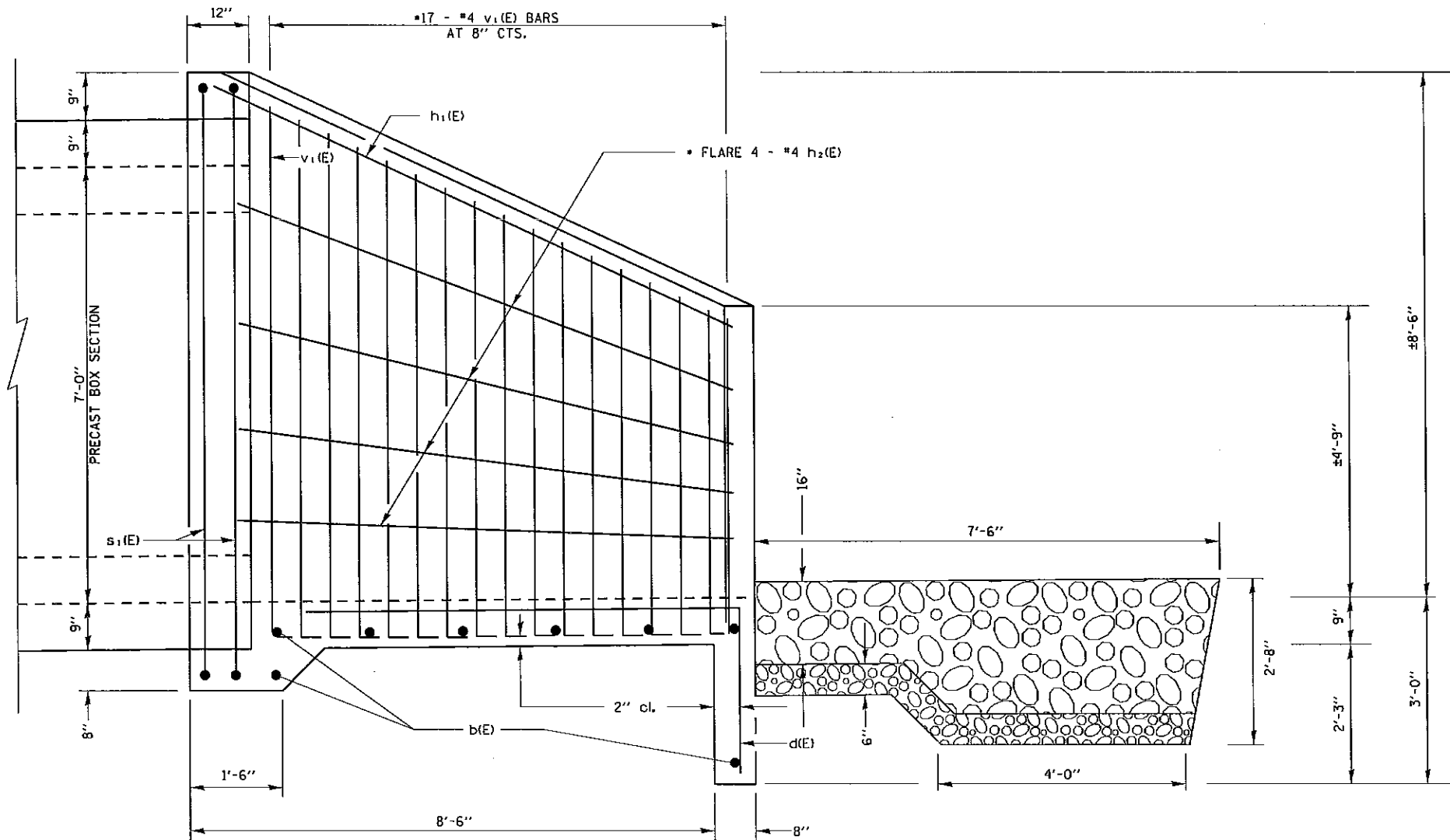

HALF SIDE ELEVATION

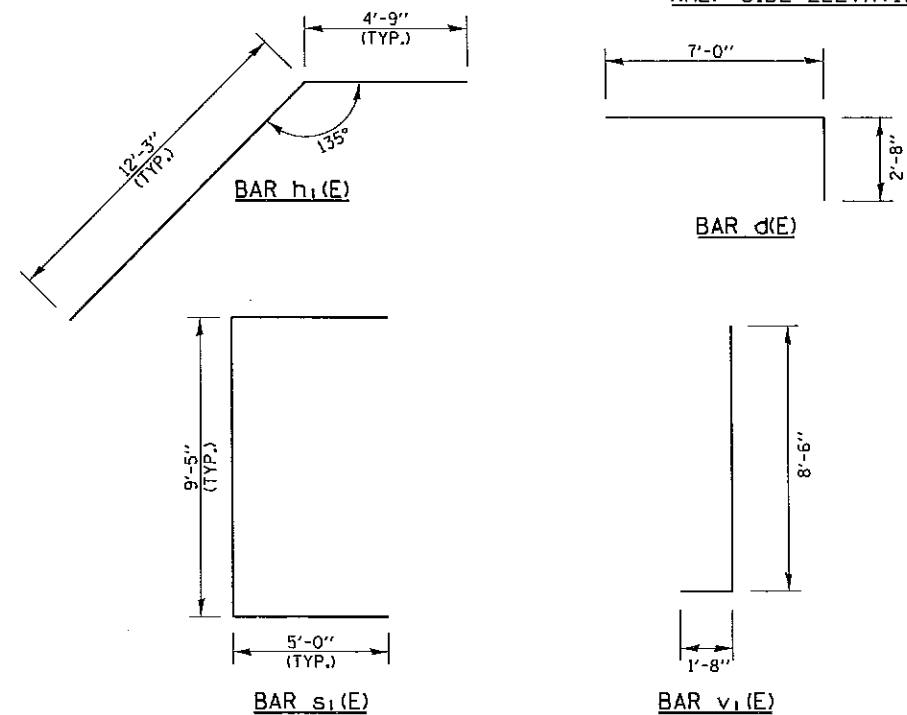

BILL OF MATERIAL (BOTH APRONS)

Bar	No.	Size	Length	Shape	
b(E)	32	#4	20'-0"	—	
d(E)	52	#4	9'-8"	┌	
h(E)	2	#4	15'-6"	—	
h1(E)	4	#4	17'-0"	└	
h2(E)	16	#4	11'-9"	—	
s(E)	8	#4	15'-0"	—	
s1(E)	8	#4	19'-5"	┌	
v1(E)	68	#4	10'-2"	└	
			CONCRETE BOX CULVERTS	CU. YD.	30.8
			REINFORCEMENT BARS, EPOXY COATED.	Pound	1610

REINFORCEMENT BARS DESIGNATED (E) SHALL BE EPOXY COATED.

FILE NAME *	USER NAME = walkerra	DESIGNED -	REVISED -
ca\pe_work\pndot\walkerra\d0326424\703	2-Design.dgn	DRAWN -	REVISED -
Default	PLOT SCALE = 2.4000 1/1 in.	CHECKED -	REVISED -
	PLOT DATE = 5/30/2013	DATE -	REVISED -

STATE OF ILLINOIS
 DEPARTMENT OF TRANSPORTATION

PROPOSED CAST-IN-PLACE APRON END
 SECTION (SN 097-7091)

SCALE: _____ SHEET _____ OF _____ SHEETS STA. _____ TO STA. _____

F.A.P. RTE. = 332	SECTION = 2B-2	COUNTY = WHITE	TOTAL SHEETS = 23	SHEET NO. = 12
				CONTRACT NO. 78312
ILLINOIS FED. AID PROJECT				