

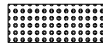

INDEX OF SHEETS

SHEET NO.	DESCRIPTION
1	COVER SHEET
2	INDEX OF SHEETS, STATE STANDARDS & GENERAL NOTES
3-4	SUMMARY OF QUANTITIES
5-6	LOCATION MAP & TRAFFIC DATA
7-8	SCHEDULE OF QUANTITIES
9-47	CURB RAMPS PLANS
48-61	TRAFFIC SIGNAL PLANS
62-69	TRAFFIC SIGNAL DETAILS
70	BD-08: DETAILS FOR FRAMES AND LIDS ADJUSTMENT WITH MILLING
71	BD-24: CURB OR CURB AND GUTTER REMOVAL AND REPLACEMENT
72	TC-10: TRAFFIC CONTROL AND PROTECTION FOR SIDE ROADS, INTERSECTIONS AND DRIVEWAYS
73	TC-13: DISTRICT ONE TYPICAL PAVEMENT MARKINGS
74	TC-22: ARTERIAL ROAD INFORMATION SIGN
75	PD-01: PROJECT DETAIL FOR SINGLE PERPENDICULAR CURB RAMPS
76	PD-02: PROJECT DETAIL FOR SINGLE PERPENDICULAR CURB RAMPS
77	PD-03: PROJECT DETAIL FOR DOUBLE PERPENDICULAR CURB RAMPS
78	PD-04: PROJECT DETAIL FOR SINGLE PERPENDICULAR CURB RAMPS WITH TURNING SPACE
79	PD-05: PROJECT DETAIL FOR DEPRESSED CORNER CURB RAMPS

LEGEND

(678.90)	EXISTING ELEVATION
	PROPOSED DETECTABLE WARNING
	PROPOSED SIDEWALK REMOVAL REPLACE WITH TOPSOIL & SOD
	PROPOSED SIDE CURB
	PROPOSED ELEVATION
	PROPOSED HMA SURFACE REMOVAL, VARIABLE DEPTH, 4' WIDE

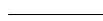
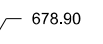
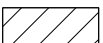
HOT-MIX ASPHALT MIXTURE REQUIREMENTS		QUALITY MANAGEMENT PROGRAM (QMP)
MIXTURE TYPE	AIR VOIDS @ Ndes	
PAVEMENT RESTORATION		
4' STRIP ANYWHERE WHERE PAVEMENT WAS DISTURBED DURING CONSTRUCTION		
HMA SURFACE COURSE, MIX "D", IL-9.5, N70 2"	4% AT 70 GYR.	QC/QA

QMP DESIGNATION: QUALITY CONTROL/QUALITY ASSURANCE (QC/QA); QUALITY CONTROL FOR PERFORMANCE (QCP); PAY FOR PERFORMANCE (PFP)

NOTE 1: THE UNIT WEIGHT USED TO CALCULATE ALL HMA SURFACE MIXTURE QUANTITIES IS 112 LBS/SQ YD/IN.

NOTE 2: THE "AC TYPE" FOR POLYMERIZED HMA MIXES SHALL BE "SBS/SBR PG 76 -22" AND FOR NON-POLYMERIZED HMA THE "AC TYPE" SHALL BE "PG 64 -22" UNLESS MODIFIED BY RECLAIMED MATERIALS SPECIFICATIONS.

STATE STANDARDS

STANDARD NO.	DESCRIPTION
000001-08	STANDARD SYMBOLS, ABBREVIATIONS AND PATTERNS
424001-11	PERPENDICULAR CURB RAMPS FOR SIDEWALKS
424006-05	DIAGONAL CURB RAMPS FOR SIDEWALKS
424011-04	CORNER PARALLEL CURB RAMPS FOR SIDEWALKS
424016-05	MID-BLOCK CURB RAMPS FOR SIDEWALKS
424021-06	DEPRESSED CORNER FOR SIDEWALKS
604001-05	FRAME AND LIDS, TYPE 1
604091-05	FRAME AND GRATES, TYPE 24
606001-08	CONCRETE CURB TYPE B AND COMBINATION CONCRETE CURB AND GUTTER
606301-04	PC CONCRETE ISLANDS AND MEDIANS
701006-05	OFF-RD OPERATIONS, 2L, 2W, 15' (4.5 M) TO 24" (600 MM) FROM PAVEMENT EDGE
701011-04	OFF-RD MOVING OPERATIONS, 2L, 2W, DAY ONLY
701101-05	OFF-RD OPERATIONS, MULTILANE, 15' (4.5 M) TO 24" (600 MM) FROM PAVEMENT EDGE
701301-04	LANE CLOSURE, 2L, 2W, SHORT TIME OPERATIONS
701311-03	LANE CLOSURE, 2L, 2W, MOVING OPERATIONS - DAY ONLY
701427-05	LANE CLOSURE, MULTILANE, INTERMITTENT OR MOVING OPERATION, FOR SPEEDS < 40 MPH
701701-10	URBAN LANE CLOSURE, MULTILANE INTERSECTION
701801-06	SIDEWALK, CORNER OR CROSSWALK CLOSURE
701901-09	TRAFFIC CONTROL DEVICES
780001-05	TYPICAL PAVEMENT MARKINGS
886001-01	DETECTOR LOOP INSTALLATIONS
886006-01	TYPICAL LAYOUT FOR DETECTOR LOOPS

GENERAL NOTES

- BEFORE STARTING ANY EXCAVATION, THE CONTRACTOR SHALL CALL "JULIE" AT (800) 892-0123 OR 811 FOR FIELD LOCATIONS OF BURIED ELECTRIC, TELEPHONE, AND GAS FACILITIES. (48 HOUR NOTIFICATION REQUIRED)
- THE CONTRACTOR SHALL COORDINATE CONSTRUCTION ACTIVITIES WITH UTILITY COMPANIES, VILLAGES OF LIBERTYVILLE, MUNDELEIN AND VERNON HILLS.
- THE CONTRACTOR SHALL CONTACT DISTRICT ONE ARTERIAL TRAFFIC CONTROL SUPERVISOR AT KALPANA.KANNAN-HOSADURGA@ILLINOIS.GOV. A MINIMUM OF 72 HOURS IN ADVANCE OF BEGINNING WORK.
- THE CONTRACTOR WILL NOT BE ALLOWED TO SET UP A YARD OR FIELD OFFICE ON STATE PROPERTY WITHOUT THE WRITTEN PERMISSION OF THE DEPARTMENT.
- EXISTING FACILITIES WITHIN THE LIMITS TO BE PROTECTED FROM DAMAGE BY CONTRACTOR. IF FACILITY PROTECTION IS REQUIRED, PLEASE CALL 1800-334-7661 TO CREATE A TICKET FOR LINE PROTECTION AS SOON AS POSSIBLE
- DO NOT SCALE PLANS FOR CONSTRUCTION DIMENSIONS.
- IT SHALL BE THE CONTRACTOR'S RESPONSIBILITY TO VERIFY ALL DIMENSIONS AND CONDITIONS EXISTING IN THE FIELD PRIOR TO CONSTRUCTION AND ORDERING OF MATERIALS.
- THE CONTRACTOR SHALL BE REQUIRED TO PROVIDE ACCESS TO ABUTTING PROPERTY AT ALL TIMES DURING THE CONSTRUCTION OF THIS PROJECT.
- SAW CUTTING OF PAVEMENTS, SIDEWALK, CURB & GUTTER, ETC. SHALL BE TO FULL DEPTH AND SHALL RESULT IN A CLEAN STRAIGHT EDGE ON THE PORTION REMAINING. ALL SAW CUTTING SHALL BE CONSIDERED INCLUDED IN THE COST OF THE ITEM REMOVED.
- TWO (2) FOOT TRANSITIONS SHALL BE USED TO MATCH PROPOSED CURB AND GUTTER ITEMS OF WORK TO EXISTING CURB AND GUTTER AND CONDITIONS IN THE FIELD, UNLESS OTHERWISE SHOWN. THE TRANSITIONS SHALL BE PAID FOR AT THE CONTRACT UNIT PRICE FOR THE PROPOSED ITEMS OF WORK SPECIFIED.
- THE RESIDENT ENGINEER SHALL CONTACT FADI SULTAN, AREA TRAFFIC FIELD ENGINEER, VIA E-MAIL AT FADI.SULTAN@ILLINOIS.GOV, A MINIMUM OF 2 WEEKS PRIOR TO PLACEMENT OF PERMANENT PAVEMENT MARKINGS.
- ALL DAMAGE TO EXISTING PAVEMENT MARKINGS OR RAISED REFLECTIVE PAVEMENT MARKERS OUTSIDE THE PROPOSED WORK SHOWN ON THE PLANS SHALL BE REPLACED AT NO ADDITIONAL COST TO THE DEPARTMENT.
- WHEN EXISTING SIDEWALK IS TO BE REMOVED WITHOUT PROPOSED SIDEWALK REPLACEMENT, IT SHALL BE REPLACED WITH TOPSOIL AND SOD.
- THE CONTRACTOR SHALL USE CARE IN REMOVING, EXCAVATING OR GRADING NEAR ANY AND ALL EXISTING ITEMS THAT WILL NOT BE REMOVED. ANY DAMAGE DONE TO EXISTING ITEMS BY THE CONTRACTOR SHALL BE REPAIRED AT THE CONTRACTOR'S OWN EXPENSE TO THE SATISFACTION OF THE ENGINEER.
- LANDSCAPED AREAS AFFECTED BY SIDEWALK CONSTRUCTION SHALL BE RESTORED WITH 18-INCH WIDE STRIP OF "SODDING, SALT TOLERANT" AND "TOPSOIL FURNISH AND PLACE, 4-INCH" INSTALLED FROM THE BACK OF THE SIDEWALK, OR AS DETERMINED BY THE RESIDENT ENGINEER/TECHNICIAN.
- ANY LOOSE MATERIAL DEPOSITED IN THE FLOW LINE OF CURB OR DRAINAGE STRUCTURES, WHICH OBSTRUCTS THE NATURAL FLOW OF WATER, SHALL BE REMOVED AT THE CLOSE OF EACH WORKING DAY. PRIOR TO ACCEPTANCE OF THE IMPROVEMENT, ALL DRAINAGE STRUCTURES SHALL BE FREE OF DIRT AND DEBRIS. THIS WORK WILL NOT BE PAID FOR SEPARATELY BUT SHALL BE CONSIDERED AS INCIDENTAL.
- ALL INDIVIDUAL CORNER LOCATIONS HAVE QUANTITY FOR PROPOSED HMA SURFACE REMOVAL, VARIABLE DEPTH. EVEN CORNERS WHERE THEY AREN'T SHOWN ON THE DETAIL SHEETS.
- THE CONTRACTOR SHALL BE RESPONSIBLE FOR THE REPLACEMENT OF ANY DETECTOR LOOPS DAMAGED DURING CONSTRUCTION.
- THE CONTRACTOR SHALL MAINTAIN PEDESTRIAN ACCESS AT ALL TIMES DURING CONSTRUCTION.
- FRAMES AND GRATES ADJUSTMENT OF PRIVATE UTILITIES WITHIN THE LIMITS OF THE IMPROVEMENTS SHALL BE DONE BY THEIR RESPECTIVE OWNERS AND ARE NOT PART OF THIS CONTRACT.
- ANY LOCATION WHERE EXISTING PAVEMENT IS DAMAGED OR DESTROYED DURING CONSTRUCTION MUST BE FIXED WITH A 4' STRIP OF 2" HMA SURFACE COURSE, IL-9.5, NO 70.



23. STORM SEWER CLEANING SHALL TAKE PLACE AT THE INTERSECTION OF IL 176 AND MILWAUKEE AVE.

1 REVISED SHEET 9/3/2024

MODEL: GenNotesSh01 (Sheet)
FILE NAME: c:\pwworking\tdconnor.mullane@illinois.gov\d1005779\120821-shr-gennote.dgn

USER NAME = connor.mullane	DESIGNED -	REVISED -  CM 8/30/2024
PLOT SCALE = 0.16666633' / in.	DRAWN -	REVISED -
PLOT DATE = 7/23/2024	CHECKED -	REVISED -
	DATE -	REVISED -

**STATE OF ILLINOIS
DEPARTMENT OF TRANSPORTATION**

CENTRAL LAKE COUNTY- ADA IMPROVEMENTS INDEX OF SHEETS, STATE STANDARDS & GENERAL NOTES			
SCALE:	SHEET	OF 1 SHEETS	STA. TO STA.

F.A. RTE.	SECTION	COUNTY	TOTAL SHEETS	SHEET NO.
VAR.	2021-125-SW	LAKE	79	2
CONTRACT NO. 62P38				
ILLINOIS FED. AID PROJECT				

0005 ROADWAY 100% STATE	SUMMARY OF QUANTITIES			0005 ROADWAY 100% STATE	0021 SAFETY 100% STATE
Code No.	Item	Unit	Total Quantity		
20200100	EARTH EXCAVATION	CU YD	110	110	0
21101615	TOPSOIL FURNISH AND PLACE, 4"	SQ YD	565.4	565.4	0
25200110	SODDING, SALT TOLERANT	SQ YD	565.4	565.4	0
25200200	SUPPLEMENTAL WATERING	UNIT	5.7	5.7	0
40600290	BITUMINOUS MATERIALS (TACK COAT)	POUND	21	21	0
40604062	HOT-MIX ASPHALT SURFACE COURSE, IL-9.5, MIX "D", N70	TON	91.8	91.8	0
42001300	PROTECTIVE COAT	SQ YD	926.7	926.7	0
42400200	PORTLAND CEMENT CONCRETE SIDEWALK 5 INCH	SQ FT	8820	8820	0
42400800	DETECTABLE WARNINGS	SQ FT	1032	1032	0
44000200	DRIVEWAY PAVEMENT REMOVAL	SQ YD	4	4	0
44000600	SIDEWALK REMOVAL	SQ FT	9295	9295	0
44003100	MEDIAN REMOVAL	SQ FT	334	334	0
60250200	CATCH BASINS TO BE ADJUSTED	EACH	29	29	0
60255500	MANHOLES TO BE ADJUSTED	EACH	4	4	0
60266600	VALVE BOXES TO BE ADJUSTED	EACH	4	4	0
60404300	FRAMES AND GRATES, TYPE 3	EACH	1	1	0
60406001	FRAMES AND LIDS, TYPE 1,ADA COMPLIANT, OPEN LID	EACH	5	5	0
60618300	CONCRETE MEDIAN SURFACE, 4 INCH	SQ FT	334	334	0
* 66900200	NON-SPECIAL WASTE DISPOSAL	CU YD	110	110	0

	SUMMARY OF QUANTITIES			0005 ROADWAY 100% STATE	0021 SAFETY 100% STATE
Code No.	Item	Unit	Total Quantity		
* 66900530	SOIL DISPOSAL ANALYSIS	EACH	10	10	0
* 66901001	REGULATED SUBSTANCES PRE-CONSTRUCTION PLAN	L SUM	1	1	0
* 66901003	REGULATED SUBSTANCES FINAL CONSTRUCTION REPORT	L SUM	1	1	0
* 66901006	REGULATED SUBSTANCES MONITORING	CAL DA	10	10	0
67100100	MOBILIZATION	L SUM	1	1	0
70102625	TRAFFIC CONTROL AND PROTECTION, STANDARD 701606	L SUM	1	1	0
70102635	TRAFFIC CONTROL AND PROTECTION, STANDARD 701701	L SUM	1	1	0
70102640	TRAFFIC CONTROL AND PROTECTION, STANDARD 701801	L SUM	1	1	0
* 72000100	SIGN PANEL - TYPE 1	SQ FT	22	22	0
* 72400720	RELOCATE SIGN PANEL - TYPE 2	SQ FT	13.5	13.5	0
* 72800100	TELESCOPING STEEL SIGN SUPPORT	FOOT	46	46	0
* 78000400	THERMOPLASTIC PAVEMENT MARKING - LINE 6"	FOOT	1178	1178	0
* 78000600	THERMOPLASTIC PAVEMENT MARKING - LINE 12"	FOOT	2455	2455	0
* 78000650	THERMOPLASTIC PAVEMENT MARKING - LINE 24"	FOOT	708	708	0
* 78300202	PAVEMENT MARKING REMOVAL - WATER BLASTING	SQ FT	1000	1000	0
* 81028200	UNDERGROUND CONDUIT, GALVANIZED STEEL, 2" DIA.	FOOT	512	0	512
* 81028240	UNDERGROUND CONDUIT, GALVANIZED STEEL, 4" DIA.	FOOT	40	0	40
* 85000200	MAINTENANCE OF EXISTING TRAFFIC SIGNAL INSTALLATION	EACH	7	0	7
* 87301215	ELECTRIC CABLE IN CONDUIT, SIGNAL NO. 14 2C	FOOT	4979	0	4979
*	SPECIALTY ITEM				

MODEL: SQO_1 [Sheet]
 FILE NAME: c:\pwwork\work\concor.mullane@illinois.gov\1005779\120821-shh-SQO.dgn

REVISED SHEET 9/3/2024

USER NAME = connor.mullane	DESIGNED -	REVISED -
	DRAWN -	REVISED -
	CHECKED -	REVISED -
PLOT DATE = 7/11/2024	DATE -	REVISED -

STATE OF ILLINOIS
DEPARTMENT OF TRANSPORTATION

CENTRAL LAKE COUNTY - ADA IMPROVEMENTS
SUMMARY OF QUANTITIES

SCALE: SHEET OF 2 SHEETS STA. TO STA.

F.A. RTE.	SECTION	COUNTY	TOTAL SHEETS	SHEET NO.
VAR.	2021-125-SW	LAKE	79	3
CONTRACT NO. 62P38				
ILLINOIS FED. AID PROJECT				

SUMMARY OF QUANTITIES

0005
ROADWAY
100% STATE

0021
SAFETY
100% STATE

Code No.	Item	Unit	Total Quantity	0005 ROADWAY 100% STATE	0021 SAFETY 100% STATE
* 87301900	ELECTRIC CABLE IN CONDUIT, EQUIPMENT GROUNDING CONDUCTOR, NO. 6 1C	FOOT	690	0	690
* 87900200	DRILL EXISTING HANDHOLE	EACH	31	0	31
* 88600100	DETECTOR LOOP, TYPE I	FOOT	510	0	510
* 89502210	MODIFY EXISTING CONTROLLER CABINET	EACH	7	0	7
* 89502300	REMOVE ELECTRIC CABLE FROM CONDUIT	FOOT	2760	0	2760
* 89502375	REMOVE EXISTING TRAFFIC SIGNAL EQUIPMENT	EACH	7	0	7
* 89502376	REBUILD EXISTING HANDHOLE	EACH	9	0	9
X0320050	CONSTRUCTION LAYOUT (SPECIAL)	L SUM	1	1	0
* X1400378	PEDESTRIAN SIGNAL POST, 5 FT.	EACH	29	0	29
X4400501	COMBINATION CURB AND GUTTER REMOVAL AND REPLACEMENT LESS THAN OR EQUAL TO 10 FEET	FOOT	100	100	0
X4400503	COMBINATION CURB AND GUTTER REMOVAL AND REPLACEMENT GREATER THAN 10 FEET	FOOT	1859	1859	0
X4401198	HOT-MIX ASPHALT SURFACE REMOVAL, VARIABLE DEPTH	SQ YD	820	820	0
X6700407	ENGINEER'S FIELD OFFICE, TYPE A (D1)	CAL MO	6	6	0
* X8140238	REBUILD EXISTING DOUBLE HANDHOLE	EACH	5	0	5
* X8760200	ACCESSIBLE PEDESTRIAN SIGNALS	EACH	54	0	54
* X8780012	CONCRETE FOUNDATION, TYPE A 12-INCH DIAMETER	FOOT	116	0	116
Z0030850	TEMPORARY INFORMATION SIGNING	SQ FT	102.8	102.8	0
* Z0033044	RE-OPTIMIZE TRAFFIC SIGNAL SYSTEM LEVEL 1	EACH	7	0	7
X5537800	STORM SEWERS TO BE CLEANED 12"	FOOT	400	400	
*	SPECIALTY ITEM				

MODEL: SOQ 2 [Sheet]
FILE NAME: c:\p\w\work\wis\connor.mullane@illinois.gov\1005779\120821-shr-SOQ.dgn

REVISED SHEET 9/3/2024

USER NAME = connor.mullane	DESIGNED -	REVISED -
	DRAWN -	REVISED -
	CHECKED -	REVISED -
PLOT DATE = 7/11/2024	DATE -	REVISED -

**STATE OF ILLINOIS
DEPARTMENT OF TRANSPORTATION**

**CENTRAL LAKE COUNTY - ADA IMPROVEMENTS
SUMMARY OF QUANTITIES**

SCALE: SHEET OF 2 SHEETS STA. TO STA.

F.A. RTE.	SECTION	COUNTY	TOTAL SHEETS	SHEET NO.
VAR.	2021-125-SW	LAKE	79	4
CONTRACT NO. 62P38				
ILLINOIS FED. AID PROJECT				



SOUTHWEST CORNER



SOUTHEAST CORNER



NORTHWEST CORNER



NORTHEAST CORNER

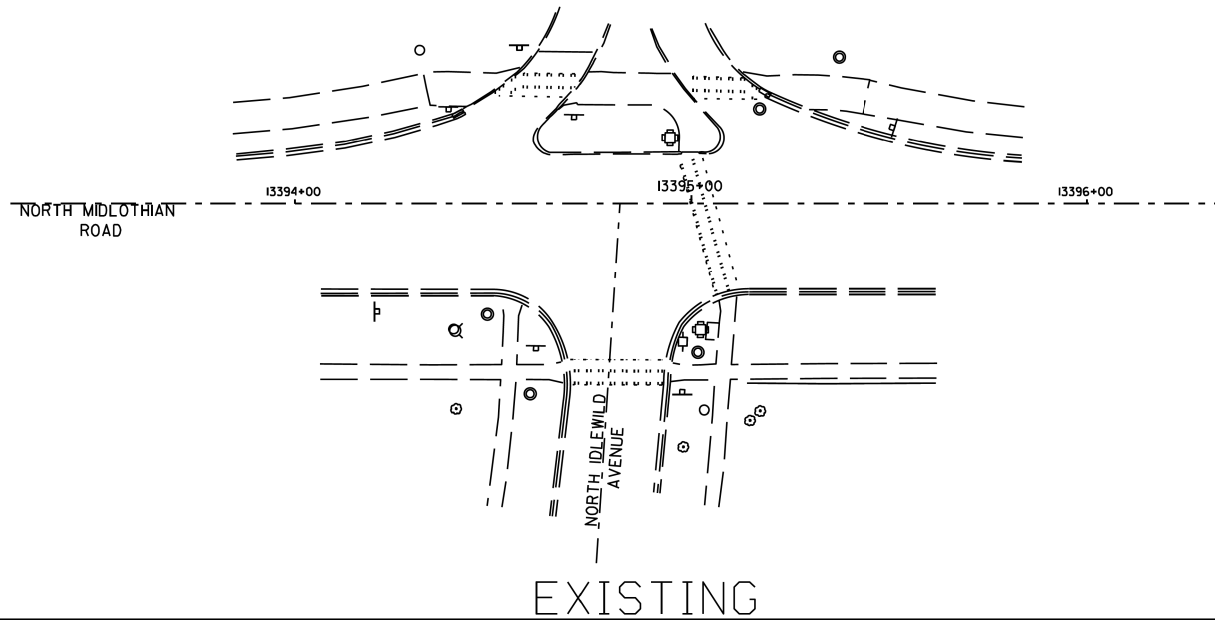

EXISTING

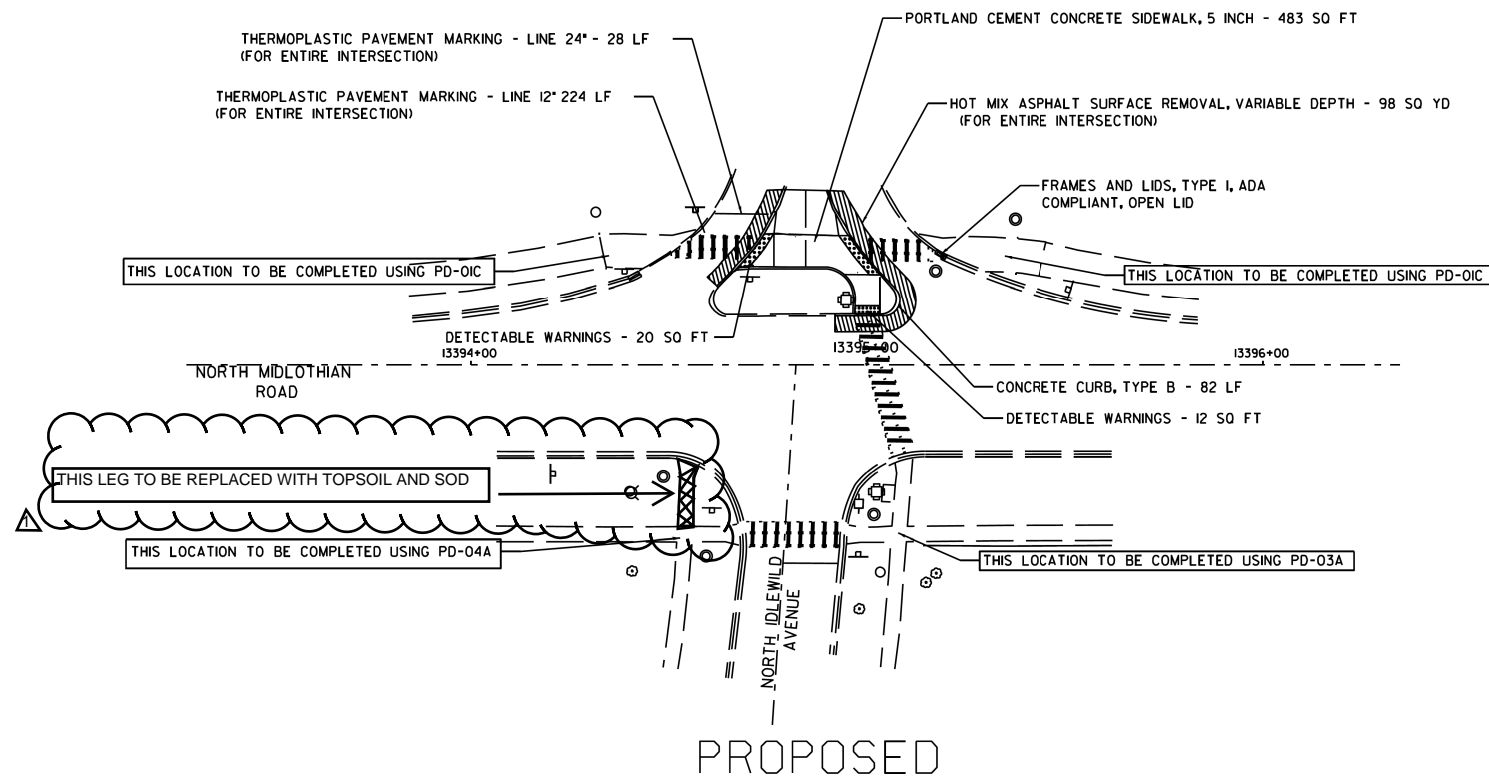

PROPOSED

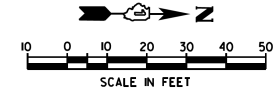

MODEL: IDLEWILD BASE (Sheet)
FILE NAME: c:\pw\work\idlewild\concor.mullane@illinois.gov\1005779\1005779\120821-sht-Plan-Misc-Idlewild.dgn

REVISOR'S MARK: REVISED SHEET 9/3/2024

USER NAME =	connor.mullane	DESIGNED -	REVISOR'S MARK: CM 8/30/2024
		DRAWN -	REVISOR'S MARK:
		CHECKED -	REVISOR'S MARK:
PLOT DATE =	7/11/2024	DATE -	REVISOR'S MARK:

STATE OF ILLINOIS
DEPARTMENT OF TRANSPORTATION

PROPOSED SIDEWALK PLAN
IDLEWILD AVE BASE SHEET

SCALE: SHEET OF 16 SHEETS STA. TO STA.

F.A. RTE.	SECTION	COUNTY	TOTAL SHEETS	SHEET NO.
	2021-125-SW	LAKE	79	35
CONTRACT NO. 62P38				
ILLINOIS FED. AID PROJECT				

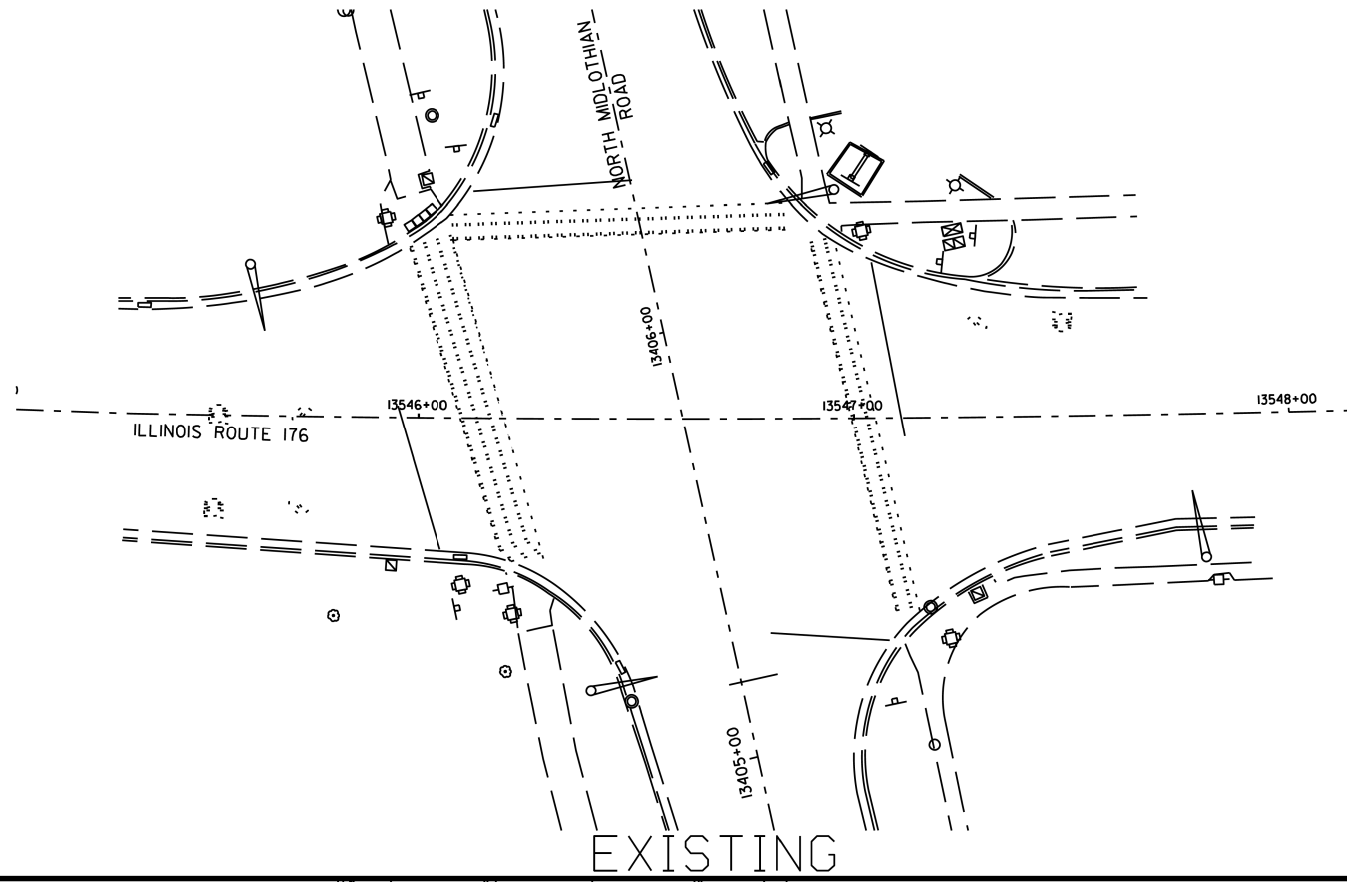

EXISTING

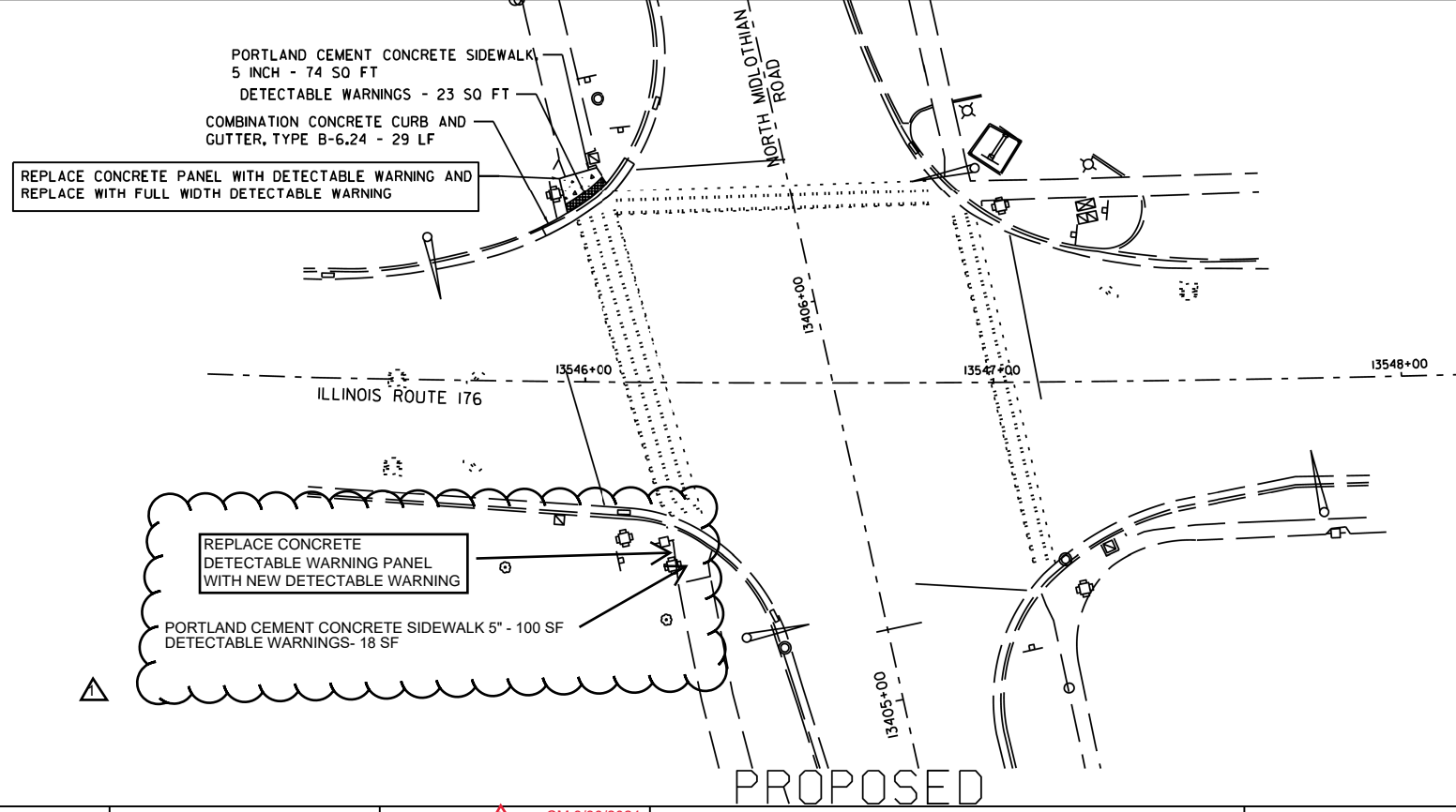

PROPOSED

PORTLAND CEMENT CONCRETE SIDEWALK
5 INCH - 74 SQ FT
DETECTABLE WARNINGS - 23 SQ FT
COMBINATION CONCRETE CURB AND
GUTTER, TYPE B-6.24 - 29 LF

REPLACE CONCRETE PANEL WITH DETECTABLE WARNING AND
REPLACE WITH FULL WIDTH DETECTABLE WARNING

REPLACE CONCRETE
DETECTABLE WARNING PANEL
WITH NEW DETECTABLE WARNING

PORTLAND CEMENT CONCRETE SIDEWALK 5" - 100 SF
DETECTABLE WARNINGS- 18 SF

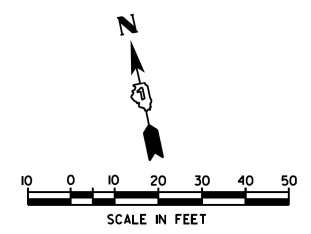

REVISOR'S MARK: REVISED SHEET 9/3/2024

MODEL: IL_176 BASE [Sheet]
FILE NAME: c:\pwworking\connor.mullane@illinois.gov\d1005779\d120821-sht_Plan-Misc\176base.dgn

USER NAME = connor.mullane	DESIGNED -	REVISED - CM 8/30/2024
	DRAWN -	REVISED -
	CHECKED -	REVISED -
PLOT DATE = 7/11/2024	DATE -	REVISED -

STATE OF ILLINOIS
DEPARTMENT OF TRANSPORTATION

PROPOSED SIDEWALK PLAN
IL 176 BASE SHEET

SCALE: SHEET OF 16 SHEETS STA. TO STA.

F.A. RTE.	SECTION	COUNTY	TOTAL SHEETS	SHEET NO.
VAR.	2021-125-SW	LAKE	79	38
CONTRACT NO. 62P38				
ILLINOIS FED. AID PROJECT				