

CODE NO.	ITEM	UNIT	TOTAL QUANTITY	CONSTR. CODE	
				80% FED 20% STATE	BRIDGE 0059 URBAN
** 78009012	MODIFIED URETHANE PAVEMENT MARKING - LINE 12"	FOOT	94	94	
** 78011040	GROOVING FOR RECESSED PAVEMENT MARKING 8"	FOOT	120	120	
** 78100100	RAISED REFLECTIVE PAVEMENT MARKER	EACH	5	5	
78300200	RAISED REFLECTIVE PAVEMENT MARKER REMOVAL	EACH	8	8	
78300202	PAVEMENT MARKING REMOVAL - WATER BLASTING	SQ FT	2,214	2,214	
* K1004595	PRUNING FOR SAFETY AND EQUIPMENT CLEARANCE	L SUM	1	1	
* X5030539	FLOOR DRAINS TO BE CLEANED	EACH	13	13	
* X0326766	CLEAN & RESEAL RELIEF JOINT	FOOT	128	128	
* X0327638	STREAM GAUGE	EACH	1	1	
* X2010516	SELECTIVE CLEARING	UNIT	2	2	
* X5030250	BRIDGE DECK GROOVING (LONGITUDINAL)	SQ YD	1,278	1,278	
□ X5537800	STORM SEWER TO BE CLEANED 12"	FOOT	105	105	①
* X6333500	TRAFFIC BARRIER TERMINAL REMOVAL	EACH	1	1	
* X6700407	ENGINEER'S FIELD OFFICE, TYPE A (D1)	CAL MO	12	12	
* X7010216	TRAFFIC CONTROL AND PROTECTION, (SPECIAL)	L SUM	1	1	

CODE NO.	ITEM	UNIT	TOTAL QUANTITY	CONSTR. CODE	
				80% FED 20% STATE	BRIDGE 0059 URBAN
* X7830050	RAISED REFLECTIVE PAVEMENT MARKER, REFLECTOR REMOVAL	EACH	108	108	
* X7830052	RAISED REFLECTIVE PAVEMENT MARKER, REFLECTOR REPLACEMENT	EACH	108	108	
* Z0001800	APPROACH SLAB REPAIR (PARTIAL DEPTH)	SQ YD	42	42	
* Z0006016	BRIDGE DECK LATEX CONCRETE OVERLAY, 2 3/4 INCHES	SQ YD	1,318	1,318	
* Z0012130	BRIDGE DECK SCARIFICATION 3/4"	SQ YD	1,318	1,318	
* Z0013798	CONSTRUCTION LAYOUT	L SUM	1	1	
* Z0016002	DECK SLAB REPAIR (FULL DEPTH, TYPE II)	SQ YD	2	2	
□ Z0018500	DRAINAGE STRUCTURES TO BE CLEANED	EACH	7	7	①
* Z0029090	DIAMOND GRINDING (BRIDGE SECTION)	SQ YD	1,361	1,361	
* Z0030850	TEMPORARY INFORMATION SIGNING	SQ FT	67.1	67.1	
Z0073510	TEMPORARY TRAFFIC SIGNAL TIMING	EACH	1	1	
* Z0052000	REPAIR STEEL PLATE BEAM GUARDRAIL, TYPE A	FOOT	50	50	

MODEL: SOQ-2 [Sheet]  
FILE NAME: c:\users\public\mb\p\3\4\1581581\1601581\162137-SOQ.dgn

- \* - SPECIAL PROVISIONS
- \*\* - SPECIALTY ITEMS

□ NON-PART 100% STATE



USER NAME = nappelt	DESIGNED - NKA	REVISED -
	DRAWN - NKA	REVISED -
PLOT SCALE = 0.16666667 / in.	CHECKED - PK	REVISED -
PLOT DATE = 5/7/2024	DATE - 05/06/2024	REVISED -

**STATE OF ILLINOIS  
DEPARTMENT OF TRANSPORTATION**

**SUMMARY OF QUANTITIES**

SCALE: SHEET 2 OF 2 SHEETS STA. TO STA.

FAU RTE.	SECTION	COUNTY	TOTAL SHEETS	SHEET NO.
1332	FAU 1332 A 22 BJ	COOK	67	4
CONTRACT NO. 62T37				
ILLINOIS FED. AID PROJECT				

NOTE:

1. PROTRUDING PORTION OF THE BACK SIDE PROTECTION OF GUARDRAIL SHALL BE REMOVED TO THE NEAREST GUARDRAIL POST. THIS REMOVAL SHALL BE INCLUDED AS INCIDENTAL TO THE COST OF REPAIR STEEL PLATE BEAM GUARDRAIL, TYPE A.
2. RAISED REFLECTIVE PAVEMENT MARKERS TO BE REMOVED FROM BRIDGE AND APPROACH SLABS.

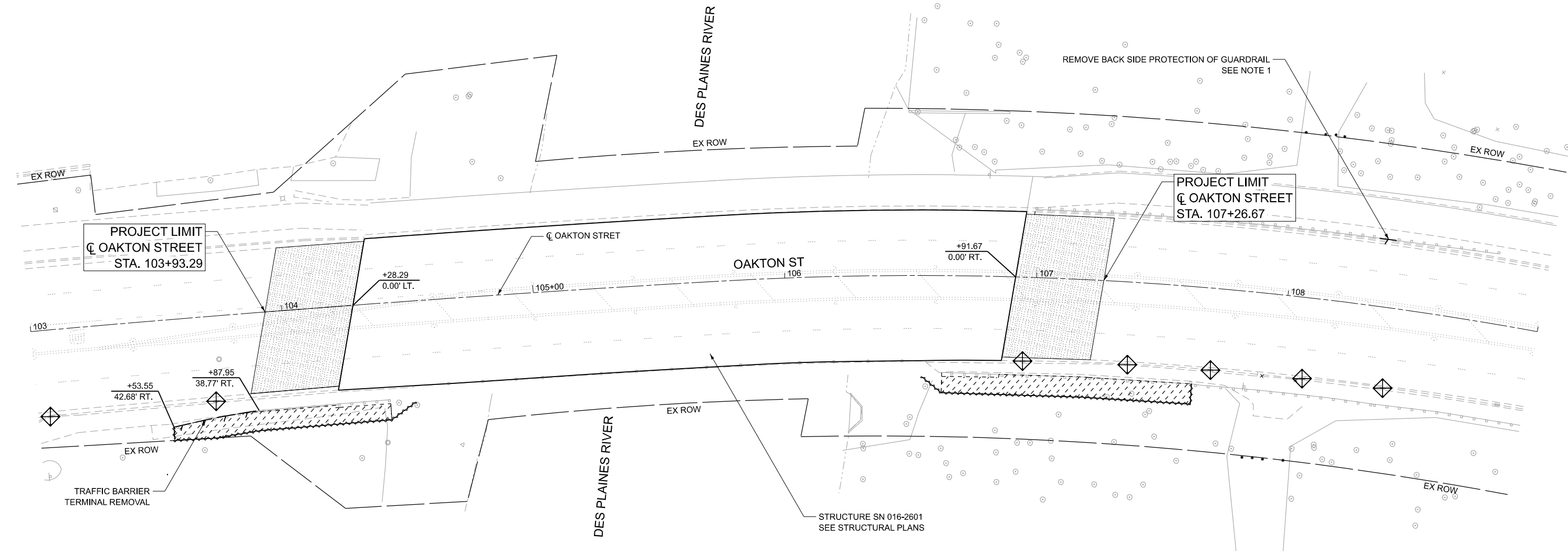
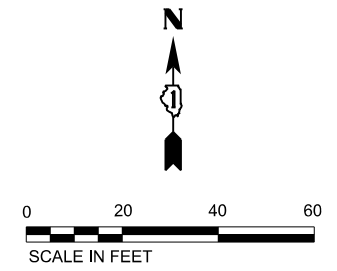

NOTE: STORM SEWERS TO BE CLEANED 12" GIVEN NOMINAL QUANTITY OF 15 FEET PER STRUCTURE. DRAINAGE STRUCTURE AND STORM SEWERS TO BE CLEANED AT THE ENGINEER'S DISCRETION.

**LEGEND**

- HOT-MIX ASPHALT SURFACE REMOVAL - BUTT JOINT (BD-32)
- INLET FILTERS
- TRAFFIC BARRIER TERMINAL REMOVAL
- SELECTIVE CLEARING, PRUNING FOR SAFETY AND EQUIPMENT CLEARANCE
- PERIMETER EROSION BARRIER

1 REVISED SHEET 9/3/2024

MODEL: EXC16 - Plan at bridge  
FILE NAME: p:\c\m\p-us-pw\ben\ibf.com\m\p-us-pw\3\Documents\Chicago\_IL\01\_Projects\DOT\_Ver\_DEsens\_PTB208\_005\1\03 - 198295\3.0 Deliverables\3.3 CADD Data\Sheets\162137-RemovalPlan

<b>AEG</b> ATLAS ENGINEERING GROUP, LTD.	USER NAME = nappett	DESIGNED - NKA	REVISED - 1 BA 8/28/2024
	PLOT SCALE = 40,000,000.00 1/in.	DRAWN - NKA	REVISED -
	PLOT DATE = 05/06/2024	CHECKED - PK	REVISED -
		DATE - 05/06/2024	REVISED -

**STATE OF ILLINOIS  
DEPARTMENT OF TRANSPORTATION**

**OAKTON STREET OVER DES PLAINES RIVER  
REMOVAL PLAN**

SCALE: 1"=20'    SHEET 1 OF 1 SHEETS    STA. 103+00.00 TO STA. 109+00.00

F.A.U. RTE.	SECTION	COUNTY	TOTAL SHEETS	SHEET NO.
1332	FAU 1332 A 22 BJ	COOK	67	18
CONTRACT NO. 62T37				
ILLINOIS FED. AID PROJECT				