

STATE OF ILLINOIS
DEPARTMENT OF TRANSPORTATION

F.A. RTE.	SECTION	COUNTY	TOTAL SHEETS	SHEET NO.
VAR	2024-974-TR	ILLINOIS	88	1
			CONTRACT NO. 62W94	COOK, WILL

* 88 + 1 = 89 TOTAL SHEETS
* * 89 + 4 = 93 TOTAL SHEETS

D-91-202-24

FOR INDEX OF SHEETS, SEE SHEET NO. 2

PROPOSED HIGHWAY PLANS

VARIOUS ROUTES
VARIOUS LOCATIONS
SECTION: 2024-974-TR
TREE REMOVAL
COOK AND WILL COUNTY

C-91-250-24

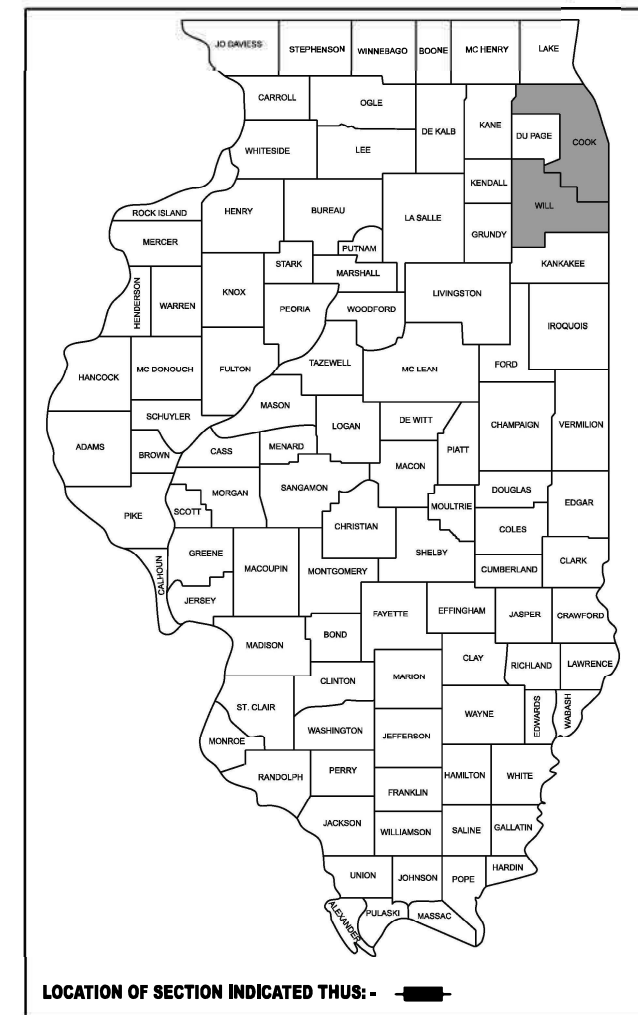

PROJECT IS LOCATED AT VARIOUS LOCATIONS WITHIN COOK AND WILL COUNTIES

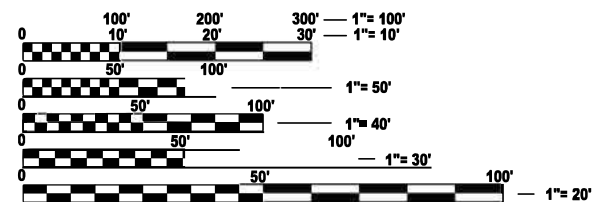

FULL SIZE PLANS HAVE BEEN PREPARED USING STANDARD ENGINEERING SCALES. REDUCED SIZED PLANS WILL NOT CONFORM TO STANDARD SCALES. IN MAKING MEASUREMENTS ON REDUCED PLANS, THE ABOVE SCALES MAY BE USED.

J.U.L.I.E.
JOINT UTILITY LOCATION INFORMATION FOR EXCAVATION
1-800-892-0123
OR 811

VARIOUS LOCATIONS
SEE LOCATION MAP FOR
EXACT LOCATIONS

PROJECT ENGINEER: LUKASZ POCIECHA (847) 705-4255
PROJECT MANAGER: VESELIN VELICHKOV

CONTRACT NO. 62W94

STATE OF ILLINOIS
DEPARTMENT OF TRANSPORTATION

SUBMITTED July 9th 2024
[Signature]
REGIONAL ENGINEER

August 16, 2024
[Signature]
ENGINEER OF DESIGN AND ENVIRONMENT

August 16, 2024
[Signature]
DIRECTOR OF HIGHWAYS PROJECT IMPLEMENTATION

PRINTED BY THE AUTHORITY
OF THE STATE OF ILLINOIS

INDEX OF SHEETS

STATE STANDARDS

GENERAL NOTES

SHEET NO.	DESCRIPTION
1	COVER SHEET
2	INDEX OF SHEETS, STATE STANDARDS, AND GENERAL NOTES
3	SUMMARY OF QUANTITIES
4-8	PROJECT LOCATION MAPS
9	TREE REMOVAL SCHEDULE
10-13	I-80 TREE REMOVAL PLANS
14	IL 68 TREE REMOVAL PLANS
15-16	55TH ST TREE REMOVAL PLANS
17-21	PERSHING RD TREE REMOVAL PLANS
22-70	IL 53 TREE REMOVAL PLANS
71-72	DEVON AVE TREE REMOVAL PLANS
73-83	IL 171 & 95TH ST TREE REMOVAL PLANS
83A	FRANCIS RD OVER I-80 TREE REMOVAL PLANS
84	ENTRANCE AND EXIT RAMP CLOSURE DETAILS (TC-08)
85	TRAFFIC CONTROL AND PROTECTION FOR SIDE ROADS, INTERSECTIONS AND DRIVEWAYS (TC-10)
86	TRAFFIC CONTROL AND PROTECTION AT TURN BAYS (TC-14)
87	TRAFFIC CONTROL DEVICES FOR FREEWAY SHOULDER CLOSURES AND PARTIAL RAMP CLOSURES (TC-17)
88	ARTERIAL ROAD INFORMATION SIGN (TC-22)

STANDARD NO.	DESCRIPTION
000001-08	STANDARD SYMBOLS, ABBREVIATIONS, AND PATTERNS
701001-02	OFF-ROAD OPERATIONS, 2L, 2W, MORE THAN 15' (4.5 m) AWAY
701006-05	OFF-ROAD OPERATIONS, 2L, 2W, 15' (4.5M) TO 24" (600MM) FROM PAVEMENT EDGE
701011-04	OFF-RD MOVING OPERATIONS, 2L, 2W, DAY ONLY
701101-05	OFF-ROAD OPERATIONS, MULTILANE, 15' (4.5m) TO 24" (600mm) FROM PAVEMENT EDGE
701106-02	OFF-ROAD OPERATIONS, MULTILANE, MORE THAN 15' (4.5m) AWAY
701201-05	LANE CLOSURE, 2L, 2W, DAY ONLY FOR SPEEDS GREATER THAN OR EQUAL TO 45 MPH
701301-04	LANE CLOSURE, 2L, 2W, SHORT TERM OPERATIONS
701306-04	LANE CLOSURE, 2L, 2W, SLOW MOVING OPERATIONS DAY ONLY, FOR SPEEDS > 45 MPH
701311-03	LANE CLOSURE, 2L, 2W, SLOW MOVING OPERATIONS DAY ONLY
701336-07	LANE CLOSURE, 2L, 2W, WORK AREA IN SERIES, FOR SPEEDS GREATER THAN OR EQUAL TO 45 MPH
701426-09	LANE CLOSURE, MULTILANE, INTERMITTENT OR MOVING OPERATION, FOR SPEEDS GREATER THAN OR EQUAL TO 45 MPH
701427-05	LANE CLOSURE, MULTILANE, INTERMITTENT OR MOVING OPERATION, FOR SPEEDS LESS THAN OR EQUAL TO 40 MPH
701501-06	URBAN LANE CLOSURE, 2L, 2W, UNDIVIDED
701502-09	URBAN LANE CLOSURE, 2L, 2W, BI-DIRECTIONAL LEFT TURN LANE
701601-09	URBAN LANE CLOSURE, MULTILANE, 1W OR 2W WITH NON-TRAVERSABLE MEDIAN
701602-10	URBAN SINGLE LANE CLOSURE, MULTILANE, 2W WITH BIDIRECTIONAL LEFT TURN LANE
701606-10	URBAN SINGLE LANE CLOSURE, MULTILANE, 2W WITH MOUNTABLE MEDIAN
701701-10	URBAN LANE CLOSURE, MULTILANE INTERSECTION
701901-09	TRAFFIC CONTROL DEVICES

- ALL ELEVATIONS IN THE PLANS ARE BASED UPON THE NORTH AMERICAN VERTICAL DATUM OF 1988 (NAVD88), UNLESS OTHERWISE NOTED.
- BEFORE STARTING ANY EXCAVATION, THE CONTRACTOR SHALL CALL "JULIE AT (800) 892-0123 OR 811 FOR FIELD LOCATIONS OF BURIED ELECTRIC, TELEPHONE AND GAS FACILITIES, (48 HOURS NOTIFICATION IS REQUIRED).
- THE CONTRACTOR SHALL CONTACT THE DISTRICT TRAFFIC CONTROL SUPERVISOR AT KALPANA.KANNAN-HOSADURGA@ILLINOIS.GOV A MINIMUM OF 72 HOURS IN ADVANCE OF BEGINNING WORK.
- THE CONTRACTOR MUST CALL THE IDOT ELECTRICAL MAINTENANCE CONTRACTOR TO LOCATE IDOT FACILITY CABLES
- THE CONTRACTOR WILL NOT BE ALLOWED TO SET UP A YARD OR FIELD OFFICE ON STATE PROPERTY WITHOUT WRITTEN PERMISSION FROM THE DEPARTMENT.
- THE CONTRACTOR SHALL BE REQUIRED TO PROVIDE ACCESS TO ADJUTING PROPERTY AT ALL TIMES DURING THE CONSTRUCTION OF THIS PROJECT.
- EXCEPT WHERE DESIGNATED OTHERWISE, THE LOCATIONS AND/OR DEPTHS OF UNDERGROUND UTILITIES SHOWN HAVE BEEN TAKEN FROM OFFICE RECORD INFORMATION FURNISHED BY THE UTILITY OWNERS AND THE SUE SURVEYS. ALL UNDERGROUND UTILITIES MUST BE CONSIDERED APPROXIMATE. THE CONTRACTOR SHALL BE RESPONSIBLE FOR THE PROTECTION OF ALL UNDERGROUND OR SURFACE UTILITIES EVEN THOUGH THEY MAY NOT BE SHOWN IN THE PLANS. ANY UTILITY THAT IS DAMAGED DURING CONSTRUCTION SHALL BE REPAIRED OR REPLACED TO THE SATISFACTION OF THE ENGINEER. THIS WORK SHALL BE AT THE CONTRACTOR'S EXPENSE.
- THE CONSTRUCTION LIMITS WILL BE STAKED BY THE CONTRACTOR AND APPROVED BY THE ENGINEER PRIOR TO COMMENCING CONSTRUCTION. THE CONSTRUCTION LIMITS MAY BE ADJUSTED BY THE ENGINEER TO PRESERVE TREES AND NO ADDITIONAL COMPENSATION WILL BE PAID TO THE CONTRACTOR FOR CHANGES IN CONSTRUCTION LIMITS.
- DURING CONSTRUCTION OPERATIONS, WHEN ANY LOOSE MATERIAL IS DEPOSITED IN THE FLOW LINE OF DITCHES, GUTTERS, OR DRAINAGE STRUCTURES SO THAT THE NATURAL FLOW OF WATER IS OBSTRUCTED, THE MATERIAL SHALL BE REMOVED AT THE CLOSE OF EACH WORKING DAY. THIS WORK SHALL BE INCLUDED IN THE COST OF TREE REMOVAL.
- THE CONTRACTOR SHALL OBSERVE AND COMPLY WITH ALL SECTIONS OF THE ILLINOIS CUSTOM SPRAY LAW, INCLUDING LICENSING. CONTRACTOR PERSONNEL APPLYING HERBICIDES SHALL HAVE A VALID PESTICIDE APPLICATOR LICENSE ISSUED BY THE ILLINOIS DEPARTMENT OF AGRICULTURE. THE LICENSED PESTICIDE APPLICATOR SHALL SUBMIT THEIR CURRENT LICENSE TO THE ENGINEER. THE LICENSED PESTICIDE APPLICATOR SHALL BE QUALIFIED AT A MINIMUM IN RIGHT-OF-WAY AND AQUATICS. THE LICENSED APPLICATOR SHALL WORK ON-SITE.
- DO NOT SCALE PLANS FOR CONSTRUCTION DIMENSIONS.
- THE NORTHERN LONG EARED BAT (NLEB) HAS BEEN RECLASSIFIED AS AN ENDANGERED SPECIES UNDER THE ENDANGERED SPECIES ACT BY THE U.S. FISH AND WILDLIFE SERVICE (USFWS). TO AVOID AND MINIMIZE IMPACTS TO THE NLEB AND ITS HABITAT, DISTRICT ONE HAS IMPLEMENTED TIME RESTRICTIONS FOR ALL TREE REMOVAL AND FORESTRY WORK. THIS WORK SHALL NOT OCCUR FROM APRIL 1 TO OCTOBER 31 OF ANY GIVEN YEAR THROUGHOUT DISTRICT ONE.
- A TREE GROWTH FACTOR HAS BEEN ADDED TO THE TOTAL QUANTITY OF "UNIT" ITEMS TO ACCOUNT FOR TREE GROWTH BETWEEN THE INITIAL TREE SURVEY AND THE REMOVAL OF THE TREE.
- ALL LAYOUT OF ROW/TEMPORARY/PERMANENT EASEMENT AND TEMPORARY FENCING AND TREE PRUNING SHALL BE COMPLETED BEFORE TREE REMOVAL OPERATIONS COMMENCE IN ANY AREA.
- THE CONTRACTOR SHALL TAKE PRECAUTION BY PRESERVING EXISTING TREES WITHIN THE RIGHT OF WAY. IF ANY DAMAGE OCCURS, TREES SHALL BE REPLACED IN KIND PER ARTICLE 201.07 REPAIR OR REPLACEMENT OF EXISTING PLANT MATERIAL REQUIREMENTS STATED HEREIN.
- THE CONTRACTOR SHALL TAKE EXTRA CARE IN GRADING AND EXCAVATING NEAR TREES WHICH ARE NOT MARKED FOR REMOVAL SO AS NOT TO CAUSE INJURY TO THE ROOT SYSTEM OR TRUNKS. ANY DAMAGE DONE TO EXISTING ITEMS BY THE CONTRACTOR SHALL BE REPAIRED BY THE CONTRACTOR AT THE CONTRACTOR'S OWN EXPENSE.

88A IL 171 TREE REMOVAL PLANS
 88 B-D IL 64 TREE REMOVAL PLANS

MODEL: GenNotesSheet [Sheet]
 FILE NAME: c:\pw\work\pavstatcom\nor.mullane@illinois.gov\10034320120224-sh-gemnote.dgn

USER NAME = connor.mullane	DESIGNED -	REVISED - CM 8/29/2024
	DRAWN -	REVISED -
PLOT SCALE = 0.16666633' / in.	CHECKED -	REVISED -
PLOT DATE = 8/7/2024	DATE -	REVISED -

STATE OF ILLINOIS
 DEPARTMENT OF TRANSPORTATION

TREE REMOVAL
 INDEX OF SHEETS, STATE STANDARDS AND GENERAL NOTES

SCALE: SHEET OF 1 SHEETS STA. TO STA.

FA RTE.	SECTION	COUNTY	TOTAL SHEETS	SHEET NO.
VAR	2024-974-TR	*	88	2
CONTRACT NO. 62W94				
ILLINOIS FED. AID PROJECT				

REVISED SHEET 9/3/2024

SUMMARY OF QUANTITIES			100% STATE 0031	
Code No.	Item	Unit	Total Quantity	
20100110	TREE REMOVAL (6 TO 15 UNITS DIAMETER)	UNIT	5365	5365
20100210	TREE REMOVAL (OVER 15 UNITS DIAMETER)	UNIT	2125	2125
20100500	TREE REMOVAL, ACRES	ACRE	10.09	10.09
20101000	TEMPORARY FENCE	FOOT	1213	1213
67100100	MOBILIZATION	L SUM	1	1
70100450	TRAFFIC CONTROL AND PROTECTION, STANDARD 701201	L SUM	1	1
70100460	TRAFFIC CONTROL AND PROTECTION, STANDARD 701306	L SUM	1	1
70100600	TRAFFIC CONTROL AND PROTECTION, STANDARD 701336	L SUM	1	1
70102620	TRAFFIC CONTROL AND PROTECTION, STANDARD 701501	L SUM	1	1
70102622	TRAFFIC CONTROL AND PROTECTION, STANDARD 701502	L SUM	1	1
70102625	TRAFFIC CONTROL AND PROTECTION, STANDARD 701606	L SUM	1	1
70102630	TRAFFIC CONTROL AND PROTECTION, STANDARD 701601	L SUM	1	1
70102632	TRAFFIC CONTROL AND PROTECTION, STANDARD 701602	L SUM	1	1
70102635	TRAFFIC CONTROL AND PROTECTION, STANDARD 701701	L SUM	1	1
X2010106	TREE REMOVAL (UNDER 6 UNITS DIAMETER)	UNIT	22	22
X2010310	TREE REMOVAL (SPECIAL)	UNIT	2	2
X2010350	TREE REMOVAL, ACRES (SPECIAL)	ACRE	13.5	13.5
20101300	TREE PRUNING (1 TO 10 INCH DIAMETER)	EACH	52	52
20101350	TREE PRUNING (OVER 10 INCH DIAMETER)	EACH	38	38



SUMMARY OF QUANTITIES			100% STATE 0031	
Code No.	Item	Unit	Total Quantity	
X6700407	ENGINEER'S FIELD OFFICE, TYPE A (D1)	CAL MO	6	6
X7011015	TRAFFIC CONTROL AND PROTECTION (EXPRESSWAYS)	L SUM	1	1
Z0013798	CONSTRUCTION LAYOUT	L SUM	1	1
Z0030850	TEMPORARY INFORMATION SIGNING	SQ FT	102.8	102.8
X2010516	SELECTIVE CLEARING	UNIT	156	156

MODEL: SOQ01 [Sheet]
 FILE NAME: c:\pw_work\pavido\connor.mullane\1003432\120224-shs-SOQ.dgn

USER NAME = connor.mullane	DESIGNED -	REVISED -
PLOT SCALE = 0.16666633' / in.	DRAWN -	REVISED -
PLOT DATE = 7/11/2024	CHECKED -	REVISED -
	DATE -	REVISED -

STATE OF ILLINOIS
DEPARTMENT OF TRANSPORTATION

TREE REMOVAL
SUMMARY OF QUANTITIES

SCALE: SHEET OF 1 SHEETS STA. TO STA.

F.A. RTE.	SECTION	COUNTY	TOTAL SHEETS	SHEET NO.
VAR	2024-974-TR	*	88	3
CONTRACT NO. 62W94			ILLINOIS FED. AID PROJECT	

REVISED SHEET 9/3/2024

PROJECT LOCATION



**IL 68 OVER SALT CREEK
VILLAGE OF PALATINE
COOK COUNTY
(LOCATION 2)**

PROJECT LOCATION

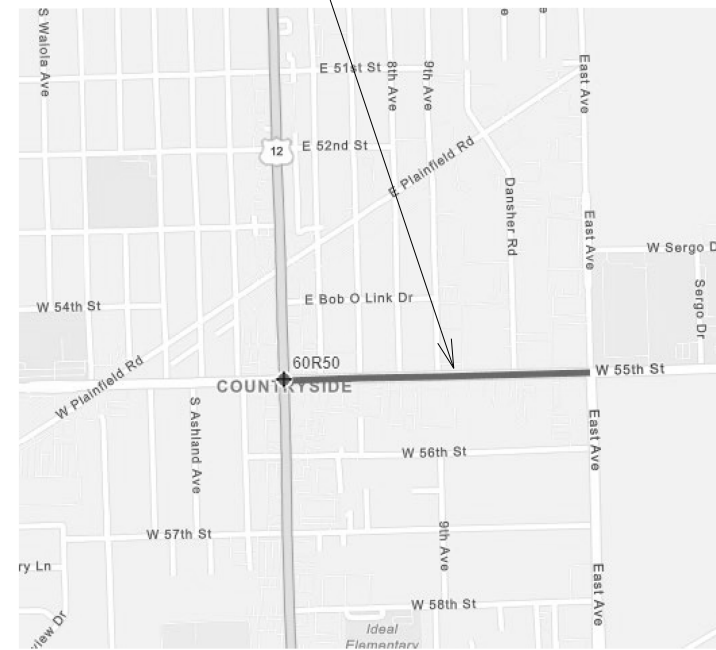

**55TH ST FROM LA GRANGE RD TO 47TH ST
VILLAGE OF COUNTRYSIDE
COOK COUNTY
(LOCATION 3)**

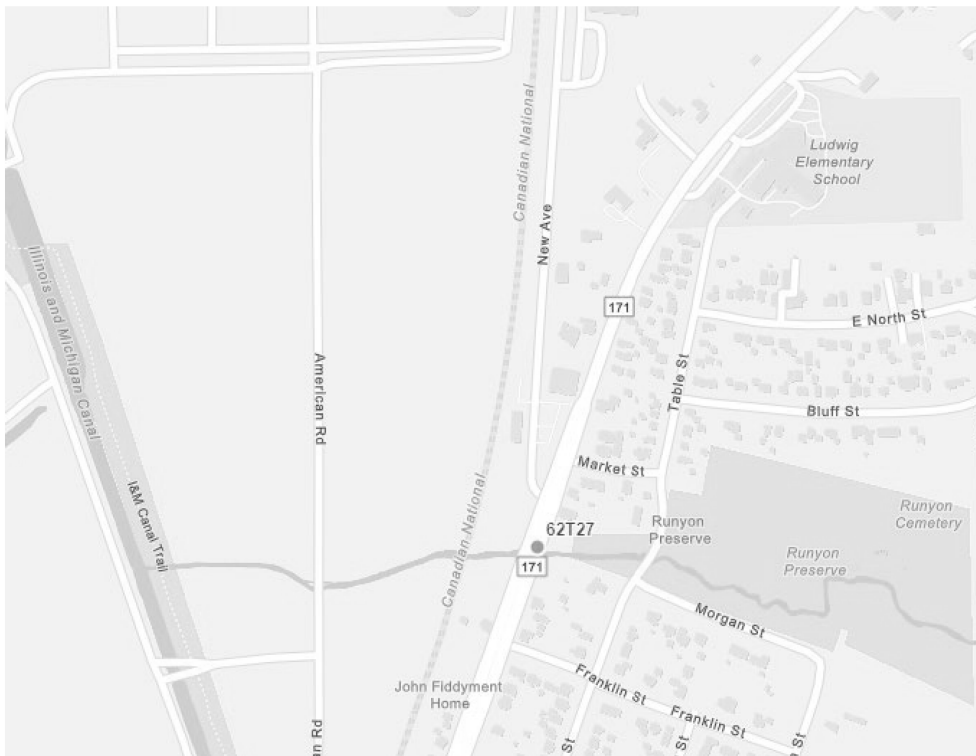

**IL 171 AT FIDDYMENT CREEK
VILLAGE OF LOCKPORT
WILL COUNTY
(LOCATION 9)**



**IL 64 FROM 25TH AVE TO 5TH AVE
VILLAGES OF ELMWOOD PARK, MELROSE PARK,
NORTHLAKE, RIVER FOREST, RIVER GROVE
COOK COUNTY
(LOCATION 10)**



MODEL: IL 68 AND 55TH ST (Sheet)
FILE NAME: c:\p\work\pav\il\concor.mullane\1003433\120224-shh-location.mxd

USER NAME =	connor.mullane	DESIGNED -		REVISED -	
		DRAWN -		REVISED -	
		CHECKED -		REVISED -	
PLOT DATE =	8/29/2024	DATE -		REVISED -	

**STATE OF ILLINOIS
DEPARTMENT OF TRANSPORTATION**

PROJECT LOCATION MAP

SCALE: SHEET OF 5 SHEETS STA. TO STA.

REVISED ENTIRE SHEET 9/3/2024

F.A. RTE.	SECTION	COUNTY	TOTAL SHEETS	SHEET NO.
VAR	2024-974-TR	*	88	5
			CONTRACT NO. 62W94	
			ILLINOIS FED. AID PROJECT	

COOK WILL



LOCATION	PAY ITEM	I-80 OVER RAMP B/BNSF/UP/GA RDNER, JOLIET (LOCATION 1)	IL 68 OVER SALT CREEK (LOCATION 2)	55TH STREET FROM LA GRANGE RD TO EAST AVE (LOCATION 3)	PERSHING RD FROM ASHLAND TO WENTWORTH (LOCATION 4)	IL 53 FROM I-90 TO LAKE COOK RD (LOCATION 5)	DEVON AVE FROM KILPATRICK TO LINCOLN (LOCATION 6)	IL 171 & 95TH ST (LOCATION 7)	FRANCIS RD OVER I-80 (LOCATION 8)	IL 171 AT FIDDYMENT CREEK (LOCATION 9)	IL 64 FROM 25TH AVE TO 5TH AVE (LOCATION 10)	TOTAL WITHOUT TREE GROWTH FACTOR	TREE GROWTH FACTOR	TOTAL WITH TREE GROWTH FACTOR	UNIT
		WILL	COOK	COOK	COOK	COOK	COOK	COOK	COOK	WILL	WILL				
ORIGINAL CONTRACT NO		62F94	62R73	60R50	62K61	62N91, 62W38	62L58	60R94	62U39	62T27	62J79				
TREE REMOVAL (6 TO 15 UNITS DIAMETER)	20100110	0	220	39	790	284	12	3298	0	24	210	4877	1.1	5365	UNITS
TREE REMOVAL (OVER 15 UNITS DIAMETER)	20100210	0	32	173	75	137	18	1496	0	0	0	1931	1.1	2125	UNITS
TREE REMOVAL, ACRES	20100500	4.09	0	0	0	6	0	0	0	0	0	10.09	1	10.09	ACRES
TEMPORARY FENCE	20101000	0	0	0	0	0	0	1213	0	0	0	1213	1	1213	FOOT
TREE PRUNING (1 to 10 INCH DIAMETER)	20101300	0	0	0	0	0	0	412	0	0	0	412	1	412	EACH
TREE PRUNING (OVER 10 INCH DIAMETER)	20101350	0	0	0	0	0	0	591	0	0	0	591	1	591	EACH
TREE REMOVAL (UNDER 6 UNITS DIAMETER)	X2010106	0	0	20	0	0	0	0	0	0	0	20	1.1	22	UNITS
TREE REMOVAL (SPECIAL)	X2010310	0	0	0	0	2	0	0	0	0	0	2	1	2	UNITS
TREE REMOVAL , ACRES (SPECIAL)	X2010350	0	0	0	0	12	0	1.5	0	0	0	13.5	1	13.5	ACRES
SELECTIVE CLEARING (UNITS)	Z0064800	0	0	0	0	137	0	0	4.3	0	0	141.3	1.1	156	UNITS

MODEL: Schedule01 (Sheet)
FILE NAME: c:\p\work\work\connor.mullane@illinois.gov\1003432\120224-shr-schedule.dgn

REVISD ENTIRE SHEET 9/3/2024

USER NAME = connor.mullane	DESIGNED -	REVISED - CM 8/29/2024
	DRAWN -	REVISED -
PLOT SCALE = 0.16666833' / in.	CHECKED -	REVISED -
PLOT DATE = 8/7/2024	DATE -	REVISED -

STATE OF ILLINOIS
DEPARTMENT OF TRANSPORTATION

TREE REMOVAL PLAN
SCHEDULE OF QUANTITIES

SCALE: SHEET OF 1 SHEETS STA. TO STA.

F.A. RTE.	SECTION	COUNTY	TOTAL SHEETS	SHEET NO.
VAR	2024-974-TR	*	88	9
CONTRACT NO. 62W94			ILLINOIS FED. AID PROJECT	

COOK WILL

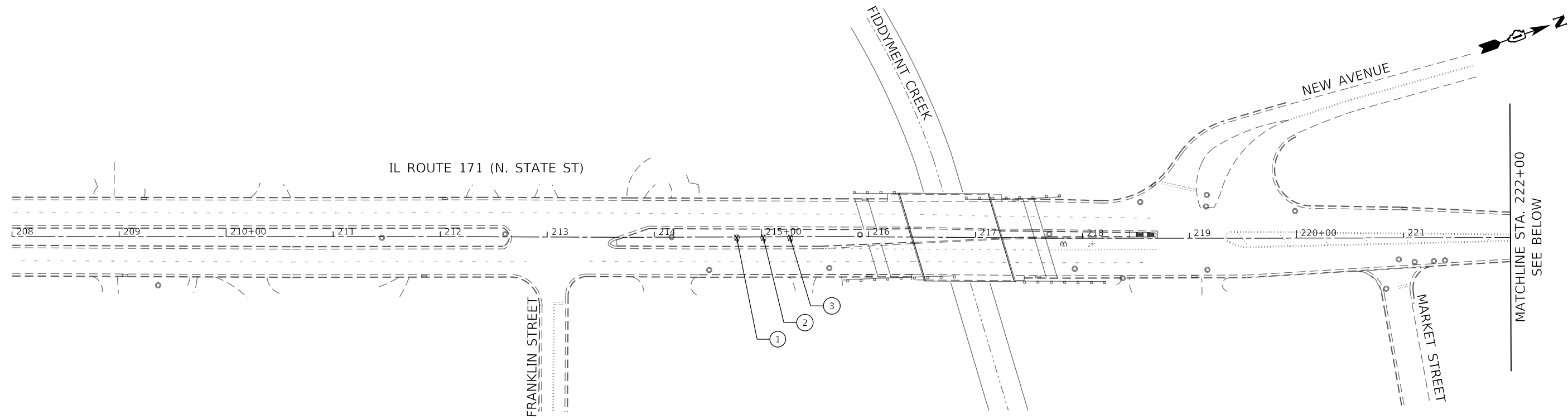

TREE #	STATION	OFFSET	201001100 - TREE REMOVAL (6 TO 15 UNITS DIAMETER)
1	214+77	0.75' RT	8
2	215+02	0.87' RT	8
3	215+27	1.00' RT	8
TOTAL			24

LEGEND
X TREE REMOVAL

NOTES

- THE CONTRACTOR SHALL VERIFY ALL DIMENSIONS AND CONDITIONS OF THE EXISTING TREES IN FIELD PRIOR TO BEGINNING CONSTRUCTION. VERIFICATION SHALL INCLUDE EXACT STATIONS, OFFSETS, AND DIAMTER OF THE EXISTING TREES.

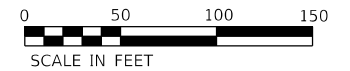

DATE SIGNED: 08/28/2024
EXP. DATE: 11/30/2025

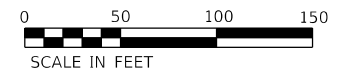

REVISOR: [Symbol] REVISED ENTIRE SHEET 6/10/2024



USER NAME = default	DESIGNED -	REVISOR - [Symbol] 08/27/2024
PLOT SCALE = 100.0000' / In.	DRAWN -	REVISOR -
PLOT DATE = 8/27/2024	CHECKED -	REVISOR -
	DATE -	REVISOR -

STATE OF ILLINOIS
DEPARTMENT OF TRANSPORTATION

IL 171 (LOCATION 9)
TREE REMOVAL PLAN

SCALE: 1" = 50' SHEET OF SHEETS STA. TO STA.

F.A. RTE.	SECTION	COUNTY	TOTAL SHEETS	SHEET NO.
VAR	2024-974-TR	+	88	88A
CONTRACT NO. 62W94			ILLINOIS FED. AID PROJECT	

IL. RTE. 64
(NORTH AVE.)

25th AVE.

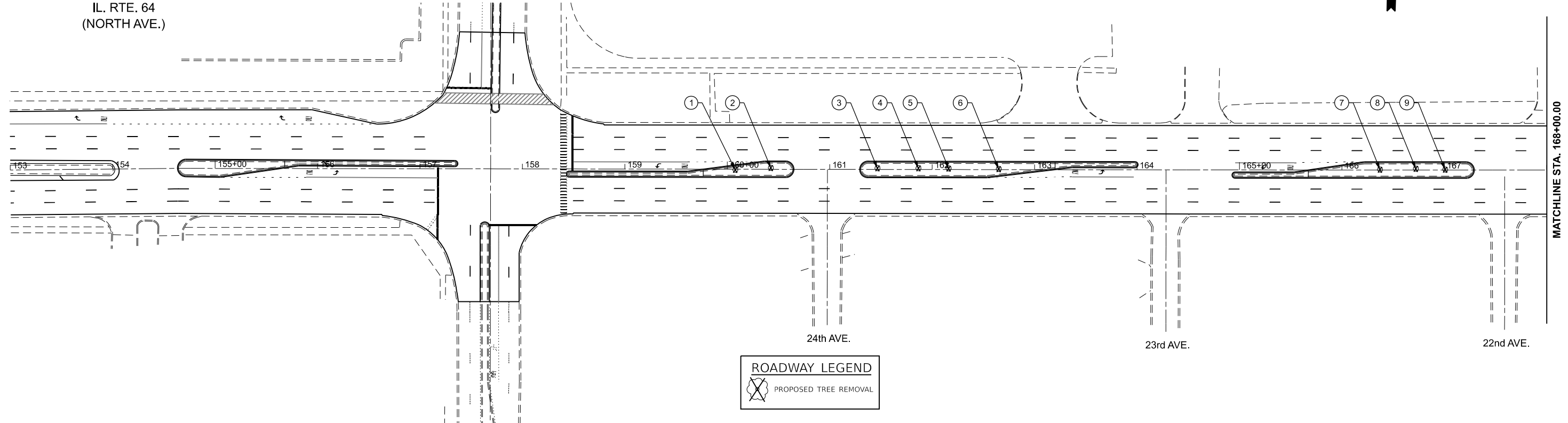

MATCHLINE STA. 168+00.00

ROADWAY LEGEND

PROPOSED TREE REMOVAL

IL. RTE. 64
(NORTH AVE.)

JEWELS DR.

N. 19th AVE.

N. 18th AVE.

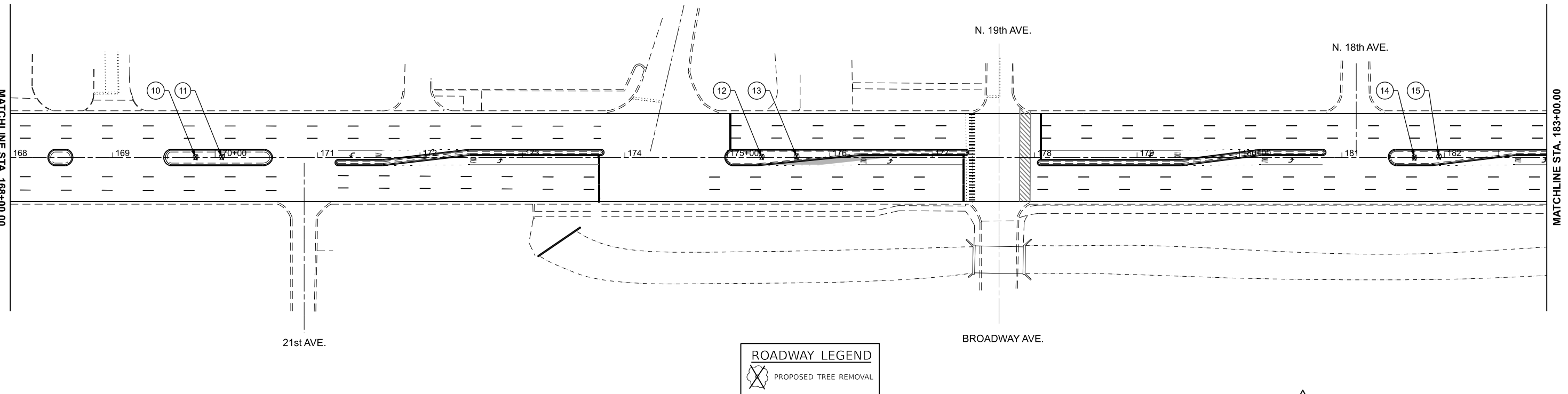

MATCHLINE STA. 168+00.00

MATCHLINE STA. 183+00.00

ROADWAY LEGEND

PROPOSED TREE REMOVAL

ADDED ENTIRE SHEET 9/3/2024

MODEL: IL 64_E_IL 64 Tree Removal (Sheet)
FILE NAME: c:\pwworking\infobas.babul@illinois.gov\d0860062\D124320-sh-plan.dgn

USER NAME = nicholas.babul	DESIGNED -	REVISED - CM 8/29/2024
	DRAWN -	REVISED -
	CHECKED -	REVISED -
PLOT DATE = 8/29/2024	DATE -	REVISED -

**STATE OF ILLINOIS
DEPARTMENT OF TRANSPORTATION**

**IL ROUTE 64 (NORTH AVE.) (LOCATION 10)
TREE REMOVAL**

SCALE: 1"=50' SHEET OF SHEETS STA. 153+00.00 TO STA. 183+00.00

F.A. RTE.	SECTION	COUNTY	TOTAL SHEETS	SHEET NO.
VAR	2024 974 TR	WILL, COOK	88	88B
CONTRACT NO. 62W94				
ILLINOIS FED. AID PROJECT				

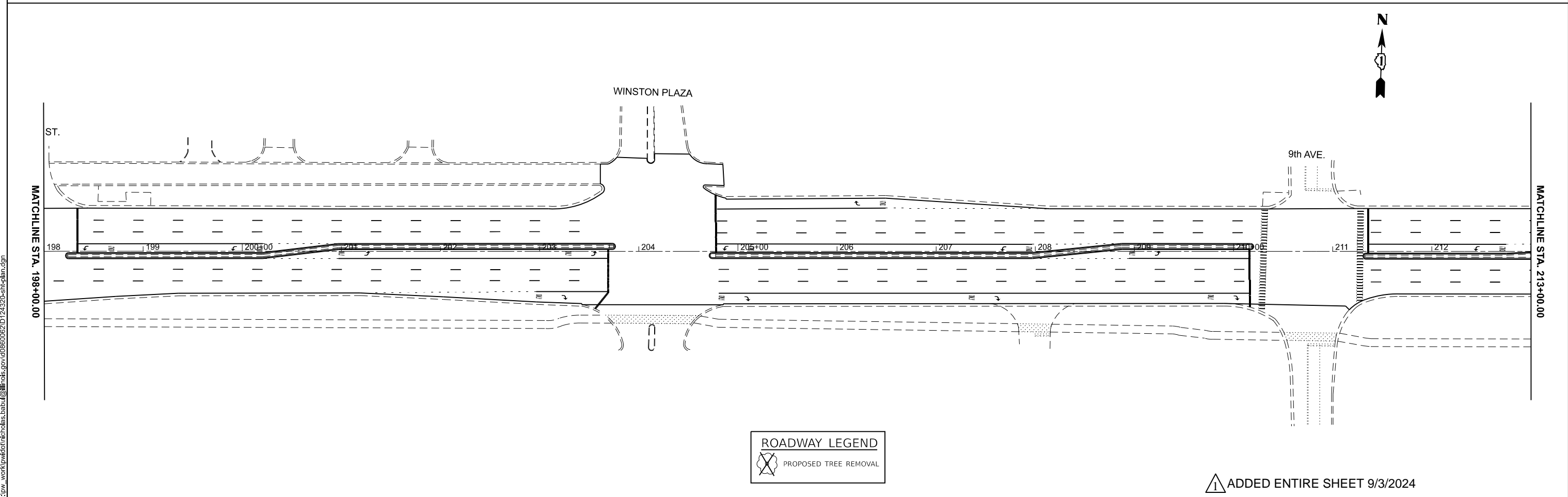
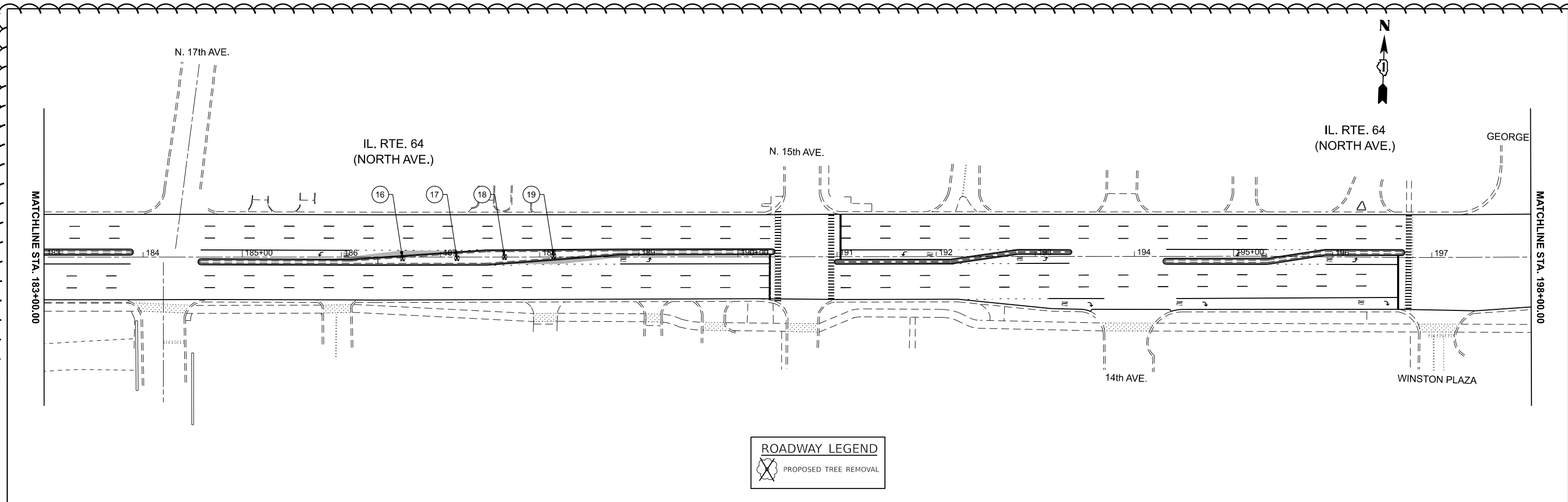

ADDED ENTIRE SHEET 9/3/2024

MODEL: IL 64_E_IL 64 Tree Removal_2 (Sheet)
 FILE NAME: c:\pwworking\infobas.babul@illinois.gov\d086062D124320-sh-plan.dgn

USER NAME = nicholas.babul	DESIGNED -	REVISED - CM 8/29/2024
	DRAWN -	REVISED -
	CHECKED -	REVISED -
PLOT DATE = 8/29/2024	DATE -	REVISED -

STATE OF ILLINOIS
 DEPARTMENT OF TRANSPORTATION

IL ROUTE 64 (NORTH AVE.) (LOCATION 10)
 TREE REMOVAL

SCALE: 1"=50' SHEET OF SHEETS STA. 183+00.00 TO STA. 213+00.00

F.A. RTE.	SECTION	COUNTY	TOTAL SHEETS	SHEET NO.
VAR	2024 974 TR	WILL, COOK	88	88C
CONTRACT NO. 62W94			ILLINOIS FED. AID PROJECT	

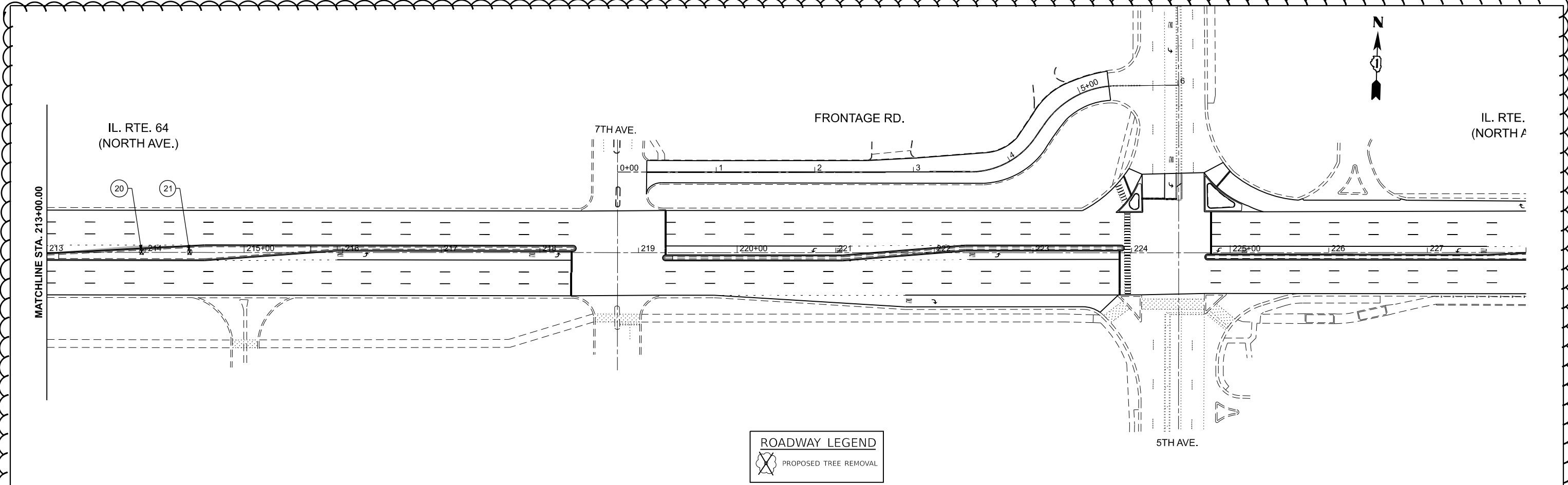

TREE #	STATION	OFFSET	20100110 - TREE REMOVAL (6 TO 15 UNITS DIAMETER)
1	160+07	MEDIAN	10
2	160+43	MEDIAN	10
3	161+47	MEDIAN	10
4	161+87	MEDIAN	10
5	162+16	MEDIAN	10
6	162+65	MEDIAN	10
7	166+37	MEDIAN	10
8	166+72	MEDIAN	10
9	167+01	MEDIAN	10
10	169+81	MEDIAN	10
11	170+07	MEDIAN	10
12	175+34	MEDIAN	10
13	175+68	MEDIAN	10
14	181+71	MEDIAN	10
15	181+95	MEDIAN	10
16	186+62	MEDIAN	10
17	187+17	MEDIAN	10
18	187+65	MEDIAN	10
19	188+14	MEDIAN	10
20	213+96	MEDIAN	10
21	214+45	MEDIAN	10

1

M:\04 - E-M 64 (see memo 4/17/24) \work\pawford\nicholas.babul\@illinois.gov\060062\012320-sr-plan.dgn
 FILE NAME: c:\paw\work\pawford\nicholas.babul\@illinois.gov\060062\012320-sr-plan.dgn

ADDED ENTIRE SHEET 9/3/2024

USER NAME = nicholas.babul	DESIGNED -	REVISED - CM 8/29/2024
	DRAWN -	REVISED -
	CHECKED -	REVISED -
PLOT DATE = 8/29/2024	DATE -	REVISED -

**STATE OF ILLINOIS
DEPARTMENT OF TRANSPORTATION**

**IL ROUTE 64 (NORTH AVE.) (LOCATION 10)
TREE REMOVAL**

SCALE: 1"=50' SHEET OF SHEETS STA. 213+00.00 TO STA. 228+00.00

F.A. RTE.	SECTION	COUNTY	TOTAL SHEETS	SHEET NO.
VAR	2024 974 TR	WILL, COOK	88	88D
CONTRACT NO. 62W94				

ILLINOIS FED. AID PROJECT