

STATE OF ILLINOIS  
DEPARTMENT OF TRANSPORTATION

F.A.P. RTE.	SECTION	COUNTY	TOTAL SHEETS	SHEET NO.
607	(125,126)RS-4	-	22	1
*LASALLE & KENDALL		ILLINOIS	CONTRACT NO. 66P11	

000001-08	STANDARD SYMBOLS, ABBREVIATIONS AND PATTERNS
001006	DECIMAL OF AN INCH AND OF A FOOT
406201-01	MAILBOX TURNOUT
701001-02	OFF-ROAD OPERATIONS 2L, 2W, MORE THAN 15' AWAY
701006-05	OFF-ROAD OPERATIONS 2L, 2W, 15' TO 24" FROM PAVEMENT EDGE
701011-04	OFF-ROAD MOVING OPERATIONS 2L, 2W, DAY ONLY
701301-04	LANE CLOSURE, 2L, 2W, SHORT TIME OPERATIONS
701306-04	LANE CLOSURE, 2L, 2W, SLOW MOVING OPERATIONS DAY ONLY 45 MPH OR MORE
701311-03	LANE CLOSURE, 2L, 2W, MOVING OPERATIONS - DAY ONLY
701901-09	TRAFFIC CONTROL DEVICES
720011-01	METAL POSTS FOR SIGNS, MARKERS AND DELINEATORS
729001-01	APPLICATIONS OF TYPE A AND B METAL POSTS (FOR SIGNS & MARKERS)
731001-01	BASE FOR TELESCOPING STEEL SIGN SUPPORT
780001-05	TYPICAL PAVEMENT MARKINGS
781001-04	TYPICAL APPLICATIONS RAISED REFLECTIVE PAVEMENT MARKERS

# PROPOSED HIGHWAY PLANS

## FAP ROUTE 607 (US-52) SECTION (125,126)RS-4 PROJECT STP-IYCF(963) MILLING & RESURFACING (DESIGNED OVERLAY) LASALLE & KENDALL COUNTY

### INDEX OF SHEETS

- 1 COVER SHEET
- 2 GENERAL NOTES
- 3 LINE DIAGRAM
- 4-6 SUMMARY OF QUANTITIES
- 7-9 TYPICAL SECTIONS
- 10-15 SCHEDULE OF QUANTITIES
- 16-22 DETAILS

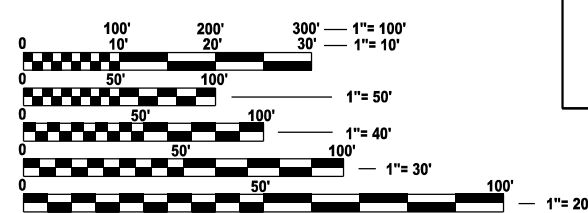
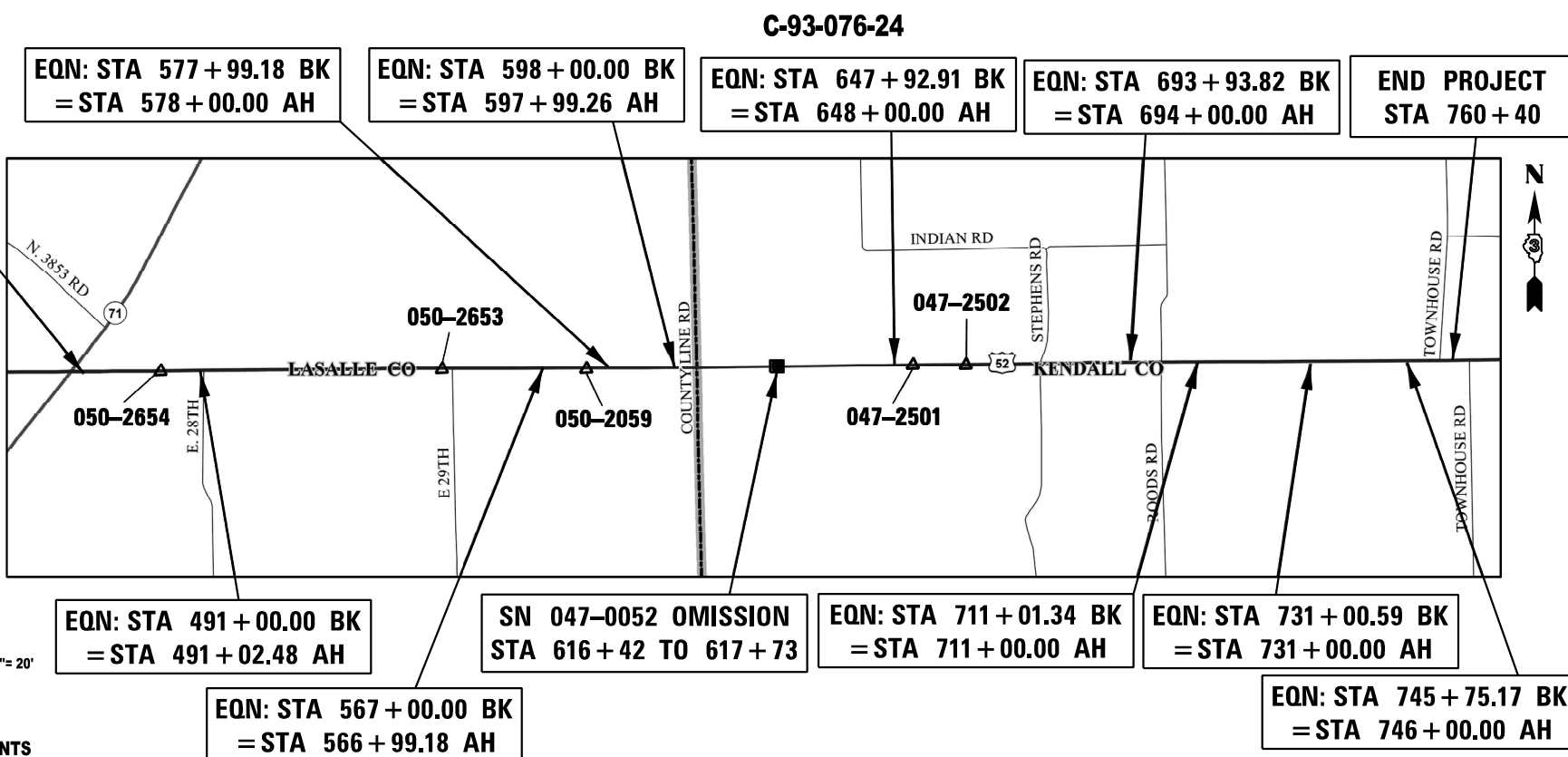
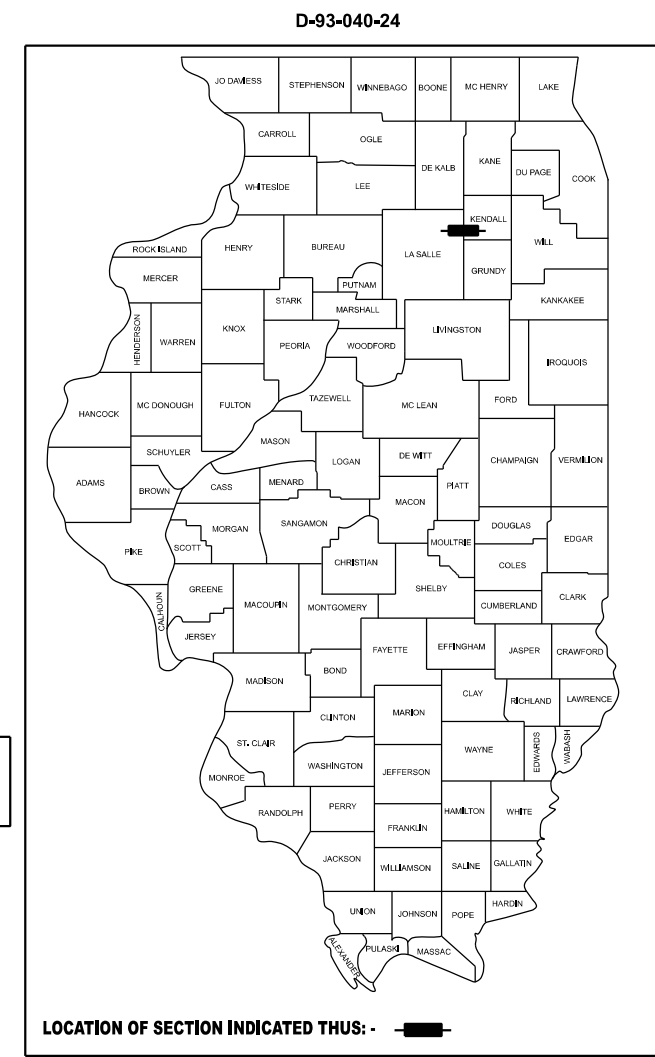

FULL SIZE PLANS HAVE BEEN PREPARED USING STANDARD ENGINEERING SCALES. REDUCED SIZED PLANS WILL NOT CONFORM TO STANDARD SCALES. IN MAKING MEASUREMENTS ON REDUCED PLANS, THE ABOVE SCALES MAY BE USED.

J.U.L.I.E.  
JOINT UTILITY LOCATION INFORMATION FOR EXCAVATION  
1-800-892-0123  
OR 811

PROJECT ENGINEER: JOE KANNEL, P.E.  
UNIT CHEIF: STEPHENIE CARMIN  
DISTRICT 3 NO. (815) 434-6131  
CONTRACT NO. 66P11

GROSS LENGTH = 29586.91 FT. = 5.6 MILE  
NET LENGTH = 29455.91 FT. = 5.58 MILE

FAP 607 (US 52)  
OTHER PRINCIPAL ARTERIAL  
ADT (2021) = 1500  
P.V. = 59.9%  
S.U. = 34.1%  
M.U. = 6.0%

STATE OF ILLINOIS  
DEPARTMENT OF TRANSPORTATION

SUBMITTED July 2, 2024  
*Trisha Thompson*  
REGIONAL ENGINEER

August 16, 2024  
*Scott A. Elk*  
ENGINEER OF DESIGN AND ENVIRONMENT

August 16, 2024  
*James J. Gu*  
DIRECTOR OF HIGHWAYS PROJECT IMPLEMENTATION

PRINTED BY THE AUTHORITY  
OF THE STATE OF ILLINOIS

**GENERAL NOTES**

THE HMA SURFACE OF ALL MAILBOX TURNOUTS, PRIVATE ENTRANCES, COMMERCIAL ENTRANCES, AND SIDE ROADS SHALL BE MADE NEATLY, IN A WORKMANLIKE MANNER, AND SHALL ACCURATELY CONFORM TO THE SHAPES AND DIMENSIONS SHOWN ON THE PLAN DETAILS. IF REQUIRED BY THE ENGINEER, THE CONTRACTOR SHALL SAW CUT THE HMA SURFACE TO CONFORM TO THE SHAPES AND DIMENSIONS SHOWN ON THE PLAN DETAILS. THIS WORK WILL BE INCLUDED IN THE COST OF THE HMA SURFACE.

EXCEPT AS NOTED ON THE PLANS, PAVEMENT GRADES SHOWN ARE AT THE TOP OF PAVEMENT SURFACES.

THE ENGINEER WILL BE THE SOLE JUDGE CONCERNING CURING TIME FOR THE VARIOUS HMA LIFTS.

ALL EXCAVATED MATERIAL, WHICH INCLUDES DIGGING OR GRADING OF ANY SOIL OR FILL MATERIAL, WITH THE EXCEPTION OF AGGREGATE FILLS, MUST BE INCORPORATED WITHIN THE !DOT RIGHT OF WAY.

ON EXISTING PAVEMENT WHICH MAY BE SUPERELEVATED, THE NEW HMA PAVEMENT SHALL BE BUILT WITH THE SAME SUPERELEVATION UNLESS NEW SUPERELEVATION RATES ARE GIVEN ON THE PLANS.

ALL ELEVATIONS REFERRING TO U.S.G.S. MEAN SEA LEVEL DATUM.

THE FOLLOWING RATES OF APPLICATION HAVE BEEN USED IN CALCULATING PLAN QUANTITIES:

GRANULAR MATERIALS	2.05	TONS / CU YD
HMA RESURFACING	112	LBS / SQ YD / IN
SHORT TERM PAVEMENT MARKING	10	FT /100 FT OF APPLICATION
MIX FOR CRACKS, JTS & FLGWYS	0.0003	TONS / SQ YD
BINDER (HAND METHOD)	0.0005	TONS / SQ YD

THE CONTRACTOR SHALL CONTACT JULIE AT LEAST 48 HOURS PRIOR TO EXCAVATION TO DETERMINE WHICH UTILITIES ARE IN THE AREA

**COMMITMENTS**

NONE

**HMA MIXTURE REQUIREMENT TABLE**

LOCATIONS:	ENTIRE PROJECT	ENTIRE PROJECT	ENTIRE PROJECT
MIXTURE USE(S):	HMA BINDER	HMA SURFACE	HMA INCIDENTAL
BINDER GRADE (PG):	PG 64-22	PG 64-22	PG 64-22
DESIGN AIR VOIDS:	4.0% @ N50	4.0% @ N50	4.0% @ N50
MIXTURE COMPOSITION: (MIXTURE GRADATION)	IL 19.0	IL 9.5	IL 9.5
FRICTION AGGREGATE:		MIXTURE C	MIXTURE C
MIXTURE WEIGHT:	112.0 LB/SY/IN	112.0 LB/SY/IN	112.0 LB/SY/IN
QUALITY MANAGEMENT PROGRAM:	QCP	QCP	QCQA
SUBLOT SIZE:	1000 TONS	1000 TONS	N/A
DENSITY TEST METHOD:	CORES	CORES	CORES/NUCLEAR
MATERIAL TRANSFER DEVICE (REQUIRED)	YES	YES	NO

MODEL: Default  
FILE NAME: c:\p\work\evision\ferguson\hd0941336\0366P11-Cover.dgn

USER NAME = Joseph.Zagar	DESIGNED -	REVISED -
	DRAWN -	REVISED -
	CHECKED -	REVISED -
PLOT DATE = 7/2/2024	DATE -	REVISED -

**STATE OF ILLINOIS  
DEPARTMENT OF TRANSPORTATION**

**GENERAL NOTES, STANDARDS, & COMMITMENTS**

SCALE: SHEET OF SHEETS STA. TO STA.

F.A.P RTE.	SECTION	COUNTY	TOTAL SHEETS	SHEET NO.
607	(125,126)RS-4	*	22	2
<b>*LASALLE &amp; KENDALL</b>			CONTRACT NO. 66P11	
		ILLINOIS	FED. AID PROJECT	

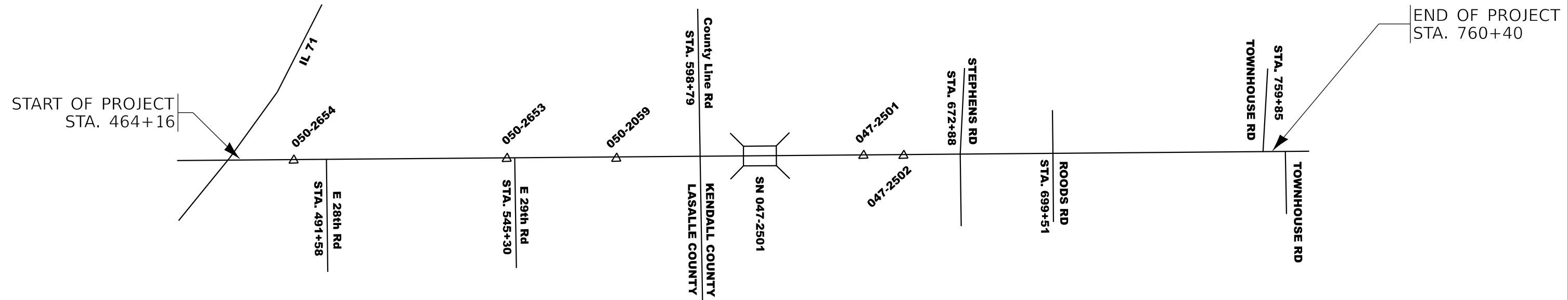

MODEL: Default  
 FILE NAME: c:\p\work\pav\idol\ferguson\p1\0941336\0366P11-Cover.dgn

USER NAME = Joseph.Zagar	DESIGNED -	REVISED -
	DRAWN -	REVISED -
	CHECKED -	REVISED -
PLOT DATE = 7/2/2024	DATE -	REVISED -

**STATE OF ILLINOIS  
 DEPARTMENT OF TRANSPORTATION**

<b>LINE DIAGRAM</b>			
SCALE:	SHEET	OF	SHEETS
	STA.		TO STA.

F.A.P. RTE. 607	SECTION (125,126)RS-4	COUNTY *	TOTAL SHEETS 22	SHEET NO. 3
*LASALLE & KENDALL		CONTRACT NO. 66P11		
ILLINOIS		FED. AID PROJECT		

CODE NO.	ITEM	UNIT	TOTAL QUANTITY	CONSTRUCTION CODE	
				LASALLE CO STP-RUR FAP 607	KENDALL CO STP-RUR FAP 607
				ROADWAY	ROADWAY
				0005	0005
				RURAL	RURAL
20400800	FURNISHED EXCAVATION	CU YD	8	4	4
40200800	AGGREGATE SURFACE COURSE, TYPE B	TON	59	29	30
40600290	BITUMINOUS MATERIALS (TACK COAT)	POUND	57875	25425	32450
40600370	LONGITUDINAL JOINT SEALANT	FOOT	29455	13422	16033
40600400	MIXTURE FOR CRACKS, JOINTS, AND FLANGEWAYS	TON	24	11	13
40600900	HOT-MIX ASPHALT BINDER COURSE (HAND METHOD), N50	TON	39	18	21
40600990	TEMPORARY RAMP	SQ YD	293	125	168
40603080	HOT-MIX ASPHALT BINDER COURSE, IL-19.0, N50	TON	9984	4579	5405
40604050	HOT-MIX ASPHALT SURFACE COURSE, IL-9.5, MIX "C", N50	TON	6656	3052	3604
40800050	INCIDENTAL HOT-MIX ASPHALT SURFACING	TON	598	418	180
44000164	HOT-MIX ASPHALT SURFACE REMOVAL, 3 3/4"	SQ YD	79240	36339	42901
44201053	CLASS B PATCHES, TYPE IV, 17 INCH	SQ YD	80		80
44201055	CLASS B PATCHES, TYPE II, 17 INCH	SQ YD	1253	552	701
44201057	CLASS B PATCHES, TYPE III, 17 INCH	SQ YD	48	32	16

\* SPECIALITY ITEMS

MODEL: D:\hull...  
 FILE NAME: ...  
 C:\Users\jzagar\Documents\DOT Office\District 3\ORD Projects\88P11\CADD\Drawings\88P11-COMPLETE SHEETS

<table border="1"> <tr> <td>USER NAME = Joseph.Zagar</td> <td>DESIGNED -</td> <td>REVISED -</td> </tr> <tr> <td>PLOT SCALE = \$SCALE\$</td> <td>CHECKED -</td> <td>REVISED -</td> </tr> <tr> <td>PLOT DATE = 7/2/2024</td> <td>DATE -</td> <td>REVISED -</td> </tr> </table>	USER NAME = Joseph.Zagar	DESIGNED -	REVISED -	PLOT SCALE = \$SCALE\$	CHECKED -	REVISED -	PLOT DATE = 7/2/2024	DATE -	REVISED -	<b>STATE OF ILLINOIS</b> <b>DEPARTMENT OF TRANSPORTATION</b>	<b>SUMMARY OF QUANTITIES</b>	<table border="1"> <tr> <td>F.A.P. RTE. 607</td> <td>SECTION (125,126)RS-4</td> <td>COUNTY *</td> <td>TOTAL SHEETS 22</td> <td>SHEET NO. 4</td> </tr> <tr> <td colspan="3">LASALLE &amp; KENDALL</td> <td colspan="2">CONTRACT NO. 66P11</td> </tr> <tr> <td colspan="5" style="text-align: right;">ILLINOIS FED. AID PROJECT</td> </tr> </table>	F.A.P. RTE. 607	SECTION (125,126)RS-4	COUNTY *	TOTAL SHEETS 22	SHEET NO. 4	LASALLE & KENDALL			CONTRACT NO. 66P11		ILLINOIS FED. AID PROJECT				
USER NAME = Joseph.Zagar	DESIGNED -	REVISED -																									
PLOT SCALE = \$SCALE\$	CHECKED -	REVISED -																									
PLOT DATE = 7/2/2024	DATE -	REVISED -																									
F.A.P. RTE. 607	SECTION (125,126)RS-4	COUNTY *	TOTAL SHEETS 22	SHEET NO. 4																							
LASALLE & KENDALL			CONTRACT NO. 66P11																								
ILLINOIS FED. AID PROJECT																											
SCALE:		SHEET OF SHEETS STA.		TO STA.																							

CODE NO.	ITEM	UNIT	TOTAL QUANTITY	CONSTRUCTION CODE	
				LASALLE CO STP-RUR FAP 607 ROADWAY	KENDALL CO STP-RUR FAP 607 ROADWAY
				0005	0005
				RURAL	RURAL
44201299	DOWEL BARS 1 1/2"	EACH	3240	1420	1820
44213200	SAW CUTS	FOOT	5960	2580	3380
44213204	TIE BARS 3/4"	EACH	20		20
48102100	AGGREGATE WEDGE SHOULDER, TYPE B	TON	2656	1210	1446
63500105	DELINEATORS	EACH	12	6	6
* 66700205	PERMANENT SURVEY MARKERS, TYPE I	EACH	8	4	4
67000400	ENGINEER'S FIELD OFFICE, TYPE A	CAL MO	3	1.5	1.5
67100100	MOBILIZATION	L SUM	1	0.5	0.5
70100460	TRAFFIC CONTROL AND PROTECTION, STANDARD 701306	L SUM	1	0.5	0.5
70300100	SHORT TERM PAVEMENT MARKING	FOOT	9312	4416	4896
70300150	SHORT TERM PAVEMENT MARKING REMOVAL	SQ FT	3108	1473	1635
* 78004600	PREFORMED PLASTIC PAVEMENT MARKING, TYPE D - STANDARD - LETTERS AND SYMBOLS	SQ FT	81	81	
* 78004640	PREFORMED PLASTIC PAVEMENT MARKING, TYPE D - STANDARD - LINE 8"	FOOT	246	246	
* 78009004	MODIFIED URETHANE PAVEMENT MARKING - LINE 4"	FOOT	162621	69214	93407

\* SPECIALITY ITEMS

MODEL: D:\rhull... FILE NAME: P:\Ildisp\pc\hull\com\p\DOT Documents\DOT Office\District 3\CRD Project\88P11\CADD\Info\CD\chetas88P11-COMPLETE SHEETS

USER NAME = Joseph.Zagar	DESIGNED -	REVISD -	<p align="center"><b>STATE OF ILLINOIS</b></p> <p align="center"><b>DEPARTMENT OF TRANSPORTATION</b></p>	<p align="center"><b>SUMMARY OF QUANTITIES</b></p>			F.A.P. RTE.	SECTION	COUNTY	TOTAL SHEETS	SHEET NO.
PLOT SCALE = \$\$SCALE\$	CHECKED -	REVISD -					607	(125,126)RS-4	*	22	5
PLOT DATE = 7/2/2024	DATE -	REVISD -		SCALE:	SHEET OF SHEETS	STA.	TO STA.		LASALLE & KENDALL	CONTRACT NO. 66P11	
							ILLINOIS	FED.AID PROJECT			

CODE NO.	ITEM	UNIT	TOTAL QUANTITY	CONSTRUCTION CODE	
				LASALLE CO STP-RUR FAP 607	KENDALL CO STP-RUR FAP 607
				ROADWAY	ROADWAY
				0005	0005
				RURAL	RURAL
* 78009006	MODIFIED URETHANE PAVEMENT MARKING - LINE 6"	FOOT	11840	5660	6180
* 78011000	GROOVING FOR RECESSED PAVEMENT MARKING, LETTERS AND SYMBOLS	SQ FT	81	81	
* 78011045	GROOVING FOR RECESSED PAVEMENT MARKING 9"	FOOT	246	246	
* 78100100	RAISED REFLECTIVE PAVEMENT MARKER	EACH	374	173	201
* 78200006	GUARDRAIL REFLECTORS, TYPE B	EACH	22	18	4
78300200	RAISED REFLECTIVE PAVEMENT MARKER REMOVAL	EACH	374	173	201
X4401198	HOT-MIX ASPHALT SURFACE REMOVAL, VARIABLE DEPTH	SQ YD	2848	1992	856
X6350120	DELINEATOR REMOVAL	EACH	12	6	6
X6350204	LINEAR DELINEATOR PANELS, 4 INCH	EACH	22	18	4
X6350206	LINEAR DELINEATOR PANELS, 6 INCH	EACH	2		2
Z0030850	TEMPORARY INFORMATION SIGNING	SQ FT	42	21	21
Z0034105	MATERIAL TRANSFER DEVICE	TON	16640	7631	9009
Z0055300	RUMBLE STRIP	EACH	3	3	

\* SPECIALITY ITEMS

MODEL: D:\hml...  
 FILE NAME: ...  
 C:\ProgramData\Autodesk\LT2024\Temp\Drawings\DOT\Office\District 3\ORD\Project\038P11\CADD\Drawings\CAD\Sheet\8P11-COMplete\_SHEETS

USER NAME = Joseph.Zagar	DESIGNED -	REVISED -
DRAWN -	REVISIONS -	
PLOT SCALE = \$\$SCALE\$	CHECKED -	REVISED -
PLOT DATE = 7/2/2024	DATE -	REVISED -

**STATE OF ILLINOIS  
DEPARTMENT OF TRANSPORTATION**

**SUMMARY OF QUANTITIES**

SCALE: SHEET OF SHEETS STA. TO STA.

F.A.P. RTE.	SECTION	COUNTY	TOTAL SHEETS	SHEET NO.
607	(125,126)RS-4	*	22	6
LASALLE & KENDALL			CONTRACT NO. 66P11	
ILLINOIS FED. AID PROJECT				

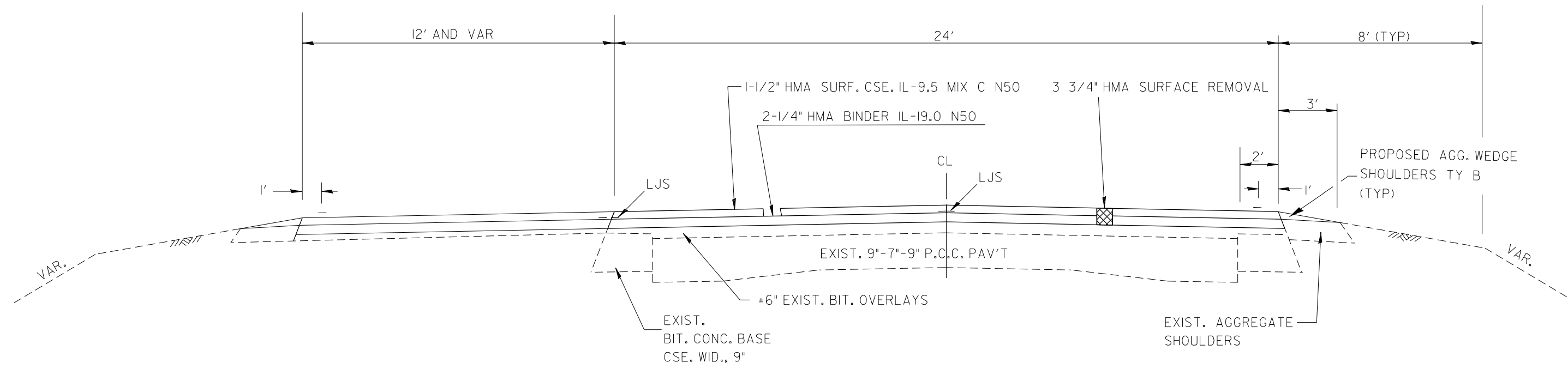

**PROPOSED TYPICAL SECTION 5**

STA. 464+16 TO STA. 468+00

MODEL: Default  
 FILE NAME: c:\p\work\pav\jzagar\k0941336\0366P11-Typical Sections.dgn

USER NAME = Joseph.Zagar	DESIGNED -	REVISED -
	DRAWN -	REVISED -
	CHECKED -	REVISED -
PLOT DATE = 7/2/2024	DATE -	REVISED -

**STATE OF ILLINOIS  
 DEPARTMENT OF TRANSPORTATION**

**TYPICAL SECTIONS**

SCALE: SHEET OF SHEETS STA. TO STA.

F.A.P. RTE.	SECTION	COUNTY	TOTAL SHEETS	SHEET NO.
607	(125,126)RS-4	*	22	7
*LASALLE & KENDALL			CONTRACT NO. 66P11	
ILLINOIS FED. AID PROJECT				

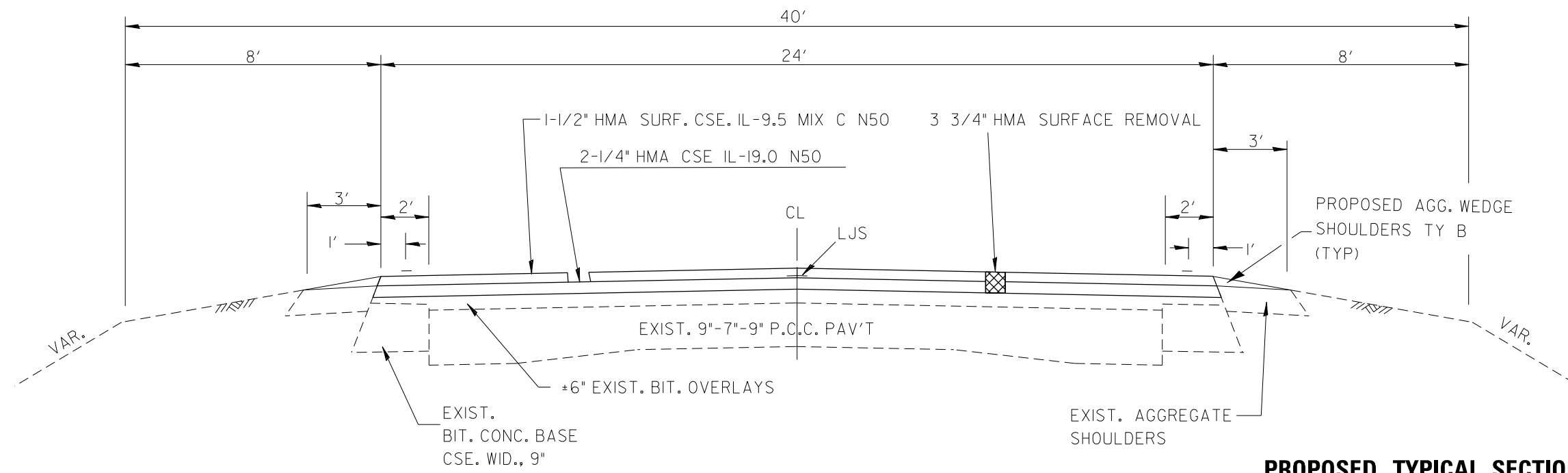

**PROPOSED TYPICAL SECTION 1**

STA. 464+16 TO STA. 594+00

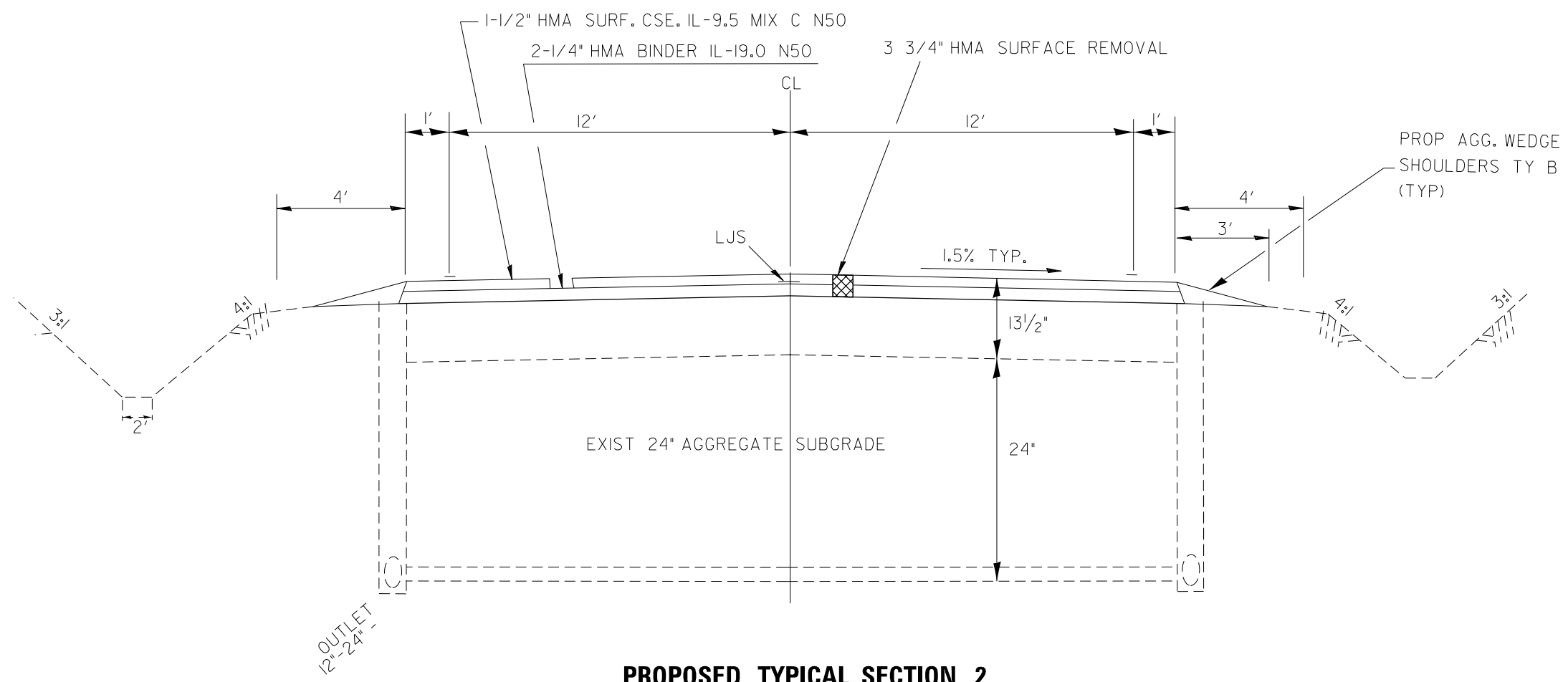

**PROPOSED TYPICAL SECTION 2**

STA. 594+00 TO STA. 601+50

MODEL: Default  
FILE NAME: c:\p\work\avidol\zagar\k0941336\0366P11-Typical Sections.dgn

USER NAME = Joseph.Zagar	DESIGNED -	REVISED -
	DRAWN -	REVISED -
	CHECKED -	REVISED -
PLOT DATE = 7/2/2024	DATE -	REVISED -

**STATE OF ILLINOIS  
DEPARTMENT OF TRANSPORTATION**

**TYPICAL SECTIONS**

SCALE: SHEET OF SHEETS STA. TO STA.

F.A.P. RTE.	SECTION	COUNTY	TOTAL SHEETS	SHEET NO.
607	(125,126)RS-4	*	22	8
*LASALLE & KENDALL		CONTRACT NO. 66P11		
ILLINOIS FED. AID PROJECT				



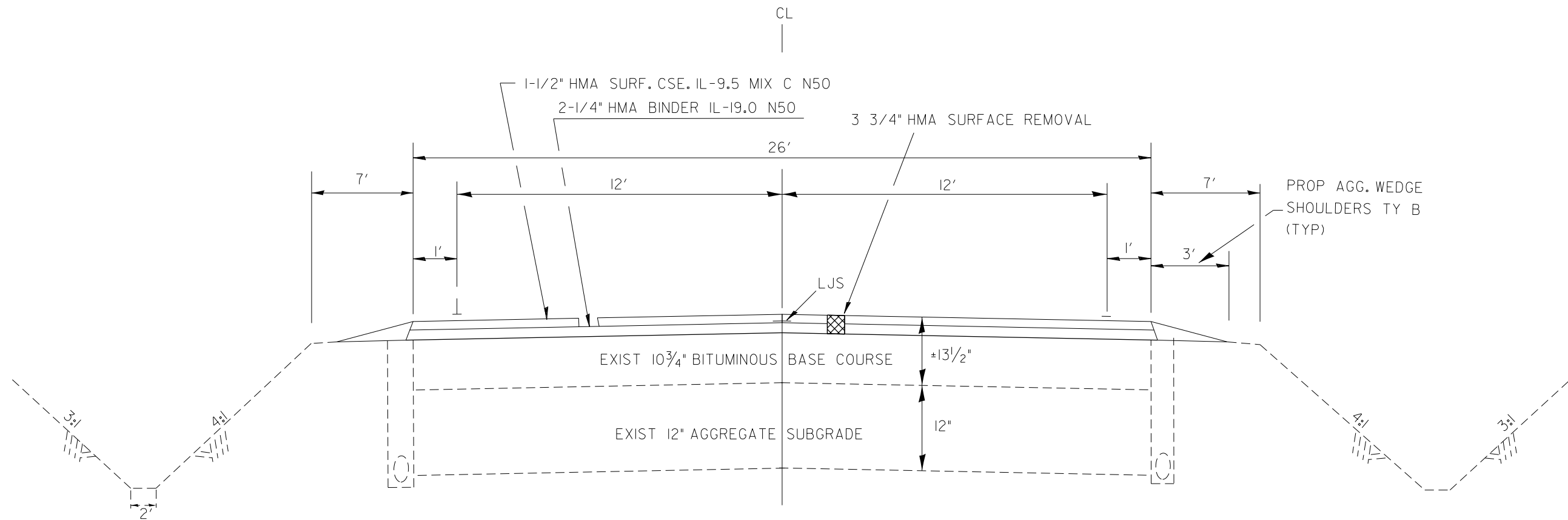

**PROPOSED TYPICAL SECTION 3**

STA. 601+50 TO STA. 605+00

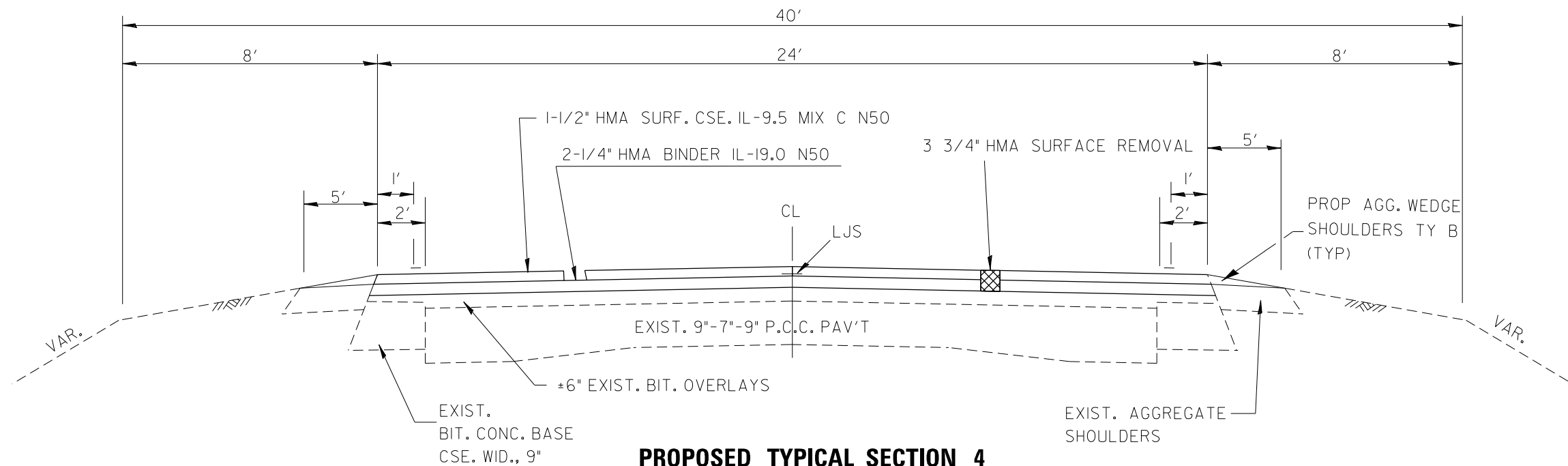

**PROPOSED TYPICAL SECTION 4**

STA. 605+00 TO STA. 615+25  
STA. 618+95 TO STA. 760+40

MODEL: Default  
FILE NAME: c:\p\work\avidol\zagar\k0941336\0366P11-Typical Sections.dgn

USER NAME = Joseph.Zagar	DESIGNED -	REVISED -
	DRAWN -	REVISED -
	CHECKED -	REVISED -
PLOT DATE = 7/2/2024	DATE -	REVISED -

**STATE OF ILLINOIS  
DEPARTMENT OF TRANSPORTATION**

**TYPICAL SECTIONS**

SCALE: SHEET OF SHEETS STA. TO STA.

F.A.P. RTE.	SECTION	COUNTY	TOTAL SHEETS	SHEET NO.
607	(125,126)RS-4	*	22	9
*LASALLE & KENDALL			CONTRACT NO. 66P11	
ILLINOIS FED. AID PROJECT				

## MAINLINE SCHEDULE

LOCATION			LENGTH	WIDTH	AREA	HMA SURF REM 3 3/4"	BIT MAT TACK COAT	LONG JOINT SEAL	MIX CR, JT, & FLGWY	BIND CSE (HM) IL-19.0 N50	BIND CSE (MM) IL-19.0 N50	HMA SURF CSE MIX C N50 IL-9.5FG MAINLINE	AGG WEDGE SHLDS TY B	TEMP RAMP
STA	TO	STA	FOOT	FOOT	SQ YD	SQ YD	POUND	FOOT	TON	TON	TON	TON	TON	SQ YD
<b>LASALLE COUNTY</b>														
464+16	TO	468+90	474	31.5	1714	1714	1157.0	474	0.51	0.86	216	144.0	43	44
468+90	TO	491+00	2210	24	5893	5893	3978.0	2210	1.77	2.95	743	495.0	199	
STA EQ 491+00 BK TO 491+02.48 AH														
491+02	TO	566+99	7597	24	20257	20257	13673.7	7597	6.08	10.13	2552	1701.6	685	
STA EQ 567+00 BK TO 566+99.18 AH														
566+99	TO	577+99	1100	24	2934	2934	1980.3	1100	0.88	1.47	370	246.4	99	
STA EQ 577+99.18 BK TO 578+00.00 AH														
578+00	TO	594+00	1600	24	4267	4267	2880.0	1600	1.28	2.13	538	358.4	144	
594+00	TO	598+00	400	26	1156	1156	780.0	400	0.35	0.58	146	97.1	36	
STA EQ 598+00.00 BK TO 597+99.26 AH														
597+99	TO	598+40	41	26	118	118	80.0	41	0.04	0.06	15	9.9	4	
<b>LASALLE TOTAL</b>			<b>13422</b>	<b>180</b>	<b>36339</b>	<b>36339</b>	<b>24529</b>	<b>13422</b>	<b>11</b>	<b>18</b>	<b>4579</b>	<b>3052</b>	<b>1210</b>	<b>44</b>
<b>KENDALL COUNTY</b>														
598+40	TO	605+00	660	26	1907	1907	1287.0	660	0.57	0.95	240	160.2	60	
605+00	TO	616+42	1142	24	3045	3045	2055.6	1142	0.91	1.52	384	255.8	103	
OMISSION SN 047-0052														67
617+73	TO	647+93	3020	24	8053	8053	5435.8	3020	2.42	4.03	1015	676.5	272	
STA EQ 647+92.91 BK TO 648+00.00 AH														
648+00	TO	693+94	4594	24	12250	12250	8268.9	4594	3.68	6.13	1544	1029.0	414	
STA EQ 693+93.82 BK TO 694+00.00 AH														
694+00	TO	711+01	1701	24	4536	4536	3061.8	1701	1.36	2.27	572	381.0	153	
STA EQ 711+01.34 BK TO 711+00.00 AH														
711+00	TO	731+01	2001	24	5336	5336	3601.8	2001	1.60	2.67	672	448.2	180	
STA EQ 731+00.59 BK TO 731+00.00 AH														
731+00	TO	745+75	1475	24	3933	3933	2655.0	1475	1.18	1.97	496	330.4	133	
STA EQ 745+75.17 BK TO 746+00.00 AH														
746+00	TO	760+40	1440	24	3840	3840	2592.0	1440	1.15	1.92	484	322.6	130	33
<b>KENDALL TOTAL</b>			<b>16033</b>	<b>194</b>	<b>42901</b>	<b>42901</b>	<b>28958</b>	<b>16033</b>	<b>13</b>	<b>21</b>	<b>5405</b>	<b>3604</b>	<b>1446</b>	<b>100</b>

MODEL: D:\hml...  
 FILE NAME: ...  
 PROJECT: ...  
 SHEETS: ...

USER NAME = Joseph.Zagar PLOT SCALE = \$SCALE\$ PLOT DATE = 7/2/2024	DESIGNED - DRAWN - CHECKED - DATE -	REVISED - REVISED - REVISED - REVISED -	<b>STATE OF ILLINOIS</b> <b>DEPARTMENT OF TRANSPORTATION</b>	<b>SCHEDULES</b>	SCALE:      SHEET      OF      SHEETS      STA.      TO STA.	F.A.P. RTE.      SECTION      COUNTY      TOTAL SHEETS      SHEET NO.
			*LASALLE & KENDALL		CONTRACT NO. 66P11	
			ILLINOIS      FED. AID PROJECT			

# SIDEROAD SCHEDULE US 52

STA	SIDE	LOCATION	MATERIAL	LENGTH	WIDTH FRONT	WIDTH BACK	AREA	HMA SURF REM VAR	BIT MAT TACK COAT	INC HMA SURF	FURN EXCAV	AGG SURF CSE TYP B	TEMP RAMP
				FOOT	FOOT	FOOT	SQ YD	SQ YD	POUND	TON	CU YD	TON	SQ YD
<b>LASALLE COUNTY</b>													
466+36	LT	FE	HMA	10	75	25	56					11.9	
482+68	LT	PE	HMA	18	64	27	91	91	41	19			
484+00	LT	PE	HMA	20	62	23	94	94	43	20			
491+58	RT	E 28th Rd	HMA	30	60	19	132	132	59	28	0.8		33
510+84	RT	PE	HMA	9	39	22	31	31	14	6			
515+38	RT	FE	AGG	10	33	33	37					7.8	
519+36	LT	FE	AGG	10	25	12	21					4.4	
525+43	LT	PE/MBTO	HMA	15	70	14	56	56	25	12			
529+15	LT	PE	HMA	9	38	15	27	27	12	6			
534+53	RT	PE	HMA	9	41	16	29	29	13	6			
534+53	LT	MBTO	HMA	5	68	25	26	26	12	5			
537+21	LT	CE	HMA	9	87	41	64	64	29	13			
539+63	LT	CE	HMA	10	52	40	51	51	23	11			
544+67	LT	PE	HMA	9	87	45	66	66	30	14			
545+30	RT	E 29th Rd	HMA	30	127	60	312	312	140	65	0.8		71
552+92	RT	PE	HMA	8	33	19	23	23	10	5			
553+00	LT	MBTO	HMA	6	57	10	22	22	10	5			
557+00	LT	PE/MBTO	HMA	9	71	22	50	50	23	11			
559+33	LT	MBTO	HMA	5	50	33	23	23	10	5			
559+36	RT	PE	HMA	9	34	18	26	26	12	5			
582+49	RT	CE	HMA	13	126	82	150	150	68	32			
585+07	LT	FE	AGG	10	27	10	21					4.4	
595+56	RT	PE	HMA	9	44	29	37	37	16	8			
596+89	RT	PE	HMA	8	46	34	36	36	16	7			
598+79	LT	E 30th Rd	HMA	76	123	27	390	390	176	82	0.8		68
598+79	RT	E 30th Rd	HMA	30	155	40	258	258	116	54	0.8		86
<b>LASALLE TOTAL</b>				<b>386</b>	<b>1694</b>	<b>741</b>	<b>2125</b>	<b>1992</b>	<b>896</b>	<b>418</b>	<b>3.3</b>	<b>28.5</b>	<b>258</b>
<b>KENDALL COUNTY</b>													
614+21	RT	FE	AGG	10	34	15	27					5.8	
614+21	LT	FE	AGG	10	33	13	26					5.5	
625+12	LT	FE	AGG	10	38	21	33					7.0	
672+88	RT	Stephens Rd	HMA	30	82	26	142	142	64	30	0.8		46
672+88	LT	Stephens Rd	HMA	30	62	24	111	111	50	23	0.8		34
670+00	RT	PE	HMA	9	38	19	29	29	13	6			
684+00	LT	PE	HMA	10	32	14	26	26	12	5			
691+93	LT	PE	AGG	10	43	19	34					7.4	
699+51	LT	Roods Rd	HMA	20	71	26	108	108	49	23	0.8		39
699+51	RT	Roods Rd	HMA	30	46	20	110	110	50	23	0.8		26
700+91	LT	PE	HMA	8	36	19	24	24	11	5			
702+15	LT	CE	HMA	10	80	36	64	64	29	14			
730+32	RT	PE	HMA	8	33	17	22	22	10	5			
735+56	LT	PE	HMA	10	45	22	37	37	17	8			
745+59	RT	PE	HMA	10	43	18	34	34	15	7			
745+59	LT	MBTO	HMA	5	45	19	18	18	8	4			
746+47	LT	FE	AGG	10	20	15	19					4.2	
759+85	LT	Townhouse Rd	HMA	23	76	27	132	132	59	28	0.8		15
<b>KENDALL TOTAL</b>				<b>253</b>	<b>857</b>	<b>370</b>	<b>996</b>	<b>856</b>	<b>385</b>	<b>180</b>	<b>4</b>	<b>30</b>	<b>160</b>
<b>TOTAL</b>				<b>639</b>	<b>2551</b>	<b>1111</b>	<b>3121</b>	<b>2848</b>	<b>1282</b>	<b>598</b>	<b>8</b>	<b>58</b>	<b>418</b>

MODEL: D:\hntb\...  
 FILE NAME: ...  
 PROJECT: ...  
 SHEETS: ...

USER NAME = Joseph.Zagar	DESIGNED -	REVISED -
	DRAWN -	REVISED -
PLOT SCALE = \$SCALE\$	CHECKED -	REVISED -
PLOT DATE = 7/2/2024	DATE -	REVISED -

**STATE OF ILLINOIS  
DEPARTMENT OF TRANSPORTATION**

<b>SCHEDULES</b>	
SCALE:	SHEET OF SHEETS STA. TO STA.

F.A.P. RTE.	SECTION	COUNTY	TOTAL SHEETS	SHEET NO.
607	(125,126)RS-4	*	22	11
*LASALLE & KENDALL			CONTRACT NO. 66P11	
ILLINOIS FED. AID PROJECT				

## PAVEMENT MARKING SCHEDULE

LOCATION	LENGTH	NOTES	SHORT TERM PMK		PREF PL TYP. D		MOD URETH PM		GRV RCSD PVT MRKG		RAISED REFLECTIVE		RUMBLE	
			INSTALL (3 APP)	REMOVE (3 APP)	LTR & SYM	8"	4"	6"	LTR & SYM	9"	PAVEMENT MARKERS		STRIP	
											(2 APP)	(2 APP)		INSTALL
STA	TO	STA	FT	FT	SQ FT	SQ FT	FT	FT	SQ FT	FT	EACH	EACH	EACH	
464+16.00	TO	491+00.00 BK	2,684.00	1164	390	81	246	11645	1360	81	246	39	39	3
491+02.48	AH	TO 491+58.00	55.52	24	9			159	40			1	1	
491+50.00	TO	545+30	5,372.00	1620	540			29715	1900			67	67	
545+30	TO	567+00.00 BK	2,170.00	660	219			13099	780			27	27	
566+99.18	AH	TO 577+99.18 BK	1,100.00	336	111			4400	560			14	14	
578+00.00	AH	TO 598+00.00 BK	2,000.00	600	201			9864	1000			25	25	
597+99.26	AH	TO 598+39	39.74	12	3			332	20					
<b>LASALLE COUNTY TOTAL</b>				<b>4416</b>	<b>1473</b>	<b>81</b>	<b>246</b>	<b>69,214</b>	<b>5660</b>	<b>81</b>	<b>246</b>	<b>173</b>	<b>173</b>	<b>3</b>
598+39	TO	647+92.91 BK	4,953.91	1488	495			24178	2380			62	62	
648+00.00	AH	TO 672+96	2,496.00	756	252			13790	1220			31	31	
672+96	TO	693+93.82 BK	2,097.82	636	213			16679				26	26	
694+00.00	AH	TO 699+56	556.00	168	57			4318				7	7	
699+56	TO	711+01.34 BK	1,145.34	348	117			8642	120			14	14	
711+00.00	AH	TO 731+00.59 BK	2,000.59	612	204			11234	1020			25	25	
731+00.00	AH	TO 745+75.17 BK	1,475.17	444	147			7321	740			18	18	
746+00.00	AH	TO 759+91	1,391.00	420	141			6842	700			17	17	
759+91	TO	760+40.00	49.00	24	9			403				1	1	
<b>KENDALL COUNTY TOTAL</b>				<b>4,896</b>	<b>1,635</b>			<b>93,407</b>	<b>6,180</b>			<b>201</b>	<b>201</b>	
<b>TOTAL</b>				<b>9312</b>	<b>3108</b>	<b>81</b>	<b>246</b>	<b>162,621</b>	<b>11840</b>	<b>81</b>	<b>246</b>	<b>374</b>	<b>374</b>	<b>3</b>

\* FOR LETTERS AND SYMBOLS: RIGHT TURN ARROWS AND STOP AHEAD. STOP FIRST THEN 100' TO AHEAD.

## DELINEATOR SCHEDULE

STATION	CULVERT	DELINEATOR REMOVAL	DELINEATORS	6" DELIN PANEL	4" DELIN PANEL	GR REFLECT TYP B
		EACH	EACH	EACH	EACH	EACH
<b>LASALLE COUNTY</b>						
479+00	050-2654	2	2		6	6
542+65	050-2653	2	2		6	6
575+17	050-2059	2	2		6	6
<b>LASALLE TOTAL</b>		<b>6</b>	<b>6</b>	<b>0</b>	<b>18</b>	<b>18</b>
<b>KENDALL COUNTY</b>						
616+42	SN 047-0052	2	2	2	4	4
652+29	047-2501	2	2			
664+15	047-2502	2	2			
<b>KENDALL TOTAL</b>		<b>6</b>	<b>6</b>	<b>2</b>	<b>4</b>	<b>4</b>
<b>TOTAL</b>		<b>12</b>	<b>12</b>	<b>2</b>	<b>22</b>	<b>22</b>

MODEL: D:\hml...  
FILE NAME: P:\hml...  
PROJECT: I:\ORD...  
DRAWING: I:\ORD...  
SHEET: I-\COMPLETE SHEETS

USER NAME = Joseph.Zagar	DESIGNED -	REVISED -
	DRAWN -	REVISED -
PLOT SCALE = \$SCALE\$	CHECKED -	REVISED -
PLOT DATE = 7/2/2024	DATE -	REVISED -

**STATE OF ILLINOIS  
DEPARTMENT OF TRANSPORTATION**

<b>SCHEDULES</b>	
SCALE:	SHEET OF SHEETS STA. TO STA.

F.A.P. RTE.	SECTION	COUNTY	TOTAL SHEETS	SHEET NO.
607	(125,126)RS-4	*	22	12
*LASALLE & KENDALL			CONTRACT NO. 66P11	
ILLINOIS FED. AID PROJECT				

# US-52 MAINLINE PATCHING SCHEDULE 1 of 1

LOCATION START STA:464+16 (+/- 528')	EASTBOUND LANE							WESTBOUND LANE					
	PATCH LENGTH	PATCH WIDTH	AREA SQ YD	SAW CUTS	DOWEL BARS 18" EACH	CLASS B PATCHING		PATCH LENGTH	PATCH WIDTH	AREA SQ YD	SAW CUTS	DOWEL BARS 18" EACH	CLASS B PATCHING
						TY II 17" SQ YD	TY III 17" SQ YD						TY II 17" SQ YD
	FOOT	FOOT	SQ YD	FOOT	EACH	SQ YD	SQ YD	FOOT	FOOT	SQ YD	FOOT	EACH	SQ YD
<b>LASALLE COUNTY</b>													
464+16	6	12	8	36	20	8		6	12	8	36	20	8
464+16	6	12	8	36	20	8		6	12	8	36	20	8
469+44	6	12	8	36	20	8		6	12	8	36	20	8
480+00	6	12	8	36	20	8		6	12	8	36	20	8
485+28	6	12	8	36	20	8		6	12	8	36	20	8
485+28	6	12	8	36	20	8		6	12	8	36	20	8
485+28	6	12	8	36	20	8		6	12	8	36	20	8
490+56	6	12	8	36	20	8		6	12	8	36	20	8
495+84	6	12	8	36	20	8		6	12	8	36	20	8
501+12	6	12	8	36	20	8		6	12	8	36	20	8
501+12	6	12	8	36	20	8		6	12	8	36	20	8
506+40	6	12	8	36	20	8		6	12	8	36	20	8
506+40	6	12	8	36	20	8		6	12	8	36	20	8
511+68	6	12	8	36	20	8		6	12	8	36	20	8
511+68	6	12	8	36	20	8		6	12	8	36	20	8
516+96	6	12	8	36	20	8		6	12	8	36	20	8
522+24	6	12	8	36	20	8		6	12	8	36	20	8
522+24	6	12	8	36	20	8		6	12	8	36	20	8
527+52	6	12	8	36	20	8		6	12	8	36	20	8
527+52	6	12	8	36	20	8		6	12	8	36	20	8
532+80	12	12	16	48	20		16	6	12	8	36	20	8
538+08	12	12	16	48	20		16	6	12	8	36	20	8
543+36	6	12	8	36	20	8		6	12	8	36	20	8
553+92	6	12	8	36	20	8		6	12	8	36	20	8
553+92	6	12	8	36	20	8		6	12	8	36	20	8
559+20	6	12	8	36	20	8		6	12	8	36	20	8
559+20	6	12	8	36	20	8		6	12	8	36	20	8
564+48	6	12	8	36	20	8		6	12	8	36	20	8
564+48	6	12	8	36	20	8		6	12	8	36	20	8
569+76	6	12	8	36	20	8		6	12	8	36	20	8
575+04	6	12	8	36	20	8		6	12	8	36	20	8
575+04	6	12	8	36	20	8		6	12	8	36	20	8
580+32	6	12	8	36	20	8		6	12	8	36	20	8
580+32	6	12	8	36	20	8		6	12	8	36	20	8
585+60	6	12	8	36	20	8		6	12	8	36	20	8
590+88	6	12	8	36	20	8		6	12	8	36	20	8
<b>LASALLE TOTAL</b>	<b>222</b>	<b>420</b>	<b>296</b>	<b>1284</b>	<b>700</b>	<b>264</b>	<b>32</b>	<b>216</b>	<b>432</b>	<b>288</b>	<b>1296</b>	<b>720</b>	<b>288</b>

MODEL: D:\hmf...  
 FILE NAME: P:\hmf...  
 PROJECT: I:\ORD...  
 OFFICE: I:\DOT...  
 COMPLETE SHEETS

USER NAME = Joseph.Zagar	DESIGNED -	REVISED -
	DRAWN -	REVISED -
PLOT SCALE = \$SCALE\$	CHECKED -	REVISED -
PLOT DATE = 7/2/2024	DATE -	REVISED -

**STATE OF ILLINOIS  
DEPARTMENT OF TRANSPORTATION**

SCALE:	SHEET	OF	SHEETS	STA.	TO STA.
--------	-------	----	--------	------	---------

**SCHEDULES**

F.A.P. RTE.	SECTION	COUNTY	TOTAL SHEETS	SHEET NO.
607	(125,126)RS-4	*	22	13
*LASALLE & KENDALL			CONTRACT NO. 66P11	
ILLINOIS FED. AID PROJECT				



## PERMANENT SURVEY MARKER SCHEDULE

MONUMENT NUMBER	DESCRIPTION	APPROXIMATE LOCATION	EXISTING MONUMENT TYPE	PROPOSED MONUMENT TYPE	MONUMENT RECORD TO BE RECORDED	RESPONSIBILITY
A052001	NW CORNER SECTION 26, T35N, R5E, 3RD PM	E 28TH RD INTERSECTION, WEST SIDE	MAG NAIL	TYPE 1	YES	1
052001	NW CORNER SECTION 26, T35N, R5E, 3RD PM ALTERNATE OPINION	"	3/4" PIPE	NO CHANGE	REFERENCE WITH A052001	2
052002	N QTR CORNER SECTION 26, T35N, R5E, 3RD PM	1/2 MI E OF 28TH RD INTERSECTION	BURIED MAG NAIL	MAG NAIL IF FOUND	YES	2
052003	NE CORNER SECTION 26, T35N, R5E, 3RD PM	E 29TH RD INTERSECTION, WEST SIDE	ALUMINUM PLAQUE / BURIED STEEL PLATE	TYPE 1	YES	1
052004	N QTR CORNER SECTION 25, T35N, R5E, 3RD PM	1/2 MI E OF 29TH RD INTERSECTION	BRASS PLAQUE	TYPE 1	YES	1
052005	NE CORNER SECTION 25, T35N, R5E, 3RD PM	E 30TH RD INTERSECTION	MAG NAIL / BURIED STEEL PLATE	TYPE 1	YES	1
052007	NW CORNER SECTION 29, T35N, R6E, 3RD PM	1/2 MI W OF STEPHENS RD	BRASS PLAQUE	TYPE 1	NO	1
052008	N QTR CORNER SECTION 29, T35N, R6E, 3RD PM	STEPHENS RD INTERSECTION	RR SPIKE	TYPE 1	YES	1
052009	NE CORNER SECTION 29, T35N, R6E, 3RD PM	ROODS RD INTERSECTION	BRASS PLAQUE / BURIED STEEL PLATE	TYPE 1	YES	1
052011	N QTR CORNER SECTION 28, T35N, R6E, 3RD PM	1/2 MI E OF ROODS RD INTERSECTION	SPINDLE	SURVEY NAIL	NO	2
052010	NE CORNER SECTION 28, T35N, R6E, 3RD PM	700 FEET +/- WEST OF TOWNHOUSE RD	SPINDLE / BURIED STEEL PLATE	TYPE 1	YES	1

ONLY THE ORIGINAL SCOPE OF THIS JOB HAS BEEN SEARCHED FOR MONUMENTS. R.E. MUST INFORM PLATS AND PLANS TO SEARCH FOR ADDITIONAL MONUMENTS PRIOR TO MILLING IF ADDENDUMS HAVE BEEN ADDED TO THIS JOB.

**R.E. WILL INFORM PLATS AND PLANS WHEN SURFACE IS TO BE MILLED FOR THE PURPOSE OF LOCATING BURIED SURVEY MONUMENTS.**

UNKNOWN MONUMENTS MAY EXIST. IF AN UNLISTED MONUMENT IS FOUND, R.E. IS REQUIRED TO PROTECT THE MONUMENT FROM DAMAGE UNTIL A PLATS AND PLANS LAND SURVEYOR CAN DOCUMENT THE MONUMENT. PLATS AND PLANS WILL RESET SUCH MONUMENTS IN KIND FOLLOWING CONSTRUCTION.

**UPON PAVING COMPLETION, R.E. WILL DIRECT PLATS AND PLANS TO STAKE THE TYPE 1 PSM CORING LOCATIONS.**

TYPE 1 TOTALS ARE SUBJECT TO CHANGE BASED ON THE RESULTS OF THE MILLED ROAD MONUMENTS SEARCH.

**NOTE: FOR BIDDING PURPOSES, NO CONTRACTED LAND SURVEYING SERVICES WILL BE REQUIRED FOR SETTING THE LISTED PERMANENT SURVEY MARKERS. PLATS AND PLANS WILL PREPARE THE REQUIRED MONUMENT RECORDS.**

**RESPONSIBILITY:**

- 1) RESIDENT TO RE-ESTABLISH MONUMENT (PAY ITEM REQUIRED. PERMANENT SURVEY MARKER, TYPE 1)
- 2) PLATS AND PLANS TO RE-ESTABLISH MONUMENT

MODEL: D:\hull...  
 FILE NAME: ...  
 PROJECT: ...  
 SHEETS: ...

USER NAME = Joseph.Zagar	DESIGNED -	REVISED -
	DRAWN -	REVISED -
PLOT SCALE = \$SCALE\$	CHECKED -	REVISED -
PLOT DATE = 7/2/2024	DATE -	REVISED -

**STATE OF ILLINOIS  
DEPARTMENT OF TRANSPORTATION**

SCALE:	SHEET	OF	SHEETS	STA.	TO STA.
--------	-------	----	--------	------	---------

**SCHEDULES**

F.A.P. RTE.	SECTION	COUNTY	TOTAL SHEETS	SHEET NO.
607	(125,126)RS-4	*	22	15
*LASALLE & KENDALL			CONTRACT NO. 66P11	
ILLINOIS   FED. AID PROJECT				

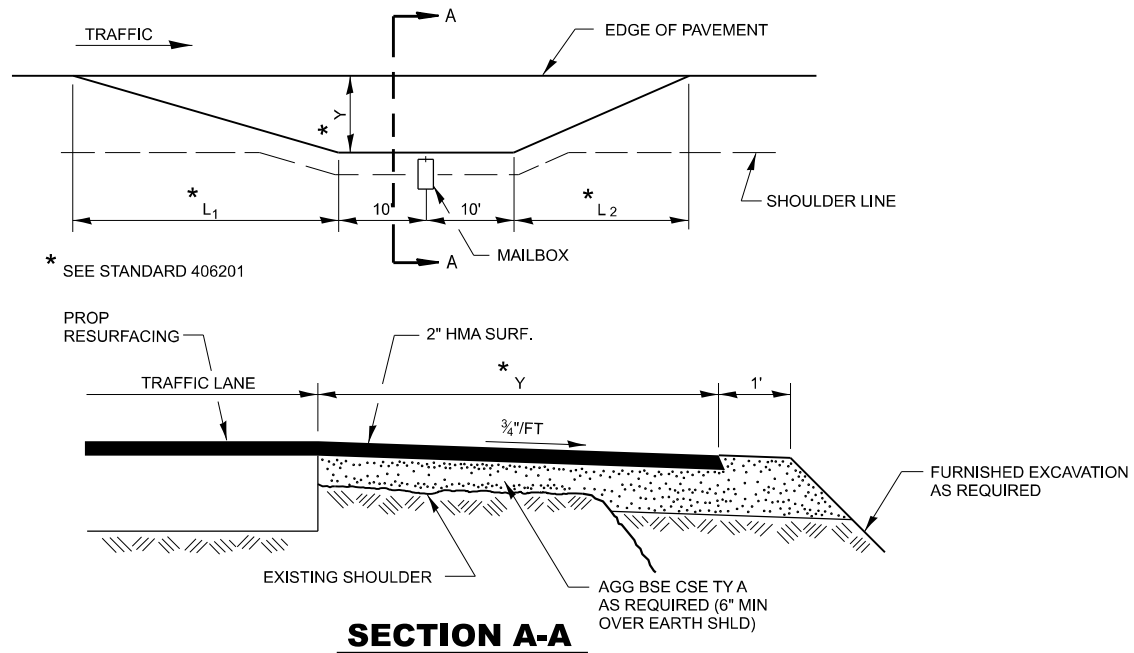

**SECTION A-A**  
**RURAL MAILBOX TURNOUT DETAILS**

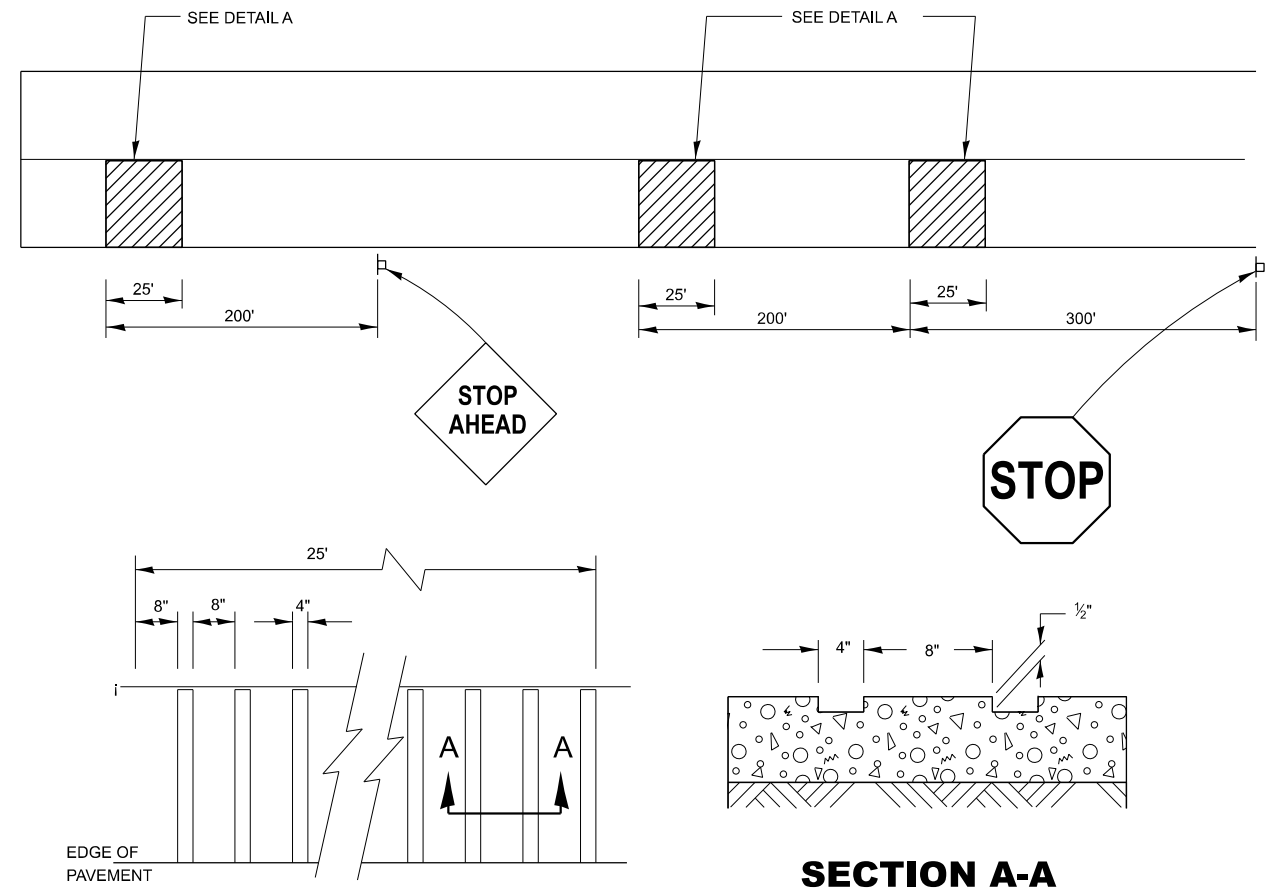

**DETAIL A**  
**TYPICAL GROOVED RUMBLE STRIP APPLICATION IN ADVANCE OF AN INTERSECTION**

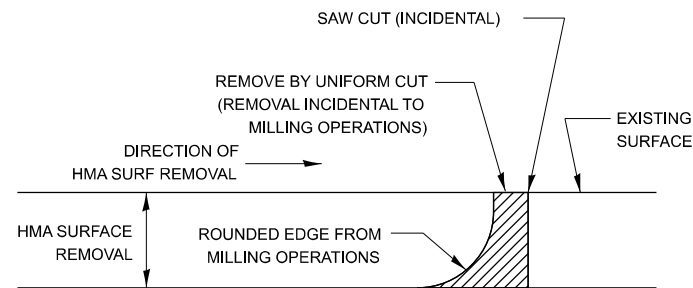

NOTE:  
WHEN MILLING OPERATIONS PRODUCE A ROUNDED EDGE,  
THEN A SAW CUT SHALL BE USED TO MANUFACTURE  
A PERPENDICULAR EDGE AS SHOWN IN THE DETAIL.  
THE ENGINEER SHALL BE THE SOLE JUDGE  
CONCERNING THE USE OF THIS DETAIL

**HMA DETAIL AT BUTT JOINTS**

MODEL: Default  
FILE NAME: c:\p\work\pav\detail\zagar\k0941336\0366P11-Detail.dgn

USER NAME = Joshua.Ferguson	DESIGNED -	REVISED -
	DRAWN -	REVISED -
	CHECKED -	REVISED -
PLOT DATE = 7/2/2024	DATE -	REVISED -

STATE OF ILLINOIS  
DEPARTMENT OF TRANSPORTATION

DETAILS

SCALE: SHEET OF SHEETS STA. TO STA.

F.A.P. RTE.	SECTION	COUNTY	TOTAL SHEETS	SHEET NO.
607	(125,126)RS-4	*	22	16
*LASALLE & KENDALL		CONTRACT NO. 66P11		
ILLINOIS FED. AID PROJECT				



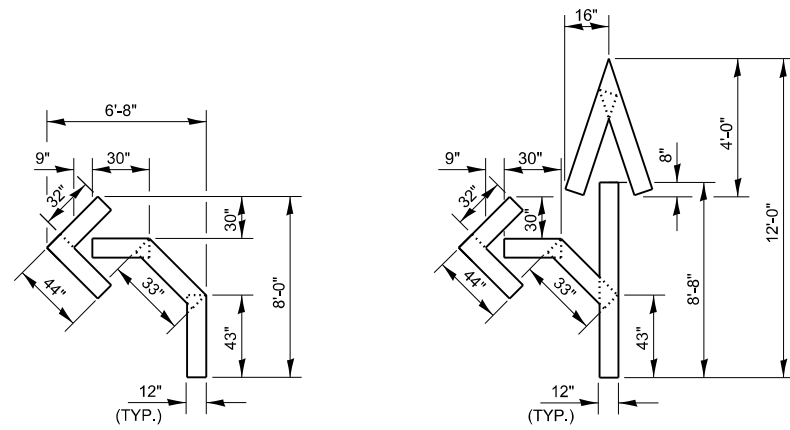

QUANTITY  
12" LINE = 16 LIN FT  
OR 4" LINE = 48 LIN FT

QUANTITY  
12" LINE = 29 LIN FT  
OR 4" LINE = 87 LIN FT

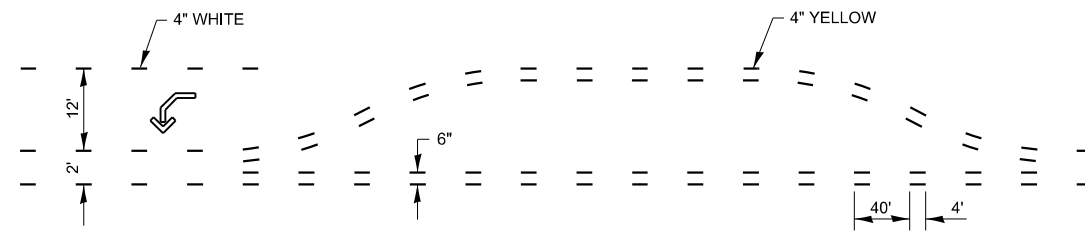

### SHORT-TERM PAVEMENT MARKING FOR MEDIANS AND ARROWS

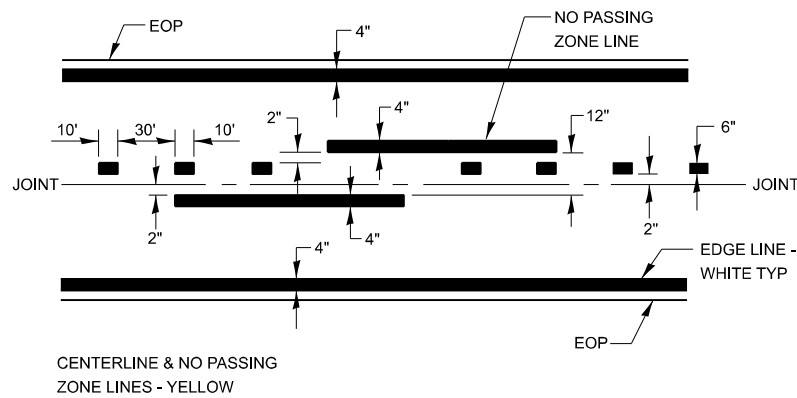

### PAVEMENT MARKING

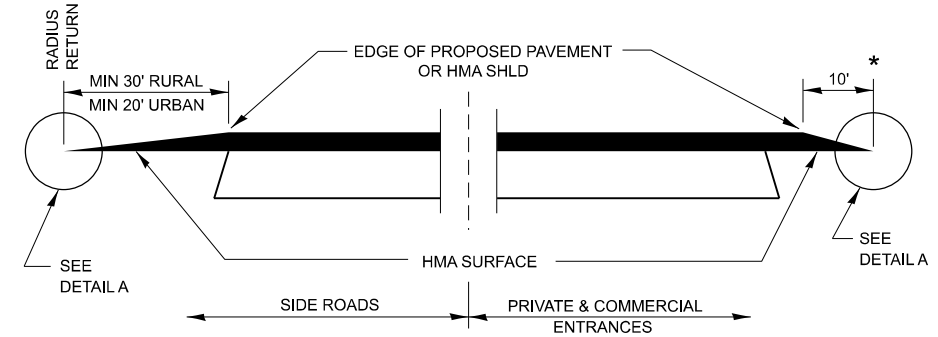

### SECTION A-A DETAILS AT ENTRANCES & SIDE ROADS

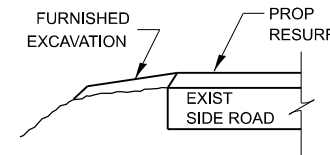

### SECTION B-B

THE COST OF REMOVAL AT EXISTING HMA OR PCC LOCATIONS SHALL BE PAID FOR PER SQ YD BY THE APPROPRIATE PAY ITEM. REMOVAL AT THE EXISTING AGG LOCATIONS SHALL BE INCIDENTAL TO THE HMA. A-3 LOCATIONS SHALL BE FEATHER TAPERED.

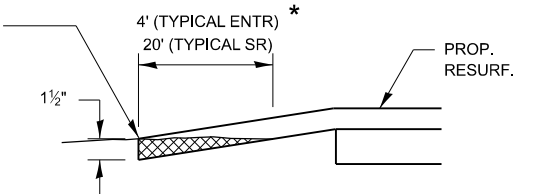

### DETAIL A

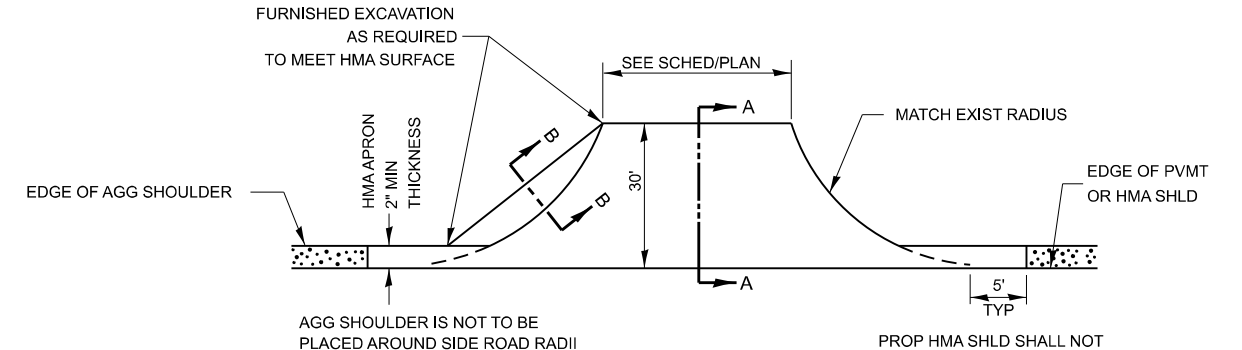

### PLAN AT SIDE ROADS

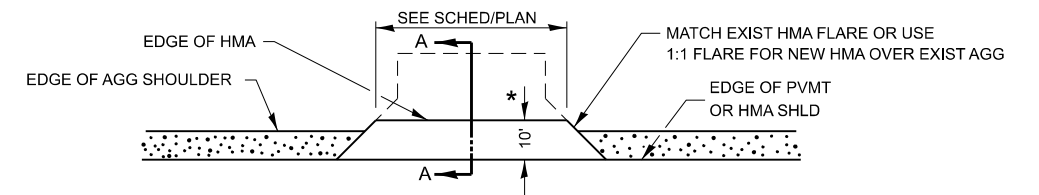

### PLAN AT PRIVATE & COMMERCIAL ENTRANCES

(DO NOT RESURFACE FIELD ENTRANCES)

MODEL - Default  
FILE NAME: c:\p\work\pav\detail\zagar\k0941336\0366P11-Details.dgn

USER NAME = Joshua.Ferguson	DESIGNED -	REVISED -
	DRAWN -	REVISED -
	CHECKED -	REVISED -
PLOT DATE = 7/2/2024	DATE -	REVISED -

STATE OF ILLINOIS  
DEPARTMENT OF TRANSPORTATION

DETAILS			
SCALE:	SHEET	OF SHEETS	STA. TO STA.

F.A.P RTE.	SECTION	COUNTY	TOTAL SHEETS	SHEET NO.
607	(125,126)RS-4	*	22	17
*LASALLE & KENDALL		CONTRACT NO. 66P11		
ILLINOIS FED. AID PROJECT				

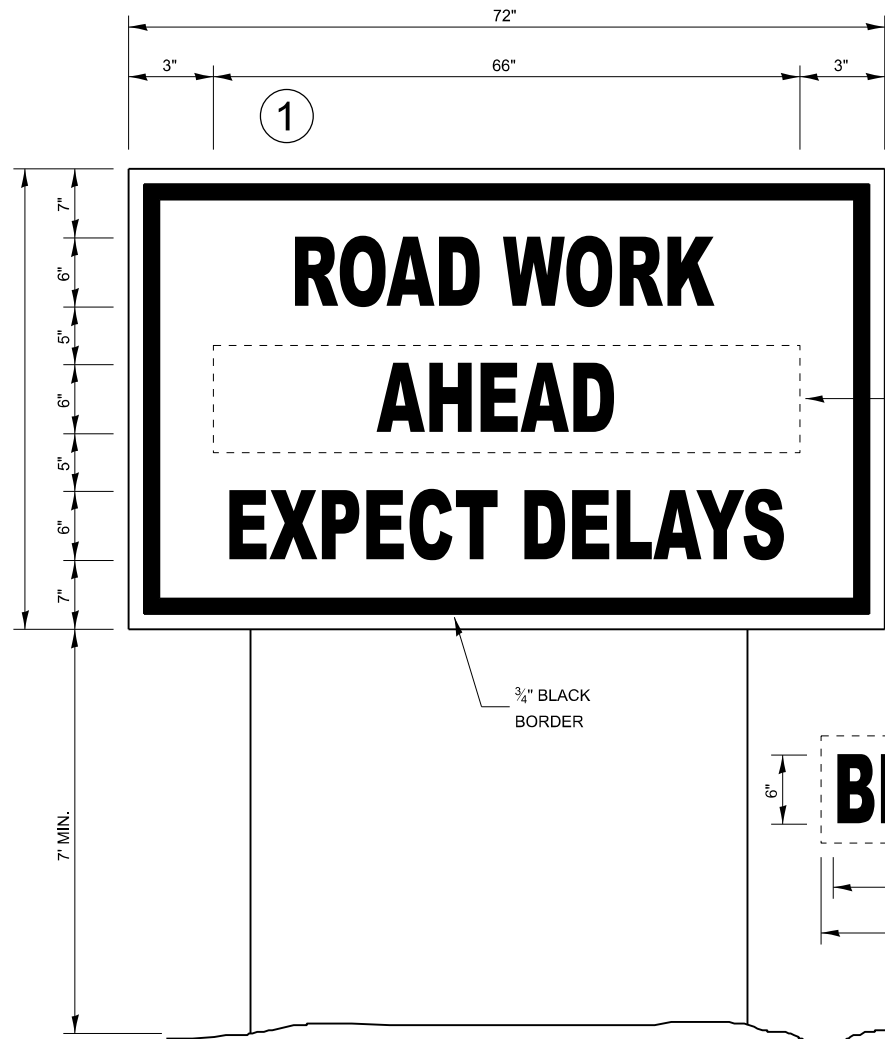

**TEMPORARY INFORMATION SIGNING**

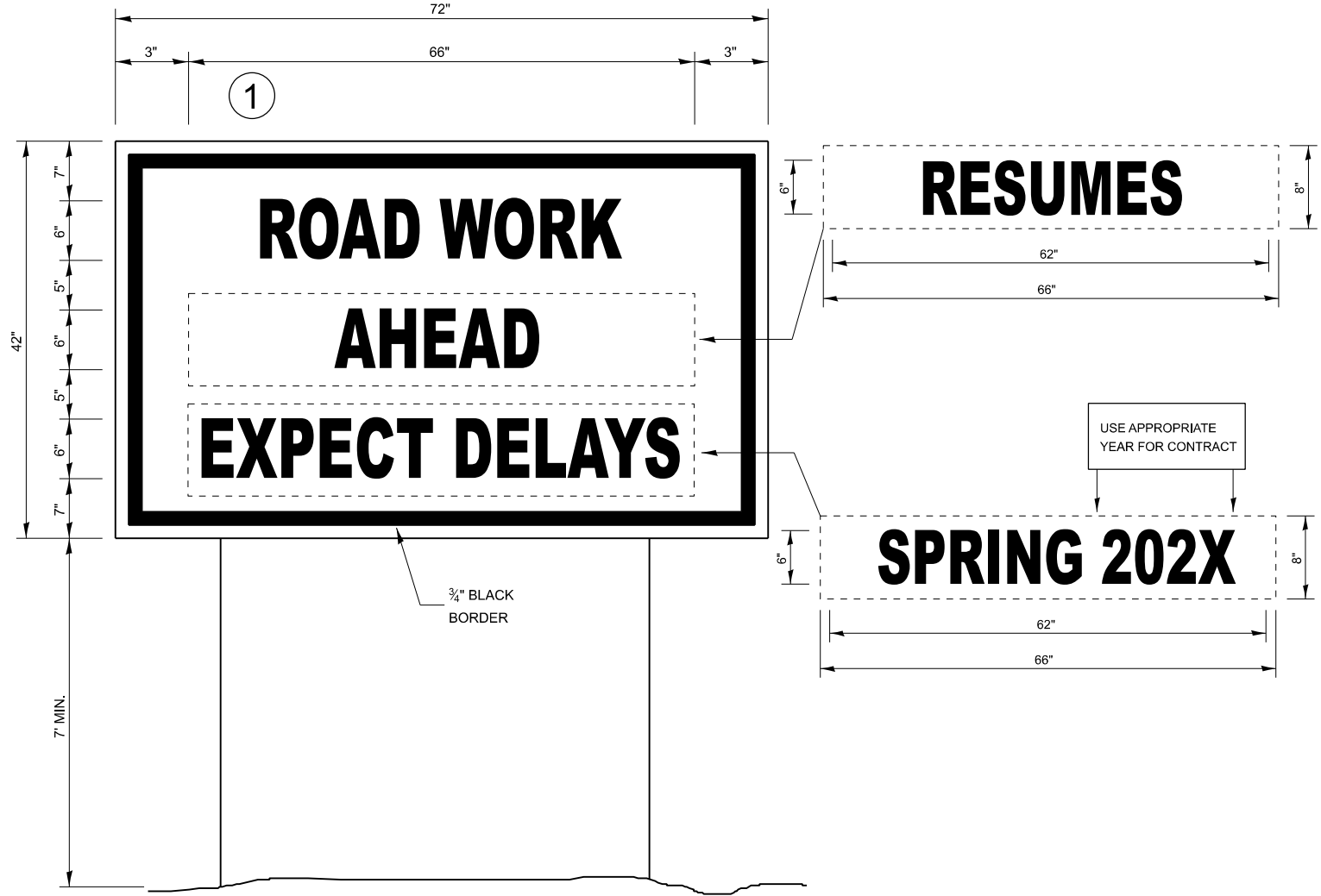

**WINTER SHUT DOWN SIGNING**

**NOTES:**

1. USE 6" D BLACK LETTERING ON FLOURESENT ORANGE BACKGROUND.
2. ERECT SIGNS AT LOCATIONS IN ADVANCE OF THE "ROAD CONSTRUCTION AHEAD" SIGNS AS DIRECTED BY THE ENGINEER.
3. ERECT SIGN 1 WITH INSTALLED PANEL 2 A MINIMUM OF ONE WEEK PRIOR TO THE START OF THE LANE CLOSURE.
4. REMOVE PANEL 2 ON THAT DATE.
5. SEE SPECIAL PROVISION "TEMPORARY INFORMATION SIGNING" FOR ADDITIONAL INFORMATION.
6. WILL BE PAID FOR PER SQ FT AS "TEMPORARY INFORMATION SIGNING". EACH SIGN = 21 SQ FT AND THE DATE PANEL 2 WILL NOT BE MEASURED SEPARATELY FOR PAYMENT.

MODEL: Default  
FILE NAME: c:\p\work\awinfo\zagar\k0941336\0366P11-Details.dgn

USER NAME = Joshua.Ferguson	DESIGNED -	REVISED -
	DRAWN -	REVISED -
	CHECKED -	REVISED -
PLOT DATE = 7/2/2024	DATE -	REVISED -

**STATE OF ILLINOIS  
DEPARTMENT OF TRANSPORTATION**

**DETAILS**

SCALE: SHEET OF SHEETS STA. TO STA.

F.A.P. RTE.	SECTION	COUNTY	TOTAL SHEETS	SHEET NO.
607	(125,126)RS-4	*	22	18
*LASALLE & KENDALL			CONTRACT NO. 66P11	
ILLINOIS FED. AID PROJECT				

**NOTES**

DELINEATORS FOR ROADSIDE HAZARDS SHALL ONLY BE PLACED AT LOCATIONS WHERE THERE IS NO GUARDRAIL, OR OTHER PERMANENT BARRIER, ON THE SAME SIDE OF ROAD AS THE HAZARD.

DELINEATORS FOR ROADSIDE HAZARDS SHALL ONLY BE PLACED AT LOCATIONS WHERE DELINEATORS ARE NOT IN PLACE ALONG THE EDGE OF SHOULDER.

EACH POST SHALL BE CONSIDERED AS ONE DELINEATOR FOR PAYMENT, REGARDLESS OF THE NUMBER OF DELINEATORS ATTACHED TO IT.

FOR ONE-WAY ROADWAYS THE APPLICATION SHALL BE SIMILAR WITH DELINEATORS PLACED ON THE TRAFFIC APPROACH SIDE OF HAZARDS AND OBJECTS. ONLY SINGLE FACE DELINEATORS WILL BE REQUIRED ON ONE-WAY ROADWAYS. CRYSTAL ON RIGHT SIDE, AMBER ON LEFT.

FOR OTHER DELINEATOR APPLICATIONS, REFER TO HIGHWAY STANDARD 635001.

**IDENTIFICATION OF ROADSIDE HAZARDS FOR TWO-LANE ROADWAYS**

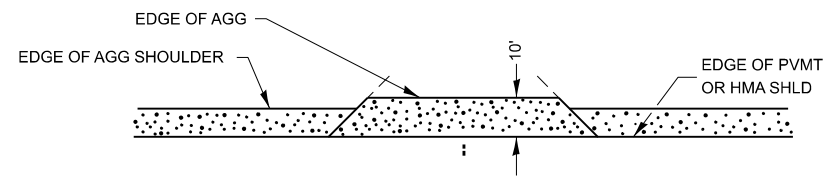
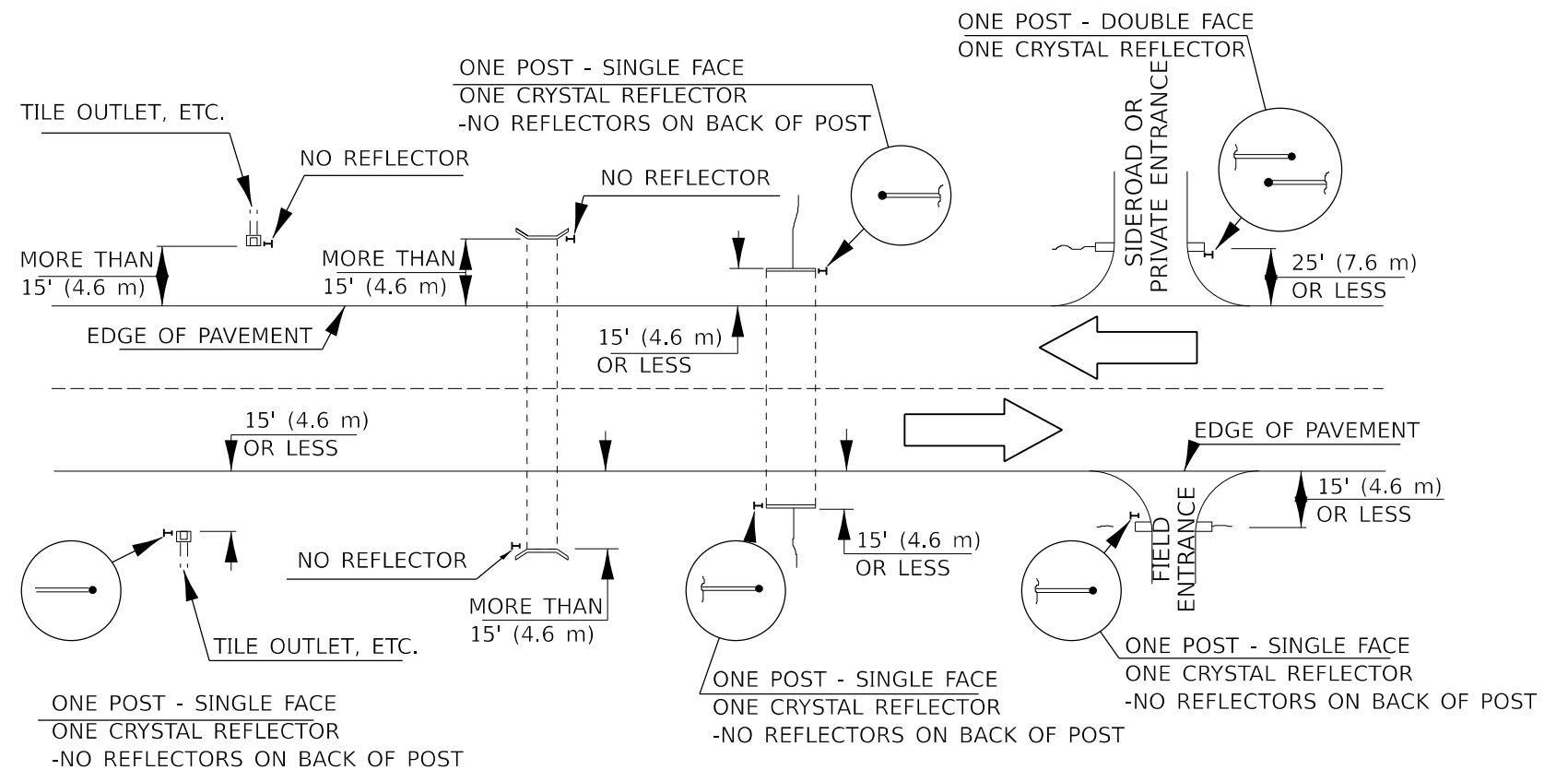

**PLAN AT FIELD ENTRANCES**

MODEL: Default  
FILE NAME: c:\p\work\awid\otz\aggr\k\0941336\0366P11-Details.dgn

USER NAME = Joshua.Ferguson	DESIGNED -	REVISED -
	DRAWN -	REVISED -
	CHECKED -	REVISED -
PLOT DATE = 7/2/2024	DATE -	REVISED -

**STATE OF ILLINOIS  
DEPARTMENT OF TRANSPORTATION**

**DETAILS**

SCALE: SHEET OF SHEETS STA. TO STA.

F.A.P. RTE.	SECTION	COUNTY	TOTAL SHEETS	SHEET NO.
607	(125,126)RS-4	*	22	19
*LASALLE & KENDALL			CONTRACT NO. 66P11	
ILLINOIS FED. AID PROJECT				

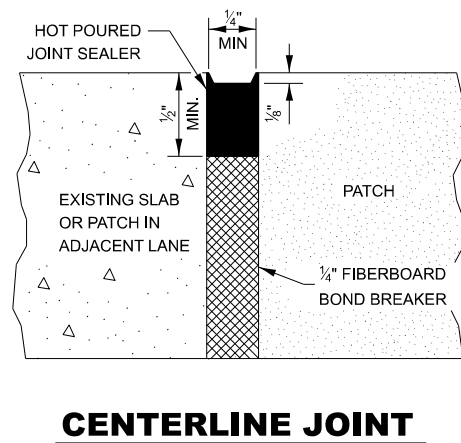
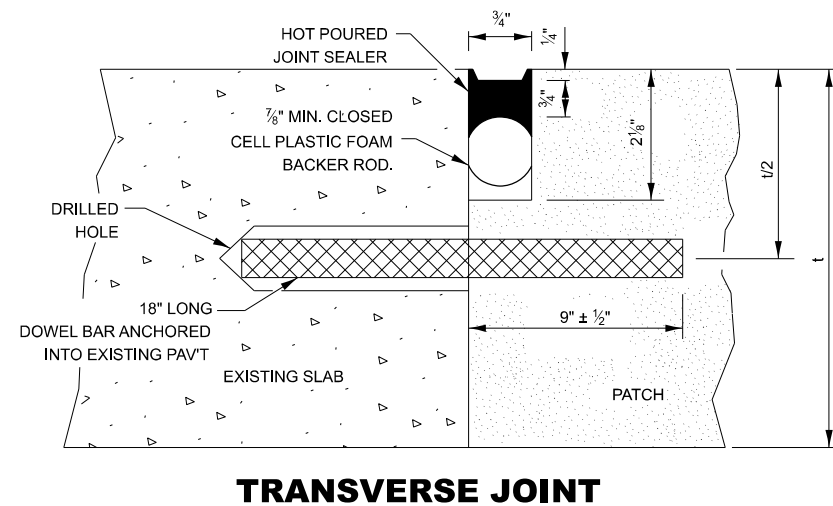
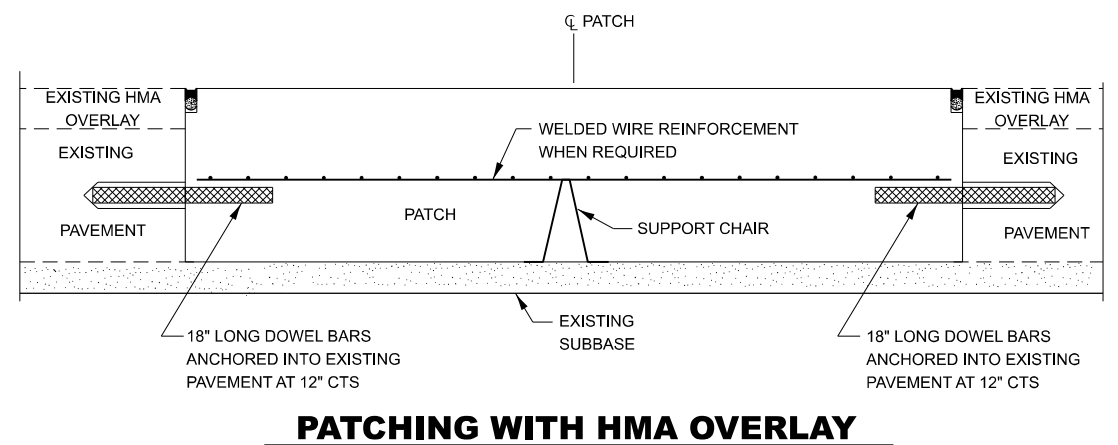
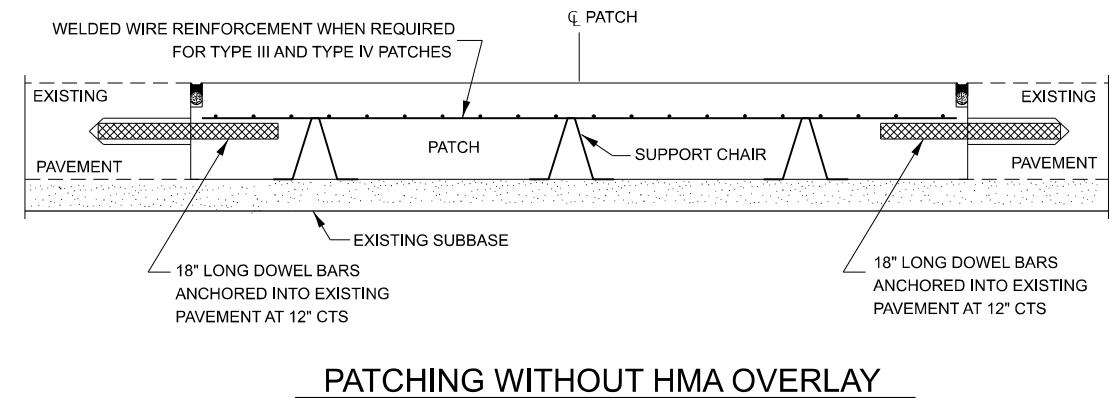
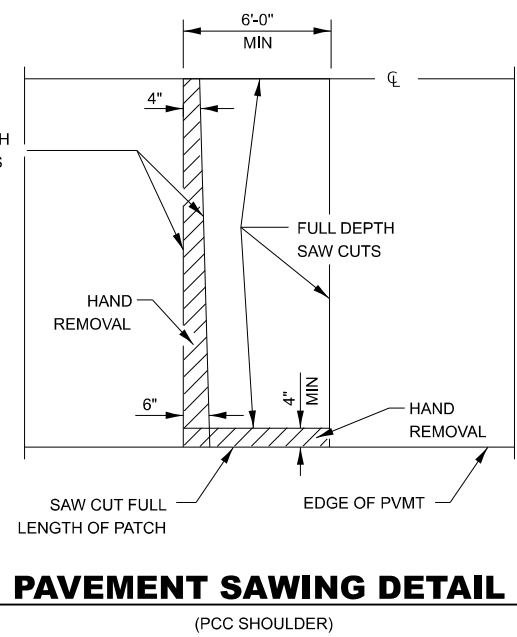
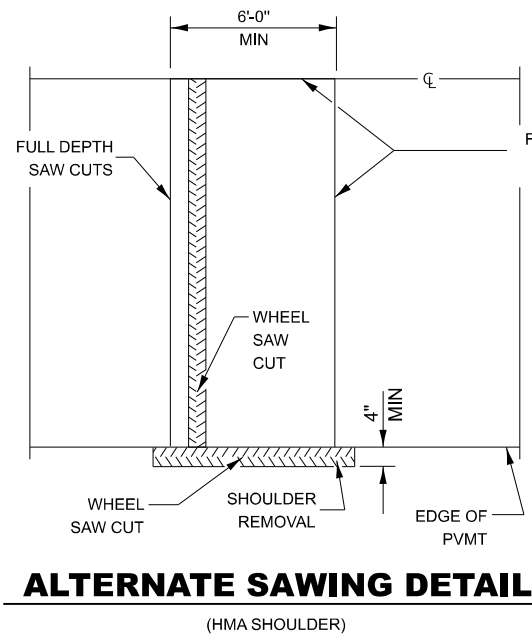
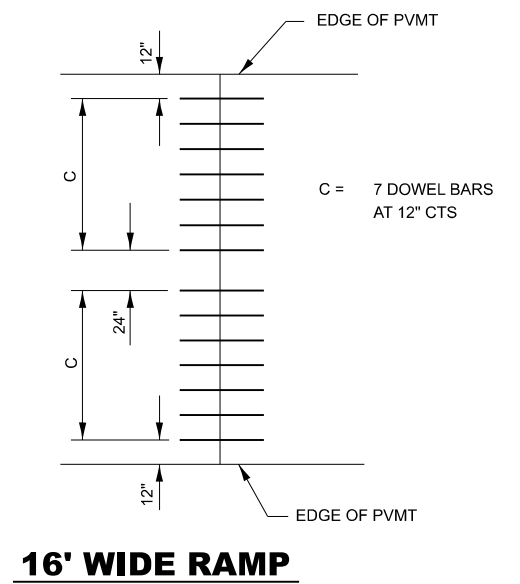
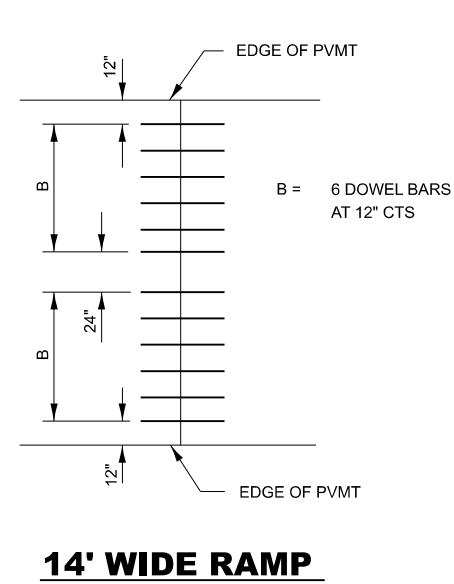
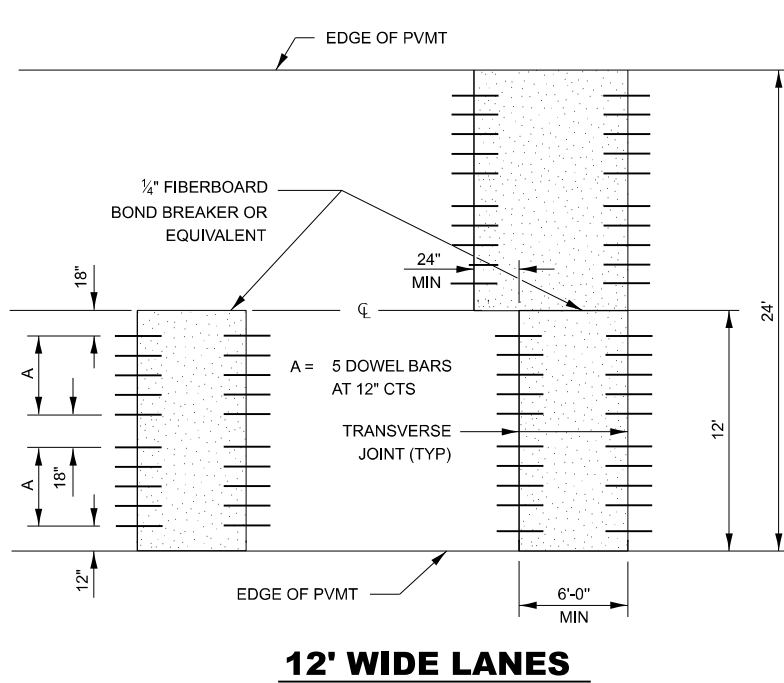
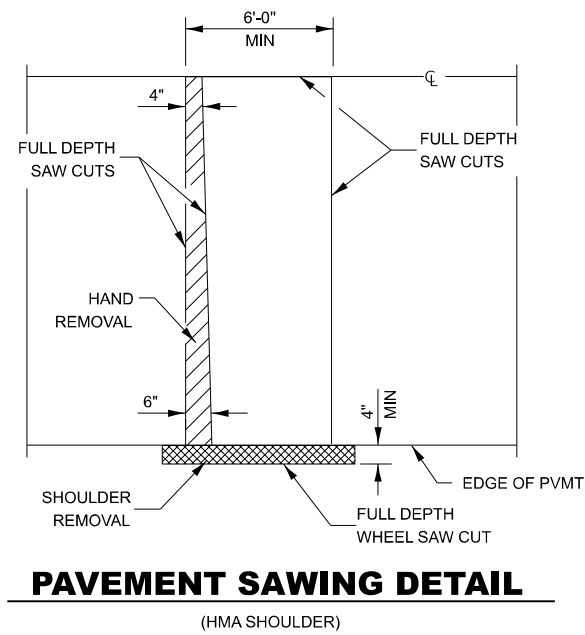

DOWEL BAR TABLE		
PAVEMENT THICKNESS	DOWEL BAR DIAMETER	HOLE DIAMETER
8" OR GREATER	1 1/2"	1 5/8"
7" THRU 7.99"	1 1/4"	1 3/8"
LESS THAN 7"	1"	1 1/8"

**GENERAL NOTES**

THE TRANSVERSE JOINTS FOR CLASS B PATCHES SHALL ALIGN WITH JOINTS OR CRACKS IN THE ADJACENT LANE WHENEVER POSSIBLE.

SEE STANDARD 420701 FOR DETAILS OF PAVEMENT WELDED WIRE REINFORCEMENT.

MODEL: Default  
FILE NAME: c:\p\work\pav\detail\zagar\k0941336\0366P11-Details.dgn

USER NAME = Joshua.Ferguson	DESIGNED -	REVISED -
	DRAWN -	REVISED -
	CHECKED -	REVISED -
PLOT DATE = 7/2/2024	DATE -	REVISED -

STATE OF ILLINOIS  
DEPARTMENT OF TRANSPORTATION

**CLASS B PATCHING DETAILS**

SCALE: SHEET OF SHEETS STA. TO STA.

F.A.P. RTE.	SECTION	COUNTY	TOTAL SHEETS	SHEET NO.
607	(125,126)RS-4	*	22	20
*LASALLE & KENDALL			CONTRACT NO. 66P11	
ILLINOIS   FED. AID PROJECT				

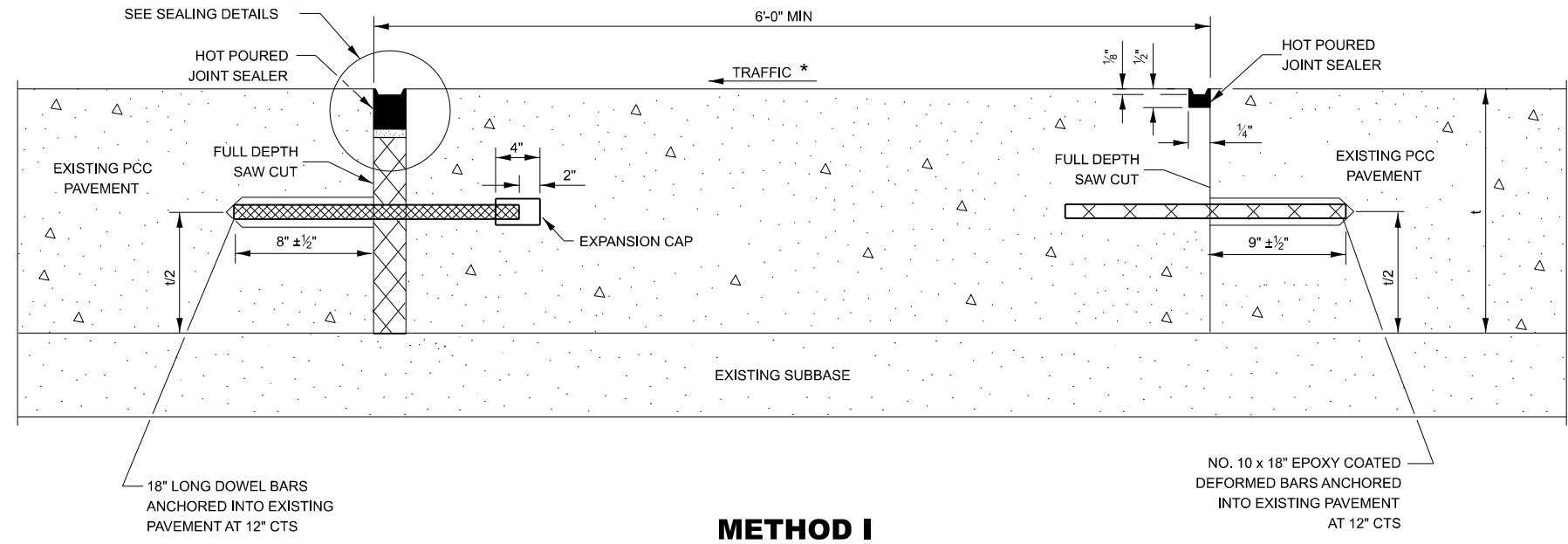

**METHOD I**  
(WITHOUT HMA OVERLAY)

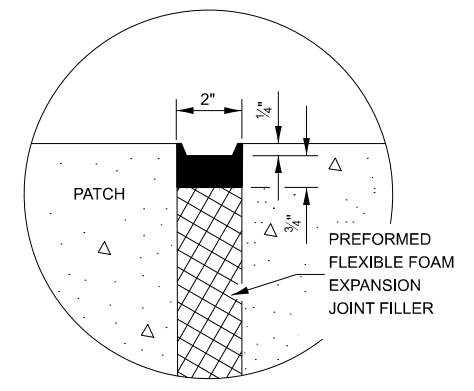

**SEALING DETAIL**

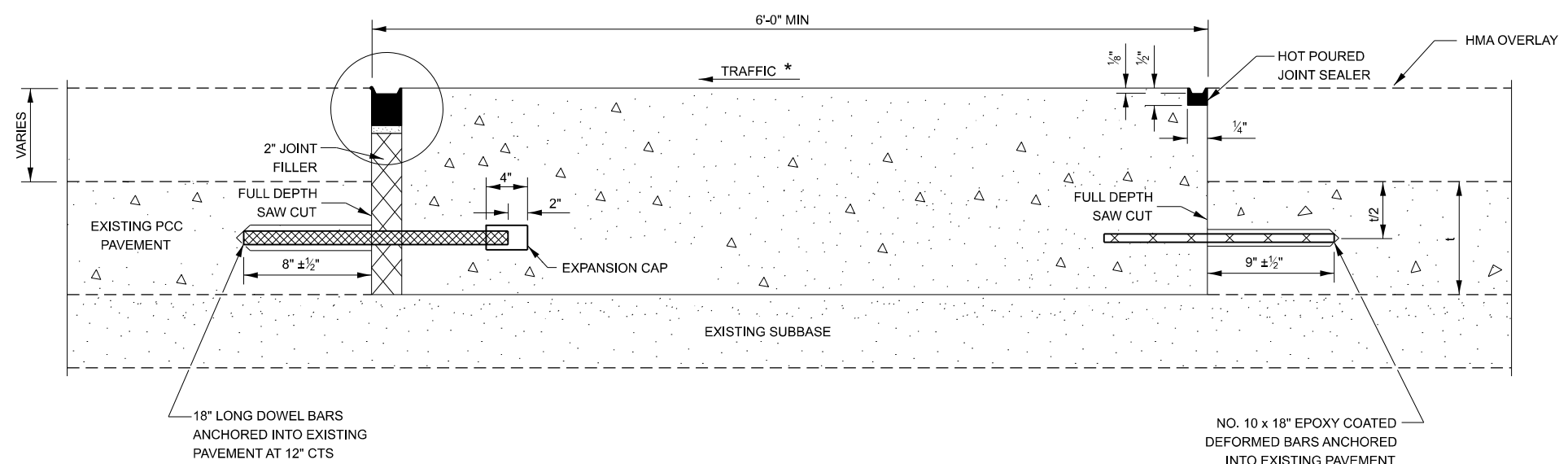

**METHOD II**  
(WITH HMA OVERLAY)

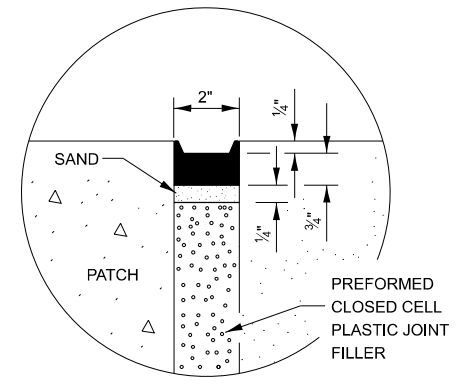

**SEALING DETAIL**

**NOTE**

\* WHEN RE-ESTABLISHING A TRANSVERSE EXPANSION JOINT ON A TWO-WAY ROAD, REVERSE THE ORIENTATION OF THE DOWEL BARS WITH RESPECT TO TRAFFIC FOR ONE OF THE PATCHES SUCH THAT THE JOINT WILL BE CONTINUOUS ACROSS BOTH LANES.

MODEL: Default  
FILE NAME: c:\p\work\pav\detail\zagar\k0941336\0366P11-Details.dgn

USER NAME = Joshua.Ferguson	DESIGNED -	REVISED -	<b>STATE OF ILLINOIS DEPARTMENT OF TRANSPORTATION</b>	<b>CLASS B PATCHING DETAILS</b>				F.A.P. RTE.	SECTION	COUNTY	TOTAL SHEETS	SHEET NO.
	DRAWN -	REVISED -		607	(125,126)RS-4	*	22	21				
	CHECKED -	REVISED -		*LASALLE & KENDALL				CONTRACT NO. 66P11				
PLOT DATE = 7/2/2024	DATE -	REVISED -		SCALE:	SHEET	OF	SHEETS	STA.	TO STA.	ILLINOIS	FED. AID PROJECT	

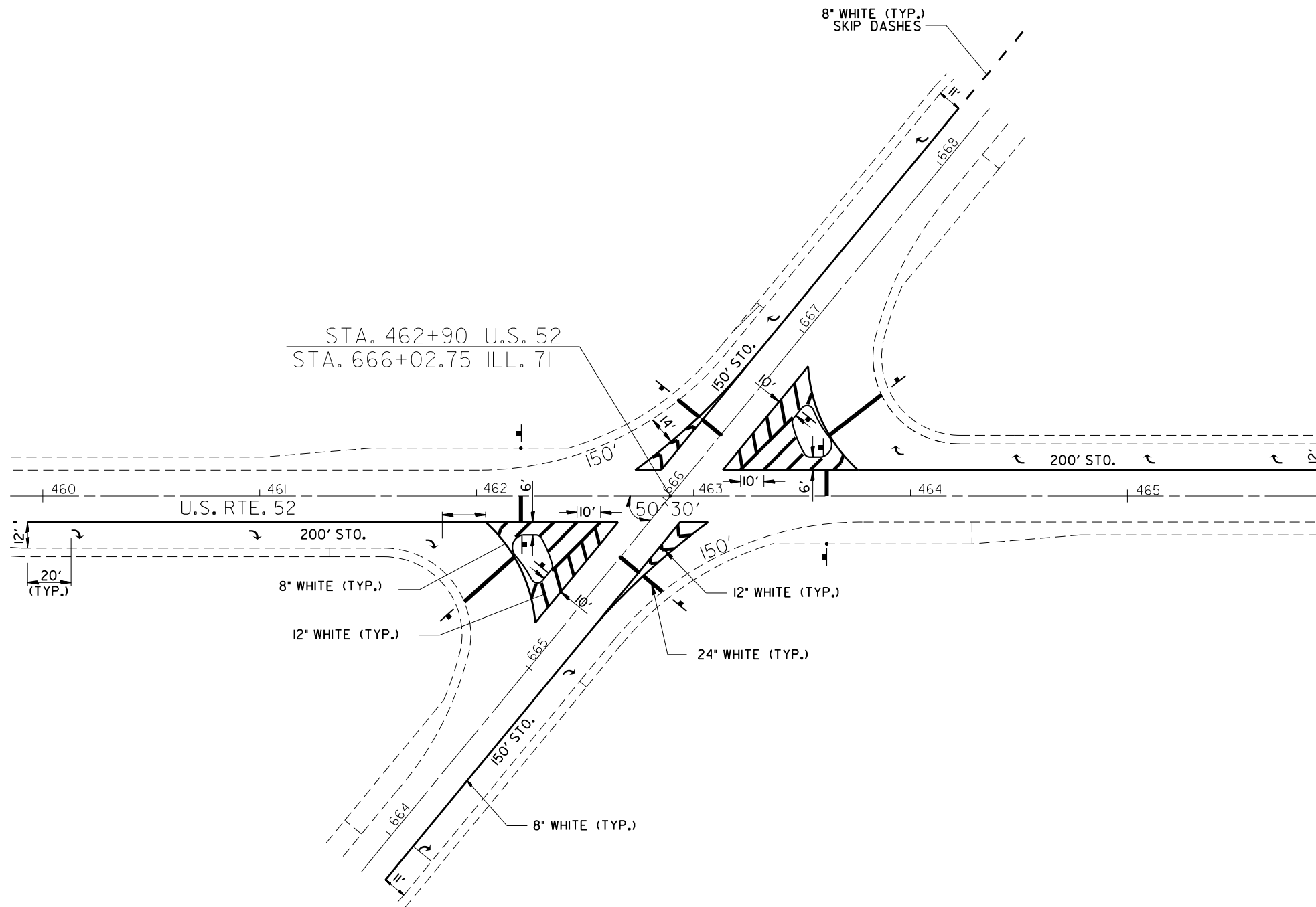

IL 72 and US 52 INTERSECTION DETAIL  
FOR INFORMATION ONLY

MODEL: Default  
FILE NAME: c:\p\work\pav\vid\zagar\k0941336\0366P11-Details.dgn

USER NAME = Joshua.Ferguson	DESIGNED -	REVISED -
	DRAWN -	REVISED -
	CHECKED -	REVISED -
PLOT DATE = 7/2/2024	DATE -	REVISED -

**STATE OF ILLINOIS  
DEPARTMENT OF TRANSPORTATION**

**DETAILS**

SCALE: SHEET OF SHEETS STA. TO STA.

F.A.P. RTE.	SECTION	COUNTY	TOTAL SHEETS	SHEET NO.
607	(125,126)RS-4	*	22	22
*LASALLE & KENDALL		CONTRACT NO. 66P11		
ILLINOIS FED. AID PROJECT				