

STATE OF ILLINOIS  
DEPARTMENT OF TRANSPORTATION

**PROPOSED  
HIGHWAY PLANS**

**FAP 71 (IL 54 / IL 115), FAS 340 (IL 115),  
FAP 798 (IL 115)  
SECTION (109,110)RS-2  
PROJECT STP-HSIP-AP6S(188)  
DESIGNED OVERLAY WITH  
SAFETY SHOULDERS  
FORD COUNTY**

* FAP 71 (IL 54 / IL 115), FAS 340 (IL 115), FAP 798 (IL 115)			
F.A. RTE.	SECTION	COUNTY	TOTAL SHEETS
*	(109,110)RS-2	FORD	21
ILLINOIS			SHEET NO. 1
CONTRACT NO. 66P19			

INDEX OF SHEETS

- 1 COVER SHEET
- 2 GENERAL NOTES
- 3-6 SUMMARY OF QUANTITIES
- 7 LINE DIAGRAM
- 8-9 TYPICAL SECTIONS
- 10 PERMANENT SURVEY MARKER
- 11-15 SCHEDULES
- 16-21 DETAILS

LIST OF ILLINOIS DOT HIGHWAY STANDARDS

000001-08	STANDARD SYMBOLS, ABBREVIATIONS AND PATTERNS
001006	DECIMAL OF AN INCH AND OF A FOOT
406201-01	MAILBOX TURNOUT
442101-09	CLASS B PATCHES
482001-02	HMA SHOULDER ADJACENT TO FLEXIBLE PAVEMENT
642006-01	SHOULDER RUMBLE STRIPS, 8 INCH
667101-02	PERMANENT SURVEY MARKERS
701001-02	OFF-ROAD OPERATIONS 2L, 2W, MORE THAN 15' AWAY
701201-05	LANE CLOSURE, 2L, 2W, DAY ONLY, FOR SPEEDS ≥ 45 MPH
701306-04	LANE CLOSURE, 2L, 2W, SLOW MOVING OPERATIONS DAY ONLY, FOR SPEEDS ≥ 45 MPH
701311-03	LANE CLOSURE, 2L, 2W, MOVING OPERATIONS - DAY ONLY
701901-09	TRAFFIC CONTROL DEVICES
725001-01	OBJECT AND TERMINAL MARKERS
780001-05	TYPICAL PAVEMENT MARKINGS
781001-04	TYPICAL APPLICATIONS RAISED REFLECTIVE PAVEMENT MARKERS
701326-04	LANE CLOSURE, 2L, 2W, PAVEMENT WIDENING FOR SPEEDS ≥ 45 MPH

D-93-033-24

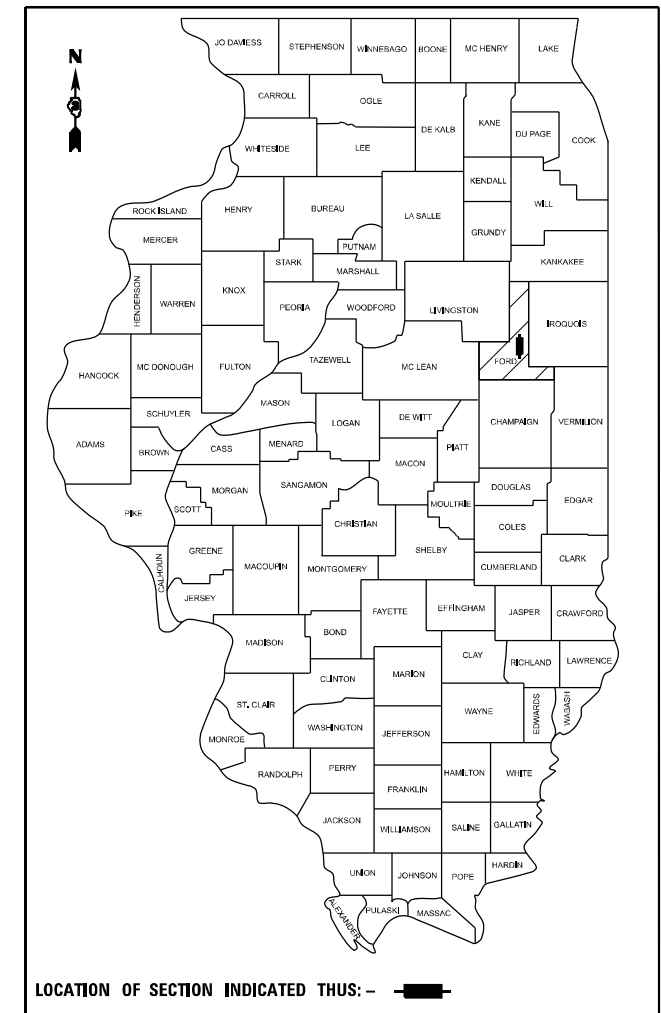

LOCATION OF SECTION INDICATED THIS: - ■ -

C-93-068-24

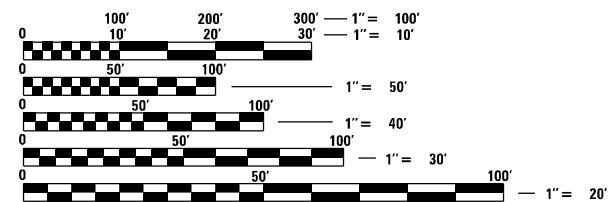
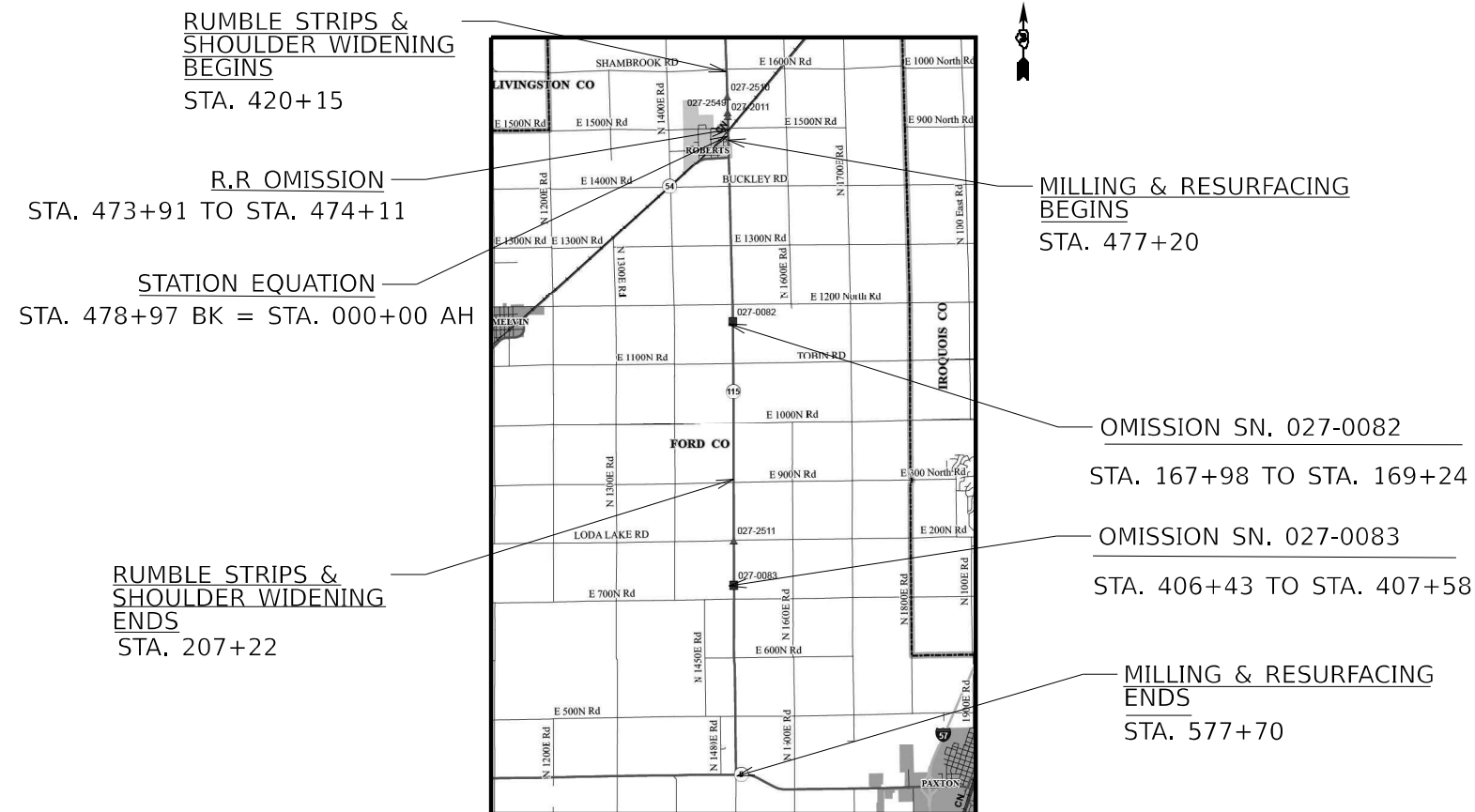

FULL SIZE PLANS HAVE BEEN PREPARED USING STANDARD ENGINEERING SCALES, REDUCED SIZED PLANS WILL NOT CONFORM TO STANDARD SCALES. IN MAKING MEASUREMENTS ON REDUCED PLANS, THE ABOVE SCALES MAY BE USED.

J.U.L.I.E.  
JOINT UTILITY LOCATION INFORMATION FOR EXCAVATION  
1-800-892-0123  
OR 811

**PROJECT ENGINEER: JOE KANNEL, PE**  
**UNIT CHIEF: MOHAMED YOUSIF**  
**DISTRICT 3 NO. (815) 434-6131**  
**CONTRACT NO. 66P19**

GROSS LENGTH = 58,132.8 FT. = 11.01 MILE  
NET LENGTH = 58,070.8 FT. = 10.9 MILE

MINOR ARTERIAL RURAL  
2021 ADT = 1900  
PV=85.6% SU=5.5% MU=8.9%

STATE OF ILLINOIS  
DEPARTMENT OF TRANSPORTATION

SUBMITTED June 13, 2024

*Trisha Thompson* REGIONAL ENGINEER

August 16, 2024

*Scott A. Elk* ENGINEER OF DESIGN AND ENVIRONMENT

August 16, 2024

*James J. ...* DIRECTOR OF HIGHWAYS PROJECT IMPLEMENTATION

**PRINTED BY THE AUTHORITY  
OF THE STATE OF ILLINOIS**

**GENERAL NOTES**

THE HMA SURFACE OF ALL MAILBOX TURNOUTS, PRIVATE ENTRANCES, COMMERCIAL ENTRANCES, AND SIDE ROADS SHALL BE MADE NEATLY, IN A WORKMANLIKE MANNER, AND SHALL ACCURATELY CONFORM TO THE SHAPES AND DIMENSIONS SHOWN ON THE PLAN DETAILS. IF REQUIRED BY THE ENGINEER, THE CONTRACTOR SHALL SAW CUT THE HMA SURFACE TO CONFORM TO THE SHAPES AND DIMENSIONS SHOWN ON THE PLAN DETAILS. THIS WORK WILL BE INCLUDED IN THE COST OF THE HMA SURFACE.

EXCEPT AS NOTED ON THE PLANS, PAVEMENT GRADES SHOWN ARE AT THE TOP OF PAVEMENT SURFACES.

THE ENGINEER WILL BE THE SOLE JUDGE CONCERNING CURING TIME FOR THE VARIOUS HMA LIFTS.

ON EXISTING PAVEMENT WHICH MAY BE SUPERELEVATED, THE NEW HMA PAVEMENT SHALL BE BUILT WITH THE SAME SUPERELEVATION UNLESS NEW SUPERELEVATION RATES ARE GIVEN ON THE PLANS.

ALL ELEVATIONS REFERRING TO U.S.G.S. MEAN SEA LEVEL DATUM.

THE FOLLOWING RATES OF APPLICATION HAVE BEEN USED IN CALCULATING PLAN QUANTITIES:

GRANULAR MATERIALS	2.05	TONS / CU YD
HMA RESURFACING	112	LBS / SQ YD / IN
SHORT TERM PAVEMENT MARKING	10	FT /100 FT OF APPLICATION
MIX FOR CRACKS, JTS & FLGWYS	0.0003	TONS / SQ YD

MEMEBRS OF JULIE KNOWN TO BE WITHIN THE LIMITS OF THE IMPROVEMENTS ARE: AT&T / DISTRIBUTION, AMEREN ILLINOIS - (NORTH), EASTERN ILLINI ELECTRIC, COOP., FRONTIER COMMUNICATIONS, ZAYOFIBER SOLUTIONS, METRO COMMUNICATIONS CO., NICOR GAS, ONE EARTH ENERGY, LLC, VILLAGE OF ROBERTS

**COMMITMENTS**

None

**HMA MIXTURE REQUIREMENT TABLE**

LOCATIONS:	ENTIRE PROJECT	ENTIRE PROJECT	STA 207+22 TO STA 420+15	STA 207+22 TO STA 420+15	ENTIRE PROJECT
MIXTURE USE(S):	HMA BINDER	HMA SURFACE	HMA SHOULDERS BOTTOM LIFTS @ 4" AND 2.25"	HMA SHOULDERS TOP LIFT @ 1.75"	HMA INCIDENTAL
BINDER GRADE (PG):	PG 64-22	PG 64-22	PG 64-22	PG 64-22	PG 64-22
DESIGN AIR VOIDS:	4.0% @ N50	4.0% @ N50	4.0% @ N50	4.0% @ N50	4.0% @ N50
MIXTURE COMPOSITION: (MIXTURE GRADATION)	IL 19.0	IL 9.5	IL 19.0	IL 9.5	IL 9.5
FRICTION AGGREGATE:	N/A	MIXTURE C	N/A	MIXTURE C	MIXTURE C
MIXTURE WEIGHT:	112.0 LB/SY/IN	112.0 LB/SY/IN	112.0 LB/SY/IN	112.0 LB/SY/IN	112.0 LB/SY/IN
QUALITY MANAGEMENT PROGRAM:	QCP	QCP	QC/QA	QC/QA	QCQA
SUBLOT SIZE:	1000 TONS	1000 TONS	N/A	N/A	N/A
DENSITY TEST METHOD:	CORES	CORES	CORES	CORES	CORES/NUCLEAR
MATERIAL TRANSFER DEVICE (REQUIRED)	YES	YES	NO	NO	NO

STATE OF ILLINOIS  
DEPARTMENT OF TRANSPORTATION  
DISTRICT THREE  
AS BUILT INFORMATION

\_\_\_\_\_  
SUPERVISING CONSTRUCTION FIELD ENGINEER

\_\_\_\_\_  
RESIDENT ENGINEER / TECHNICIAN

START & END DATES  
OF CONSTRUCTION:

INSPECTORS:

MODEL: D:\full... FILE NAME: ...

USER NAME = Mohamed,Yousif	DESIGNED -	REVISED -
	DRAWN -	REVISED -
PLOT SCALE = \$SCALES	CHECKED -	REVISED -
PLOT DATE = 5/29/2024	DATE -	REVISED -

**STATE OF ILLINOIS  
DEPARTMENT OF TRANSPORTATION**

**GENERAL NOTES**

SCALE: SHEET OF SHEETS STA. TO STA.

F.A.* RTE.	SECTION	COUNTY	TOTAL SHEETS	SHEET NO.
*	(109,110)RS-2	FORD	21	2
CONTRACT NO. 66P19				
ILLINOIS FED. AID PROJECT				

\* FAP 71 (IL 54 / IL 115), FAS 340 (IL 115), FAP 798 (IL 115)

CODE NO.	ITEM	UNIT	TOTAL QUANTITY	CONSTRUCTION CODE	
				STP 80% FED & 20% STATE	HSIP 90% FED & 10% STATE
				ROADWAY 0005 RURAL	SAFETY 0021 RURAL
20400800	FURNISHED EXCAVATION	CU YD	105	105	
40200800	AGGREGATE SURFACE COURSE, TYPE B	TON	52	52	
40600290	BITUMINOUS MATERIALS (TACK COAT)	POUND	33656	13112	20544
40600370	LONGITUDINAL JOINT SEALANT	FOOT	57947	57947	
40600400	MIXTURE FOR CRACKS, JOINTS, AND FLANGEWAYS	TON	45	45	
40600900	HOT-MIX ASPHALT BINDER COURSE (HAND METHOD), N50	TON	75	75	
40600990	TEMPORARY RAMP	SQ YD	457	457	
40603080	HOT-MIX ASPHALT BINDER COURSE, IL-19.0, N50	TON	18869	18869	
40604050	HOT-MIX ASPHALT SURFACE COURSE, IL-9.5, MIX "C", N50	TON	12579	12579	
40800050	INCIDENTAL HOT-MIX ASPHALT SURFACING	TON	620	620	
42000060	WELDED WIRE REINFORCEMENT	SQ YD	612	612	
44000164	HOT-MIX ASPHALT SURFACE REMOVAL, 3 3/4"	SQ YD	149754	149754	
44201019	CLASS B PATCHES, TYPE II, 14 INCH	SQ YD	266	266	
44201023	CLASS B PATCHES, TYPE III, 14 INCH	SQ YD	396	396	

MODEL: D:\in\it...  
FILE NAME: ...

USER NAME = Mohamed.Youssif	DESIGNED -	REVISED -
PLOT SCALE = \$SCALE\$	DRAWN -	REVISED -
PLOT DATE = 6/26/2024	CHECKED -	REVISED -
	DATE -	REVISED -

**STATE OF ILLINOIS  
DEPARTMENT OF TRANSPORTATION**

**SUMMARY OF QUANTITIES**

SCALE: SHEET OF SHEETS STA. TO STA.

F.A.* RTE.	SECTION	COUNTY	TOTAL SHEETS	SHEET NO.
-	(109,110)RS-2	FORD	21	3
CONTRACT NO. 66P19				
ILLINOIS FED. AID PROJECT				

\*FAP 798 (IL 115), FAP 71 (IL 115/IL 54), FAS 340 (IL 115)

CODE NO.	ITEM	UNIT	TOTAL QUANTITY	CONSTRUCTION CODE	
				STP 80% FED & 20% STATE	HSIP 90% FED & 10% STATE
				ROADWAY	SAFETY
				0005 RURAL	0021 RURAL
44201025	CLASS B PATCHES, TYPE IV, 14 INCH	SQ YD	216	216	
44201299	DOWEL BARS 1 1/2"	EACH	1080	1080	
44213200	SAW CUTS	FOOT	3256	3256	
48102100	AGGREGATE WEDGE SHOULDER, TYPE B	TON	4379	4379	
48203029	HOT-MIX ASPHALT SHOULDERS, 8"	SQ YD	22812		22812
64200108	SHOULDER RUMBLE STRIPS, 8 INCH	FOOT	51526		51526
* 66700205	PERMANENT SURVEY MARKERS, TYPE I	EACH	20	20	
* 66900200	NON-SPECIAL WASTE DISPOSAL	CU YD	353		353
* 66900530	SOIL DISPOSAL ANALYSIS	EACH	6		6
* 66901001	REGULATED SUBSTANCES PRE-CONSTRUCTION PLAN	L SUM	1		1
* 66901003	REGULATED SUBSTANCES FINAL CONSTRUCTION REPORT	L SUM	1		1
* 66901006	REGULATED SUBSTANCES MONITORING	CAL DA	2		2
67000400	ENGINEER'S FIELD OFFICE, TYPE A	CAL MO	4	3	1
67100100	MOBILIZATION	L SUM	1	1	

\*= SPECIALTY ITEM

MODEL: D:\infra...  
 FILE NAME: ...  
 ...

USER NAME = Mohamed.Yousif	DESIGNED -	REVISED -	<b>STATE OF ILLINOIS DEPARTMENT OF TRANSPORTATION</b>	<b>SUMMARY OF QUANTITIES</b>				F.A. RTE.	SECTION	COUNTY	TOTAL SHEETS	SHEET NO.
PLOT SCALE = \$SCALE\$	CHECKED -	REVISED -						*	(109,110)RS-2	FORD	21	4
PLOT DATE = 6/26/2024	DATE -	REVISED -		SCALE:	SHEET	OF	SHEETS	STA.	TO STA.	CONTRACT NO. 66P19		
										ILLINOIS FED. AID PROJECT		

CODE NO.	ITEM	UNIT	TOTAL QUANTITY	CONSTRUCTION CODE	
				STP	HSIP
				80% FED & 20% STATE ROADWAY	90% FED & 10% STATE SAFETY
				0005 RURAL	0021 RURAL
70100450	TRAFFIC CONTROL AND PROTECTION, STANDARD 701201	L SUM	1	1	
70100460	TRAFFIC CONTROL AND PROTECTION, STANDARD 701306	L SUM	1	1	
70100500	TRAFFIC CONTROL AND PROTECTION, STANDARD 701326	L SUM	1		1
70300100	SHORT TERM PAVEMENT MARKING	FOOT	8079	8079	
70300150	SHORT TERM PAVEMENT MARKING REMOVAL	SQ FT	2693	2693	
* 72501000	TERMINAL MARKER - DIRECT APPLIED	EACH	10	10	
* 78000200	THERMOPLASTIC PAVEMENT MARKING - LINE 4"	FOOT	180	180	
* 78004600	PREFORMED PLASTIC PAVEMENT MARKING, TYPE D - STANDARD - LETTERS AND SYMBOLS	SQ FT	245	245	
* 78004640	PREFORMED PLASTIC PAVEMENT MARKING, TYPE D - STANDARD - LINE 8"	FOOT	444	444	
* 78004660	PREFORMED PLASTIC PAVEMENT MARKING, TYPE D - STANDARD - LINE 12"	FOOT	139	139	
* 78004720	PREFORMED PLASTIC PAVEMENT MARKING, TYPE D - STANDARD - LINE 24"	FOOT	165	165	
* 78009004	MODIFIED URETHANE PAVEMENT MARKING - LINE 4"	FOOT	306158	306158	
* 78009006	MODIFIED URETHANE PAVEMENT MARKING - LINE 6"	FOOT	29104	29104	
* 78011000	GROOVING FOR RECESSED PAVEMENT MARKING, LETTERS AND SYMBOLS	SQ FT	245	245	

\*= SPECIALTY ITEM

MODEL: Default  
FILE NAME: P:\Illinois\Projects\66P19\CAD\Drawings\DOT\Office\Drawings\66P19\CAD\Drawings\66P19\Sheet-600.dwg

USER NAME = Mohamed, Yousof	DESIGNED -	REVISED -	<b>STATE OF ILLINOIS DEPARTMENT OF TRANSPORTATION</b>	<b>SUMMARY OF QUANTITIES</b>				F.A.* RTE.	SECTION	COUNTY	TOTAL SHEETS	SHEET NO.
PLOT SCALE = \$SCALES	CHECKED -	REVISED -						*	(109,110)RS-2	FORD	21	5
PLOT DATE = 6/26/2024	DATE -	REVISED -		SCALE:	SHEET	OF	SHEETS	STA.	TO STA.	CONTRACT NO. 66P19		
										ILLINOIS FED. AID PROJECT		

CODE NO.	ITEM	UNIT	TOTAL QUANTITY	CONSTRUCTION CODE	
				STP	HSIP
				80% FED & 20% STATE	90% FED & 10% STATE
				ROADWAY	SAFETY
				0005	0021
				RURAL	RURAL
* 78011035	GROOVING FOR RECESSED PAVEMENT MARKING 7"	FOOT	180	180	
* 78011125	GROOVING FOR RECESSED PAVEMENT MARKING 25"	FOOT	165	165	
* 78100100	RAISED REFLECTIVE PAVEMENT MARKER	EACH	796	796	
78300200	RAISED REFLECTIVE PAVEMENT MARKER REMOVAL	EACH	796	796	
X4401198	HOT-MIX ASPHALT SURFACE REMOVAL, VARIABLE DEPTH	SQ YD	4178	4178	
X4404262	SHOULDER REMOVAL (SPECIAL)	SQ YD	22812		22812
Z0030850	TEMPORARY INFORMATION SIGNING	SQ FT	42	21	21
∅ Z0076600	TRAINEES	HOUR	1,000	1,000	
Z0034105	MATERIAL TRANSFER DEVICE	TON	31448	31448	
∅ Z0076604	TRAINEES - TRAINING PROGRAM GRADUATE	HOUR	1,000	1,000	
Z0048665	RAILROAD PROTECTIVE LIABILITY INSURANCE	L SUM	1	1	

∅ 0042  
 \*= SPECIALTY ITEM

MODEL: D:\b\1111...  
 FILE NAME: p:\11111111\11111111\11111111\11111111\11111111\11111111\11111111\11111111\11111111\11111111.dgn

USER NAME = Mohamed.Yousif	DESIGNED -	REVISED -
PLOT SCALE = \$\$CALE\$	DRAWN -	REVISED -
PLOT DATE = 6/26/2024	CHECKED -	REVISED -
	DATE -	REVISED -

**STATE OF ILLINOIS**  
**DEPARTMENT OF TRANSPORTATION**

SCALE:		SHEET	OF	SHEETS	STA.	TO STA.
--------	--	-------	----	--------	------	---------

**SUMMARY OF QUANTITIES**

F.A. RTE.	SECTION	COUNTY	TOTAL SHEETS	SHEET NO.
*	(109,110)RS-2	FORD	21	6
			CONTRACT NO. 66P19	
ILLINOIS   FED. AID PROJECT				

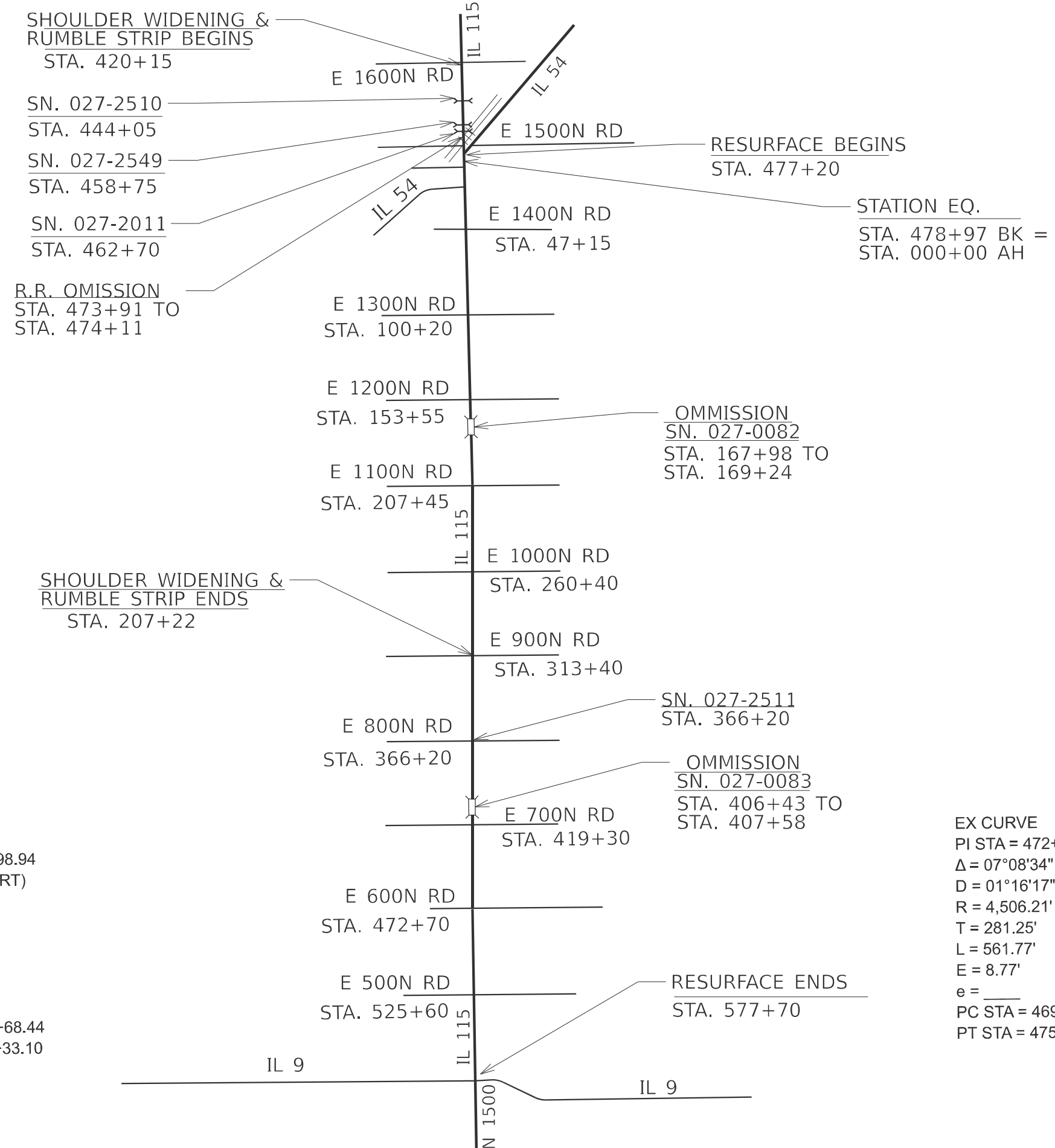

EX CURVE  
 PI STA = 478+98.94  
 $\Delta = 06^\circ 27' 56''$  (RT)  
 $D = 01^\circ 24' 14''$   
 $R = 4,080.88'$   
 $T = 230.50'$   
 $L = 460.51'$   
 $E = 6.50'$   
 $e =$  \_\_\_\_\_  
 PC STA = 476+68.44  
 PT STA = 481+33.10

EX CURVE  
 PI STA = 472+49.66  
 $\Delta = 07^\circ 08' 34''$  (LT)  
 $D = 01^\circ 16' 17''$   
 $R = 4,506.21'$   
 $T = 281.25'$   
 $L = 561.77'$   
 $E = 8.77'$   
 $e =$  \_\_\_\_\_  
 PC STA = 469+68.41  
 PT STA = 475+30.19

MODEL: Default  
 FILE NAME: I:\projects\2024\66P19\115\115\115.dwg

USER NAME = Mohamed.Yousif	DESIGNED -	REVISED -
	DRAWN -	REVISED -
PLOT SCALE = 1:1	CHECKED -	REVISED -
PLOT DATE = 6/5/2024	DATE -	REVISED -

**STATE OF ILLINOIS  
 DEPARTMENT OF TRANSPORTATION**

LOCATION MAP	
SCALE:	SHEET OF SHEETS STA. TO STA.

F.A. RTE.	SECTION	COUNTY	TOTAL SHEETS	SHEET NO.
*	(109,110)RS-2	FORD	21	7
CONTRACT NO. 66P19				
ILLINOIS FED. AID PROJECT				

\*FAP 798 (IL 115), FAP 71 (IL 115/IL 54), FAS 340 (IL 115)

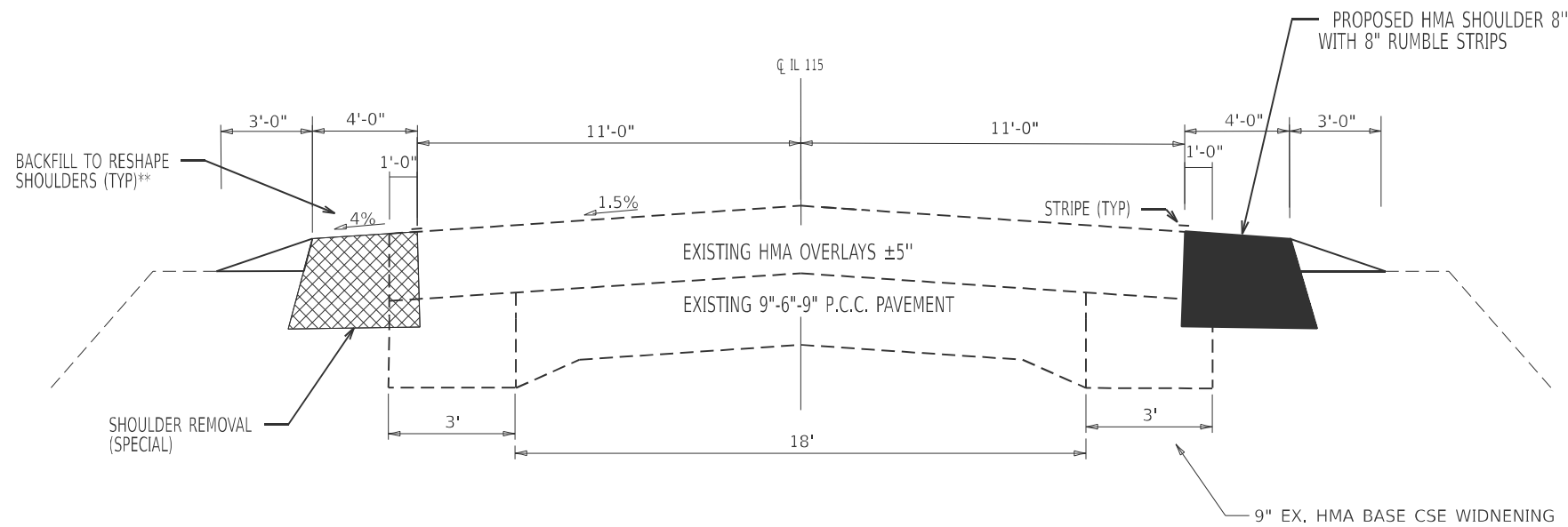

**PROPOSED TYPICAL SECTION 1**

STA 420+15 TO STA 460+24  
 STA 460+24.00 BK = STA 460+21.08 AH STATION EQUATION  
 STA 460+21 TO STA 473+97  
 STA 473+91 TO STA 474+11 RAILROAD OMISSION  
 STA 474+06 TO STA 477+20

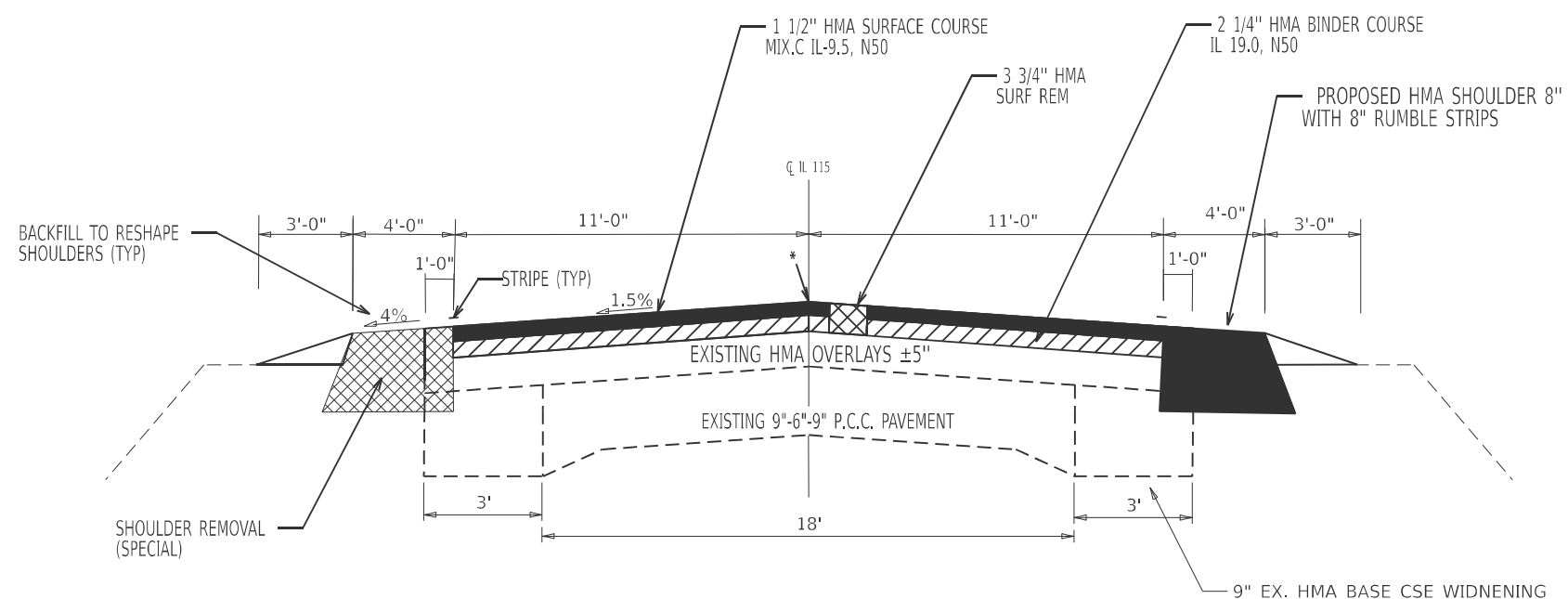

**PROPOSED TYPICAL SECTION 2**

STA 477+20 TO STA 478+97  
 STA 478+97 BK = STA 0+00 AH STATION EQUATION  
 STA 0+00 TO STA 19+30  
 STA 21+50 TO STA 167+98  
 STA 167+98 TO STA 169+24 SN 027-0082 OMISSION PCC  
 STA 169+24 TO STA 207+22

\* LONGITUDINAL JOINT SEALANT IS TO BE PLACED UNDER THE HMA SURFACE

MODEL: D:\infra\...  
 FILE NAME: ...  
 PROJECT: ...  
 DATE: 6/5/2024

USER NAME = Mohamed.Yousif	DESIGNED -	REVISED -
DRAWN -	REVISED -	
PLOT SCALE = SCALES	CHECKED -	REVISED -
PLOT DATE = 6/5/2024	DATE -	REVISED -

**STATE OF ILLINOIS  
 DEPARTMENT OF TRANSPORTATION**

**TYPICAL SECTION**

SCALE: SHEET OF SHEETS STA. TO STA.

F.A. RTE.	SECTION	COUNTY	TOTAL SHEETS	SHEET NO.
*	(109,110)RS-2	FORD	21	8
CONTRACT NO. 66P19				



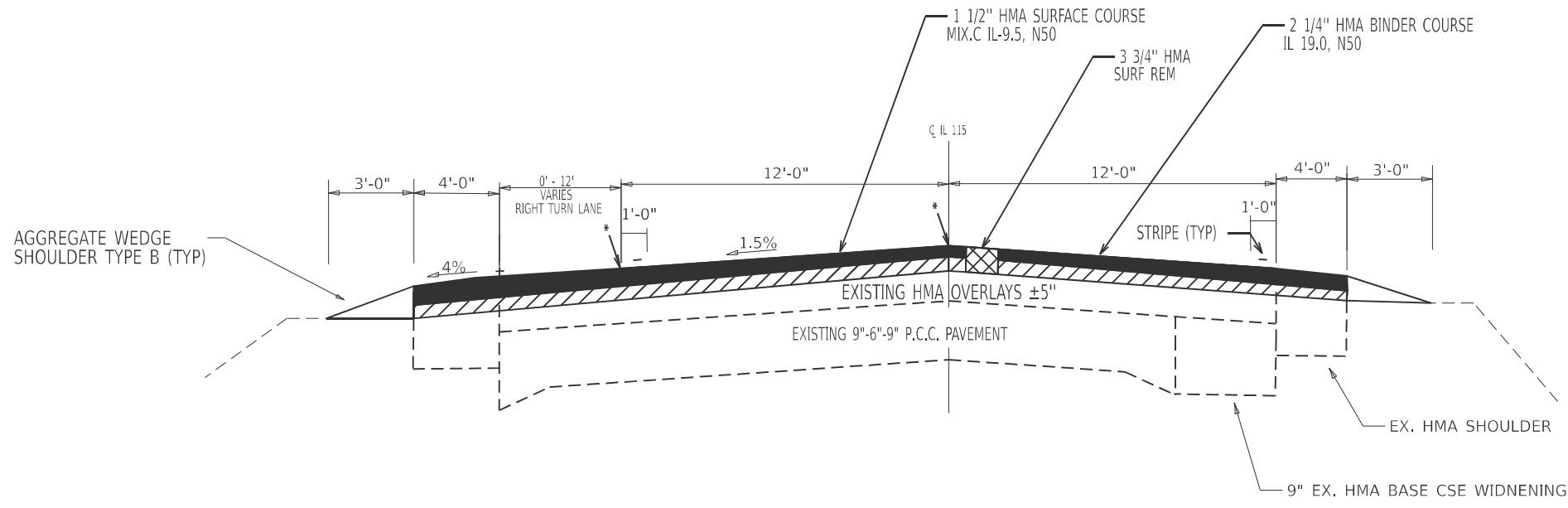

**PROPOSED TYPICAL SECTION 3**  
 STA 19+30 TO STA 21+50

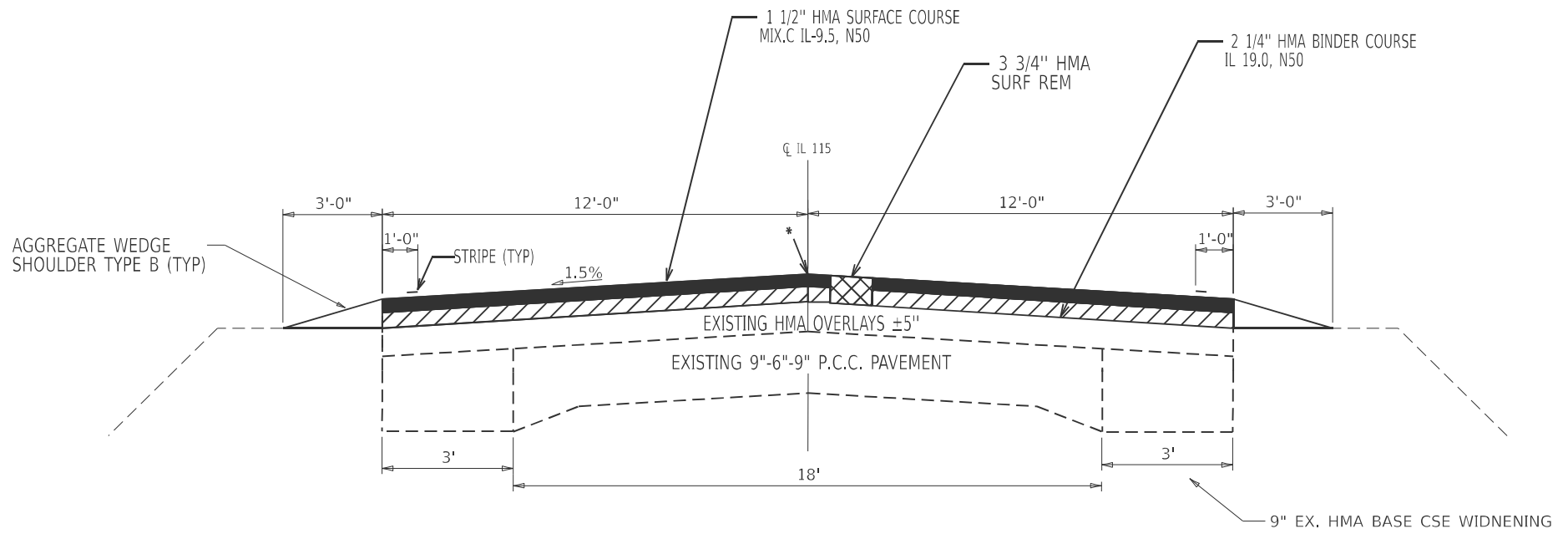

**PROPOSED TYPICAL SECTION 4**  
 STA 207+22 TO STA 406+43  
 STA 406+43 TO STA 407+58 SN 027-0083 OMISSION PCC  
 STA 407+58 TO STA 577+70

\* LONGITUDINAL JOINT SEALANT IS TO BE PLACED UNDER THE HMA SURFACE

MODEL: D:\in\...  
 FILE NAME: ...  
 PROJECT: ...  
 DATE: 6/5/2024

USER NAME = Mohamed.Yousif	DESIGNED -	REVISED -
DRAWN -	REVISED -	
PLOT SCALE = \$SCALE\$	CHECKED -	REVISED -
PLOT DATE = 6/5/2024	DATE -	REVISED -

**STATE OF ILLINOIS  
 DEPARTMENT OF TRANSPORTATION**

**TYPICAL SECTION**

SCALE: SHEET OF SHEETS STA. TO STA.

F.A. RTE.	SECTION	COUNTY	TOTAL SHEETS	SHEET NO.
*	(109,110)RS-2	FORD	21	9
CONTRACT NO. 66P19				

GPS NUMBER	DESCRIPTION	APPROXIMATE LOCATION	MONUMENT TYPE	MONUMENT TYPE	RECORD TO BE RECORDED	RESPONSIBILITY
115076	W QTR CORNER SECTION 22, T25N, R9E, 3RD PM	ILL RTE 54(S) / ILL RTE 115 INTERSECTION	MAG NAIL W/ WASHER	TYPE 1	YES	1
A115076	PRIVATE SURVEY MARKER	1320 FEET S OF RTE 54(S) INTERSECTION	MAG NAIL	MAG NAIL	NO	2
115075	NW CORNER SECTION 27, T25N, R9E, 3RD PM	1400 N RD INTERSECTION	TYPE 1	TYPE 1	YES	1
A115075	PRIVATE SURVEY MARKER	573 FEET N OF W QTR COR SEC 27	MAG NAIL	MAG NAIL	NO	2
115074	W QTR CORNER SECTION 27, T25N, R9E, 3RD PM	1/2 MI S OF 1400 N RD INTERSECTION	PK NAIL	TYPE 1	YES	1
115073	SW CORNER SECTION 27, T25N, R9E, 3RD PM	1300 N RD INTERSECTION	MAG NAIL	TYPE 1	YES	1
115072	W QTR CORNER SECTION 34, T25N, R9E, 3RD PM	1/2 MI S OF 1300 N RD INTERSECTION	MAG NAIL	TYPE 1	YES	1
115070	NW CORNER SECTION 3, T24N, R9E, 3RD PM	1200 N RD INTERSECTION	MAG NAIL	TYPE 1	YES	1
115068	SW CORNER SECTION 3, T24N, R9E, 3RD PM	1100 N RD INTERSECTION	TYPE 1	TYPE 1	YES	1
115067	W QTR CORNER SECTION 10, T24N, R9E, 3RD PM	1/2 MI S OF 1200N RD INTERSECTION	MISSING	TYPE 1	YES	1
115066	SW CORNER SECTION 10, T24N, R9E, 3RD PM	1000 N RD INTERSECTION	MISSING	TYPE 1	YES	1
115065	W QTR CORNER SECTION 15, T24N, R9E, 3RD PM	1/2 MI S OF 1000N RD INTERSECTION	MAG NAIL W/ WASHER	TYPE 1	YES	1
A115065	PRIVATE SURVEY MARKER	1653 FEET N OF 900 N RD INTERSECTION	MAG NAIL	MAG NAIL	NO	2
115064	SW CORNER SECTION 15, T24N, R9E, 3RD PM	900 N RD INTERSECTION	TYPE 1	TYPE 1	YES	1
115063	SW CORNER SECTION 22, T24N, R9E, 3RD PM	800 N RD INTERSECTION	MAG NAIL W/ WASHER	TYPE 1	YES	1
A115063	PRIVATE SURVEY MARKER	659 FEET S OF 800 N RD INTERSECTION	MAG NAIL	MAG NAIL	NO	2
B115063	PRIVATE SURVEY MARKER	1320 FEET S OF 800 N RD INTERSECTION	MAG NAIL	MAG NAIL	NO	2
115062	W QTR CORNER SECTION 27, T24N, R9E, 3RD PM	1/2 MI S OF 800 N RD INTERSECTION	MAG NAIL	TYPE 1	YES	1
115060	NW CORNER SECTION 34, T24N, R9E, 3RD PM	700 N RD INTERSECTION	TYPE 1	TYPE 1	YES	1
155059	W QTR CORNER SECTION 34, T24N, R9E, 3RD PM	1/2 MI S OF 700N RD INTERSECTION	ROD W/ ALUM. CAP	TYPE 1	YES	1
115058	SW CORNER SECTION 34, T24N, R9E, 3RD PM	600 N RD INTERSECTION	ROD W/ ALUM. CAP	TYPE 1	YES	1
115057	NW CORNER SECTION 3, T23N, R9E, 3RD PM	600 N RD INTERSECTION	MISSING	TYPE 1	YES	1
115056	W QTR CORNER SECTION 3, T23N, R9E, 3RD PM	1/2 MI S OF 600N RD INTERSECTION	MISSING	TYPE 1	YES	1
115055	SW CORNER SECTION 3, T23N, R9E, 3RD PM	500 N RD INTERSECTION	MISSING	TYPE 1	YES	1
115054	W QTR CORNER SECTION 10, T23N, R9E, 3RD PM	1/2 MI S OF 500N RD INTERSECTION	MISSING	TYPE 1	YES	1

ONLY THE ORIGINAL SCOPE OF THIS JOB HAS BEEN SEARCHED FOR MONUMENTS. R.E. MUST INFORM PLATS AND PLANS TO SEARCH FOR ADDITIONAL MONUMENTS PRIOR TO MILLING IF ADDENDUMS HAVE BEEN ADDED TO THIS JOB.

R.E. WILL INFORM PLATS AND PLANS WHEN SURFACE IS TO BE MILLED FOR THE PURPOSE OF LOCATING MONUMENTS NOTED AS MISSING.

UNKNOWN MONUMENTS MAY EXIST. IF AN UNLISTED MONUMENT IS FOUND, R.E. IS REQUIRED TO PROTECT THE MONUMENT FROM DAMAGE UNTIL A PLATS AND PLANS LAND SURVEYOR CAN DOCUMENT THE MONUMENT. PLATS AND PLANS WILL RESET SUCH MONUMENTS IN KIND FOLLOWING CONSTRUCTION.

UPON PAVING COMPLETION, R.E. WILL DIRECT PLATS AND PLANS TO STAKE THE TYPE 1 PSM CORING LOCATIONS.

TYPE 1 TOTALS ARE SUBJECT TO CHANGE BASED ON THE RESULTS OF THE MILLED ROAD MONUMENTS SEARCH.

NOTE: FOR BIDDING PURPOSES, NO CONTRACTED LAND SURVEYING SERVICES WILL BE REQUIRED FOR SETTING THE LISTED PERMANENT SURVEY MARKERS. PLATS AND PLANS WILL PREPARE THE REQUIRED MONUMENT RECORDS.

**RESPONSIBILITY:**

- 1) RESIDENT TO RE-ESTABLISH MONUMENT (PAY ITEM REQUIRED. PERMANENT SURVEY MARKER, TYPE 1)
- 2) PLATS AND PLANS TO RE-ESTABLISH MONUMENT

MODEL: Default  
FILE NAME: P:\Illinois\Projects\DOT\Documents\DOT Office\Bids\13CRD\Project\13CRD\CAD\Drawings\BPP1\Sheet\sheet\_bpp1.dgn

USER NAME = Mohamed.Yousif	DESIGNED -	REVISED -
PLOT SCALE = \$SCALES	DRAWN -	REVISED -
PLOT DATE = 6/6/2024	CHECKED -	REVISED -
	DATE -	REVISED -

**STATE OF ILLINOIS  
DEPARTMENT OF TRANSPORTATION**

**SCHEDULE OF QUANTITIES**

SCALE: SHEET OF SHEETS STA. TO STA.

F.A.* RTE.	SECTION	COUNTY	TOTAL SHEETS	SHEET NO.
*	(109,110)RS-2	FORD	21	10
CONTRACT NO. 66P19				
ILLINOIS FED. AID PROJECT				

**MAINLINE SCHEDULE**

LOCATION		LENGTH	MAINLINE WIDTH	HMA SURFACE REMOVAL	HMA SURF.CSE MIX.C	BINDER COURSE	HMA BINDER CSE (HM)	MATERIAL TRANSFER DEVICE	MIX FOR JTS, CRACKS & FLGWYS	BIT. MAT'L (TACK COAT)	LONG JOINT SEAL	AGG WEDGE SHLD TY B	TEMP RAMP
STA	STA	FT	FT	3 3/4" SQ YD	IL-9.5,N50 1 1/2" TONS	N50 2 1/4" TONS	N50 TON	TON	TONS	POUND	FOOT	TONS	SQ YD
477+20.	478+97.	177	22	433	36.3	55		90.9	0.1	32	177	13.4	30.6
STA 478+97.15 BK = STA 0+00 AH													
0+00	7+00.	700	22	1711	143.7	216	1	359.3	0.5	128	700	53.1	
7+00.	16+55.	955	22	2334	196.1	294	1	490.2	0.7	175	955	72.5	
16+55.	19+30.	275	36	1100	92.4	139	1	231.0	0.3	83	550	20.9	
19+30.	21+50.	220	28	684	57.5	86		143.7	0.2	51	220	16.7	
21+50.	47+20.	2570	22	6282	527.7	792	3	1319.3	1.9	471	2570	195.1	
47+20.	81+00.	3380	22	8262	694.0	1041	4	1735.1	2.5	620	3380	256.6	
STA. 81+00 BK = STA. 81+05 AH													
81+05.	100+00.	1895	22	4632	389.1	584	2	972.8	1.4	347	1895	143.9	
100+00.	112+00.	1200	22	2933	246.4	370	2	616.0	0.9	220	1200	91.1	
112+01.	139+00.	2699	22	6598	554.2	831	3	1385.5	2.0	495	2699	204.9	
139+00.	158+99.	1999	22	4886	410.5	616	2	1026.2	1.5	366	1999	151.8	
STA 158+99.96 BK = STA. 159+05.40 AH													
159+05.	167+98.	893	22	2183	183.4	275	1	458.4	0.7	164	893	67.8	
167+98.	169+24.	126	22	SN 027-0082 OMISSION PCC									61.1
169+24.	181+00.	1176	22	2875	241.5	362	1	603.7	0.9	216	1176	89.3	
STA 181+00.00 BK = STA. 181+04.00 AH													
181+04.	207+22.	2618	22	6400	537.6	806	3	1343.9	1.9	480	2618	198.8	
207+22.	235+00.	2778	24	7408	622.3	933	4	1555.7	2.2	556	2778	210.9	
235+00.	248+98.	1398	24	3728	313.2	470	2	782.9	1.1	280	1398	106.1	
248+98.	279+03.	3005	24	8013	673.1	1010	4	1682.8	2.4	601	3005	228.2	
279+03.	327+00.	4797	24	12792	1074.5	1612	6	2686.3	3.8	959	4797	364.2	
327+00.	346+99.	1999	24	5331	447.8	672	3	1119.4	1.6	400	1999	151.8	
346+99.	385+02.	3803	24	10141	851.9	1278	5	2129.7	3.0	761	3803	288.7	
385+02.	406+43.	2141	24	5709	479.6	719	3	1199.0	1.7	428	2141	162.6	
406+43.	407+58.	115	24	SN 027-0083 OMISSION PCC									66.7
407+58.	419+40.	1182	24	3152	264.8	397	2	661.9	0.9	236	1182	89.7	
STA. 419+40 BK = STA. 419+47 AH													
419+47.	431+40.	1193	24	3181	267.2	401	2	668.1	1.0	239	1193	90.6	
STA. 431+40 BK = STA. 431+42 AH													
431+42.	481+28.	4986	24	13296	1116.9	1675	7	2792.2	4.0	997	4986	378.6	
STA 481+28.95BK = STA 481+33.10AH													
481+33.	534+40.	5307	24	14152	1188.8	1783	7	2971.9	4.2	1061	5307	402.9	
STA. 534+40 BK = STA. 534+44 AH													
534+44.	577+70.	4326	24	11536	969.0	1454	6	2422.6	3.5	865	4326	328.5	33.3
<b>TOTALS</b>				<b>149754</b>	<b>12579</b>	<b>18869</b>	<b>75</b>	<b>31448</b>	<b>45</b>	<b>11232</b>	<b>57947</b>	<b>4379</b>	<b>192</b>

MODEL: D:\h\h\...  
 FILE NAME: ...

USER NAME = Mohamed.Yousif	DESIGNED -	REVISED -
PLOT SCALE = \$SCALE\$	DRAWN -	REVISED -
PLOT DATE = 6/13/2024	CHECKED -	REVISED -
	DATE -	REVISED -

**STATE OF ILLINOIS  
DEPARTMENT OF TRANSPORTATION**

**SCHEDULE OF QUANTITIES**

SCALE: SHEET OF SHEETS STA. TO STA.

F.A. RTE.	SECTION	COUNTY	TOTAL SHEETS	SHEET NO.
*	(109,110)RS-2	FORD	21	11
CONTRACT NO. 66P19				
ILLINOIS FED. AID PROJECT				

**SHOULDER REMOVAL & REPLACEMENT SCHEDULE**

LOCATION		SIDE	LENGTH	SHOULDER REMOVAL (SPECIAL)	HMA SHOULDER 8"	BIT MTL TACK COAT	SHOULDER RUMBLE STRIPS, 8"
STA	TO STA	LT/RT	FOOT	SQ YD	SQ YD	POUND	FOOT
420+15	TO 423+40	LT & RT	325	289	289	261	650
423+40	TO 424+15	LT & RT	75	67	67	61	150
424+15	TO 426+90	LT & RT	275	245	245	221	550
426+90	TO 445+80	LT & RT	1,890	1,680	1,680	1,512	3,780
SN 027-2510 STA 444+05							
445+80	TO 460+24	LT & RT	1,444	1,284	1,284	1,156	2,888
SN 027-2549 STA 458+75							
STATION EQUATION: STA 460+24.00 BK = STA 460+21.08 AH							
460+21	TO 473+40	LT & RT	1,319	1,173	1,173	1,056	2,638
SN 027-2011 STA 462+70							
473+40	TO 473+91	LT & RT	51	46	46	42	102
STA 474+01 R.R OMISSION				RAILROAD OMISSION			
474+11	TO 474+40	LT & RT	29	26	26	24	58
STA 475+00 IL 54							
474+40	TO 476+60	RT	220	98	98	89	440
476+60	TO 477+20	LT & RT	60	54	54	49	120
477+20	TO 478+97	LT & RT	177	158	158	143	354
STATION EQUATION: STA 487+97.15 BK = STA 0+00.00 AH							
0+00	TO 7+17	LT & RT	717	638	638	575	1,434
10+25	TO 19+30	LT & RT	905	805	805	725	1,810
STA 20+30 IL 54							
21+50	TO 46+90	LT & RT	2,540	2,258	2,258	2,033	5,080
STA 47+15 E 1400 N RD							
47+60	TO 81+00	LT & RT	3,340	2,969	2,969	2,673	6,680
STATION EQUATION: STA 81+00.00 BK = STA 81+05.00 AH							
81+05	TO 100+05	LT & RT	1,900	1,689	1,689	1,521	3,800
STA 100+20 E 1300 RD							
100+67	TO 112+00	LT & RT	1,133	1,008	1,008	908	2,266
STATION EQUATION: STA 112+00.00 BK = STA 81+01.00 AH							
112+01	TO 153+28	LT & RT	4,127	3,669	3,669	3,303	8,254
STA 153+55 E 1200 N RD							
153+85	TO 168+15	LT & RT	1,430	1,272	1,272	1,145	2,860
SN 027-0082 BRIDGE OMISSION							
169+12	TO 181+00	LT & RT	1,188	1,056	1,056	951	2,376
STATION EQUATION: STA 181+00.00 BK = STA 181+04.00 AH							
181+04	TO 207+22	LT & RT	2,618	2,328	2,328	2,096	5,236
<b>TOTAL</b>			<b>25,763</b>	<b>22,812</b>	<b>22,812</b>	<b>20,544</b>	<b>51,526</b>

MODEL: D:\inf\...  
 FILE NAME: ...

USER NAME = Mohamed, Yousif	DESIGNED -	REVISED -	<b>STATE OF ILLINOIS DEPARTMENT OF TRANSPORTATION</b>	<b>SCHEDULE OF QUANTITIES</b>				F.A. RTE.	SECTION	COUNTY	TOTAL SHEETS	SHEET NO.
PLOT SCALE = \$SCALE\$	CHECKED -	REVISED -						*	(109,110)RS-2	FORD	21	12
PLOT DATE = 5/30/2024	DATE -	REVISED -		SCALE:	SHEET	OF	SHEETS	STA.	TO STA.	CONTRACT NO. 66P19		
										ILLINOIS FED. AID PROJECT		

**SIDE ROADS & ENTRANCES SCHEDULE**

STATION	TYPE	SIDE	MATER	WIDTH FRONT	WIDTH BACK	VARIABLE DEPTH SURF REM	INCIDENTAL HMA SURF	BIT MATL (TACK COAT)	AGG SURF CSE TY B	FURNISH EX	SEEDING CLASS 2A*	NITROGEN FERTILIZER NUTRIENT *	PHOSPHORUS FERTILIZER NUTRIENT *	POTASSIUM FERTILIZER NUTRIENT *	TEMP RAMP
						SQ YD	TON	POUND	TON	CU YD	ACRE	POUND	POUND	POUND	SQ YD
477+45	PE	RT	HMA	50	23	40.6	6.0	18.3							
1+50	CE	RT	HMA	148	134	156.7	23.2	70.5							
3+35	PE	RT	HMA	28	16	24.4	3.6	11.0							
3+90	DILKS ST	RT	HMA	43	14	95.0	14.1	42.8							7.8
5+00	PE	RT	HMA	51	31	45.6	6.8	20.5							
6+25	PE	RT	HMA	21	11	17.8	2.6	8.0							
7+50	CE	RT	HMA	298	292	327.8	48.6	147.5							
7+50	CE/PE	LT	HMA	114	100	118.9	17.6	53.5							
10+00	E WELDON ST	RT	HMA	34	20	90.0	13.4	40.5							11.1
10+40	CE	LT	HMA	56	38	52.2	7.7	23.5							
12+30	CE	LT	HMA	61	42	57.2	8.5	25.8							
13+60	PE	LT	HMA	45	23	37.8	5.6	17.0							
20+30	IL 54	RT	HMA	220	102	536.7	79.6	241.5		5.0	0.002	0.2	0.2	0.2	56.7
30+55	FE	LT	AGG	23	12				5.2						
47+15	E 1400 NORTH RD	LT	HMA	68	21	148.3	22.0	66.8		5.0	0.002	0.2	0.2	0.2	11.7
47+15	E 1400 NORTH RD	RT	HMA	69	21	150.0	22.3	67.5		5.0	0.002	0.2	0.2	0.2	11.7
69+00	PE	RT	HMA	25	13	21.1	3.1	9.5							
70+20	PE	RT	HMA	32	13	25.0	3.7	11.3							
96+80	PE/MB	LT	HMA	72	16	48.9	7.3	22.0							
100+20	E 1300 NORTH RD	RT	HMA	44	14	96.7	14.3	43.5		5.0	0.002	0.2	0.2	0.2	7.8
100+20	E 1300 NORTH RD	LT	HMA	47	16	105.0	15.6	47.3		5.0	0.002	0.2	0.2	0.2	8.9
104+30	FE	RT	AGG	24	13				5.9						
112+60	PE	RT	HMA	30	12	23.3	3.5	10.5							
153+55	E 1200 NORTH RD	RT	HMA	62	22	140.0	20.8	63.0		5.0	0.002	0.2	0.2	0.2	12.2
153+55	E 1200 NORTH RD	LT	HMA	62	14	126.7	18.8	57.0		5.0	0.002	0.2	0.2	0.2	7.8
172+55	PE	LT	HMA	24	13	20.6	3.1	9.3							
189+75	FE	RT	AGG	24	12				5.5						
201+50	PE	RI	HMA	27	10	20.6	3.1	9.3							
207+45	E 1100 NORTH RD	RT	HMA	42	16	96.7	14.3	43.5		5.0	0.002	0.2	0.2	0.2	8.9
207+45	E 1100 NORTH RD	LT	HMA	52	16	113.3	16.8	51.0		5.0	0.002	0.2	0.2	0.2	8.9
250+10	PE	RT	HMA	58	12	38.9	5.8	17.5							
260+40	E 1000 NORTH RD	RT	HMA	34	11	75.0	11.1	33.8		5.0	0.002	0.2	0.2	0.2	6.1
260+40	E 1000 NORTH RD	LT	HMA	36	16	86.7	12.9	39.0		5.0	0.002	0.2	0.2	0.2	8.9
307+15	PE	RT	HMA	24	18	23.3	3.5	10.5							
313+40	E 900 NORTH RD	RT	HMA	36	18	90.0	13.4	40.5		5.0	0.002	0.2	0.2	0.2	10.0
313+40	E 900 NORTH RD	LT	HMA	36	16	86.7	12.9	39.0		5.0	0.002	0.2	0.2	0.2	8.9
314+05	CE	RT	HMA	60	54	63.3	9.4	28.5							
314+45	FE	LT	AGG	24	12				5.5						
366+20	E 800 NORTH RD	LT	HMA	60	18	130.0	19.3	58.5		5.0	0.002	0.2	0.2	0.2	10.0
366+40	E 800 NORTH RD	RT	HMA	60	18	130.0	19.3	58.5		5.0	0.002	0.2	0.2	0.2	10.0
374+15	FE	LT	AGG	24	13				5.9						
384+05	PE	RT	HMA	22	10	17.8	2.6	8.0							
384+90	MP	RT	HMA	20	8	6.2	0.9	2.8							
408+05	FE	RT	AGG	24	13				5.9						
419+30	E 700 NORTH RD	RT	HMA	40	16	93.3	13.9	42.0		5.0	0.002	0.2	0.2	0.2	8.9
419+30	E 700 NORTH RD	LT	HMA	40	16	93.3	13.9	42.0		5.0	0.002	0.2	0.2	0.2	8.9
472+70	E 600 NORTH RD	LT	HMA	46	16	103.3	15.3	46.5		5.0	0.002	0.2	0.2	0.2	8.9
472+80	E 600 NORTH RD	RT	HMA	46	16	103.3	15.3	46.5		5.0	0.002	0.2	0.2	0.2	8.9
499+20	PE	LT	HMA	30	14	24.4	3.6	11.0							
525+60	E 500 NORTH RD	RT	HMA	45	18	105.0	15.6	47.3		5.0	0.002	0.2	0.2	0.2	10.0
525+60	E 500 NORTH RD	LT	HMA	48	22	116.7	17.3	52.5		5.0	0.002	0.2	0.2	0.2	12.2
531+70	PE	RT	HMA	35	12	26.1	3.9	11.8							
535+40	PE	RT	HMA	32	18	27.8	4.1	12.5							
552+35	PE	LT	AGG	35	18				12.0						
577+10	FE	LT	AGG	24	13				5.9						
<b>TOTALS</b>						<b>4178</b>	<b>620</b>	<b>1880</b>	<b>52</b>	<b>105</b>	<b>0.04</b>	<b>4</b>	<b>4</b>	<b>4</b>	<b>265.0</b>

\*SEEDING PAY ITEMS WILL NOT BE PAID FOR SEPARATLY, BUT WILL BE INCLUDED IN THE COST OF FURNISHED EXCAVATION

MODEL: Default  
FILE: \\uic-e-prod\share\dot\documents\DOT\Office\B\B\18\CAD\Draws\CAD\Draws\B\B\18\set\set\dot\dot\dot

USER NAME = Mohamed,Yousif	DESIGNED -	REVISED -
	DRAWN -	REVISED -
PLOT SCALE = \$SCALES	CHECKED -	REVISED -
PLOT DATE = 5/30/2024	DATE -	REVISED -

**STATE OF ILLINOIS  
DEPARTMENT OF TRANSPORTATION**

**SCHEDULE OF QUANTITIES**

SCALE: SHEET OF SHEETS STA. TO STA.

F.A.* RTE.	SECTION	COUNTY	TOTAL SHEETS	SHEET NO.
*	(109,110)RS-2	FORD	21	13
CONTRACT NO. 66P19				
ILLINOIS FED. AID PROJECT				



**PAVEMENT MARKING SCHEDULE**

STATION	LOCATION	COMMENT	LENGTH FOOT	MODIFIED URETHANE PM 2 APPLICATIONS		PREFORMED PLASTIC TY D			THERMOPLASTIC RUMBLE STRIP WHITE 4"	GROOVING FOR RECESSED PM			RAISED REF PM	RAISED REF PM REM	TERMINAL MARKER- DIRECT APPLIED		
				LINE 4"		LINE 6"	LINE 8"	LINE 12"		LINE 24"	LTR & SYM	LINE 7"				LINE 25"	LTR & SYM
				EDGE WHITE	NO PASS YELLOW	SKIP DASH YELLOW	ISLAND WHITE	ISLAND WHITE		STOP OR RR X-ING WHITE							
STA 420+15	TO STA 421+11	NO PASSING NB	96	384	192								1	1			
STA 421+11	TO STA 468+70	PASSING	4759	19036									59	59	5		
STA 468+70	TO STA 473+97	NO PASSING SB	527	2108	1054								7	7			
STA 473+97	TO STA 474+06	RR OMISSION	9														
STA 474+06	TO STA 477+20	NO PASSING NB	314	1256	628				72	61				4	4		
STA 477+20	TO STA 478+97	NO PASSING NB	177	708	354	88							2	2			
STA 0+00	AH TO STA 01+93	NO PASSING NB	193	772	386	96				61			2	2			
STA 01+93	TO STA 21+50	PASSING	1957	7828		1038	444	139	33	62			24	24			
STA 21+50	TO STA 60+22	PASSING	3872	15488		1996							53	53			
STA 60+22	TO STA 68+70	NO PASSING SB	848	3392	1696	424							11	11			
STA 68+70	TO STA 80+59	NO PASSING	1189	4756	4756	594							15	15			
STA 80+59	TO STA 89+54	NO PASSING NB	895	3580	1790	448							11	11			
STA 89+54	TO STA 99+16	PASSING	962	3848		482							12	12			
STA 99+16	TO STA 109+70	NO PASSING SB	1054	4216	2108	528							13	13			
STA 109+70	TO STA 110+75	PASSING	105	420		52							1	1			
STA 110+75	TO STA 121+19	NO PASSING NB	1044	4176	2088	522							13	13			
STA 121+19	TO STA 166+48	PASSING	4529	18116		2264							57	57			
STA 166+48	TO STA 176+16	NO PASSING SB	968	3872	1936	484							12	12	1		
STA 176+16	TO STA 180+02	PASSING	386	1544		194							5	5			
STA 180+02	TO STA 187+08	NO PASSING NB	706	2824	1412	354							9	9			
STA 187+08	TO STA 207+22	PASSING	2014	8056		1008							25	25			
STA 207+22	TO STA 239+79	PASSING	3257	13028		1628							41	41			
STA 239+79	TO STA 247+33	NO PASSING SB	754	3016	1508	378							9	9			
SIA 247+33	TO SIA 249+27	PASSING	194	776		98							2	2			
STA 249+27	TO STA 258+02	NO PASSING NB	875	3500	1750	438							11	11			
STA 258+02	TO STA 268+32	PASSING	1030	4120		516							13	13			
STA 268+32	TO STA 280+53	NO PASSING SB	1221	4884	2442	610							15	15			
STA 280+53	TO STA 301+84	NO PASSING	2131	8524	8524	1066							27	27			
STA 301+84	TO STA 313+35	NO PASSING NB	1151	4604	2302	576							14	14			
STA 313+35	TO STA 314+97	NO PASSING NB	162	648	324	82							2	2			
STA 314+97	TO STA 376+70	PASSING	6173	24692		3086							77	77			
STA 376+70	TO STA 382+15	NO PASSING SB	545	2180	1090	272							7	7			
STA 382+15	TO STA 386+10	PASSING	395	1580		198							5	5			
STA 386+10	TO STA 392+61	NO PASSING NB	651	2604	1302	326							8	8			
STA 392+61	TO STA 418+32	PASSING	2571	10284		1286							32	32	4		
STA 418+32	TO STA 428+25	NO PASSING SB	993	3972	1986	496							12	12			
STA 428+25	TO STA 430+94	PASSING	269	1076		134							3	3			
STA 430+94	TO STA 439+77	NO PASSING NB	883	3532	1766	442							11	11			
STA 439+77	TO STA 505+64	PASSING	6587	26348		3294							82	82			
STA 505+64	TO STA 513+82	NO PASSING SB	818	3272	1636	410							10	10			
STA 513+82	TO STA 516+32	PASSING	250	1000		126							3	3			
STA 516+32	TO STA 524+45	NO PASSING NB	813	3252	1626	406							10	10			
STA 524+45	TO STA 526+43	NO PASSING	198	792	792	100							2	2			
STA 526+43	TO STA 532+10	NO PASSING SB	567	2268	1134	284							7	7			
STA 532+10	TO STA 534+71	PASSING	261	1044		130							3	3			
STA 534+71	TO STA 542+08	NO PASSING NB	737	2948	1474	368							9	9			
STA 542+08	TO STA 544+40	PASSING	232	928		116							3	3			
STA 544+40	TO STA 552+50	NO PASSING SB	810	3240	1620	406							10	10			
STA 552+50	TO STA 553+05	NO PASSING	55	220	220	28							1	1			
STA 553+05	TO STA 561+50	NO PASSING NB	845	3380	1690	422							11	11			
STA 561+50	TO STA 577+70	PASSING	1620	6480		810				180	180		20	20			
<b>TOTALS</b>			<b>63652</b>	<b>306158</b>	<b>29104</b>	<b>444</b>	<b>139</b>	<b>165</b>	<b>245</b>	<b>180</b>	<b>180</b>	<b>165</b>	<b>245</b>	<b>796</b>	<b>796</b>	<b>10</b>	

\*RESURFACING LIMITS AT 477+20 TO 577+70  
 \*\* SHOULDERS WIDENING LIMITS ARE 420+15 TO 207+22

MODEL: D:\dell\... FILE NAME: p:\p\illinois\...

USER NAME = Mohamed.Yousif	DESIGNED -	REVISED -
PLOT SCALE = \$SCALES	DRAWN -	REVISED -
PLOT DATE = 5/30/2024	CHECKED -	REVISED -
	DATE -	REVISED -

**STATE OF ILLINOIS  
DEPARTMENT OF TRANSPORTATION**

**SCHEDULE OF QUANTITIES**

SCALE: SHEET OF SHEETS STA. TO STA.

F.A. RTE.	SECTION	COUNTY	TOTAL SHEETS	SHEET NO.
*	(109,110)RS-2	FORD	21	15
CONTRACT NO. 66P19				
ILLINOIS FED. AID PROJECT				

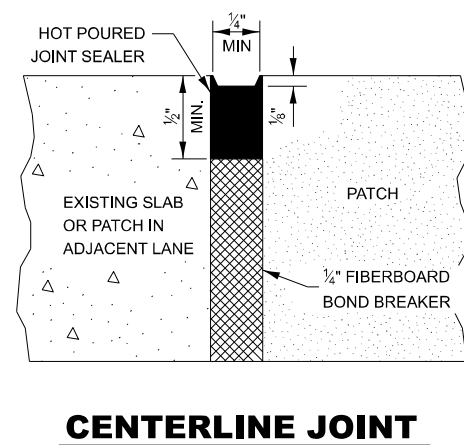
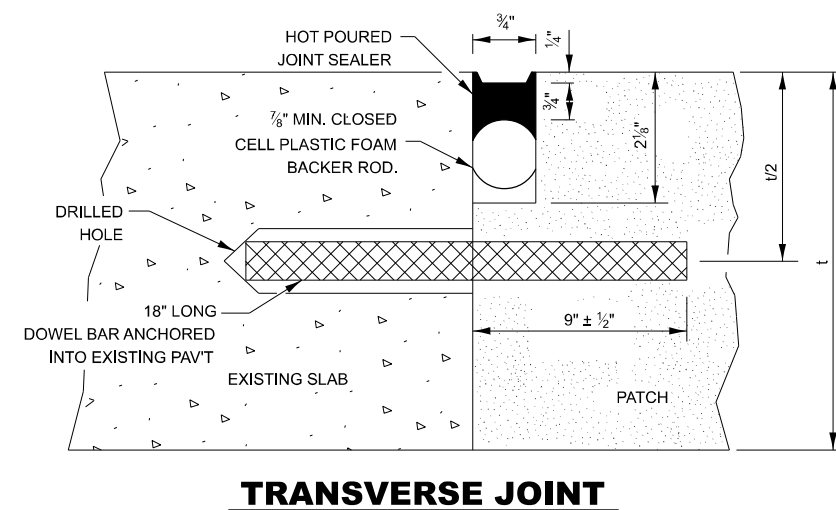
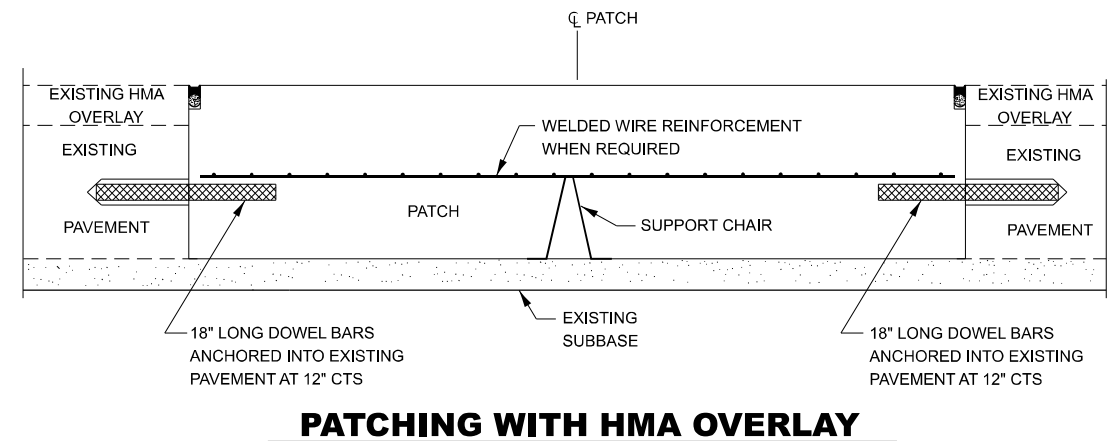
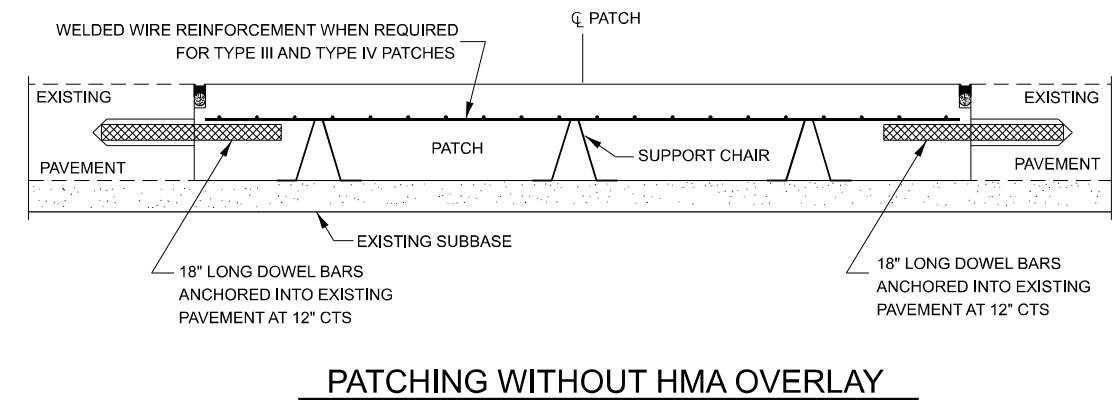
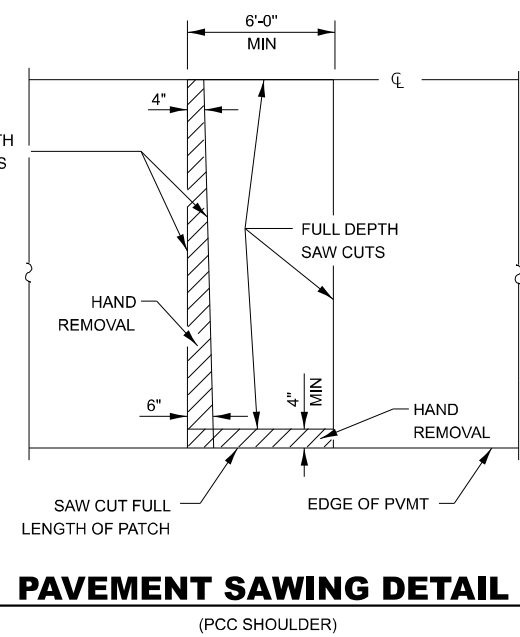
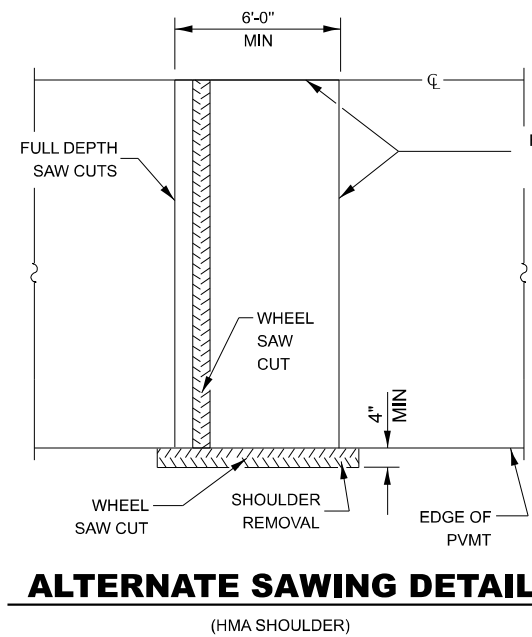
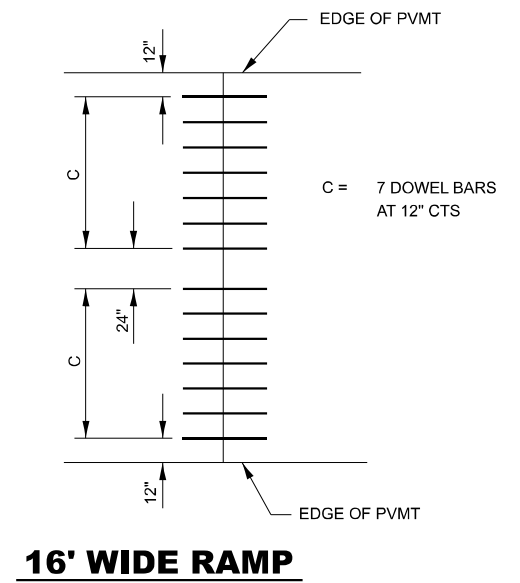
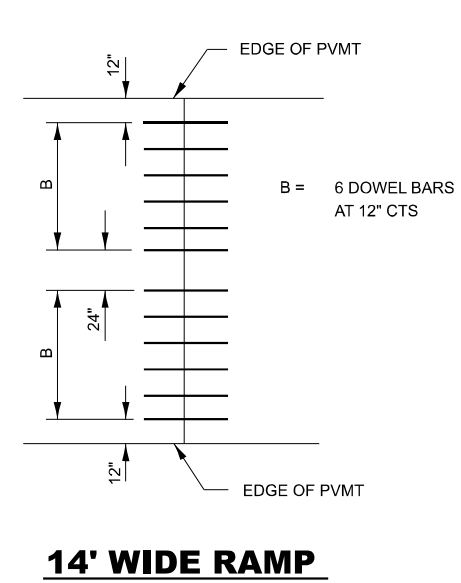
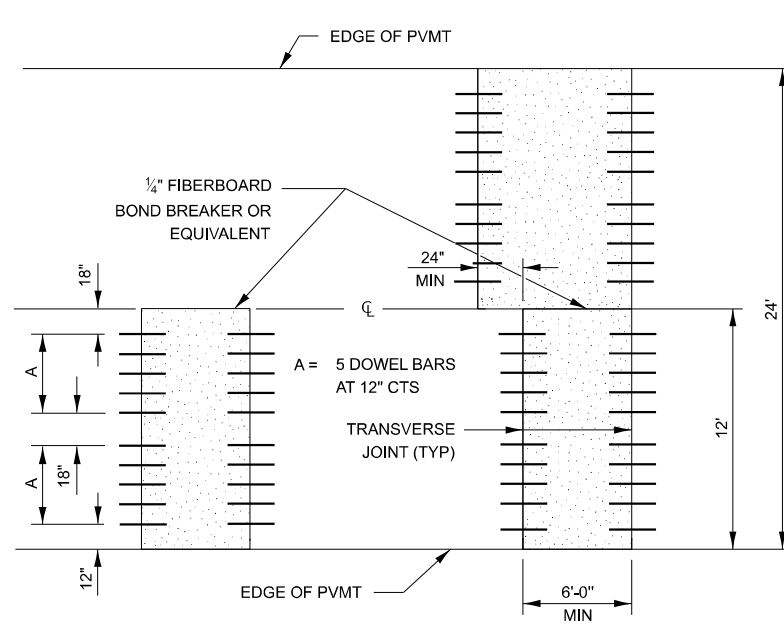
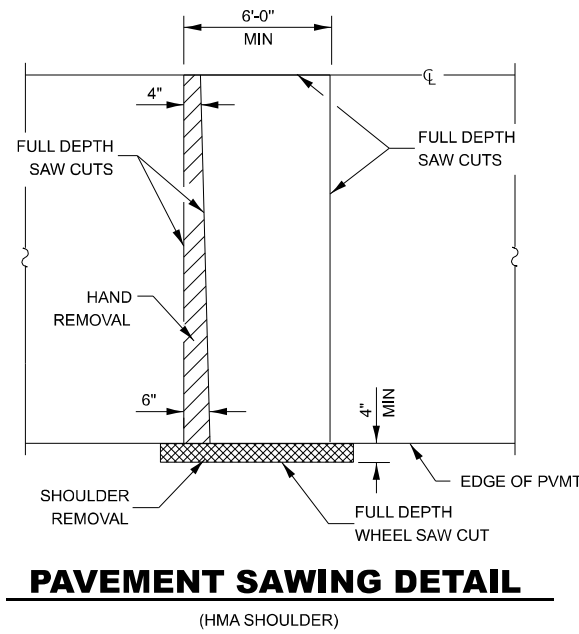

DOWEL BAR TABLE		
PAVEMENT THICKNESS	DOWEL BAR DIAMETER	HOLE DIAMETER
8" OR GREATER	1 1/2"	1 5/8"
7" THRU 7.99"	1 1/2"	1 3/8"
LESS THAN 7"	1"	1 1/8"

**GENERAL NOTES**

THE TRANSVERSE JOINTS FOR CLASS B PATCHES SHALL ALIGN WITH JOINTS OR CRACKS IN THE ADJACENT LANE WHENEVER POSSIBLE.

SEE STANDARD 420701 FOR DETAILS OF PAVEMENT WELDED WIRE REINFORCEMENT.

MODEL - Detail FILE NAME - PavementPatching\DOT Office\Detail 3\ORD Project\0368P18\CAD\Drawings\CAD\Drawings\66P18\sheetdetail.dgn

USER NAME = Mhamed.Yousif	DESIGNED -	REVISED -
PLOT SCALE = \$SCALE\$	DRAWN -	REVISED -
PLOT DATE = 5/29/2024	CHECKED -	REVISED -
	DATE -	REVISED -

**STATE OF ILLINOIS  
DEPARTMENT OF TRANSPORTATION**

**CLASS B PATCHING DETAILS**

SCALE: SHEET OF SHEETS STA. TO STA.

F.A. RTE.	SECTION	COUNTY	TOTAL SHEETS	SHEET NO.
*	(109,110)RS-2	FORD	21	16
CONTRACT NO. 66P19				
ILLINOIS FED. AID PROJECT				



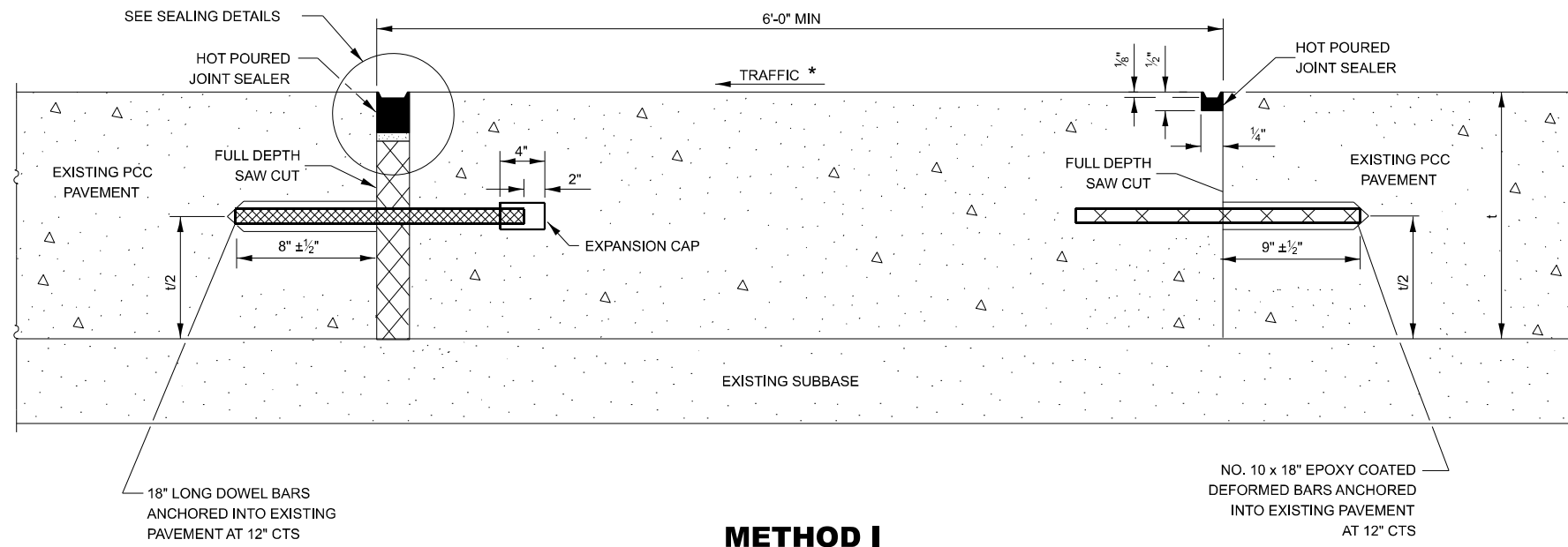

**METHOD I**  
(WITHOUT HMA OVERLAY)

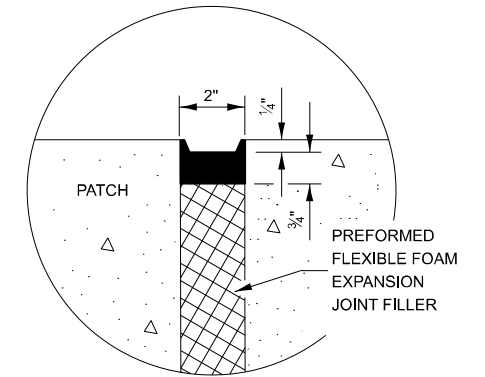

**SEALING DETAIL**

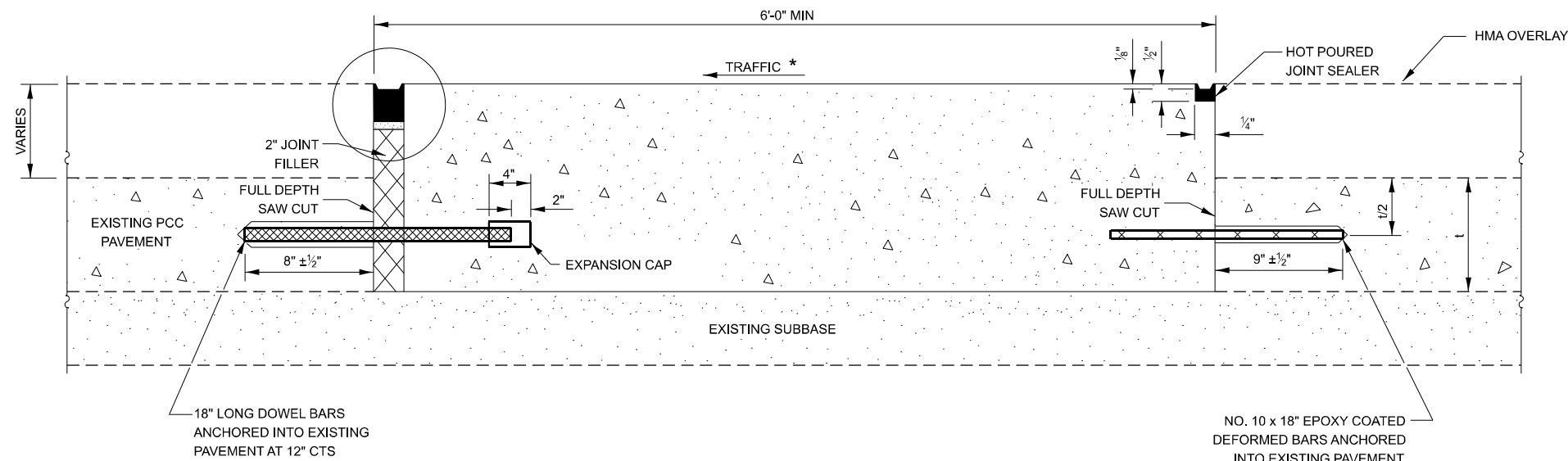

**METHOD II**  
(WITH HMA OVERLAY)

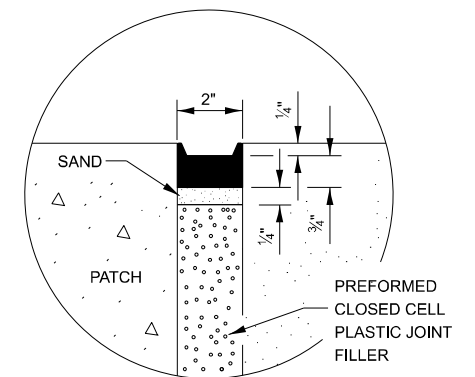

**SEALING DETAIL**

**NOTE**

\* WHEN RE-ESTABLISHING A TRANSVERSE EXPANSION JOINT ON A TWO-WAY ROAD, REVERSE THE ORIENTATION OF THE DOWEL BARS WITH RESPECT TO TRAFFIC FOR ONE OF THE PATCHES SUCH THAT THE JOINT WILL BE CONTINUOUS ACROSS BOTH LANES.

MODEL: D:\draft... FILE NAME: ...

USER NAME = Mohamed.Yousif	DESIGNED -	REVISED -
PLOT SCALE = \$\$SCALE\$	DRAWN -	REVISED -
PLOT DATE = 5/29/2024	CHECKED -	REVISED -
	DATE -	REVISED -

STATE OF ILLINOIS  
DEPARTMENT OF TRANSPORTATION

CLASS B PATCHING DETAILS

SCALE: SHEET OF SHEETS STA. TO STA.

F.A. RTE.	SECTION	COUNTY	TOTAL SHEETS	SHEET NO.
*	(109,110)RS-2	FORD	21	17
CONTRACT NO. 66P19				
ILLINOIS FED. AID PROJECT				

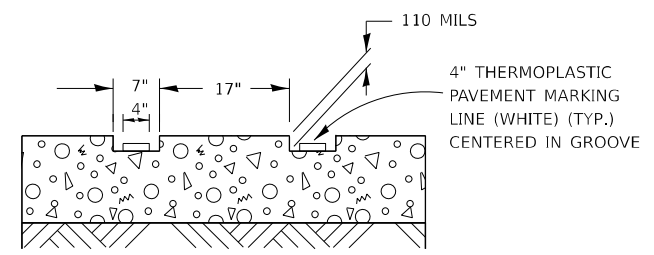
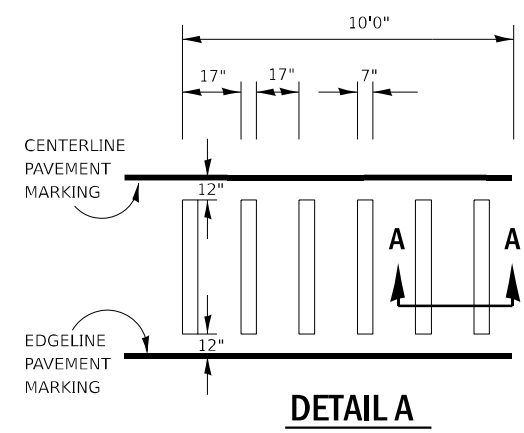
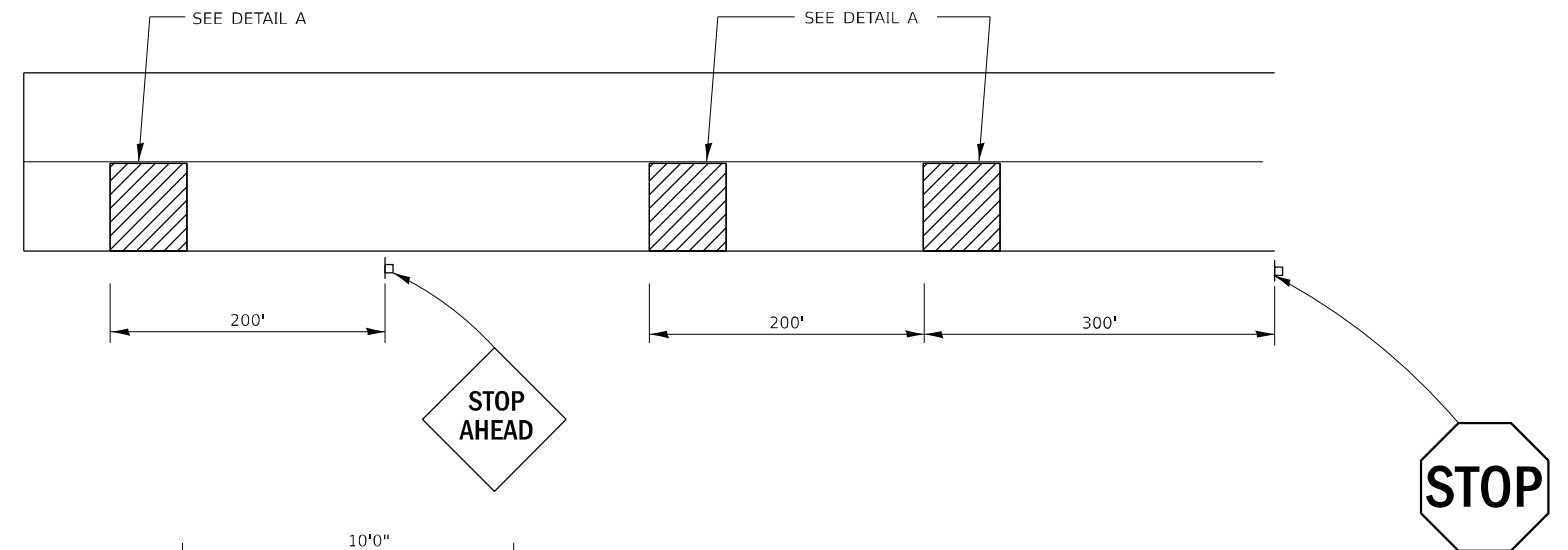

**GROOVED RUMBLE STRIP WITH THERMOPLASTIC PVMT MARKING**  
APPLICATION IN ADVANCE OF AN INTERSECTION

STATE OF ILLINOIS DEPARTMENT OF TRANSPORTATION		DETAILS			F.A. RTE.	SECTION	COUNTY	TOTAL SHEETS	SHEET NO.
					*	(109,110)RS-2	FORD	21	18
SCALE:		SHEET	OF	SHEETS	STA.	TO STA.	ILLINOIS FED. AID PROJECT		

\*FAP 798 (IL 115), FAP 71 (IL 115/IL 54), FAS 340 (IL 115)

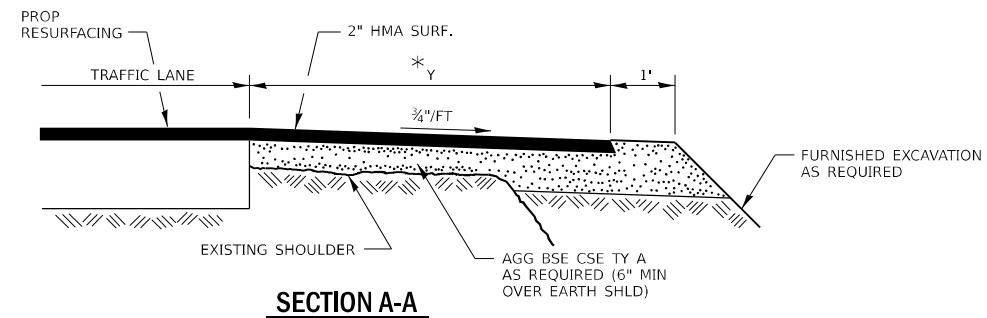
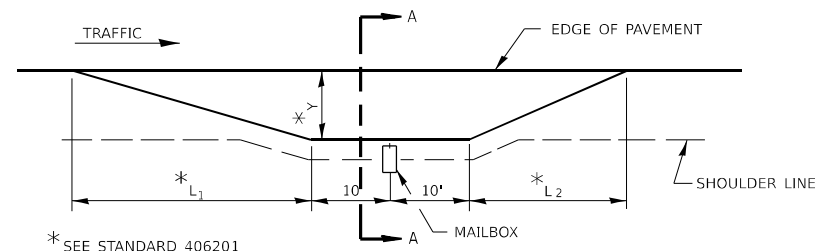

**RURAL MAILBOX TURNOUT DETAILS**

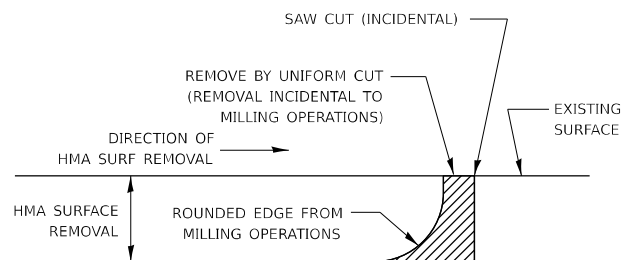

NOTE:  
WHEN MILLING OPERATIONS PRODUCE A ROUNDED EDGE, THEN A SAW CUT SHALL BE USED TO MANUFACTURE A PERPENDICULAR EDGE AS SHOWN IN THE DETAIL. THE ENGINEER SHALL BE THE SOLE JUDGE CONCERNING THE USE OF THIS DETAIL

**HMA DETAIL AT BUTT JOINTS**

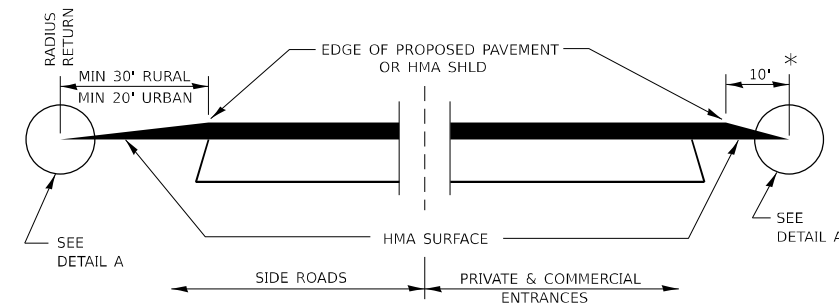

**SECTION A-A  
DETAILS AT ENTRANCES & SIDE ROADS**

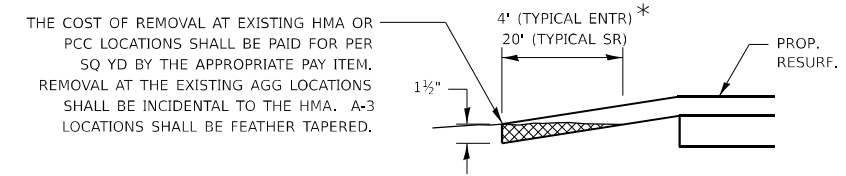
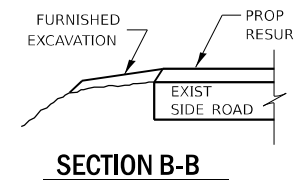

**DETAIL A**

THE COST OF REMOVAL AT EXISTING HMA OR PCC LOCATIONS SHALL BE PAID FOR PER SQ YD BY THE APPROPRIATE PAY ITEM. REMOVAL AT THE EXISTING AGG LOCATIONS SHALL BE INCIDENTAL TO THE HMA. A-3 LOCATIONS SHALL BE FEATHER TAPERED.

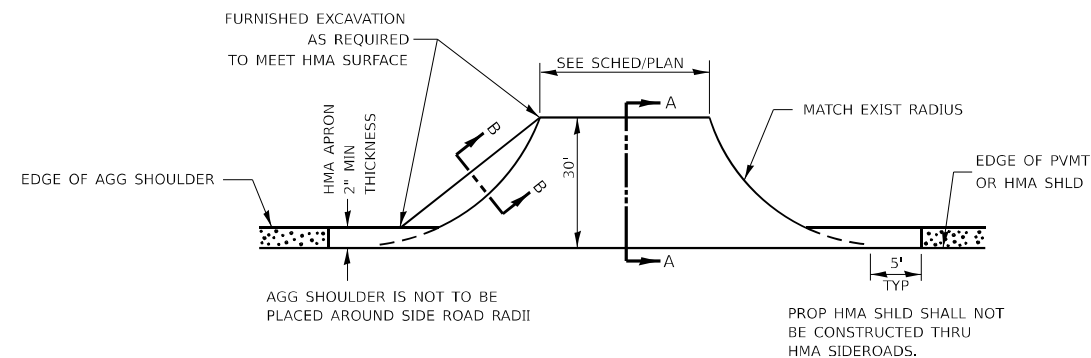

**PLAN AT SIDE ROADS**

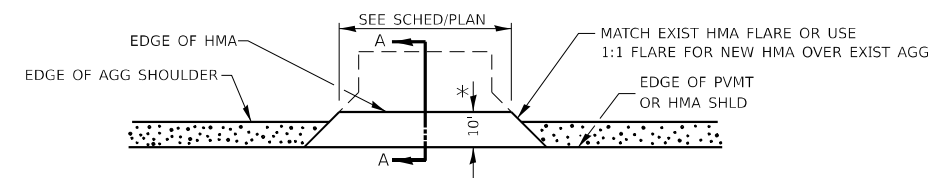

**PLAN AT PRIVATE & COMMERCIAL ENTRANCES**

(DO NOT RESURFACE FIELD ENTRANCES)

STATE OF ILLINOIS  
DEPARTMENT OF TRANSPORTATION

DETAILS

SCALE: SHEET OF SHEETS STA. TO STA.

F.A. RTE.	SECTION	COUNTY	TOTAL SHEETS	SHEET NO.
*	(109,110)RS-2	FORD	21	19
CONTRACT NO. 66P19				
ILLINOIS FED. AID PROJECT				

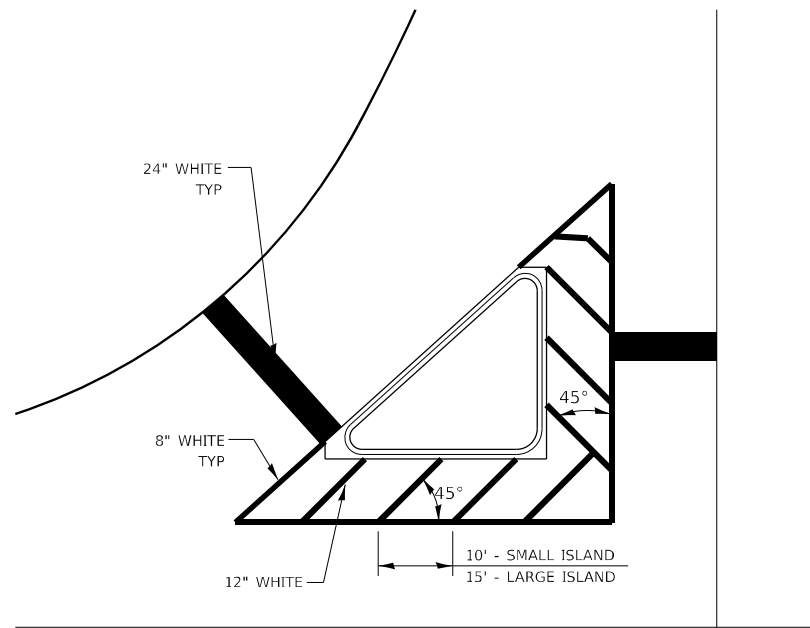

**TYPICAL ISLAND**

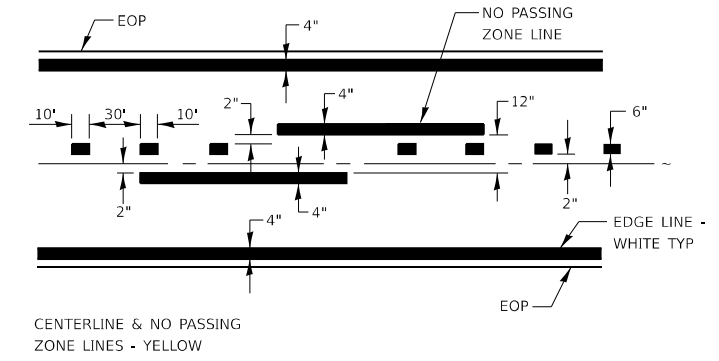

**PAVEMENT MARKING**

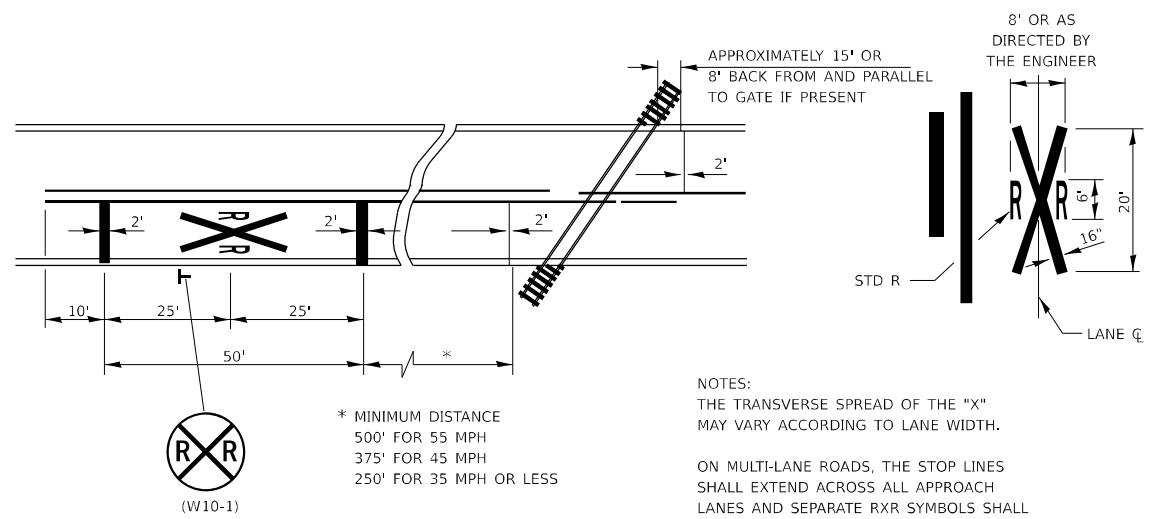

**PAVEMENT MARKINGS AT RAILROAD-HIGHWAY GRADE CROSSING**

NOTES:  
 THE TRANSVERSE SPREAD OF THE "X" MAY VARY ACCORDING TO LANE WIDTH.  
 ON MULTI-LANE ROADS, THE STOP LINES SHALL EXTEND ACROSS ALL APPROACH LANES AND SEPARATE RXX SYMBOLS SHALL BE PLACED ADJACENT TO EACH OTHER IN EACH LANE.  
 WHEN THE PAVEMENT MARKING SYMBOL IS USED, A PORTION OF THE SYMBOL SHOULD BE LOCATED DIRECTLY ADJACENT TO THE ADVANCE WARNING SIGN (W10-1).



**STATE OF ILLINOIS  
 DEPARTMENT OF TRANSPORTATION**

**DETAILS**  
 SCALE: SHEET OF SHEETS STA. TO STA.

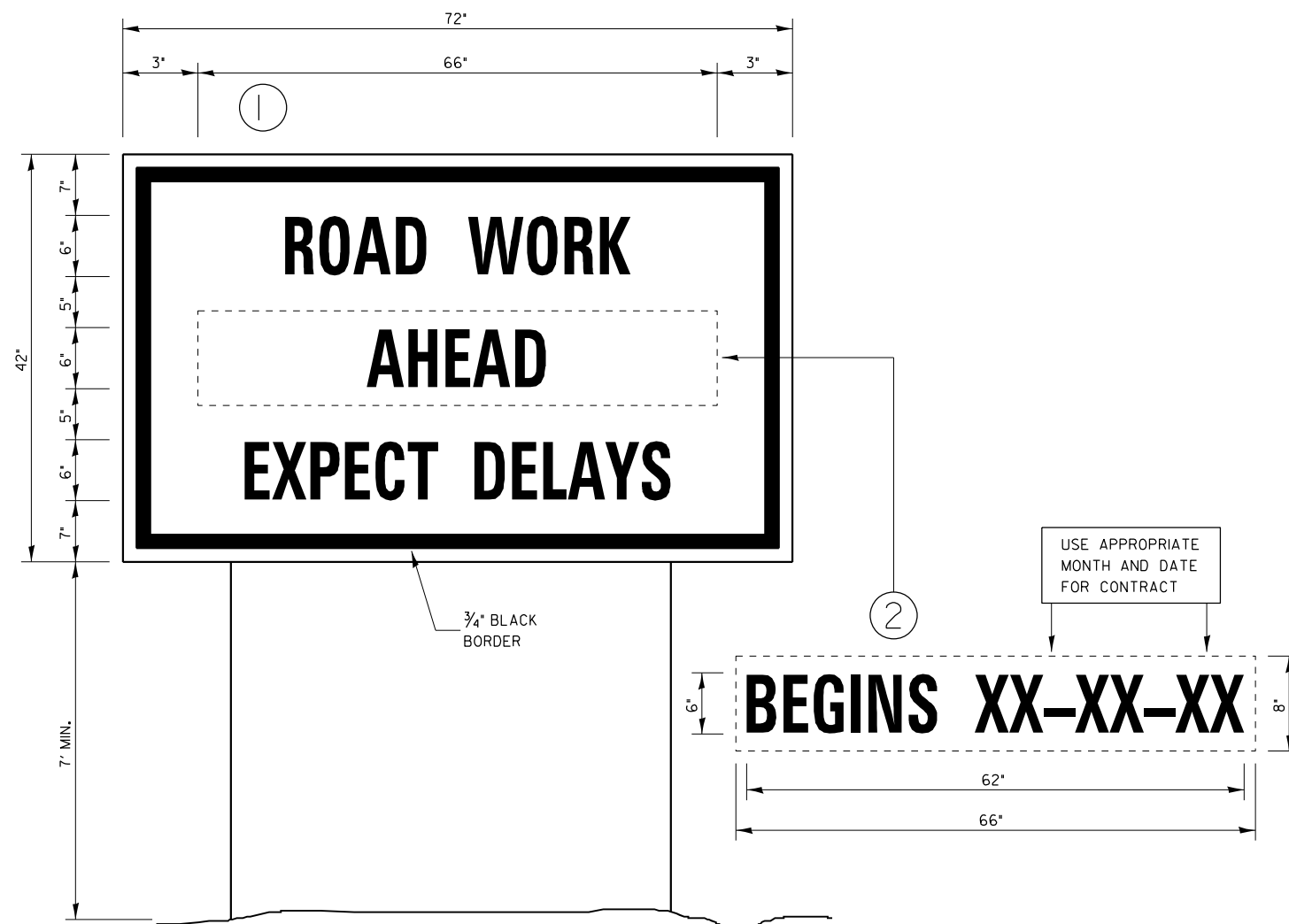
F.A.* RTE.	SECTION	COUNTY	TOTAL SHEETS	SHEET NO.
*	(109,110)RS-2	FORD	21	20
CONTRACT NO. 66P19				
ILLINOIS FED. AID PROJECT				

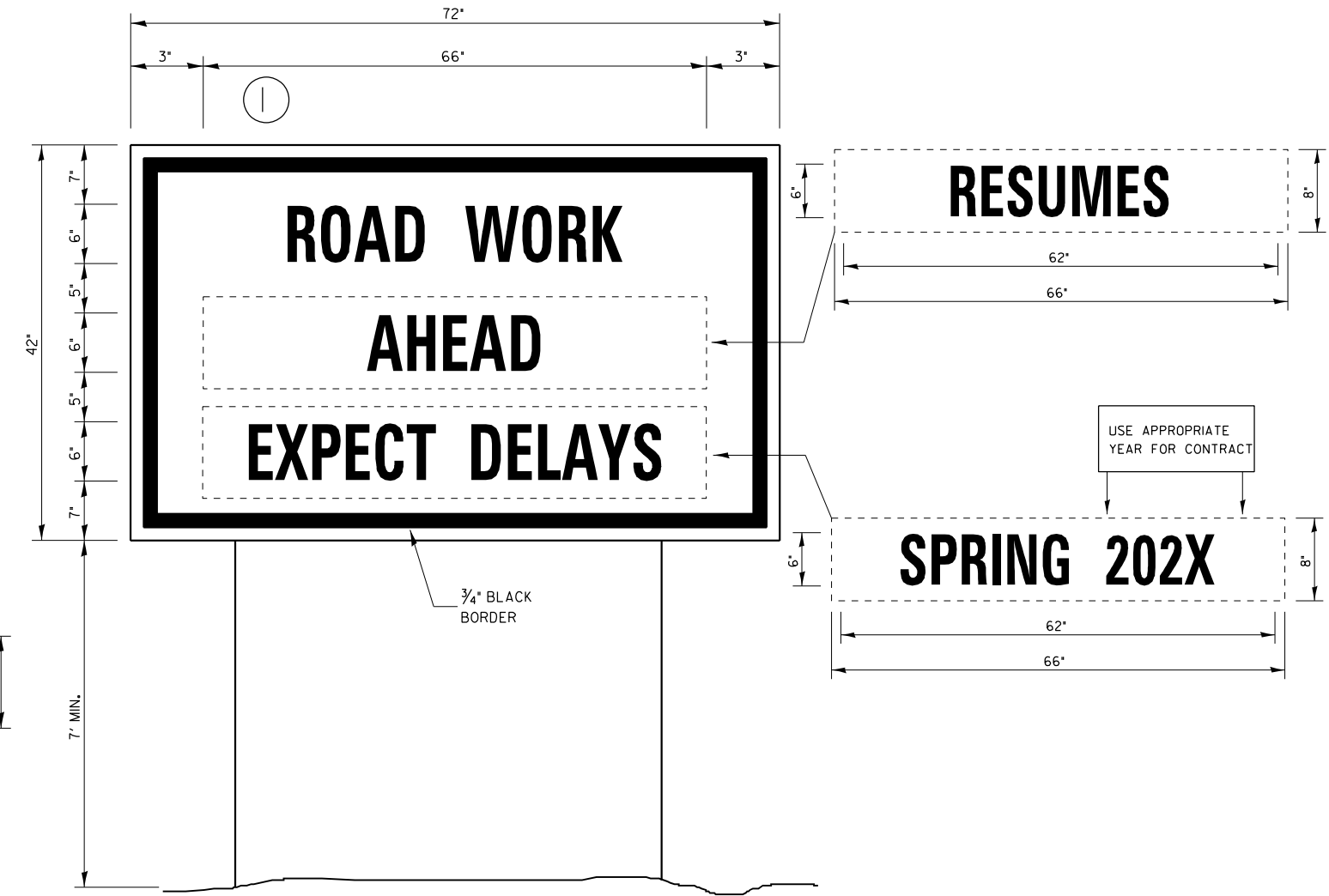

**TEMPORARY INFORMATION SIGNING**



**WINTER SHUT DOWN SIGNING**

**NOTES:**

1. USE 6" D BLACK LETTERING ON FLOURESENT ORANGE BACKGROUND.
2. ERECT SIGNS AT LOCATIONS IN ADVANCE OF THE "ROAD CONSTRUCTION AHEAD" SIGNS AS DIRECTED BY THE ENGINEER.
3. ERECT SIGN ① WITH INSTALLED PANEL 2 ② MINIMUM OF ONE WEEK PRIOR TO THE START OF THE LANE CLOSURE.
4. REMOVE PANEL ② ON THAT DATE.
5. SEE SPECIAL PROVISION "TEMPORARY INFORMATION SIGNING" FOR ADDITIONAL INFORMATION.
6. WILL BE PAID FOR PER SO FT AS "TEMPORARY INFORMATION SIGNING". EACH SIGN = 2150 FT AND THE DATE PANEL ② WILL NOT BE MEASURED SEPARATELY FOR PAYMENT.

<b>STATE OF ILLINOIS DEPARTMENT OF TRANSPORTATION</b>		<b>DETAILS</b>		F.A. RTE. *	SECTION (109,110)RS-2	COUNTY FORD	TOTAL SHEETS 21	SHEET NO. 21
		SCALE:      SHEET      OF      SHEETS      STA.      TO STA.		ILLINOIS FED. AID PROJECT      CONTRACT NO. 66P19				