

F.A.P. RTE.	SECTION	COUNTY	TOTAL SHEETS	SHEET NO.
786	(109,110,111)RS-4	VARIOUS	28	1
		ILLINOIS	CONTRACT NO. 66P42	

STATE OF ILLINOIS DEPARTMENT OF TRANSPORTATION PROPOSED HIGHWAY PLANS

FAP ROUTE 786 (IL 170) SECTION (109,110,111)RS-4 PROJECT STP-7SH5(224) MILL & RESURFACE (DESIGNED OVERLAY) LASALLE & LIVINGSTON COUNTIES

INDEX OF SHEETS

- 1 COVER SHEET
- 2 GENERAL NOTES
- 3-6 SUMMARY OF QUANTITIES
- 7-10 TYPICAL SECTIONS
- 11 LINE DIAGRAM
- 12-20 SCHEDULES
- 21-28 DETAILS

LIST OF ILLINOIS DOT HIGHWAY STANDARDS

- 000001-08 STANDARD SYMBOLS, ABBREVIATIONS AND PATTERNS
- 001006 DECIMAL OF AN INCH AND OF A FOOT
- 406201-01 MAILBOX TURNOUT
- 420406 PAVEMENT CONNECTOR (HMA) FOR BRIDGE APPROACH SLAB
- 442101-09 CLASS B PATCHES
- 542301-03 PRECAST REINFORCED CONCRETE FLARED END SECTION
- 635001-02 DELINEATORS
- 667101-02 PERMANENT SURVEY MARKERS
- 701001-02 OFF-ROAD OPERATIONS 2L, 2W, MORE THAN 15' AWAY
- 701006-05 OFF-ROAD OPERATIONS 2L, 2W, 15' TO 24" FROM PAVEMENT EDGE
- 701011-04 OFF-ROAD MOVING OPERATIONS 2L, 2W, DAY ONLY
- 701201-05 LANE CLOSURE, 2L, 2W, DAY ONLY, FOR SPEEDS ≥ 45 MPH
- 701306-04 LANE CLOSURE, 2L, 2W, SLOW MOVING OPERATIONS DAY ONLY, FOR SPEEDS ≥ 45 MPH
- 701311-03 LANE CLOSURE, 2L, 2W, MOVING OPERATIONS - DAY ONLY
- 701901-09 TRAFFIC CONTROL DEVICES
- 780001-05 TYPICAL PAVEMENT MARKINGS
- 781001-04 TYPICAL APPLICATIONS RAISED REFLECTIVE PAVEMENT MARKERS
- 782006-01 GUARDRAIL AND BARRIER WALL REFLECTOR MOUNTING DETAILS

D-93-057-24

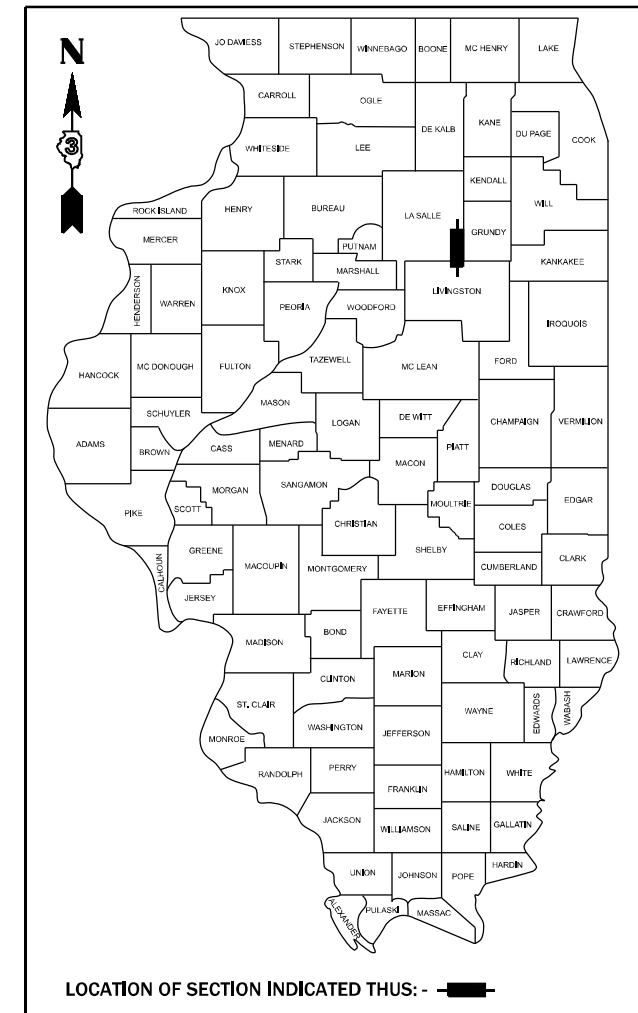

LOCATION OF SECTION INDICATED THUS: - [Red Rectangle] -

**FUNCTIONAL CLASSIFICATION =
MINOR ARTERIAL (RURAL)**

ADT (2021) = 3700

P.V. = 90.14% M.U. = 4.86% S.U. = 5.00%

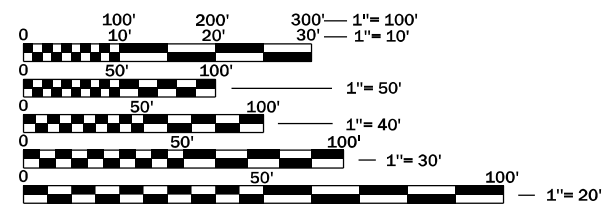

FULL SIZE PLANS HAVE BEEN PREPARED USING STANDARD ENGINEERING SCALES. REDUCED SIZED PLANS WILL NOT CONFORM TO STANDARD SCALES. IN MAKING MEASUREMENTS ON REDUCED PLANS, THE ABOVE SCALES MAY BE USED.

**J.U.L.I.E.
JOINT UTILITY LOCATION INFORMATION FOR EXCAVATION
1-800-892-0123
OR 811**

**PROJECT ENGINEER: JOSEPH KANNEL, P.E.
UNIT CHIEF: DARCY MITCHELL
DISTRICT 3 NO. (815) 434-6131
CONTRACT NO. 66P42**

**C-93-095-24 PROJECT BEGINS
R 5 E STA. 98 + 35**

**STRUCTURE OMISSION
S.N. 050-0258
STA. 699 + 11 TO 701 + 71**

**PROJECT ENDS
STA. 946 + 44**

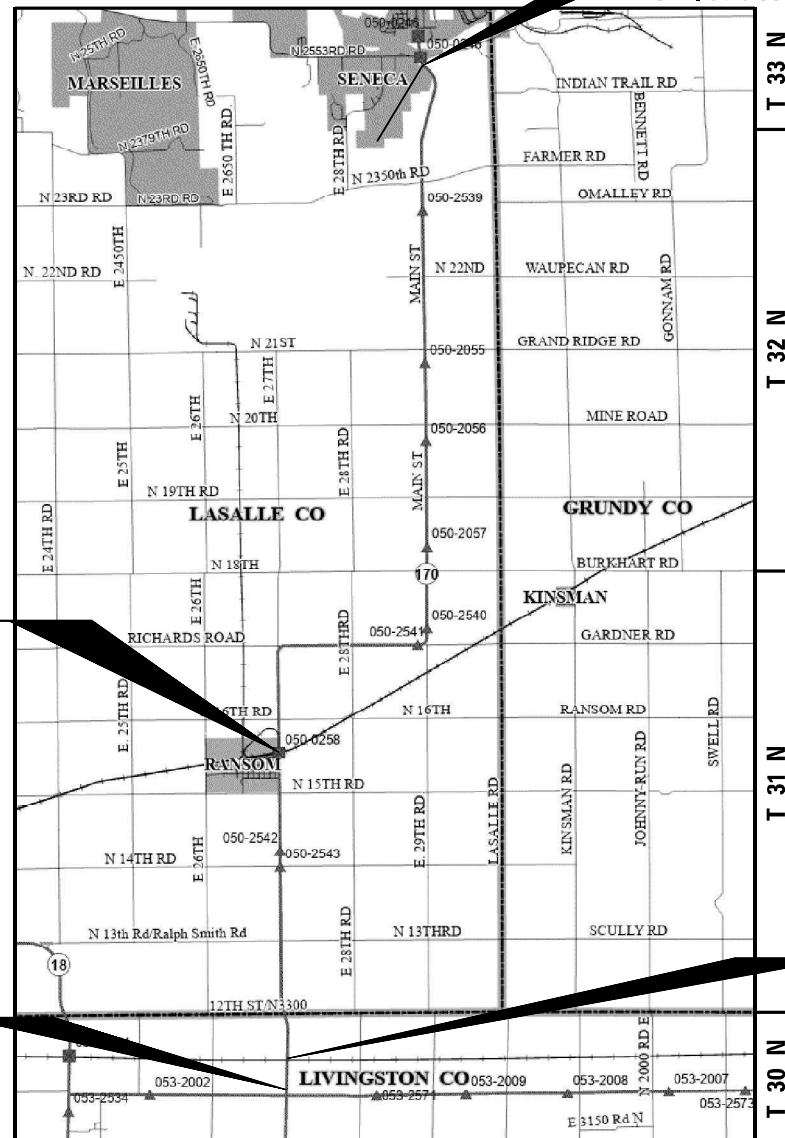

**GROSS LENGTH = 85,602 FT. = 16.21 MI.
NET LENGTH = 84,956 FT. = 16.09 MI.**

NORFOLK SOUTHERN RAILWAY

STATE OF ILLINOIS
DEPARTMENT OF TRANSPORTATION

SUBMITTED June 26, 2024

Tawika Thompson
REGIONAL ENGINEER

August 16, 2024

Joe E.A. Elk
ENGINEER OF DESIGN AND ENVIRONMENT

August 16, 2024

James J. Gu
DIRECTOR OF HIGHWAYS PROJECT IMPLEMENTATION

**PRINTED BY THE AUTHORITY
OF THE STATE OF ILLINOIS**

GENERAL NOTES

THE HMA SURFACE OF ALL MAILBOX TURNOUTS, PRIVATE ENTRANCES, COMMERCIAL ENTRANCES, AND SIDE ROADS SHALL BE MADE NEATLY, IN A WORKMANLIKE MANNER, AND SHALL ACCURATELY CONFORM TO THE SHAPES AND DIMENSIONS SHOWN ON THE PLAN DETAILS. IF REQUIRED BY THE ENGINEER, THE CONTRACTOR SHALL SAW CUT THE HMA SURFACE TO CONFORM TO THE SHAPES AND DIMENSIONS SHOWN ON THE PLAN DETAILS. THIS WORK WILL BE INCLUDED IN THE COST OF THE HMA SURFACE.

EXCEPT AS NOTED ON THE PLANS, PAVEMENT GRADES SHOWN ARE AT THE TOP OF PAVEMENT SURFACES.

BEFORE ORDERING PIPE CULVERTS OR PIPE DRAINS, THE CONTRACTOR SHALL CONSULT THE ENGINEER FOR EXACT LENGTHS.

THE ENGINEER WILL BE THE SOLE JUDGE CONCERNING CURING TIME FOR THE VARIOUS HMA LIFTS.

THE FINISHED EARTHWORK SHALL HAVE A VEGETATION SUSTAINING SOIL COVERING THE TOP FOUR INCHES (100 MILLIMETERS) IN AREAS TO BE SEEDED OR SODDED. THE VEGETATION SUSTAINING SOIL REQUIRED WILL NOT BE PAID FOR SEPARATELY BUT WILL BE INCLUDED IN THE COST OF FURNISHED EXCAVATION.

ON EXISTING PAVEMENT WHICH MAY BE SUPERELEVATED, THE NEW HMA PAVEMENT SHALL BE BUILT WITH THE SAME SUPERELEVATION UNLESS NEW SUPERELEVATION RATES ARE GIVEN ON THE PLANS.

ALL ELEVATIONS REFERRING TO U.S.G.S. MEAN SEA LEVEL DATUM.

THE FOLLOWING RATES OF APPLICATION HAVE BEEN USED IN CALCULATING PLAN QUANTITIES:

GRANULAR MATERIALS	2.05	TONS / CU YD
HMA RESURFACING	112	LBS / SQ YD / IN
SHORT TERM PAVEMENT MARKING	10	FT /100 FT OF APPLICATION
MIX FOR CRACKS, JTS & FLGWYS	0.0003	TONS / SQ YD

MEMBERS OF JULIE KNOWN TO BE WITHIN THE LIMITS OF THE IMPROVEMENT ARE:

NON-MEMBERS OF JULIE KNOWN TO BE WITHIN THE LIMITS OF THE IMPROVEMENT ARE:

COMMITMENTS:

NONE

HMA MIXTURE REQUIREMENT TABLE			
LOCATIONS:	ENTIRE PROJECT	ENTIRE PROJECT	ENTIRE PROJECT
MIXTURE USE(S):	HMA SURFACE	HMA BINDER	HMA INCIDENTAL
BINDER GRADE (PG):	PG 64-22	PG 64-22	PG 64-22
DESIGN AIR VOIDS:	4.0% @ N50	4.0% @ N50	4.0% @ N50
MIXTURE COMPOSITION: (MIXTURE GRADATION)	IL 9.5	IL 19.0	IL 9.5
FRICITION AGGREGATE:	MIXTURE C		
MIXTURE WEIGHT:	112.0 LB/SY/IN	112.0 LB/SY/IN	112.0 LB/SY/IN
QUALITY MANAGEMENT PROGRAM:	QCP	QCP	QCQA
SUBLOT SIZE:	1000 TONS	1000 TONS	NA
DENSITY TEST METHOD:	CORES	CORES	SATISFACTION OF ENGINEER
MATERIAL TRANSFER DEVICE (REQUIRED)	YES	YES	NO

STATE OF ILLINOIS
DEPARTMENT OF TRANSPORTATION
DISTRICT THREE
AS BUILT INFORMATION

SUPERVISING CONSTRUCTION FIELD ENGINEER

RESIDENT ENGINEER / TECHNICIAN

START & END DATES
OF CONSTRUCTION:

INSPECTORS:

**STATE OF ILLINOIS
DEPARTMENT OF TRANSPORTATION**

GENERAL NOTES

SCALE: SHEET OF SHEETS STA. TO STA.

F.A.P. RTE.	SECTION	COUNTY	TOTAL SHEETS	SHEET NO.
786	(109,110,111)RS-4	VARIOUS	28	2
CONTRACT NO. 66P42			ILLINOIS FED. AID PROJECT	

MODEL: Default
FILE NAME: p:\ilidct-pw-bentley.com\p\ilidct\Documents\DOT 0_csr\District_3\ORR\Project\356842\CADD\356842\356842-1ht-cover.dgn

MODEL: Default
 FILE NAME: p:\ilidct-pw-bentley.com\P\INDOT\Documents\DOT 0 ces\District_3\ORSD Projects\0368642\CADD\0368642-0111-cover.dgn

CODE NO.	ITEM	UNIT	TOTAL QUANTITY	CONSTRUCTION CODE	
				80% FED 20% STATE LASALLE	80% FED 20% STATE LIVINGSTON
				ROADWAY	ROADWAY
				0005	0005
				RURAL	RURAL
20400800	FURNISHED EXCAVATION	CU YD	11	11	
40200800	AGGREGATE SURFACE COURSE, TYPE B	TON	811	792	19
40600290	BITUMINOUS MATERIALS (TACK COAT)	POUND	24916	23965	951
40600370	LONGITUDINAL JOINT SEALANT	FOOT	80343	76359	3984
40600400	MIXTURE FOR CRACKS, JOINTS, AND FLANGEWAYS	TON	81	78	3
40600990	TEMPORARY RAMP	SQ YD	601	493	108
40603080	HOT-MIX ASPHALT BINDER COURSE, IL-19.0, N50	TON	34006	32610	1396
40604050	HOT-MIX ASPHALT SURFACE COURSE, IL-9.5, MIX "C", N50	TON	22707	21740	967
40800050	INCIDENTAL HOT-MIX ASPHALT SURFACING	TON	1531	1502	29
44000155	HOT-MIX ASPHALT SURFACE REMOVAL, 1 1/2"	SQ YD	144		144
44000164	HOT-MIX ASPHALT SURFACE REMOVAL, 3 3/4"	SQ YD	273798	258808	14990
44201102	CLASS B PATCHES, TYPE II, 20 INCH	SQ YD	70	70	
44201106	CLASS B PATCHES, TYPE IV, 20 INCH	SQ YD	43	43	
44201299	DOWEL BARS 1 1/2"	EACH	180	180	

* SPECIALTY ITEM

USER NAME = Richard.Yoo	DESIGNED -	REVISED -	STATE OF ILLINOIS DEPARTMENT OF TRANSPORTATION	SUMMARY OF QUANTITIES				F.A.P. RTE.	SECTION	COUNTY	TOTAL SHEETS	SHEET NO.
PLOT SCALE = \$SCALE\$	DRAWN -	REVISED -						786	(109,110,111)RS-4	VARIOUS	28	3
PLOT DATE = 6/27/2024	CHECKED -	REVISED -		SCALE:	SHEET	OF	SHEETS	STA.	TO	STA.	CONTRACT NO. 66P42	
	DATE -	REVISED -									ILLINOIS FED. AID PROJECT	

CODE NO.	ITEM	UNIT	TOTAL QUANTITY	CONSTRUCTION CODE	
				80% FED 20% STATE LASALLE	80% FED 20% STATE LIVINGSTON
				ROADWAY	ROADWAY
				0005 RURAL	0005 RURAL
44213000	PATCHING REINFORCEMENT	SQ YD	43	43	
44213200	SAW CUTS	FOOT	509	509	
44213204	TIE BARS 3/4"	EACH	30	30	
48102100	AGGREGATE WEDGE SHOULDER, TYPE B	TON	6100	5798	302
63500105	DELINEATORS	EACH	106	94	12
64200108	SHOULDER RUMBLE STRIPS, 8 INCH	FOOT	55733	55733	
* 66700205	PERMANENT SURVEY MARKERS, TYPE I	EACH	20	19	1
67000400	ENGINEER'S FIELD OFFICE, TYPE A	CAL MO	7	5	2
67100100	MOBILIZATION	L SUM	1	0.9	0.1
70100460	TRAFFIC CONTROL AND PROTECTION, STANDARD 701306	L SUM	1	0.9	0.1
70300100	SHORT TERM PAVEMENT MARKING	FOOT	25298	23214	2084
70300150	SHORT TERM PAVEMENT MARKING REMOVAL	SQ FT	2812	2579	233
* 78000100	THERMOPLASTIC PAVEMENT MARKING - LETTERS AND SYMBOLS	SQ FT	122		122
* 78000650	THERMOPLASTIC PAVEMENT MARKING - LINE 24"	FOOT	216	138	78

* SPECIALTY ITEM

MODEL: Default
FILE NAME: p:\illicit-pw-beadley.com\P\INDOT\Documents\DOT 0 ces\District_3\ORSD_projects\308RD_projects\308RD\308RD\CADD\308RD\308RD2-rlt-cover.dgn

USER NAME = Richard.Yoo	DESIGNED -	REVISED -
	DRAWN -	REVISED -
PLOT SCALE = 5:SCALE5	CHECKED -	REVISED -
PLOT DATE = 6/27/2024	DATE -	REVISED -

**STATE OF ILLINOIS
DEPARTMENT OF TRANSPORTATION**

SUMMARY OF QUANTITIES

SCALE: SHEET OF SHEETS STA. TO STA.

F.A.P. RTE.	SECTION	COUNTY	TOTAL SHEETS	SHEET NO.
786	(109,110,111)RS-4	VARIOUS	28	4
			CONTRACT NO. 66P42	
ILLINOIS FED. AID PROJECT				

CODE NO.	ITEM	UNIT	TOTAL QUANTITY	CONSTRUCTION CODE	
				80% FED 20% STATE LASALLE	80% FED 20% STATE LIVINGSTON
				ROADWAY	ROADWAY
				0005	0005
				RURAL	RURAL
* 78009004	MODIFIED URETHANE PAVEMENT MARKING - LINE 4"	FOOT	395656	356708	38948
* 78009006	MODIFIED URETHANE PAVEMENT MARKING - LINE 6"	FOOT	42165	38691	3474
* 78009008	MODIFIED URETHANE PAVEMENT MARKING - LINE 8"	FOOT	368	368	
* 78009012	MODIFIED URETHANE PAVEMENT MARKING - LINE 12"	FOOT	192	192	
* 78011000	GROOVING FOR RECESSED PAVEMENT MARKING, LETTERS AND SYMBOLS	SQ FT	122		122
* 78011125	GROOVING FOR RECESSED PAVEMENT MARKING 25"	FOOT	216	138	78
* 78100100	RAISED REFLECTIVE PAVEMENT MARKER	EACH	1054	966	88
78300200	RAISED REFLECTIVE PAVEMENT MARKER REMOVAL	EACH	1054	966	88
X4401198	HOT-MIX ASPHALT SURFACE REMOVAL, VARIABLE DEPTH	SQ YD	10856	10200	656
X6350204	LINEAR DELINEATOR PANELS, 4 INCH	EACH	74	74	
X6350206	LINEAR DELINEATOR PANELS, 6 INCH	EACH	6	6	
Z0018900	DRILL AND GROUT DOWEL BARS	EACH	180	180	
Z0018911	DRILL AND GROUT #6 TIE BARS	EACH	30	30	
Z0030850	TEMPORARY INFORMATION SIGNING	SQ FT	42	21	21

* SPECIALTY ITEM

MODEL: Default
 FILE NAME: p:\p1\dot\documents\DOT 0 ces\District_3\ORRD Project\0368642\CADD\0368642-01\cover.dgn

USER NAME = Richard.Yoo	DESIGNED -	REVISED -
	DRAWN -	REVISED -
PLOT SCALE = 55CALES	CHECKED -	REVISED -
PLOT DATE = 6/27/2024	DATE -	REVISED -

**STATE OF ILLINOIS
DEPARTMENT OF TRANSPORTATION**

SUMMARY OF QUANTITIES

SCALE: SHEET OF SHEETS STA. TO STA.

F.A.P. RTE.	SECTION	COUNTY	TOTAL SHEETS	SHEET NO.
786	(109,110,111)RS-4	VARIOUS	28	5
CONTRACT NO. 66P42				
ILLINOIS FED. AID PROJECT				

CODE NO.	ITEM	UNIT	TOTAL QUANTITY	CONSTRUCTION CODE	
				80% FED 20% STATE LASALLE	80% FED 20% STATE LIVINGSTON
				ROADWAY	ROADWAY
				0005 RURAL	0005 RURAL
Z0034105	MATERIAL TRANSFER DEVICE	TON	56713	54350	2363
Z0048665	RAILROAD PROTECTIVE LIABILITY INSURANCE	L SUM	1		1
∅ Z0076600	TRAINEES	HOUR	2,000	2,000	
* Z0070202	SURVEY MARKER VAULT	EACH	1	1	
∅ Z0076604	TRAINEES - TRAINING PROGRAM GRADUATE	HOUR	2,000	2,000	

* SPECIALTY ITEM

∅ 0042

MODEL: Default
 FILE NAME: p:\illicit-aw-beadley.com\P\INDOT\Documents\DOT 0 ces\District 3\ORBD Project\0368662\CADD\0368662-rlt-cover.dgn

USER NAME = Richard.Yoo	DESIGNED -	REVISED -	STATE OF ILLINOIS DEPARTMENT OF TRANSPORTATION	SUMMARY OF QUANTITIES				F.A.P. RTE.	SECTION	COUNTY	TOTAL SHEETS	SHEET NO.
PLOT SCALE = \$SCALE\$	CHECKED -	REVISED -						786	(109,110,111)RS-4	VARIOUS	28	6
PLOT DATE = 6/27/2024	DATE -	REVISED -		SCALE:	SHEET OF SHEETS	STA. TO STA.	ILLINOIS FED. AID PROJECT					
							CONTRACT NO. 66P42					

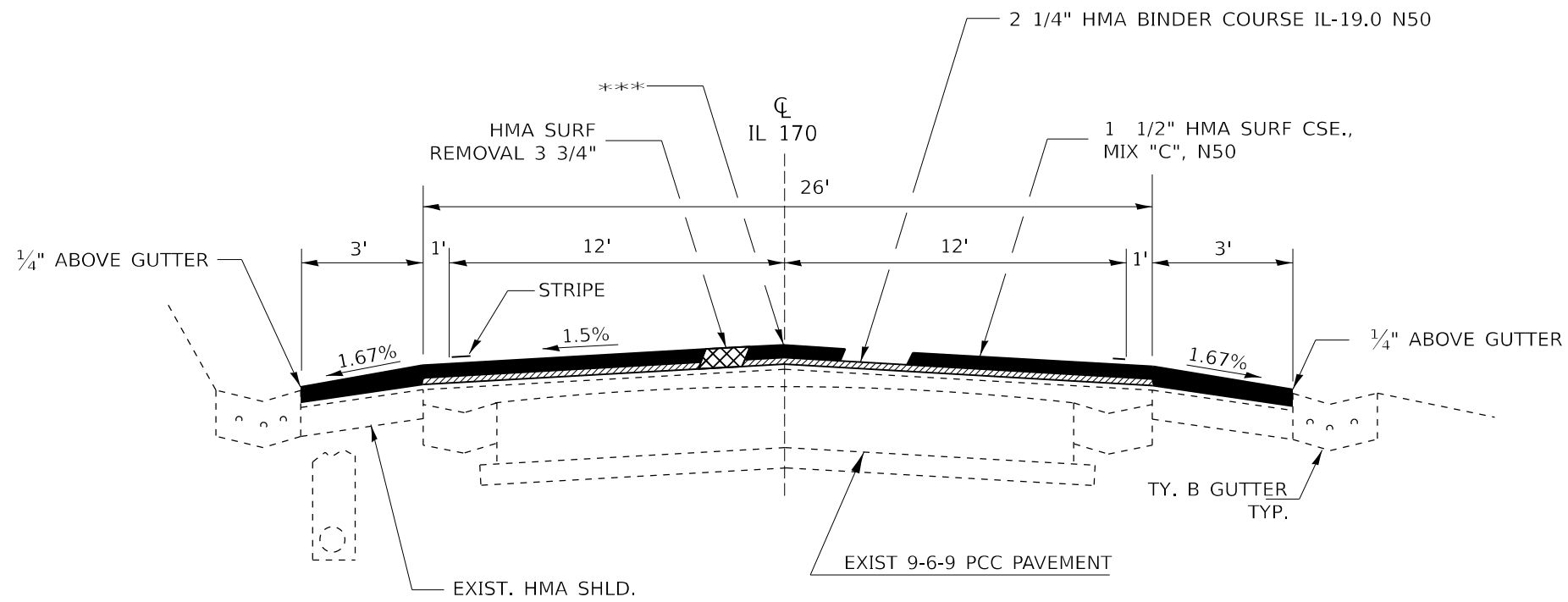

PROPOSED TYPICAL 1

STA. 98+35 TO STA. 100+95.74
 *** LJS UNDER SURFACE LIFT ONLY

OMISSION
 S.N. 050-0258
 STA. 699+11 TO STA. 701+71

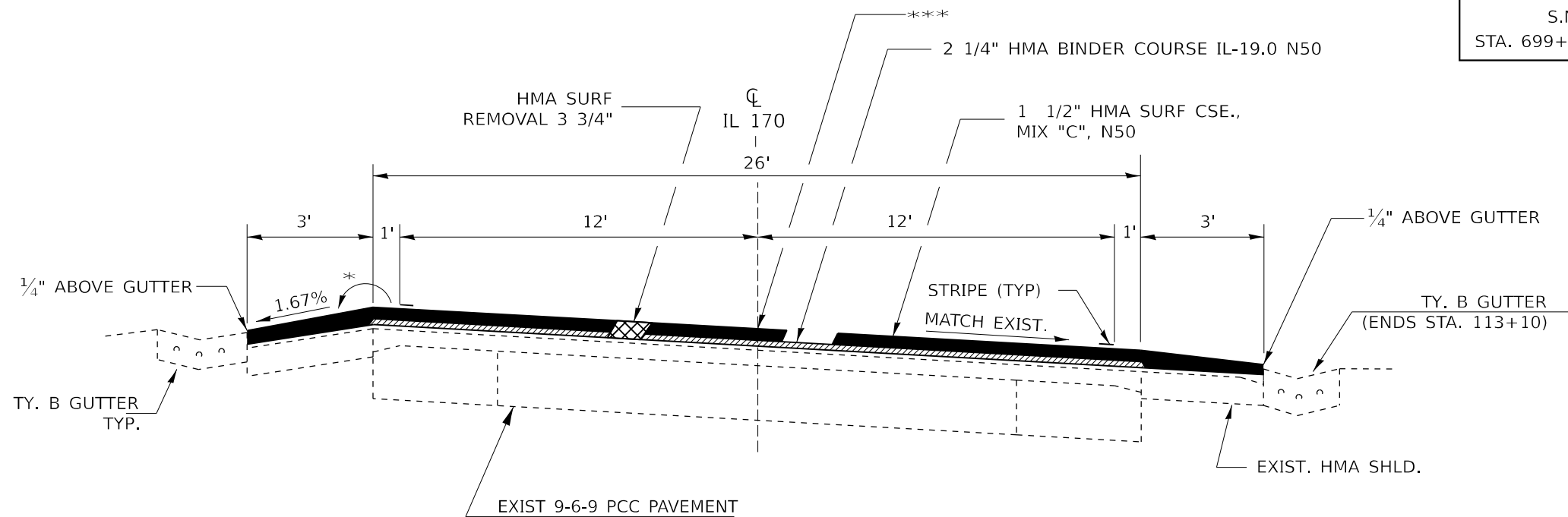

PROPOSED TYPICAL 2

* 8% MAX. ROLLOVER
 STA. 100+95.74 TO STA. 114+76.23
 *** LJS UNDER SURFACE LIFT ONLY

MODEL: Default
 FILE NAME: p:\ilidoc\aw\bea\efy.com\p\ilidoc\Documents\DOT 0 ces\Btfrict_3\ORD Project\368642\CADD\368642-2ht\typical.dgn

USER NAME = Richard.Yoo	DESIGNED -	REVISED -
	DRAWN -	REVISED -
PLOT SCALE = 5/5CALES	CHECKED -	REVISED -
PLOT DATE = 6/27/2024	DATE -	REVISED -

STATE OF ILLINOIS
 DEPARTMENT OF TRANSPORTATION

TYPICAL SECTIONS

SCALE: SHEET OF SHEETS STA. TO STA.

F.A.P. RTE.	SECTION	COUNTY	TOTAL SHEETS	SHEET NO.
786	(109,110,111)RS-4	VARIOUS	28	7
CONTRACT NO. 66P42				
ILLINOIS FED. AID PROJECT				

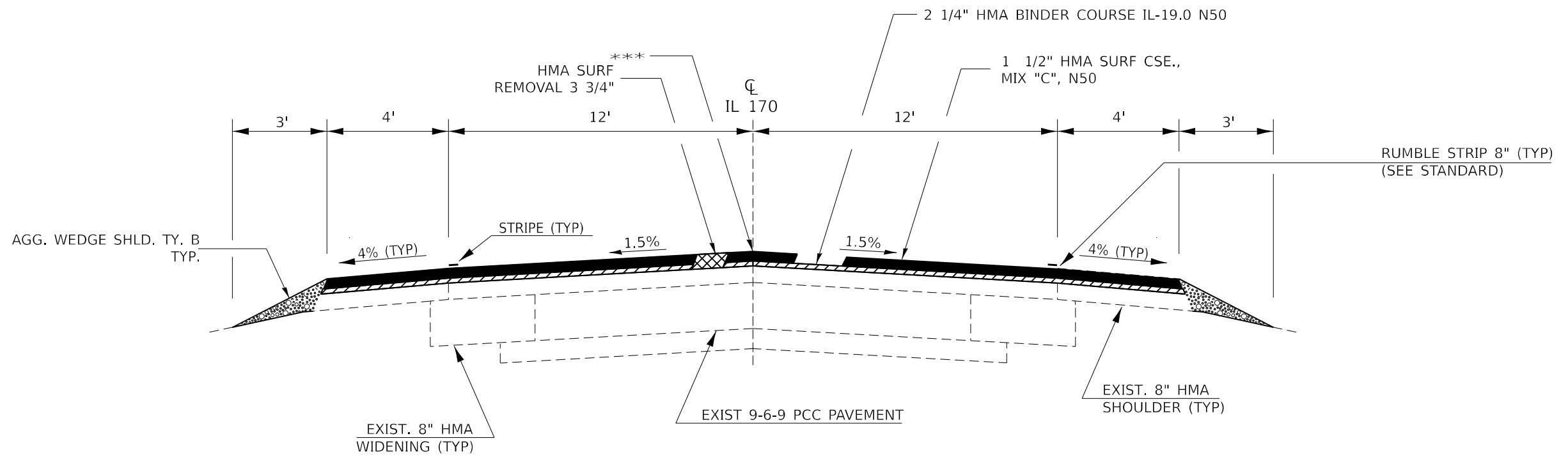

PROPOSED TYPICAL SECTION 3
 STA. 114+76.23 TO STA. 302+12.73
 *** LJS UNDER SURFACE LIFT ONLY

OMISSION
 S.N. 050-0258
 STA. 699+11 TO STA. 701+71

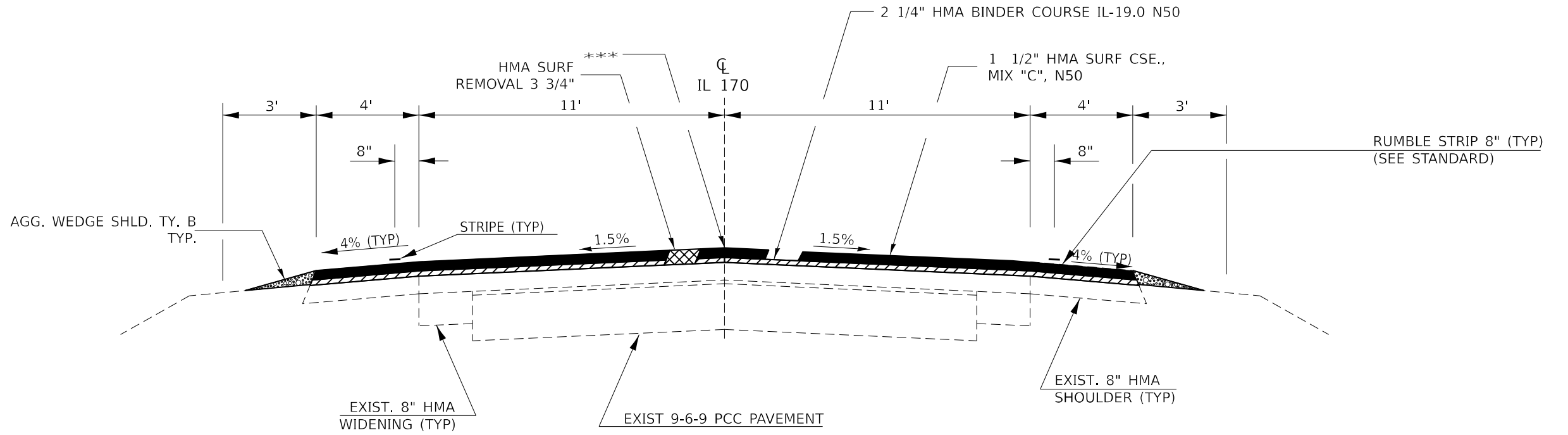

*REFER TO STANDARD 482001 IN AREAS OF SUPERELEVATION

PROPOSED TYPICAL SECTION 4
 STA. 302+12.73 TO STA. 676+00
 *** LJS UNDER SURFACE LIFT ONLY

MODEL: Default
 FILE: I:\msc\pwworkspace\dotnet\DOT 0.cad\Project_3080\Project_3080\DOT0\DOT0.dwg
 DATE: 6/27/2024 10:58:18 AM
 USER: rjoo

USER NAME = Richard.Yoo	DESIGNED -	REVISED -
PLOT SCALE = 5/SCALE5	DRAWN -	REVISED -
PLOT DATE = 6/27/2024	CHECKED -	REVISED -
	DATE -	REVISED -

STATE OF ILLINOIS
 DEPARTMENT OF TRANSPORTATION

TYPICAL SECTIONS				
SCALE:	SHEET	OF	SHEETS	STA. TO STA.

F.A.P. RTE.	SECTION	COUNTY	TOTAL SHEETS	SHEET NO.
786	(109,110,111)RS-4	VARIOUS	28	8
CONTRACT NO. 66P42				
ILLINOIS FED. AID PROJECT				

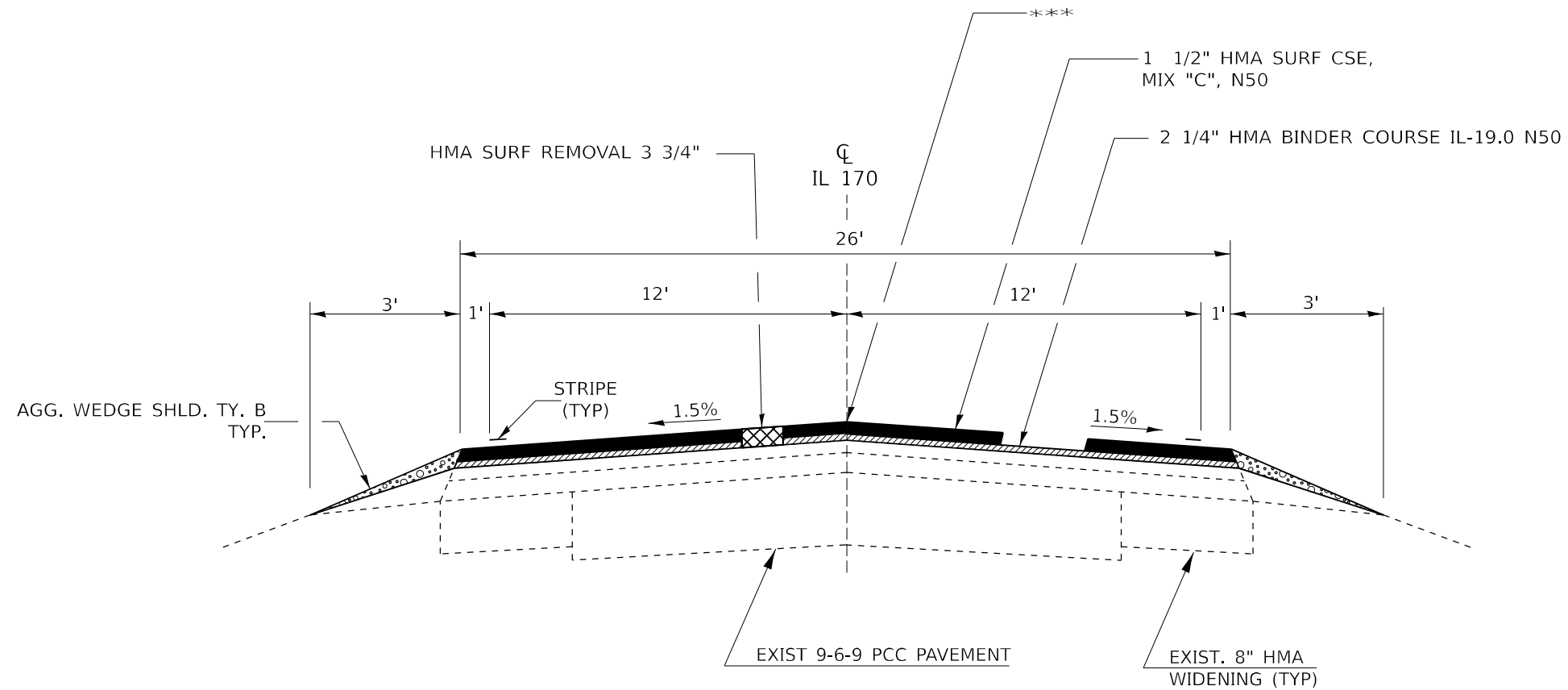

PROPOSED TYPICAL 6

STA. 688+36.51 TO STA. 699+11
 STA. 701+71 TO STA. 713+17.42
 *** LJS UNDER SURFACE LIFT ONLY

OMISSION
 S.N. 050-0258
 STA. 699+11 TO STA. 701+71

MODEL: Default
 FILE NAME: p:\ilidoc\aw_bentley.com\p\ilidoc\Documents\DOT 0_ces\District_3\ORRD_projects\308RD_projects\CADD\Drawings\308RD2-INT-typtical.dgn

USER NAME = Richard.Yoo	DESIGNED -	REVISED -
	DRAWN -	REVISED -
PLOT SCALE = \$SCALE\$	CHECKED -	REVISED -
PLOT DATE = 6/27/2024	DATE -	REVISED -

STATE OF ILLINOIS
 DEPARTMENT OF TRANSPORTATION

TYPICAL SECTIONS

SCALE: SHEET OF SHEETS STA. TO STA.

F.A.P. RTE.	SECTION	COUNTY	TOTAL SHEETS	SHEET NO.
786	(109,110,111)RS-4	VARIOUS	28	10
CONTRACT NO. 66P42				
ILLINOIS FED. AID PROJECT				

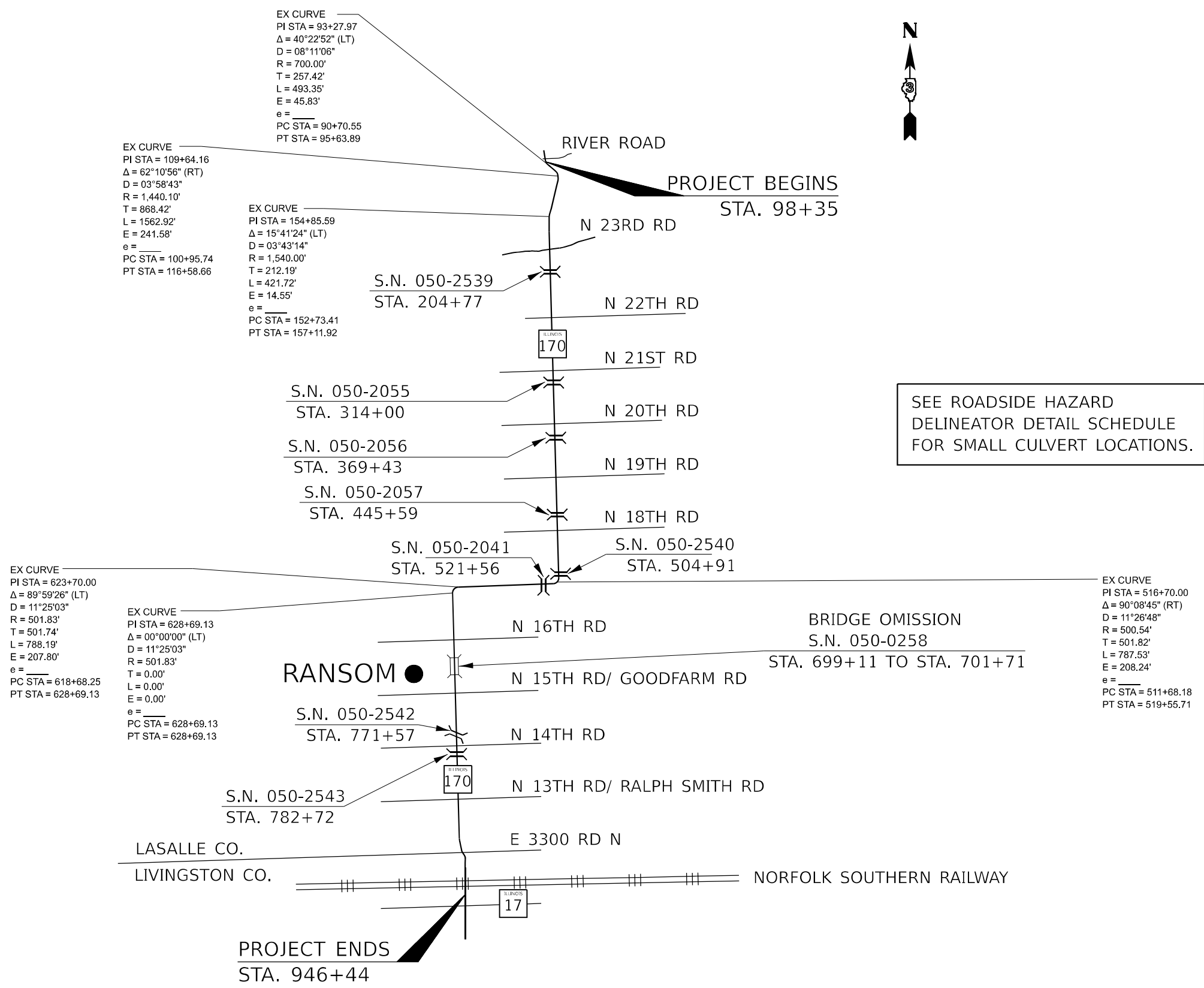

SEE ROADSIDE HAZARD
 DELINEATOR DETAIL SCHEDULE
 FOR SMALL CULVERT LOCATIONS.

MODEL: Default
 FILE: \\mfrs-pw-bentley.com\PW\DOT\Documents\DOT_0_csr\District_3\ORSD_projects\308RD_projects\308RD\308RD\308RD.dwg
 PROJECT: 308RD_projects\308RD\308RD.dwg

USER NAME = Richard.Yoo	DESIGNED -	REVISED -
	DRAWN -	REVISED -
PLOT SCALE = \$SCALES	CHECKED -	REVISED -
PLOT DATE = 6/27/2024	DATE -	REVISED -

STATE OF ILLINOIS
DEPARTMENT OF TRANSPORTATION

LINE DIAGRAM			
SCALE:	SHEET	OF SHEETS	STA. TO STA.

F.A.P. RTE.	SECTION	COUNTY	TOTAL SHEETS	SHEET NO.
786	(109,110,111)RS-4	VARIOUS	28	11
CONTRACT NO. 66P42			ILLINOIS FED. AID PROJECT	

PAVEMENT MARKING SCHEDULE														
LOCATION			LENGTH	MODIFIED URETHANE (2 APPLICATIONS)				THERMOPLASTIC PAVEMENT MARKING		GROOVING FOR RECESSED PAVT MKG		RAISED REFLECT PVMT MARK	RAISED REFLECT PVMT MARK	
				LINE 4"	LINE 6"	LINE 8"	LINE 12"	LINE 24"	LTR & SYM	LINE 25"	LTR & SYM	2 WAY YEL	REMOVAL	
STATION			FOOT	FOOT	FOOT	FOOT	FOOT	SQ FT	FOOT	SQ FT	EACII	CACII		
LASALLE COUNTY														
98+35.00	TO	156+95.12	5860	23440	2930						73	73		
STA EQ 156+95.12 BK=157+11.92 AH			STATION EQUATION											
157+11.92	TO	232+99.14	7587	30349	3794						95	95		
STA EQ 232+99.14 BK=233+00.00 AH			STATION EQUATION											
233+00.00	TO	372+45.29	13945	55781	6973	368	192	138		138	174	174		
STA EQ 372+45.29 BK=372+50.00 AH			STATION EQUATION											
372+50.00	TO	454+10.27	8160	32641	4080						102	102		
STA EQ 454+10.27 BK=454+00.00 AH			STATION EQUATION											
454+00.00	TO	547+00.00	9300	37200	4650						116	116		
STA EQ 547+00.00 BK=549+17.44 AH			STATION EQUATION											
549+17.44	TO	578+00.00	2883	11530	1441						36	36		
STA EQ 578+00.00 BK=577+98.93 AH			STATION EQUATION											
577+98.93	TO	626+56.44	4858	19430	2429						61	61		
STA EQ 626+56.44 BK=628+69.13 AH			STATION EQUATION											
628+69.13	TO	699+11.00	7042	28167	3521						88	88		
699+11.00	TO	701+71.00	260	1040	130						3	3		
701+71.00	TO	796+00.00	9429	37716	4715						118	118		
STA EQ 796+00.00 BK=796+08.60 AH			STATION EQUATION											
796+08.60	TO	846+00.00	4991	19966	2496						62	62		
STA EQ 846+00.00 BK=846+01.30 AH			STATION EQUATION											
846+01.30	TO	876+67.39	3066	12264	1533						38	38		
STA EQ 876+67.39 BK=876+73.00 AH			STATION EQUATION											
LASALLE CO. SUBTOTAL				309525	38691	368	192	138		138	966	966		
LIVINGSTON COUNTY														
876+73.00	TO	892+21.33	1548	6193	774						19	19		
STA EQ 892+21.33 BK=892+29.60 AH			STATION EQUATION											
892+29.60	TO	909+00.00	1670	6682	835						21	21		
STA EQ 909+00.00 BK=909+01.30 AH			STATION EQUATION											
909+01.30	TO	920+75.00	1174	4695	587			26	61	26	61	15	15	
920+75.00	TO	921+55.00	80	320	40						1	1		
921+55.00	TO	922+05.00	50	200	25			26		26	1	1		
922+05.00	TO	922+85.00	80	320	40						1	1		
922+85.00	TO	937+00.00	1415	5660	708			26	61	26	61	18	18	
STA EQ 937+00.00 BK=937+14.40 AH			STATION EQUATION											
937+14.40	TO	946+44.00	930	3718	465						12	12		
LIVINGSTON CO. SUBTOTAL				27788	3474			78	122	78	122	88	88	
TOTAL				84328	337313	42165	368	192	216	122	216	122	1054	1054

MODEL: Default
 FILE NAME: c:\pwworking\illinois.gov_richard.yoo\0974601\0366P42-sh-schedule.dgn

USER NAME = Richard.Yoo	DESIGNED -	REVISED -
	DRAWN -	REVISED -
	CHECKED -	REVISED -
PLOT DATE = 6/27/2024	DATE -	REVISED -

STATE OF ILLINOIS
DEPARTMENT OF TRANSPORTATION

SCALE: SHEET OF SHEETS STA. TO STA.

SCHEDULES

F.A.P RTE.	SECTION	COUNTY	TOTAL SHEETS	SHEET NO.
786	(109,110,111)RS-4	VARIOUS	28	12
CONTRACT NO. 66P42				
		ILLINOIS	FED. AID PROJECT	

SHORT TERM PAVEMENT MARKINGS				
LOCATION			SHORT TERM PVMT	SHORT TERM PVMT REM
STATION			FOOT	SQ FT
LASALLE COUNTY				
98+35.00	TO	156+95.12	1758	195
STA EQ 156+95.12 BK=157+11.92 AH			STATION EQUATION	
157+11.92	TO	232+99.14	2276	253
STA EQ 232+99.14 BK=233+00.00 AH			STATION EQUATION	
233+00.00	TO	372+45.29	4184	465
STA EQ 372+45.29 BK=372+50.00 AH			STATION EQUATION	
372+50.00	TO	454+10.27	2448	272
STA EQ 454+10.27 BK=454+00.00 AH			STATION EQUATION	
454+00.00	TO	547+00.00	2790	310
STA EQ 547+00.00 BK=549+17.44 AH			STATION EQUATION	
549+17.44	TO	578+00.00	865	96
STA EQ 578+00.00 BK=577+98.93 AH			STATION EQUATION	
577+98.93	TO	626+56.44	1457	162
STA EQ 626+56.44 BK=628+69.13 AH			STATION EQUATION	
628+69.13	TO	699+11.00	2113	235
699+11.00	TO	701+71.00	78	9
701+71.00	TO	796+00.00	2829	314
STA EQ 796+00.00 BK=796+08.60 AH			STATION EQUATION	
796+08.60	TO	846+00.00	1497	166
STA EQ 846+00.00 BK=846+01.30 AH			STATION EQUATION	
846+01.30	TO	876+67.39	920	102
LASALLE CO. SUBTOTAL			23214	2579
LIVINGSTON COUNTY				
STA EQ 876+67.39 BK=876+73.00 AH			STATION EQUATION	
876+73.00	TO	892+21.33	464	52
STA EQ 892+21.33 BK=892+29.60 AH			STATION EQUATION	
892+29.60	TO	909+00.00	501	56
STA EQ 909+00.00 BK=909+01.30 AH			STATION EQUATION	
909+01.30	TO	920+75.00	352	39
920+75.00	TO	921+55.00	24	3
921+55.00	TO	922+05.00	15	2
922+05.00	TO	922+85.00	24	3
922+85.00	TO	937+00.00	425	47
STA EQ 937+00.00 BK=937+14.40 AH			STATION EQUATION	
937+14.40	TO	946+44.00	279	31
LIVINGSTON CO. SUBTOTAL			2084	233
TOTAL			25298	2812

PAVEMENT MARKING SCHEDULE (NO PASSING ZONES)

LOCATION			MODIFIED URETHANE (2 APPLICATIONS)
STATION			LINE 4" YELLOW
STATION			FOOT
LASALLE COUNTY			
98+35	TO	117+11	3753
98+35	TO	117+11	3753
117+11	TO	123+38	1252
286+20	TO	294+41	1641
297+12	TO	302+74	1123
502+61	TO	512+96	2070
512+96	TO	518+96	1201
512+96	TO	518+96	1201
518+96	TO	526+90	1587
534+74	TO	543+99	1851
544+71	TO	553+24	1707
568+52	TO	575+10	1315
576+99	TO	587+06	2015
608+05	TO	615+62	1514
615+62	TO	624+24	1724
615+62	TO	624+24	1724
624+24	TO	630+85	1322
630+85	TO	633+12	453
630+85	TO	633+12	453
633+12	TO	639+11	1198
642+03	TO	650+36	1666
654+18	TO	662+77	1717
663+22	TO	670+91	1538
686+40	TO	694+23	1568
694+23	TO	697+52	656
694+23	TO	697+52	656
697+52	TO	706+39	1775
782+45	TO	791+86	1883
792+74	TO	799+52	1356
868+19	TO	875+74	1510
LASALLE CO. SUBTOTAL			47183
LIVINGSTON COUNTY			
875+74	TO	894+74	3800
875+74	TO	894+74	3800
894+74	TO	902+75	1602
911+84	TO	917+08	1048
917+08	TO	921+63	910
LIVINGSTON CO. SUBTOTAL			11160
TOTALS			58343

MODEL: Default
FILE NAME: c:\p\work\pavmark\illinois.gov_richard.yoo@d0974601\0366P42-sh-schedule.dgn

USER NAME = Richard.Yoo	DESIGNED -	REVISED -
	DRAWN -	REVISED -
	CHECKED -	REVISED -
PLOT DATE = 6/27/2024	DATE -	REVISED -

**STATE OF ILLINOIS
DEPARTMENT OF TRANSPORTATION**

SCALE: SHEET OF SHEETS STA. TO STA.

SCHEDULES

F.A.P. RTE.	SECTION	COUNTY	TOTAL SHEETS	SHEET NO.
786	(109,110,111)RS-4	VARIOUS	28	13
CONTRACT NO. 66P42				
ILLINOIS FED. AID PROJECT				

MAINLINE SCHEDULE

STA. TO STA.	LENGTH	MAINLINE WIDTH	HMA SURFACE REMOVAL	HMA SURFACE REMOVAL VARIABLE DEPTH	HMA SURFACE REMOVAL	HMA SURF.CSE MIX.C IL-9.5,N50 1 1/2"	BINDER COURSE IL-19.0 N50 2 1/4"	MATERIAL TRANSFER DEVICE	MIX FOR JTS, CRACKS & FLGWYS	BIT. MAT'L (TACK COAT)	LONG JOINT SEAL	RUMBLE STRIPS 8"	AGG WEDGE TY B	TEMP RAMP	
	FT	FT	SQ YD	SQ YD	SQ YD	TONS	TONS	TON	TONS	POUND	FOOT	FOOT	TONS	SQ YD	
LASALLE COUNTY															
98+35.00	156+95.12	5860.12	32	20836.0		1750.2	2625.3	4375.6	6.3	1562.7	5860.1	4269.1	444.9	44.4	
156+95.12 BK	157+11.92 AH	STATION EQUATION													
157+11.92	232+99.14	7587.22	32	26976.8		2266.0	3399.1	5665.1	8.1	2023.3	7587.2	7587.2	576.1		
232+99.14 BK	233+00.00 AH	STATION EQUATION													
233+00.00	372+45.29	13945.29	32	49583.3		4165.0	6247.5	10412.5	14.9	3718.7	13945.3	13945.3	1058.8		
372+45.29 BK	372+50.00 AH	STATION EQUATION													
372+50.00	454+10.27	8160.27	32	29014.3		2437.2	3655.8	6093.0	8.7	2176.1	8160.3	8160.3	619.6		
454+10.27 BK	454+00.00 AH	STATION EQUATION													
454+00.00	547+00.00	9300	32	33066.7		2777.6	4166.4	6944.0	9.9	2480.0	9300.0	9300.0	706.1		
547+00.00 BK	549+17.44 AH	STATION EQUATION													
549+17.44	578+00.00	2882.56	32	10249.1		860.9	1291.4	2152.3	3.1	768.7	2882.6	2882.6	218.9		
578+00.00 BK	577+98.93 AH	STATION EQUATION													
577+98.93	626+56.44	4857.51	32	17271.1		1450.8	2176.2	3626.9	5.2	1295.3	4857.5	4857.5	368.8		
626+56.44 BK	628+69.13 AH	STATION EQUATION													
628+69.13	676+00.00	4730.87	32	16820.9		1413.0	2119.4	3532.4	5.0	1261.6	4730.9	4730.9	359.2	44.4	
676+00.00	699+11.00	2311	26	6676.2		560.8	841.2	1402.0	2.0	500.7	2311.0		175.5	36.1	
699+11.00	701+71.00	BRIDGE OMISSION													
701+71.00	796+00.00	9429	26	27239.3		2288.1	3432.2	5720.3	8.2	2043.0	9429.0		715.9	36.1	
796+00.00 BK	796+08.60 AH	STATION EQUATION													
796+08.60	846+00.00	4991.4	26	14419.6		1211.2	1816.9	3028.1	4.3	1081.5	4991.4		379.0		
846+00.00 BK	846+01.30 AH	STATION EQUATION													
846+01.30	876+67.39	3066.09	26	8857.6		744.0	1116.1	1860.1	2.7	664.3	3066.1		232.8		
876+67.39 BK	876+73.00 AH	STATION EQUATION													
876+73.00	892+21.33	1548.33	26	4473.0		375.7	563.6	939.3	1.3	335.5	1548.3		117.6		
LASALLE CO. SUBTOTAL				258808		21740	32610	54350	78	19411	76359	55733	5798	125	
888+67	LASALLE-LIVINGSTON COUNTY LINE														
LIVINGSTON COUNTY															
892+21.33 BK	892+29.60 AH	STATION EQUATION													
892+29.60	909+00.00	1670.4	26	4825.6		405.4	608.0	1013.4	1.4	361.9	1670.4		126.8		
909+00.00 BK	909+01.30 AH	STATION EQUATION													
909+01.30	920+75.00	1173.7	26	3390.7		284.8	427.2	712.0	1.0	254.3	1173.7		89.1		
920+75.00	921+55.00	80	26		231.1	19.4	11.3	30.7	0.1	17.3	80.0		6.1		
921+55.00	922+05.00	50	26			12.1		12.1	0.0	10.8	50.0		3.8	72.2	
922+05.00	922+85.00	80	26		231.1	19.4	11.3	30.7	0.1	17.3	80.0		6.1		
922+85.00	937+00.00	1415	26	4087.8											
937+00.00 BK	937+14.40 AH	STATION EQUATION													
937+14.40	946+44.00	929.6	26	2685.5		225.6	338.4	564.0	0.8	201.4	929.6		70.6	36.1	
LIVINGSTON CO. SUBTOTAL				14990	462	144	967	1396	2363	3	863	3984	0	302	108
TOTALS				273798	462	144	22707	34006	56713	81	20274	80343	55733	6100	233

MODEL: Default
FILE NAME: c:\pwworking\illinois.gov_richard.yoo\d0974601\0366P42-sh-schedule.dgn

USER NAME = Richard.Yoo	DESIGNED -	REVISED -
	DRAWN -	REVISED -
	CHECKED -	REVISED -
PLOT DATE = 6/27/2024	DATE -	REVISED -

**STATE OF ILLINOIS
DEPARTMENT OF TRANSPORTATION**

SCHEDULES	
SCALE:	SHEET OF SHEETS STA. TO STA.

F.A.P. RTE.	SECTION	COUNTY	TOTAL SHEETS	SHEET NO.
786	(109,110,111)RS-4	VARIOUS	28	14
CONTRACT NO. 66P42				
ILLINOIS FED.AID PROJECT				

SIDEROADS SCHEDULE																
STATION	NAME	SIDE	MATERIAL	WIDTH FRONT	WIDTH BACK	LENGTH	VARIABLE DEPTH SURF REM	INCIDENTAL HMA SURF	BIT MATL (TACK COAT)	TEMP RAMP	FURNISH EX	SEEDING, CL 2A *	NITROGEN FERTILIZER NUTRIENT *	PHOSPHORUS FERTILIZER NUTRIENT *	POTASSIUM FERTILIZER NUTRIENT *	EROSION CONTROL BLANKET *
				FOOT	FOOT	FOOT	SQ YD	TON	POUND	SQ YD	CU YD	ACRE	POUND	POUND	POUND	SQ YD
LASALLE COUNTY																
184+08	N 2350th Rd	LT	HMA	60	23	30	138.3	20.5	62.3	12.8	0.4	0.002	0.2	0.2	0.2	10.0
184+17	N 2350th Rd	RT	HMA	66	25	30	151.7	22.5	68.3	13.9	0.4	0.002	0.2	0.2	0.2	10.0
251+57	N 22nd Rd	LT	HMA	56	21	30	128.3	19.0	57.8	11.7	0.4	0.002	0.2	0.2	0.2	10.0
251+57	N 22nd Rd	RT	AGG	113	103	10	SEE AGG SURF QUANTITY IN ENTRANCES SCHEDULE									
304+63	N 21st Rd	LT	HMA	257	29	154	1476.7	219.1	664.5							
304+63	N 21st Rd	RT	HMA	239	24	235	1720.8	255.4	774.4	13.3	0.4	0.002	0.2	0.2	0.2	10.0
357+70	N 20th Rd	LT	HMA	50	21	30	118.3	17.6	53.3	11.7	0.4	0.002	0.2	0.2	0.2	10.0
357+70	N 20th Rd	RT	HMA	52	22	30	123.3	18.3	55.5	12.2	0.4	0.002	0.2	0.2	0.2	10.0
410+70	N 19th Rd	LT	HMA	86	27	30	188.3	27.9	84.8	15.0	0.4	0.002	0.2	0.2	0.2	10.0
410+70	N 19th Rd	RT	HMA	57	23	30	133.3	19.8	60.0	12.8	0.4	0.002	0.2	0.2	0.2	10.0
463+57	N 18th Rd	LT	HMA	56	24	30	133.3	19.8	60.0	13.3	0.4	0.002	0.2	0.2	0.2	10.0
463+57	N 18th Rd	RT	HMA	56	20	30	126.7	18.8	57.0	11.1	0.4	0.002	0.2	0.2	0.2	10.0
516+26	N 17th Rd	LT	HMA	145	30	63	291.7	43.3	131.3	16.7	0.4	0.002	0.2	0.2	0.2	10.0
570+21	E 2800th Rd	RT	HMA	40	22	15	103.3	15.3	46.5	12.2	0.4	0.002	0.2	0.2	0.2	10.0
570+21	E 2800th Rd	LT	HMA	50	22	15	120.0	17.8	54.0	12.2	0.4	0.002	0.2	0.2	0.2	10.0
620+16	N 17th Rd	RT	HMA	140	22	66	281.3	41.7	126.6	12.2	0.4	0.002	0.2	0.2	0.2	10.0
625+10	E 27th Rd	RT	HMA	130	23	100	316.6	47.0	142.5	12.8	0.4	0.002	0.2	0.2	0.2	10.0
676+68	N16th Rd	RT	PCC	99	21	30										
676+68	N16th Rd	LT	HMA	108	24	78	298.8	44.3	134.5	13.3	0.4	0.002	0.2	0.2	0.2	10.0
709+83	E Plumb St	RT	HMA	90	36	30	210.0	31.2	94.5	20.0	0.4	0.002	0.2	0.2	0.2	10.0
715+44	E Harrison St	RT	HMA	63	23	30	143.3	21.3	64.5	12.8	0.4	0.002	0.2	0.2	0.2	10.0
718+97	Roosevelt St	RT	HMA	51	18	30	115.0	17.1	51.8	10.0	0.4	0.002	0.2	0.2	0.2	10.0
729+50	N 15th Rd	LT	HMA	93	28	30	201.7	29.9	90.8	15.6	0.4	0.002	0.2	0.2	0.2	10.0
729+50	N 15th Rd	RT	HMA	63	24	30	145.0	21.5	65.3	13.3	0.4	0.002	0.2	0.2	0.2	10.0
782+38	N 14th Rd	LT	HMA	100	32	30	220.0	32.6	99.0	17.8	0.4	0.002	0.2	0.2	0.2	10.0
782+38	N 14th Rd	RT	HMA	62	25	30	145.0	21.5	65.3	13.9	0.4	0.002	0.2	0.2	0.2	10.0
835+40	N 13th Rd	LT	HMA	72	27	30	165.0	24.5	74.3	15.0	0.4	0.002	0.2	0.2	0.2	10.0
835+40	N 13th Rd	RT	HMA	74	26	30	166.7	24.7	75.0	14.4	0.4	0.002	0.2	0.2	0.2	10.0
888+67	E 3300 N Rd	LT	HMA	92	27	30	198.3	29.4	89.3	15.0	0.4	0.002	0.2	0.2	0.2	10.0
888+67	E 3300 N Rd	RT	HMA	80	23	30	171.7	25.5	77.3	12.8	0.4	0.002	0.2	0.2	0.2	10.0
LASALLE CO. SUBTOTAL							7733	1148	3480	368	11					
TOTALS							7733	1148	3480	368	11	0.06	5	5	5	270

* SEEDING PAY ITEMS WILL NOT BE PAID FOR SEPARATELY, BUT WILL BE INCLUDED IN THE COST OF FURNISHED EXCAVATION.

PATCHING SCHEDULE																	
SOUTHBOUND							NORTHBOUND										
LOCATION	PATCH LENGTH	PATCH WIDTH	CLASS B PATCHING TYPE II 20"	SAW CUTS	DOWEL BARS 1 1/2"	DRILL AND GROUT DOWEL BARS	LOCATION	PATCH LENGTH	PATCH WIDTH	CLASS B PATCHING TYPE II 20"	CLASS B PATCHING TYPE IV 20"	PATCH REINFORCEMENT	SAW CUTS	TIE BARS 3/4"	DRILL AND GROUT #6 TIE BARS	DOWEL BARS 1 1/2"	DRILL AND GROUT DOWEL BARS
STATION	FT	FT	SQ YD	FT	EACH	EACH	STATION	FT	FT	SQ YD	SQ YD	SQ YD	FT	EACH	EACH	EACH	EACH
LASALLE COUNTY																	
137+83	10	12	13	56	20	20	137+83	10	12	13			56			20	20
149+24	6	12	8	48	20	20	138+26	9	12	12			54			20	20
225+60	6	12	8	48	20	20	149+24	6	12	8			48			20	20
							300+95	32	12		43	43	100	30	30	20	20
							301+51	6	12	8			48			20	20
							756+12	9	11	11			51			20	20
LASALLE CO. TOTALS							LASALLE CO. TOTALS										
SOUTHBOUND TOTALS							NORTHBOUND TOTALS										
			29	152	60	60				52	43	43	357	30	30	120	120

MODEL: Default; FILE NAME: c:\pwworking\illinois.gov_rchard.yoo\illinois.gov_60974601\0366P42-sh-schedule.dgn

ENTRANCES SCHEDULE

STATION	TYPE	SIDE	MATERIAL	WIDTH	WIDTH	LENGTH	VARIABLE	INCIDENTAL	BIT	AGG
				FRONT	BACK		DEPTH	HMA SURF	MATL	SURF
				FOOT	FOOT	FOOT	SQ YD	TON	POUND	TON
LASALLE COUNTY										
113+86	FE	RT	AGG	93	44	10				13.0
114+15	PE	LT	HMA	92	35	30	211.7	31.4	95.3	
116+29	FE	RT	AGG	20	20	10				3.8
116+85	FE	RT	AGG	20	20	10				3.8
117+24	FE	LT	AGG	20	20	10				3.8
117+32	FE	RT	AGG	20	20	10				3.8
121+22	PE	LT	HMA/AGG	46	26	10	40.0	5.9	18.0	
123+10	PE	RT	HMA/AGG	35	15	10	27.8	4.1	12.5	
125+00	PE	LT	HMA	40	17	10	31.7	4.7	14.3	
125+18	PE	RT	AGG	29	14	10	23.9			4.1
126+76	PE	RT	AGG	24	13	10	20.6			3.5
127+91	PE	LT	HMA	27	10	10	20.6	3.1	9.3	
128+51	PE	RT	HMA	12	10	10	12.2	1.8	5.5	
129+27	FE	LT	AGG	20	20	10				3.8
129+88	PE	RT	AGG	44	20	10	35.6			6.1
130+83	PE	LT	HMA	25	18	10	23.9	3.5	10.8	
130+93	PE	RT	PCC							
132+45	PE	RT	PCC							
132+54	PE	LT	HMA/AGG	26	22	10	26.7	4.0	12.0	
132+85	PE	RT	HMA	35	24	10	32.8	4.9	14.8	
134+00	PE	LT	HMA/AGG	35	20	10	30.6	4.5	13.8	
134+27	PE	RT	HMA/PCC	31	19	10	27.8	4.1	12.5	
135+21	PE	LT	HMA/AGG	34	11	10	25.0	3.7	11.3	
135+70	PE	RT	HMA	35	23	10	32.2	4.8	14.5	
136+60	PE	LT	HMA	39	23	10	34.4	5.1	15.5	
137+10	PE	RT	HMA	20	12	10	17.8	2.6	8.0	
138+47	PE	LT	AGG	25	15	10				3.8
138+60	PE	RT	HMA	20	12	10	17.8	2.6	8.0	
139+20	PE	LT	HMA	27	17	10	24.4	3.6	11.0	
139+35	PE	RT	HMA/PCC	27	17	10	24.4	3.6	11.0	
141+95	PE	LT	HMA/AGG	37	18	10	30.6	4.5	13.8	
143+83	PE	LT	HMA/AGG	50	26	10	42.2	6.3	19.0	
145+71	PE	RT	HMA	27	16	10	23.9	3.5	10.8	
149+41	FE	LT	AGG	20	20	10				3.8
149+48	PE	RT	AGG	52	42	10				8.9
152+01	PE/MBTO	RT	HMA/AGG	46	28	10	41.1	6.1	18.5	
153+79	PE	RT	HMA/AGG	86	62	10	82.2	12.2	37.0	
156+95.12 BK	157+11.92 AH	STATION EQUATION								
158+64	PE	RT	AGG	24	12	10				3.4
160+18	PE	RT	AGG	26	16	10				4.0
162+41	PE	RT	AGG	39	24	10				6.0
162+93	PE	RT	HMA/AGG	38	34	10	40.0	5.9	18.0	
164+67	PE	RT	AGG	24	13	10				3.5
168+42	PE	LT	HMA/AGG	48	27	10	41.7	6.2	18.8	
168+89	PE	RT	HMA/AGG	34	22	10	31.1	4.6	14.0	
184+54	FE	LT	AGG	20	20	10				3.8
198+75	FE	LT	AGG	20	20	10				3.8
201+77	FE	RT	AGG	20	20	10				3.8
208+64	FE	LT	AGG	20	20	10				3.8
215+36	PE	RT	HMA/AGG	26	20	10	25.6	3.8	11.5	
232+99.14 BK	233+00.00 AH	STATION EQUATION								
238+31	FE	RT	AGG	20	20	10				3.8
244+87	MBTO	RT	HMA	40	20	2	6.7	1.0	3.0	
245+52	PE	LT	HMA/AGG	57	32	10	49.4	7.3	22.3	
249+23	PE	RT	HMA/AGG	49	30	10	43.9	6.5	19.8	
251+57	PE/MBTO	RT	HMA	113	103	10	120.0	17.8	54.0	

MODEL: Default
FILE NAME: c:\pwworking\illinois.gov_richard.yoo\0974601\0366P42-sh-schedule.dgn

USER NAME = Richard.Yoo	DESIGNED -	REVISED -
	DRAWN -	REVISED -
	CHECKED -	REVISED -
PLOT DATE = 6/27/2024	DATE -	REVISED -

**STATE OF ILLINOIS
DEPARTMENT OF TRANSPORTATION**

SCHEDULES

SCALE: SHEET OF SHEETS STA. TO STA.

F.A.P. RTE.	SECTION	COUNTY	TOTAL SHEETS	SHEET NO.
786	(109,110,111)R5-4	VARIOUS	28	16
CONTRACT NO. 66P42				
ILLINOIS FED. AID PROJECT				

ENTRANCES SCHEDULE (CONT.)

STATION	TYPE	SIDE	MATERIAL	WIDTH	WIDTH	LENGTH	VARIABLE	INCIDENTAL	BIT	AGG
				FRONT	BACK		DEPTH	HMA SURF	MATL	SURF
				FOOT	FOOT	FOOT	SQ YD	TON	POUND	TY B
258+69	PE/MBTO	RT	AGG	50	30	10				7.6
264+78	PE/MBTO	RT	HMA/AGG	50	26	10	42.2	6.3	19.0	
268+12	PE	RT	AGG	48	35	10				7.9
278+00	FE	LT	AGG	20	20	10				3.8
278+37	FE	RT	AGG	20	20	10				3.8
278+37	FE	LT	AGG	20	20	10				3.8
295+00	FE	LT	AGG	20	20	10				3.8
317+66	FE	RT	AGG	20	20	10				3.8
318+02	FE	LT	AGG	20	20	10				3.8
331+05	FE	RT	AGG	20	20	10				3.8
333+03	PE	LT	HMA/AGG	60	31	10	50.6	7.5	22.8	
349+14	PE/MBTO	LT	HMA/AGG	52	30	10	45.6	6.8	20.5	
360+63	PE	LT	AGG	50	22	10	40.0	5.9	18.0	
360+63	MBTO	RT	HMA	40	20	2	6.7	1.0	3.0	
372+45.29 BK	372+50.00 AH	STATION EQUATION								
373+14	FE	RT	AGG	20	20	10				3.8
373+14	FE	LT	AGG	20	20	10				3.8
395+55	PE	LT	HMA/AGG	48	26	10	41.1	6.1	18.5	
397+22	FE	RT	AGG	20	20	10				3.8
400+22	PE/MBTO	RT	HMA/AGG	44	20	10	35.6	5.3	16.0	
414+57	PE	RT	HMA/AGG	49	22	10	39.4	5.9	17.8	
414+57	FE	LT	AGG	20	20	10				3.8
424+06	FE	RT	AGG	20	20	10				3.8
437+12	FE	LT	AGG	20	20	10				3.8
440+46	FE	LT	AGG	20	20	10				3.8
441+11	FE	RT	AGG	20	20	10				3.8
441+95	PE	LT	HMA/AGG	43	18	10	33.9	5.0	15.3	
454+10.27 BK	454+00.00 AH	STATION EQUATION								
448+23	FE	RT	AGG	20	20	10				3.8
449+00	FE	LT	AGG	20	20	10				3.8
474+57	PE	LT	AGG	40	13	10				5.0
484+80	PE	RT	AGG	78	37	10				10.9
485+30	FE	LT	AGG	20	20	10				3.8
489+87	FE	RT	AGG	20	20	10				3.8
494+35	FE	RT	AGG	20	20	10				3.8
503+55	PE	LT	HMA	35	17	10	28.9	4.3	13.0	
506+15	FE	RT	AGG	20	20	10				3.8
528+61	FE	RT	AGG	20	20	10				3.8
528+90	FE	LT	AGG	20	20	10				3.8
541+23	FE	LT	AGG	20	20	10				3.8
545+18	PE	RT	HMA/AGG	77	50	10	70.6	10.5	31.8	
547+00.00 BK	549+17.44 AH	STATION EQUATION								
557+36	FE	RT	AGG	20	20	10				3.8
565+82	FE	LT	AGG	20	20	10				3.8
578+00.00 BK	577+98.98 AH	STATION EQUATION								
583+72	FE	LT	AGG	20	20	10				3.8
590+00	FE	RT	AGG	20	20	10				3.8
596+87	PE	RT	HMA/AGG	33	15	10	26.7	4.0	12.0	
596+91	FE	LT	AGG	20	20	10				3.8
624+74	PE	RT	HMA/AGG	30	13	10	23.9	3.5	10.8	
626+56.44 BK	628+69.13 AH	STATION EQUATION								
630+00	PE/MBTO	LT	HMA/AGG	101	42	10	79.4	11.8	35.8	
637+00	FE	RT	AGG	20	20	10				3.8
640+33	FE	LT	AGG	20	20	10				3.8
650+03	FE	RT	AGG	20	20	10				3.8
650+03	FE	LT	AGG	20	20	10				3.8
650+35	FE	RT	AGG	20	20	10				3.8

MODEL: Default
FILE NAME: c:\pwwork\work\illinois.gov_richard.yoo\0974601\0366P42-sh-schedule.dgn

USER NAME = Richard.Yoo	DESIGNED -	REVISED -
	DRAWN -	REVISED -
	CHECKED -	REVISED -
PLOT DATE = 6/27/2024	DATE -	REVISED -

**STATE OF ILLINOIS
DEPARTMENT OF TRANSPORTATION**

SCHEDULES			
SCALE:	SHEET	OF	SHEETS
	STA.		TO STA.

F.A.P. RTE.	SECTION	COUNTY	TOTAL SHEETS	SHEET NO.
786	(109,110,111)RS-4	VARIOUS	28	17
CONTRACT NO. 66P42				
ILLINOIS FED. AID PROJECT				

ENTRANCES SCHEDULE (CONT.)

STATION	TYPE	SIDE	MATERIAL	WIDTH	WIDTH	LENGTH	VARIABLE	INCIDENTAL	BIT	AGG
				FRONT	BACK		DEPTH			
				FOOT	FOOT	FOOT	REM	TON	POUND	TY B
							SQ YD			TON
657+28	PE	RT	AGG	26	12	10				3.6
668+53	PE/MBTO	LT	HMA/AGG	38	21	10	32.8	4.9	14.8	5.6
685+21	FE	LT	AGG	20	20	10				3.8
689+12	PE	LI	HMA/AGG	42	16	10	32.2	4.8	14.5	
711+61	FE	LT	AGG	20	20	10				3.8
715+44	FE	LT	AGG	20	20	10				3.8
719+24	PE	LT	HMA/AGG	40	18	10	32.2	4.8	14.5	
722+40	FE	LT	AGG	20	20	10				3.8
737+22	PE	RT	HMA/AGG	28	16	10	24.4	3.6	11.0	
742+38	MBTO	RT	HMA	40	20	2	6.7	1.0	3.0	
742+84	FE	RT	AGG	20	20	10				3.8
742+94	PE	LT	HMA/AGG	33	18	10	28.3	4.2	12.8	
756+00	FE	RT	AGG	20	20	10				3.8
762+28	FE	LT	AGG	20	20	10				3.8
765+78	PE	LT	HMA/AGG	105	88	10	107.2	15.9	48.3	18.3
765+78	MBTO	RT	HMA	40	20	2	6.7	1.0	3.0	
768+56	FE	RT	AGG	20	20	10				3.8
785+94	PE	LT	HMA/AGG	45	24	10	38.3	5.7	17.3	
795+45	FE	LT	AGG	20	20	10				3.8
795+78	FE	RT	AGG	20	20	10				3.8
796+00.00 BK	796+08.60 AH	STATION EQUATION								
797+73	PE	LT	HMA/AGG	47	20	10	37.2	5.5	16.8	
797+73	MBTO	RT	HMA	40	20	2	6.7	1.0	3.0	
799+06	FE	LT	AGG	20	20	10				3.8
803+32	PE	RT	HMA/AGG	35	20	10	30.6	4.5	13.8	
807+07	PE	LT	HMA	48	17	10	36.1	5.4	16.3	
808+96	FE	LT	AGG	20	20	10				3.8
813+49	FE	LT	AGG	20	20	10				3.8
815+69	PE	RT	HMA/AGG	22	12	10	18.9	2.8	8.5	
822+20	FE	LT	AGG	20	20	10				3.8
840+00	FE	LT	AGG	20	20	10				3.8
846+00.00 BK	846+01.30 AH	STATION EQUATION								
847+00	FE	RT	AGG	18	14	10				3.0
854+73	PE/MBTO	RT	HMA	40	20	10	33.3	4.9	15.0	
854+94	FE	LT	AGG	20	20	10				3.8
857+74	FE	RT	AGG	20	20	10				3.8
862+00	FE	RT	AGG	20	20	10				3.8
862+10	FE	LT	AGG	20	20	10				3.8
868+62	PE	LT	HMA/PCC	50	29	10	43.9	6.5	19.8	
869+25	PE	LT	HMA	38	16	10	30.0	4.5	13.5	
875+31	PE	RT	HMA	46	20	10	36.7	5.4	16.5	
876+67.39 BK	876+73.00 AH	STATION EQUATION								
LASALLE CO. SUBTOTAL							2467	354	1074	792
888+67	LASALLE-LIVINGSTON COUNTY LINE									
LIVINGSTON COUNTY										
892+21.33 BK	892+29.6 AH	STATION EQUATION								
895+63	FE	RT	AGG	20	20	10				3.8
902+84	FE	RT	AGG	20	20	10				3.8
909+00.00 BK	909+01.30 AH	STATION EQUATION								
912+13	FE	RT	AGG	20	20	10				3.8
912+53	FE	LT	AGG	27	14	10				3.9
920+00	CE	LT	HMA	70	30	30	166.7	24.7	75.0	
928+21	FE	RI	AGG	25	14	10				3.7
937+00.00 BK	937+14.40 AH	STATION EQUATION								
937+27	PE	RT	HMA	33	17	10	27.8	4.1	12.5	
943+05	FE	LT	AGG	20	20	10				3.8
946+10	CE	LT	PCC							
LIVINGSTON CO. SUBTOTAL							194	29	88	19
TOTAL							2661	383	1162	811

MODEL: Default
FILE NAME: c:\pwwork\work\illinois.gov_richard.yoo\0974601\0366P42-sh-schedule.dgn

USER NAME = Richard.Yoo
PLOT DATE = 6/27/2024

DESIGNED -	REVISED -
DRAWN -	REVISED -
CHECKED -	REVISED -
DATE -	REVISED -

**STATE OF ILLINOIS
DEPARTMENT OF TRANSPORTATION**

SCHEDULES

SCALE: SHEET OF SHEETS STA. TO STA.

F.A.P. RTE.	SECTION	COUNTY	TOTAL SHEETS	SHEET NO.
786	(109,110,111)RS-4	VARIOUS	28	18
CONTRACT NO. 66P42				
ILLINOIS FED. AID PROJECT				

LINEAR DELINEATOR PANEL SCHEDULE						
STRUCTURE NUMBER	SIDE	STRUCTURE CENTERLINE	GUARDRAIL LENGTH	PARAPET LENGTH	LINEAR DELINEATOR PANELS, 4"	LINEAR DELINEATOR PANELS, 6"
		STATION	FT	FT	EACH	EACH
LASALLE COUNTY						
050-2539	RIGHT	204+86.50	444.4		6	
050-2539	LEFT	204+86.50	444.2		6	
050-2055	RIGHT	314+14.00	235.2		3	
050-2055	LEFT	314+14.00	235.2		3	
050-2056	RIGHT	369+65.00	233.6		3	
050-2056	LEFT	369+65.00	233.0		3	
050-2057	RIGHT	445+55.00	270.2		3	
050-2057	LEFT	445+55.00	288.6		4	
050-2540	RIGHT	503+97.60	181.8		2	
050-2540	LEFT	503+97.60	167.8		2	
050-2541	RIGHT	520+34.40	177.1		2	
050-2541	LEFT	520+34.40	165.3		2	
050-0258	RIGHT	699+12.15	1171.0	225.6	15	3
050-0258	LEFT	701+70.11	1160.0	224.39	15	3
050-2542	RIGHT	766+39.20	167.8		2	
050-2542	LEFT	766+39.20	189.8		2	
050-2543	RIGHT	778+00.80	117.2		1	
LASALLE CO. SUBTOTAL			5882	450	74	6
TOTAL			5882	450	74	6

MODEL: Default
 FILE NAME: c:\p\work\pww\illinois.gov_richard.yoo@d074601D366P42-sh-schedule.dgn

USER NAME = Richard.Yoo	DESIGNED -	REVISED -	STATE OF ILLINOIS DEPARTMENT OF TRANSPORTATION	SCHEDULES			F.A.P. RTE.	SECTION	COUNTY	TOTAL SHEETS	SHEET NO.
	DRAWN -	REVISED -					786	(109,110,111)RS-4	VARIOUS	28	19
	CHECKED -	REVISED -		CONTRACT NO. 66P42			ILLINOIS FED. AID PROJECT				
PLOT DATE = 6/27/2024	DATE -	REVISED -		SCALE:	SHEET	OF SHEETS	STA.	TO STA.			

IL 170 PERMANENT SURVEY MARKER

GPS NUMBER	DESCRIPTION	APPROXIMATE LOCATION	EXISTING MONUMENT TYPE	PROPOSED MONUMENT TYPE	MONUMENT RECORD TO BE RECORDED	RESPONSIBILITY
170040	SW CORNER SECTION 1, T32N, R5E, 3RD PM	1450 FEET S OF 2350TH RD INTERSECTION	BRASS PLAQUE	TYPE 1	YES	1
170038	SW CORNER SECTION 12, T32N, R5E, 3RD PM	2200 N RD INTERSECTION	BRASS PLAQUE	TYPE 1	YES	1
170037	W QTR CORNER SECTION 13, T32N, R5E, 3RD PM	1/2 MI S OF 2200 N RD INTERSECTION	MAG NAIL AND WASHER	TYPE 1	YES	1
170036	SW CORNER SECTION 13, T32N, R5E, 3RD PM	2100 N RD INTERSECTION	BRASS PLAQUE	TYPE 1	YES	1
170035	W QTR CORNER SECTION 24, T32N, R5E, 3RD PM	1/2 MI S OF 2100 N RD INTERSECTION	MAG NAIL	MAG NAIL	NO	2
170034	SW CORNER SECTION 24, T32N, R5E, 3RD PM	2000 N RD INTERSECTION	MAG NAIL	TYPE 1	YES	1
170033	W QTR CORNER SECTION 25, T32N, R5E, 3RD PM	1/2 MI S OF 2000 N RD INTERSECTION	BURIED PK NAIL	MAG NAIL	NO	2
170032	SW CORNER SECTION 25, T32N, R5E, 3RD PM	1900 N RD INTERSECTION	MAG NAIL	TYPE 1	YES	1
170031	W QTR CORNER SECTION 36, T32N, R5E, 3RD PM	1/2 MI S OF 1900 N RD INTERSECTION	MAG NAIL	TYPE 1	YES	1
170030	SW CORNER SECTION 36, T32N, R5E, 3RD PM	1800 N RD INTERSECTION	MISSING	TYPE 1	YES	1
170029	NW CORNER SECTION 1, T31N, R5E, 3RD PM	1800 N RD INTERSECTION	OLD CROSS TIE NAILS	TYPE 1	YES	1
170028	W QTR CORNER SECTION 1, T31N, R5E, 3RD PM	1/2 MI S OF 1800 N RD INTERSECTION	MAG NAIL	MAG NAIL	NO	2
170026	N QTR CORNER SECTION 11, T31N, R5E, 3RD PM	1/2 MI W OF 2900 E RD INTERSECTION	PK NAIL	TYPE 1	YES	1
170025	NW CORNER SECTION 11, T31N, R5E, 3RD PM	2800 E RD INTERSECTION	MISSING	TYPE 1	YES	1
170024	N QTR CORNER SECTION 10, T31N, R5E, 3RD PM	1/2 MI W OF 2800 E RD INTERSECTION	BRASS PLAQUE	TYPE 1	YES	1
170022	W QTR CORNER SECTION 10, T31N, R5E, 3RD PM	1/2 MI S OF 1700 N RD INTERSECTION	PIPE / MAG NAIL	MAG NAIL	YES	1
170021	SW CORNER SECTION 10, T31N, R5E, 3RD PM	1600 N RD INTERSECTION	RAILROAD SPIKE OVER STONE	VAULT OVER STONE	YES	3
A017020	W QTR CORNER SECTION 15, T31N, R5E, 3RD PM	1/2 MI S OF 1600 N RD INTERSECTION	BRASS PLAQUE	TYPE 1	NO	1
170019	SW CORNER SECTION 15, T31N, R5E, 3RD PM	1500 N RD INTERSECTION	MAG NAIL	TYPE 1	YES	1
170018	W QTR CORNER SECTION 22, T31N, R5E, 3RD PM	1/2 MI S OF 1500 N RD INTERSECTION	PK NAIL	TYPE 1	YES	1
170017	SW CORNER SECTION 22, T31N, R5E, 3RD PM	1400 N RD INTERSECTION	MAG NAIL	TYPE 1	YES	1
170015	SW CORNER SECTION 27, T31N, R5E, 3RD PM	1300 N RD INTERSECTION	MAG NAIL	TYPE 1	YES	1
170014	W QTR CORNER SECTION 34, T31N, R5E, 3RD PM	1/2 MI S OF 1300 N RD INTERSECTION	NEW MAG NAIL	MAG NAIL	NO	1
170013	W QTR CORNER SECTION 33, T30N, R5E, 3RD PM	1/2 MI S OF 3300 N RD INTERSECTION	MAG NAIL	TYPE 1	NO	1

ONLY THE ORIGINAL SCOPE OF THIS JOB HAS BEEN SEARCHED FOR MONUMENTS. R.E. MUST INFORM PLATS AND PLANS TO SEARCH FOR ADDITIONAL MONUMENTS PRIOR TO MILLING IF ADDENDUMS HAVE BEEN ADDED TO THIS JOB.

R.E. WILL INFORM PLATS AND PLANS WHEN SURFACE IS TO BE MILLED FOR THE PURPOSE OF LOCATING ANY BURIED MONUMENTS.

UNKNOWN MONUMENTS MAY EXIST. IF AN UNLISTED MONUMENT IS FOUND, R.E. IS REQUIRED TO PROTECT THE MONUMENT FROM DAMAGE UNTIL A PLATS AND PLANS LAND SURVEYOR CAN DOCUMENT THE MONUMENT. PLATS AND PLANS WILL RESET SUCH MONUMENTS IN KIND FOLLOWING CONSTRUCTION.

UPON PAVING COMPLETION, R.E. WILL DIRECT PLATS AND PLANS TO STAKE THE TYPE 1 PSM CORING LOCATIONS.

TYPE 1 TOTALS ARE SUBJECT TO CHANGE BASED ON THE RESULTS OF THE MILLED ROAD MONUMENTS SEARCH.

NOTE: FOR BIDDING PURPOSES, NO CONTRACTED LAND SURVEYING SERVICES WILL BE REQUIRED FOR SETTING THE LISTED PERMANENT SURVEY MARKERS. PLATS AND PLANS WILL PREPARE THE REQUIRED MONUMENT RECORDS.

RESPONSIBILITY:

- 1) RESIDENT TO RE-ESTABLISH MONUMENT (PAY ITEM REQUIRED. PERMANENT SURVEY MARKER, TYPE 1)
- 2) PLATS AND PLANS TO RE-ESTABLISH MONUMENT
- 3) RESIDENT TO INSTALL VAULT OVER STONE MONUMENT PER SPECIAL PROVISION

MODEL: Default
FILE NAME: c:\pwwork\work\illinois.gov_richard.yoo\d0974601\0366P42-sh-schedule.dgn

USER NAME = Richard.Yoo	DESIGNED -	REVISED -	STATE OF ILLINOIS DEPARTMENT OF TRANSPORTATION	SCHEDULES			F.A.P. RTE.	SECTION	COUNTY	TOTAL SHEETS	SHEET NO.
	DRAWN -	REVISED -					786	(109,110,111)R5-4	VARIOUS	28	20
	CHECKED -	REVISED -		CONTRACT NO. 66P42			ILLINOIS FED. AID PROJECT				
PLOT DATE = 6/27/2024	DATE -	REVISED -		SCALE:	SHEET	OF	SHEETS	STA.	TO	STA.	

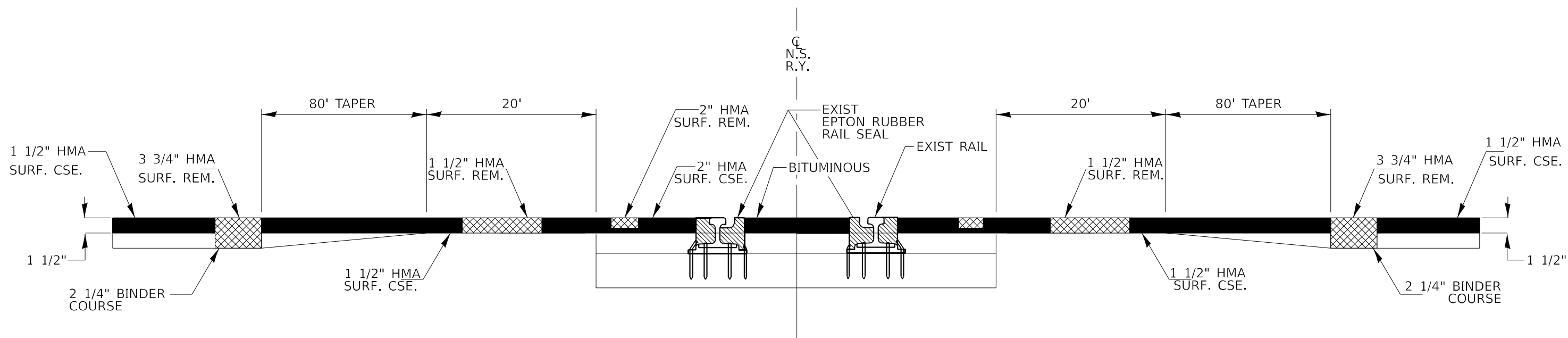

HMA SURFACE REMOVAL REPLACEMENT AT THE IL 170 - NORFOLK SOUTHERN RAILWAY GRADE CROSSING

DRAWING NOT TO SCALE

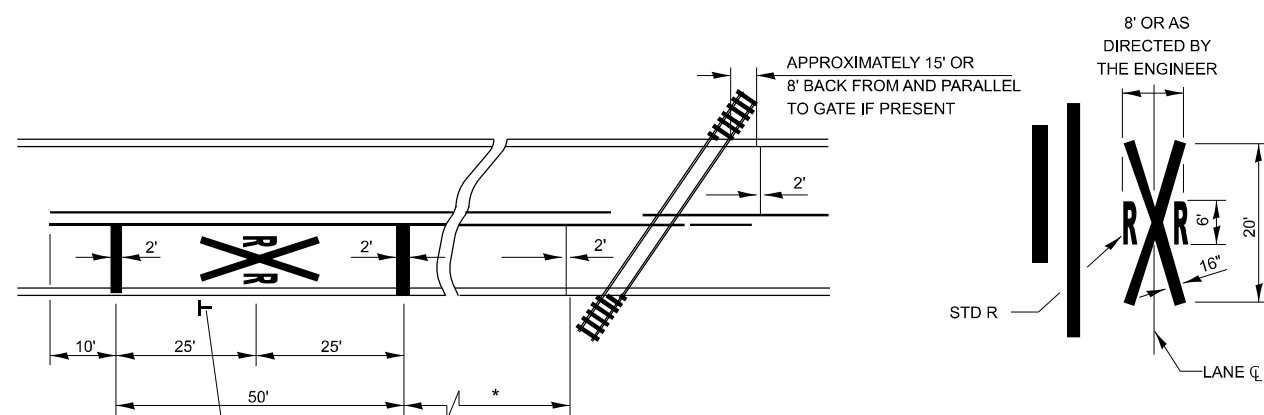

* MINIMUM DISTANCE
 500' FOR 55 MPH
 375' FOR 45 MPH
 250' FOR 35 MPH OR LESS

NOTES:
 THE TRANSVERSE SPREAD OF THE "X"
 MAY VARY ACCORDING TO LANE WIDTH.

ON MULTI-LANE ROADS, THE STOP LINES
 SHALL EXTEND ACROSS ALL APPROACH
 LANES AND SEPARATE RXR SYMBOLS SHALL
 BE PLACED ADJACENT TO EACH OTHER
 IN EACH LANE.

WHEN THE PAVEMENT MARKING SYMBOL
 IS USED, A PORTION OF THE SYMBOL
 SHOULD BE LOCATED DIRECTLY ADJACENT
 TO THE ADVANCE WARNING SIGN (W10-1).

**PAVEMENT MARKINGS AT
 RAILROAD-HIGHWAY GRADE CROSSING**

FILE NAME =	USER NAME = Anthony.Grunstad	DESIGNED -	REVISED -	STATE OF ILLINOIS DEPARTMENT OF TRANSPORTATION	DETAILS				F.A.P. RTE.	SECTION	COUNTY	TOTAL SHEETS	SHEET NO.		
pw2/illdot-pw.bentley.com/PWIDOT/Documents/IDOT Offices/District 3/ORD Projects/D368P42/CADDData/D368P42-sth-deta	DRAWN -	CHECKED -	REVISED -		SCALE:	SHEET	OF	SHEETS	STA.	TO STA.	786	(109,110,111)RS-4	VARIOUS	28	21
Default	PLOT SCALE = \$SCALE\$	DATE -	REVISED -		CONTRACT NO. 66P42										
	PLOT DATE = 6/27/2024	DATE -	REVISED -		ILLINOIS FED. AID PROJECT										

IDENTIFICATION OF ROADSIDE HAZARDS FOR TWO-LANE ROADWAYS

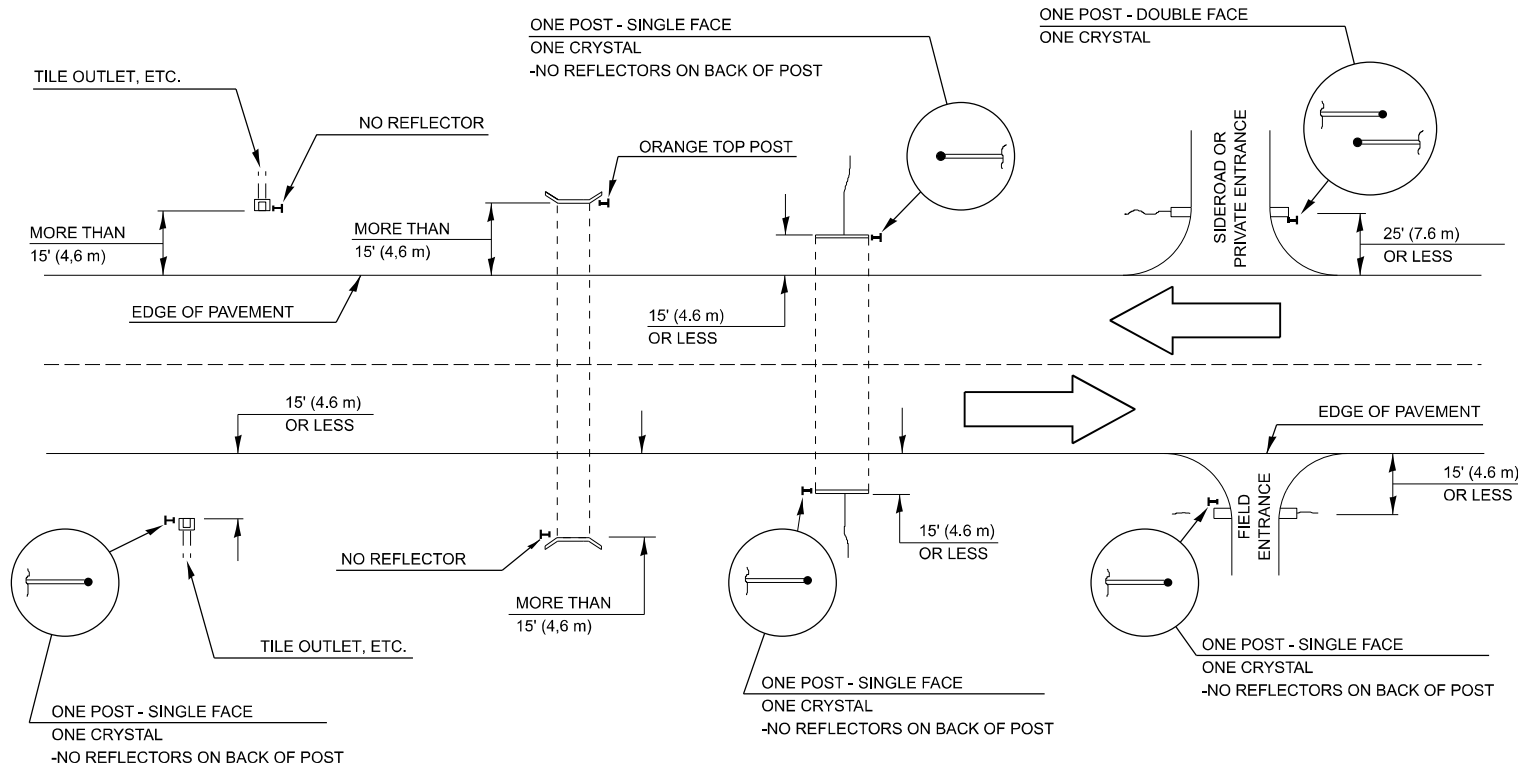

NOTE:

DELINEATORS FOR ROADSIDE HAZARDS SHALL ONLY BE PLACED AT LOCATIONS WHERE THERE IS NO GUARDRAIL, OR OTHER PERMANENT BARRIER, ON THE SAME SIDE OF THE ROAD AS THE HAZZARD.

DELINEATORS FOR ROADSIDE HAZARDS SHALL ONLY BE PLACED AT LOCATIONS WHERE DELINEATORS ARE NOT IN PLACE ALONG THE EDGE OF SHOULDER.

EACH POST SHALL BE CONSIDERED AS ONE DELINEATOR FOR PAYMENT, REGARDLESS OF THE NUMBER OF DELINEATORS ATTACHED TO IT.

FOR ONE-WAY AND INTERSTATE ROADWAYS THE APPLICATION SHALL BE SIMILAR WITH DELINEATORS PLACED ON THE TRAFFIC APPROACH SIDE OF HAZARDS AND OBJECTS. ONLY SINGLE FACE DELINEATORS WILL BE REQUIRED ON ONE-WAY ROADWAYS, CRYSTAL ON THE RIGHT SIDE AND AMBER ON THE LEFT SIDE.

FOR OTHER DELINEATOR APPLICATIONS, REFER TO HIGHWAY STANDARD 635001.

ROADSIDE HAZARDS DELINEATOR SCHEDULE

STRUCTURE NUMBER	SIDE	STRUCTURE CENTERLINE STATION	SINGLE FACE	DELINEATORS
			EACH	EACH
LASALLE COUNTY				
2329	LT, RT	118+33.00	2	2
1665	LT, RT	127+33.00	2	2
2330	LT, RT	143+57.00	2	2
1666	LT, RT	159+55.00	2	2
2331	LT, RT	185+71.00	2	2
1667	LT, RT	204+77.00	2	2
1668	LT, RT	243+82.00	2	2
2332	LT, RT	251+53.00	2	2
1669	LT, RT	270+33.00	2	2
1670	LT, RT	304+39.00	2	2
1671	LT, RT	324+00.00	2	2
1672	LT, RT	340+92.00	2	2
2333	LT, RT	358+00.00	2	2
1673	LT, RT	390+00.00	2	2
1674	LT, RT	407+55.00	2	2
1675	LT, RT	423+00.00	2	2
1676	LT, RT	463+45.00	2	2
1677	LT, RT	470+29.00	2	2
2334	LT, RT	484+00.00	2	2
1678	LT, RT	505+65.00	2	2
1679	LT, RT	523+54.00	2	2
2335	LT, RT	550+64.00	2	2
1680	LT, RT	559+00.00	2	2
1681	LT, RT	581+14.00	2	2
1682	LT, RT	589+07.00	2	2
1683	LT, RT	598+63.00	2	2
1684	LT, RT	612+00.00	2	2
1685	LT, RT	636+33.00	2	2
1686	LT, RT	654+26.00	2	2
1686	LT, RT	654+26.00	2	2
1687	LT, RT	660+00.00	2	2
1687	LT, RT	660+00.00	2	2
1688	LT, RT	671+91.00	2	2
1689	LT, RT	687+24.00	2	2
4924	LT, RT	707+50.00	2	2
1690	LT, RT	725+58.00	2	2
1691	LT, RT	744+90.00	2	2
1692	LT, RT	749+09.00	2	2
1693	LT, RT	771+51.00	2	2
1694	LT, RT	782+86.00	2	2
1695	LT, RT	802+72.00	2	2
1696	LT, RT	811+65.00	2	2
1697	LT, RT	835+00.00	2	2
1698	LT, RT	848+39.00	2	2
1699	LT, RT	857+32.00	2	2
1700	LT, RT	875+00.00	2	2
1701	LT, RT	885+00.00	2	2
LASALLE CO. SUBTOTAL			94	94
LIVINGSTON COUNTY				
2336	LT, RT	891+47.96	2	2
1702	LT, RT	899+75.83	2	2
1703	LT, RT	914+12.13	2	2
2337	LT, RT	921+84.78	2	2
2338	LT, RT	922+43.15	2	2
1704	LT, RT	940+57.92	2	2
LIVINGSTON CO. SUBTOTAL			12	12
TOTAL			106	106

FILE NAME =	USER NAME = Anthony.Grunstad	DESIGNED -	REVISED -
pwz://ldot-pw.bentley.com/PWIDOT/Documents/IDOT Offices/District 3/ORD Projects/D368P42/CADDData/D368P42-sh-detailed		DRAWN -	REVISED -
Default	PLOT SCALE = \$SCALE\$	CHECKED -	REVISED -
	PLOT DATE = 6/27/2024	DATE -	REVISED -

**STATE OF ILLINOIS
DEPARTMENT OF TRANSPORTATION**

DETAILS			
SCALE:	SHEET	OF SHEETS	STA. TO STA.

F.A.P. RTE.	SECTION	COUNTY	TOTAL SHEETS	SHEET NO.
786	(109,110,111)RS-4	VARIOUS	28	22
CONTRACT NO. 66P42				
ILLINOIS		FED. AID PROJECT		

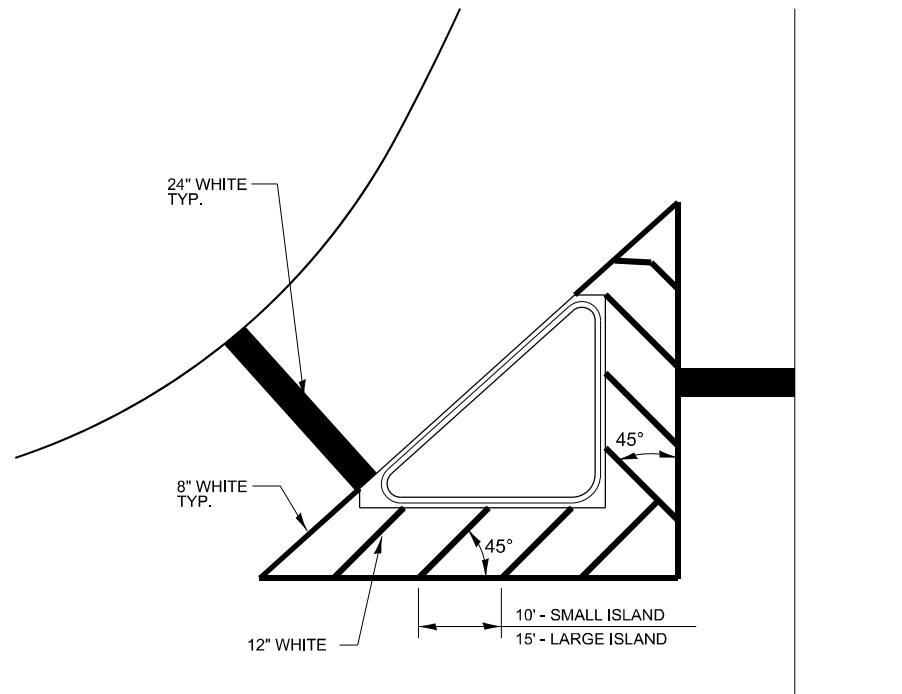

TYPICAL ISLAND MARKINGS

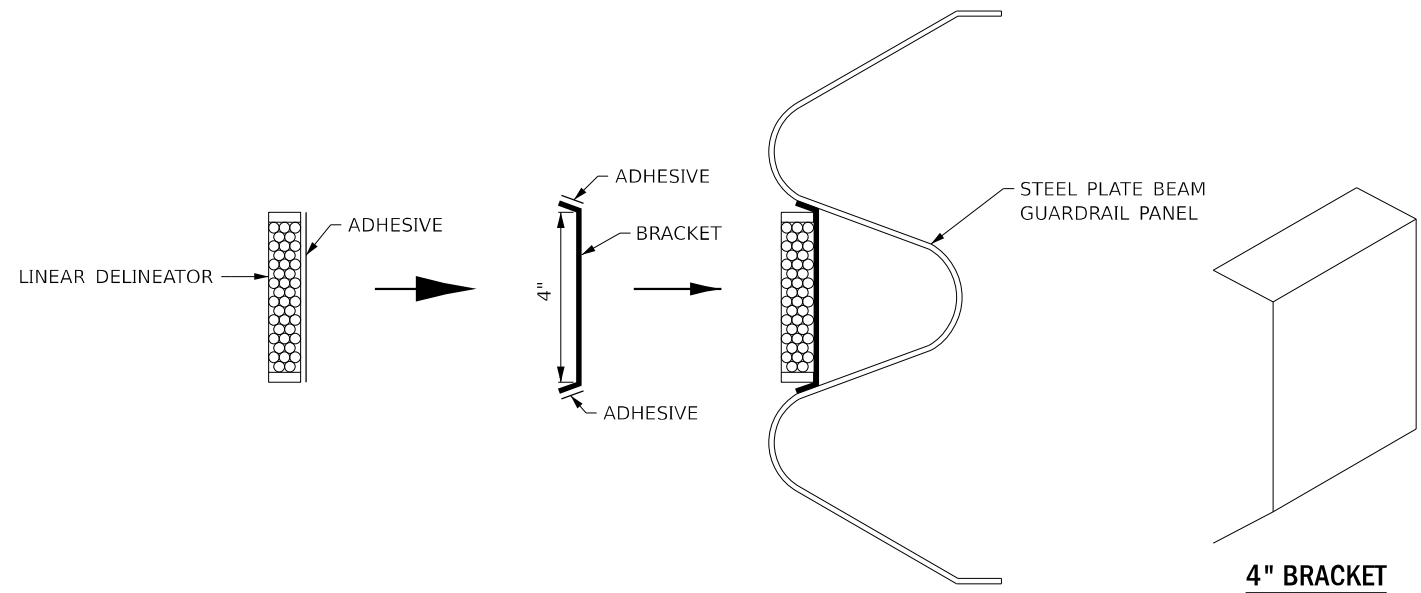

LINEAR DELINEATOR APPLICATION TO STANDARD GALVANIZED GUARDRAIL

LINEATOR DELINEATOR SHALL BE APPLIED ACCORDING TO THE MANUFACTURER'S RECOMMENDATIONS

FILE NAME =	USER NAME = Anthony.Grunstad	DESIGNED -	REVISED -
pw2/illdot-pw.bentley.com:PWIDOT/Document/IDOT Office/District 3/ORD Projects/D368P42/CADDData/D368P42-sh-deta		DRAWN -	REVISED -
Default	PLOT SCALE = \$SCALE\$	CHECKED -	REVISED -
	PLOT DATE = 6/27/2024	DATE -	REVISED -

**STATE OF ILLINOIS
DEPARTMENT OF TRANSPORTATION**

DETAILS			
SCALE:	SHEET	OF SHEETS	STA. TO STA.

F.A.P. RTE.	SECTION	COUNTY	TOTAL SHEETS	SHEET NO.
786	(109,110,111)RS-4	VARIOUS	28	23
CONTRACT NO. 66P42				
ILLINOIS FED. AID PROJECT				

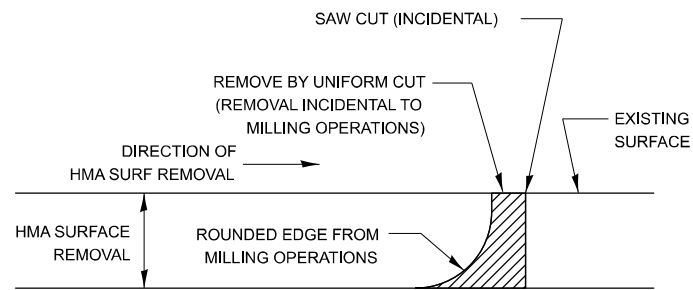

NOTE:
WHEN MILLING OPERATIONS PRODUCE A ROUNDED EDGE, THEN A SAW CUT SHALL BE USED TO MANUFACTURE A PERPENDICULAR EDGE AS SHOWN IN THE DETAIL. THE ENGINEER SHALL BE THE SOLE JUDGE CONCERNING THE USE OF THIS DETAIL.

HMA BUTT JOINT SAW CUTS

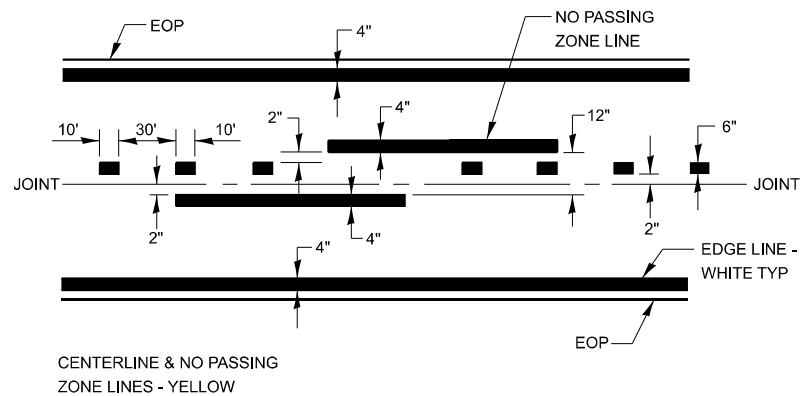

PAVEMENT MARKING

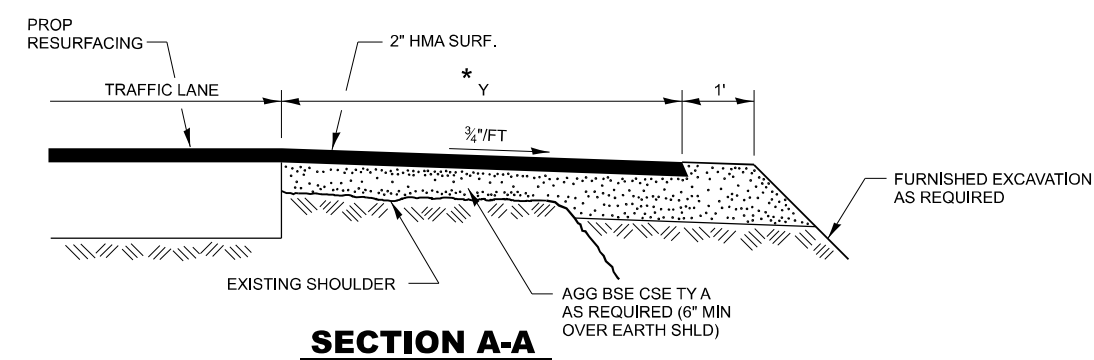
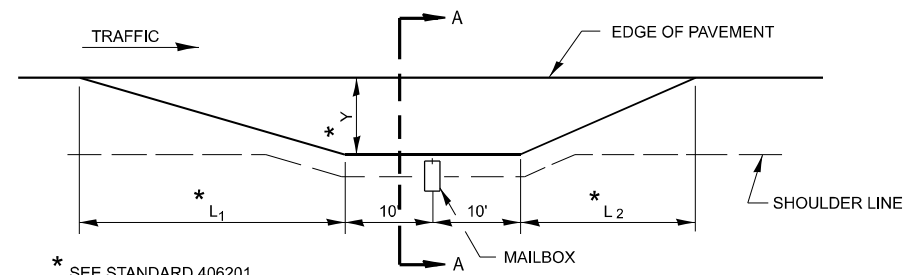

SECTION A-A

RURAL MAILBOX TURNOUT DETAILS

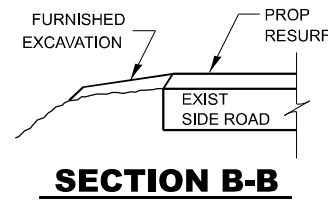

SECTION B-B

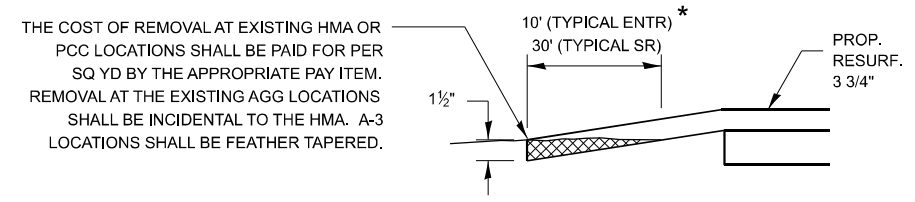

DETAIL A

THE COST OF REMOVAL AT EXISTING HMA OR PCC LOCATIONS SHALL BE PAID FOR PER SQ YD BY THE APPROPRIATE PAY ITEM. REMOVAL AT THE EXISTING AGG LOCATIONS SHALL BE INCIDENTAL TO THE HMA. A-3 LOCATIONS SHALL BE FEATHER TAPERED.

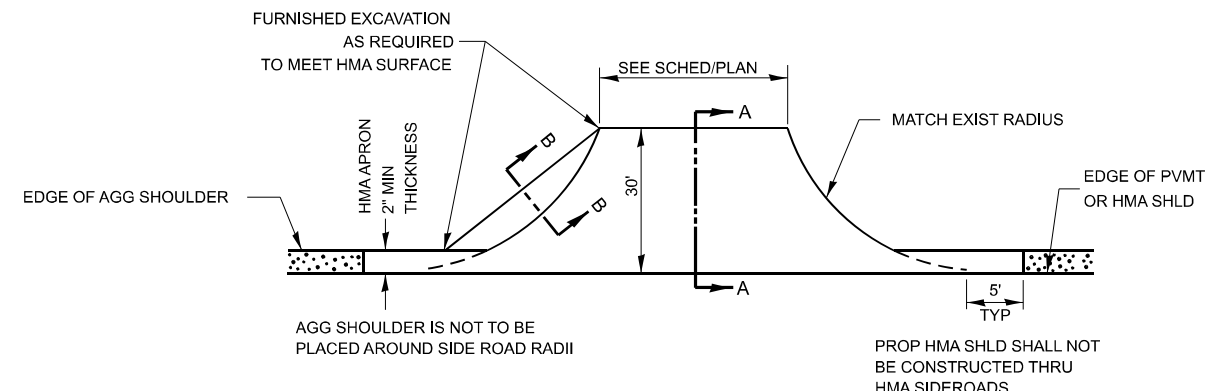

PLAN AT SIDE ROADS

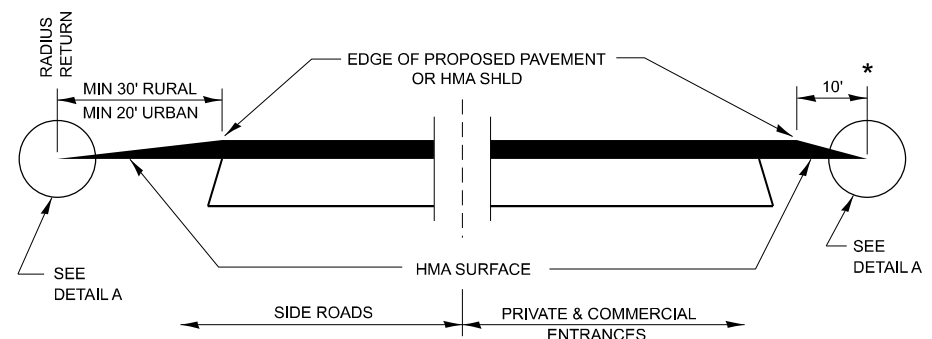

SECTION A-A DETAILS AT ENTRANCES & SIDE ROADS

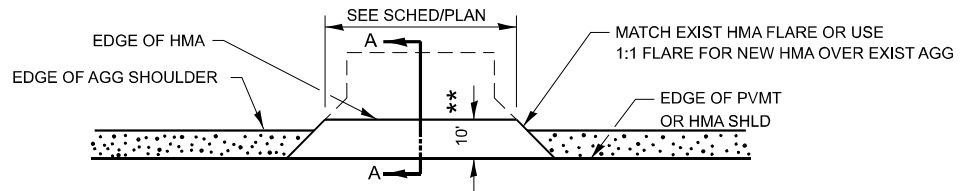

PLAN AT PRIVATE & COMMERCIAL ENTRANCES

(DO NOT RESURFACE FIELD ENTRANCES)

FILE NAME =	USER NAME = Anthony.Grunstad	DESIGNED -	REVISED -	STATE OF ILLINOIS DEPARTMENT OF TRANSPORTATION	DETAILS	F.A.P. RTE.	SECTION	COUNTY	TOTAL SHEETS	SHEET NO.	
pw2/illdot-pw.bentley.com/PWDOT/Documents/IDOT Offices/District 3/ORD Projects/D368P42/CADDData/D368P42-st-deta	DRAWN -	REVISED -	786			(109,110,111)RS-4	VARIOUS	28	24		
Default	PLOT SCALE = \$SCALE\$	CHECKED -	REVISED -			CONTRACT NO. 66P42					
	PLOT DATE = 6/27/2024	DATE -	REVISED -			SCALE:	SHEET	OF	SHEETS	STA.	TO
						ILLINOIS FED. AID PROJECT					

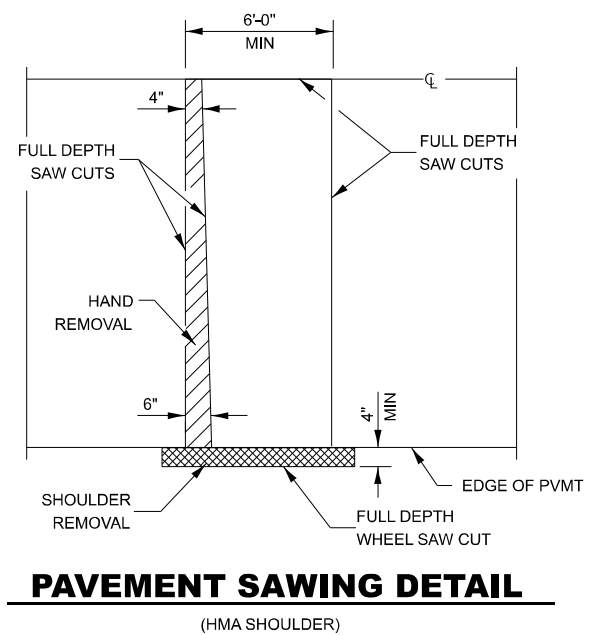

PAVEMENT SAWING DETAIL
(HMA SHOULDER)

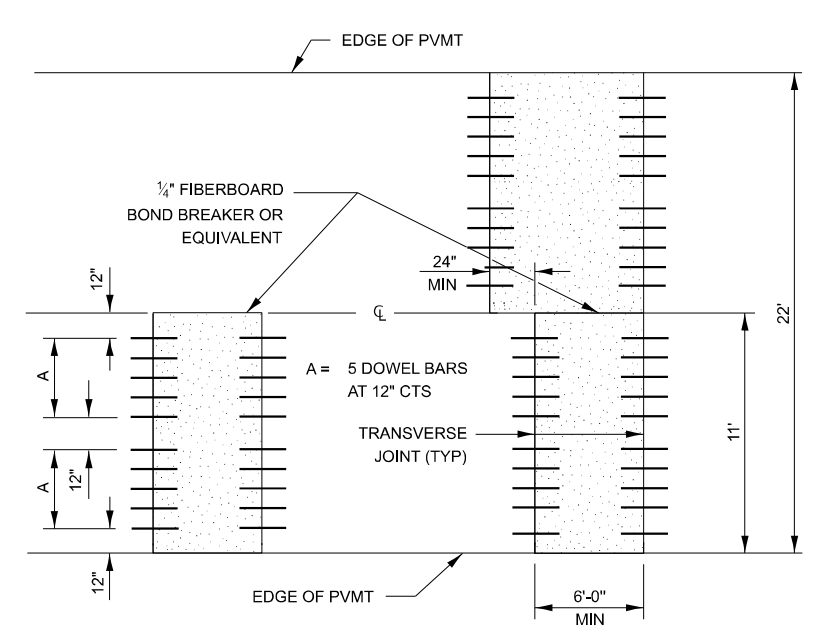

11' WIDE LANES

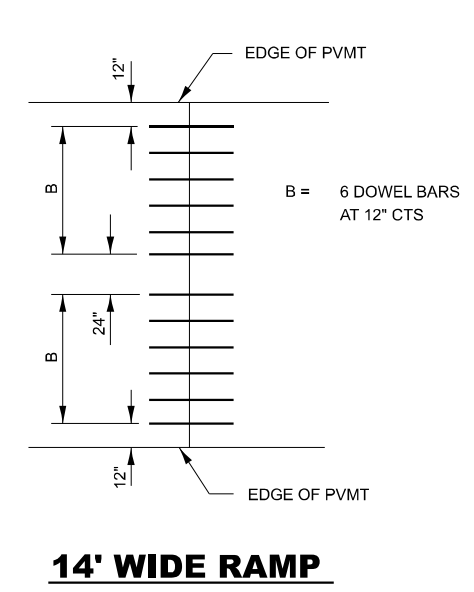

14' WIDE RAMP

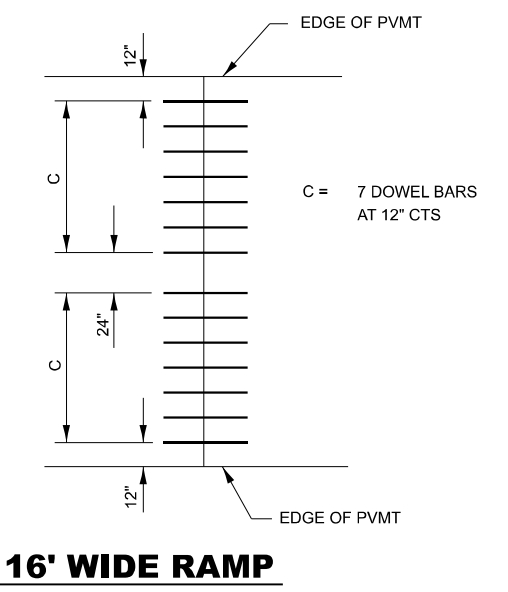

16' WIDE RAMP

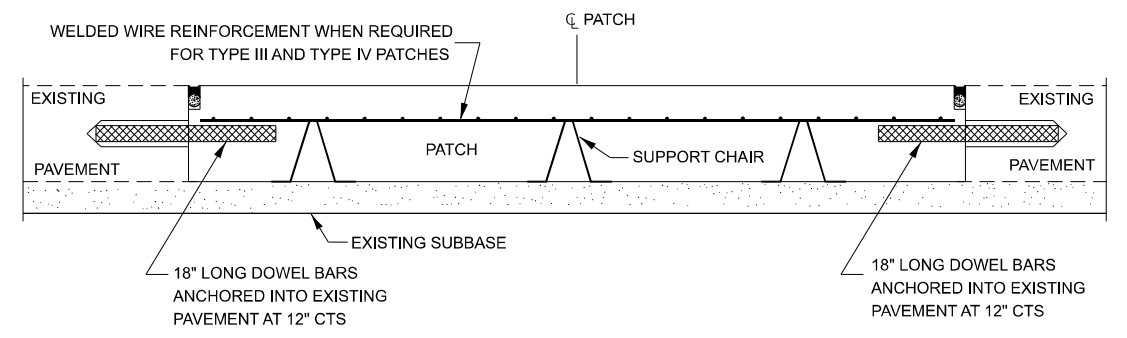

PATCHING WITHOUT HMA OVERLAY

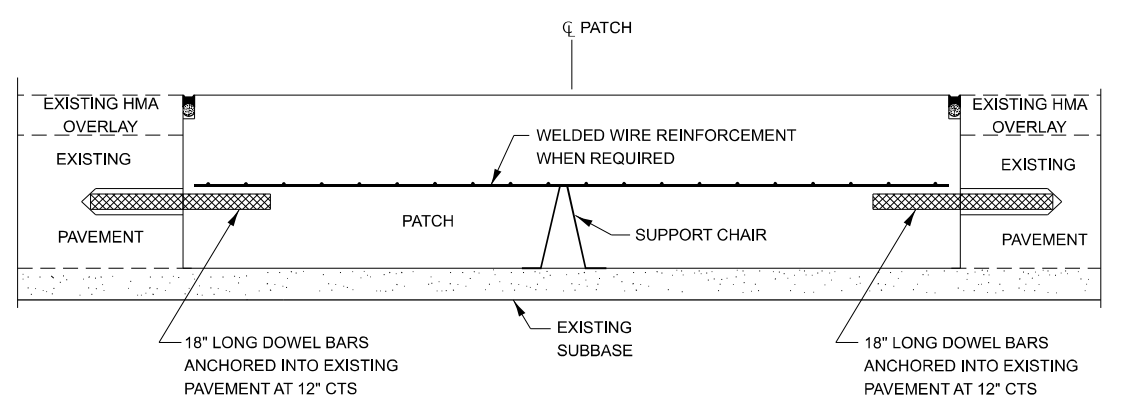

PATCHING WITH HMA OVERLAY

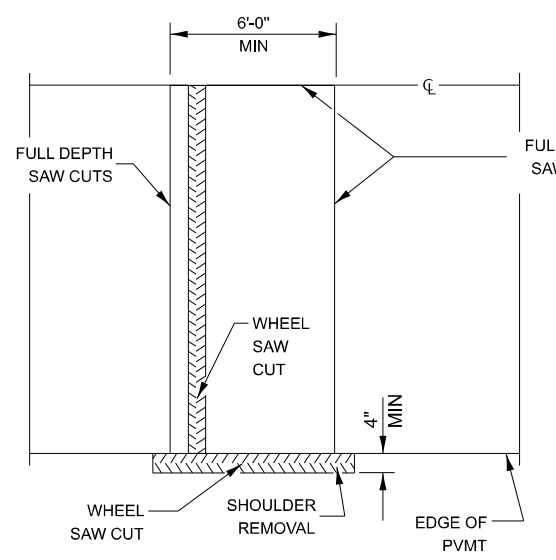

ALTERNATE SAWING DETAIL
(HMA SHOULDER)

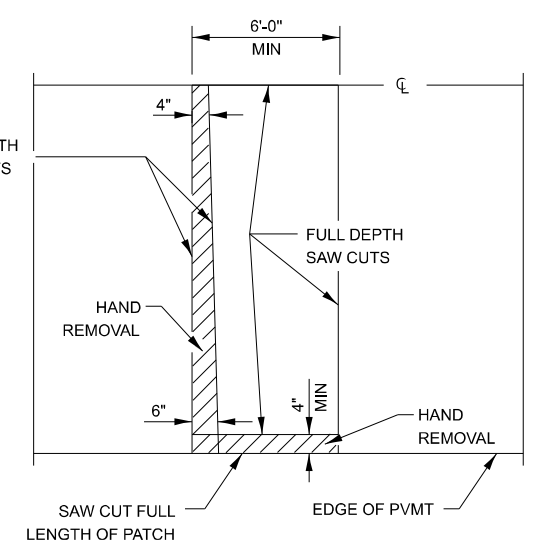

PAVEMENT SAWING DETAIL
(PCC SHOULDER)

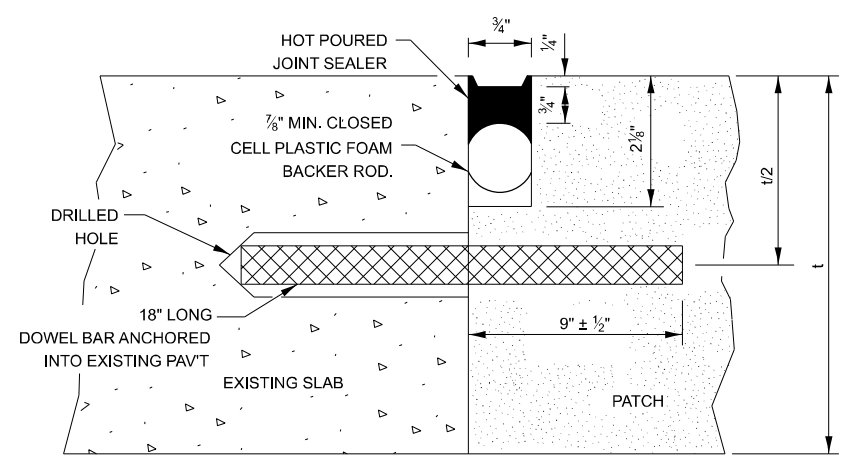

TRANSVERSE JOINT

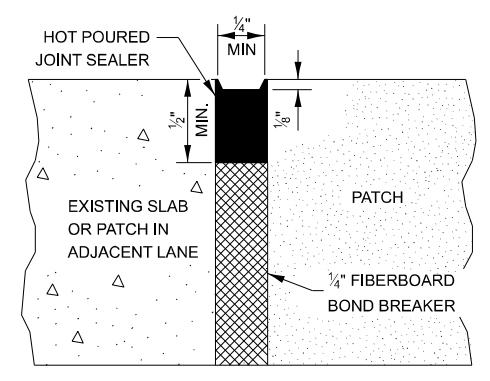

CENTERLINE JOINT

DOWEL BAR TABLE		
PAVEMENT THICKNESS	DOWEL BAR DIAMETER	HOLE DIAMETER
8" OR GREATER	1 1/2"	1 5/8"
7" THRU 7.99"	1 1/4"	1 3/8"
LESS THAN 7"	1"	1 1/8"

GENERAL NOTES

THE TRANSVERSE JOINTS FOR CLASS B PATCHES SHALL ALIGN WITH JOINTS OR CRACKS IN THE ADJACENT LANE WHENEVER POSSIBLE.

SEE STANDARD 420701 FOR DETAILS OF PAVEMENT WELDED WIRE REINFORCEMENT.

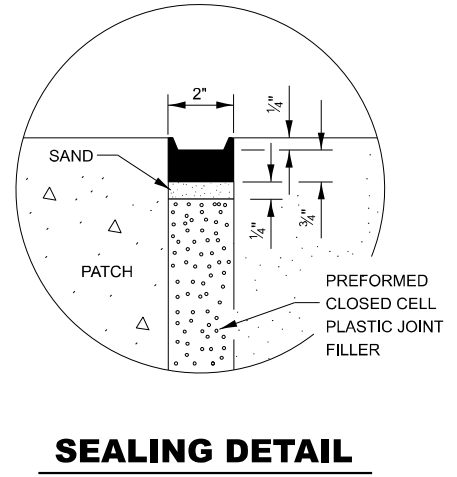
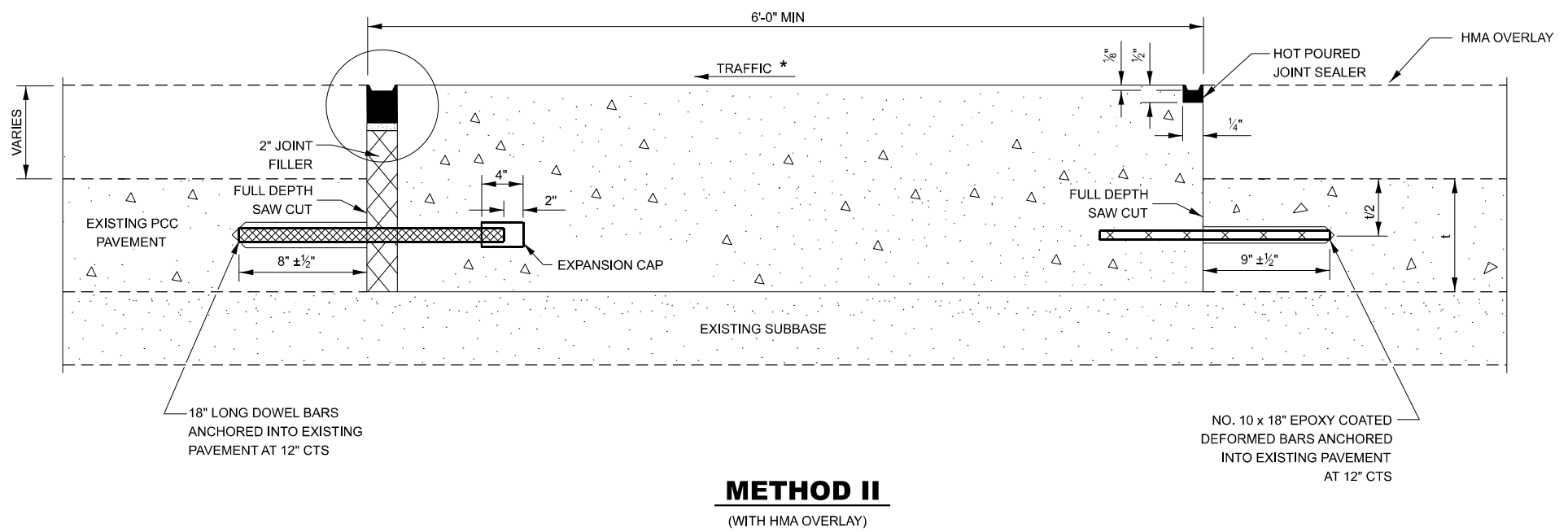
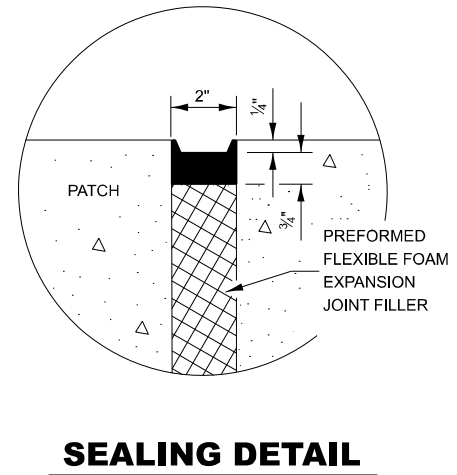
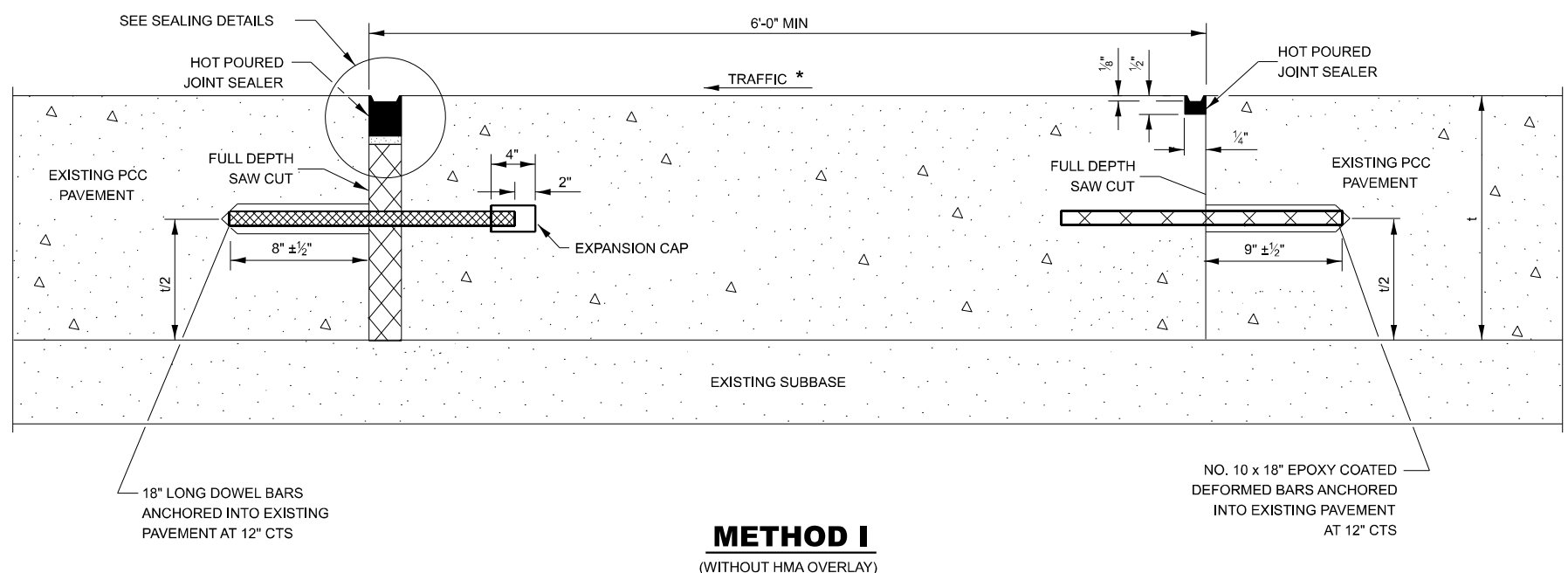



NOTE

* WHEN RE-ESTABLISHING A TRANSVERSE EXPANSION JOINT ON A TWO-WAY ROAD, REVERSE THE ORIENTATION OF THE DOWEL BARS WITH RESPECT TO TRAFFIC FOR ONE OF THE PATCHES SUCH THAT THE JOINT WILL BE CONTINUOUS ACROSS BOTH LANES.

FILE NAME =	USER NAME = Anthony.Grunstad	DESIGNED -	REVISED -	STATE OF ILLINOIS DEPARTMENT OF TRANSPORTATION	DETAILS			F.A.P. RTE.	SECTION	COUNTY	TOTAL SHEETS	SHEET NO.
pw2/illdot-pw.bentley.com/PWIDOT/Documents/IDOT Offices/District 3/ORD Projects/D366P42/CADDData/D366P42-sh-deta	DRAWN -	REVISED -	786					(109,110,111)RS-4	VARIOUS	28	26	
Default	PLOT SCALE = \$SCALE\$	CHECKED -	REVISED -		SCALE: SHEET OF SHEETS STA. TO STA.			CONTRACT NO. 66P42				
	PLOT DATE = 6/27/2024	DATE -	REVISED -		ILLINOIS FED. AID PROJECT							

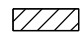
LEGEND

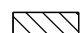
-  = 6" CONCRETE - CLASS PP-1 OR PP-2
-  = EXISTING/ PROPOSED HMA OR PCC PAVEMENT
-  = SURVEY BOX VAULT
-  = 8" PVC

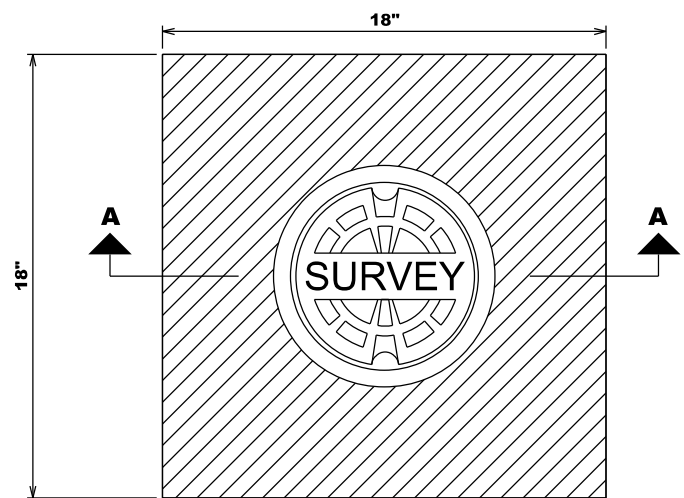

VAULT LID PLAN

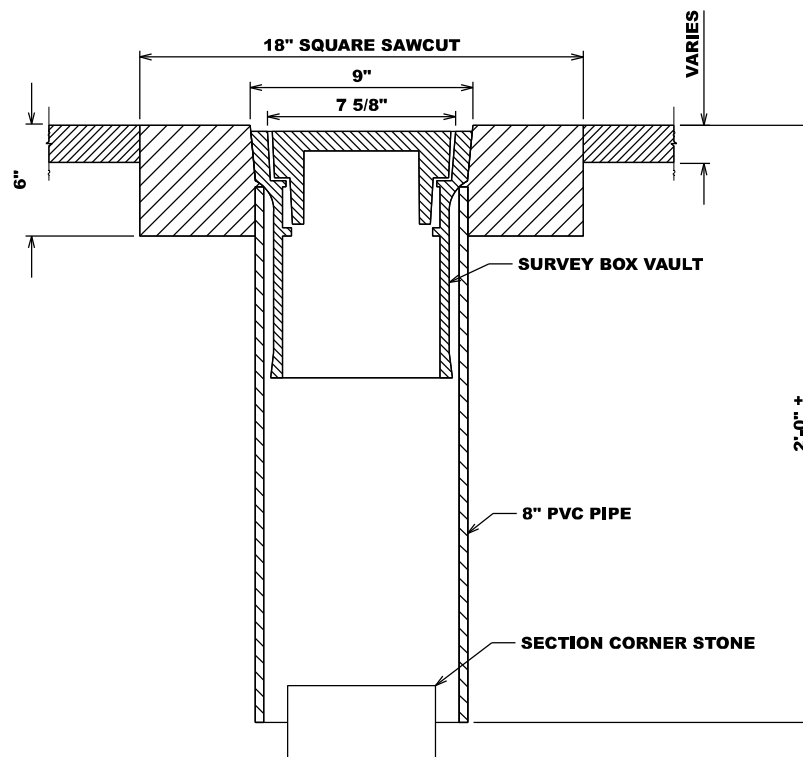

SECTION A-A

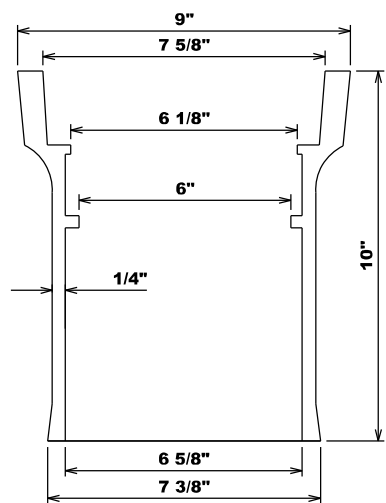

MONUMENT VAULT BODY

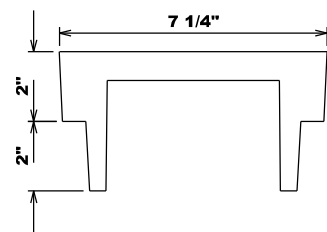

MONUMENT VAULT LID

NOTE

* ALL LABOR AND MATERIALS INCLUDING CUTTING PAVEMENT AND FILLING WITH CONCRETE SHALL BE INCLUDED IN THE COST OF THE PAY ITEM.

DRAWING NOT TO SCALE

FILE NAME =	USER NAME = Anthony.Grunstad	DESIGNED -	REVISED -
pw2/illdot-pw.bentley.com/PWIDOT/Documents/IDOT Offices/District 3/ORD Projects/D366P42/CADDData/D366P42-sh-drawings		DRAWN -	REVISED -
Default	PLOT SCALE = \$SCALE\$	CHECKED -	REVISED -
	PLOT DATE = 6/27/2024	DATE -	REVISED -

STATE OF ILLINOIS
DEPARTMENT OF TRANSPORTATION

SECTION CORNER VAULT

SCALE: SHEET OF SHEETS STA. TO STA.

F.A.P. RTE.	SECTION	COUNTY	TOTAL SHEETS	SHEET NO.
786	(109,110,111)RS-4	VARIOUS	28	27
CONTRACT NO. 66P42				
ILLINOIS		FED. AID PROJECT		

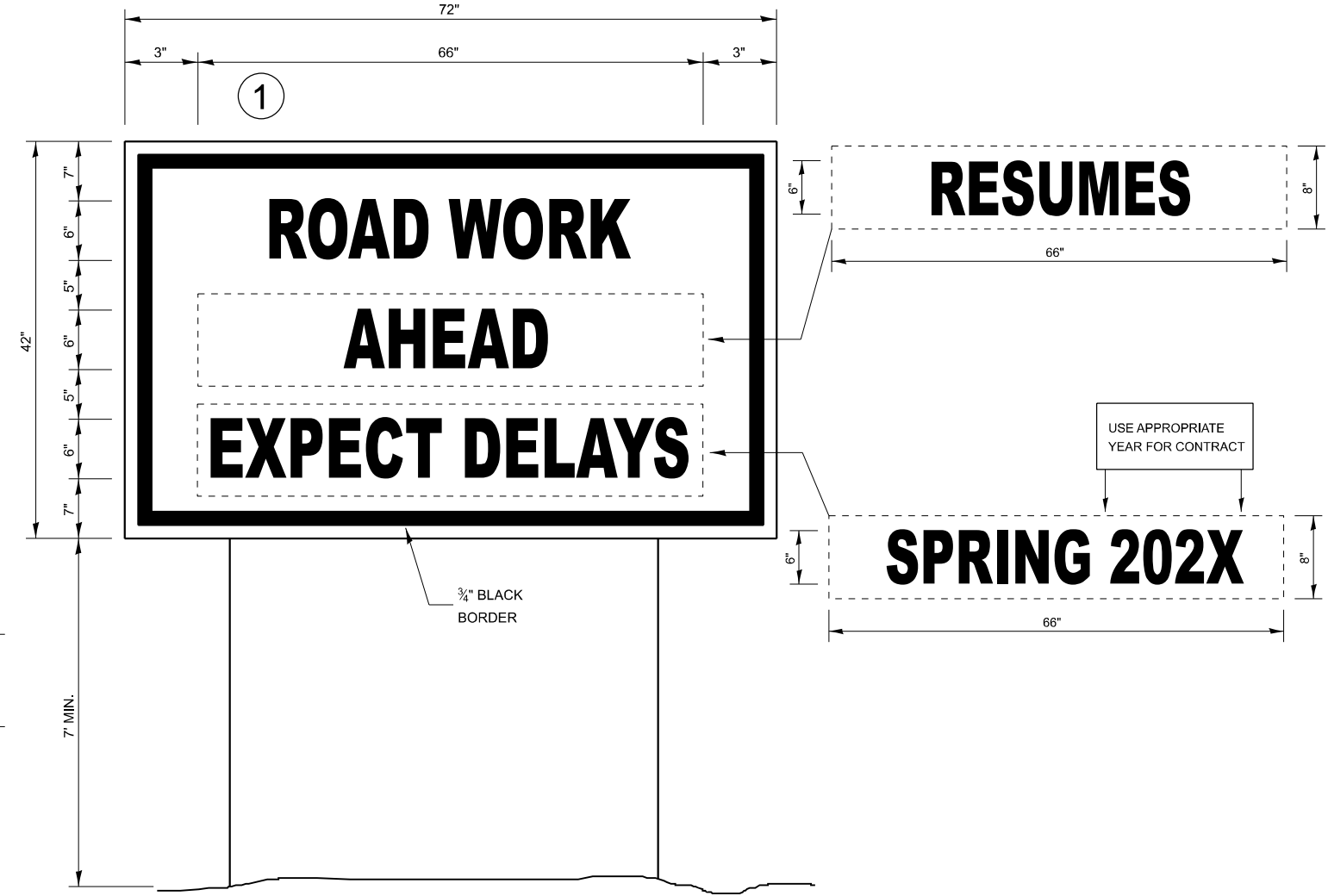
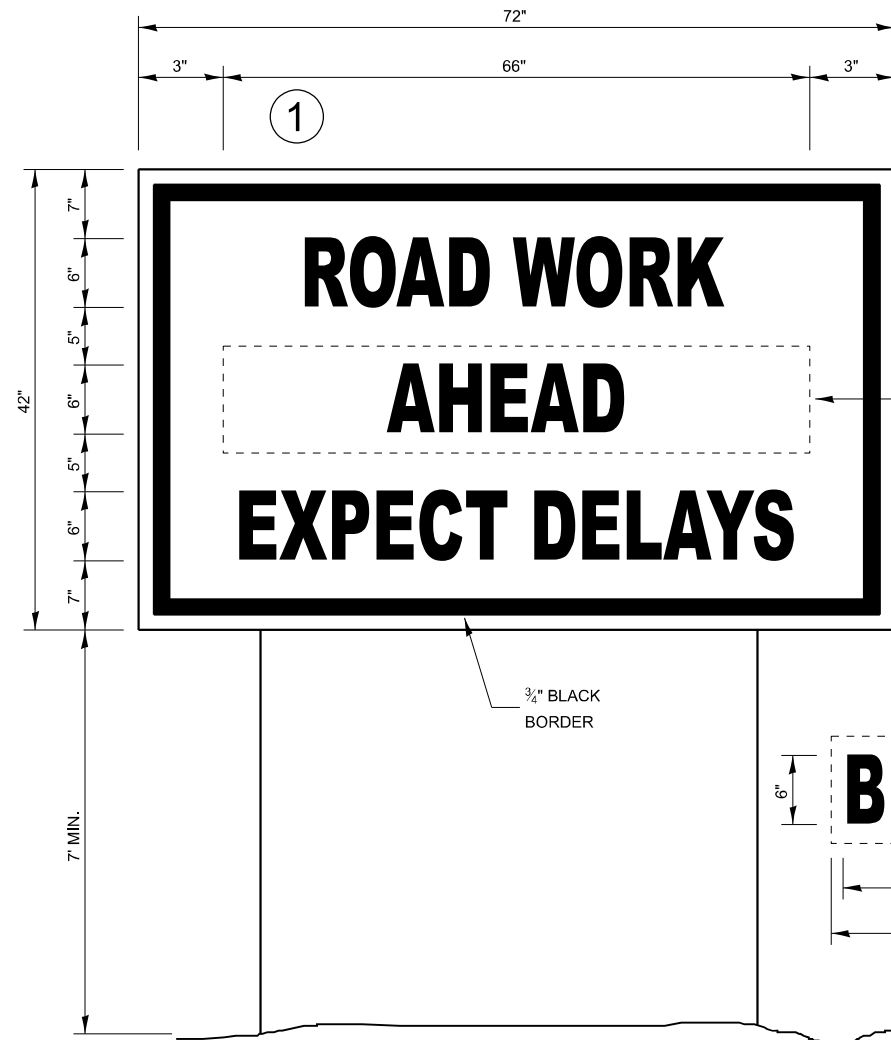

TEMPORARY INFORMATION SIGNING

WINTER SHUT DOWN SIGNING

NOTES:

1. USE 6" D BLACK LETTERING ON FLOURESENT ORANGE BACKGROUND.
2. ERECT SIGNS AT LOCATIONS IN ADVANCE OF THE "ROAD CONSTRUCTION AHEAD" SIGNS AS DIRECTED BY THE ENGINEER.
3. ERECT SIGN ① WITH INSTALLED PANEL ② A MINIMUM OF ONE WEEK PRIOR TO THE START OF THE LANE CLOSURE.
4. REMOVE PANEL ② ON THAT DATE.
5. SEE SPECIAL PROVISION "TEMPORARY INFORMATION SIGNING" FOR ADDITIONAL INFORMATION.
6. WILL BE PAID FOR PER SQ FT AS "TEMPORARY INFORMATION SIGNING". EACH SIGN = 21 SQ FT

FILE NAME =	USER NAME = Anthony.Grunstad	DESIGNED -	REVISED -	STATE OF ILLINOIS DEPARTMENT OF TRANSPORTATION	DETAILS				F.A.P. RTE.	SECTION	COUNTY	TOTAL SHEETS	SHEET NO.
pw2/illdot-pw.bentley.com/PWDOT/Document/IDOT Offices/District 3/ORD Projects/D368P42/CADDData/D368P42-est-deta	DRAWN -	REVISED -	REVISED -		786	(109,110,111)RS-4	VARIOUS	28	28				
Default	PLOT SCALE = \$SCALE\$	CHECKED -	REVISED -		CONTRACT NO. 66P42								
	PLOT DATE = 6/27/2024	DATE -	REVISED -		SCALE:	SHEET	OF	SHEETS	STA.	TO STA.	ILLINOIS	FED. AID PROJECT	