

STATE OF ILLINOIS  
DEPARTMENT OF TRANSPORTATION

F.A.P. RTE.	SECTION	COUNTY	TOTAL SHEETS	SHEET NO.
774	D7 BRIDGE REPAIRS 2025-4	EFFINGHAM	15	1
		ILLINOIS	CONTRACT NO. 74C53	

D-97-099-23

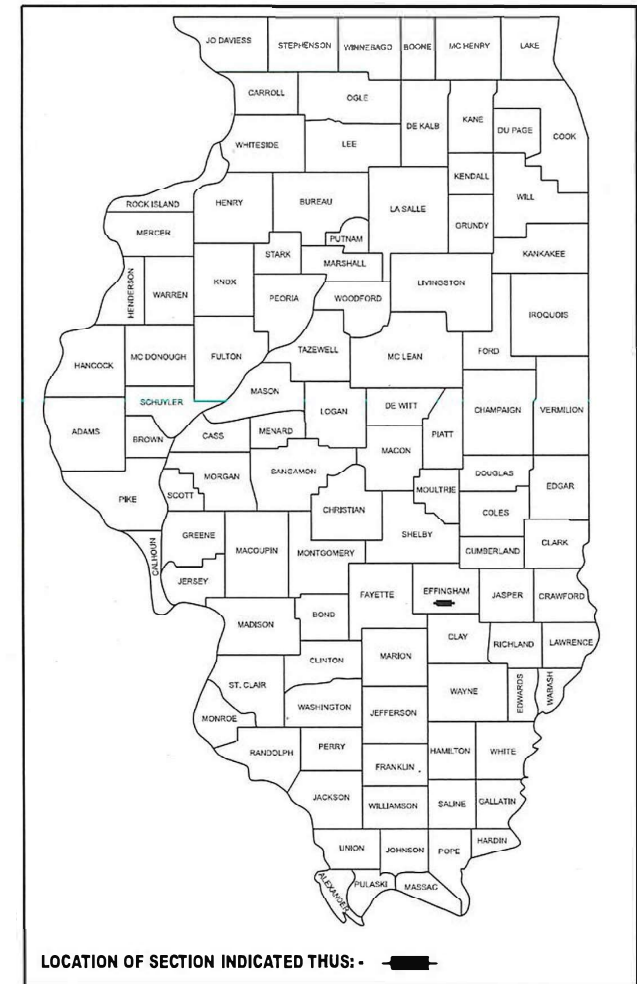

FOR INDEX OF SHEETS, SEE SHEET NO. 2  
ADT 3200 (2021)

# PROPOSED HIGHWAY PLANS

FAP ROUTE 774 (IL 33)  
D7 BRIDGE REPAIRS 2025-4  
PROJECT STP-LNAH (600)  
BRIDGE DECK OVERLAY  
EFFINGHAM COUNTY

C-97-130-23

STR: 025-0031  
STATION 303 + 85

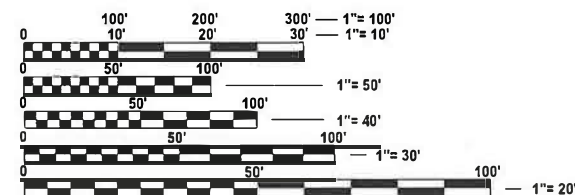
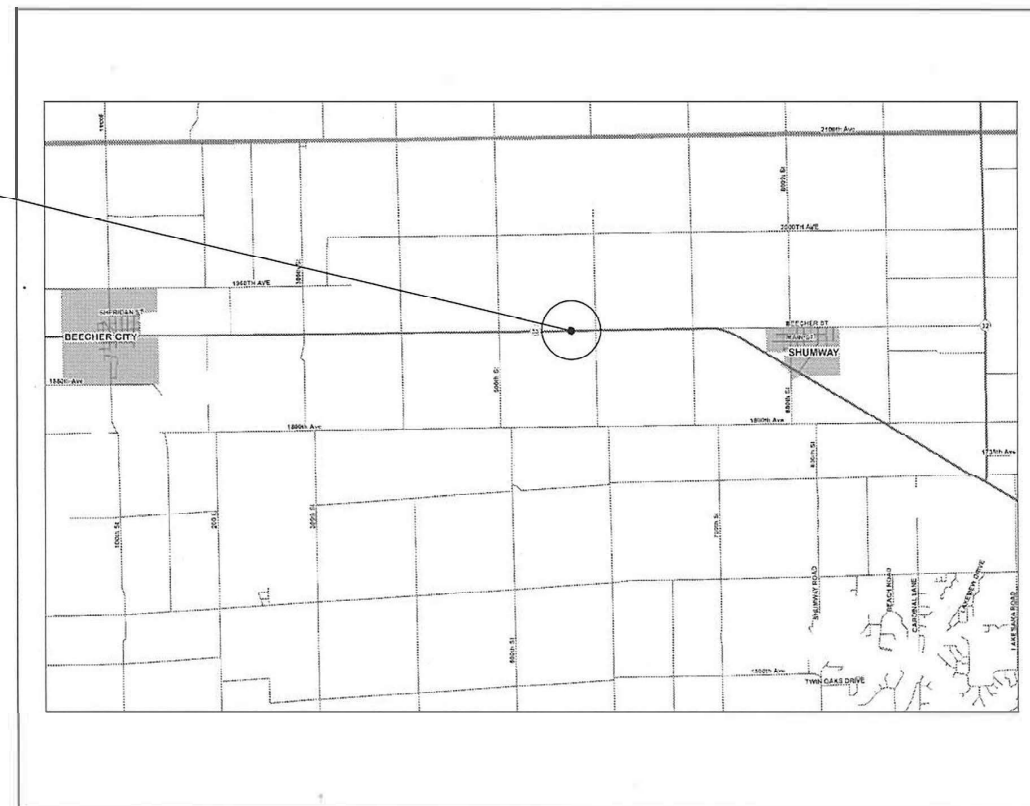

FULL SIZE PLANS HAVE BEEN PREPARED USING STANDARD ENGINEERING SCALES. REDUCED SIZED PLANS WILL NOT CONFORM TO STANDARD SCALES. IN MAKING MEASUREMENTS ON REDUCED PLANS, THE ABOVE SCALES MAY BE USED.

J.U.L.I.E.  
JOINT UTILITY LOCATION INFORMATION FOR EXCAVATION  
1-800-892-0123  
OR 811

PROJECT ENGINEER- BRIAN LEWIS  
PROJECT MANAGER- REID DOLL

CONTRACT NO. 74C53

GROSS LENGTH = 685 FT. = 0.13 MILE  
NET LENGTH = 90 FT. = 0.017 MILE

STATE OF ILLINOIS  
DEPARTMENT OF TRANSPORTATION

SUBMITTED JUNE 25 2024  
Jeffrey P. Myer  
REGIONAL ENGINEER

August 16, 2024  
Scott A. Clark  
ENGINEER OF DESIGN AND ENVIRONMENT

August 16, 2024  
James J. Guerin  
DIRECTOR OF HIGHWAYS PROJECT IMPLEMENTATION

PRINTED BY THE AUTHORITY  
OF THE STATE OF ILLINOIS

GENERAL NOTES

THE PROPOSED PROJECT ON STRUCTURE #025-0031 IS LOCATED AT MORRIS CREEK 0.3 MI W OF 500TH ST ON FAP 774 (IL 33).

THE WORK IN THIS SECTION CONSISTS OF BRIDGE DECK OVERLAY, BRIDGE APPROACH REPAIR, BRIDGE DECK REPAIRS, PCC BASE COURSE WIDENING, PAVEMENT MARKING, AND ALL OTHER WORK NEEDED TO COMPLETE THIS SECTION. THE WORK WILL BE COMPLETE UNDER STAGE CONSTRUCTION.

THE TOTAL QUANTITY OF PAINT PAVEMENT MARKING LINE- 4" CALCULATED CONSISTS OF 172 FEET OF YELLOW AND 1372 FEET OF WHITE.

THE FOLLOWING MIXTURE REQUIREMENTS ARE APPLICABLE TO THIS PROJECT:

LOCATION(S)	MIXTURE USE(S)	PG	DESIGN AIR Voids	MIXTURE COMPOSITION	FRICTION AGGREGATE	MIXTURE WEIGHT	QUALITY MANAGEMENT PROGRAM	SUBLOT SIZE	MATERIAL TRANSFER DEVICE (REQUIRED?)
MAINLINE	HMA SURFACE COURSE, IL-9.5, MIX "C", N70	PG 64-22	4.0% @ N=70	IL - 9.5	MIXTURE C	N70	QC/QA	3000	N/A

INDEX OF SHEETS

SHEET NO.	DESCRIPTION
1	COVER SHEET
2	GENERAL NOTES, INDEX OF SHEETS, HIGHWAY STANDARDS
3-4	SUMMARY OF QUANTITIES
5	TRANSITION DETAILS
6	PRE-STAGE CONSTRUCTION PCC BASE COURSE WIDENING DETAIL
7-8	STAGE CONSTRUCTION DETAILS
9-11	BRIDGE REPAIR PLANS
12-15	PAVEMENT MARKING DETAILS

THE FOLLOWING STANDARDS ARE A PART OF THESE PLANS AND ARE INCLUDED AFTER THE LAST NUMBERED SHEET OF THE PLANS.

STANDARD NO.	DESCRIPTION
000001-08	STANDARD SYMBOLS, ABBREVIATIONS, AND PATTERNS
001001-02	AREAS OF REINFORCEMENT BARS
001006	DECIMAL OF AN INCH AND OF A FOOT
701001-02	OFF-ROAD OPERATIONS, 2L, 2W, MORE THAN 15' AWAY
701006-05	OFF-ROAD OPERATIONS, 2L, 2W, 15' TO 24" FROM PAVEMENT EDGE
701201-05	LANE CLOSURE, 2L, 2W, DAY ONLY
701301-04	LANE CLOSURE, 2L, 2W, SHORT TIME OPERATIONS
701311-03	LANE CLOSURE, 2L, 2W, MOVING OPERATIONS, DAY ONLY
701321-18	LANE CLOSURE, 2L, 2W, BRIDGE REPAIR WITH BARRIER
701326-04	LANE CLOSURE, 2L, 2W, PAVEMENT WIDENING
701901-09	TRAFFIC CONTROL DEVICES
704001-08	TEMPORARY CONCRETE BARRIER
780001-05	TYPICAL PAVEMENT MARKINGS
420001-10	PAVEMENT JOINTS
782006-01	GUARDRAIL AND BARRIER WALL REFLECTOR MOUNTING DETAILS

MODEL: General Notes (Sheet)  
FILE NAME: c:\pwworking\illinois\id688976\1D774C53\_2D-General Notes.dgn

REV - MS

USER NAME = myra.dtman	DESIGNED -	REVISED -	<b>STATE OF ILLINOIS DEPARTMENT OF TRANSPORTATION</b>	<b>INDEX OF SHEETS &amp; GENERAL NOTES</b>	F.A.P. RTE.	SECTION	COUNTY	TOTAL SHEETS	SHEET NO.
PLOT SCALE = \$\$CALES	DRAWN -	REVISED -			774	D7 BRIDGE REPAIRS 2025-4	EFFINGHAM	15	2
PLOT DATE = 5/20/2024	CHECKED -	REVISED -			CONTRACT NO. 74C53				
	DATE -	REVISED -			ILLINOIS   FED. AID PROJECT				
				SCALE:	SHEET	OF	SHEETS	STA.	TO STA.

80% FED  
20% STATE

SUMMARY OF QUANTITIES				CONSTR. CODE
CODE NO.	ITEM	UNIT	TOTAL QUANTITY	BRIDGE
				0059 025-0031
20200500	EARTH EXCAVATION (WIDENING)	CU YD	75	75
35300300	PORTLAND CEMENT CONCRETE BASE COURSE 8"	SQ YD	459	459
40600290	BITUMINOUS MATERIALS (TACK COAT)	POUND	308	308
40600982	HOT-MIX ASPHALT SURFACE REMOVAL - BUTT JOINT	SQ YD	352	352
40600990	TEMPORARY RAMP	SQ YD	56	56
40604052	HOT-MIX ASPHALT SURFACE COURSE, IL-9.5, MIX "C", N70	TON	58	58
44004250	PAVED SHOULDER REMOVAL	SQ YD	213	213
50300260	BRIDGE DECK GROOVING	SQ YD	150	150
50300300	PROTECTIVE COAT	SQ YD	162	162
67000400	ENGINEER'S FIELD OFFICE, TYPE A	CAL MO	5	5
67100100	MOBILIZATION	L SUM	1	1
70100405	TRAFFIC CONTROL AND PROTECTION, STANDARD 701321	EACH	1	1
70100450	TRAFFIC CONTROL AND PROTECTION, STANDARD 701201	L SUM	1	1
70100500	TRAFFIC CONTROL AND PROTECTION, STANDARD 701326	L SUM	1	1

80% FED  
20% STATE

SUMMARY OF QUANTITIES				CONSTR. CODE
CODE NO.	ITEM	UNIT	TOTAL QUANTITY	BRIDGE
				0059 025-0031
70107005	PAVEMENT MARKING BLACKOUT TAPE, 5"	FOOT	742	742
70107025	CHANGEABLE MESSAGE SIGN	CAL DA	28	28
70300150	SHORT TERM PAVEMENT MARKING REMOVAL	SQ FT	309	309
70400100	TEMPORARY CONCRETE BARRIER	FOOT	350	350
70400200	RELOCATE TEMPORARY CONCRETE BARRIER	FOOT	300	300
70600250	IMPACT ATTENUATORS, TEMPORARY (NON- REDIRECTIVE), TEST LEVEL 3	EACH	2	2
70600260	IMPACT ATTENUATORS, TEMPORARY (FULLY REDIRECTIVE, NARROW), TEST LEVEL 3	EACH	1	1
70600350	IMPACT ATTENUATORS, RELOCATE (NON- REDIRECTIVE), TEST LEVEL 3	EACH	1	1
* 78001110	PAINT PAVEMENT MARKING - LINE 4"	FOOT	1544	1544
X7016500	TEMPORARY BRIDGE TRAFFIC SIGNALS (SPECIAL)	EACH	1	1
Z0001800	APPROACH SLAB REPAIR (PARTIAL DEPTH)	SQ YD	3	3
Z0012110	BRIDGE DECK FLY ASH OR GGBF SLAG CONCRETE OVERLAY, 2 1/4"	SQ YD	162	162
Z0012130	BRIDGE DECK SCARIFICATION 3/4"	SQ YD	162	162
Z0016001	DECK SLAB REPAIR (FULL DEPTH, TYPE I)	SQ YD	6	6

\* SPECIALTY ITEM

REV - MS

MODEL: SQQ (Sheet)  
FILE NAME: c:\pwworkspace\billie\id688976\1D774C53.SQD.dgn

USER NAME = myra.oltman	DESIGNED -	REVISED -
	DRAWN -	REVISED -
	CHECKED -	REVISED -
PLOT DATE = 5/28/2024	DATE -	REVISED -

STATE OF ILLINOIS  
DEPARTMENT OF TRANSPORTATION

SUMMARY OF QUANTITIES

SCALE: SHEET OF SHEETS STA. TO STA.

F.A.P. RTE.	SECTION	COUNTY	TOTAL SHEETS	SHEET NO.
774	D7 BRIDGE REPAIRS 2025-4	EFFINGHAM	15	3
ILLINOIS FED. AID PROJECT			CONTRACT NO. 74C53	

80% FED  
20% STATE

SUMMARY OF QUANTITIES				CONSTR. CODE
CODE NO.	ITEM	UNIT	TOTAL QUANTITY	BRIDGE
				0059
				025-0031
Z0016002	DECK SLAB REPAIR (FULL DEPTH, TYPE II)	SQ YD	3	3

MODEL: SQ02 (Sheet)  
FILE NAME: c:\p\work\pwrto\hille\ad088976\1D774C53\SQ0.dgn

USER NAME = jessica.hille	DESIGNED -	REVISED -
	DRAWN -	REVISED -
	CHECKED -	REVISED -
PLOT DATE = 6/25/2024	DATE -	REVISED -

**STATE OF ILLINOIS  
DEPARTMENT OF TRANSPORTATION**

**SUMMARY OF QUANTITIES**

SCALE: SHEET OF SHEETS STA. TO STA.

F.A.P. RTE.	SECTION	COUNTY	TOTAL SHEETS	SHEET NO.
774	D7 BRIDGE REPAIRS 2025-4	EFFINGHAM	15	4
CONTRACT NO. 74C53				
ILLINOIS FED. AID PROJECT				

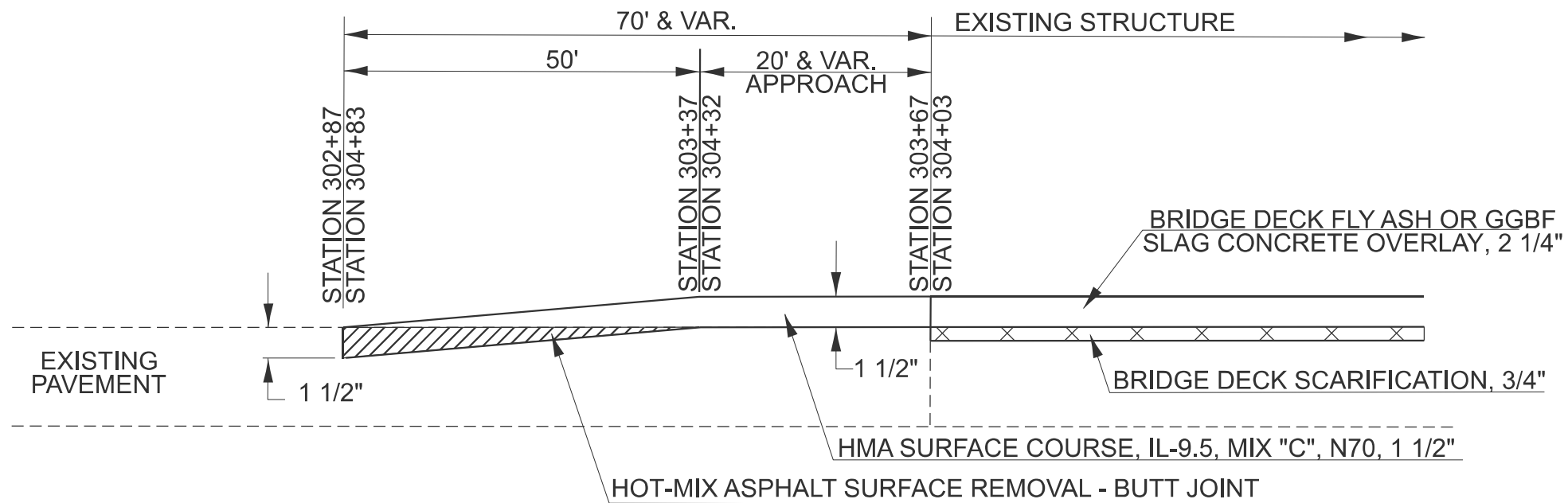

**TRANSITION DETAIL**

STATION 302+87 TO STATION 303+87  
STATION 304+03 TO STATION 304+82

HMA SURFACE REMOVAL - BUTT JOINT									
STATIONING		LENGTH	WIDTH	SHOULDER	TOTAL EOP WIDTH	AREA MAINLINE	AREA SHOULDER	AREA COMBINED	
FROM	TO	(FEET)	(FEET)	(FEET)	(FEET)	(SQ FT)	(SQ FT)	(SQ FT)	(SQ YD)
302+87	303+37	50	24.0	16.0	24.0	1,200	384	1,200	176
304+32	304+82	50	24.0	16.0	24.0	1,200	384	1,200	176
TOTALS									352

BITUMINOUS MATERIALS (TACK COAT)								
STATIONING		LENGTH	WIDTH	SHOULDER	AREA APPROACH	AREA MAINLINE	AREA COMBINED	BITUMINOUS MATERIALS (TACK COAT) MAINLINE
FROM	TO	(FEET)	(FEET)	(FEET)	(SQ FT)	(SQ FT)	(SQ FT)	(POUND)
302+87.00	303+67.00	80	24.0	16.0	1,070	2,000	3,070	154
304+03.00	304+83.00	80	24.0	16.0	1,070	2,000	3,070	154
TOTALS								308

HMA SURFACE COURSE, IL-9.5, MIX "C", N70									
STATIONING		LENGTH	WIDTH	SHOULDER	LIFT THICKNESS	AREA APPROACH	AREA MAINLINE	AREA COMBINED	HMA SURF. CRSE. IL-9.5 N70
FROM	TO	(FEET)	(FEET)	(FEET)	(INCH)	(SQ FT)	(SQ FT)	(SQ FT)	(TON)
302+87.00	303+67.00	80	24.0	16.0	1.50	1,070	2,000	3,070	29
304+03.00	304+83.00	80	24.0	16.0	1.50	1,070	2,000	3,070	29
TOTALS									58

MODEL: TRANSITION DETAIL (Sheet)  
FILE NAME: c:\p\work\pav\hille\0889761\0774C53\_DETAILS.dgn

USER NAME = myra.olman	DESIGNED -	REVISED -
	DRAWN -	REVISED -
	CHECKED -	REVISED -
PLOT DATE = 5/28/2024	DATE -	REVISED -

STATE OF ILLINOIS  
DEPARTMENT OF TRANSPORTATION

TRANSITION DETAIL

SCALE: SHEET OF 4 SHEETS STA. TO STA.

F.A.P. RTE.	SECTION	COUNTY	TOTAL SHEETS	SHEET NO.
774	D7 BRIDGE REPAIRS 2025-4	EFFINGHAM	15	5
CONTRACT NO. 74C53				
ILLINOIS FED. AID PROJECT				

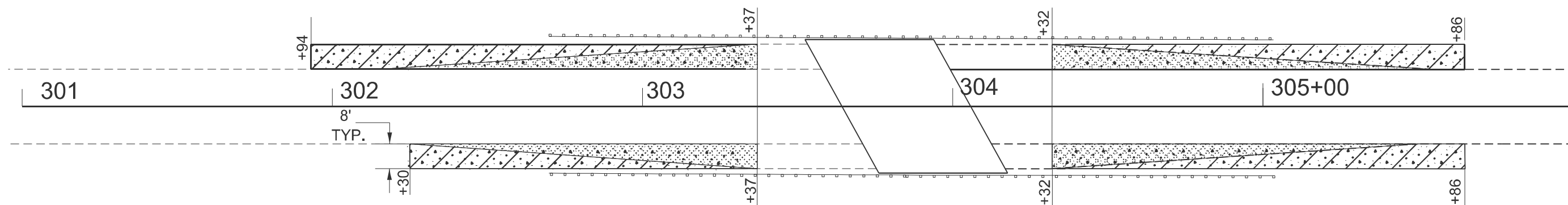

PAVED SHOULDER REMOVAL					
	STATIONING		WIDENING WIDTH (FOOT)	WIDENING LENGTH (FOOT)	WIDENING AREA (SQ YD)
	FROM	TO			
NE	304+37.00	305+86.00	VARIABLE	149.0	57
SE	304+37.00	305+86.00	VARIABLE	149.0	49
NW	301+74.00	303+33.00	VARIABLE	159.0	55
SW	302+30.00	303+33.00	VARIABLE	103.0	51
TOTAL					213

PORTLAND CEMENT CONCRETE BASE COURSE 8"					
	STATIONING		WIDENING WIDTH (FOOT)	WIDENING LENGTH (FOOT)	WIDENING AREA (SQ YD)
	FROM	TO			
NE	304+32.00	305+65.00	8	133.0	118
SE	304+32.00	305+65.00	8	133.0	118
NW	301+94.00	303+37.00	8	143.0	127
SW	302+30.00	303+37.00	8	107.0	95
TOTAL					459

- EARTH EXCAVATION WIDENING
- PAVED SHOULDER REMOVAL
- PORTLAND CEMENT CONCRETE BASE COURSE, 8"

EARTH EXCAVATION WIDENING							
	STATIONING		WIDENING WIDTH (FOOT)	CADD MEAS SQ FT	WIDENING AREA SQ YD	WIDENING DEPTH INCHES	WIDENING CU YD
	FROM	TO					
NE	304+37.00	305+86.00	VARIABLE	548	61	10	17
SE	304+37.00	305+86.00	VARIABLE	600	67	10	19
NW	301+74.00	303+67.00	VARIABLE	660	73	10	20
SW	302+30.00	303+67.00	VARIABLE	600	67	10	19
TOTAL							75

MODEL: PCC WIDENING DETAIL (Sheet)  
 FILE NAME: c:\p\work\pccwidening\id774c53\_details.dgn

USER NAME = jessica.hille	DESIGNED -	REVISED -
	DRAWN -	REVISED -
	CHECKED -	REVISED -
PLOT DATE = 6/25/2024	DATE -	REVISED -

**STATE OF ILLINOIS**  
**DEPARTMENT OF TRANSPORTATION**

**PRE-STAGE CONSTRUCTION**  
**PCC WIDENING DETAIL**

SCALE: SHEET OF 4 SHEETS STA. TO STA.

F.A.P. RTE.	SECTION	COUNTY	TOTAL SHEETS	SHEET NO.
774	D7 BRIDGE REPAIRS 2025-4	EFFINGHAM	15	6
CONTRACT NO. 74C53				
ILLINOIS FED. AID PROJECT				



TEMPORARY RAMP					
STAGE 1					
LOCATION STATION	SIDE	RAMP WIDTH (FOOT)	DROP-OFF DEPTH (INCH)	RAMP LENGTH (FOOT)	RAMP AREA (SQ YD)
303+67	CL	20.0	1.5	6	14
304+03	CL	20.0	1.5	6	14
TOTAL					28

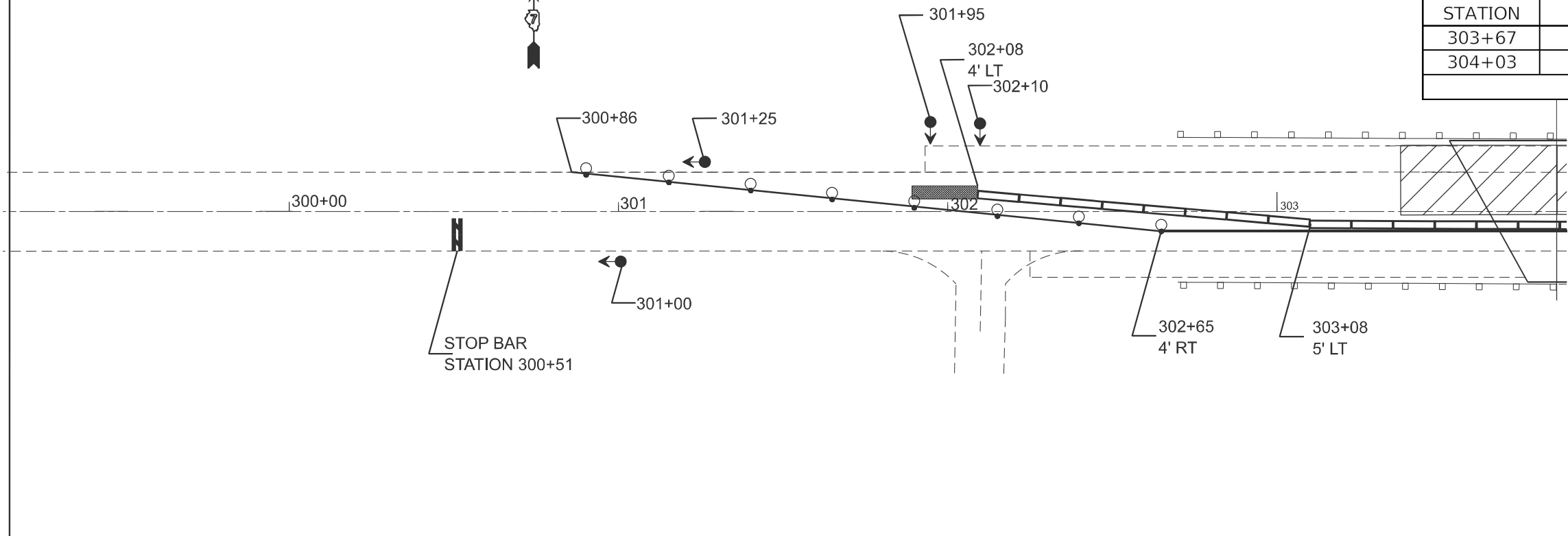

PAVEMENT MARKING BLACKOUT TAPE, 5"			
STAGE 1			
STATION	TO	STATION	FOOT
300+33		301+93	40
301+83		305+65	382
305+77		307+19	36
TOTAL			458

SHORT TERM PAVEMENT MARKING REMOVAL			
STAGE 1			
STATION		STATION	SQ FT
300+33		301+93	17
301+83		305+65	159
305+77		307+19	15
TOTAL			191

TEMPORARY CONCRETE BARRIER		
STAGE 1		FEET
302+08	305+63	350
TOTAL		350

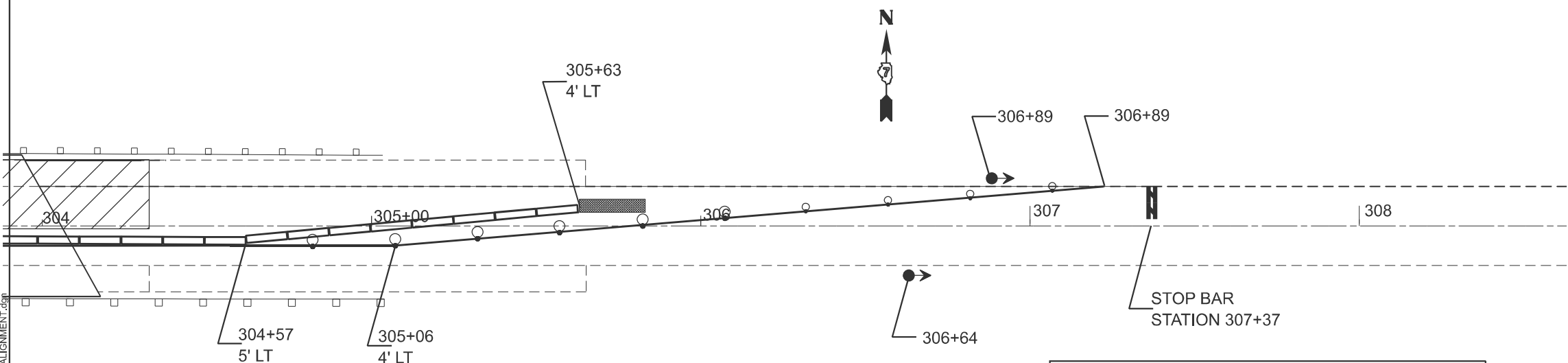

IMPACT ATTENUATORS, TEMPORARY, (NON REDIRECTIVE) TEST LEVEL 3		
STAGE 1		
STATION	LT/RT	EACH
302+08	LT	1
305+63	LT	1
TOTAL		2

LEGEND	
	IMPACT ATTENUATOR, TEMPORARY (NON-REDIRECTIVE), TEST LEVEL 3
	TEMPORARY BRIDGE SIGNALS
	TEMPORARY CONCRETE BARRIERS

MODEL: Unnamed Plan - Stage 1A (Sheet)  
FILE NAME: c:\p\work\pav\hille\id088976\ID774C53\_ALIGNMENT.dwg

USER NAME = jessica.hille	DESIGNED -	REVISED -
	DRAWN -	REVISED -
	CHECKED -	REVISED -
PLOT DATE = 6/25/2024	DATE -	REVISED -

**STATE OF ILLINOIS  
DEPARTMENT OF TRANSPORTATION**

**STAGE 1 CONSTRUCTION DETAILS**

SCALE: 1"=20'      SHEET OF 4 SHEETS      STA. 299+13.02 TO STA. 308+63.02

F.A.P. RTE.	SECTION	COUNTY	TOTAL SHEETS	SHEET NO.
774	D7 BRIDGE REPAIRS 2025-4	EFFINGHAM	15	7
CONTRACT NO. 74C53				
ILLINOIS FED. AID PROJECT				

TEMPORARY RAMP					
STAGE 2					
LOCATION STATION	SIDE	RAMP WIDTH (FOOT)	DROP-OFF DEPTH (INCH)	RAMP LENGTH (FOOT)	RAMP AREA (SQ YD)
303+67	CL	20.0	1.5	6	14
304+03	CL	20.0	1.5	6	14
TOTAL					28

PAVEMENT MARKING BLACKOUT TAPE, 5"			
STAGE 2			
STATION	TO	STATION	FOOT
301+93		303+40	147
304+30		305+67	137
TOTAL			284

SHORT TERM PAVEMENT MARKING REMOVAL			
STAGE 2			
STATION		STATION	
301+93		303+40	61
304+30		305+67	57
TOTAL			118

RELOCATE TEMPORARY CONCRETE BARRIER			
STAGE 2			
STATION		STATION	
302+47		305+47	300.0

RELOCATE IMPACT ATTENUATORS, TEMPORARY, (NON-REDIRECTIVE) TEST LEVEL 3			
STAGE 2			
STATION	LT/RT	EACH	
305+47	RT		1
TOTAL			1

IMPACT ATTENUATORS, TEMPORARY (FULLY REDIRECTIVE, NARROW), TEST LEVEL 3			
STAGE 2			
STATION	LT/RT	EACH	
302+47	RT		1
TOTAL			1

PAINT PAVEMENT MARKING LINE, 4"						
STAGE 2						
LOCATION STATION	TO	WIDTH (FOOT)	LENGTH	WHITE EDGE LINE	YELLOW CL SKIP	TOTAL FEET
300+51		307+37	686.0		172	172
300+51		307+37	686.0	1372		1372
TOTAL						1544

LEGEND	
	IMPACT ATTENUATOR, TEMPORARY (FULLY REDIRECTIVE), TEST LEVEL 3
	IMPACT ATTENUATOR, TEMPORARY (NON-REDIRECTIVE), TEST LEVEL 3
	TEMPORARY BRIDGE SIGNALS (SPECIAL)
	RELOCATE TEMPORARY CONCRETE BARRIERS
	TYPE 3 BARRICADE

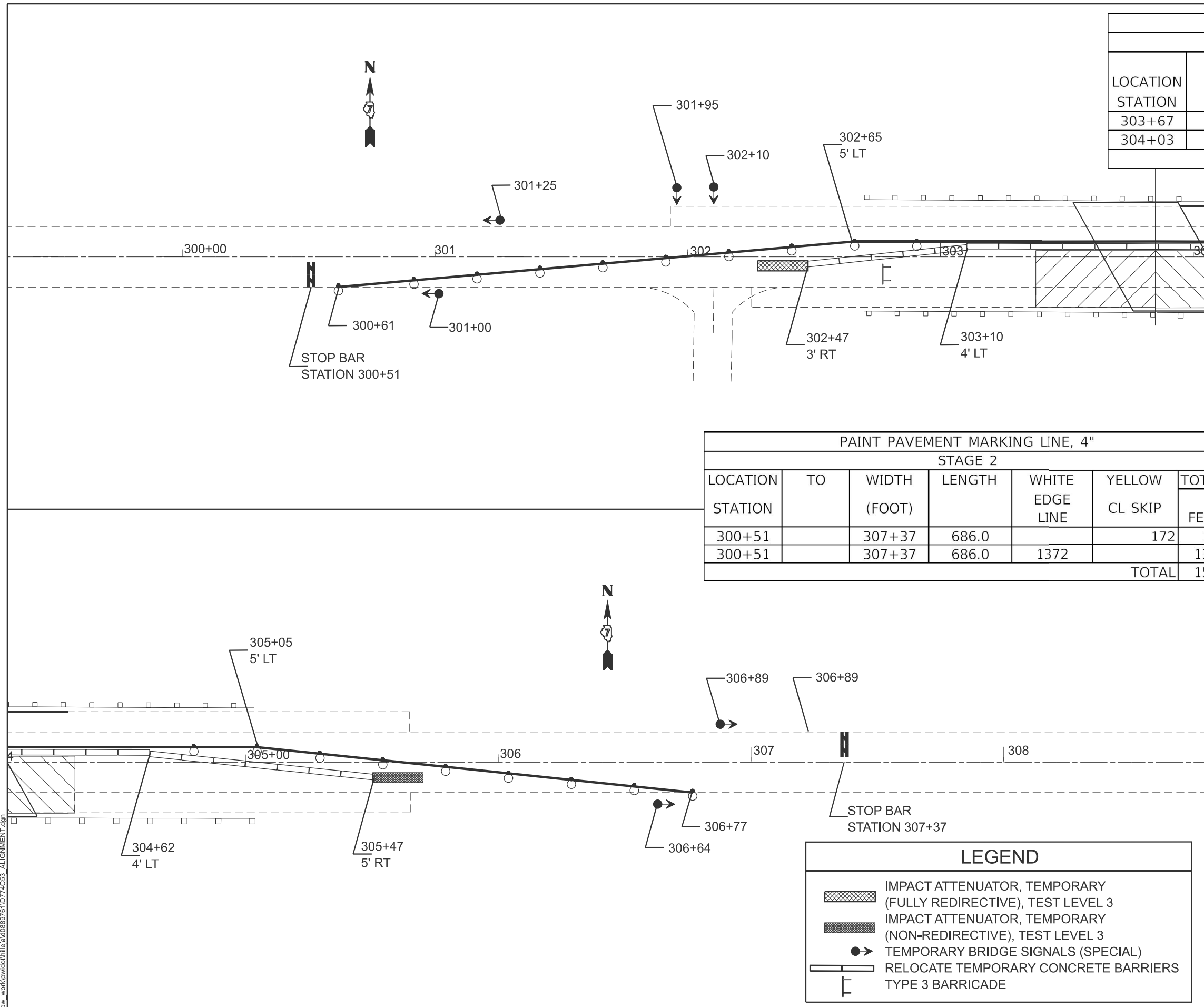

MODEL: Unnamed Plan-1 - Stage 2A  
FILE NAME: c:\p\work\wv\hille\ad088976\1D774C53\_ALIGNMENT.dgn

USER NAME = jessica.hille	DESIGNED -	REVISED -
	DRAWN -	REVISED -
	CHECKED -	REVISED -
PLOT DATE = 6/25/2024	DATE -	REVISED -

STATE OF ILLINOIS  
DEPARTMENT OF TRANSPORTATION

STAGE II CONSTRUCTION DETAILS

SCALE: 1"=20' SHEET OF 4 SHEETS STA. 7+84.82 TO STA. 17+34.82

F.A.P. RTE.	SECTION	COUNTY	TOTAL SHEETS	SHEET NO.
774	D7 BRIDGE REPAIRS 2025-4	EFFINGHAM	15	8
CONTRACT NO. 74C53				
ILLINOIS FED. AID PROJECT				



Structure 025-0031 carries ILL 33 over Morris Creek. The original structure was a reinforced concrete girder bridge built in 1939. The superstructure was replaced in 1990 with a reinforced concrete deck on steel stringers. The proposed project consists of bridge deck scarification, bridge deck overlay, full depth deck patching, & bridge deck grooving

**DESIGN SPECIFICATIONS**

2002 AASHTO Standard Specifications for Highway Bridges

**GENERAL NOTES**

Plan dimensions and details relative to the existing structure have been taken from existing plans and are subject to nominal construction variations. The Contractor shall field verify existing dimensions and details affecting new construction and make necessary approved adjustments prior to construction or ordering of materials. Such variations shall not be cause for additional compensation for a change in scope of the work, however, the Contractor will be paid for the quantity actually furnished at the unit price bid for the work.

Prior to pouring the new concrete deck, all heavy or loose rust, loose mill scale, and other loose or potentially detrimental foreign material shall be removed from the surfaces in contact with concrete. Tightly adhered paint may remain unless otherwise noted. Removal shall be accomplished by methods that will not damage the steel and the cost will be included in the pay item covering removal of the existing concrete.

Protective Coat to be applied to areas of new concrete only, including bridge deck concrete overlay.

Areas of deck repairs shown are estimated. The Engineer shall show actual locations of deck repairs on as-built plans.

Full depth deck slab repairs performed in the exterior bays of the bridge deck (between the parapet walls and the first interior beams) shall be limited to individual lengths no greater than 10'. In these portions of the deck, repair areas longer than 10' shall be divided into segments not greater than 10' in length, and the segments shall be poured in alternating sequence. Subsequent segments repaired in sequence shall not be removed until 72 hours shall have elapsed from the end of the previous, adjacent pour, and the adjacent pour shall have attained a minimum modulus of rupture of 650psi.

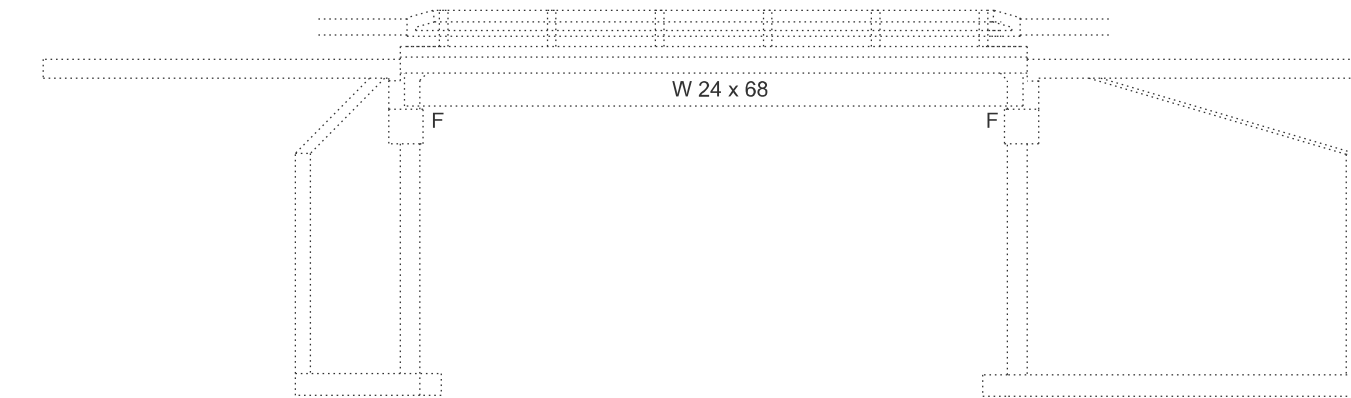

**ELEVATION**

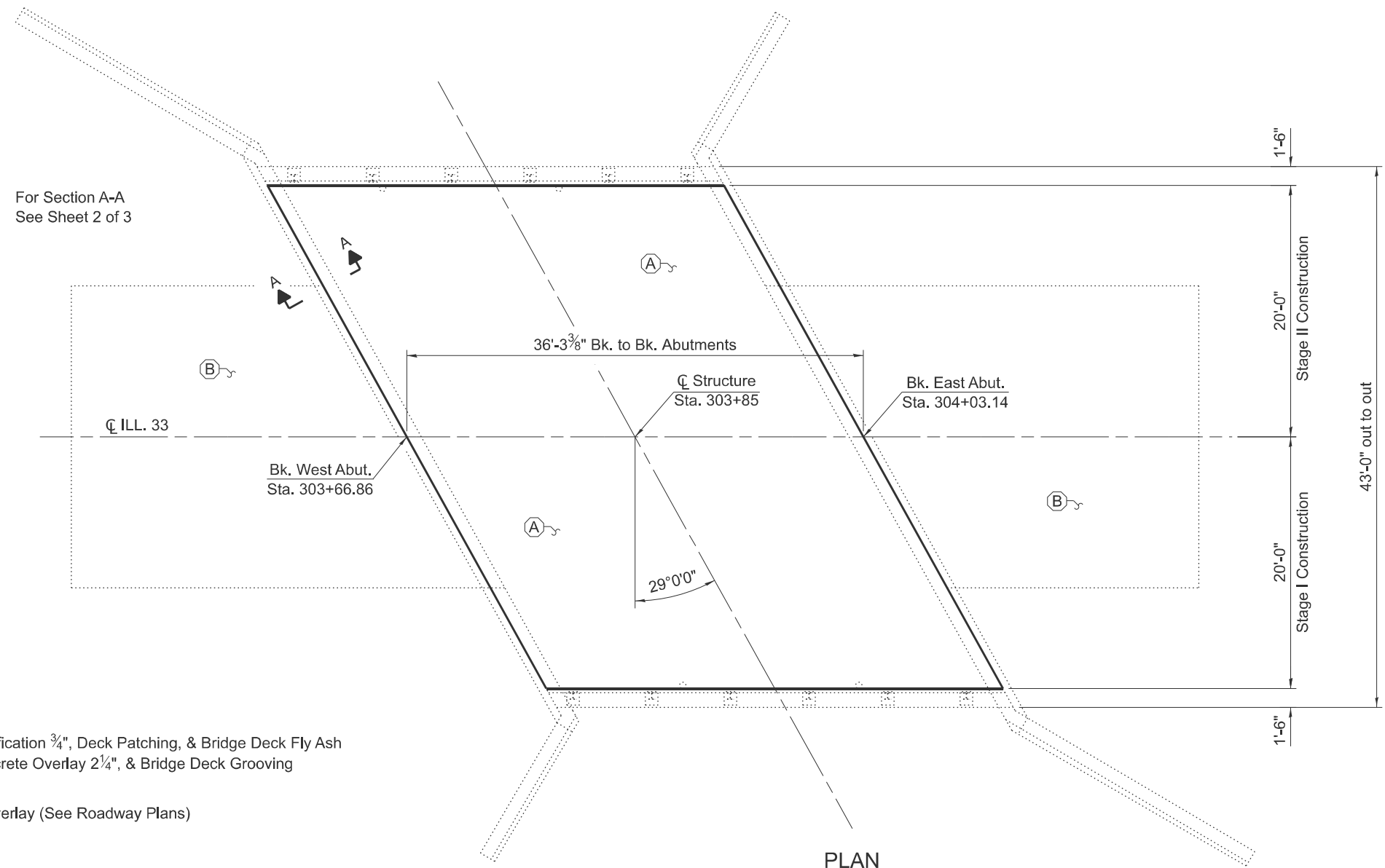

For Section A-A See Sheet 2 of 3

**PLAN**

(A) - Bridge Deck Scarification 3/4", Deck Patching, & Bridge Deck Fly Ash or GGBF Slag Concrete Overlay 2 1/4", & Bridge Deck Grooving

(B) - Proposed HMA Overlay (See Roadway Plans)

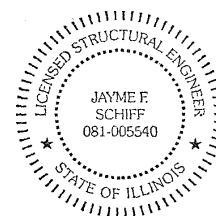

EXPIRES 11-30-2024

*Jayne F. Schiff*

**STATE OF ILLINOIS  
DEPARTMENT OF TRANSPORTATION**

**GENERAL PLAN & ELEVATION  
S.N. 025-0031**

F.A.P. RTE.	SECTION	COUNTY	TOTAL SHEETS	SHEET NO.
774	D7 BRIDGE REPAIRS 2025-4	EFFINGHAM	15	9
CONTRACT NO. 74C53				
		ILLINOIS	FED. AID PROJECT	

SCALE: SHEET 1 OF 3 SHEETS STA. TO STA.

MODEL: D:\info... FILE NAME: ...

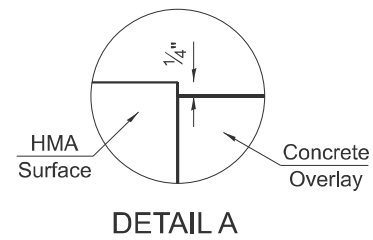
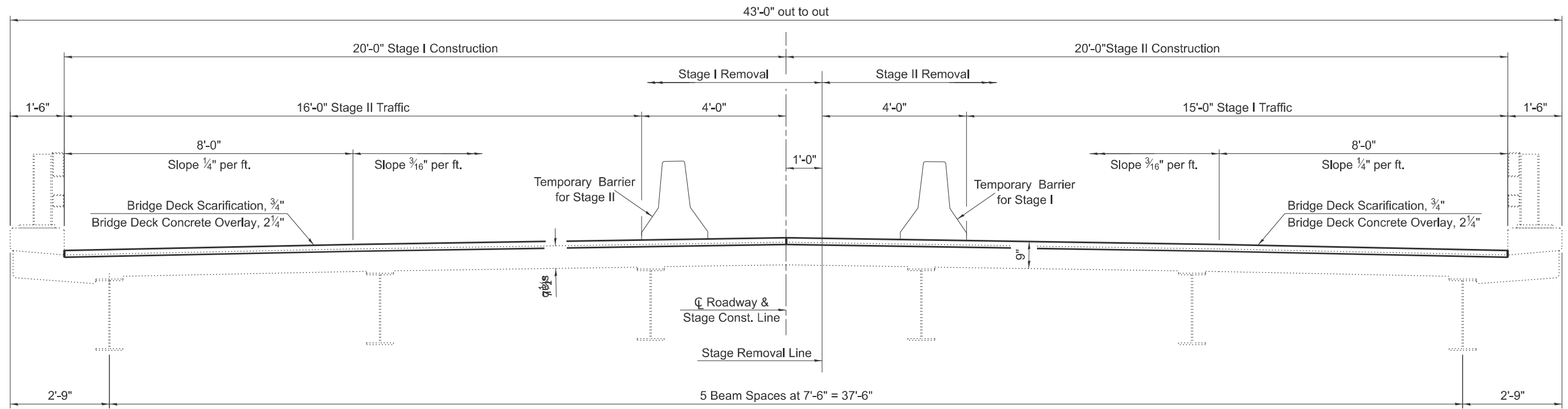

**DECK CROSS SECTION**  
Looking West

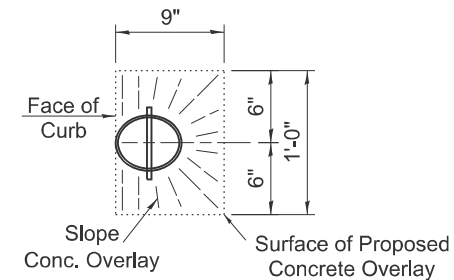

**TOP PLAN OF FLOOR DRAIN**

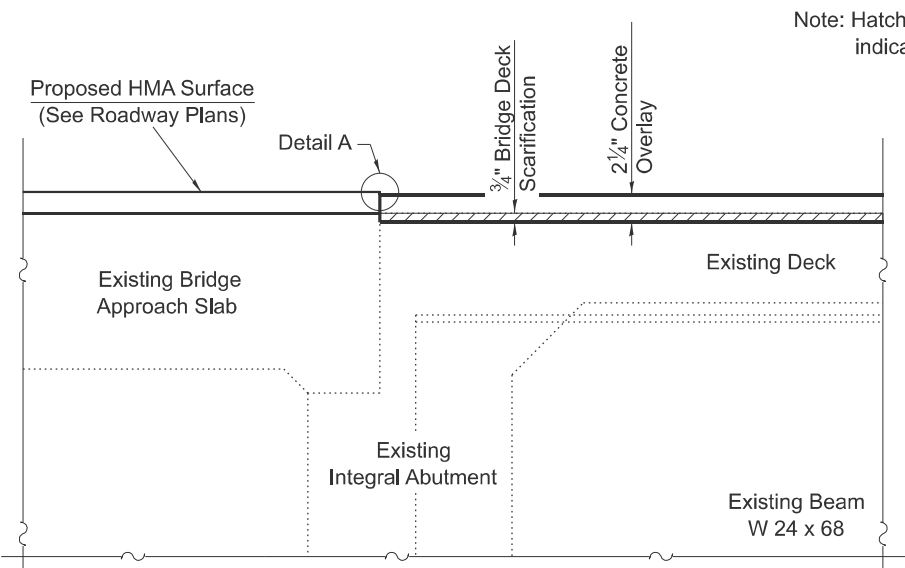

**SECTION A-A**

Note: Hatched area indicates removal.

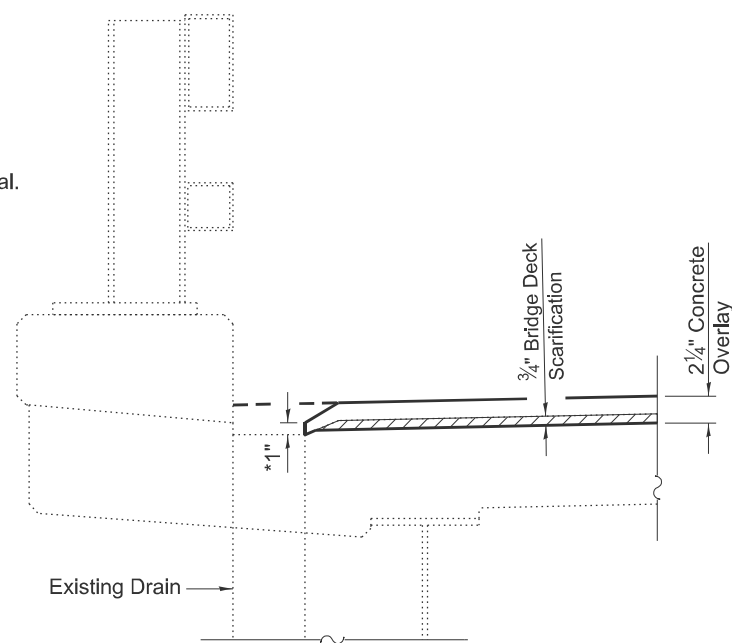

**FLOOR DRAIN PRESERVATION**

\* Minimum thickness of overlay at edge of drain = 1"

**TOTAL BILL OF MATERIALS**

ITEM	UNIT	QUANTITY
Bridge Deck Scarification 3/4"	Sq. Yd.	162
Bridge Deck Fly Ash or GGBF Slag Concrete Overlay, 2 1/4"	Sq. Yd.	162
Bridge Deck Grooving	Sq. Yd.	150
Protective Coat	Sq. Yd.	162
Deck Slab Repair (Full Depth, Type I)	Sq. Yd.	6.0
Deck Slab Repair (Full Depth, Type II)	Sq. Yd.	3.0
Approach Slab Repair (Partial Depth)	Sq. Yd.	3.0

MODEL: D:\info\... FILE NAME: ...

USER NAME = jessica.nille	DESIGNED - T. Walk	REVISED -
PLOT SCALE = \$SCALE\$	DRAWN - T. Walk	REVISED -
PLOT DATE = 6/25/2024	CHECKED - D. Macklin	REVISED -
	DATE - August 2023	REVISED -

**STATE OF ILLINOIS  
DEPARTMENT OF TRANSPORTATION**

**STAGE CONSTRUCTION & BILL OF MATERIALS  
S.N. 025-0031**

SCALE: SHEET 2 OF 3 SHEETS STA. TO STA.

F.A.P. RTE.	SECTION	COUNTY	TOTAL SHEETS	SHEET NO.
774	D7 BRIDGE REPAIRS 2025-4	EFFINGHAM	15	10
CONTRACT NO. 74C53				
ILLINOIS FED. AID PROJECT				

025-0031 Bridge Deck & Approach Patching

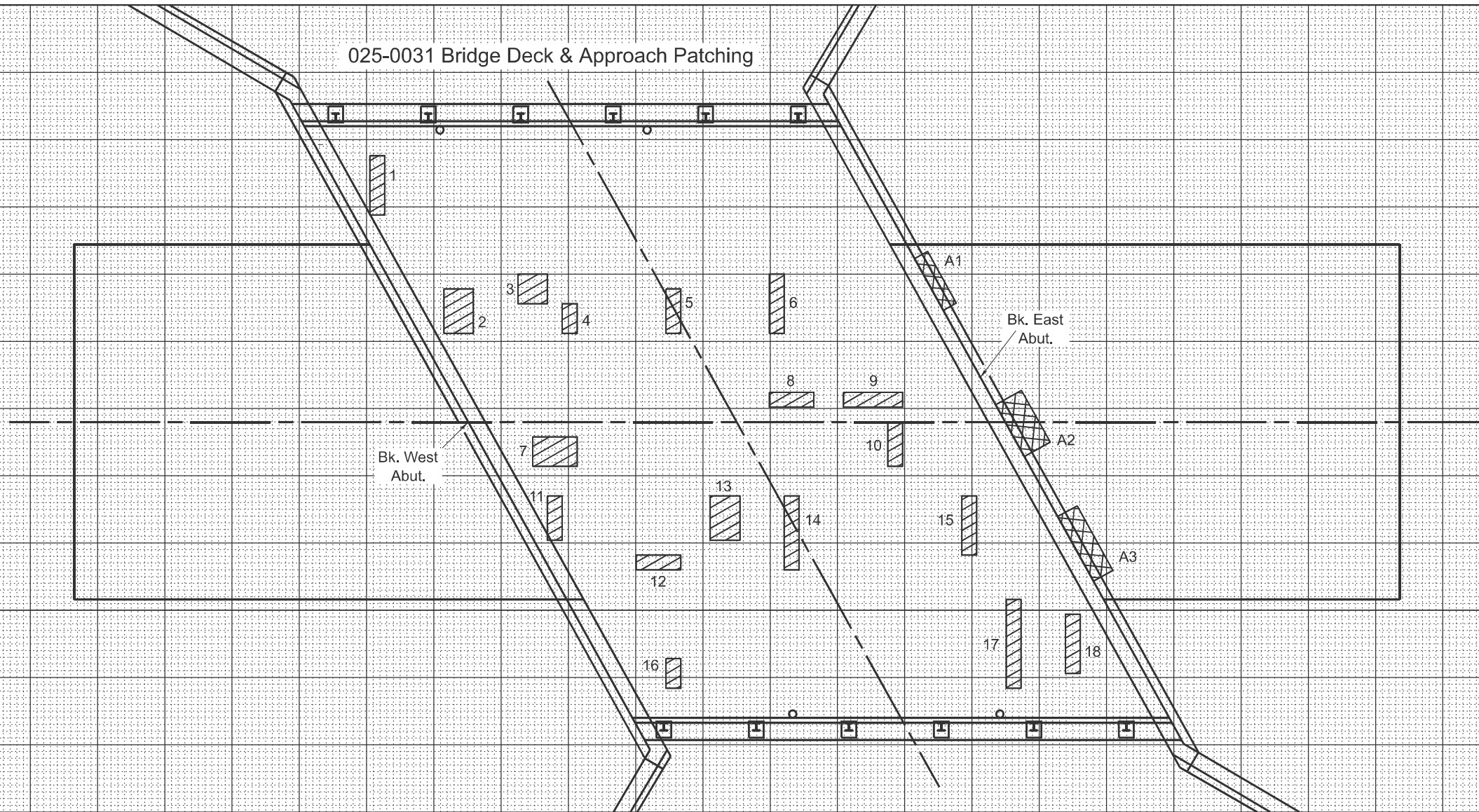
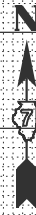

PATCH NO.	SIZE		DECK SLAB REPAIR (FD TYPE I)	DECK SLAB REPAIR (FD TYPE II)
	LENGTH	WIDTH	SQ YD	SQ YD
1	1.0	4.0	0.4	
2	2.0	3.0		0.7
3	2.0	2.0	0.4	
4	1.0	2.0	0.2	
5	1.0	3.0	0.3	
6	1.0	4.0	0.4	
7	3.0	2.0		0.7
8	3.0	1.0	0.3	
9	4.0	1.0	0.4	
10	1.0	3.0	0.3	
11	1.0	3.0	0.3	
12	3.0	1.0	0.3	
13	2.0	3.0		0.7
14	1.0	5.0	0.6	
15	1.0	4.0	0.4	
16	1.0	2.0	0.2	

PATCH NO.	SIZE		DECK SLAB REPAIR (FD TYPE I)	DECK SLAB REPAIR (FD TYPE II)
	LENGTH	WIDTH	SQ YD	SQ YD
17	1.0	6.0		0.7
18	1.0	4.0	0.4	
TOTAL ROUNDS TO:			6.0	3.0

PATCH NO.	SIZE		APPROACH REPAIR (PART. DEPTH)	APPROACH REPAIR (FULL DEPTH)
	LENGTH	WIDTH	SQ YD	SQ YD
A1	1.0	4.0	0.4	
A2	2.0	4.0	0.9	
A3	1.5	5.0	0.8	
TOTAL ROUNDS TO:			3.0	0.0

THE LOCATIONS AND SIZES SHOWN GRAPHICALLY ABOVE ARE APPROXIMATE. SEE THIS TABLE FOR ACTUAL SIZES.

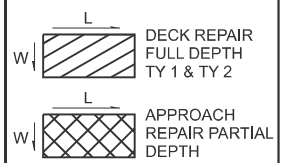

DATE OF SURVEY: 7-10-23  
 SURVEY BY: DPM & TMW  
 METHOD OF SURVEY: VISUAL

**ESTIMATED PAY QUANTITIES:**

DECK SLAB REPAIR (FULL DEPTH TYPE I)  
 6.0 SQ YD

DECK SLAB REPAIR (FULL DEPTH TYPE II)  
 3.0 SQ YD

APPROACH SLAB PATCHING (PARTIAL DEPTH)  
 3.0 SQ YD

MODEL: Default  
 FILE NAME: j:\projects\025-0031\025-0031 Bridge Repair Plans

USER NAME = jessica.nille	DESIGNED - T. Walk	REVISED -
PLOT SCALE = \$SCALE\$	DRAWN - T. Walk	REVISED -
PLOT DATE = 6/25/2024	CHECKED - D. Macklin	REVISED -
	DATE - August 2023	REVISED -

STATE OF ILLINOIS  
 DEPARTMENT OF TRANSPORTATION

BRIDGE DECK & APPROACH PATCHING  
 S.N. 025-0031

SCALE: SHEET 3 OF 3 SHEETS STA. TO STA.

F.A.P. RTE.	SECTION	COUNTY	TOTAL SHEETS	SHEET NO.
774	D7 BRIDGE REPAIRS 2025-4	EFFINGHAM	15	11
CONTRACT NO. 74C53				

ILLINOIS FED. AID PROJECT

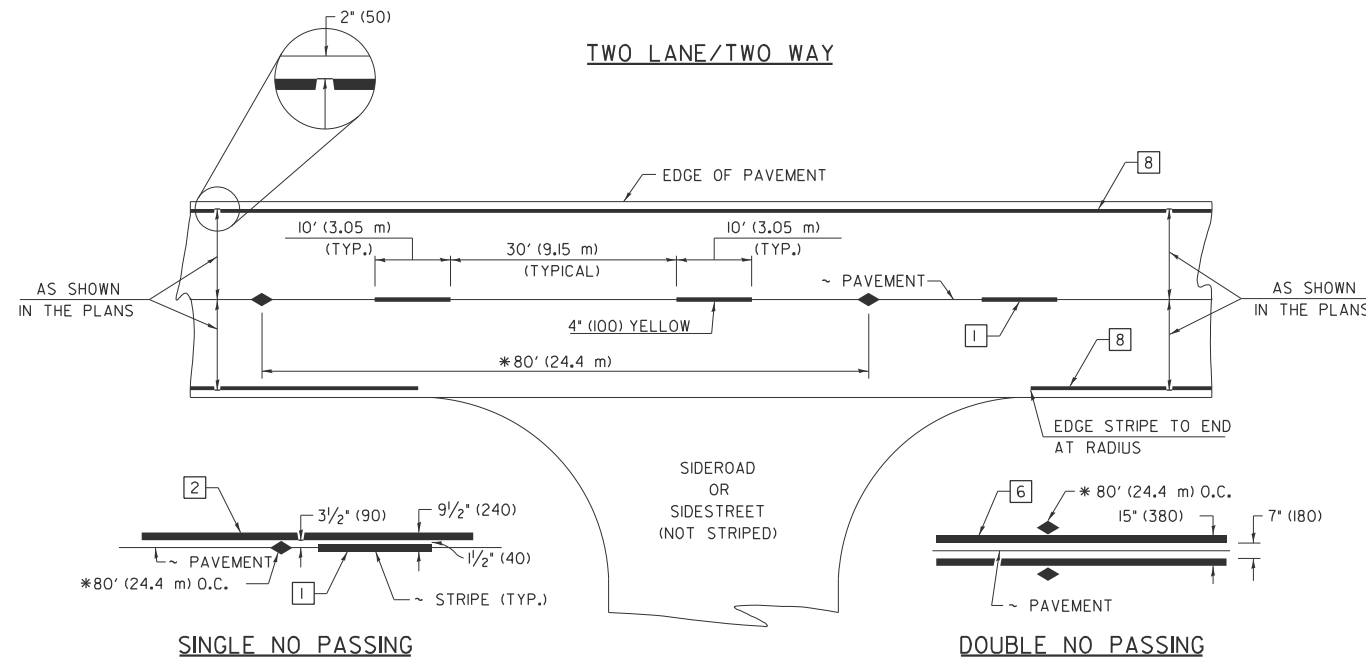

\* REDUCE TO 40' (12.2 m) O.C. ON CURVES WITH POSTED OR ADVISORY SPEEDS OF 45 mph (70 km/h) OR LESS.

PAVEMENT MARKING LEGEND

- 1 4" (100) SKIP-DASH (YELLOW)
- 2 4" (100) SOLID (YELLOW)
- 3 12" (300) DIAGONAL (YELLOW)
- 4 4" (100) DOUBLE YELLOW (NARROW)
- 5 12" (300) SOLID WHITE
- 6 4" (100) DOUBLE YELLOW (WIDE)
- 7 6" (150) SKIP-DASH (WHITE)
- 8 4" (100) SOLID (WHITE)
- 9 12" (300) DIAGONAL (WHITE)
- 10 6" (150) SOLID (WHITE)
- 11 24" (600) STOP BAR (WHITE)
- 12 8" (200) SOLID (WHITE)
- 13 4" (100) PARKING WHITE

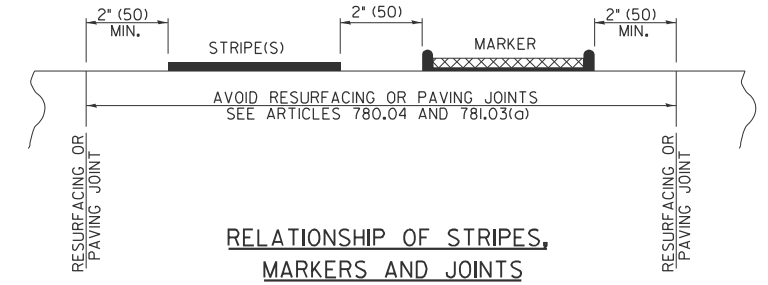

RELATIONSHIP OF STRIPES, MARKERS AND JOINTS

TYPICAL PAVEMENT MARKERS LEGEND

- ◆ TWO-WAY AMBER MARKER
- ▶ ONE-WAY AMBER MARKER
- ▷ ONE-WAY CRYSTAL MARKER

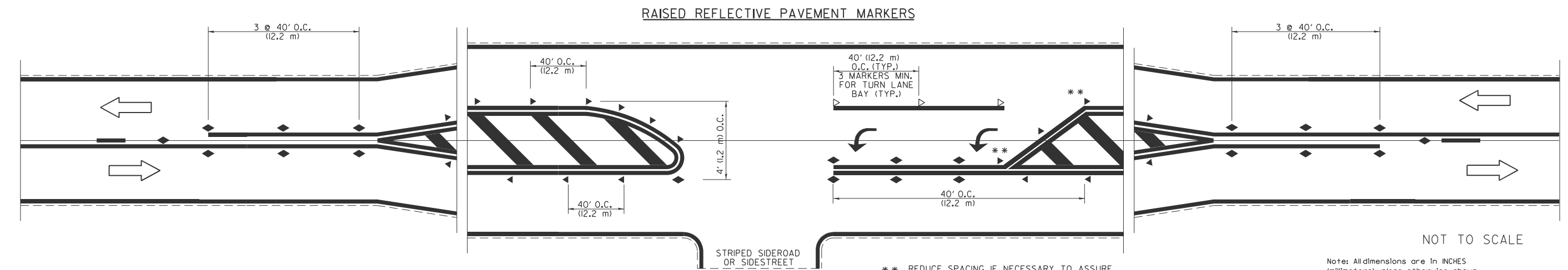

NOT TO SCALE

Note: All dimensions are in INCHES (millimeters) unless otherwise shown.

DISTRICT 7 DETAIL NO. 7800001

MODEL: PAVEMENT MARK 3 (Sheet) FILE NAME: c:\p\work\pav\hille\088976\1D774C53.DT PAVEMENT MARKING DETAIL.dgn

USER NAME = jessica.hille	DESIGNED -	REVISED -
	DRAWN -	REVISED -
	CHECKED -	REVISED -
PLOT DATE = 6/25/2024	DATE -	REVISED -

STATE OF ILLINOIS  
DEPARTMENT OF TRANSPORTATION

PAVEMENT MARKING AND RAISED REFLECTIVE PAVEMENT MARKERS  
(RURAL AND URBAN APPLICATIONS)

SCALE: SHEET 1 OF 4 SHEETS STA. TO STA.

F.A.P. RTE.	SECTION	COUNTY	TOTAL SHEETS	SHEET NO.
774	D7 BRIDGE REPAIRS 2025-4	EFFINGHAM	15	12
CONTRACT NO. 74C53			ILLINOIS FED. AID PROJECT	

MODEL: PAVEMENT MARK DETAIL 2 (Sheet)  
 FILE NAME: c:\pwworking\billie@d088976\10774c53.DT PAVEMENT MARKING DETAIL.dgn

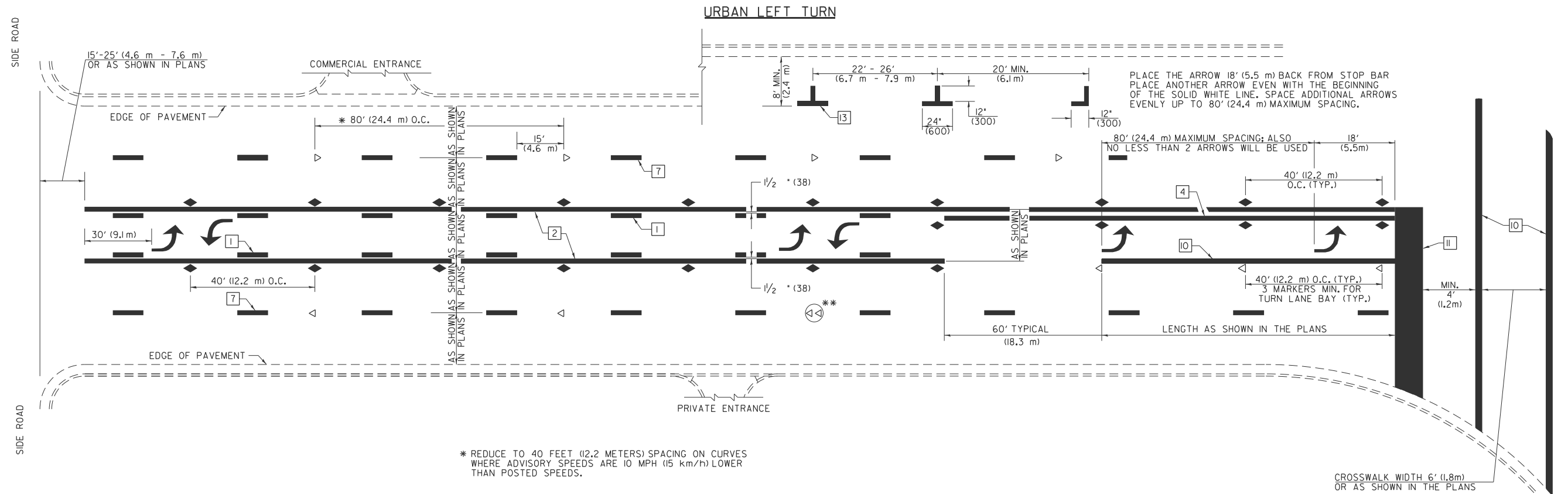

\* REDUCE TO 40 FEET (12.2 METERS) SPACING ON CURVES WHERE ADVISORY SPEEDS ARE 10 MPH (15 km/h) LOWER THAN POSTED SPEEDS.

\*\* DOUBLE LANE LINE MARKERS SHALL BE SPECIFIED AND SPACED AS SHOWN IN HIGHWAY STANDARD 781001 FOR MULTI-LANE DIVIDED AND UNDIVIDED HIGHWAYS.

**PAVEMENT MARKING LEGEND**

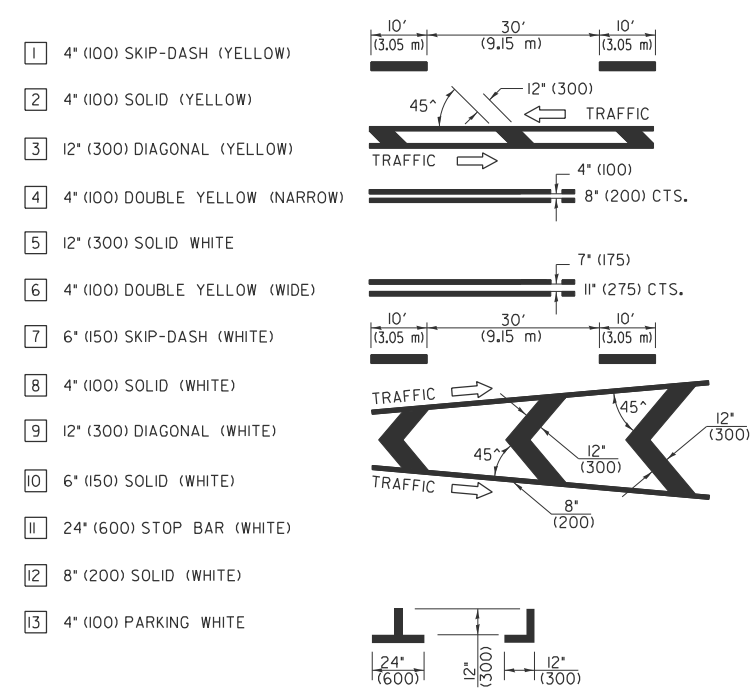

**GENERAL NOTES**

1. TURN ARROW PAIRS SHALL BE PLACED AT 250' (75 m) INTERVALS AND SHALL BE EVENLY SPACED BETWEEN BOTH ENDS OF THE BIDIRECTIONAL LEFT TURN LANE. USE A MINIMUM OF TWO PAIRS PER BLOCK.
2. THE SOLID YELLOW PAVEMENT MARKINGS [2] SHOULD GENERALLY START OR END NEAR THE RADIUS POINT OF EACH STREET RETURN EXCEPT WHERE ONE OR BOTH ENDS WOULD INCLUDE STOP BARS.
3. THE SKIP-DASH PAVEMENT MARKINGS [1] OR [7] SHOULD BE CENTERED BETWEEN BOTH ENDS OF EACH CITY BLOCK AND SHALL BE PLACED SO THEY LINE UP ACROSS FROM EACH OTHER.
4. USE LARGE ARROW SIZE FOR BOTH RURAL AND URBAN LOCATIONS. (SEE SECTION 780 FOR SYMBOLS TABLE)
5. LANE LINE EXTENSIONS SHALL BE THE SAME COLOR AND WIDTH AS THE LANE LINE BEING EXTENDED.
6. ALL WHITE SKIP-DASH LINES SHALL BE 6" IN WIDTH.

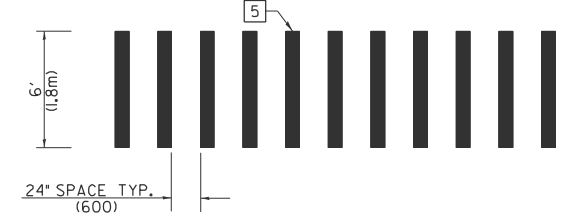

CROSSWALK DETAIL (DECATUR CITY LIMITS ONLY)

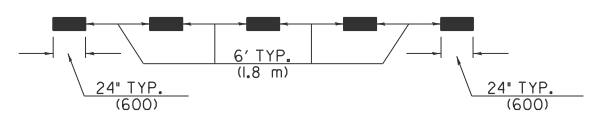

LANE LINE EXTENSIONS

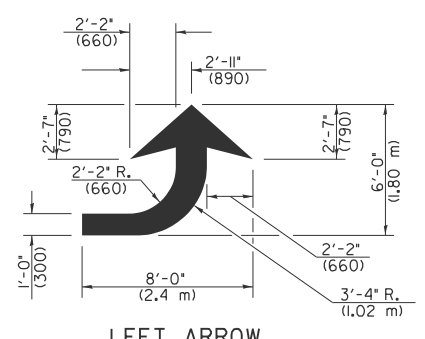

LEFT ARROW  
 REVERSE FOR RIGHT ARROW  
 AREA = 15.6 SQ. FT. (1.47 m<sup>2</sup>) (WHITE)

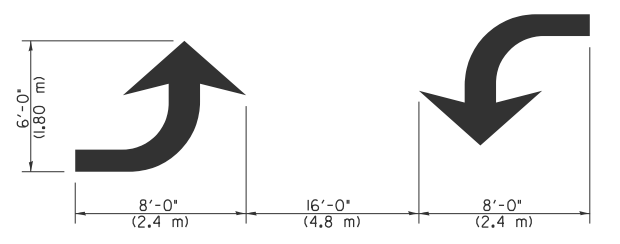

TYPICAL DOUBLE TURN ARROWS (WHITE)

NOT TO SCALE

Note: All dimensions are in INCHES (millimeters) unless otherwise shown.

**DISTRICT 7 DETAIL NO. 7800001**

USER NAME = jessica.hille	DESIGNED -	REVISED -
	DRAWN -	REVISED -
	CHECKED -	REVISED -
PLOT DATE = 6/25/2024	DATE -	REVISED -

STATE OF ILLINOIS  
 DEPARTMENT OF TRANSPORTATION

**PAVEMENT MARKING AND RAISED REFLECTIVE PAVEMENT MARKERS (RURAL AND URBAN APPLICATIONS)**

SCALE: SHEET 2 OF 4 SHEETS STA. TO STA.

F.A.P. RTE.	SECTION	COUNTY	TOTAL SHEETS	SHEET NO.
774	D7 BRIDGE REPAIR 2025-4	EFFINGHAM	15	13
CONTRACT NO. 74C53			ILLINOIS FED. AID PROJECT	

**ISLANDS**

**OPTION 1**

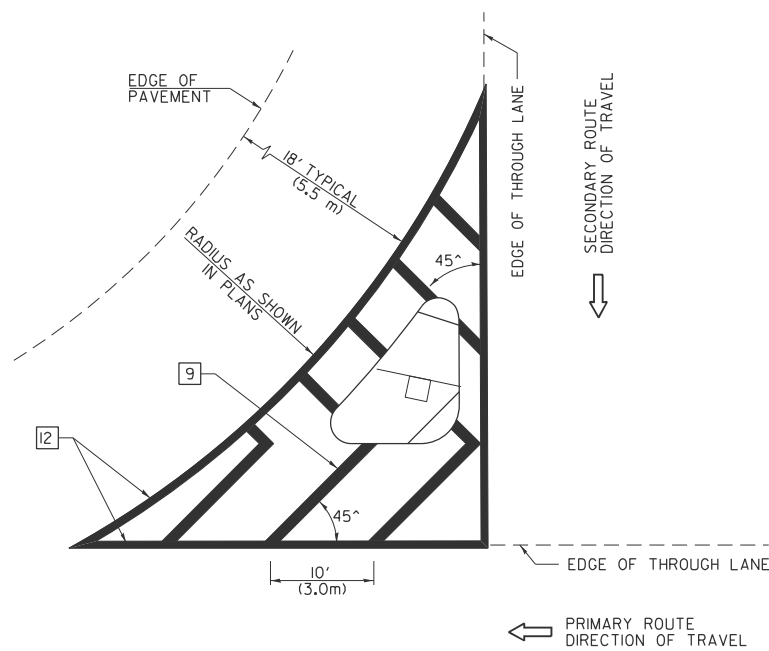

**GENERAL NOTES**

1. RAISED AND CORRUGATED MEDIANS SHALL BE OUTLINED WITH [2].
2. SOME OF THE INFORMATION INCLUDED WITH THIS DETAIL MAY NOT BE APPLICABLE TO THIS IMPROVEMENT.
3. PAVEMENT MARKINGS ARE TO BE EXTENDED THROUGH OMISSIONS WHEN APPLICABLE.
4. FINAL PAVEMENT MARKINGS SHALL BE IN PLACE PRIOR TO PLACING ANY RAISED REFLECTIVE PAVEMENT MARKERS.
5. THE FOLLOWING CRITERIA SHALL BE USED FOR SELECTING THE DIAGONAL PAVEMENT MARKING SPACING:
 

<30 MPH (<50 km/h)	15' (4.5 m)
30-45 MPH (50-75 km/h)	20' (6.0 m)
>45 MPH (>75 km/h)	30' (9.0 m)
6. THE USE OF ISLAND STRIPING OPTION 1 OR OPTION 2 SHALL BE AS SHOWN ON THE PLANS.

**PAVEMENT MARKING LEGEND**

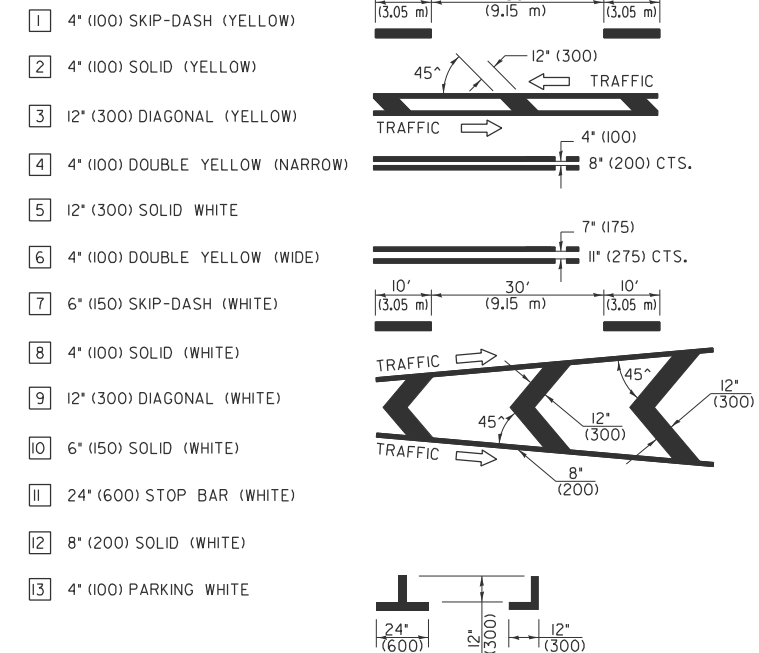

**OPTION 2**

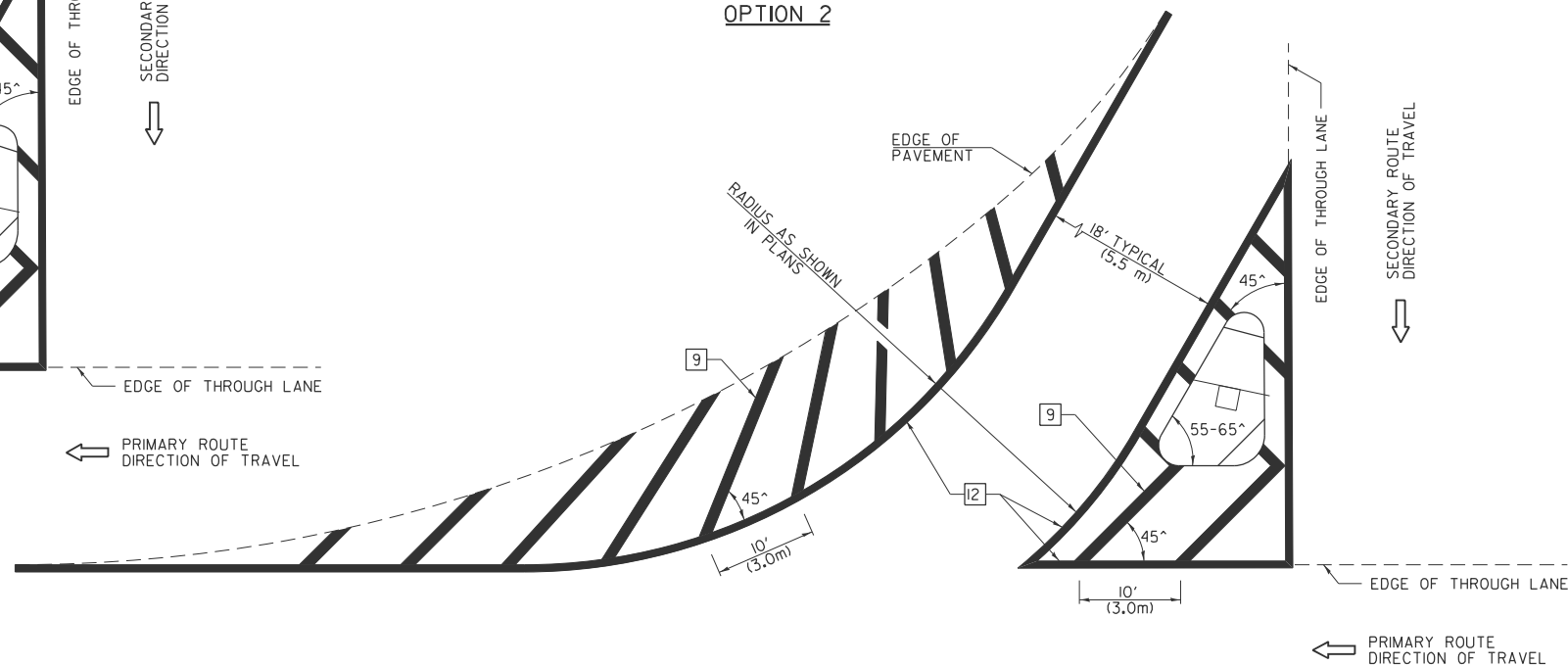

**RURAL LEFT TURN STRIPING**

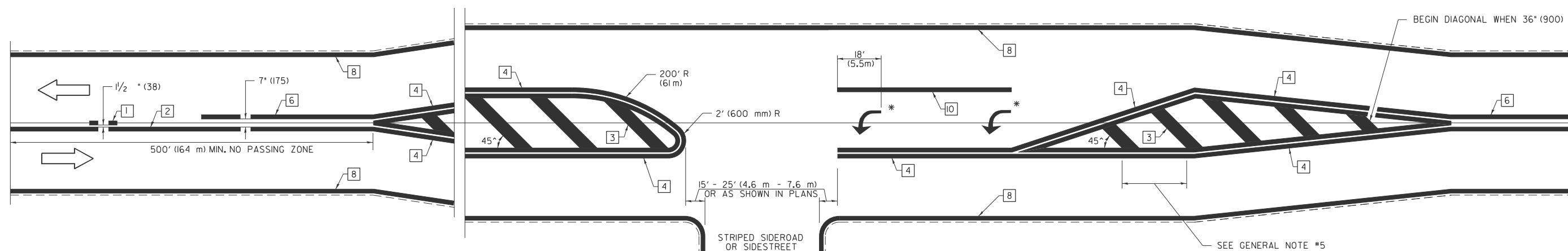

\* PLACE AN ARROW 18' (5.5 m) BACK FROM END OF THE SOLID WHITE LINE. PLACE ANOTHER ARROW EVEN WITH THE BEGINNING OF THE SOLID WHITE LINE. SPACE ADDITIONAL ARROWS EVENLY UP TO 80' (24.4 m) MAXIMUM SPACING. USE MINIMUM OF 2 ARROWS.

NOT TO SCALE

Note: All dimensions are in INCHES (millimeters) unless otherwise shown.

**DISTRICT 7 DETAIL NO. 7800001**

MODEL: PAVEMENT MARK DETAIL 3 (Sheet)  
FILE NAME: c:\p\work\pav\hille\ad088976\1D774C53\_D7 PAVEMENT MARKING DETAIL.dgn

USER NAME = jessica.hille	DESIGNED -	REVISED -
	DRAWN -	REVISED -
	CHECKED -	REVISED -
PLOT DATE = 6/25/2024	DATE -	REVISED -

**STATE OF ILLINOIS  
DEPARTMENT OF TRANSPORTATION**

**PAVEMENT MARKING AND RAISED REFLECTIVE PAVEMENT MARKERS  
(RURAL AND URBAN APPLICATIONS)**

SCALE: SHEET 3 OF 4 SHEETS STA. TO STA.

F.A.P. RTE.	SECTION	COUNTY	TOTAL SHEETS	SHEET NO.
774	D7 BRIDGE REPAIR 2025-4	EFFINGHAM	15	14
CONTRACT NO. 74C53				
ILLINOIS FED. AID PROJECT				

# SUPPLEMENTAL PAVEMENT MARKING TREATMENT FOR RAILROAD-HIGHWAY GRADE CROSSING

## PAVEMENT MARKING LEGEND

### PAVEMENT MARKINGS AT RAILROAD-HIGHWAY GRADE CROSSING

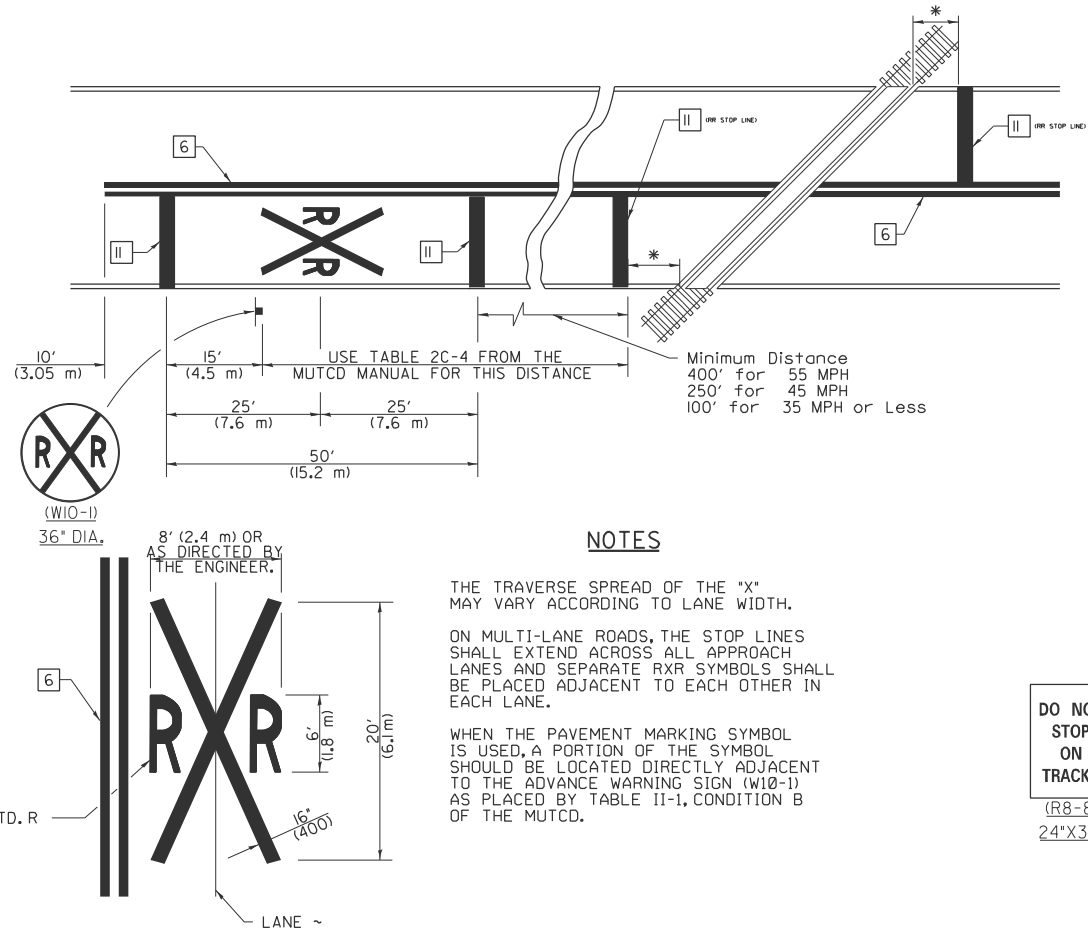

### RAILROAD CROSSING WITH NON-SIGNALIZED INTERSECTION

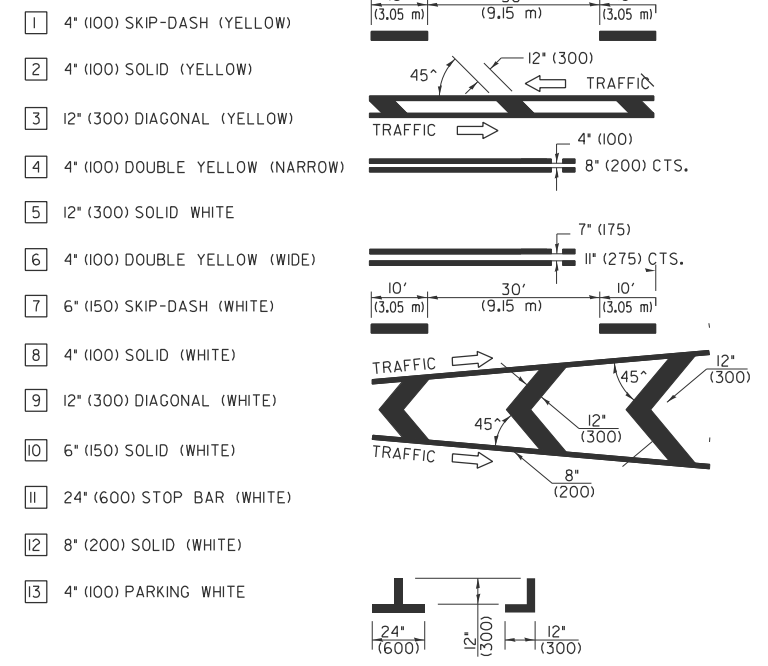
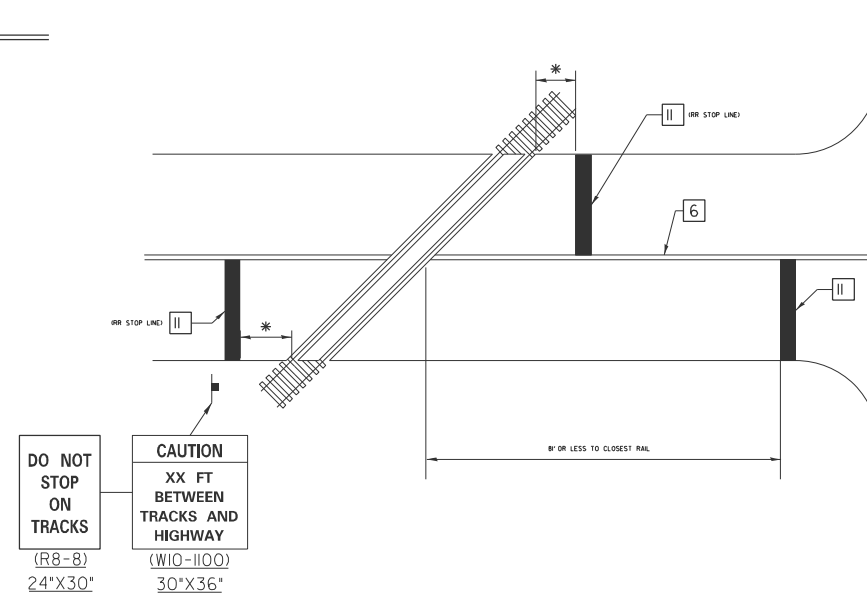

### NOTES

THE TRAVERSE SPREAD OF THE "X" MAY VARY ACCORDING TO LANE WIDTH.

ON MULTI-LANE ROADS, THE STOP LINES SHALL EXTEND ACROSS ALL APPROACH LANES AND SEPARATE RXX SYMBOLS SHALL BE PLACED ADJACENT TO EACH OTHER IN EACH LANE.

WHEN THE PAVEMENT MARKING SYMBOL IS USED, A PORTION OF THE SYMBOL SHOULD BE LOCATED DIRECTLY ADJACENT TO THE ADVANCE WARNING SIGN (W10-1) AS PLACED BY TABLE II-1, CONDITION B OF THE MUTCD.

### GENERAL NOTES

- SUPPLEMENTAL PAVEMENT MARKINGS TO BE INSTALLED ONLY ON APPROACHES TO INTERSECTIONS CONTROLLED BY TRAFFIC SIGNALS WHICH ARE INTERCONNECTED WITH THE RAILROAD WARNING SIGNALS.
- EXTEND PAVEMENT MARKINGS TO THE INTERSECTION ONLY WHERE PRE-SIGNALS ARE USED.
- WHEN PEDESTRIAN SIGNALS ARE PRESENT WITH INTERCONNECTED SIGNALS, WARNING SIGN W10-1101 (18"x24") SHALL BE PLACED NEAR EACH PEDESTRIAN SIGNAL HEAD. COUNTDOWN PEDESTRIAN SIGNAL HEADS SHALL NOT BE UTILIZED ALONG WITH INTERCONNECTED SIGNALS.
- PLEASE REFER TO THE IDOT BUREAU OF OPERATION MEMO OPS T-06 DATED DECEMBER 1, 2020 FOR ADDITIONAL INFORMATION.

**CAUTION**  
WALK TIME SHORTENED WHEN TRAIN APPROACHES  
(W10-1101)  
18"x24"

### RAILROAD CROSSING WITH INTERCONNECT ONLY

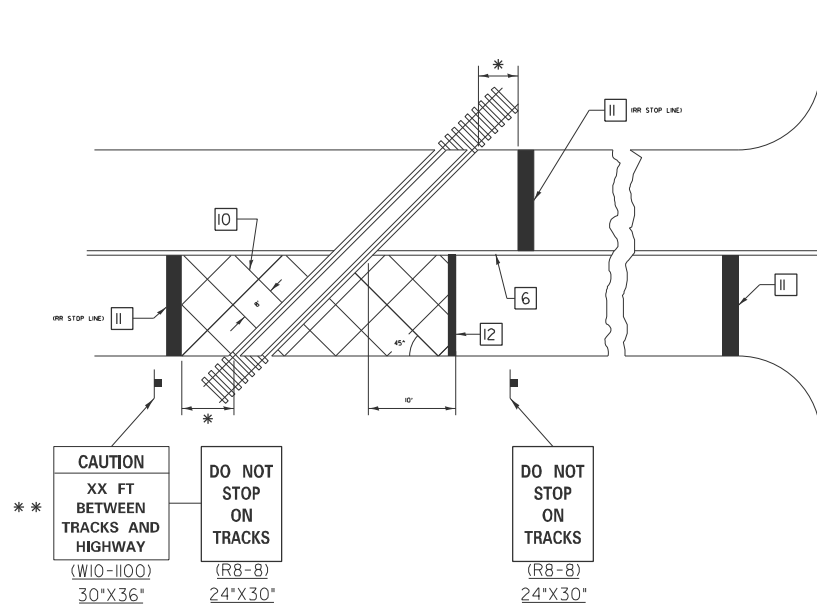

### RAILROAD CROSSING WITH INTERCONNECT AND PRE-SIGNALS

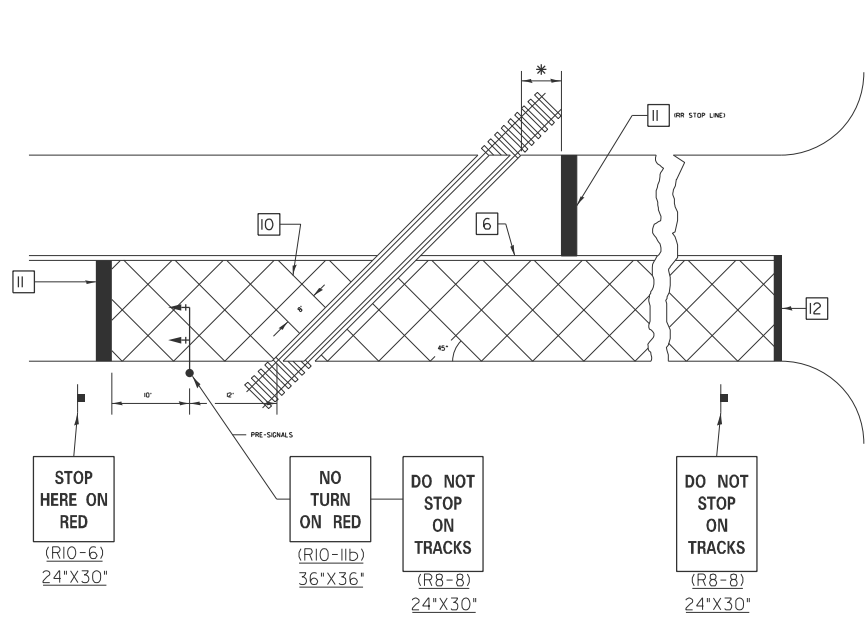

NOT TO SCALE

Note: All dimensions are in INCHES (millimeters) unless otherwise shown.

DISTRICT 7 DETAIL NO. 78000001

MODEL: PAVEMENT MARK DETAIL 4 (Sheet) FILE NAME: c:\p\work\pav\hille\ad088976\10774c53\_D7\_PAVEMENT MARKING DETAIL.dgn

USER NAME = jessica.hille	DESIGNED -	REVISED -
	DRAWN -	REVISED -
	CHECKED -	REVISED -
PLOT DATE = 6/25/2024	DATE -	REVISED -

STATE OF ILLINOIS  
DEPARTMENT OF TRANSPORTATION

PAVEMENT MARKING AND RAISED REFLECTIVE PAVEMENT MARKERS  
(RURAL AND URBAN APPLICATIONS)

SCALE: SHEET 4 OF 4 SHEETS STA. TO STA.

F.A.P. RTE.	SECTION	COUNTY	TOTAL SHEETS	SHEET NO.
774	D7 BRIDGE REPAIR 2025-4	EFFINGHAM	15	15
CONTRACT NO. 74C53				
ILLINOIS FED. AID PROJECT				