

CODE NO.	ITEM	UNIT	TOTAL QUANTITY	CONSTRUCTION CODE	
				100% STATE	100% STATE
				ROADWAY	ROADWAY
				0005	0005
				URBAN	RURAL
20200100	EARTH EXCAVATION	CU YD	1113	532	581
21001000	GEOTECHNICAL FABRIC FOR GROUND STABILIZATION	SQ YD	6679	3191	3488
31101400	SUBBASE GRANULAR MATERIAL, TYPE B 6"	SQ YD	6679	3191	3488
40600290	BITUMINOUS MATERIALS (TACK COAT)	POUND	66771	19215	47556
40600295	POLYMERIZED BITUMINOUS MATERIALS (TACK COAT)	POUND	33385	9607	23778
40600370	LONGITUDINAL JOINT SEALANT	FOOT	54234	15265	38969
40600990	TEMPORARY RAMP	SQ YD	199	127	72
40603090	HOT-MIX ASPHALT BINDER COURSE, IL-19.0, N90	TON	18696	5380	13316
40604164	POLYMERIZED HOT-MIX ASPHALT SURFACE COURSE, IL-9.5, MIX "D", N90	TON	12464	3587	8877
44000164	HOT-MIX ASPHALT SURFACE REMOVAL, 3 3/4"	SQ YD	148379	42699	105680
44200050	WELDED WIRE REINFORCEMENT	SQ YD	6679	3191	3488
44201298	DOWEL BARS 1 1/4"	EACH	3979	2622	1357
44213200	SAW CUTS	FOOT	22190	11899	10291
44213204	TIE BARS 3/4"	EACH	1257	518	739
48102100	AGGREGATE WEDGE SHOULDER, TYPE B	TON	2209	241	1968
63100167	TRAFFIC BARRIER TERMINAL TYPE 1 (SPECIAL) TANGENT	EACH	7		7
63100169	TRAFFIC BARRIER TERMINAL TYPE 1 (SPECIAL) FLARED	EACH	1		1
63200310	GUARDRAIL REMOVAL	FOOT	363		363
67000400	ENGINEER'S FIELD OFFICE, TYPE A	CAL MO	6	2	4
67100100	MOBILIZATION	L SUM	1	0.5	0.5
70100450	TRAFFIC CONTROL AND PROTECTION, STANDARD 701201	L SUM	1	0.5	0.5
70100455	TRAFFIC CONTROL AND PROTECTION, STANDARD 701206	L SUM	1	0.5	0.5
70100460	TRAFFIC CONTROL AND PROTECTION, STANDARD 701306	L SUM	1	0.5	0.5
70100600	TRAFFIC CONTROL AND PROTECTION, STANDARD 701336	L SUM	1	0.5	0.5
70102620	TRAFFIC CONTROL AND PROTECTION, STANDARD 701501	L SUM	1	1	
70103815	TRAFFIC CONTROL SURVEILLANCE	CAL DA	240	60	180
70107025	CHANGEABLE MESSAGE SIGN	CAL DA	240	60	180
70200100	NIGHTTIME WORK ZONE LIGHTING	L SUM	1	0.5	0.5
70300100	SHORT TERM PAVEMENT MARKING	FOOT	32,151	10393	21758
70300150	SHORT TERM PAVEMENT MARKING REMOVAL	SQ FT	10,793	3,540	7,253
70300211	TEMPORARY PAVEMENT MARKING LETTERS AND SYMBOLS - PAINT	SQ FT	61	61	



REVISD 9-10-2024

REV - MS

MODEL: D:\cexcant\S00\001  
FILE NAME: P:\2024\ME5003\_PTB 196-059 PH-L1\_Multibeam\W098\_IL\_301-CAD\052\_Sheet\09717189-ent\S00.dwg



USER NAME = jcovarubias	DESIGNED - MJR	REVISED -
DRAWN - JC	REVISD -	
CHECKED - ERO	REVISED -	
DATE - 6/27/2024	REVISED -	

STATE OF ILLINOIS  
DEPARTMENT OF TRANSPORTATION

FAP 312 (IL ROUTE 3)  
SUMMARY OF QUANTITIES

SCALE: 1"=1'-0" SHEET 1 OF SHEETS STA. 0+00.00 TO STA. 0+75.19

F.A.P. RTE.	SECTION	COUNTY	TOTAL SHEETS	SHEET NO.
312	(119-1)RS-3, (121,122)RS-5	RANDOLPH	33	3
CONTRACT NO. 76169			ILLINOIS   FED. AID PROJECT	

CODE NO.	ITEM	UNIT	TOTAL QUANTITY	CONSTRUCTION CODE	
				100% STATE ROADWAY	100% STATE ROADWAY
				0005 URBAN	0005 RURAL
70300241	TEMPORARY PAVEMENT MARKING - LINE 6"- PAINT	FOOT	175.973	55093	120880
70300281	TEMPORARY PAVEMENT MARKING - LINE 24"- PAINT	FOOT	60	60	
* 72501000	TERMINAL MARKER - DIRECT APPLIED	EACH	10	1	9
* 78000100	THERMOPLASTIC PAVEMENT MARKING - LETTERS AND SYMBOLS	SQ FT	61	61	
* 78000400	THERMOPLASTIC PAVEMENT MARKING - LINE 6"	FOOT	175.973	55093	120880
* 78000650	THERMOPLASTIC PAVEMENT MARKING - LINE 24"	FOOT	60	60	
* 78100100	RAISED REFLECTIVE PAVEMENT MARKER	EACH	713	219	494
78300200	RAISED REFLECTIVE PAVEMENT MARKER REMOVAL	EACH	713	219	494
78300201	PAVEMENT MARKING REMOVAL - GRINDING	SQ FT	100	25	75
78300202	PAVEMENT MARKING REMOVAL - WATER BLASTING	SQ FT	100	25	75
X0327487	TRIAxIAL GEOGRID REINFORCEMENT, TYPE I	SQ YD	6679	3191	3488
X4421017	CLASS B PATCHES, TYPE II, 12 INCH (SPECIAL)	SQ YD	757	509	248
X4421019	CLASS B PATCHES, TYPE III, 12 INCH, (SPECIAL)	SQ YD	893	612	281
X4421021	CLASS B PATCHES, TYPE IV, 12 INCH, (SPECIAL)	SQ YD	5029	2070	2959
Z0034105	MATERIAL TRANSFER DEVICE	TON	31160	8967	22193
Z0048665	RAILROAD PROTECTIVE LIABILITY INSURANCE	L SUM	1	0.5	0.5
Ø Z0076604	TRAINEES TRAINING PROGRAM GRADUATE	HOUR	2500	2500	

△ REVISED 9-10-2024

\* SPECIALTY ITEM Ø 0042

REV - MS

MODEL: D:\excel\500\002  
FILE NAME: P:\2024\ME\5003\_PTB 196-659 PH I-I\_Midham\W008 IL 301-CAD\002\_She109171819-ent-500.002.dwg



USER NAME = jcovarubias	DESIGNED - MJR	REVISED -
	DRAWN - JC	REVISED -
PLOT SCALE = 0.16666633 / in.	CHECKED - ERO	REVISED -
PLOT DATE = 6/27/2024	DATE - 6/27/2024	REVISED -

STATE OF ILLINOIS  
DEPARTMENT OF TRANSPORTATION

FAP 312 (IL ROUTE 3)  
SUMMARY OF QUANTITIES

SCALE: 1"=1'-0" SHEET 2 OF SHEETS STA. 0+00.00 TO STA. 0+00.00

F.A.P. RTE.	SECTION	COUNTY	TOTAL SHEETS	SHEET NO.
312	(119-1)RS-3, (121.122)RS-5	RANDOLPH	33	4
CONTRACT NO. 76769				
ILLINOIS   FED. AID PROJECT				

MODEL: D:\18100\_01\18100\_02\FAP 312 (IL ROUTE 3)\SCHEDULE OF QUANTITIES\RESURFACING PAVEMENT MARKING SCHEDULE.dwg  
 FILE NAME: P:\2024\18100\_02\FAP 312 (IL ROUTE 3)\SCHEDULE OF QUANTITIES\RESURFACING PAVEMENT MARKING SCHEDULE.dwg

RESURFACING PAVEMENT MARKING SCHEDULE											
APPROXIMATE LOCATION		SHORT TERM PAVT MKING	SHRT TRM PAVT MK REM	THPL PVT MK LTR & SYM	THPL PVT MK LINE 6	THPL PVT MK LINE 24	PAVMT MRKG REM GRIND	PAVMT MRKG REM WTR BL	TMP PVT MK L&S PNT	TEMP PVT MK L 6 PNT	TEMP PVT MK L 24 PNT
STATION FROM	STATION TO	FOOT	SQ FT	SQ FT	FOOT	FOOT	SQ FT	SQ FT	SQ FT	FOOT	FOOT
<b>URBAN</b>											
10+40.0	163+45.0	5510	1837		30610					30610	
10+40.4	11+39.2	71	24		396					396	
10+45.0		168	56			21					21
11+39.2	13+00.0	58	19		322					322	
13+00.0	32+57.5	440	147		2447					2447	
32+57.5	35+10.6	91	30		506					506	
35+10.6	41+50.2	144	48		800					800	
41+50.2	44+77.1	15	5		82					82	
44+77.1	52+90.4	183	61		1017					1017	
52+90.4	67+46.0	524	175		2911					2911	
67+46.0	74+76.1	164	55		913					913	
76+36.2	88+41.5	271	90		1507					1507	
88+41.5	91+73.3	119	40		663					663	
91+73.3	99+90.4	184	61		1022					1022	
99+90.4	144+10.1	1591	530		8839					8839	
144+10.1	151+00.0	155	52		862					862	
151+00.0	155+55.6	164	55		911					911	
155+55.6	159+45.3	88	29		487					487	
159+07.0		104	35			13					13
159+30.0		0	76	61				61.0			
159+45.3	163+45.0	144	48		799					799	
159+56.0		104	35			13					13
163+27.8		100	33			13					13
<b>RURAL</b>											
167+43.0	557+12.1	14029	4676		77938					77938	
167+43.0	176+98.7	215	72		1195					1195	
176+98.7	193+00.0	72	24		400					400	
193+00.0	212+33.1	435	145		2416					2416	
212+33.2	216+40.2	147	49		814					814	
216+40.2	223+90.1	169	56		937					937	
223+90.1	225+45.5	56	19		311					311	
225+45.5	235+36.6	223	74		1239					1239	
235+36.6	242+17.8	31	10		170					170	
242+17.8	252+90.1	241	80		1340					1340	
252+90.1	257+80.3	176	59		980					980	
257+80.3	267+00.0	207	69		1150					1150	
267+00.0	273+58.2	30	10		165					165	
273+58.2	294+01.1	460	153		2554					2554	
294+01.1	296+00.0	9	3		50					50	
296+00.0	306+32.4	232	77		1290					1290	
306+32.4	317+10.1	388	129		2155					2155	
317+10.1	328+00.0	245	82		1362					1362	
328+00.0	381+00.0	239	80		1325					1325	
381+00.0	388+56.2	170	57		945					945	
388+56.2	391+28.8	12	4		68					68	
391+28.8	397+79.1	146	49		813					813	
397+79.1	403+79.8	27	9		150					150	
403+79.8	411+00.0	162	54		900					900	
411+00.0	415+00.0	18	6		100					100	
415+00.0	431+90.1	380	127		2113					2113	
431+90.1	450+75.7	679	226		3771					3771	
450+75.7	459+46.1	196	65		1088					1088	
459+46.1	465+46.1	27	9		150					150	
465+46.1	472+13.1	150	50		834					834	
472+13.1	494+31.8	799	266		4438					4438	
494+31.8	522+00.0	623	208		3460					3460	
522+00.0	527+00.0	23	8		125					125	
527+00.0	537+43.3	235	78		1304					1304	
537+43.3	539+68.9	81	27		451					451	
539+68.9	548+35.7	195	65		1083					1083	
548+35.7	551+00.0	95	32		529					529	
551+00.0	557+12.1	138	46		765					765	
<b>URBAN SUBTOTAL</b>		10393	3540	61	55093	60	25	25	61	55093	60
<b>RURAL SUBTOTAL</b>		21758	7253	0	120880	0	75	75	0	120880	0
<b>TOTAL</b>		32151	10793	61	175973	60	100	100	61	175973	60

RESURFACING SCHEDULE						
APPROXIMATE LOCATION		LENGTH	WIDTH	AREA	AGG WEDGE SHLD TYPE B	
STATION FROM	STATION TO	FOOT	FOOT	SQ YD	TON	
<b>URBAN</b>						
71+00	131+32	6032	3	2011	241.3	
<b>RURAL</b>						
197+62	207+59	997	3	332	39.9	
257+63	267+08	945	3	315	37.8	
273+34	304+83	3149	3	1050	126.0	
311+41	313+65	224	3	75	9.0	
320+17	325+91	574	3	191	23.0	
418+46	448+61	3015	3	1005	120.6	
172+59	196+62	2403	3	801	192.2	
210+69	212+82	213	3	71	17.0	
224+69	245+01	2032	3	677	162.6	
249+18	257+63	845	3	282	67.6	
267+08	273+34	626	3	209	50.1	
304+83	311+41	658	3	219	52.6	
325+91	380+20	5429	3	1810	434.3	
390+00	418+46	2846	3	949	227.7	
506+11	557+12	5101	3	1700	408.1	
<b>URBAN SUBTOTAL</b>					2011	241
<b>RURAL SUBTOTAL</b>					9686	1968
<b>TOTAL</b>					11696	2210

GUARDRAIL SCHEDULE					
APPROXIMATE LOCATION		GUARDRAIL REMOV	TR BAR TRM T1 SPL TAN	TR BAR TRM T1 SPL FLR	TERMINAL MARKER - DA
STATION FROM	NB / SB	FOOT	EACH	EACH	EACH
<b>URBAN</b>					
163+31.0					1
<b>RURAL</b>					
210+50.0	SB	50	1		1
213+00.0	NB				1
218+00.0	SB	50	1		1
260+25.0	SB	50	1		1
265+75.0	SB	50	1		1
364+25.0	SB	50	1		1
454+75.0	NB	50	1		1
490+00.0	SB	13	1		1
503+75.0	NB	50		1	1
<b>URBAN SUBTOTAL</b>					1
<b>RURAL SUBTOTAL</b>					9
<b>TOTAL</b>					10



USER NAME: joovarubbas	DESIGNED: MJR	REVISED: -
DRAWN: JC	CHECKED: ERO	REVISED: -
DATE: 9/10/2024		REVISED: -

**STATE OF ILLINOIS**  
**DEPARTMENT OF TRANSPORTATION**

<b>FAP 312 (IL ROUTE 3)</b>		F.A.P. R/E: 312	SECTION: (119-1)RS-3,(121,122)RS-5	COUNTY: RANDOLPH	TOTAL SHEETS: 33	SHEET NO.: 12
<b>SCHEDULE OF QUANTITIES</b>		CONTRACT NO. 76T69				
SCALE:	SHEET 6	OF 5 SHEETS	STA. 0+00.00	TO STA. 0+00.00	ILLINOIS   FEB. 2019 PROJECT	

REVISED 9-10-2024

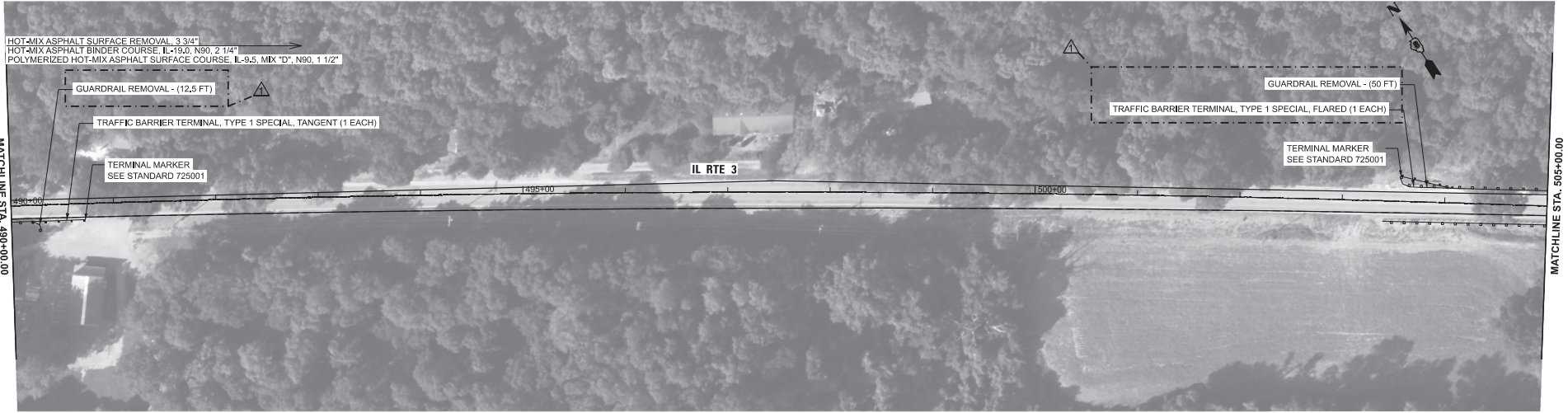

MODEL: D:\176169\_411\_116-017  
 FILE NAME: P:\2024\116-003\_PTB\_116-009\_P11\_IL\_RTE3\116-003\_PTB\_116-009\_P11\_IL\_RTE3.dwg



USER NAME = joovarubias	DESIGNED - MJR	REVISED -
DRAWN - JC	REVISED -	
PLOT SCALE = 0.16666633 / PL	CHECKED - ERO	REVISED -
PLOT DATE = 9/10/2024	DATE - 9/10/2024	REVISED -

**STATE OF ILLINOIS**  
**DEPARTMENT OF TRANSPORTATION**

**FAP 312 (IL ROUTE 3)**  
**ROADWAY PLAN**

SCALE: 1"=50'    SHEET 17    OF 19    SHEETS    STA. 490+00.00    TO STA. 520+00.00

F.A.P. RTE.	SECTION	COUNTY	TOTAL SHEETS	SHEET NO.
312	(119-1)RS-3, (121,122)RS-5	RANDOLPH	33	29
CONTRACT NO. 76769				
ILLINOIS   FED. AID PROJECT				

REVISED 9-10-2024

0 10 20 30 40 50 60 70 80 90 100 110 120 130 140 150 160 170 180 190 200 210 220 230 240 250 260 270 280 290 300 310 320 330 340 350 360 370 380 390 400 410 420 430 440 450 460 470 480 490 500 510 520 530 540 550 560 570 580 590 600 610 620 630 640 650 660 670 680 690 700 710 720 730 740 750 760 770 780 790 800 810 820 830 840 850 860 870 880 890 900 910 920 930 940 950 960 970 980 990 1000





MATCHLINE STA. 520+00.00

MATCHLINE STA. 535+00.00

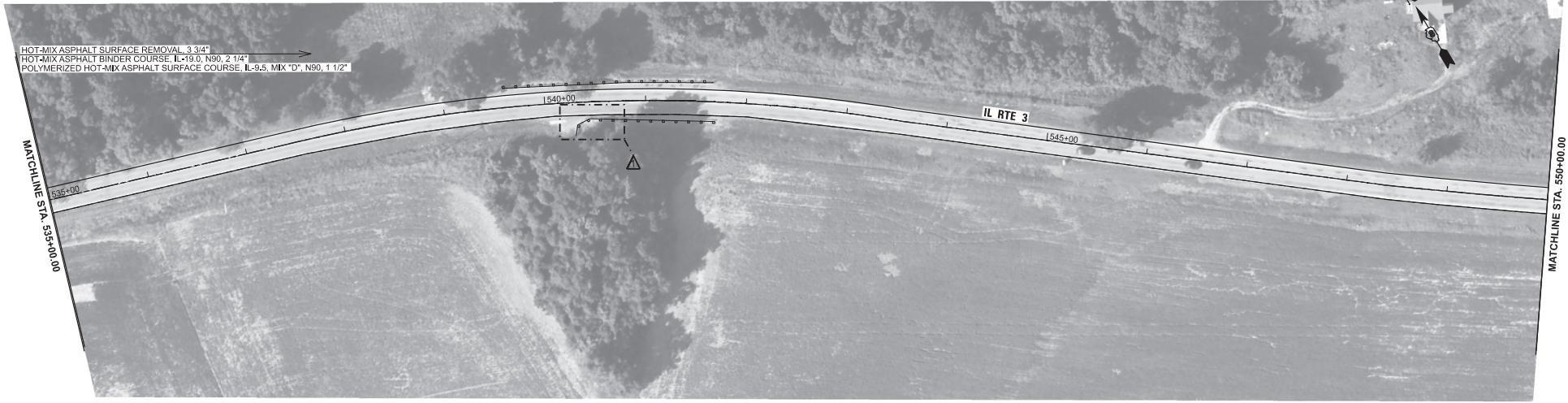

MATCHLINE STA. 535+00.00

MATCHLINE STA. 550+00.00

MODEL: D:\P18169\_A\A18-018  
FILE NAME: P:\2024\18169\_A000\_P18169-009\_P18169-010\18169-010.dwg

**REVIS** 9-10-2024



USER NAME	joovarubias	DESIGNED	MJR	REVISED	-
		DRAWN	JC	REVISED	-
PLOT SCALE	0.166666667 / PL	CHECKED	ERO	REVISED	-
PLOT DATE	9/10/2024	DATE	9/10/2024	REVISED	-

**STATE OF ILLINOIS  
DEPARTMENT OF TRANSPORTATION**

**FAP 312 (IL ROUTE 3)  
ROADWAY PLAN**

F.A.P. RTE.	SECTION	COUNTY	TOTAL SHEETS	SHEET NO.
312	(119-1)RS-3, (121,122)RS-5	RANDOLPH	33	30
CONTRACT NO. 76769				
ILLINOIS   FEB. 40 PROJECT				

SCALE: 1"=50'    SHEET 18 OF 19 SHEETS    STA. 520+00.00 TO STA. 550+00.00

8000102024 18169-009 P18169-010.dwg 9/10/2024 10:00:00 AM