

STATE OF ILLINOIS
DEPARTMENT OF TRANSPORTATION

F.A.P. RTE.	SECTION	COUNTY	TOTAL SHEETS	SHEET NO.
312	(119-1)RS-3,(121,122)RS-5	RANDOLPH	32	1
		ILLINOIS	CONTRACT NO. 76T69	

INDEX OF SHEETS

- 1 COVER
- 2 HIGHWAY STANDARDS, GENERAL NOTES & COMMITMENTS
- 3-4 SUMMARY OF QUANTITIES
- 5 LOCATION MAP
- 6-7 TYPICAL SECTIONS
- 8-12 SCHEDULE OF QUANTITIES
- 13-31 ROADWAY PLANS
- 32 CLASS B PATCHES (SPECIAL) DETAIL

PROPOSED
HIGHWAY PLANS

FAP ROUTE 312 (IL 3)
SECTION (119-1)RS-3,(121,122)RS-5

DESIGNED OVERLAY
RANDOLPH COUNTY

D-98-042-24



FUNCTIONAL CLASSIFICATION
OTHER PRINCIPAL ARTERIAL

TRAFFIC DATA

IL 3 - URBAN

2023 ADT = 3950 (ACTUAL)
2025 ADT = 4050 (ESTIMATED)
2045 ADT = 5000 (ESTIMATED)
SU = 10.6% MU = 11.4%

IL 3 - RURAL

2023 ADT = 3450 (ACTUAL)
2025 ADT = 3500 (ESTIMATED)
2045 ADT = 4400 (ESTIMATED)
SU = 5.2% MU = 34.8%

BEGIN IMPROVEMENT
STA 10 + 40
LAT: 2395643.222'
LONG: 453626.072'

C-98-104-24

OMISSION
STA 163 + 45 - 167 + 43
SN 079-0011

OMISSION
STA 557 + 11.6 TO
STA 558 + 58

END IMPROVEMENT
STA 558 + 58
LAT: 2439771.127'
LONG: 423033.223

LOCATION MAP
NOT TO SCALE

T7S

T8S

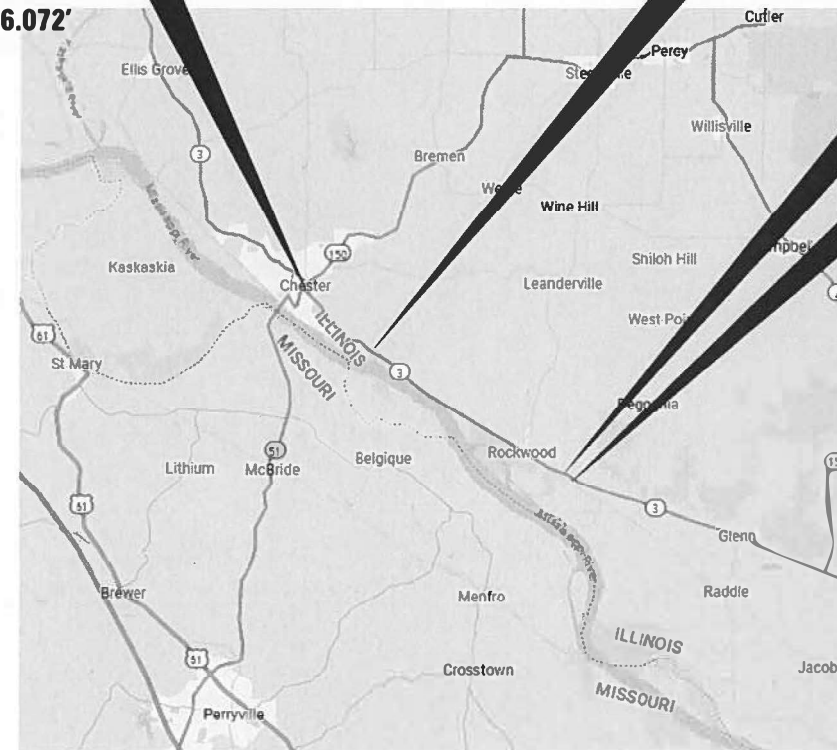

R7W R6W R5W

LOCATION MAP
NOT TO SCALE

GROSS LENGTH = 54,818 FT. = 10.382 MILE
NET LENGTH = 54,274 FT. = 10.279 MILE



FULL SIZE PLANS HAVE BEEN PREPARED USING STANDARD ENGINEERING SCALES. REDUCED SIZED PLANS WILL NOT CONFORM TO STANDARD SCALES. IN MAKING MEASUREMENTS ON REDUCED PLANS, THE ABOVE SCALES MAY BE USED.

J.U.L.I.E.
JOINT UTILITY LOCATION INFORMATION FOR EXCAVATION
1-800-892-0123
OR 811

PROJECT ENGINEER: ROBERT HARBAUGH
PROJECT MANAGER: CHERYL KEPLAR

CONTRACT NO. 76T69



Michael J. Rosborg
06/27/2024
Expires 11/30/25

STATE OF ILLINOIS
DEPARTMENT OF TRANSPORTATION

SUBMITTED July 12, 2024
[Signature]
REGIONAL ENGINEER

August 16, 2024
[Signature]
ENGINEER OF DESIGN AND ENVIRONMENT

August 16, 2024
[Signature]
DIRECTOR OF HIGHWAYS PROJECT IMPLEMENTATION

PRINTED BY THE AUTHORITY
OF THE STATE OF ILLINOIS

HIGHWAY STANDARDS

- 000001-08 STANDARD SYMBOLS, ABBREVIATIONS AND PATTERNS
- 001006 DECIMAL OF AN INCH AND OF A FOOT
- 420001-10 PAVEMENT JOINTS
- 420701-03 PAVEMENT WELDED WIRE REINFORCEMENT
- 442101-09 CLASS B PATCHES
- 630001-13 STEEL PLATE BEAM GUARDRAIL
- 630301-09 SHOULDER WIDENING FOR TYPE 1 (SPECIAL) GUARDRAIL TERMINALS
- 701006-05 OFF-RD OPERATIONS, 2L, 2W, 15' TO 24" FROM PAVEMENT EDGE
- 701011-04 OFF-RD MOVING OPERATIONS, 2L, 2W, DAY ONLY
- 701201-05 LANE CLOSURE, 2L, 2W, DAY ONLY, FOR SPEED >=45 MPH
- 701206-05 LANE CLOSURE, 2L, 2W, NIGHT ONLY, FOR SPEEDS >= 45MPH
- 701301-04 LANE CLOSURE, 2L, 2W, SHORT TIME OPERATIONS
- 701306-04 LANE CLOSURE, 2L, 2W, SLOW MOVING OPERATIONS DAY ONLY, FOR SPEED >=45 MPH
- 701311-03 LANE CLOSURE, 2L, 2W, MOVING OPERATIONS - DAY ONLY
- 701336-07 LANE CLOSURE, 2L, 2W, WORK AREAS IN SERIES, FOR SPEED >= 45 MPH
- 701501-06 URBAN LANE CLOSURE, 2L, 2W, UNDIVIDED
- 701901-09 TRAFFIC CONTROL DEVICES
- 725001-01 OBJECT AND TERMINAL MARKERS
- 780001-05 TYPICAL PAVEMENT MARKINGS
- 781001-04 TYPICAL APPLICATIONS RAISED REFLECTIVE PAVEMENT MARKERS
- 782006-01 GUARDRAIL AND BARRIER WALL REFLECTOR MOUNTING DETAILS

GENERAL NOTES

1. ILLINOIS STATE LAW REQUIRES A 48-HOUR NOTICE TO BE GIVEN TO UTILITIES BEFORE DIGGING. FIELD MARKING OF FACILITIES MAY BE OBTAINED BY CONTACTING J.U.L.I.E. (PHONE 800-892-0123 OR 811) OR FOR NON-MEMBERS, THE UTILITY COMPANY DIRECTLY. UTILITIES KNOWN TO HAVE FACILITIES WITHIN THE PROJECT AREA:

	AERIAL	BURIED
* AMEREN ILLINOIS (ELECTRIC)	X	X
* CITY OF CHESTER (WATER)		X
* CITY OF CHESTER (SEWER)		X
* CITY OF CHESTER (GAS)		X
* CLEARWAVE FIBER LLC (COMMUNICATIONS)	X	X
* EGYPTIAN ELECTRIC COOPERATIVE ASSOCIATION (ELECTRIC)	X	X
* EGYPTIAN TELEPHONE COOPERATIVE ASSOCIATION (COMMUNICATIONS)	X	X
* FRONTIER COMMUNICATIONS (COMMUNICATIONS)	X	X
* VILLAGE OF GORHAM (WATER)		X
* VILLAGE OF GORHAM (SEWER)		X
* NEWWAVE COMMUNICATIONS (CABLE TV)	X	X
* SUNOCO LOGISTICS (PIPELINE)		X
* WINDSTREAM KDL, INC. (COMMUNICATIONS)	X	X

MEMBERS OF J.U.L.I.E. CALL TOLL FREE (800) 892-0123 OR 811 ARE INDICATED BY *. NON-J.U.L.I.E. MEMBERS MUST BE NOTIFIED INDIVIDUALLY.
2. THE CONTRACTOR AND THE ENGINEER SHALL BE AWARE THAT NO SURVEY WAS PERFORMED FOR THIS PROJECT. THE STATIONING, TOPOGRAPHY, AND QUANTITIES SHOWN IN THE PLANS WERE CREATED USING MICROFILM AND FIELD MEASUREMENTS. ALL SHALL BE ASSUMED TO BE APPROXIMATE. THE CONTRACTOR SHALL VERIFY DIMENSIONS AND CONDITIONS IN THE FIELD PRIOR TO CONSTRUCTION AND ORDERING OF MATERIALS.
3. THE CONTRACTOR SHALL PROVIDE POSITIVE AND ADEQUATE DRAINAGE AT ALL TIMES.
4. THE THICKNESS OF HOT-MIX-ASPHALT SURFACE MIXTURES SHOWN ON THE PLANS IS THE NOMINAL THICKNESS. DEVIATIONS MAY OCCUR DUE TO IRREGULARITIES IN THE EXISTING SURFACE OR BASE ON WHICH THE BITUMINOUS MIXTURE IS PLACED.
5. "ROAD CONSTRUCTION AHEAD" SIGNS SHALL BE PLACED AT EACH END OF THE PROJECT PLUS THE INTERSECTING SIDEROADS, AND WILL BE CONSIDERED INCLUDED IN THE TRAFFIC CONTROL PAY ITEMS. ALL CONSTRUCTION SIGNS SHALL BE FLUORESCENT ORANGE.
6. ONLY SHORT TERM PAVEMENT MARKING REMOVAL FROM THE FINAL SURFACE SHALL BE PAID FOR AS "SHORT TERM PAVEMENT MARKING REMOVAL".
7. THE PROPOSED PAVEMENT MARKING SHALL MATCH THE LOCATIONS OF THE EXISTING PAVEMENT MARKING, AS DIRECTED BY THE ENGINEER.
8. THE USE OF A MATERIAL TRANSFER DEVICE SHALL BE PERMITTED FOR THE PAVING OPERATIONS OF THIS PROJECT. HOWEVER, THE MATERIAL TRANSFER DEVICE SHALL BE EMPTY WHEN PASSING OVER THE FOLLOWING STRUCTURE:
SN 079-0100 (MARY'S RIVER BRIDGE).
9. ALL MILLED AREAS SHALL BE RESURFACED WITH THE BINDER COURSE PRIOR TO OPENING THE LANE TO TRAFFIC.
10. SEE ATTACHED DETAIL BD-32 FOR TEMPORARY RAMPS AND BUTT JOINTS.
11. ALL TURF AREAS DISTURBED BY THE CONTRACTOR SHALL BE SEEDED WITH THE APPROPRIATE EROSION CONTROL AS DIRECTED BY THE ENGINEER AT THE COST OF THE CONTRACTOR.
12. MATERIAL TRANSFER DEVICE (MTD) CAN OPERATE IN AN UNLOADED CONDITION ON SN 079-2424, SN 079-2425, SN 079-2426, SN 079-2427, SN 079-2428, SN 79-0012, SN 079-2429, SN 079-2430, SN 079-2431, AND SN 079-243 WITH A MAXIMUM GROSS WEIGHT OF 40 TONS.

MIXTURE REQUIREMENTS

THE FOLLOWING MIXTURE REQUIREMENTS ARE APPLICABLE FOR THIS PROJECT:

LOCATION AND MIXTURE USE(S):	IL 3	
	POLY SURFACE	BINDER
PG:	SBS PG 70-28	PG 64-22
DESIGN AIR VOIDS:	4.0% @ Ndes = 90	4.0% @ Ndes = 90
MIXTURE COMPOSITION:	IL 9.5	IL 19.0
FRICTION AGGREGATE:	MIXTURE "D"	MIXTURE "B"
MIXTURE WEIGHT:	112 lb/sy/in	112 lb/sy/in
QUALITY MANAGEMENT PROGRAM:	QCP	QCP
SUBLOT SIZE:	1000	1000
MATERIAL TRANSFER DEVICE	YES	YES

COMMITMENTS

THE RESIDENT ENGINEER SHALL NOTIFY THE FOLLOWING ENTITIES AT LEAST 2 WEEKS PRIOR TO ANY LANE CLOSURES AND/OR CONSTRUCTION ACTIVITIES FOR THIS PROJECT.
 * CITY OF CHESTER; MAYOR TOM PAGE AT (618) 826-5114
 * NIGHT HAWK COAL; (618) 426-3662

REV - MS

MODEL: D:\XXXX-ent-gennotes
 FILE NAME: P:\2024\ME24003_PTB_156-059 PH HI_Hutchinson\W008_IL_3101-CADD\02-Shis\08\76T69-shi-gennotes.dgn

	USER NAME = jcovarrubias	DESIGNED - MJR	REVISED -	STATE OF ILLINOIS DEPARTMENT OF TRANSPORTATION	HIGHWAY STANDARDS, GENERAL NOTES & COMMITMENTS	F.A.P RTE.	SECTION	COUNTY	TOTAL SHEETS	SHEET NO		
	PLOT SCALE = 0.166666 1/in.	CHECKED - ERO	REVISED -			312	(119-1)RS-3,(121,122)RS-5	RANDOLPH	33	2		
	PLOT DATE = 6/27/2024	DATE - 6/27/2024	REVISED -			CONTRACT NO. 76T69						
						SCALE:	SHEET 1	OF 1	SHEETS	STA. 0+00.00	TO STA. 0+00.00	ILLINOIS FED. AID PROJECT

CODE NO.	ITEM	UNIT	TOTAL QUANTITY	CONSTRUCTION CODE	
				100% STATE ROADWAY	100% STATE ROADWAY
				0005 URBAN	0005 RURAL
20200100	EARTH EXCAVATION	CU YD	1113	532	581
21001000	GEOTECHNICAL FABRIC FOR GROUND STABILIZATION	SQ YD	6679	3191	3488
31101400	SUBBASE GRANULAR MATERIAL, TYPE B 6"	SQ YD	6679	3191	3488
40600290	BITUMINOUS MATERIALS (TACK COAT)	POUND	66771	19215	47556
40600295	POLYMERIZED BITUMINOUS MATERIALS (TACK COAT)	POUND	33385	9607	23778
40600370	LONGITUDINAL JOINT SEALANT	FOOT	54234	15265	38969
40600990	TEMPORARY RAMP	SQ YD	199	127	72
40603090	HOT-MIX ASPHALT BINDER COURSE, IL-19.0, N90	TON	18696	5380	13316
40604164	POLYMERIZED HOT-MIX ASPHALT SURFACE COURSE, IL-9.5, MIX "D", N90	TON	12464	3587	8877
44000164	HOT-MIX ASPHALT SURFACE REMOVAL, 3 3/4"	SQ YD	148379	42699	105680
44200050	WELDED WIRE REINFORCEMENT	SQ YD	6679	3191	3488
44201298	DOWEL BARS 1 1/4"	EACH	3979	2622	1357
44213200	SAW CUTS	FOOT	22190	11899	10291
44213204	TIE BARS 3/4"	EACH	1257	518	739
48102100	AGGREGATE WEDGE SHOULDER, TYPE B	TON	2209	241	1968
63100167	TRAFFIC BARRIER TERMINAL, TYPE 1 (SPECIAL) TANGENT	EACH	10		10
63200310	GUARDRAIL REMOVAL	FOOT	524		524
67000400	ENGINEER'S FIELD OFFICE, TYPE A	CAL MO	6	2	4
67100100	MOBILIZATION	L SUM	1	0.5	0.5
70100450	TRAFFIC CONTROL AND PROTECTION, STANDARD 701201	L SUM	1	0.5	0.5
70100455	TRAFFIC CONTROL AND PROTECTION, STANDARD 701206	L SUM	1	0.5	0.5
70100460	TRAFFIC CONTROL AND PROTECTION, STANDARD 701306	L SUM	1	0.5	0.5
70100600	TRAFFIC CONTROL AND PROTECTION, STANDARD 701336	L SUM	1	0.5	0.5
70102620	TRAFFIC CONTROL AND PROTECTION, STANDARD 701501	L SUM	1	1	
70103815	TRAFFIC CONTROL SURVEILLANCE	CAL DA	240	60	180
70107025	CHANGEABLE MESSAGE SIGN	CAL DA	240	60	180
70200100	NIGHTTIME WORK ZONE LIGHTING	L SUM	1	0.5	0.5
70300100	SHORT TERM PAVEMENT MARKING	FOOT	32,151	10393	21758
70300150	SHORT TERM PAVEMENT MARKING REMOVAL	SQ FT	10,793	3,540	7,253
70300211	TEMPORARY PAVEMENT MARKING LETTERS AND SYMBOLS - PAINT	SQ FT	61	61	

REV - MS

MODEL: D:\xoc\sh-soc-001
FILE NAME: P:\2024\ME24003_PTB_196-059 PH 1-11_Hutchison\W008_IL_3101-CADD\02-Sha\0876189-shr-SOC-001.dgn



USER NAME = jcovarrubias
PLOT SCALE = 0.16666633' / in.
PLOT DATE = 6/27/2024

DESIGNED - MJR
DRAWN - JC
CHECKED - ERO
DATE - 6/27/2024

REVISED -
REVISED -
REVISED -
REVISED -

STATE OF ILLINOIS
DEPARTMENT OF TRANSPORTATION

FAP 312 (IL ROUTE 3)
SUMMARY OF QUANTITIES

SCALE: 1"=1'-0" SHEET 1 OF SHEETS STA. 0+00.00 TO STA. 0+75.19

F.A.P. RTE.	SECTION	COUNTY	TOTAL SHEETS	SHEET NO.
312	(119-1)RS-3, (121,122)RS-5	RANDOLPH	33	3
CONTRACT NO. 76T69				
ILLINOIS FED. AID PROJECT				

CODE NO.	ITEM	UNIT	TOTAL QUANTITY	CONSTRUCTION CODE	
				100% STATE ROADWAY	100% STATE ROADWAY
				0005 URBAN	0005 RURAL
70300241	TEMPORARY PAVEMENT MARKING - LINE 6"- PAINT	FOOT	175,973	55093	120880
70300281	TEMPORARY PAVEMENT MARKING - LINE 24"- PAINT	FOOT	60	60	
* 72501000	TERMINAL MARKER - DIRECT APPLIED	EACH	12	1	11
* 78000100	THERMOPLASTIC PAVEMENT MARKING - LETTERS AND SYMBOLS	SQ FT	61	61	
* 78000400	THERMOPLASTIC PAVEMENT MARKING - LINE 6"	FOOT	175,973	55093	120880
* 78000650	THERMOPLASTIC PAVEMENT MARKING - LINE 24"	FOOT	60	60	
* 78100100	RAISED REFLECTIVE PAVEMENT MARKER	EACH	713	219	494
78300200	RAISED REFLECTIVE PAVEMENT MARKER REMOVAL	EACH	713	219	494
78300201	PAVEMENT MARKING REMOVAL - GRINDING	SQ FT	100	25	75
78300202	PAVEMENT MARKING REMOVAL - WATER BLASTING	SQ FT	100	25	75
X0327487	TRIAxIAL GEOGRID REINFORCEMENT, TYPE I	SQ YD	6679	3191	3488
X4421017	CLASS B PATCHES, TYPE II, 12 INCH (SPECIAL)	SQ YD	757	509	248
X4421019	CLASS B PATCHES, TYPE III, 12 INCH, (SPECIAL)	SQ YD	893	612	281
X4421021	CLASS B PATCHES, TYPE IV, 12 INCH, (SPECIAL)	SQ YD	5029	2070	2959
Z0034105	MATERIAL TRANSFER DEVICE	TON	31160	8967	22193
Z0048665	RAILROAD PROTECTIVE LIABILITY INSURANCE	L SUM	1	0.5	0.5
Ø Z0076604	TRAINEES TRAINING PROGRAM GRADUATE	HOUR	2500	2500	

* SPECIALTY ITEM Ø 0042

REV - MS

MODEL: D:\cadd\h-soc-002
FILE NAME: P:\2024\ME24003_PTB_196-059_P1 I-1 - Hutchison\W008_IL_3101-CADD\02-Sha\0876T69-sht-SOC-002.dgn



USER NAME = jcovarrubias	DESIGNED - MJR	REVISED -
	DRAWN - JC	REVISED -
PLOT SCALE = 0.16666633 / in.	CHECKED - ERO	REVISED -
PLOT DATE = 6/27/2024	DATE - 6/27/2024	REVISED -

**STATE OF ILLINOIS
DEPARTMENT OF TRANSPORTATION**

**FAP 312 (IL ROUTE 3)
SUMMARY OF QUANTITIES**

SCALE: 1"=1'-0" SHEET 2 OF SHEETS STA. 0+00.00 TO STA. 0+00.00

F.A.P. RTE.	SECTION	COUNTY	TOTAL SHEETS	SHEET NO.
312	(119-1)RS-3, (121,122)RS-5	RANDOLPH	33	4
CONTRACT NO. 76T69				
ILLINOIS FED. AID PROJECT				

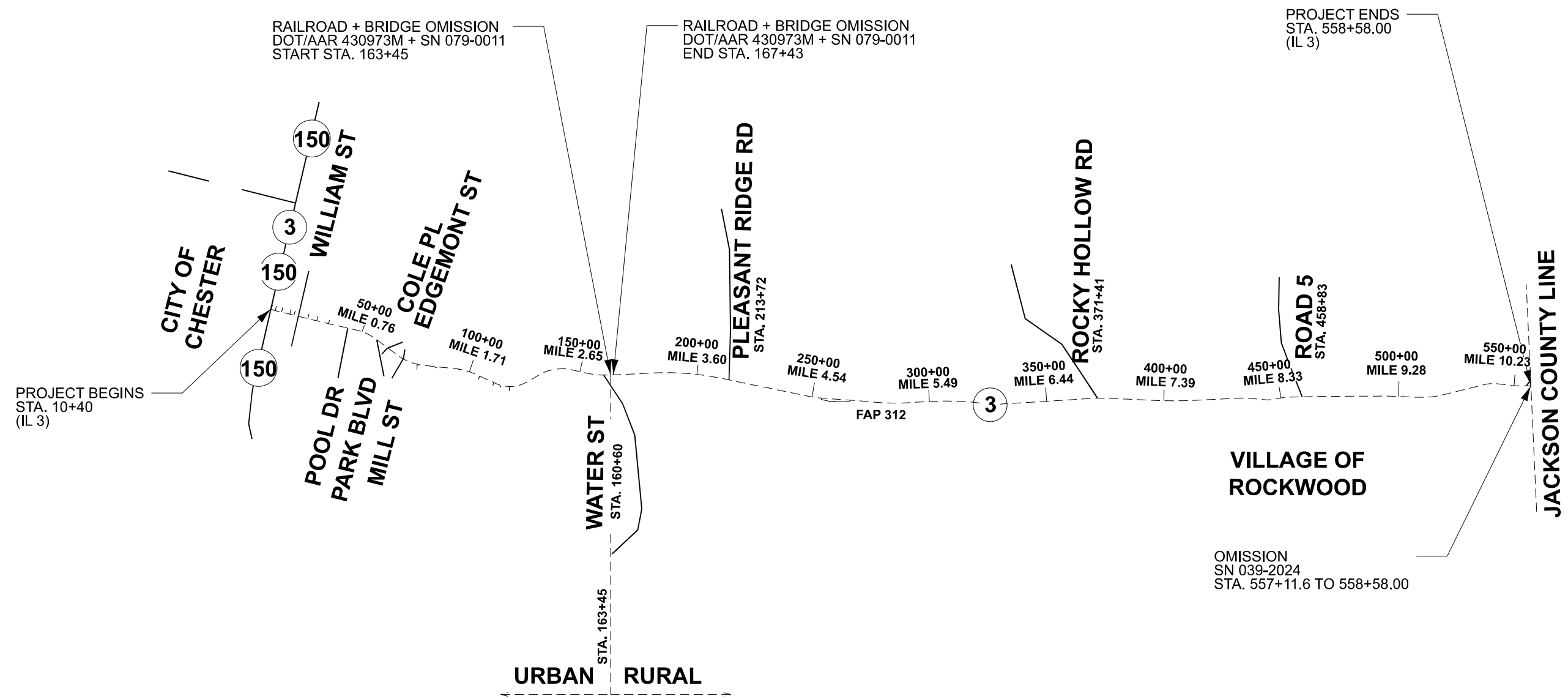
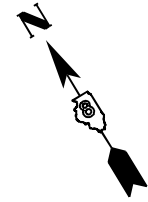

OMISSION
SN 039-2024
STA. 557+11.6 TO 558+58.00

NOT TO SCALE

MODEL: D8XXXXX-shd-Line Diagram
FILE NAME: P:\2024\11E24003_PTB_196-059 PH 1-11_Hutchison\W008_IL_3\01-CADD\02-Shd\0876169-shd-Line Diagram.dgn



USER NAME = jcovarrubias	DESIGNED - MJR	REVISED -
	DRAWN - JC	REVISED -
PLOT SCALE = 0.166666' / in.	CHECKED - ERO	REVISED -
PLOT DATE = 6/27/2024	DATE - 6/27/2024	REVISED -

**STATE OF ILLINOIS
DEPARTMENT OF TRANSPORTATION**

**FAP 312 (IL ROUTE 3)
LOCATION MAP**

SCALE: N/A SHEET 1 OF 1 SHEETS STA. 10+40 TO STA. 558+58

F.A.P. RTE.	SECTION	COUNTY	TOTAL SHEETS	SHEET NO.
312	(119-1)RS-3,(121,122)RS-5	RANHOLPH	33	5
CONTRACT NO. 76T69				

ILLINOIS FED. AID PROJECT

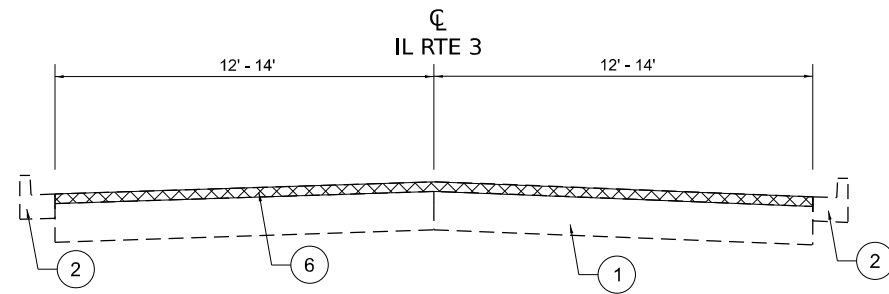

EXISTING TYPICAL SECTION

IL RTE 3

STA. 10+00 TO STA. 26+00

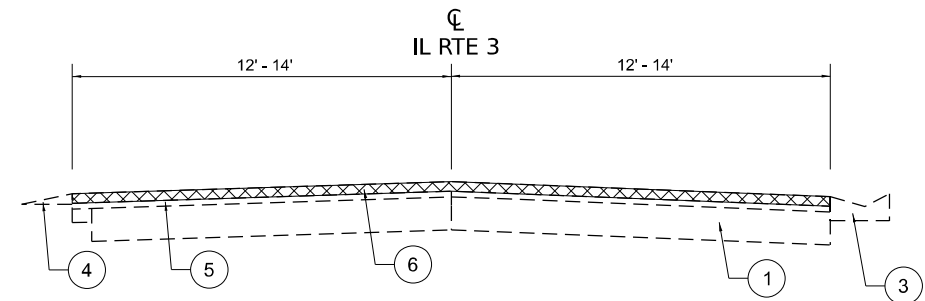

EXISTING TYPICAL SECTION

IL RTE 3

STA. 71+00 TO STA. 131+32
 STA. 197+62 TO STA. 207+59
 STA. 257+63 TO STA. 267+08
 STA. 273+34 TO STA. 304+83
 STA. 311+41 TO STA. 313+65
 STA. 320+17 TO STA. 325+91
 STA. 418+46 TO STA. 448+61

OMISSIONS

STA. 163+45 TO STA. 167+43

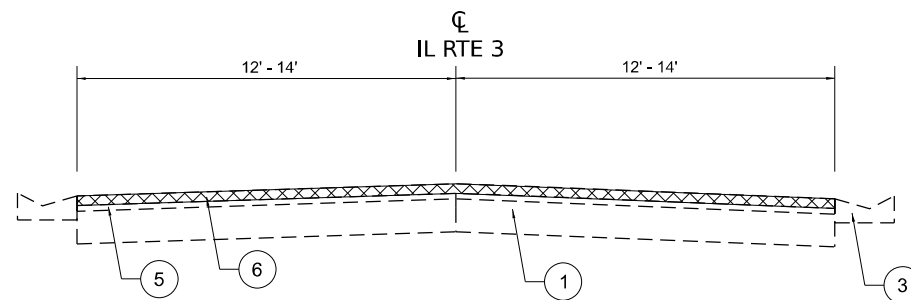

EXISTING TYPICAL SECTION

IL RTE 3

STA. 26+00 TO STA. 71+00
 STA. 131+32 TO STA. 163+45
 STA. 207+59 TO STA. 210+69
 STA. 212+82 TO STA. 224+69
 STA. 245+01 TO STA. 249+18
 STA. 313+65 TO STA. 320+17
 STA. 380+20 TO STA. 390+00
 STA. 448+61 TO STA. 506+11

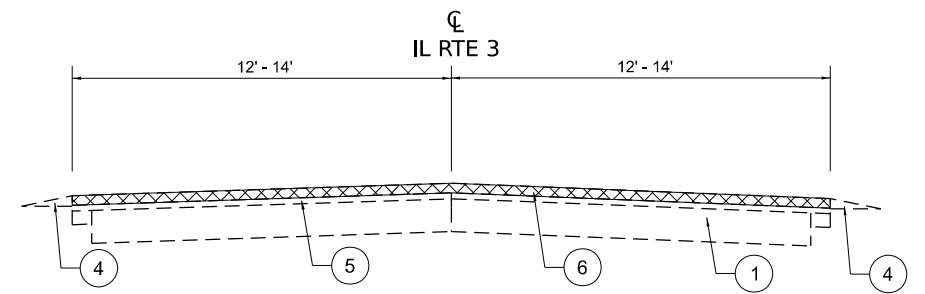

EXISTING TYPICAL SECTION

IL RTE 3

STA. 172+59 TO STA. 196+62
 STA. 210+69 TO STA. 212+82
 STA. 224+69 TO STA. 245+01
 STA. 249+18 TO STA. 257+63
 STA. 267+08 TO STA. 273+34
 STA. 304+83 TO STA. 311+41
 STA. 325+91 TO STA. 380+20
 STA. 390+00 TO STA. 418+46
 STA. 506+11 TO STA. 557+12

LEGEND

- ① EXISTING PAVEMENT (5.75"-9.75")
- ② EXISTING CURB AND GUTTER
- ③ EXISTING GUTTER
- ④ EXISTING AGGREGATE WEDGE SHOULDERS
- ⑤ EXISTING OVERLAY (4.25" - 17")
- ⑥ PROPOSED HOT-MIX ASPHALT SURFACE REMOVAL, 3 3/4"

NOTES:

- 1. PATCHES SHALL BE MILLED
- 2. ALL MILLED AREAS SHALL BE RESURFACED WITH THE BINDER COURSE PRIOR TO OPENING THE LANE TO TRAFFIC.

MODEL: D:\xxxx\11-3-24\11-3-24.dwg FILE NAME: P:\2024\11-3-24\11-3-24.dwg

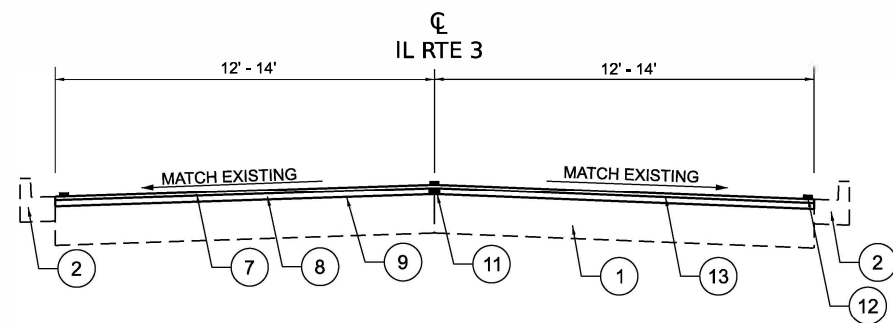

PROPOSED TYPICAL SECTION
IL RTE 3
STA. 10+00 TO STA. 26+00

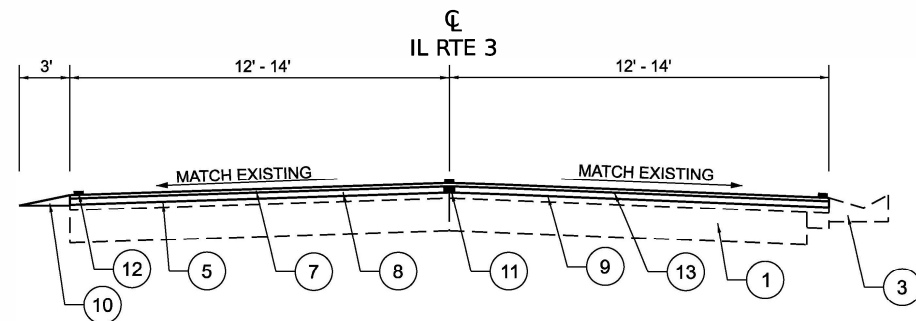

PROPOSED TYPICAL SECTION
IL RTE 3
STA. 71+00 TO STA. 131+32
STA. 197+62 TO STA. 207+59
STA. 257+63 TO STA. 267+08
STA. 273+34 TO STA. 304+83
STA. 311+41 TO STA. 313+65
STA. 320+17 TO STA. 325+91
STA. 418+46 TO STA. 448+61

OMISSIONS

STA. 163+45 TO STA. 167+43

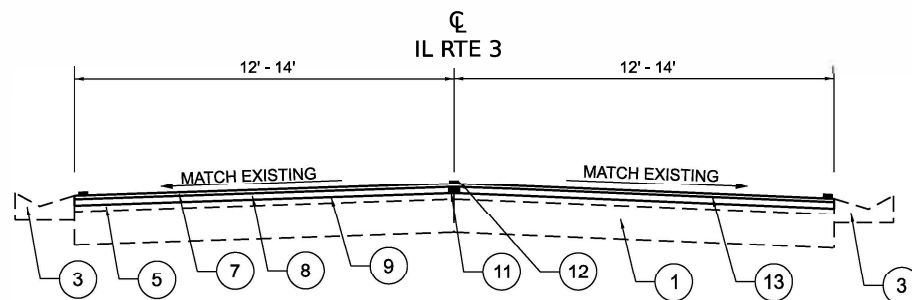

PROPOSED TYPICAL SECTION
IL RTE 3
STA. 26+00 TO STA. 71+00
STA. 131+32 TO STA. 163+45
STA. 207+59 TO STA. 210+69
STA. 212+82 TO STA. 224+69
STA. 245+01 TO STA. 249+18
STA. 313+65 TO STA. 320+17
STA. 380+20 TO STA. 390+00
STA. 448+61 TO STA. 506+11

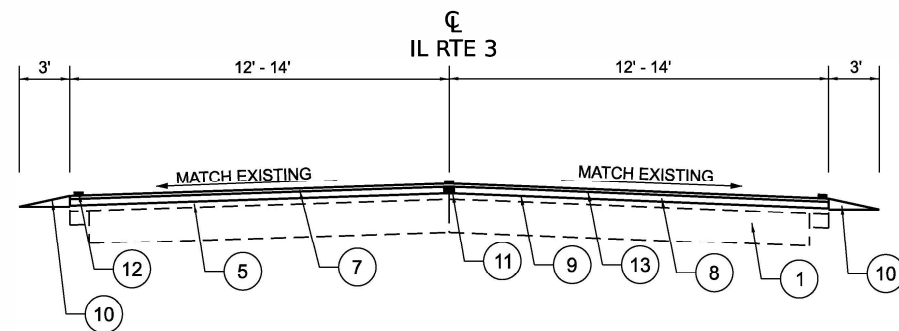

PROPOSED TYPICAL SECTION
IL RTE 3
STA. 172+59 TO STA. 196+62
STA. 210+69 TO STA. 212+82
STA. 224+69 TO STA. 245+01
STA. 249+18 TO STA. 257+63
STA. 267+08 TO STA. 273+34
STA. 304+83 TO STA. 311+41
STA. 325+91 TO STA. 380+20
STA. 390+00 TO STA. 418+46
STA. 506+11 TO STA. 557+12

LEGEND

- ① EXISTING PAVEMENT (5.75"-9.75")
- ② EXISTING CURB AND GUTTER
- ③ EXISTING GUTTER
- ④ EXISTING AGGREGATE WEDGE SHOULDERS
- ⑤ EXISTING OVERLAY (4.25" - 17")
- ⑥ PROPOSED HOT-MIX ASPHALT SURFACE REMOVAL, 3 3/4"
- ⑦ PROPOSED POLYMERIZED HOT-MIX ASPHALT SURFACE COURSE, IL-9.5, MIX "D", N90, 1 1/2"
- ⑧ PROPOSED HOT-MIX ASPHALT BINDER COURSE, IL-19.0, N90, 2 1/4"
- ⑨ PROPOSED BITUMINOUS MATERIALS (TACK COAT)
- ⑩ PROPOSED AGGREGATE WEDGE SHOULDERS, TYPE B
- ⑪ PROPOSED LONGITUDINAL JOINT SEALANT
- ⑫ PROPOSED PAVEMENT MARKING
- ⑬ PROPOSED POLYMERIZED BITUMINOUS MATERIALS (TACK COAT)

NOTES:

- 1. PATCHES SHALL BE MILLED
- 2. ALL MILLED AREAS SHALL BE RESURFACED WITH THE BINDER COURSE PRIOR TO OPENING THE LANE TO TRAFFIC.

REV - MS

MODEL: D:\xxxx\shh\pwr\... FILE NAME: P:\2024\11\24\11\24\003_PTB_196-059_PH_1-11_Hutchinson\W008_IL_3101-CADD\02-Shh\0876169-shh-tpw-pr.dgn



USER NAME = jcovarrubias	DESIGNED - MJR	REVISED -
	DRAWN - JC	REVISED -
PLOT SCALE = 0.1666663 3' / 1"	CHECKED - ERO	REVISED -
PLOT DATE = 6/27/2024	DATE - 6/27/2024	REVISED -

STATE OF ILLINOIS
DEPARTMENT OF TRANSPORTATION

FAP 312 (IL ROUTE 3)			
TYPICAL SECTIONS - PROPOSED			
SCALE:	SHEET 1	OF SHEETS	TO STA. 0+00.00

F.A.P. RTE.	SECTION	COUNTY	TOTAL SHEETS	SHEET NO.
312	(119-1)RS-3,(121,122)RS-5	RANDOLPH	33	7
CONTRACT NO. 76T69				
ILLINOIS FED. AID PROJECT				

CLASS B PATCHES (SPECIAL) SCHEDULE

PATCH #	SB / NB	STATION	MILE	LENGTH (FT)	WIDTH (FT)	AREA (SQ YD)	CLASS B PATCH TYPE II, 12" SPECIAL (SQ YD)	CLASS B PATCH TYPE III, 12" SPECIAL (SQ YD)	CLASS B PATCH TYPE IV, 12" SPECIAL (SQ YD)	EARTH EXCAVATION (CU YD)	GEOTECH FAB F/GR STAB (SQ YD)	TRI GEOGRID REINF T1 (SQ YD)	SUB GRAN MAT B 6 (SQ YD)	WELDED WIRE REINFORCEMENT (SQ YD)	DOWEL BARS 1-1/4"	TIE BARS 3/4"	SAW CUTS (FT)
URBAN																	
1	SB	25+84	0.3	15	12	20.0		20.0		3.3	20.0	20.0	20.0	20.0	20		81
2	SB	25+84	0.3	8	12	10.7	10.7			1.8	10.7	10.7	10.7	10.7	20		60
3	SB	31+12	0.4	6	12	8.0	8.0			1.3	8.0	8.0	8.0	8.0	20		54
4	SB	31+12	0.4	30	12	40.0		40.0		6.7	40.0	40.0	40.0	40.0	20	10	126
5	SB	36+40	0.5	8	12	10.7	10.7			1.8	10.7	10.7	10.7	10.7	20		60
6	SB	41+68	0.6	6	12	8.0	8.0			1.3	8.0	8.0	8.0	8.0	20		54
7	SB	46+96	0.7	6	12	8.0	8.0			1.3	8.0	8.0	8.0	8.0	20		54
8	SB	46+96	0.7	6	12	8.0	8.0			1.3	8.0	8.0	8.0	8.0	20		54
9	SB	52+24	0.8	8	12	10.7	10.7			1.8	10.7	10.7	10.7	10.7	20		60
10	SB	52+24	0.8	8	12	10.7	10.7			1.8	10.7	10.7	10.7	10.7	20		60
11	SB	57+52	0.9	6	12	8.0	8.0			1.3	8.0	8.0	8.0	8.0	20		54
12	SB	57+52	0.9	6	12	8.0	8.0			1.3	8.0	8.0	8.0	8.0	20		54
13	SB	62+80	1.0	6	12	8.0	8.0			1.3	8.0	8.0	8.0	8.0	20		54
14	SB	62+80	1.0	6	12	8.0	8.0			1.3	8.0	8.0	8.0	8.0	20		54
15	SB	73+36	1.2	6	12	8.0	8.0			1.3	8.0	8.0	8.0	8.0	20		54
16	SB	78+64	1.3	10	12	13.3	13.3			2.2	13.3	13.3	13.3	13.3	20		66
17	SB	78+64	1.3	6	12	8.0	8.0			1.3	8.0	8.0	8.0	8.0	20		54
18	SB	78+64	1.3	15	12	20.0		20.0		3.3	20.0	20.0	20.0	20.0	20		81
19	SB	78+64	1.3	10	12	13.3	13.3			2.2	13.3	13.3	13.3	13.3	20		66
20	SB	83+92	1.4	20	12	26.7		26.7		4.4	26.7	26.7	26.7	26.7	20	7	96
21	SB	83+92	1.4	10	12	13.3	13.3			2.2	13.3	13.3	13.3	13.3	20		66
22	SB	83+92	1.4	12	12	16.0		16.0		2.7	16.0	16.0	16.0	16.0	20		72
23	SB	89+20	1.5	8	12	10.7	10.7			1.8	10.7	10.7	10.7	10.7	20		60
24	SB	94+48	1.6	30	12	40.0		40.0		6.7	40.0	40.0	40.0	40.0	20	10	126
25	SB	99+76	1.7	10	12	13.3	13.3			2.2	13.3	13.3	13.3	13.3	20		66
26	SB	105+04	1.8	8	12	10.7	10.7			1.8	10.7	10.7	10.7	10.7	20		60
27	SB	105+04	1.8	12	12	16.0		16.0		2.7	16.0	16.0	16.0	16.0	20		72
28	SB	105+04	1.8	20	12	26.7		26.7		4.4	26.7	26.7	26.7	26.7	20	7	96
29	SB	105+04	1.8	15	12	20.0		20.0		3.3	20.0	20.0	20.0	20.0	20		81
30	SB	110+32	1.9	10	12	13.3	13.3			2.2	13.3	13.3	13.3	13.3	20		66
31	SB	110+32	1.9	20	12	26.7		26.7		4.4	26.7	26.7	26.7	26.7	20	7	96
32	SB	110+32	1.9	10	12	13.3	13.3			2.2	13.3	13.3	13.3	13.3	20		66
33	SB	115+60	2.0	15	12	20.0		20.0		3.3	20.0	20.0	20.0	20.0	20		81
34	SB	120+88	2.1	12	12	16.0		16.0		2.7	16.0	16.0	16.0	16.0	20		72
35	SB	126+16	2.2	20	12	26.7		26.7		4.4	26.7	26.7	26.7	26.7	20	7	96
36	SB	126+16	2.2	30	12	40.0		40.0		6.7	40.0	40.0	40.0	40.0	20	10	126
37	SB	131+44	2.3	30	12	40.0		40.0		6.7	40.0	40.0	40.0	40.0	20	10	126
38	SB	131+44	2.3	20	12	26.7		26.7		4.4	26.7	26.7	26.7	26.7	20	7	96
39	SB	131+44	2.3	45	12	60.0		60.0		10.0	60.0	60.0	60.0	60.0	20	15	171
40	SB	131+44	2.3	20	12	26.7		26.7		4.4	26.7	26.7	26.7	26.7	20	7	96
41	SB	131+44	2.3	20	12	26.7		26.7		4.4	26.7	26.7	26.7	26.7	20	7	96
42	SB	131+44	2.3	60	12	80.0		80.0		13.3	80.0	80.0	80.0	80.0	20	20	216
43	SB	136+72	2.4	40	12	53.3		53.3		8.9	53.3	53.3	53.3	53.3	20	13	156
44	SB	136+72	2.4	30	12	40.0		40.0		6.7	40.0	40.0	40.0	40.0	20	10	126
45	SB	136+72	2.4	25	12	33.3		33.3		5.6	33.3	33.3	33.3	33.3	20	8	111
46	SB	136+72	2.4	20	12	26.7		26.7		4.4	26.7	26.7	26.7	26.7	20	7	96
47	SB	136+72	2.4	45	12	60.0		60.0		10.0	60.0	60.0	60.0	60.0	20	15	171
48	SB	142+00	2.5	15	12	20.0		20.0		3.3	20.0	20.0	20.0	20.0	20		81
49	SB	142+00	2.5	15	12	20.0		20.0		3.3	20.0	20.0	20.0	20.0	20		81
50	SB	142+00	2.5	25	12	33.3		33.3		5.6	33.3	33.3	33.3	33.3	20	8	111
51	SB	142+00	2.5	12	12	16.0		16.0		2.7	16.0	16.0	16.0	16.0	20		72
52	SB	147+28	2.6	10	12	13.3	13.3			2.2	13.3	13.3	13.3	13.3	20		66
53	SB	147+28	2.6	30	12	40.0		40.0		6.7	40.0	40.0	40.0	40.0	20	10	126
54	SB	152+56	2.7	30	12	40.0		40.0		6.7	40.0	40.0	40.0	40.0	20	10	126
55	SB	152+56	2.7	40	12	53.3		53.3		8.9	53.3	53.3	53.3	53.3	20	13	156
56	SB	152+56	2.7	60	12	80.0		80.0		13.3	80.0	80.0	80.0	80.0	20	20	216
57	SB	152+56	2.7	50	12	66.7		66.7		11.1	66.7	66.7	66.7	66.7	20	17	186
58	SB	157+84	2.8	60	12	80.0		80.0		13.3	80.0	80.0	80.0	80.0	20	20	216
59	SB	157+84	2.8	20	12	26.7		26.7		4.4	26.7	26.7	26.7	26.7	20	7	96
60	SB	157+84	2.8	20	12	26.7		26.7		4.4	26.7	26.7	26.7	26.7	20	7	96
61	SB	163+12	2.9	20	12	26.7		26.7		4.4	26.7	26.7	26.7	26.7	20	7	96

MODEL: D876T69_sht_sch-001
FILE NAME: P:\2024\ME\4003_P1B_196-059 PH I.H. Hutchison\W008_IL_310-CADD\02-Sht\0876T69_sht_sch-001.dgn



USER NAME = jcovarrubias	DESIGNED - MJR	REVISED -
	DRAWN - JC	REVISED -
PLOT SCALE = 0.16666633' / in.	CHECKED - ERO	REVISED -
PLOT DATE = 6/27/2024	DATE - 6/27/2024	REVISED -

**STATE OF ILLINOIS
DEPARTMENT OF TRANSPORTATION**

**FAP 312 (IL ROUTE 3)
SCHEDULE OF QUANTITIES**

SCALE: SHEET 1 OF 5 SHEETS STA. 0+00.00 TO STA. 0+00.00

F.A.P. RTE.	SECTION	COUNTY	TOTAL SHEETS	SHEET NO.
312	(119-1)RS-3,(121,122)RS-5	RANDOLPH	33	8
CONTRACT NO. 76T69				
ILLINOIS FED. AID PROJECT				

CLASS B PATCHES (SPECIAL) SCHEDULE

PATCH #	SB / NB	STATION	MILE	LENGTH (FT)	WIDTH (FT)	AREA (SQ YD)	CLASS B PATCH TYPE II, 12" SPECIAL (SQ YD)	CLASS B PATCH TYPE III, 12" SPECIAL (SQ YD)	CLASS B PATCH TYPE IV, 12" SPECIAL (SQ YD)	EARTH EXCAVATION (CU YD)	GEOTECH FAB F/GR STAB (SQ YD)	TRI GEOGRID REINF T1 (SQ YD)	SUB GRAN MAT B 6 (SQ YD)	WELDED WIRE REINFORCEMENT (SQ YD)	DOWEL BARS 1-1/4"	TIE BARS 3/4"	SAW CUTS (FT)
RURAL																	
62	SB	168+40	3.0	8	12	10.7	10.7			1.8	10.7	10.7	10.7	10.7	20		60
63	SB	168+40	3.0	25	12	33.3			33.3	5.6	33.3	33.3	33.3	33.3	20	8	111
64	SB	168+40	3.0	12	12	16.0		16.0		2.7	16.0	16.0	16.0	16.0	20		72
65	SB	168+40	3.0	25	12	33.3			33.3	5.6	33.3	33.3	33.3	33.3	20	8	111
66	SB	168+40	3.0	15	12	20.0		20.0		3.3	20.0	20.0	20.0	20.0	20		81
67	SB	173+68	3.1	15	12	20.0		20.0		3.3	20.0	20.0	20.0	20.0	20		81
68	SB	178+96	3.2	15	12	20.0		20.0		3.3	20.0	20.0	20.0	20.0	20		81
69	SB	184+24	3.3	8	12	10.7	10.7			1.8	10.7	10.7	10.7	10.7	20		60
70	SB	184+24	3.3	6	12	8.0	8.0			1.3	8.0	8.0	8.0	8.0	20		54
71	SB	200+08	3.6	6	12	8.0	8.0			1.3	8.0	8.0	8.0	8.0	20		54
72	SB	210+64	3.8	15	12	20.0		20.0		3.3	20.0	20.0	20.0	20.0	20		81
73	SB	215+92	3.9	8	12	10.7	10.7			1.8	10.7	10.7	10.7	10.7	20		60
74	SB	215+92	3.9	8	12	10.7	10.7			1.8	10.7	10.7	10.7	10.7	20		60
75	SB	215+92	3.9	8	12	10.7	10.7			1.8	10.7	10.7	10.7	10.7	20		60
76	SB	226+48	4.1	120	12	160.0			160.0	26.7	160.0	160.0	160.0	160.0	20	40	396
77	SB	226+48	4.1	110	12	146.7			146.7	24.4	146.7	146.7	146.7	146.7	20	37	366
78	SB	226+48	4.1	120	12	160.0			160.0	26.7	160.0	160.0	160.0	160.0	20	40	396
79	SB	226+48	4.1	80	12	106.7			106.7	17.8	106.7	106.7	106.7	106.7	20	27	276
80	SB	237+04	4.3	10	12	13.3	13.3			2.2	13.3	13.3	13.3	13.3	20		66
81	SB	242+32	4.4	40	12	53.3			53.3	8.9	53.3	53.3	53.3	53.3	20	13	156
82	SB	247+60	4.5	8	12	10.7	10.7			1.8	10.7	10.7	10.7	10.7	20		60
83	SB	247+60	4.5	8	12	10.7	10.7			1.8	10.7	10.7	10.7	10.7	20		60
84	SB	247+60	4.5	8	12	10.7	10.7			1.8	10.7	10.7	10.7	10.7	20		60
85	SB	247+60	4.5	8	12	10.7	10.7			1.8	10.7	10.7	10.7	10.7	20		60
86	SB	247+60	4.5	10	12	13.3	13.3			2.2	13.3	13.3	13.3	13.3	20		66
87	SB	247+60	4.5	12	12	16.0		16.0		2.7	16.0	16.0	16.0	16.0	20		72
88	SB	247+60	4.5	15	12	20.0		20.0		3.3	20.0	20.0	20.0	20.0	20		81
89	SB	247+60	4.5	12	12	16.0		16.0		2.7	16.0	16.0	16.0	16.0	20		72
90	SB	289+84	5.3	15	12	20.0		20.0		3.3	20.0	20.0	20.0	20.0	20		81
91	SB	295+12	5.4	15	12	20.0		20.0		3.3	20.0	20.0	20.0	20.0	20		81
92	SB	310+96	5.7	20	12	26.7			26.7	4.4	26.7	26.7	26.7	26.7	20	7	96
93	SB	310+96	5.7	20	12	26.7			26.7	4.4	26.7	26.7	26.7	26.7	20	7	96
94	SB	353+20	6.5	100	12	133.3			133.3	22.2	133.3	133.3	133.3	133.3	20	33	336
95	SB	379+60	7.0	10	12	13.3	13.3			2.2	13.3	13.3	13.3	13.3	20		66
96	SB	427+12	7.9	80	12	106.7			106.7	17.8	106.7	106.7	106.7	106.7	20	27	276
97	SB	427+12	7.9	40	12	53.3			53.3	8.9	53.3	53.3	53.3	53.3	20	13	156
98	SB	432+40	8.0	30	12	40.0			40.0	6.7	40.0	40.0	40.0	40.0	20	10	126
99	SB	432+40	8.0	25	12	33.3			33.3	5.6	33.3	33.3	33.3	33.3	20	8	111
100	SB	432+40	8.0	40	12	53.3			53.3	8.9	53.3	53.3	53.3	53.3	20	13	156
101	SB	437+68	8.1	200	12	266.7			266.7	44.4	266.7	266.7	266.7	266.7	20	67	636
102	SB	522+16	9.7	10	12	13.3	13.3			2.2	13.3	13.3	13.3	13.3	20		66
103	NB	527+44	9.8	15	12	20.0		20.0		3.3	20.0	20.0	20.0	20.0	20		81
104	NB	511+60	9.5	8	12	10.7	10.7			1.8	10.7	10.7	10.7	10.7	20		60
105	NB	464+08	8.6	160	12	213.3			213.3	35.6	213.3	213.3	213.3	213.3	20	53	516
106	NB	458+80	8.5	10	12	13.3	13.3			2.2	13.3	13.3	13.3	13.3	20		66
107	NB	437+68	8.1	125	12	166.7			166.7	27.8	166.7	166.7	166.7	166.7	20	42	411
108	NB	432+40	8.0	65	12	86.7			86.7	14.4	86.7	86.7	86.7	86.7	20	22	231
109	NB	432+40	8.0	140	12	186.7			186.7	31.1	186.7	186.7	186.7	186.7	20	47	456
110	NB	412+34	7.6	100	12	133.3			133.3	22.2	133.3	133.3	133.3	133.3	20	33	336
111	NB	263+44	4.8	35	12	46.7			46.7	7.8	46.7	46.7	46.7	46.7	20	12	141
112	NB	258+16	4.7	60	12	80.0			80.0	13.3	80.0	80.0	80.0	80.0	20	20	216
113	NB	252+88	4.6	30	12	40.0			40.0	6.7	40.0	40.0	40.0	40.0	20	10	126
114	NB	242+32	4.4	100	12	133.3			133.3	22.2	133.3	133.3	133.3	133.3	20	33	336
115	NB	231+76	4.2	40	12	53.3			53.3	8.9	53.3	53.3	53.3	53.3	20	13	156
116	NB	173+68	3.1	12	12	16.0		16.0		2.7	16.0	16.0	16.0	16.0	20		72
117	NB	173+68	3.1	6	12	8.0	8.0			1.3	8.0	8.0	8.0	8.0	20		54
118	NB	173+68	3.1	6	12	8.0	8.0			1.3	8.0	8.0	8.0	8.0	20		54
119	NB	173+68	3.1	8	12	10.7	10.7			1.8	10.7	10.7	10.7	10.7	20		60
120	NB	168+40	3.0	15	12	20.0		20.0		3.3	20.0	20.0	20.0	20.0	20		81

MODEL: D876T69_sht_sch-001
FILE NAME: P:\2024\ME\4003_PTB_196-059 PH I-111_Hutchison\W008_IL_3101-CADD\02-SHA\0876T69_sht_sch-002.dgn



USER NAME = jcovarrubias	DESIGNED - MJR	REVISED -
	DRAWN - JC	REVISED -
PLOT SCALE = 0.16666833' / in.	CHECKED - ERO	REVISED -
PLOT DATE = 6/27/2024	DATE - 6/27/2024	REVISED -

**STATE OF ILLINOIS
DEPARTMENT OF TRANSPORTATION**

**FAP 312 (IL ROUTE 3)
SCHEDULE OF QUANTITIES**

SCALE: SHEET 2 OF 5 SHEETS STA. 0+00.00 TO STA. 0+00.00

F.A.P. RTE.	SECTION	COUNTY	TOTAL SHEETS	SHEET NO.
312	(119-1)RS-3,(121,122)RS-5	RANDOLPH	33	9
CONTRACT NO. 76T69				
ILLINOIS FED. AID PROJECT				

CLASS B PATCHES (SPECIAL) SCHEDULE

PATCH #	SB / NB	STATION	MILE	LENGTH (FT)	WIDTH (FT)	AREA (SQ YD)	CLASS B PATCH TYPE II, 12" SPECIAL (SQ YD)	CLASS B PATCH TYPE III, 12" SPECIAL (SQ YD)	CLASS B PATCH TYPE IV, 12" SPECIAL (SQ YD)	EARTH EXCAVATION (CU YD)	GEOTECH FAB F/GR STAB (SQ YD)	TRI GEOGRID REINF T1 (SQ YD)	SUB GRAN MAT B 6 (SQ YD)	WELDED WIRE REINFORCEMENT (SQ YD)	DOWEL BARS 1-1/4"	TIE BARS 3/4"	SAW CUTS (FT)
URBAN																	
121	NB	163+12	2.9	10	12	13.3	13.3			2.2	13.3	13.3	13.3	13.3	20		66
122	NB	163+12	2.9	15	12	20.0		20.0		3.3	20.0	20.0	20.0	20.0	20		81
123	NB	163+12	2.9	10	12	13.3	13.3			2.2	13.3	13.3	13.3	13.3	20		66
124	NB	163+12	2.9	40	12	53.3			53.3	8.9	53.3	53.3	53.3	53.3	20	13	156
125	NB	157+84	2.8	60	12	80.0			80.0	13.3	80.0	80.0	80.0	80.0	20	20	216
126	NB	157+84	2.8	15	12	20.0		20.0		3.3	20.0	20.0	20.0	20.0	20		81
127	NB	157+84	2.8	8	12	10.7	10.7			1.8	10.7	10.7	10.7	10.7	20		60
128	NB	152+56	2.7	25	12	33.3			33.3	5.6	33.3	33.3	33.3	33.3	20	8	111
129	NB	152+56	2.7	15	12	20.0		20.0		3.3	20.0	20.0	20.0	20.0	20		81
130	NB	152+56	2.7	20	12	26.7			26.7	4.4	26.7	26.7	26.7	26.7	20	7	96
131	NB	147+28	2.6	25	12	33.3			33.3	5.6	33.3	33.3	33.3	33.3	20	8	111
132	NB	147+28	2.6	10	12	13.3	13.3			2.2	13.3	13.3	13.3	13.3	20		66
133	NB	147+28	2.6	8	12	10.7	10.7			1.8	10.7	10.7	10.7	10.7	20		60
134	NB	147+28	2.6	8	12	10.7	10.7			1.8	10.7	10.7	10.7	10.7	20		60
135	NB	147+28	2.6	8	12	10.7	10.7			1.8	10.7	10.7	10.7	10.7	20		60
136	NB	147+28	2.6	15	12	20.0		20.0		3.3	20.0	20.0	20.0	20.0	20		81
137	NB	147+28	2.6	12	12	16.0		16.0		2.7	16.0	16.0	16.0	16.0	20		72
138	NB	147+28	2.6	15	12	20.0		20.0		3.3	20.0	20.0	20.0	20.0	20		81
139	NB	142+00	2.5	12	12	16.0		16.0		2.7	16.0	16.0	16.0	16.0	20		72
140	NB	142+00	2.5	20	12	26.7			26.7	4.4	26.7	26.7	26.7	26.7	20	7	96
141	NB	142+00	2.5	20	12	26.7			26.7	4.4	26.7	26.7	26.7	26.7	20	7	96
142	NB	142+00	2.5	15	12	20.0		20.0		3.3	20.0	20.0	20.0	20.0	20		81
143	NB	142+00	2.5	25	12	33.3			33.3	5.6	33.3	33.3	33.3	33.3	20	8	111
144	NB	142+00	2.5	15	12	20.0		20.0		3.3	20.0	20.0	20.0	20.0	20		81
145	NB	136+72	2.4	12	12	16.0		16.0		2.7	16.0	16.0	16.0	16.0	20		72
146	NB	136+72	2.4	15	12	20.0		20.0		3.3	20.0	20.0	20.0	20.0	20		81
147	NB	136+72	2.4	25	12	33.3			33.3	5.6	33.3	33.3	33.3	33.3	20	8	111
148	NB	136+72	2.4	25	12	33.3			33.3	5.6	33.3	33.3	33.3	33.3	20	8	111
149	NB	136+72	2.4	12	12	16.0		16.0		2.7	16.0	16.0	16.0	16.0	20		72
150	NB	136+72	2.4	80	12	106.7			106.7	17.8	106.7	106.7	106.7	106.7	20	27	276
151	NB	136+72	2.4	12	12	16.0		16.0		2.7	16.0	16.0	16.0	16.0	20		72
152	NB	136+72	2.4	10	12	13.3	13.3			2.2	13.3	13.3	13.3	13.3	20		66
153	NB	136+72	2.4	8	12	10.7	10.7			1.8	10.7	10.7	10.7	10.7	20		60
154	NB	136+72	2.4	20	12	26.7			26.7	4.4	26.7	26.7	26.7	26.7	20	7	96
155	NB	136+72	2.4	8	12	10.7	10.7			1.8	10.7	10.7	10.7	10.7	20		60
156	NB	131+44	2.3	25	12	33.3			33.3	5.6	33.3	33.3	33.3	33.3	20	8	111
157	NB	126+16	2.2	20	12	26.7			26.7	4.4	26.7	26.7	26.7	26.7	20	7	96
158	NB	126+16	2.2	8	12	10.7	10.7			1.8	10.7	10.7	10.7	10.7	20		60
159	NB	105+04	1.8	15	12	20.0		20.0		3.3	20.0	20.0	20.0	20.0	20		81
160	NB	105+04	1.8	10	12	13.3	13.3			2.2	13.3	13.3	13.3	13.3	20		66
161	NB	99+76	1.7	10	12	13.3	13.3			2.2	13.3	13.3	13.3	13.3	20		66
162	NB	83+92	1.4	6	12	8.0	8.0			1.3	8.0	8.0	8.0	8.0	20		54
163	NB	83+92	1.4	15	12	20.0		20.0		3.3	20.0	20.0	20.0	20.0	20		81
164	NB	83+92	1.4	8	12	10.7	10.7			1.8	10.7	10.7	10.7	10.7	20		60
165	NB	83+92	1.4	12	12	16.0		16.0		2.7	16.0	16.0	16.0	16.0	20		72
166	NB	83+92	1.4	8	12	10.7	10.7			1.8	10.7	10.7	10.7	10.7	20		60
167	NB	78+64	1.3	12	12	16.0		16.0		2.7	16.0	16.0	16.0	16.0	20		72
168	NB	68+08	1.1	8	12	10.7	10.7			1.8	10.7	10.7	10.7	10.7	20		60
169	NB	25+84	0.3	20	12	26.7			26.7	4.4	26.7	26.7	26.7	26.7	20	7	96
170	NB	20+56	0.2	8	12	10.7	10.7			1.8	10.7	10.7	10.7	10.7	20		60
171	NB	15+28	0.1	15	12	20.0		20.0		3.3	20.0	20.0	20.0	20.0	20		81
172	NB	15+28	0.1	12	12	16.0		16.0		2.7	16.0	16.0	16.0	16.0	20		72
173	NB	10+00	0.0	20	12	26.7			26.7	4.4	26.7	26.7	26.7	26.7	20	7	96
URBAN SUBTOTAL						2774.7	442.7	532.0	1800.0	462.4	2774.7	2774.7	2774.7	2774.7	2280	450	10347
RURAL SUBTOTAL						3033.3	216.0	244.0	2573.3	505.6	3033.3	3033.3	3033.3	3033.3	1180	643	8949
DISCRETIONARY QUANTITY (15%)						871.2	98.8	116.4	656.0	145.2	871.2	871.2	871.2	871.2	519	164	2894
TOTAL						6679.2	757.5	892.4	5029.3	1113.2	6679.2	6679.2	6679.2	6679.2	3979	1257	22190

MODEL: D876T69_sht_sch-001
FILE NAME: P:\2024\ME\4003_PTB_198-059 PH I.H. Huchison\W008_IL_3101-CADD\02-Sha\0876T69_sht_sch-003.dgn



USER NAME = jcovarrubias	DESIGNED - MJR	REVISED -
PLOT SCALE = 0.16666833' / in.	DRAWN - JC	REVISED -
PLOT DATE = 6/27/2024	CHECKED - ERO	REVISED -
	DATE - 6/27/2024	REVISED -

**STATE OF ILLINOIS
DEPARTMENT OF TRANSPORTATION**

FAP 312 (IL ROUTE 3) SCHEDULE OF QUANTITIES			
SCALE:	SHEET 3	OF 5 SHEETS	STA. 0+00.00 TO STA. 0+00.00

F.A.P. RTE.	SECTION	COUNTY	TOTAL SHEETS	SHEET NO.
312	(119-1)RS-3,(121,122)RS-5	RANDOLPH	33	10
CONTRACT NO. 76T69				
ILLINOIS FED. AID PROJECT				

RESURFACING SCHEDULE

APPROXIMATE LOCATION		LENGTH	WIDTH	AREA	BIT MATLS TACK CT	P BIT MATLS TACK CT	LONG JOINT SEALANT	TEMPORARY RAMP	HMA BC IL-19.0 N90	P HMA SC IL-9.5 D N90	HMA SURF REM 3 3/4	RAISED REFL PAVT MKR	RAISED REF PVT MK REM	MATL TRANSFER DEVICE
STATION FROM	STATION TO	FOOT	FOOT	SQ YD	POUND	POUND	FOOT	SQ YD	TON	TON	SQ YD	EACH	EACH	TON
URBAN														
10+80	12+00	120	28	373	168.0	84.0	120	92	47.0	31.4	373	3	3	78.4
12+00	12+75	75	26	217	97.5	48.8	75		27.3	18.2	217	2	2	45.5
12+75	18+37	562	25.5	1592	716.6	358.3	562		200.6	133.8	1592	9	9	334.4
18+37	20+18	181	25.25	508	228.5	114.3	181		64.0	42.7	508	4	4	106.6
20+18	22+07	189	25.25	530	238.6	119.3	189		66.8	44.5	530	4	4	111.4
22+07	26+25	418	25.25	1173	527.7	263.9	418		147.8	98.5	1173	7	7	246.3
26+25	30+17	392	25	1089	490.0	245.0	392		137.2	91.5	1089	6	6	228.7
30+17	35+37	520	26	1502	676.0	338.0	520		189.3	126.2	1502	8	8	315.5
35+37	43+69	832	24	2219	998.4	499.2	832		279.6	186.4	2219	12	12	465.9
43+69	57+54	1385	25	3847	1731.3	865.6	1385		484.8	323.2	3847	19	19	807.9
57+54	63+45	591	24.75	1625	731.4	365.7	591		204.8	136.5	1625	9	9	341.3
63+45	71+07	762	25	2117	952.5	476.3	762		266.7	177.8	2117	11	11	444.5
71+07	77+55	648	25	1800	810.0	405.0	648		226.8	151.2	1800	10	10	378.0
77+55	104+73	2718	25	7550	3397.5	1698.8	2718		951.3	634.2	7550	35	35	1585.5
104+73	110+00	527	25	1464	658.8	329.4	527		184.5	123.0	1464	8	8	307.4
110+00	111+45	145	25	403	181.3	90.6	145		50.8	33.8	403	3	3	84.6
111+45	114+32	287	25.5	813	365.9	183.0	287		102.5	68.3	813	5	5	170.8
114+32	118+20	388	24.5	1056	475.3	237.7	388		133.1	88.7	1056	6	6	221.8
118+20	163+45	4525	25.5	12821	5769.4	2884.7	4525	35	1615.4	1077.0	12821	58	58	2692.4
RURAL														
167+43	213+70	4627	24.5	12596	5668.1	2834.0	4627	35	1587.1	1058.0	12596	59	59	2645.1
213+70	371+42	15772	24.5	42935	19320.7	9660.4	15772		5409.8	3606.5	42935	199	199	9016.3
371+42	451+16	7974	24	21264	9568.8	4784.4	7974		2679.3	1786.2	21264	101	101	4465.4
451+16	458+75	759	25	2108	948.8	474.4	759		265.7	177.1	2108	11	11	442.8
458+75	557+12	9836.6	24.5	26777	12049.8	6024.9	9837	37	3374.0	2249.3	26777	124	124	5623.3
URBAN SUBTOTAL														
RURAL SUBTOTAL														
TOTAL														

MODEL: D876T69_sht_sch-002
 FILE NAME: P:\2024\ME\4003_PTB_196-059 PH I-11_Hutchison\W008_IL_3101-CADD\02-SHA\0876T69_sht_sch-004.dgn



USER NAME = jcovarrubias	DESIGNED - MJR	REVISED -
	DRAWN - JC	REVISED -
PLOT SCALE = 0.16666833' / in.	CHECKED - ERO	REVISED -
PLOT DATE = 6/27/2024	DATE - 6/27/2024	REVISED -

**STATE OF ILLINOIS
DEPARTMENT OF TRANSPORTATION**

FAP 312 (IL ROUTE 3) SCHEDULE OF QUANTITIES			
SCALE:	SHEET 4	OF 5 SHEETS	TO STA. 0+00.00

F.A.P RTE.	SECTION	COUNTY	TOTAL SHEETS	SHEET NO.
312	(119-1)RS-3,(121,122)RS-5	RANDOLPH	33	11
CONTRACT NO. 76T69				
ILLINOIS FED. AID PROJECT				

RESURFACING PAVEMENT MARKING SCHEDULE											
APPROXIMATE LOCATION		SHORT TERM PAVT MKING	SHRT TRM PAVT MK REM	THPL PVT MK LTR & SYM	THPL PVT MK LINE 6	THPL PVT MK LINE 24	PAVMT MRKG REM GRIND	PAVMT MRKG REM WTR BL	TMP PVT MK L&S PNT	TEMP PVT MK L 6 PNT	TEMP PVT MK L 24 PNT
STATION FROM	STATION TO	FOOT	SQ FT	SQ FT	FOOT	FOOT	SQ FT	SQ FT	SQ FT	FOOT	FOOT
URBAN											
10+40.0	163+45.0	5510	1837		30610					30610	
10+40.4	11+39.2	71	24		396					396	
10+45.0		168	56			21					21
11+39.2	13+00.0	58	19		322					322	
13+00.0	32+57.5	440	147		2447					2447	
32+57.5	35+10.6	91	30		506					506	
35+10.6	41+50.2	144	48		800					800	
41+50.2	44+77.1	15	5		82					82	
44+77.1	52+90.4	183	61		1017					1017	
52+90.4	67+46.0	524	175		2911					2911	
67+46.0	74+76.1	164	55		913					913	
76+36.2	88+41.5	271	90		1507					1507	
88+41.5	91+73.3	119	40		663					663	
91+73.3	99+90.4	184	61		1022					1022	
99+90.4	144+10.1	1591	530		8839					8839	
144+10.1	151+00.0	155	52		862					862	
151+00.0	155+55.6	164	55		911					911	
155+55.6	159+45.3	88	29		487					487	
159+07.0		104	35			13					13
159+30.0		0	76	61				61.0			
159+45.3	163+45.0	144	48		799					799	
159+56.0		104	35			13					13
163+27.8		100	33			13					13
RURAL											
167+43.0	557+12.1	14029	4676		77938					77938	
167+43.0	176+98.7	215	72		1195					1195	
176+98.7	193+00.0	72	24		400					400	
193+00.0	212+33.1	435	145		2416					2416	
212+33.2	216+40.2	147	49		814					814	
216+40.2	223+90.1	169	56		937					937	
223+90.1	225+45.5	56	19		311					311	
225+45.5	235+36.6	223	74		1239					1239	
235+36.6	242+17.8	31	10		170					170	
242+17.8	252+90.1	241	80		1340					1340	
252+90.1	257+80.3	176	59		980					980	
257+80.3	267+00.0	207	69		1150					1150	
267+00.0	273+58.2	30	10		165					165	
273+58.2	294+01.1	460	153		2554					2554	
294+01.1	296+00.0	9	3		50					50	
296+00.0	306+32.4	232	77		1290					1290	
306+32.4	317+10.1	388	129		2155					2155	
317+10.1	328+00.0	245	82		1362					1362	
328+00.0	381+00.0	239	80		1325					1325	
381+00.0	388+56.2	170	57		945					945	
388+56.2	391+28.8	12	4		68					68	
391+28.8	397+79.1	146	49		813					813	
397+79.1	403+79.8	27	9		150					150	
403+79.8	411+00.0	162	54		900					900	
411+00.0	415+00.0	18	6		100					100	
415+00.0	431+90.1	380	127		2113					2113	
431+90.1	450+75.7	679	226		3771					3771	
450+75.7	459+46.1	196	65		1088					1088	
459+46.1	465+46.1	27	9		150					150	
465+46.1	472+13.1	150	50		834					834	
472+13.1	494+31.8	799	266		4438					4438	
494+31.8	522+00.0	623	208		3460					3460	
522+00.0	527+00.0	23	8		125					125	
527+00.0	537+43.3	235	78		1304					1304	
537+43.3	539+68.9	81	27		451					451	
539+68.9	548+35.7	195	65		1083					1083	
548+35.7	551+00.0	95	32		529					529	
551+00.0	557+12.1	138	46		765					765	
URBAN SUBTOTAL		10393	3540	61	55093	60	25	25	61	55093	60
RURAL SUBTOTAL		21758	7253	0	120880	0	75	75	0	120880	0
TOTAL		32151	10793	61	175973	60	100	100	61	175973	60

RESURFACING SCHEDULE					
APPROXIMATE LOCATION		LENGTH	WIDTH	AREA	AGG WEDGE SHLD TYPE B
STATION FROM	STATION TO	FOOT	FOOT	SQ YD	TON
URBAN					
71+00	131+32	6032	3	2011	241.3
RURAL					
197+62	207+59	997	3	332	39.9
257+63	267+08	945	3	315	37.8
273+34	304+83	3149	3	1050	126.0
311+41	313+65	224	3	75	9.0
320+17	325+91	574	3	191	23.0
418+46	448+61	3015	3	1005	120.6
172+59	196+62	2403	3	801	192.2
210+69	212+82	213	3	71	17.0
224+69	245+01	2032	3	677	162.6
249+18	257+63	845	3	282	67.6
267+08	273+34	626	3	209	50.1
304+83	311+41	658	3	219	52.6
325+91	380+20	5429	3	1810	434.3
390+00	418+46	2846	3	949	227.7
506+11	557+12	5101	3	1700	408.1
URBAN SUBTOTAL				2011	241
RURAL SUBTOTAL				9686	1968
TOTAL				11696	2210

GUARDRAIL SCHEDULE				
APPROXIMATE LOCATION		GUARDRAIL REMOV	TR BAR TRM T1 SPL TAN	TERMINAL MARKER - DA
STATION FROM	NB / SB	FOOT	EACH	EACH
URBAN				
163+31.0				1
RURAL				
210+50.0	SB	50	1	1
213+00.0	NB			1
218+00.0	SB	50	1	1
260+25.0	SB	50	1	1
265+75.0	SB	50	1	1
364+25.0	SB	50	1	1
454+75.0	NB	50	1	1
490+00.0	SB	55	1	1
503+75.0	NB	55	1	1
531+50.0	NB	50	1	1
540+50.0	SB	64	1	1
URBAN SUBTOTAL				1
RURAL SUBTOTAL				11
TOTAL				12

MODEL: D876T69_sht_sch-002
 FILE NAME: P:\2024\ME\4003_PTB_196-059 PH I-11_Hutchison\W008_IL_3101-CADD\02-SHA\0876T69_sht_sch-005.dgn



USER NAME = jcovarrubias
 PLOT SCALE = 0.16666833 / in.
 PLOT DATE = 6/27/2024

DESIGNED - MJR
 DRAWN - JC
 CHECKED - ERO
 DATE - 6/27/2024

REVISED -
 REVISED -
 REVISED -
 REVISED -

STATE OF ILLINOIS
DEPARTMENT OF TRANSPORTATION

FAP 312 (IL ROUTE 3)
SCHEDULE OF QUANTITIES

SCALE: SHEET 5 OF 5 SHEETS STA. 0+00.00 TO STA. 0+00.00

F.A.P. RTE.	SECTION	COUNTY	TOTAL SHEETS	SHEET NO.
312	(119-1)RS-3,(121,122)RS-5	RANDOLPH	33	12
CONTRACT NO. 76T69				
ILLINOIS FED. AID PROJECT				



MATCHLINE STA. 25+00.00



MATCHLINE STA. 40+00.00

MODEL: D876T69_sht_dplan-001
 FILE NAME: P:\2024\11E\4003_PTB_198-059 PH 111_Hutchison\W008_IL_3101-CADD\02-SHA\0876T69_sht_dplan-001.dgn



USER NAME = jcovarrubias	DESIGNED - MJR	REVISED -
PLOT SCALE = 0.16666633' / in.	DRAWN - JC	REVISED -
PLOT DATE = 6/27/2024	CHECKED - ERO	REVISED -
	DATE - 6/27/2024	REVISED -

**STATE OF ILLINOIS
 DEPARTMENT OF TRANSPORTATION**

**FAP 312 (IL ROUTE 3)
 ROADWAY PLAN**

SCALE: 1"=50' SHEET 1 OF 19 SHEETS STA. 10+00.00 TO STA. 40+00.00

F.A.P. RTE.	SECTION	COUNTY	TOTAL SHEETS	SHEET NO.
312	(119-1)RS-3,(121,122)RS-5	RANDOLPH	33	13
CONTRACT NO. 76T69				
ILLINOIS FED. AID PROJECT				

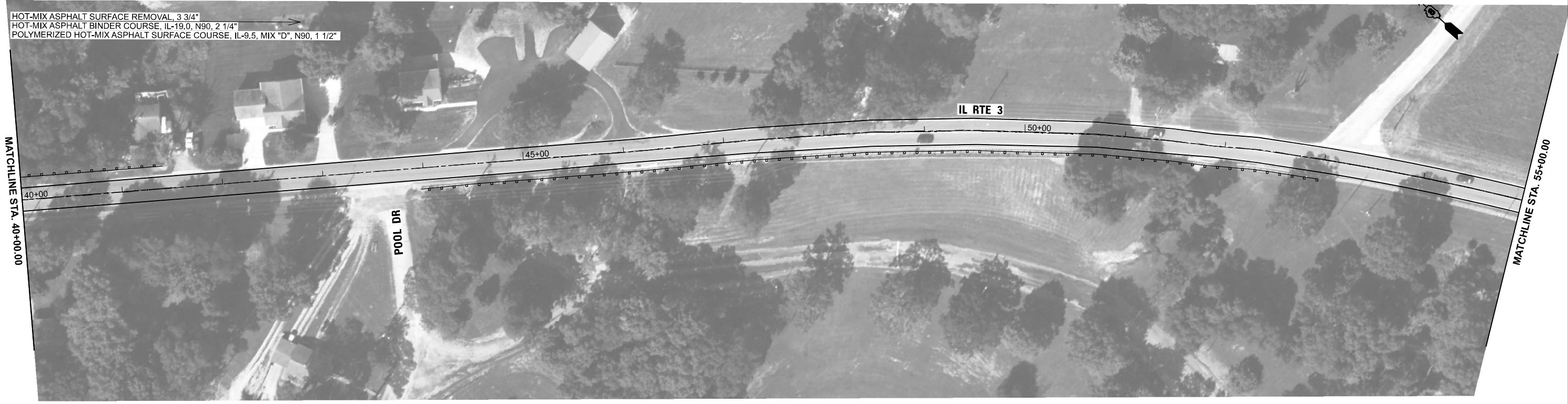

MODEL: D876T69_sht_dplan-002
 FILE NAME: P:\2024\1E\4003_PTB_198-059 PH I-11_Hutchison\W008_IL_3101-CADD\02-Shts\0876T69_sht_dplan-002.dgn



USER NAME = jcovarrubias	DESIGNED - MJR	REVISED -
	DRAWN - JC	REVISED -
PLOT SCALE = 0.16666633' / in.	CHECKED - ERO	REVISED -
PLOT DATE = 6/27/2024	DATE - 6/27/2024	REVISED -

STATE OF ILLINOIS
DEPARTMENT OF TRANSPORTATION

FAP 312 (IL ROUTE 3)
ROADWAY PLAN

SCALE: 1"=50' SHEET 2 OF 19 SHEETS STA. 40+00.00 TO STA. 70+00.00

F.A.P. RTE.	SECTION	COUNTY	TOTAL SHEETS	SHEET NO.
312	(119-1)RS-3,(121,122)RS-5	RANDOLPH	33	14
CONTRACT NO. 76T69				
ILLINOIS FED. AID PROJECT				



HOT-MIX ASPHALT SURFACE REMOVAL, 3 3/4"
 HOT-MIX ASPHALT BINDER COURSE, IL-19.0, N90, 2 1/4"
 POLYMERIZED HOT-MIX ASPHALT SURFACE COURSE, IL-9.5, MIX "D", N90, 1 1/2"



HOT-MIX ASPHALT SURFACE REMOVAL, 3 3/4"
 HOT-MIX ASPHALT BINDER COURSE, IL-19.0, N90, 2 1/4"
 POLYMERIZED HOT-MIX ASPHALT SURFACE COURSE, IL-9.5, MIX "D", N90, 1 1/2"

MODEL: D876T69_sht_dplan-003
 FILE NAME: P:\2024\11E\4003_PTB_198-059 PH I-11_Hutchison\W008_IL_3\01-CADD\02-Shts\0876T69_sht_dplan-003.dgn



USER NAME = jcovarrubias	DESIGNED - MJR	REVISED -
	DRAWN - JC	REVISED -
PLOT SCALE = 0.16666633' / in.	CHECKED - ERO	REVISED -
PLOT DATE = 6/27/2024	DATE - 6/27/2024	REVISED -

STATE OF ILLINOIS
 DEPARTMENT OF TRANSPORTATION

FAP 312 (IL ROUTE 3)
 ROADWAY PLAN

SCALE: 1"=50' SHEET 3 OF 19 SHEETS STA. 70+00.00 TO STA. 100+00.00

F.A.P. RTE.	SECTION	COUNTY	TOTAL SHEETS	SHEET NO.
312	(119-1)RS-3,(121,122)RS-5	RANDOLPH	33	15
CONTRACT NO. 76T69				
ILLINOIS FED. AID PROJECT				



MODEL: D876T69_sht_dplan-004
 FILE NAME: P:\2024\ME\4003_PTB_198-059 PH I-11_Hutchison\W008_IL_3\01-CADD\02-SHA\0876T69_sht_dplan-004.dgn



USER NAME = jcovarrubias	DESIGNED - MJR	REVISED -
DRAWN - JC	REVISED -	
PLOT SCALE = 0.16666633' / in.	CHECKED - ERO	REVISED -
PLOT DATE = 6/27/2024	DATE - 6/27/2024	REVISED -

STATE OF ILLINOIS
DEPARTMENT OF TRANSPORTATION

FAP 312 (IL ROUTE 3)
ROADWAY PLAN

SCALE: 1"=50' SHEET 4 OF 19 SHEETS STA. 100+00.00 TO STA. 130+00.00

F.A.P. RTE.	SECTION	COUNTY	TOTAL SHEETS	SHEET NO.
312	(119-1)RS-3,(121,122)RS-5	RANDOLPH	33	16
CONTRACT NO. 76T69				
ILLINOIS FED. AID PROJECT				

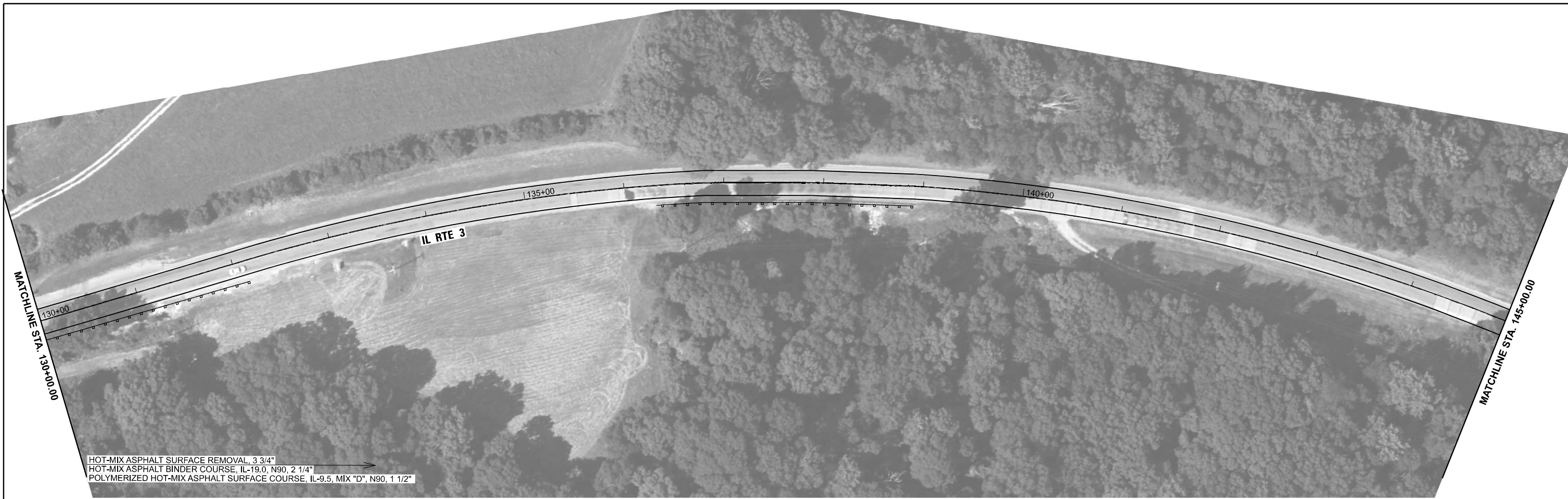

HOT-MIX ASPHALT SURFACE REMOVAL, 3 3/4"
 HOT-MIX ASPHALT BINDER COURSE, IL-19.0, N90, 2 1/4"
 POLYMERIZED HOT-MIX ASPHALT SURFACE COURSE, IL-9.5, MIX "D", N90, 1 1/2"



HOT-MIX ASPHALT SURFACE REMOVAL, 3 3/4"
 HOT-MIX ASPHALT BINDER COURSE, IL-19.0, N90, 2 1/4"
 POLYMERIZED HOT-MIX ASPHALT SURFACE COURSE, IL-9.5, MIX "D", N90, 1 1/2"

MODEL: D876T69_sht_dplan-005
 FILE NAME: P:\2024\11E\4003_PTB_198-059 PH 111_Hutchison\W008_IL_3101-CADD\02-Shts\0876T69_sht_dplan-005.dgn



USER NAME = jcovarrubias	DESIGNED - MJR	REVISED -
	DRAWN - JC	REVISED -
PLOT SCALE = 0.16666633' / in.	CHECKED - ERO	REVISED -
PLOT DATE = 6/27/2024	DATE - 6/27/2024	REVISED -

STATE OF ILLINOIS
 DEPARTMENT OF TRANSPORTATION

FAP 312 (IL ROUTE 3)
 ROADWAY PLAN

SCALE: 1"=50' SHEET 5 OF 19 SHEETS STA. 130+00.00 TO STA. 160+00.00

F.A.P. RTE.	SECTION	COUNTY	TOTAL SHEETS	SHEET NO.
312	(119-1)RS-3, (121,122)RS-5	RANDOLPH	33	17
CONTRACT NO. 76T69				
ILLINOIS FED. AID PROJECT				

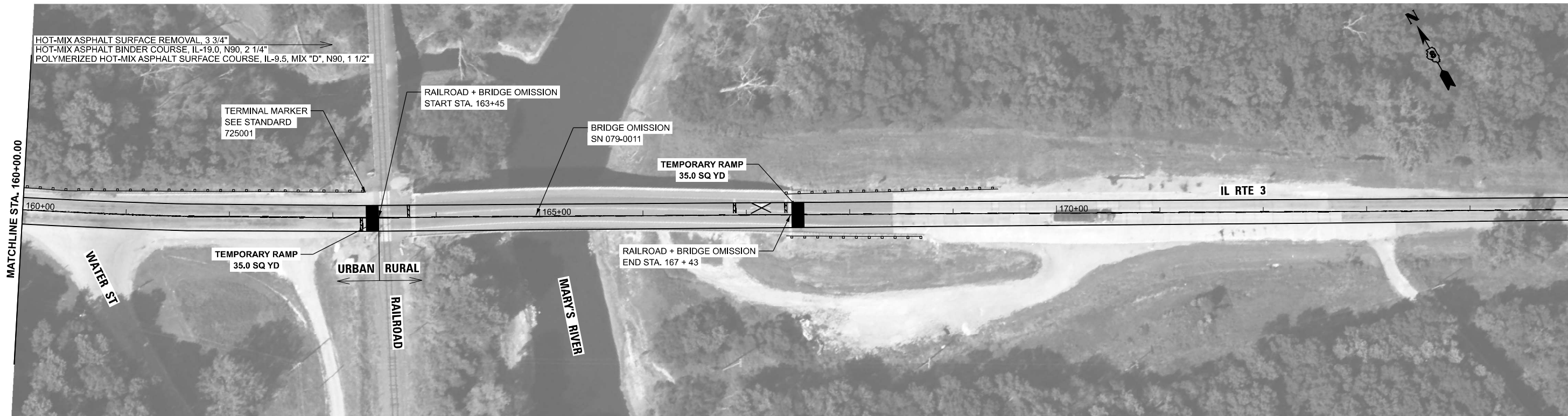

MODEL: D876T69_sht_dplan-006
 FILE NAME: P:\2024\1E\4003_PTB_198-059 PH 1-11_Hutchison\W008_IL_3101-CADD\02-SHA\0876T69_sht_dplan-006.dgn



USER NAME = jcovarrubias	DESIGNED - MJR	REVISED -
	DRAWN - JC	REVISED -
PLOT SCALE = 0.16666633' / in.	CHECKED - ERO	REVISED -
PLOT DATE = 6/27/2024	DATE - 6/27/2024	REVISED -

**STATE OF ILLINOIS
 DEPARTMENT OF TRANSPORTATION**

**FAP 312 (IL ROUTE 3)
 ROADWAY PLAN**

SCALE: 1"=50' SHEET 6 OF 19 SHEETS STA. 160+00.00 TO STA. 190+00.00

F.A.P. RTE.	SECTION	COUNTY	TOTAL SHEETS	SHEET NO.
312	(119-1)RS-3, (121,122)RS-5	RANDOLPH	33	18
CONTRACT NO. 76T69				
ILLINOIS FED. AID PROJECT				



MODEL: D876T69_sht_dplan-007
 FILE NAME: P:\2024\11E\4003_PTB_196-059 PH 1-11_Hutchison\W008_IL_3101-CADD\02-Shts\0876T69_sht_dplan-007.dgn



USER NAME = jcovarrubias	DESIGNED - MJR	REVISED -
DRAWN - JC	REVISED -	
PLOT SCALE = 0.16666633' / in.	CHECKED - ERO	REVISED -
PLOT DATE = 6/27/2024	DATE - 6/27/2024	REVISED -

**STATE OF ILLINOIS
 DEPARTMENT OF TRANSPORTATION**

**FAP 312 (IL ROUTE 3)
 ROADWAY PLAN**

SCALE: 1"=50' SHEET 7 OF 19 SHEETS STA. 190+00.00 TO STA. 220+00.00

F.A.P. RTE.	SECTION	COUNTY	TOTAL SHEETS	SHEET NO.
312	(119-1)RS-3, (121,122)RS-5	RANDOLPH	33	19
CONTRACT NO. 76T69				
ILLINOIS FED. AID PROJECT				



MODEL: D876T69_sht_dplan-008
 FILE NAME: P:\2024\ME\4003_PTB_196-059 PH I-11_Hutchison\W008_IL_3101-CADD\02-SHA\0876T69_sht_dplan-008.dgn



USER NAME = jcovarrubias	DESIGNED - MJR	REVISED -
DRAWN - JC	REVISED -	
PLOT SCALE = 0.16666633' / in.	CHECKED - ERO	REVISED -
PLOT DATE = 6/27/2024	DATE - 6/27/2024	REVISED -

STATE OF ILLINOIS
 DEPARTMENT OF TRANSPORTATION

FAP 312 (IL ROUTE 3)
 ROADWAY PLAN

SCALE: 1"=50' SHEET 8 OF 19 SHEETS STA. 220+00.00 TO STA. 250+00.00

F.A.P. RTE.	SECTION	COUNTY	TOTAL SHEETS	SHEET NO.
312	(119-1)RS-3, (121,122)RS-5	RANDOLPH	33	20
CONTRACT NO. 76T69				
ILLINOIS FED. AID PROJECT				

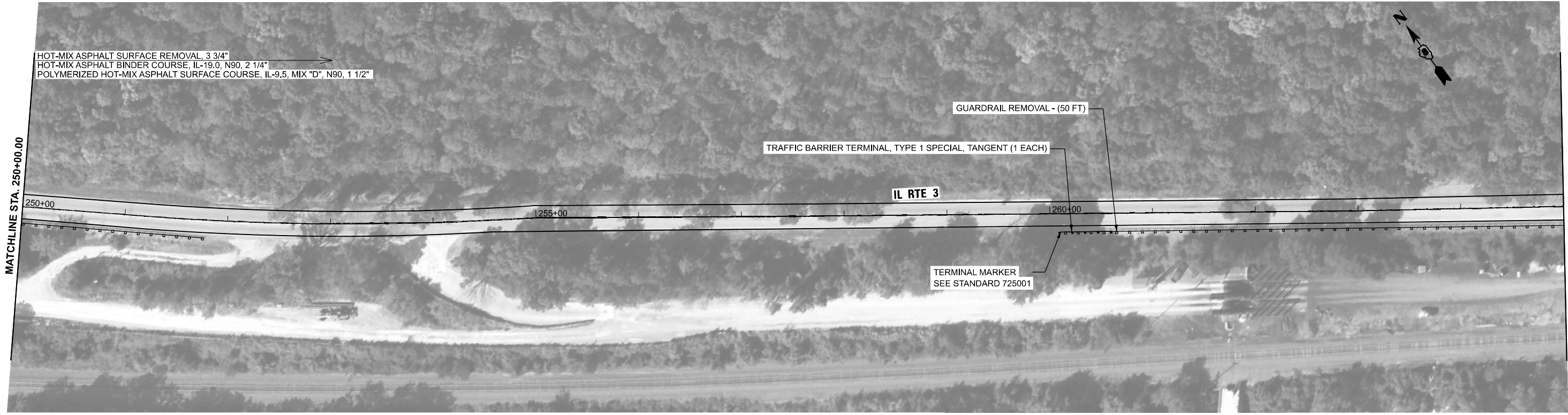

MODEL: D876T69_sht_dplan-009
 FILE NAME: P:\2024\1E\4003_PTB_196-059 PH I-I_Hutchison\W008_IL_3\01-CADD\02-SHA\0876T69_sht_dplan-009.dgn



USER NAME = jcovarrubias	DESIGNED - MJR	REVISED -
	DRAWN - JC	REVISED -
PLOT SCALE = 0.16666633' / in.	CHECKED - ERO	REVISED -
PLOT DATE = 6/27/2024	DATE - 6/27/2024	REVISED -

STATE OF ILLINOIS
DEPARTMENT OF TRANSPORTATION

FAP 312 (IL ROUTE 3)
ROADWAY PLAN

SCALE: 1"=50' SHEET 9 OF 19 SHEETS STA. 250+00.00 TO STA. 280+00.00

F.A.P. RTE.	SECTION	COUNTY	TOTAL SHEETS	SHEET NO.
312	(119-1)RS-3, (121,122)RS-5	RANDOLPH	33	21
CONTRACT NO. 76T69				
ILLINOIS FED. AID PROJECT				

HOT-MIX ASPHALT SURFACE REMOVAL, 3 3/4"
 HOT-MIX ASPHALT BINDER COURSE, IL-19.0, N90, 2 1/4"
 POLYMERIZED HOT-MIX ASPHALT SURFACE COURSE, IL-9.5, MIX "D", N90, 1 1/2"

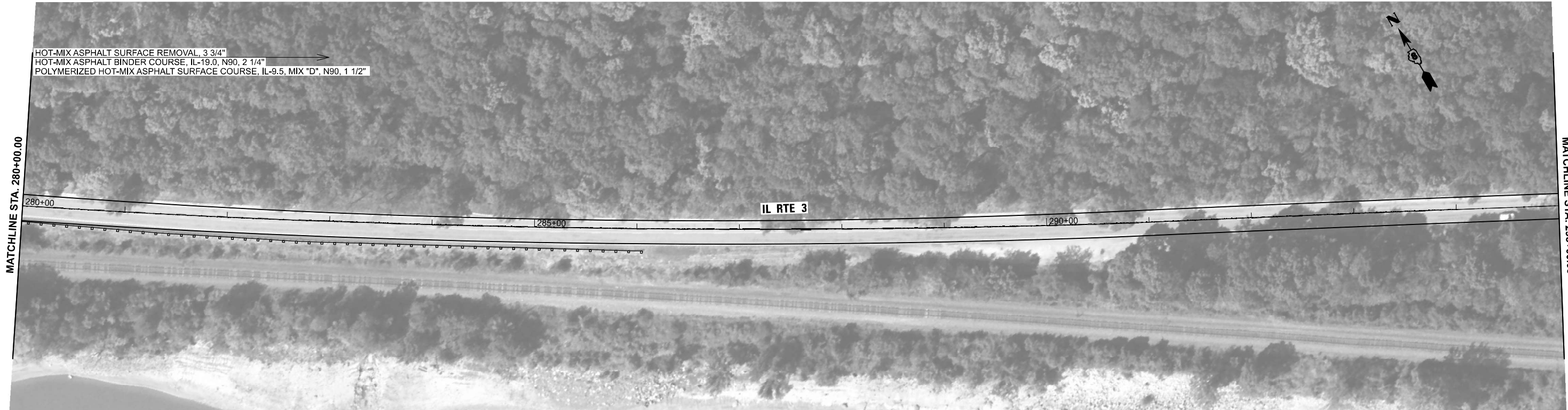

MATCHLINE STA. 280+00.00

MATCHLINE STA. 295+00.00

HOT-MIX ASPHALT SURFACE REMOVAL, 3 3/4"
 HOT-MIX ASPHALT BINDER COURSE, IL-19.0, N90, 2 1/4"
 POLYMERIZED HOT-MIX ASPHALT SURFACE COURSE, IL-9.5, MIX "D", N90, 1 1/2"

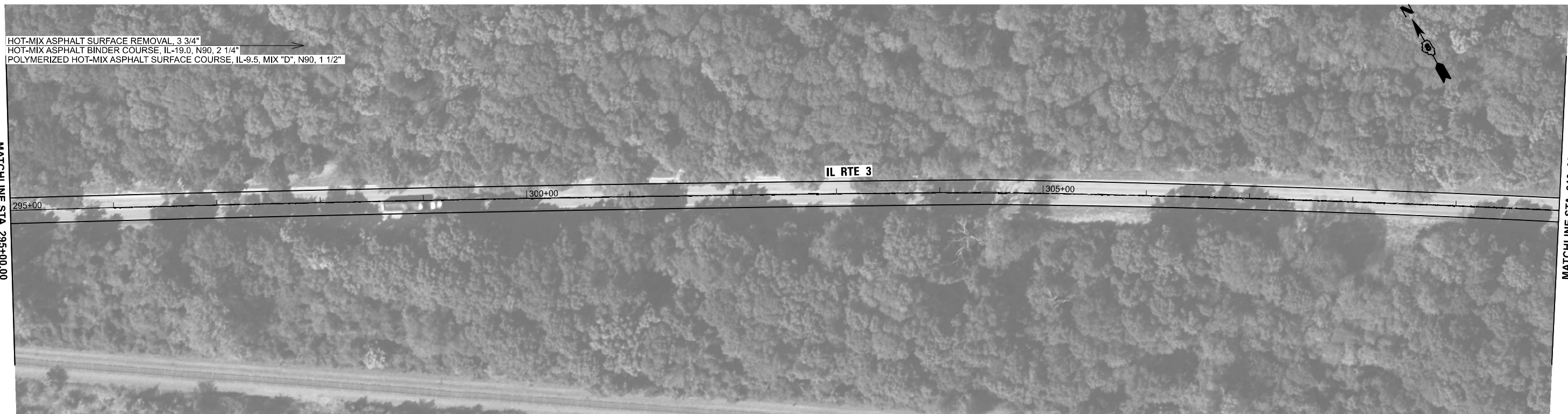

MATCHLINE STA. 295+00.00

MATCHLINE STA. 310+00.00

MODEL: D876T69_sht_dplan-010
 FILE NAME: P:\2024\11\24\1124003_PTB_196-059 PH I-11_Hutchison\W008_IL_3101-CADD\02-SHA\0876T69_sht_dplan-010.dgn



USER NAME = jcovarrubias	DESIGNED - MJR	REVISED -
	DRAWN - JC	REVISED -
PLOT SCALE = 0.16666633' / in.	CHECKED - ERO	REVISED -
PLOT DATE = 6/27/2024	DATE - 6/27/2024	REVISED -

STATE OF ILLINOIS
 DEPARTMENT OF TRANSPORTATION

FAP 312 (IL ROUTE 3)
 ROADWAY PLAN

SCALE: 1"=50' SHEET 10 OF 19 SHEETS STA. 280+00.00 TO STA. 310+00.00

F.A.P. RTE.	SECTION	COUNTY	TOTAL SHEETS	SHEET NO.
312	(119-1)RS-3, (121,122)RS-5	RANDOLPH	33	22
CONTRACT NO. 76T69				
ILLINOIS FED. AID PROJECT				

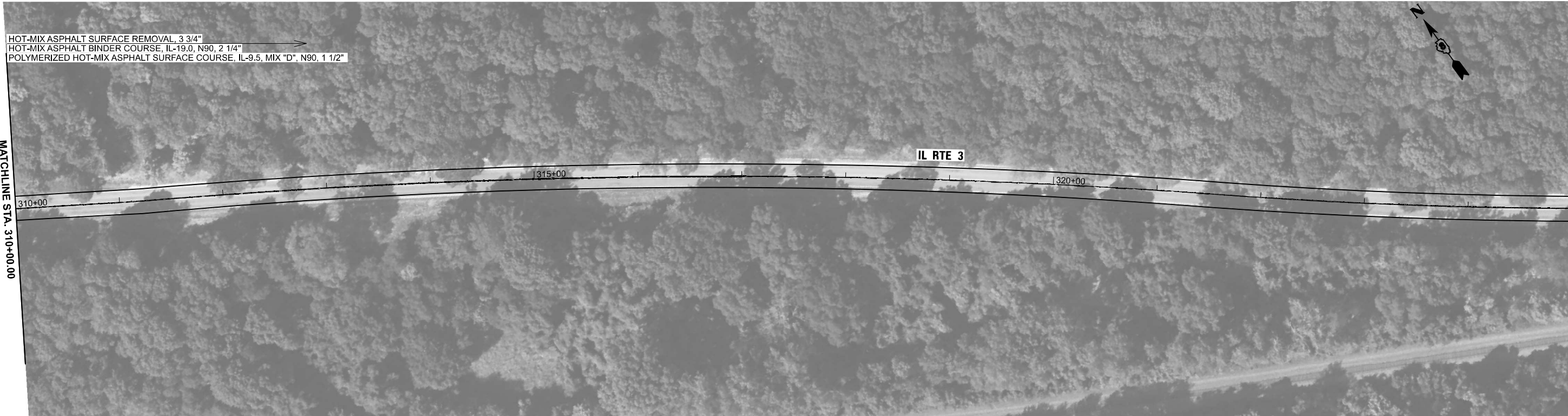

MATCHLINE STA. 310+00.00

MATCHLINE STA. 325+00.00



MATCHLINE STA. 325+00.00

MATCHLINE STA. 340+00.00

MODEL: D876T69_sht_dplan-011
FILE NAME: P:\2024\11E\4003_PTB_198-059 PH I-11_Hutchison\WO08_IL_310-CADD\02-SHA\0876T69_sht_dplan-011.dgn



USER NAME = jcovarrubias	DESIGNED - MJR	REVISED -
	DRAWN - JC	REVISED -
PLOT SCALE = 0.16666633' / in.	CHECKED - ERO	REVISED -
PLOT DATE = 6/27/2024	DATE - 6/27/2024	REVISED -

**STATE OF ILLINOIS
DEPARTMENT OF TRANSPORTATION**

**FAP 312 (IL ROUTE 3)
ROADWAY PLAN**

SCALE: 1"=50' SHEET 11 OF 19 SHEETS STA. 310+00.00 TO STA. 340+00.00

F.A.P. RTE.	SECTION	COUNTY	TOTAL SHEETS	SHEET NO.
312	(119-1)RS-3, (121,122)RS-5	RANDOLPH	33	23
CONTRACT NO. 76T69				
ILLINOIS FED. AID PROJECT				

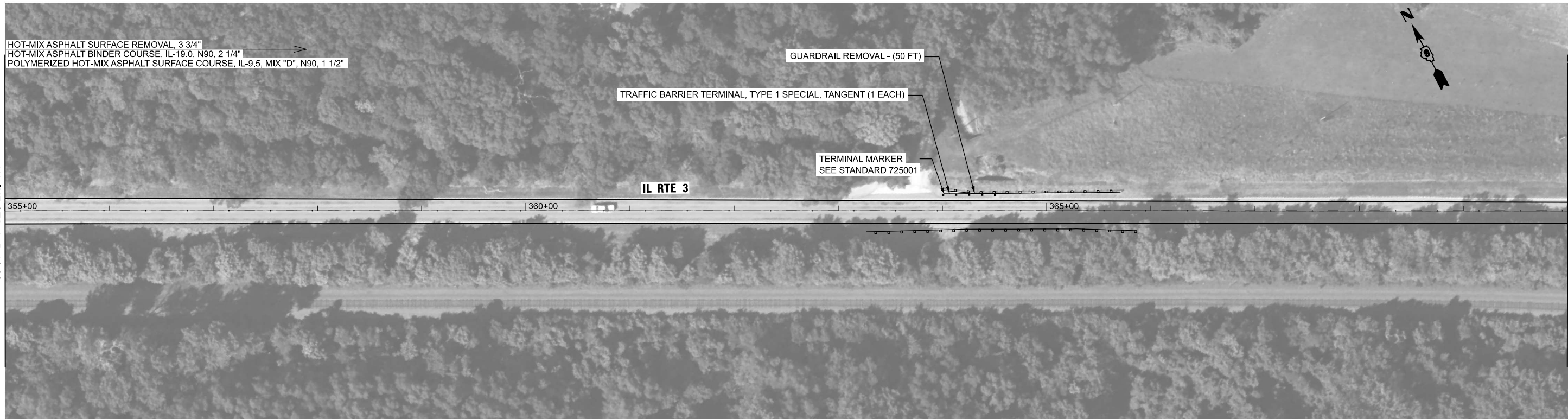

MODEL: D876T69_sht_dplan-012
 FILE NAME: P:\2024\1E\4003_PTB_196-059 PH I-11_Hutchison\W008_IL_3101-CADD\02-SHA\0876T69_sht_dplan-012.dgn



USER NAME = jcovarrubias	DESIGNED - MJR	REVISED -
	DRAWN - JC	REVISED -
PLOT SCALE = 0.16666633' / in.	CHECKED - ERO	REVISED -
PLOT DATE = 6/27/2024	DATE - 6/27/2024	REVISED -

**STATE OF ILLINOIS
 DEPARTMENT OF TRANSPORTATION**

**FAP 312 (IL ROUTE 3)
 ROADWAY PLAN**

SCALE: 1"=50' SHEET 12 OF 19 SHEETS STA. 340+00.00 TO STA. 370+00.00

F.A.P. RTE.	SECTION	COUNTY	TOTAL SHEETS	SHEET NO.
312	(119-1)RS-3, (121,122)RS-5	RANDOLPH	33	24
CONTRACT NO. 76T69				
ILLINOIS FED. AID PROJECT				



MATCHLINE STA. 370+00.00

MATCHLINE STA. 385+00.00

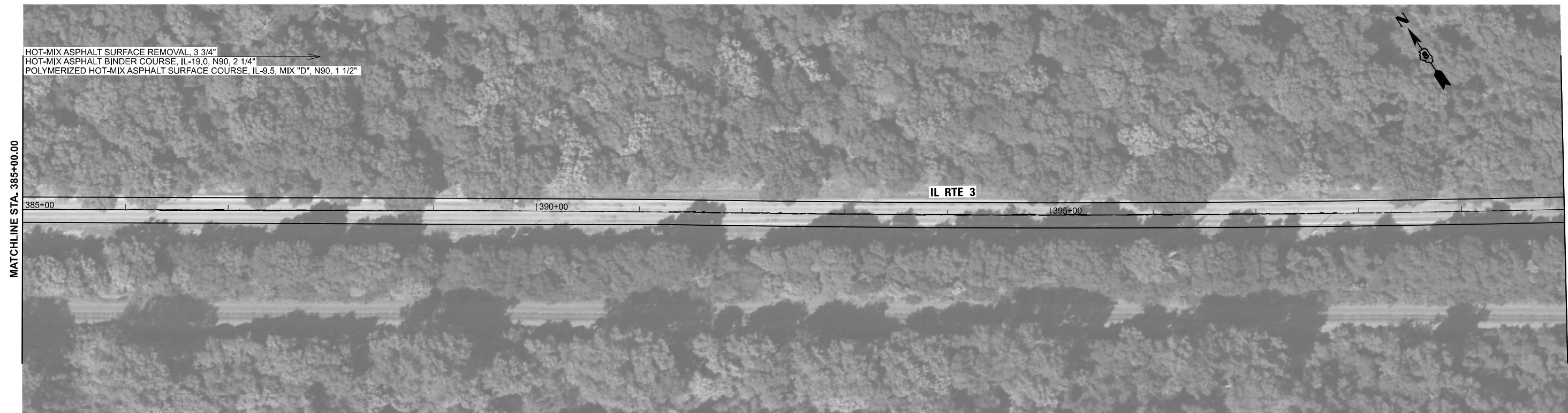

MATCHLINE STA. 385+00.00

MATCHLINE STA. 400+00.00

MODEL: D876T69_sht_dplan-013
FILE NAME: P:\2024\11E\4003_PTB_196-059 PH I-11_Hutchison\W008_IL_3101-CADD\02-SHA\0876T69_sht_dplan-013.dgn



USER NAME = jcovarrubias	DESIGNED - MJR	REVISED -
	DRAWN - JC	REVISED -
PLOT SCALE = 0.16666633' / in.	CHECKED - ERO	REVISED -
PLOT DATE = 6/27/2024	DATE - 6/27/2024	REVISED -

**STATE OF ILLINOIS
DEPARTMENT OF TRANSPORTATION**

**FAP 312 (IL ROUTE 3)
ROADWAY PLAN**

SCALE: 1"=50' SHEET 13 OF 19 SHEETS STA. 370+00.00 TO STA. 400+00.00

F.A.P. RTE.	SECTION	COUNTY	TOTAL SHEETS	SHEET NO.
312	(119-1)RS-3, (121,122)RS-5	RANDOLPH	33	25
CONTRACT NO. 76T69			ILLINOIS FED. AID PROJECT	

HOT-MIX ASPHALT SURFACE REMOVAL, 3 3/4"
 HOT-MIX ASPHALT BINDER COURSE, IL-19.0, N90, 2 1/4"
 POLYMERIZED HOT-MIX ASPHALT SURFACE COURSE, IL-9.5, MIX "D", N90, 1 1/2"



MATCHLINE STA. 400+00.00



MATCHLINE STA. 415+00.00

HOT-MIX ASPHALT SURFACE REMOVAL, 3 3/4"
 HOT-MIX ASPHALT BINDER COURSE, IL-19.0, N90, 2 1/4"
 POLYMERIZED HOT-MIX ASPHALT SURFACE COURSE, IL-9.5, MIX "D", N90, 1 1/2"



MATCHLINE STA. 415+00.00



MATCHLINE STA. 430+00.00

MODEL: D876T69_sht_dplan-014
 FILE NAME: P:\2024\11E\4003_PTB_196-059 PH I-11_Hutchison\W008_IL_3101-CADD\02-SHA\0876T69_sht_dplan-014.dgn



USER NAME = jcovarrubias	DESIGNED - MJR	REVISED -
	DRAWN - JC	REVISED -
PLOT SCALE = 0.16666633' / in.	CHECKED - ERO	REVISED -
PLOT DATE = 6/27/2024	DATE - 6/27/2024	REVISED -

STATE OF ILLINOIS
 DEPARTMENT OF TRANSPORTATION

FAP 312 (IL ROUTE 3)
 ROADWAY PLAN

SCALE: 1"=50' SHEET 14 OF 19 SHEETS STA. 400+00.00 TO STA. 430+00.00

F.A.P. RTE.	SECTION	COUNTY	TOTAL SHEETS	SHEET NO.
312	(119-1)RS-3, (121,122)RS-5	RANDOLPH	33	26
CONTRACT NO. 76T69				
ILLINOIS FED. AID PROJECT				



MODEL: D876T69_sht_dplan-015
 FILE NAME: P:\2024\11E\4003_PTB_198-059 PH 111_Hutchison\W008_IL_3101-CADD\02-SHA\0876T69_sht_dplan-015.dgn



USER NAME = jcovarrubias	DESIGNED - MJR	REVISED -
	DRAWN - JC	REVISED -
PLOT SCALE = 0.16666633' / in.	CHECKED - ERO	REVISED -
PLOT DATE = 6/27/2024	DATE - 6/27/2024	REVISED -

STATE OF ILLINOIS
 DEPARTMENT OF TRANSPORTATION

FAP 312 (IL ROUTE 3)
 ROADWAY PLAN

SCALE: 1"=50' SHEET 15 OF 19 SHEETS STA. 430+00.00 TO STA. 460+00.00

F.A.P. RTE.	SECTION	COUNTY	TOTAL SHEETS	SHEET NO.
312	(119-1)RS-3, (121,122)RS-5	RANDOLPH	33	27
CONTRACT NO. 76T69				
ILLINOIS FED. AID PROJECT				

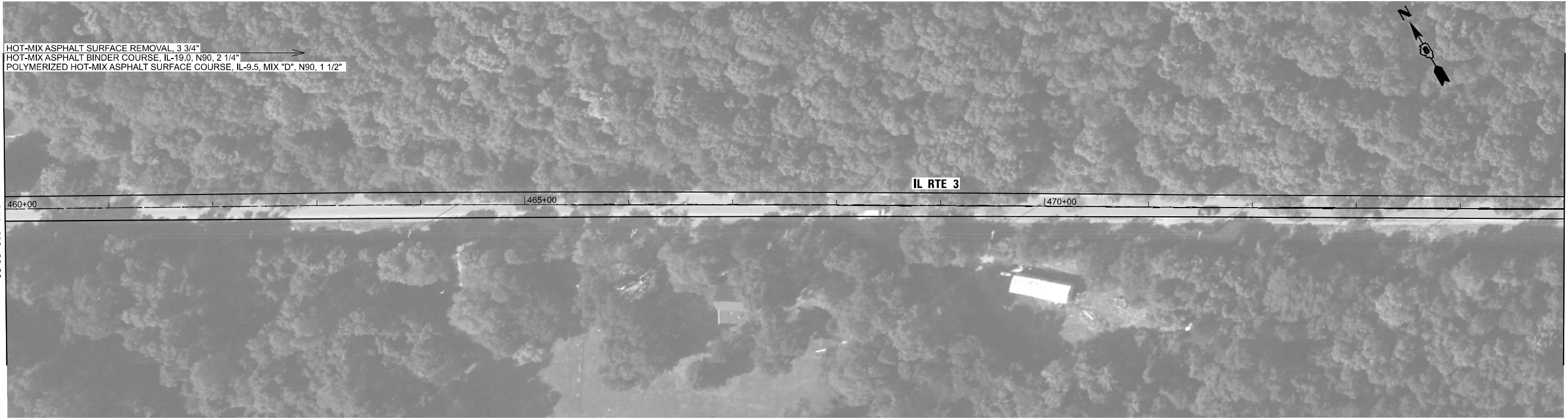

MATCHLINE STA. 460+00.00

MATCHLINE STA. 475+00.00

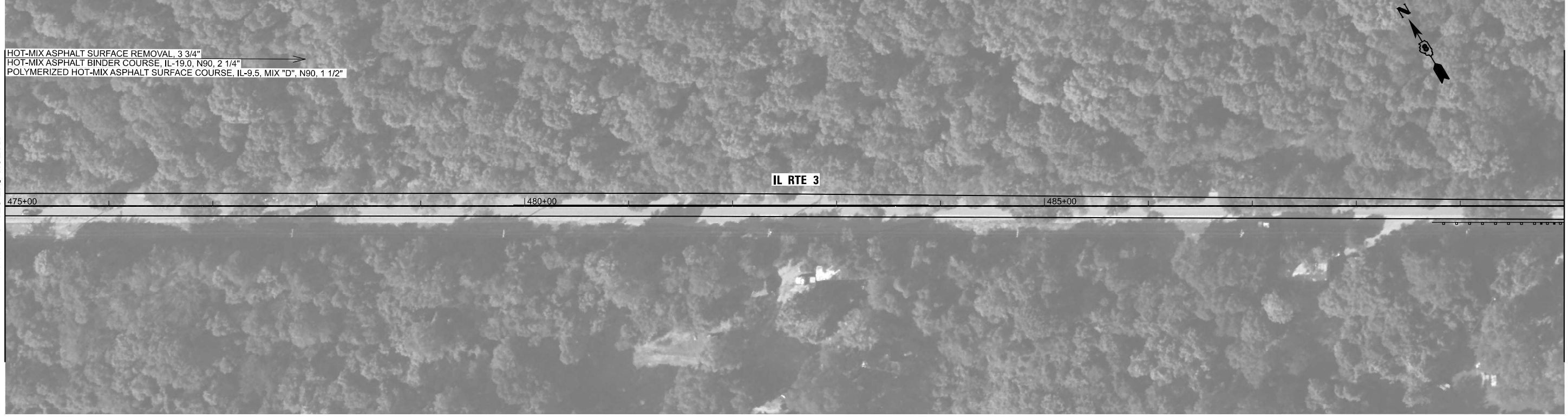

MATCHLINE STA. 475+00.00

MATCHLINE STA. 490+00.00

MODEL: D876T69_sht_dplan-016
FILE NAME: P:\2024\ME\4003_PTB_196-059 PH I-11_Hutchison\W008_IL_3\01-CADD\02-SHA\0876T69_sht_dplan-016.dgn



USER NAME = jcovarrubias	DESIGNED - MJR	REVISED -
	DRAWN - JC	REVISED -
PLOT SCALE = 0.16666633' / in.	CHECKED - ERO	REVISED -
PLOT DATE = 6/27/2024	DATE - 6/27/2024	REVISED -

**STATE OF ILLINOIS
DEPARTMENT OF TRANSPORTATION**

**FAP 312 (IL ROUTE 3)
ROADWAY PLAN**

SCALE: 1"=50' SHEET 16 OF 19 SHEETS STA. 460+00.00 TO STA. 490+00.00

F.A.P. RTE.	SECTION	COUNTY	TOTAL SHEETS	SHEET NO.
312	(119-1)RS-3, (121,122)RS-5	RANDOLPH	33	28
CONTRACT NO. 76T69				
ILLINOIS FED. AID PROJECT				

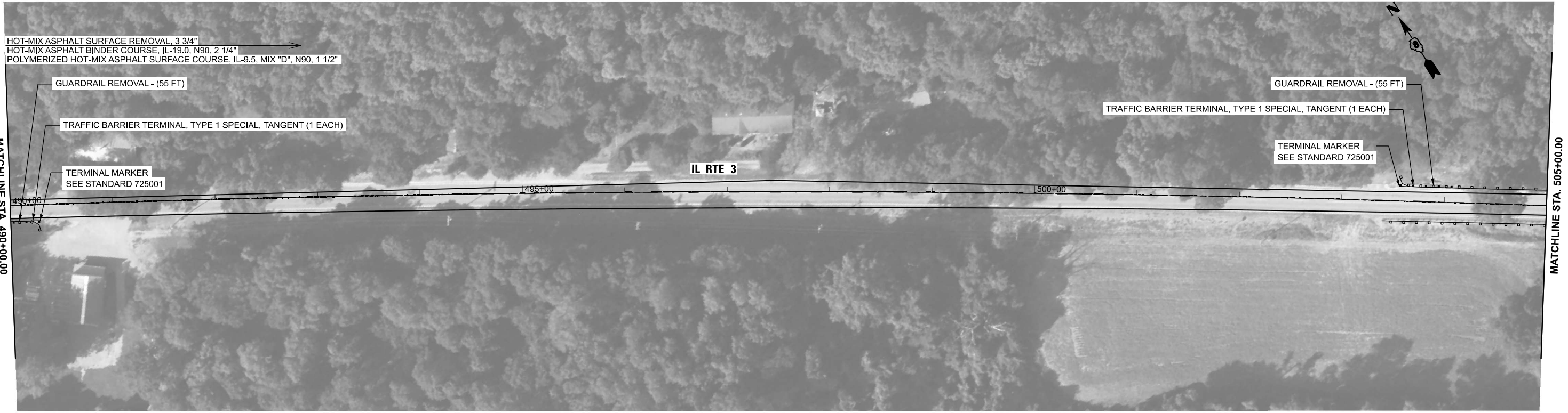

MODEL: D876T69_sht_dplan-017
 FILE NAME: P:\2024\1E\4003_PTB_196-059 PH I-11_Hutchison\W008_IL_3101-CADD\02-Shts\0876T69_sht_dplan-017.dgn



USER NAME = jcovarrubias	DESIGNED - MJR	REVISED -
DRAWN - JC	REVISIONS -	
PLOT SCALE = 0.16666633' / in.	CHECKED - ERO	REVISED -
PLOT DATE = 6/27/2024	DATE - 6/27/2024	REVISED -

STATE OF ILLINOIS
DEPARTMENT OF TRANSPORTATION

FAP 312 (IL ROUTE 3)
ROADWAY PLAN

SCALE: 1"=50' SHEET 17 OF 19 SHEETS STA. 490+00.00 TO STA. 520+00.00

F.A.P. RTE.	SECTION	COUNTY	TOTAL SHEETS	SHEET NO.
312	(119-1)RS-3, (121,122)RS-5	RANDOLPH	33	29
CONTRACT NO. 76T69				
ILLINOIS FED. AID PROJECT				

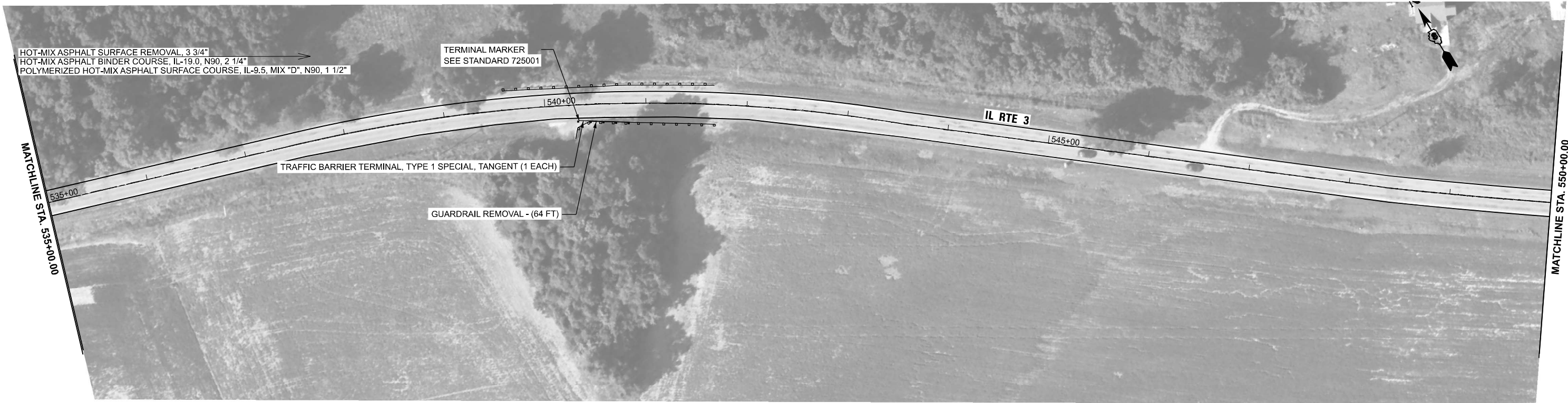

MODEL: D876T69_sht_dplan-018
 FILE NAME: P:\2024\ME\4003_PTB_198-059 PH I-I_Hutchison\W008_IL_3101-CADD\02-SHA\0876T69_sht_dplan-018.dgn



USER NAME = jcovarrubias	DESIGNED - MJR	REVISED -
DRAWN - JC	REVISED -	
PLOT SCALE = 0.16666633' / in.	CHECKED - ERO	REVISED -
PLOT DATE = 6/27/2024	DATE - 6/27/2024	REVISED -

**STATE OF ILLINOIS
DEPARTMENT OF TRANSPORTATION**

**FAP 312 (IL ROUTE 3)
ROADWAY PLAN**

SCALE: 1"=50' SHEET 18 OF 19 SHEETS STA. 520+00.00 TO STA. 550+00.00

F.A.P. RTE.	SECTION	COUNTY	TOTAL SHEETS	SHEET NO.
312	(119-1)RS-3, (121,122)RS-5	RANDOLPH	33	30
CONTRACT NO. 76T69				
ILLINOIS FED. AID PROJECT				

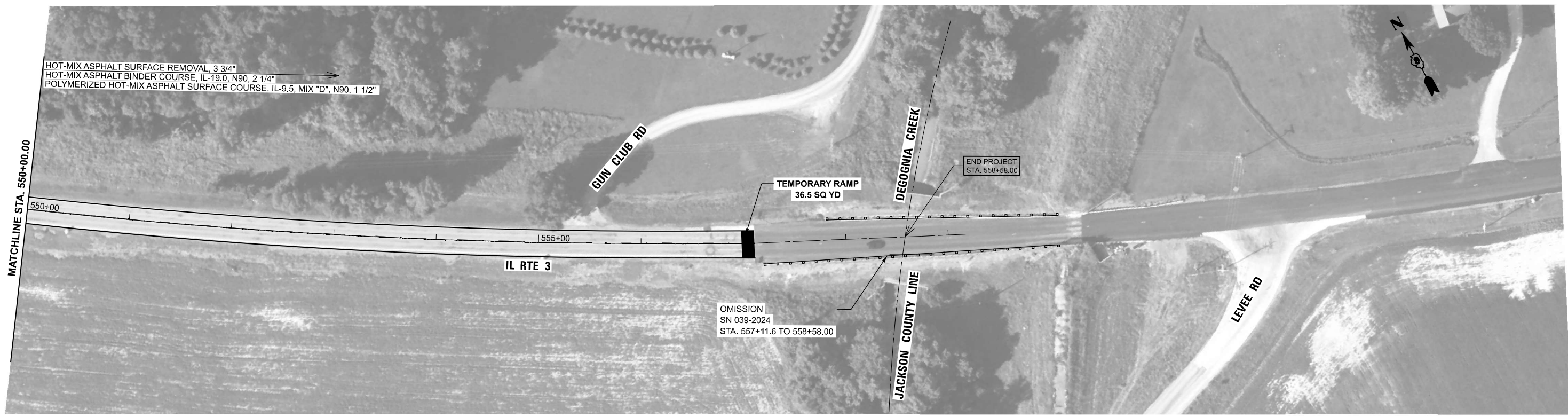

MODEL: D876T69_sht_dplan-019
 FILE NAME: P:\2024\ME\4003_PTB_196-059 PH I.H. Hutchison\W008_IL_3101-CADD\02-SHA\0876T69_sht_dplan-019.dgn



USER NAME = jcovarrubias	DESIGNED - MJR	REVISED -
	DRAWN - JC	REVISED -
PLOT SCALE = 0.16666633' / in.	CHECKED - ERO	REVISED -
PLOT DATE = 6/27/2024	DATE - 6/27/2024	REVISED -

**STATE OF ILLINOIS
 DEPARTMENT OF TRANSPORTATION**

**FAP 312 (IL ROUTE 3)
 ROADWAY PLAN**

SCALE: 1"=50' SHEET 19 OF 19 SHEETS STA. 550+00.00 TO STA. 565+00.00

F.A.P. RTE.	SECTION	COUNTY	TOTAL SHEETS	SHEET NO.
312	(119-1)RS-3, (121,122)RS-5	RANDOLPH	33	31
CONTRACT NO. 76T69				
ILLINOIS FED. AID PROJECT				

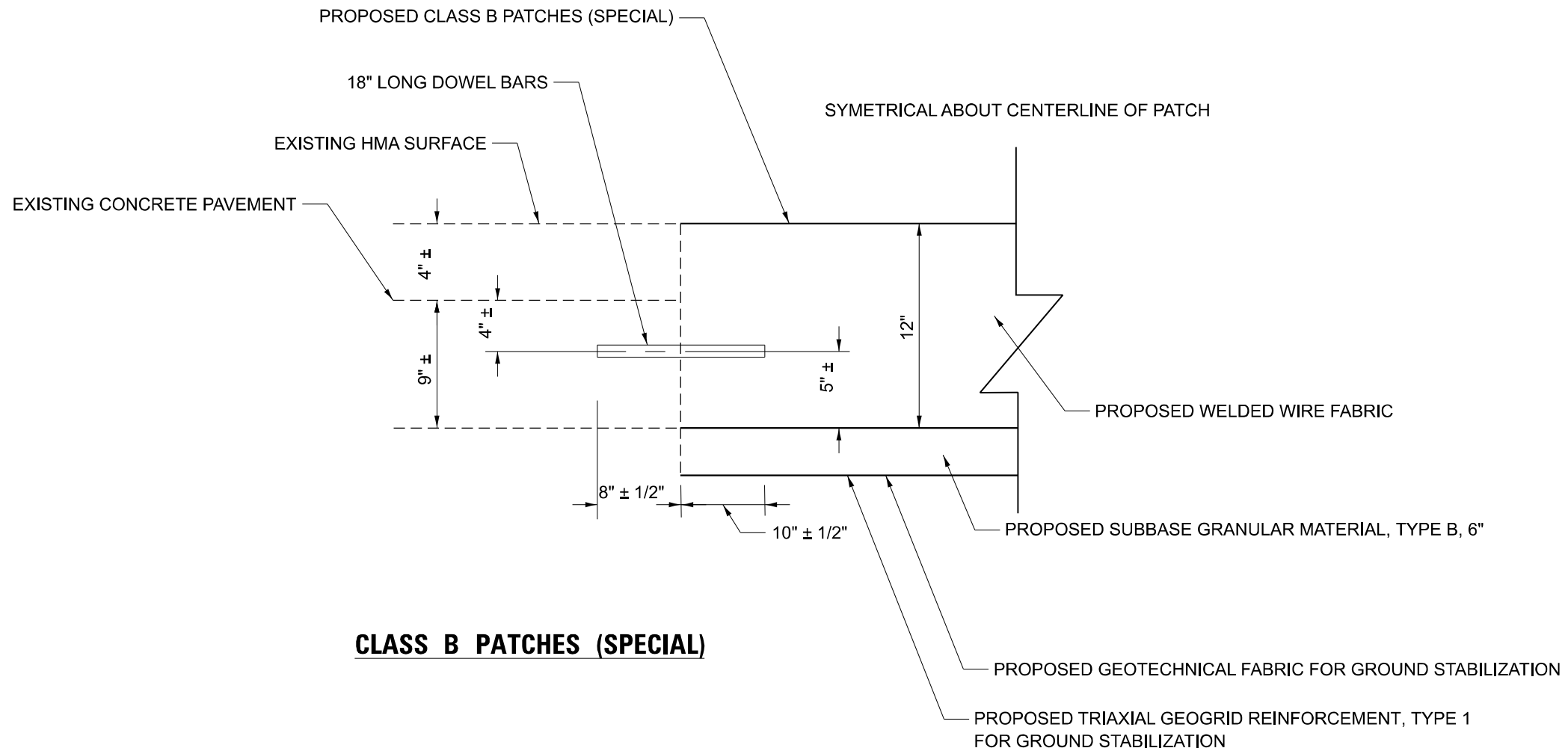

MODEL: D876T69_sht_detail001
 FILE NAME: P:\2024\ME\4003_PTB_196-059 PH I-11_Hutchison\W008_IL_3101-CADD\02-Sha\0876T69_sht_detail001.dgn



USER NAME = jcovarrubias	DESIGNED - MJR	REVISED -
	DRAWN - JC	REVISED -
PLOT SCALE = 0.16666633' / in.	CHECKED - ERO	REVISED -
PLOT DATE = 6/27/2024	DATE - 6/27/2024	REVISED -

STATE OF ILLINOIS
DEPARTMENT OF TRANSPORTATION

FAP 312 (IL ROUTE 3)
CLASS B PATCHES (SPECIAL) DETAIL

SCALE: 1"=50' SHEET 1 OF 1 SHEETS STA. TO STA.

F.A.P. RTE.	SECTION	COUNTY	TOTAL SHEETS	SHEET NO.
312	(119-1)RS-3,(121,122)RS-5	RANDOLPH	33	32
CONTRACT NO. 76T69				
ILLINOIS FED. AID PROJECT				