

STATE OF ILLINOIS
DEPARTMENT OF TRANSPORTATION

F.A. RTE.	SECTION	COUNTY	TOTAL SHEETS	SHEET NO.
	D9 HMA RES FY25-1	JACKSON	22	1
		ILLINOIS	CONTRACT NO. 78A66	

*FAS 919/CH 29

D-99-045-24



FOR INDEX OF SHEETS, SEE SHEET NO. 3
FOR SUMMARY OF QUANTITIES, SEE SHEET NO. 5-7

PROPOSED HIGHWAY PLANS

FAS 919/CH 29 ROUTE (MAKANDA RD)
SECTION D9 HMA RES FY25-1
PROJECT STP-ZNVZ(904)
HMA RESURFACING
JACKSON COUNTY

C-99-092-24

2022 TRAFFIC DATA

FAS 919 ADT=325 WITH 4.0% TRUCKS
CH 29 ADT=275 WITH 3.6% TRUCKS

TOWNSHIPS
MAKANDA

STATION EQUATIONS

STA. 85+09.23 BK TO STA. -0+44.77 AH
STA. 3+27.40 BK TO STA. 2+28.10 AH

OMISSIONS

STA. 3+06.7 TO STA. 3+27.4 BK (BRIDGE OMISSION)
STA. 2+28.1 AH TO STA. 4+43.82 (BRIDGE OMISSION)
STA. 5.47.17 TO STA. 5+55.64 (RAILROAD OMISSION)

POSTED SPEED : 35 MPH, 55 MPH

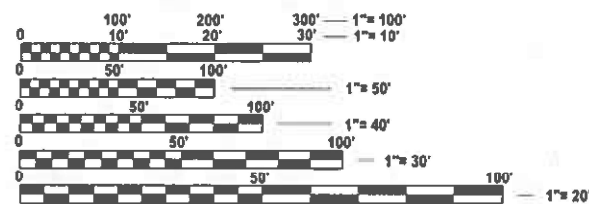

FULL SIZE PLANS HAVE BEEN PREPARED USING STANDARD ENGINEERING SCALES. REDUCED SIZED PLANS WILL NOT CONFORM TO STANDARD SCALES. IN MAKING MEASUREMENTS ON REDUCED PLANS, THE ABOVE SCALES MAY BE USED.

J.U.L.I.E.
JOINT UTILITY LOCATION INFORMATION FOR EXCAVATION
1-800-892-0123
OR 811

PROJECT ENGINEER NATHAN TAYLOR
PROJECT DESIGNER DACODA BLOCKLEY

CONTRACT NO. 78A66

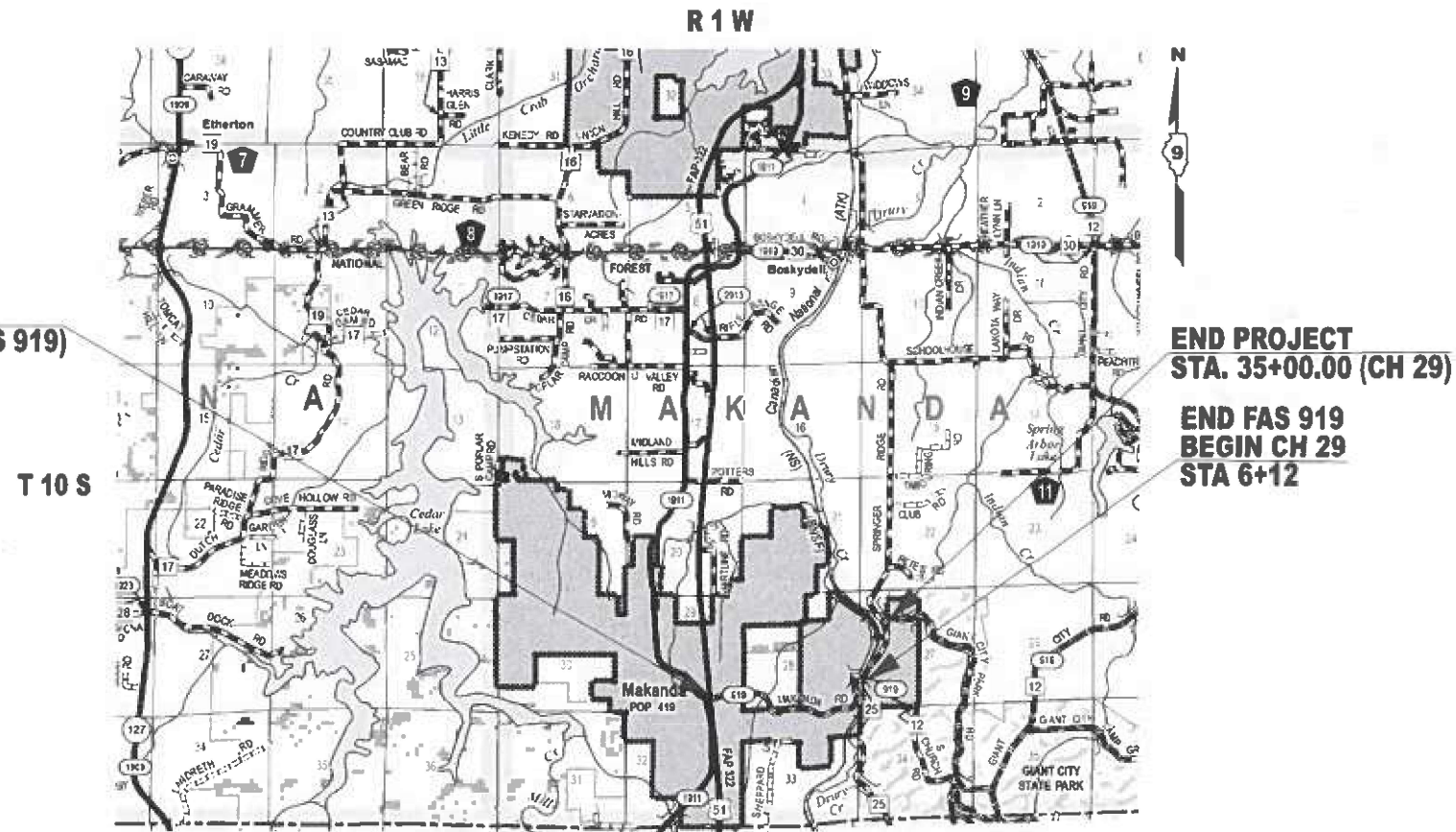

GROSS LENGTH = 12,056 FT. = 2.28 MILE
NET LENGTH = 11,811 FT. = 2.24 MILE

STATE OF ILLINOIS
DEPARTMENT OF TRANSPORTATION

SUBMITTED July 1 20 24
K. H. [Signature]
REGIONAL ENGINEER

August 16, 2024
[Signature]
ENGINEER OF DESIGN AND ENVIRONMENT

August 16, 2024
[Signature]
DIRECTOR OF HIGHWAYS PROJECT IMPLEMENTATION

PRINTED BY THE AUTHORITY
OF THE STATE OF ILLINOIS

MODEL: 02-Signature [Sheet]
FILE NAME: c:\pwworking\114161\mid0174122\0978A66-Sh1A-Cover_Sht.dgn

Prepared By: Susan Pa
DISTRICT STUDIES & PLANS ENGINEER

Examined By: Nancy Hee
DISTRICT LAND ACQUISITION ENGINEER

Examined By: Car Nelson
DISTRICT PROGRAM DEVELOPMENT ENGINEER

Examined By: [Signature]
DISTRICT OPERATIONS ENGINEER

Examined By: Doris J. Melnick
DISTRICT PROJECT IMPLEMENTATION ENGINEER

Examined By: Doris J. Melnick
DISTRICT CONSTRUCTION ENGINEER

Examined By: _____
DISTRICT MATERIALS ENGINEER

USER NAME = Nathan Taylor	DESIGNED -	REVISED -
	DRAWN -	REVISED -
	CHECKED -	REVISED -
PLOT DATE = 6/28/2024	DATE -	REVISED -

STATE OF ILLINOIS
DEPARTMENT OF TRANSPORTATION

SIGNATURE SHEET

SCALE: SHEET 2 OF 22 SHEETS STA. TO STA.

F.A. RTE.	SECTION	COUNTY	TOTAL SHEETS	SHEET NO.
*	D9 HMA RES FY25-1	JACKSON	22	2
			CONTRACT NO. 78A66	
			ILLINOIS FED. AID PROJECT	

HIGHWAY STANDARDS

- 000001-08 STANDARD SYMBOLS, ABBREVIATIONS AND PATTERNS
- 001001-02 AREAS OF REINFORCEMENT BARS
- 001006 DECIMAL OF AN INCH AND OF A FOOT
- 406201-01 MAILBOX TURNOUT
- 442201-03 CLASS C & D PATCHES
- 630001-13 STEEL PLATE BEAM GUARDRAIL
- 630301-09 SHOULDER WIDENING FOR TYPE 1 (SPECIAL) GUARDRAIL TERMINALS
- 701001-02 OFF-ROAD OPERATIONS, 2L, 2W, MORE THAN 15 FT AWAY
- 701006-05 OFF-ROAD OPERATIONS, 2L, 2W, 15 FT TO 24 IN FROM PAVEMENT EDGE
- 701201-05 LANE CLOSURE, 2L, 2W, DAY ONLY, FOR SPEEDS 45 MPH OR MORE
- 701301-04 LANE CLOSURE, 2L, 2W, SHORT TIME OPERATIONS
- 701306-04 LANE CLOSURE, 2L, 2W, SLOW MOVING OPERATIONS DAY ONLY, FOR SPEEDS 45 MPH OR MORE
- 701311-03 LANE CLOSURE, 2L, 2W, MOVING OPERATIONS - DAY ONLY
- 701336-07 LANE CLOSURE, 2L, 2W, WORK AREAS IN SERIES, FOR SPEEDS 45MPH OR MORE
- 701501-06 URBAN LANE CLOSURE, 2L, 2W, UNDIVIDED
- 701901-09 TRAFFIC CONTROL DEVICES
- 725001-01 OBJECT AND TERMINAL MARKERS
- 780001-05 TYPICAL PAVEMENT MARKINGS
- 781001-04 TYPICAL APPLICATIONS RAISED REFLECTIVE PAVEMENT MARKERS
- 782006-01 GUARDRAIL AND BARRIER WALL REFLECTOR MOUNTING DETAILS

INDEX OF SHEETS

SHEET NO	DESCRIPTION
1	COVER SHEET
2	SIGNATURE SHEET
3	INDEX OF SHEETS, HIGHWAY STANDARDS, GENERAL NOTES, COMMITMENTS, MTD CROSSING RESTRICTIONS
4	MIX DESIGN
5-7	SUMMARY OF QUANTITIES
8-10	TYPICAL SECTIONS: MAKANDA ROAD
11-14	SCHEDULES: PAVEMENT, GUARDRAIL, PAVEMENT MARKING, TEMPORARY PAVEMENT MARKING, ENTRANCE AND SIDEROAD
15-18	PLAN SHEETS: MAKANDA ROAD
19-22	DETAILS: HMA TRANSITION, ROUGH GROOVE SURFACE, UNEVEN LANES, ENTRANCE AND SIDEROAD

GENERAL NOTES

FACTORS USED FOR ESTIMATING PLAN QUANTITIES ARE AS FOLLOWS AND SHALL NOT BE USED FOR THE BASIS OF FINAL QUANTITIES:

- ALL HOT MIX ASPHALT 2.016 TONS/CU. YD.
- ALL AGGREGATE 2.05 TONS/CU. YD.

THE QUANTITY OF SHORT TERM PAVEMENT MARKING SHOWN IN THE PLANS IS BASED ON ONE APPLICATION EACH FOR THE HMA SURFACE REMOVAL, BINDER COURSE, AND SURFACE COURSE

HMA RESURFACING SHALL BE PLACED IN A SEQUENCE THAT WILL MINIMIZE THE TIME THE CENTERLINE EDGE IS EXPOSED TO TRAFFIC. WHEN AT THE END OF A DAY'S OPERATION THE EXPOSED CENTERLINE EDGE IS GREATER THAN 2,000 FT, THE CONTRACTOR SHALL BE REQUIRED TO PAVE IN THE ADJACENT LANE ON THE FOLLOWING WORK DAY. PRIOR TO WINTER SHUTDOWN, RESURFACING ON ADJACENT LANES IS TO BE BROUGHT UP TO THE SAME ELEVATION.

LONGITUDINAL JOINT SEALANT SHALL BE PLACED UNDER THE HMA SURFACE COURSE

VIBRATORY ROLLERS WILL NOT BE ALLOWED WITHIN THE CORPORATE LIMITS OF MAKANDA

INCIDENTAL HOT-MIX ASPHALT SURFACING SHALL BE PAVED IN A SEPARATE OPERATION FROM THE MAINLINE PAVEMENT

COMMITMENTS: NONE

REV - MS

MODEL: 03-IndexGen [Sheet]
FILE NAME: c:\pwworking\tdtaylor\jordan\0974122\0978A66-ShtB-Index-GenNotes_MixDesign.dgn

USER NAME = Nathan.Taylor	DESIGNED -	REVISED -	STATE OF ILLINOIS DEPARTMENT OF TRANSPORTATION	INDEX OF SHEETS, HIGHWAY STANDARDS, GENERAL NOTES, AND COMMITMENTS	F.A. RTE.	SECTION	COUNTY	TOTAL SHEETS	SHEET NO.	
	DRAWN -	REVISED -			*	D9 HMA RES FY25-1	JACKSON	22	3	
	CHECKED -	REVISED -			CONTRACT NO. 78A66					
PLOT DATE = 7/5/2024	DATE -	REVISED -			SCALE:	SHEET 3	OF 22	SHEETS	STA.	TO STA.

SUMMARY OF QUANTITIES

COUNTY:	JACKSON CO	JACKSON CO
ROUTE:	FAS 919	CH 29
FUNDING:	80% FEDERAL 20% STATE	80% FEDERAL 20% STATE
LOCATION:	RURAL	RURAL
	ROADWAY	ROADWAY
	0005	0005

CODE NUMBER	ITEM DESCRIPTION	UNIT	TOTAL QUANTITY	ROADWAY 0005	ROADWAY 0005
40600290	BITUMINOUS MATERIALS (TACK COAT)	POUND	19,418	14,611	4,807
40600370	LONGITUDINAL JOINT SEALANT	FOOT	11,947	9,059	2,888
40600990	TEMPORARY RAMP	SQ YD	403	251	152
40603080	HOT-MIX ASPHALT BINDER COURSE, IL-19.0, N50	TON	3,468	2,650	818
40604050	HOT-MIX ASPHALT SURFACE COURSE, IL-9.5, MIX "C", N50	TON	2,308	1,764	544
40800025	BITUMINOUS MATERIALS (PRIME COAT)	POUND	215	68	147
40800050	INCIDENTAL HOT-MIX ASPHALT SURFACING	TON	365	192	173
44000155	HOT-MIX ASPHALT SURFACE REMOVAL, 1 1/2"	SQ YD	24,581	18,681	5,900
44000164	HOT-MIX ASPHALT SURFACE REMOVAL, 3 3/4"	SQ YD	2,294	1,876	418
44201765	CLASS D PATCHES, TYPE II, 10 INCH	SQ YD	68	34	34
44201769	CLASS D PATCHES, TYPE III, 10 INCH	SQ YD	107	57	50
44201771	CLASS D PATCHES, TYPE IV, 10 INCH	SQ YD	370	185	185
48102100	AGGREGATE WEDGE SHOULDER, TYPE B	TON	344	242	102

MODEL: S001 [Sheet]
 FILE NAME: c:\p\work\pav\illinois\pav\mcd\0974122\0978A66-SHIC-SCO.dgn

SUMMARY OF QUANTITIES - CONT

COUNTY:	JACKSON CO	JACKSON CO
ROUTE:	FAS 919	CH 29
FUNDING:	80% FEDERAL 20% STATE	80% FEDERAL 20% STATE
LOCATION:	RURAL	RURAL
	ROADWAY	ROADWAY
	0005	0005

CODE NUMBER	ITEM DESCRIPTION	UNIT	TOTAL QUANTITY	ROADWAY 0005	ROADWAY 0005
* 6300003	STEEL PLATE BEAM GUARDRAIL, TYPE A, 9 FOOT POSTS	FOOT	1,839	1,839	
* 63100167	TRAFFIC BARRIER TERMINAL, TYPE 1 (SPECIAL) TANGENT	EACH	10	10	
63200310	GUARDRAIL REMOVAL	FOOT	1,914	1,914	
67000400	ENGINEER'S FIELD OFFICE, TYPE A	CAL MO	8	4	4
67100100	MOBILIZATION	L SUM	1	0.5	0.5
70100450	TRAFFIC CONTROL AND PROTECTION, STANDARD 701201	L SUM	1	0.5	0.5
70100460	TRAFFIC CONTROL AND PROTECTION, STANDARD 701306	L SUM	1	0.5	0.5
70100600	TRAFFIC CONTROL AND PROTECTION, STANDARD 701336	L SUM	1	0.5	0.5
70102620	TRAFFIC CONTROL AND PROTECTION, STANDARD 701501	L SUM	1	0.5	0.5
70107025	CHANGEABLE MESSAGE SIGN	CAL DA	28	14	14
70300100	SHORT TERM PAVEMENT MARKING	FOOT	9,339	5,766	3,573
70300150	SHORT TERM PAVEMENT MARKING REMOVAL	SQ FT	2,939	1,748	1,191
70300211	TEMPORARY PAVEMENT MARKING LETTERS AND SYMBOLS - PAINT	SQ FT	130	65	65

* SPECIALTY ITEM

MODEL: SQ02 (Sheet)
FILE NAME: c:\p\work\pav\illinois\pav\mcd\0974122\0978A66-SHIC-SQ0.dgn

USER NAME = Nathan.Taylor	DESIGNED -	REVISED -	STATE OF ILLINOIS DEPARTMENT OF TRANSPORTATION	SUMMARY OF QUANTITIES				F.A. RTE.	SECTION	COUNTY	TOTAL SHEETS	SHEET NO.
	DRAWN -	REVISED -		SCALE:	SHEET 6	OF 22	SHEETS	STA.	TO STA.	JACKSON	22	6
	CHECKED -	REVISED -						ILLINOIS		CONTRACT NO. 78A66		
PLOT DATE = 7/5/2024	DATE -	REVISED -						FED. AID PROJECT				

SUMMARY OF QUANTITIES - CONT

COUNTY:	JACKSON CO	JACKSON CO
ROUTE:	FAS 919	CH 29
FUNDING:	80% FEDERAL 20% STATE	80% FEDERAL 20% STATE
LOCATION:	RURAL	RURAL
	ROADWAY	ROADWAY
	0005	0005

CODE NUMBER	ITEM DESCRIPTION	UNIT	TOTAL QUANTITY	ROADWAY 0005	ROADWAY 0005
70300221	TEMPORARY PAVEMENT MARKING - LINE 4"- PAINT	FOOT	43,681	36,953	6,728
70300281	TEMPORARY PAVEMENT MARKING - LINE 24"- PAINT	FOOT	94	70	24
* 72501000	TERMINAL MARKER - DIRECT APPLIED	EACH	10	10	
* 78001100	PAINT PAVEMENT MARKING - LETTERS AND SYMBOLS	SQ FT	130	65	65
* 78001110	PAINT PAVEMENT MARKING - LINE 4"	FOOT	43,681	36,953	6,728
* 78001180	PAINT PAVEMENT MARKING - LINE 24"	FOOT	94	70	24
* 78100100	RAISED REFLECTIVE PAVEMENT MARKER	EACH	152	115	37
* 78200005	GUARDRAIL REFLECTORS, TYPE A	EACH	37	37	
78300201	PAVEMENT MARKING REMOVAL - GRINDING	SQ FT	14,884	12,527	2,357
X4401198	HOT-MIX ASPHALT SURFACE REMOVAL, VARIABLE DEPTH	SQ YD	359	259	100
Z0034105	MATERIAL TRANSFER DEVICE	TON	5,776	4,414	1,362
Z0048665	RAILROAD PROTECTIVE LIABILITY INSURANCE	L SUM	1	1	

* SPECIALTY ITEM

MODEL: SQ03 (Sheet)
FILE NAME: c:\p\work\pavement\pavement\0974122\0978A66-SHIC-SQ03.dgn

MAKANDA RD STATIONING

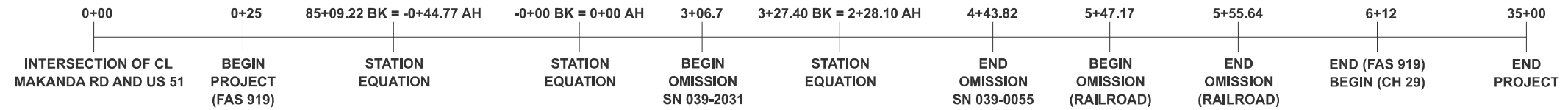

* MATCH EXISTING SLOPE

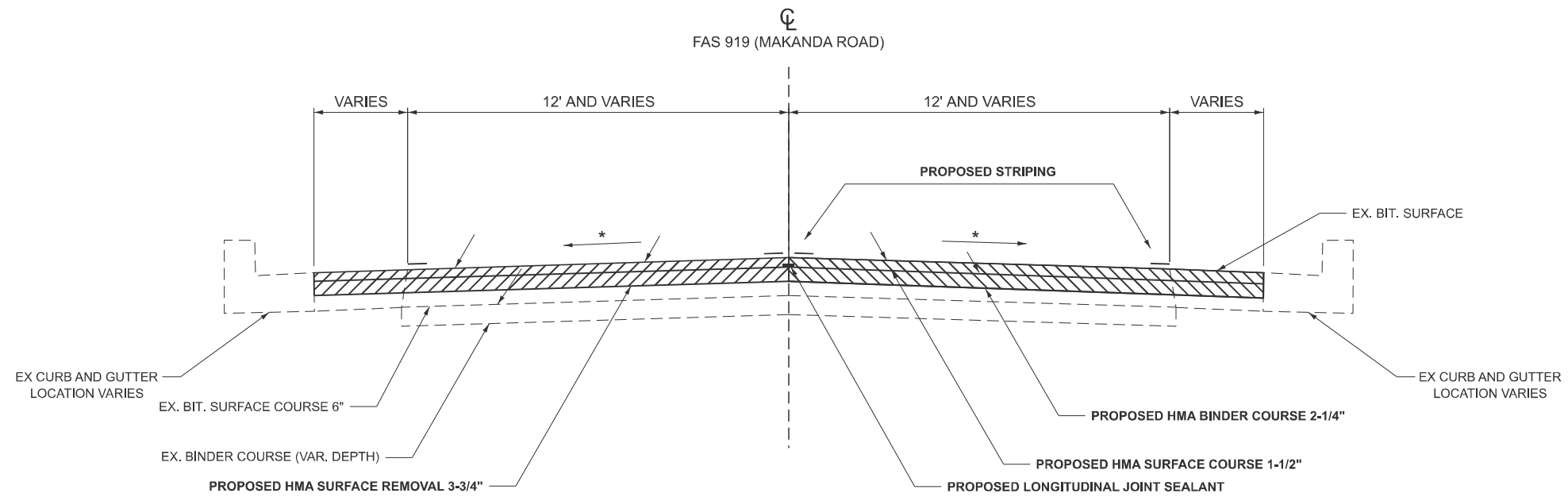

TYPICAL SECTION

TO BE USED:
STA. 0+25 TO STA. 1+20

MODEL: TYP (Sheet)
FILE NAME: c:\p\work\project\makanda\typical.dgn

USER NAME = Nathan.Taylor	DESIGNED -	REVISED -
	DRAWN -	REVISED -
	CHECKED -	REVISED -
PLOT DATE = 7/5/2024	DATE -	REVISED -

**STATE OF ILLINOIS
DEPARTMENT OF TRANSPORTATION**

TYPICAL SECTIONS

SCALE: SHEET 8 OF 22 SHEETS STA. TO STA.

F.A. RTE.	SECTION	COUNTY	TOTAL SHEETS	SHEET NO.
*	D9 HMA RES FY25-1	JACKSON	22	8
CONTRACT NO. 78A66				
		ILLINOIS	FED. AID PROJECT	

*FAS 919/CH 29

FAS 919/CH 29 (MAKANDA ROAD)

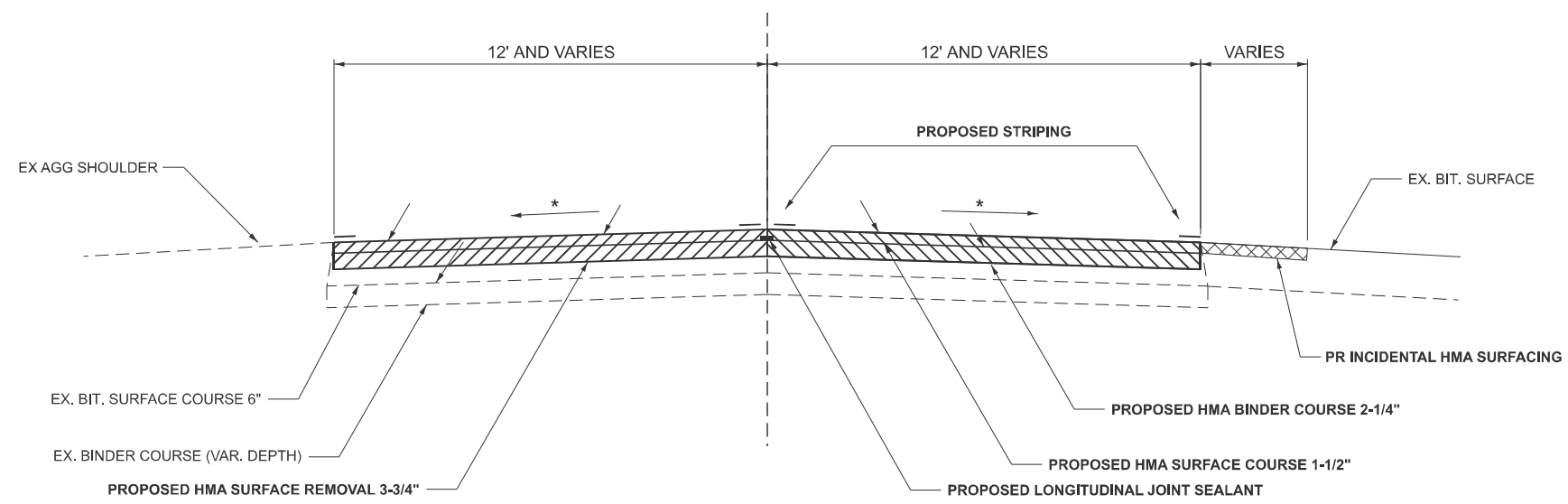

TYPICAL SECTION

TO BE USED:
 STA. 5+55.64 (RR X-ING) TO STA. 6+12 (FAS 919)
 STA. 6+12 TO STA. 8+00 (CH 29)

CH 29 (MAKANDA ROAD)

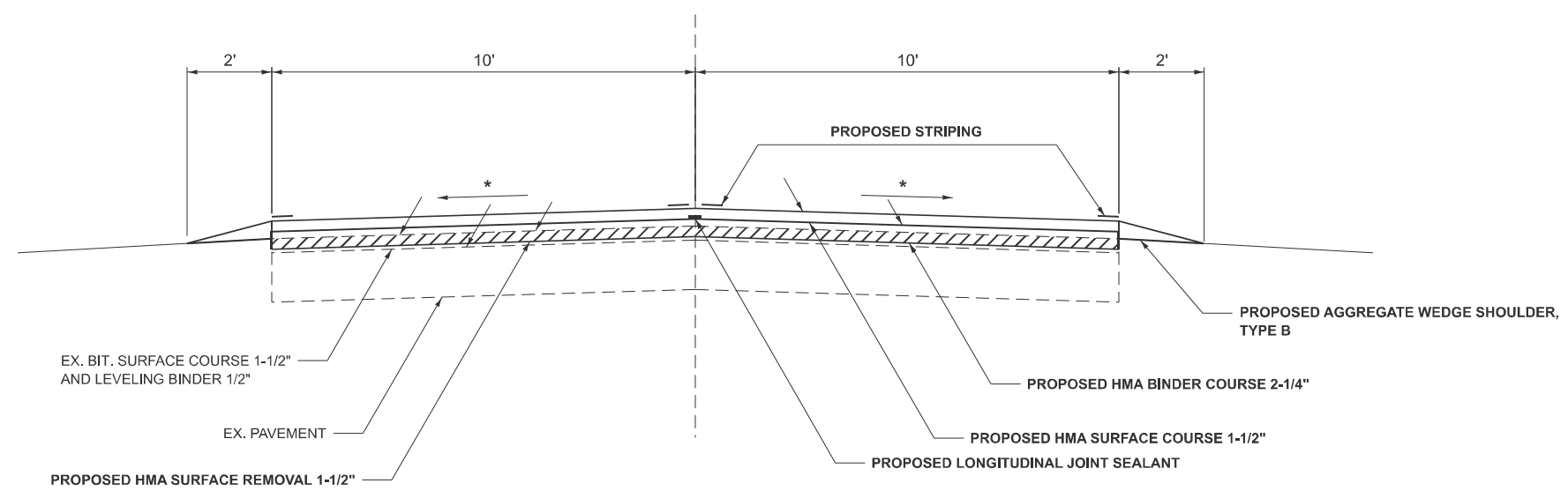

TYPICAL SECTION

TO BE USED:
 STA. 8+00 TO STA. 35+00

* MATCH EXISTING SLOPE

* MATCH EXISTING SLOPE

MODEL: TYP3 (Sheet)
 FILE NAME: c:\p\work\project\typical\mcd\0974122\0978A66-Shd-Typicals.dgn

USER NAME = Nathan.Taylor	DESIGNED -	REVISED -
	DRAWN -	REVISED -
	CHECKED -	REVISED -
PLOT DATE = 7/5/2024	DATE -	REVISED -

**STATE OF ILLINOIS
 DEPARTMENT OF TRANSPORTATION**

TYPICAL SECTIONS

SCALE: SHEET 10 OF 22 SHEETS STA. TO STA.

F.A. RTE.	SECTION	COUNTY	TOTAL SHEETS	SHEET NO.
*	D9 HMA RES FY25-1	JACKSON	22	10
CONTRACT NO. 78A66				
ILLINOIS FED. AID PROJECT				

*FAS 919/CH 29

PAVEMENT MARKING SCHEDULE

LOCATION STA TO STA					ROADWAY LENGTH	PAINT PAVEMENT MARKING					RAISED REFLECTIVE PAVEMENT MARKER	COMMENTS
						LINE - 4" WHITE	LINE - 4" YELLOW		LINE - 24" WHITE	LETTERS AND SYMBOLS		
							SOLID	SOLID				
FOOT	FOOT	FOOT	FOOT	FOOT	SQ FOOT	EACH						
JACKSON COUNTY					FAS 919							
STA	0+50.00	TO	STA	0+50.00						22		
STA	0+50.00	TO	STA	83+50.00	8300.0	16600	16600				104	
STA	83+50.00	TO	STA	85+09.23	159.2	318	159	40			2	
STA	85+09.23	TO	STA	-0+44.77		STA EQUATION						
STA	-0+44.77	TO	STA	3+27.40	372.2	744	744				5	
STA	3+27.40	TO	STA	2+28.00		STA EQUATION						
STA	2+28.00	TO	STA	2+30.00	2.0	4	4				1	
STA	2+30.00	TO	STA	4+81.00	251.0	502	502					SN 039-2031 SN 039-0055
STA	4+81.00	TO	STA	5+47.17	66.2	132	132		36	65	1	RXR SYMBOL
STA	5+47.17	TO	STA	5+55.64	8.5	OMISSION RAILROAD TRACKS						
STA	5+55.64	TO	STA	6+12.00	56.4	113	113		12		1	
ADDITIONAL QUANTITY					61.0	122	122				1	
SUB-TOTAL FAS 919							36953		70	65	115	
JACKSON COUNTY					CH 29							
STA	6+12.00	TO	STA	35+00.00	2888.0	5776			24	65	37	RXR SYMBOL
STA	6+12.00	TO	STA	6+67.00	55.0		110					
STA	6+67.00	TO	STA	8+00.00	133.0		133	33				
STA	8+00.00	TO	STA	35+00.00	2700.0			675				
SUB-TOTAL CH 29							6728		24	65	37	
TOTAL							43681		94	130	152	

MODEL: PavementSch (Sheet)
FILE NAME: c:\p\work\pav\td\lay\pmd\0974122\0978A66-SHE-Schedules.dgn

USER NAME = Nathan.Taylor	DESIGNED -	REVISED -
	DRAWN -	REVISED -
	CHECKED -	REVISED -
PLOT DATE = 7/5/2024	DATE -	REVISED -

**STATE OF ILLINOIS
DEPARTMENT OF TRANSPORTATION**

PAVEMENT MARKING SCHEDULE

SCALE: SHEET 12 OF 22 SHEETS STA. TO STA.

F.A. RTE.	SECTION	COUNTY	TOTAL SHEETS	SHEET NO.
*	D9 HMA RES FY25-1	JACKSON	22	12
CONTRACT NO. 78A66				
		ILLINOIS FED. AID PROJECT		

ENTRANCE AND SIDEROAD SCHEDULE

LOCATION FAS 919/CH 29 (MAKANDA ROAD)	ENT TYPE		EX. SURF	WIDTH AT EOP	WIDTH OF 4'	WIDTH OF 15'	RDWY AREA	INCIDENTAL HMA SURFACING	TEMPORARY RAMP	BIT. MAT. (PRIME COAT)	BIT. MAT. (TACK COAT)	REMARKS
			TYPE	FT	FT	FT	SQ YD	TON	SQ YD	POUND	POUND	
JACKSON COUNTY	FAS 919											
VIRGINIA DR.	LT	SR	HMA	44		26	59	9	2		27	EXISTING 15' APRON
WILEY LN.	RT	SR	HMA	54		26	67	10	2		31	EXISTING 15' APRON
DRIVEWAY	RT	PE	AGG	36	36		16					
DRIVEWAY	LT	PE	AGG	30	30		14					
DRIVEWAY	LT	PE	AGG	30	30		14					
DRIVEWAY	LT	PE	AGG	30	30		14	3		32		EXISTING 4' APRON
DRIVEWAY	RT	PE	AGG	36	34		16	4		36		EXISTING 4' APRON
DRIVEWAY	LT	PE	AGG	25	25		12					
SHEPPARD LN	RT	SR	HMA	50		25	63	10	2		29	EXISTING 15' APRON
OLD EASTERN STAR TRAIL	LT	SR	HMA			25	270	40	2		122	EXISTING 15' APRON
DRIVEWAY	LT	PE	PCC	40	30		16	3			8	
DRIVEWAY	RT	PE	AGG	30	30		14					
DRIVEWAY	LT	PE	AGG	30	30		14					
DRIVEWAY	RT	PE	HMA	210	200		183	27			83	EXISTING 8' APRON
DRIVEWAY	LT	PE	AGG	25	25		12					
COMERCIAL ENT.	LT	CE	HMA	158	150		69	11			32	EXISTING 4' APRON
DRIVEWAY	LT	PE	HMA	42	36		18	3			9	EXISTING 4' APRON
CHURCH ST./ LOWER EASTERN STAR TRAIL	LT	SR	HMA			25	430	64	21		194	EXISTING 15' APRON
MAKANDA CREEKSIDE PRK	RT	CE	HMA	70	60		29	5			14	EXISTING 4' APRON
PARKING LOT	LT	CE	HMA	50	40		20	3			9	EXISTING 4' APRON
SUB-TOTAL FAS 919								192	29	68	558	
JACKSON COUNTY	CH 29											
OLD LOWER COBDEN ROAD/ BAPTIST HILL ROAD	RT	SR	HMA			25	578	85	21		261	EXISTING 15' APRON
PARKING LOT	LT	CE	AGG	145	145		65	10		147		EXISTING 4' APRON
HEERN ST.	RT	SR	HMA	35		25	50	8	21		23	EXISTING 15' APRON
DRIVEWAY	RT	PE	AGG	275	275		123					
DRIVEWAY	RT	PE	AGG	20	20		9					
DRIVEWAY	RT	PE	AGG	20	20		9					
DRIVEWAY	RT	PE	AGG	20	20		9					
DRIVEWAY	RT	PE	AGG	20	20		9					
CRACKERS NECK ST.	RT	SR	HMA	35		25	50	8	21		23	EXISTING 15' APRON
DRIVEWAY	LT	PE	HMA	35	30		15	3			7	EXISTING APRON
COMERCIAL ENT.	RT	CE	HMA	20	15		8	2			4	
COMERCIAL ENT.	RT	CE	HMA	50	30		18	3			9	EXISTING 4' APRON
SIDEROAD	RT	SR	HMA	55		35	75	12	30		34	EXISTING 15' APRON
DRIVEWAY	RT	PE	AGG	20	20		9	2				
DRIVEWAY	RT	PE	AGG	20	20		9	2				
DRIVEWAY	RT	PE	AGG	20	20		9	2			5	EXISTING 4' APRON
SPRINGER RIDGE RD.	RT	SR	HMA			50	240	36	42		108	EXISTING 15' APRON
SUB-TOTAL CH 29								173	135	147	474	
TOTAL								365	164	215	1032	

MODEL: SFRentSch (Sheet)
 FILE NAME: c:\p\work\prv\td\lay\pmd\0974122\0978A66-SHE-Schedule.dgn



MODEL: Guardrail1 (Sheet)
 FILE NAME: c:\p\work\project\lay\mod\0974124\0978A66Guardrail1 Layout.dgn

USER NAME = Nathan.Taylor	DESIGNED -	REVISED -
	DRAWN -	REVISED -
	CHECKED -	REVISED -
PLOT DATE = 7/5/2024	DATE -	REVISED -

STATE OF ILLINOIS
DEPARTMENT OF TRANSPORTATION

PLAN VIEW			
SCALE:	SHEET 15	OF 22 SHEETS	STA. TO STA.

F.A. RTE.	SECTION	COUNTY	TOTAL SHEETS	SHEET NO.
*	D9 HMA RES FY25-1	JACKSON	22	15
CONTRACT NO. 78A66				
ILLINOIS FED. AID PROJECT				

*FAS 919/CH 29

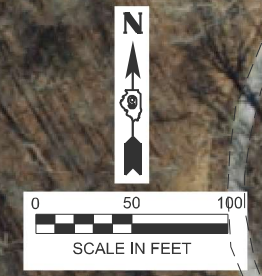

LON 91 FT FROM
EX GUARDRAIL TERMINAL

TRAFFIC BARRIER TERMINAL
TYPE 1 SPECIAL TANGENT

LOCATION 4

STEEL PLATE BEAM GUARDRAIL
TYPE A 9 FT POSTS

GUARDRAIL REMOVAL

TRAFFIC BARRIER TERMINAL
TYPE 1 SPECIAL TANGENT

LON 100' FROM
EX GUARDRAIL TERMINAL

MODEL: Guardrail-1 (Sheet)
FILE NAME: c:\p\work\proj\illinois\mtd\0974124\0978A66GuardrailLayout.dgn

USER NAME = Nathan.Taylor	DESIGNED -	REVISED -
	DRAWN -	REVISED -
	CHECKED -	REVISED -
PLOT DATE = 7/5/2024	DATE -	REVISED -

**STATE OF ILLINOIS
DEPARTMENT OF TRANSPORTATION**

PLAN VIEW			
SCALE:	SHEET 16	OF 22 SHEETS	STA. TO STA.

F.A. RTE.	SECTION	COUNTY	TOTAL SHEETS	SHEET NO.
*	D9 HMA RES FY25-1	JACKSON	22	16
CONTRACT NO. 78A66				
ILLINOIS FED. AID PROJECT				

*FAS 919/CH 29



MODEL: Guardrail-2 [Sheet]
 FILE NAME: c:\p\work\wriston\taylor\mcd\0974124\0978A66Guardrail.layout.dgn

USER NAME = Nathan.Taylor	DESIGNED -	REVISED -
	DRAWN -	REVISED -
	CHECKED -	REVISED -
PLOT DATE = 7/5/2024	DATE -	REVISED -

STATE OF ILLINOIS
DEPARTMENT OF TRANSPORTATION

PLAN VIEW
 SCALE: SHEET 17 OF 22 SHEETS STA. TO STA.

F.A. RTE. *	SECTION D9 HMA RES FY25-1	COUNTY JACKSON	TOTAL SHEETS 22	SHEET NO. 17
CONTRACT NO. 78A66				
ILLINOIS FED. AID PROJECT				

*FAS 919/CH 29



MODEL: Plan View [Sheet]
FILE NAME: c:\p\work\project\lay\mcd\0974124\0978A66-Design.dgn

USER NAME = Nathan.Taylor	DESIGNED -	REVISED -
	DRAWN -	REVISED -
	CHECKED -	REVISED -
PLOT DATE = 7/5/2024	DATE -	REVISED -

**STATE OF ILLINOIS
DEPARTMENT OF TRANSPORTATION**

PLAN VIEW			
SCALE:	SHEET 18	OF 22 SHEETS	STA. TO STA.

F.A. RTE.	SECTION	COUNTY	TOTAL SHEETS	SHEET NO.
*	D9 HMA RES FY25-1	JACKSON	22	18
CONTRACT NO. 78A66				
ILLINOIS FED. AID PROJECT				

*FAS 919/CH 29

HMA TRANSITION DETAILS

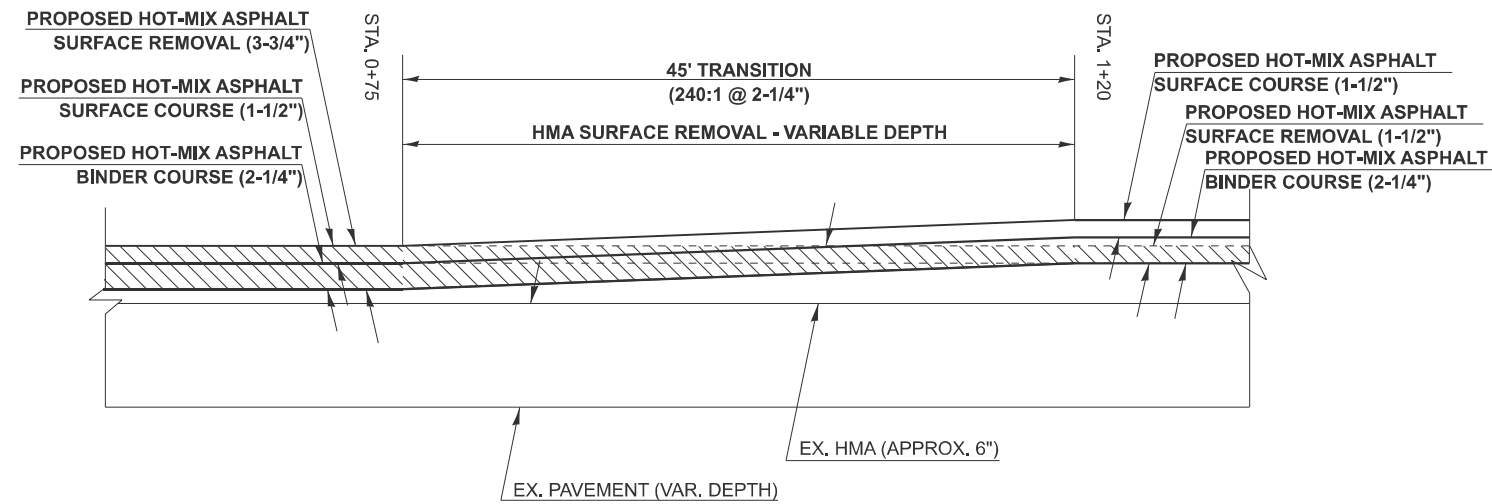

**TO BE USED:
STA. 0+75 TO STA. 1+20**

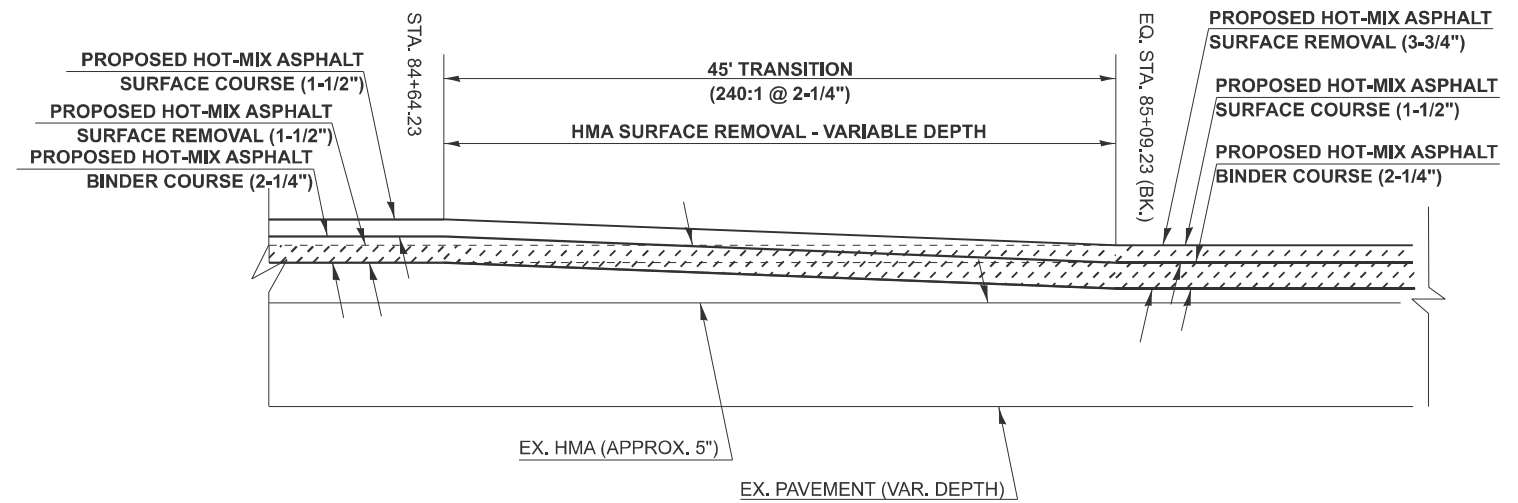

**TO BE USED:
STA. 84+64.23 TO EQ. STA. 85+09.23 (BK.)
EQ. STA. 85+09.23 (BK.) = EQ. STA. -0+44.77 (AH.)**

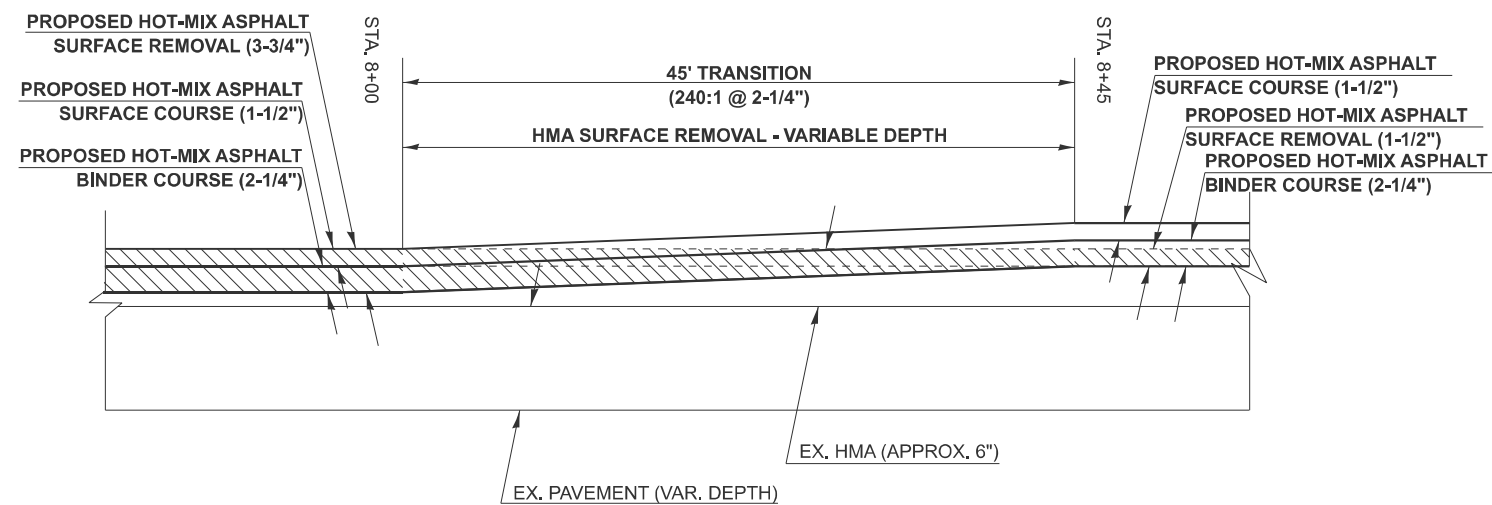

**TO BE USED:
STA. 8+00 TO STA. 8+45**

MODEL: HMA TRANS (Sheet)
FILE NAME: c:\p\work\project\lay\p\m\c\0974122\0978A66-SHTTransitionDetails.dgn

USER NAME = Nathan.Taylor	DESIGNED -	REVISED -
	DRAWN -	REVISED -
	CHECKED -	REVISED -
PLOT DATE = 6/28/2024	DATE -	REVISED -

**STATE OF ILLINOIS
DEPARTMENT OF TRANSPORTATION**

HMA TRANSITION DETAILS

SCALE: SHEET 19 OF 22 SHEETS STA. TO STA.

F.A. RTE.	SECTION	COUNTY	TOTAL SHEETS	SHEET NO.
*	D9 HMA RES FY25-1	JACKSON	22	19
CONTRACT NO. 78A66				
ILLINOIS FED. AID PROJECT				

DETAIL OF AGGREGATE OR EARTH FIELD ENTRANCE

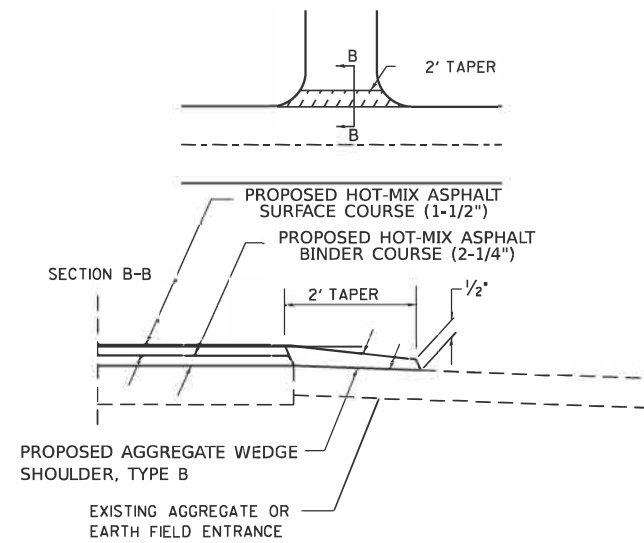

PREPARATION OF EXISTING SURFACE AND ANY EXCAVATION FOR ENTRANCES SHALL BE IN ACCORDANCE WITH ARTICLE 406.09 OF THE STANDARD SPECIFICATIONS.

BITUMINOUS OR PCC ENTRANCE

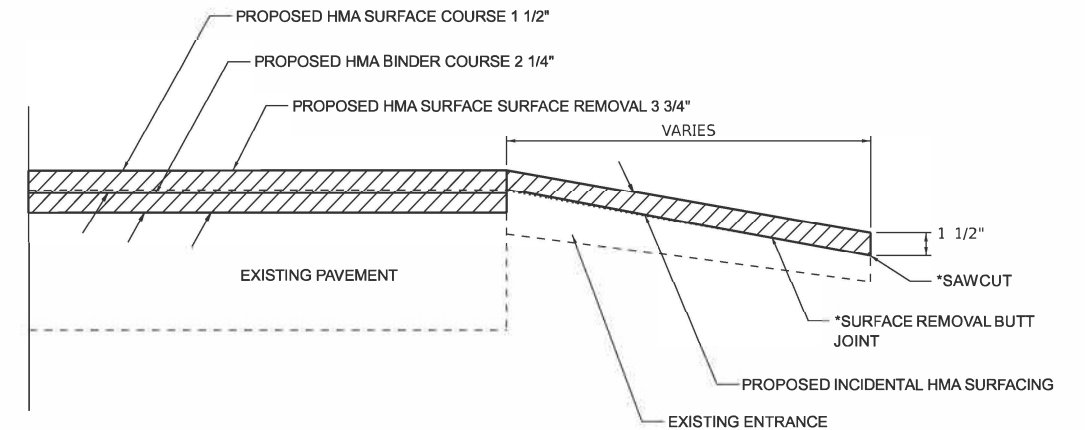

1. IF THE EXISTING SUBBASE IS INADEQUATE, AS DETERMINED BY THE ENGINEER, THE SIDE ROADS SHALL BE CORED OUT AND AGGREGATE SUBBASE, TYPE B SHALL BE PLACED FOR BASE. THE COST OF CORING OUT THE SIDEROAD AND ANY AGGREGATE BASE COURSE SHALL BE PAID FOR AS SPECIFIED IN ART. 109.04 OF THE STANDARD SPECIFICATIONS FOR ROAD AND BRIDGE CONSTRUCTION. IF EXISTING SUBBASE IS DETERMINED TO BE ADEQUATE, THE PREPARATION OF THE BASE SHALL BE CONSTRUCTED ACCORDING TO ARTICLE 406.09.
2. VARIABLE SHAPING IS INCLUDED IN THE COST OF INCIDENTAL HOT-MIX ASPHALT SURFACING.
3. *SURFACE REMOVAL BUTT JOINT ON ENTRANCES IS INCLUDED IN THE COST OF INCIDENTAL HOT-MIX ASPHALT SURFACING.
4. *SAW CUT IS INCLUDED IN THE COST OF INCIDENTAL HOT-MIX ASPHALT SURFACING.

DETAIL OF BITUMINOUS OR PCC SIDEROADS WITH BUTT JOINT

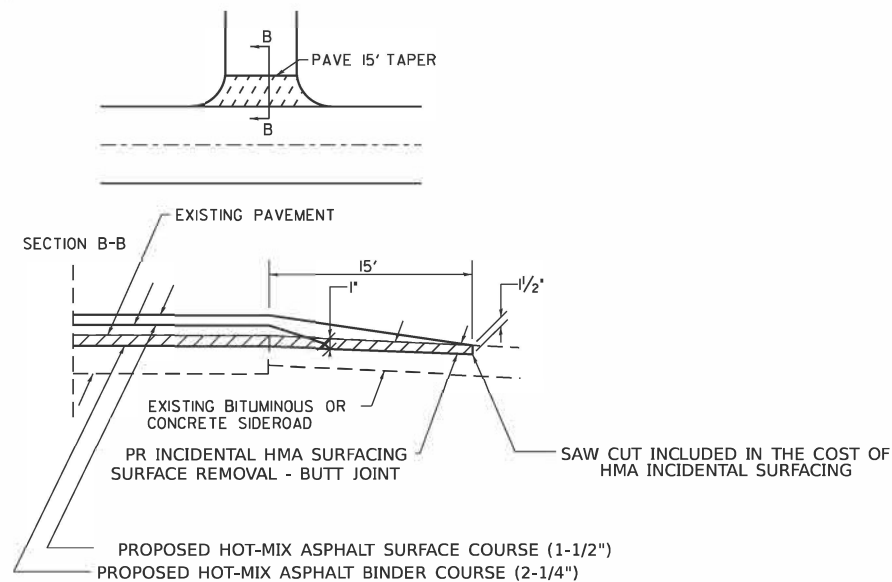

IF THE EXISTING SUBBASE IS INADEQUATE, AS DETERMINED BY THE ENGINEER, THE SIDE ROADS SHALL BE CORED OUT AND AGGREGATE SUBBASE, TYPE B SHALL BE PLACED FOR BASE. THE COST OF CORING OUT THE SIDEROAD AND ANY AGGREGATE BASE COURSE SHALL BE PAID FOR AS SPECIFIED IN ART. 109.04 OF THE STANDARD SPECIFICATIONS FOR ROAD AND BRIDGE CONSTRUCTION. IF EXISTING SUBBASE IS DETERMINED TO BE ADEQUATE, THE PREPARATION OF THE BASE SHALL BE CONSTRUCTED ACCORDING TO ARTICLE 406.09.

VARIABLE SHAPING IS INCLUDED IN THE COST OF INCIDENTAL HOT-MIX ASPHALT SURFACING
 *SURFACE REMOVAL BUTT JOINT ON ENTRANCES IS INCLUDED IN THE COST OF INCIDENTAL HOT-MIX ASPHALT SURFACING.

BUTT JOINT WITH MILLING

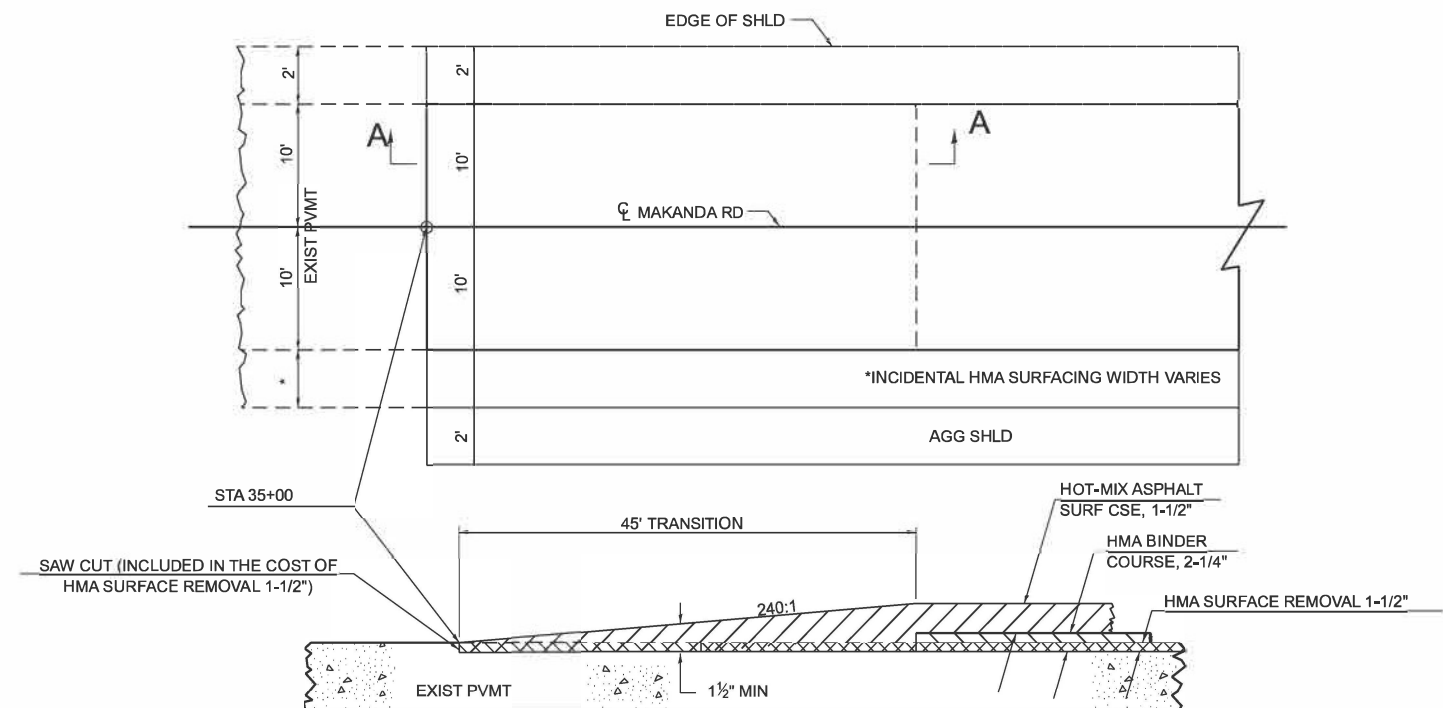

*SURFACE REMOVAL BUTT JOINT FROM STATION 35+00 TO STATION 34+55 SHALL BE INCLUDED IN THE COST OF HOT-MIX ASPHALT SURFACE REMOVAL 1-1/2".

DRAWN	03-09-17
REVISED	02-18-20
REVISED	10-21-21
REVISED	05-26-22

STD. 9-14

MODEL: details4 [Sheet]
 FILE NAME: c:\pwworking\tdtaylor\jordan\0974122\0978A66-SHS-DistrictSidss.dgn

USER NAME	= Nathan.Taylor	DESIGNED	-	REVISED	-
		DRAWN	-	REVISED	-
		CHECKED	-	REVISED	-
PLOT DATE	6/28/2024	DATE	-	REVISED	-

STATE OF ILLINOIS
 DEPARTMENT OF TRANSPORTATION

DETAILS: ENTRANCES

SCALE: SHEET 21 OF 22 SHEETS STA. TO STA.

F.A. RTE.	SECTION	COUNTY	TOTAL SHEETS	SHEET NO.
*	D9 HMA RES FY25-1	JACKSON	22	21
			CONTRACT NO. 78A66	
			ILLINOIS FED. AID PROJECT	

*FAS 919/CH 29

UNEVEN LANES SIGN
W8-11 (48" X 48")

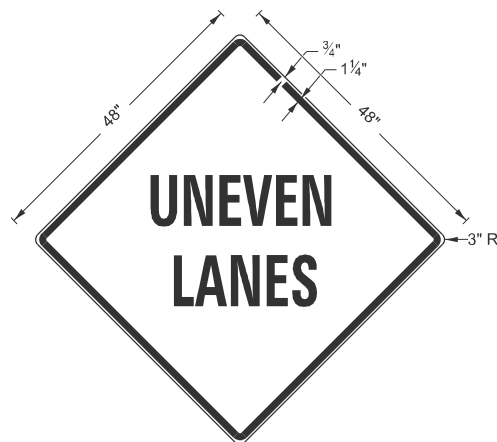

COLORS:

LEGEND AND BORDER - BLACK NON-REFLECTORIZED
 BACKGROUND - ORANGE REFLECTORIZED

NOTE: PRIOR TO ALLOWING TRAFFIC ON ANY PORTION OF THE ROADWAY THAT HAS BEEN COLDMILLED OR BEFORE RESURFACING OPERATIONS BEGIN, THE CONTRACTOR SHALL HAVE ERECTED "UNEVEN PAVEMENT" SIGNS THAT CONFORM TO THE ABOVE DETAILS. A MINIMUM OF ONE SIGN AT EACH END OF THE IMPROVEMENT WILL BE REQUIRED. THE CONTRACTOR SHALL MAINTAIN THE "UNEVEN PAVEMENT" SIGNS UNTIL THE RESURFACING OPERATIONS ARE COMPLETED.

IF AT ANY TIME THE SIGNS ARE IN PLACE BUT NOT APPLICABLE, THEY SHALL BE TURNED FROM THE VIEW OF MOTORISTS OR COVERED AS DIRECTED BY THE ENGINEER.

THE COST OF FURNISHING, ERECTING, MAINTAINING, AND REMOVING THE REQUIRED SIGNS SHALL BE INCLUDED IN THE CONTRACT.

DRAWN	02-15-89
REVISED	05-08-08
REVISED	10-21-21
REVISED	05-27-22

STD. 9-24

ILLINOIS STANDARD
ROUGH GROOVED SURFACE SIGN

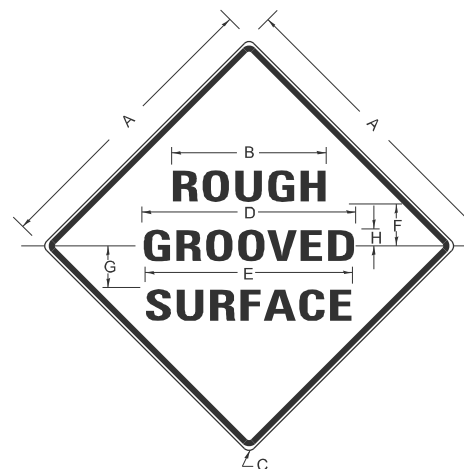

COLORS

LEGEND AND BORDER- BLACK NON-REFLECTORIZED
 BACKGROUND- ORANGE REFLECTORIZED

SIGN SIZE	DIMENSIONS							
	A	B	C	D	E	F	G	H
48X48	48.0	24.1	3.0	34.0	33.0	6.0	13.0	3.5

SIGN SIZE	SERIES LINES			MAR-GIN	BOR-DER	BLANK STD.
	1	2	3			
48X48	7C	7C	7C	0.8	1.2	B4-48D

ALL DIMENSIONS IN INCHES

NOTES

PRIOR TO ALLOWING TRAFFIC ON ANY PORTION OF THE ROADWAY THAT HAS BEEN COLDMILLED, THE CONTRACTOR SHALL HAVE ERECTED "ROUGH GROOVED SURFACE" SIGNS THAT CONFORM TO THE ABOVE DETAILS. A MINIMUM OF ONE SIGN AT EACH END OF THE IMPROVEMENT WILL BE REQUIRED. THE CONTRACTOR SHALL MAINTAIN THE "ROUGH GROOVED SURFACE" SIGNS UNTIL THE COLDMILLED SURFACE IS COVERED WITH LEVELING BINDER OR SURFACE COURSE.

IF AT ANY TIME THE SIGNS ARE IN PLACE BUT NOT APPLICABLE, THEY SHALL BE TURNED FROM THE VIEW OF MOTORISTS OR COVERED AS DIRECTED BY THE ENGINEER.

THE COST OF FURNISHING, ERECTING, MAINTAINING, AND REMOVING THE REQUIRED SIGNS SHALL BE INCLUDED IN THE CONTRACT.

DRAWN	02-15-89
REVISED	03-27-08
REVISED	10-21-21
REVISED	05-27-22

STD. 9-23

MODEL: DETAILS (Sheet)
 FILE NAME: c:\p\work\wvictor\lay\pmodel\0974122\0978A66-SHS-Districts\stds.dgn

USER NAME = Nathan.Taylor	DESIGNED -	REVISED -
	DRAWN -	REVISED -
	CHECKED -	REVISED -
PLOT DATE = 6/28/2024	DATE -	REVISED -

STATE OF ILLINOIS
DEPARTMENT OF TRANSPORTATION

DISTRICT STANDARDS: ROUGH GROOVED SURFACE,
UNEVEN LANES SIGNAGE

SCALE: SHEET 22 OF 22 SHEETS STA. TO STA.

F.A. RTE.	SECTION	COUNTY	TOTAL SHEETS	SHEET NO.
*	D9 HMA RES FY25-1	JACKSON	22	22
CONTRACT NO. 78A66				
ILLINOIS FED. AID PROJECT				