

MODEL Default
 FILE Name: p:\work\paw.bentley.com\hwp-01\Documents\01_Active Projects\WV-CIS-168112005 - Green Bay Road - Phase II\2 Design\CAD\Plan_Sheets\168112005-sht-05-01_KIA

CODE NO.	ITEM	UNIT	TOTAL QUANTITY	CONSTRUCTION CODE								
				ROADWAY 0005	ROADWAY 0042	ADA 0021	ELECTRICAL 0021	PAVEMENT MARKINGS 0021	LANDSCAPE 0031	WATER MAIN 0043	SEWER 0043	
				URBAN	URBAN	URBAN	URBAN	URBAN	URBAN	URBAN	URBAN	
				70% FHWA (STU) 30% LOCAL	70% FHWA (STU) 30% LOCAL	70% FHWA (STU) 30% LOCAL	70% FHWA (STU) 30% LOCAL	70% FHWA (STU) 30% LOCAL	70% FHWA (STU) 30% LOCAL	100% LOCAL	100% LOCAL	
70107025	CHANGEABLE MESSAGE SIGN	CAL DA	1440	864							576	
70300100	SHORT TERM PAVEMENT MARKING	FOOT	23473					21873		1600		
70300150	SHORT TERM PAVEMENT MARKING REMOVAL	SQ FT	6019					5469		550		
70307120	TEMPORARY PAVEMENT MARKING - LINE 4" - TYPE IV TAPE	FOOT	18665					18665				
70307130	TEMPORARY PAVEMENT MARKING - LINE 6" - TYPE IV TAPE	FOOT	203					203				
70307160	TEMPORARY PAVEMENT MARKING - LINE 12" - TYPE IV TAPE	FOOT	2251					2251				
70307210	TEMPORARY PAVEMENT MARKING - LINE 24" - TYPE IV TAPE	FOOT	420					420				
70400100	TEMPORARY CONCRETE BARRIER	FOOT	420	420								
70400125	PINNING TEMPORARY CONCRETE BARRIER	EACH	592	592								
70400200	RELOCATE TEMPORARY CONCRETE BARRIER	FOOT	1752	1752								
70600241	IMPACT ATTENUATORS, TEMPORARY (NON- REDIRECTIVE, NARROW), TEST LEVEL 2	EACH	10	10								
70600341	IMPACT ATTENUATORS, RELOCATE (NON- REDIRECTIVE, NARROW), TEST LEVEL 2	EACH	10	10								
# 72000100	SIGN PANEL - TYPE 1	SQ FT	339	339								
# 72000200	SIGN PANEL - TYPE 2	SQ FT	115	115								
72400100	REMOVE SIGN PANEL ASSEMBLY - TYPE A	EACH	26	26								

- SPECIALTY ITEM



USER NAME = JoelTurk	DESIGNED -	REVISED - 09/06/2024
	DRAWN -	REVISED -
PLOT SCALE = 2.0000' / in.	CHECKED -	REVISED -
PLOT DATE = 7/10/2024	DATE -	REVISED -

**STATE OF ILLINOIS
DEPARTMENT OF TRANSPORTATION**

SUMMARY OF QUANTITIES			
GREEN BAY ROAD			
SCALE:	SHEET	OF SHEETS	STA. TO STA.

F.A.U. RTE.	SECTION	COUNTY	TOTAL SHEETS	SHEET NO.
2744	19-00285-00-R5	COOK	191	11
CONTRACT NO. 61K60			ILLINOIS FED. AID PROJECT	

CODE NO.	ITEM	UNIT	TOTAL QUANTITY	CONSTRUCTION CODE								
				ROADWAY 0005	ROADWAY 0042	ADA 0021	ELECTRICAL 0021	PAVEMENT MARKINGS 0021	LANDSCAPE 0031	WATER MAIN 0043	SEWER 0043	
				URBAN	URBAN	URBAN	URBAN	URBAN	URBAN	URBAN	URBAN	
				70% FHWA (STU) 30% LOCAL	70% FHWA (STU) 30% LOCAL	70% FHWA (STU) 30% LOCAL	70% FHWA (STU) 30% LOCAL	70% FHWA (STU) 30% LOCAL	70% FHWA (STU) 30% LOCAL	100% LOCAL	100% LOCAL	
# 87301255	ELECTRIC CABLE IN CONDUIT, SIGNAL NO. 14 7C	FOOT	1411				1411					
# 87301305	ELECTRIC CABLE IN CONDUIT, LEAD-IN, NO. 14 1 PAIR	FOOT	1000				1000					
# 87301805	ELECTRIC CABLE IN CONDUIT, SERVICE, NO. 6 2 C	FOOT	906				906					
# 87301900	ELECTRIC CABLE IN CONDUIT, EQUIPMENT GROUNDING CONDUCTOR, NO. 6 1C	FOOT	4421				4421					
# 87500600	TRAFFIC SIGNAL POST, 10 FT.	EACH	5				5					
# 87501200	TRAFFIC SIGNAL POST, 16 FT.	EACH	11				11					
# 87501400	TRAFFIC SIGNAL POST, 18 FT.	EACH	1				1					
# 87700120	STEEL MAST ARM ASSEMBLY AND POLE, 16 FT.	EACH	1				1					
# 87700130	STEEL MAST ARM ASSEMBLY AND POLE, 18 FT.	EACH	1				1					
# 87700140	STEEL MAST ARM ASSEMBLY AND POLE, 20 FT.	EACH	1				1					
# 87700150	STEEL MAST ARM ASSEMBLY AND POLE, 22 FT.	EACH	1				1					
# 87700180	STEEL MAST ARM ASSEMBLY AND POLE, 28 FT.	EACH	2				2					
# 87700190	STEEL MAST ARM ASSEMBLY AND POLE, 30 FT.	EACH	1				1					
# 87700220	STEEL MAST ARM ASSEMBLY AND POLE, 36 FT.	EACH	1				1					



MODEL Default: P:\Projects\Green Bay Road - Phase II\Drawings\CAD\Plan_Sheets\168112005-Substation-01.dwg

- SPECIALTY ITEM



USER NAME = JoelTurk	DESIGNED -	REVISED - 09/06/2024
	DRAWN -	REVISED -
PLOT SCALE = 2,000' / in.	CHECKED -	REVISED -
PLOT DATE = 7/10/2024	DATE -	REVISED -

**STATE OF ILLINOIS
DEPARTMENT OF TRANSPORTATION**

**SUMMARY OF QUANTITIES
GREEN BAY ROAD**

SCALE: SHEET OF SHEETS STA. TO STA.

F.A.U. RTE.	SECTION	COUNTY	TOTAL SHEETS	SHEET NO.
2744	19-00285-00-R5	COOK	191	15
			CONTRACT NO. 61K60	
ILLINOIS FED. AID PROJECT				

CODE NO.	ITEM	UNIT	TOTAL QUANTITY	CONSTRUCTION CODE								
				ROADWAY 0005	ROADWAY 0042	ADA 0021	ELECTRICAL 0021	PAVEMENT MARKINGS 0021	LANDSCAPE 0031	WATER MAIN 0043	SEWER 0043	
				URBAN	URBAN	URBAN	URBAN	URBAN	URBAN	URBAN		
				70% FHWA (STU) 30% LOCAL	70% FHWA (STU) 30% LOCAL	70% FHWA (STU) 30% LOCAL	70% FHWA (STU) 30% LOCAL	70% FHWA (STU) 30% LOCAL	70% FHWA (STU) 30% LOCAL	100% LOCAL	100% LOCAL	
# 87700230	STEEL MAST ARM ASSEMBLY AND POLE, 38 FT.	EACH	3				3					
# 87700240	STEEL MAST ARM ASSEMBLY AND POLE, 40 FT.	EACH	1				1					
# 87800100	CONCRETE FOUNDATION, TYPE A	FOOT	160				160					
# 87800150	CONCRETE FOUNDATION, TYPE C	FOOT	16				16					
# 87800400	CONCRETE FOUNDATION, TYPE E 30-INCH DIAMETER	FOOT	34				34					
# 87800415	CONCRETE FOUNDATION, TYPE E 36-INCH DIAMETER	FOOT	13				13					
# 87900200	DRILL EXISTING HANDHOLE	EACH	21				21					
# 88030020	SIGNAL HEAD, LED, 1-FACE, 3-SECTION, BRACKET MOUNTED	EACH	23				23					
# 88030050	SIGNAL HEAD, LED, 1-FACE, 3-SECTION, MAST ARM MOUNTED	EACH	16				16					
# 88030100	SIGNAL HEAD, LED, 1-FACE, 5-SECTION, BRACKET MOUNTED	EACH	4				4					
# 88030110	SIGNAL HEAD, LED, 1-FACE, 5-SECTION, MAST ARM MOUNTED	EACH	4				4					
# 88102717	PEDESTRIAN SIGNAL HEAD, LED, 1-FACE, BRACKET MOUNTED WITH COUNTDOWN TIMER	EACH	28				28					
# 88200410	TRAFFIC SIGNAL BACKPLATE, LOUVERED, FORMED PLASTIC	EACH	10				10					
# 88500100	INDUCTIVE LOOP DETECTOR	EACH	16				16					

- SPECIALTY ITEM

MODEL Default
FILE Name: p:\work\pwbentley.com\hwp-01\Documents\01_Active Projects\WV-CIS-168112005 - Green Bay Road - Phase II\2 Design\CAD\Plan_Sheets\168112005-sht-ss-01.dwg



USER NAME = JoelTurk	DESIGNED -	REVISED - 09/06/2024
	DRAWN -	REVISED -
PLOT SCALE = 2.0000' / in.	CHECKED -	REVISED -
PLOT DATE = 7/10/2024	DATE -	REVISED -

**STATE OF ILLINOIS
DEPARTMENT OF TRANSPORTATION**

**SUMMARY OF QUANTITIES
GREEN BAY ROAD**

SCALE: SHEET OF SHEETS STA. TO STA.

F.A.U. RTE.	SECTION	COUNTY	TOTAL SHEETS	SHEET NO.
2744	19-00285-00-R5	COOK	191	16
CONTRACT NO. 61K60			ILLINOIS FED. AID PROJECT	

CODE NO.	ITEM	UNIT	TOTAL QUANTITY	CONSTRUCTION CODE								
				ROADWAY 0005	ROADWAY 0042	ADA 0021	ELECTRICAL 0021	PAVEMENT MARKINGS 0021	LANDSCAPE 0031	WATER MAIN 0043	SEWER 0043	
				URBAN	URBAN	URBAN	URBAN	URBAN	URBAN	URBAN	URBAN	
				70% FHWA (STU) 30% LOCAL	70% FHWA (STU) 30% LOCAL	70% FHWA (STU) 30% LOCAL	70% FHWA (STU) 30% LOCAL	70% FHWA (STU) 30% LOCAL	70% FHWA (STU) 30% LOCAL	100% LOCAL	100% LOCAL	
# 88600100	DETECTOR LOOP, TYPE I	FOOT	310				310					
# 88700200	LIGHT DETECTOR	EACH	16				16					
# 88700300	LIGHT DETECTOR AMPLIFIER	EACH	4				4					
# 89000100	TEMPORARY TRAFFIC SIGNAL INSTALLATION	EACH	3				3					
# 89502300	REMOVE ELECTRIC CABLE FROM CONDUIT	FOOT	7500				7500					
# 89502375	REMOVE EXISTING TRAFFIC SIGNAL EQUIPMENT	EACH	4				4					
# 89502380	REMOVE EXISTING HANDHOLE	EACH	11				11					
# 89502382	REMOVE EXISTING DOUBLE HANDHOLE	EACH	10				10					
# 89502385	REMOVE EXISTING CONCRETE FOUNDATION	EACH	23				23					
# A2002884	TREE, CELTIS OCCIDENTALIS CHICAGOLAND, (CHICAGOLAND HACKBERRY), 3" CALIPER, BALLED AND BURLAPPED	EACH	4						4			
# A2005042	TREE, GYMNOCLADUS DIOICUS ESPRESSO-JFS (ESPRESSO KENTUCKY COFFEETREE), 3" CALIPER, BALLED AND BURLAPPED	EACH	4						4			
# A2006524	TREE, QUERCUS BICOLOR (SWAMP WHITE OAK), 3" CALIPER, BALLED AND BURLAPPED	EACH	3						3			
# A2007201	TREE, QUERCUS ROBUR LONG (REGAL PRINCE OAK), 3" CALIPER, BALLED AND BURLAPPED	EACH	4						4			
# B2006322	TREE, SYRINGA RETICULATA IVORY SILK (IVORY SILK JAPANESE TREE LILAC), 3" CALIPER, BALLED AND BURLAPPED	EACH	3						3			



- SPECIALTY ITEM

MODEL Default: Kimley-Horn and Associates, Inc. 168112005 - Green Bay Road - Phase II - Design/CADD/Plan Sheets/168112005-sht-05-01.dwg



USER NAME = JoelTurk	DESIGNED -	REVISED - 09/09/2024
	DRAWN -	REVISED -
PLOT SCALE = 2,000' / in.	CHECKED -	REVISED -
PLOT DATE = 7/10/2024	DATE -	REVISED -

**STATE OF ILLINOIS
DEPARTMENT OF TRANSPORTATION**

**SUMMARY OF QUANTITIES
GREEN BAY ROAD**

SCALE: SHEET OF SHEETS STA. TO STA.

F.A.U. RTE.	SECTION	COUNTY	TOTAL SHEETS	SHEET NO.
2744	19-00285-00-R5	COOK	191	17
CONTRACT NO. 61K60			ILLINOIS FED. AID PROJECT	

MODEL Default: Kimley-Horn Bentley.com\hpw-01\Documents\01_Active Projects\WV-CIS-168112005 - Green Bay Road - Phase II Design\CAD\Plan_Sheets\168112005-sht-09-01.dwg

CODE NO.	ITEM	UNIT	TOTAL QUANTITY	CONSTRUCTION CODE								
				ROADWAY 0005	ROADWAY 0042	ADA 0021	ELECTRICAL 0021	PAVEMENT MARKINGS 0021	LANDSCAPE 0031	WATER MAIN 0043	SEWER 0043	
				URBAN	URBAN	URBAN	URBAN	URBAN	URBAN	URBAN	URBAN	
				70% FHWA (STU) 30% LOCAL	70% FHWA (STU) 30% LOCAL	70% FHWA (STU) 30% LOCAL	70% FHWA (STU) 30% LOCAL	70% FHWA (STU) 30% LOCAL	70% FHWA (STU) 30% LOCAL	100% LOCAL	100% LOCAL	
# XX009654	SHRUB, WEIGELA FLORIDA VERWEIG (MY MONET WEIGELA), 3-GALLON, EACH" MY MONET WEIGELA	EACH	9							9		
# K0012990	PERENNIAL PLANTS, ORNAMENTAL TYPE, GALLON POT	UNIT	2							2		
# K0036118	MULCH PLACEMENT 3"	SQ YD	100							100		
# X0300635	PLANTER	EACH	16							16		
X0323677	STREET SWEEPING	HOUR	220								202	18
# X0324085	EMERGENCY VEHICLE PRIORITY SYSTEM LINE SENSOR CABLE, NO. 20 3/C	FOOT	1939				1939					
X0327997	TRASH RECEPTACLES	EACH	4							4		
X0540000	BRICK PAVERS	SQ FT	6262							6262		
# X1200017	FLUOROCARBON RUBBER (VITON) GASKET	EACH	12								12	
# X1400096	LED LAMP MODULE REPLACEMENT	EACH	27				27					
# X1400144	UNINTERRUPTABLE POWER SUPPLY AND CABINET, SPECIAL	EACH	4				4					
# X2010400	STUMP REMOVAL ONLY	UNIT	100							100		
# X2530008	TREE GRATES	EACH	18							18		
X4021000	TEMPORARY ACCESS (PRIVATE ENTRANCE)	EACH	4			4						
X4022000	TEMPORARY ACCESS (COMMERCIAL ENTRANCE)	EACH	24			24						

- SPECIALTY ITEM



USER NAME = JoelTurk	DESIGNED -	REVISED - 09/09/2024
	DRAWN -	REVISED -
PLOT SCALE = 2.0000' / in.	CHECKED -	REVISED -
PLOT DATE = 7/10/2024	DATE -	REVISED -

**STATE OF ILLINOIS
DEPARTMENT OF TRANSPORTATION**

**SUMMARY OF QUANTITIES
GREEN BAY ROAD**

SCALE: SHEET OF SHEETS STA. TO STA.

F.A.U. RTE.	SECTION	COUNTY	TOTAL SHEETS	SHEET NO.
2744	19-00285-00-R5	COOK	191	18
ILLINOIS FED. AID PROJECT			CONTRACT NO. 61K60	

CODE NO.	ITEM	UNIT	TOTAL QUANTITY	CONSTRUCTION CODE								
				ROADWAY 0005	ROADWAY 0042	ADA 0021	ELECTRICAL 0021	PAVEMENT MARKINGS 0021	LANDSCAPE 0031	WATER MAIN 0043	SEWER 0043	
				URBAN	URBAN	URBAN	URBAN	URBAN	URBAN	URBAN	URBAN	
				70% FHWA (STU) 30% LOCAL	70% FHWA (STU) 30% LOCAL	70% FHWA (STU) 30% LOCAL	70% FHWA (STU) 30% LOCAL	70% FHWA (STU) 30% LOCAL	70% FHWA (STU) 30% LOCAL	100% LOCAL	100% LOCAL	
# X8250510	LIGHTING CONTROLLER FOUNDATION	EACH	2				2					
# X8300001	LIGHT POLE (SPECIAL)	EACH	2				2					
# X8301802	REMOVE TEMPORARY WOOD POLE	EACH	4				4					
# X8302141	TEMPORARY WOOD POLE, 40 FT., CLASS 4	EACH	4				4					
# X8410102	TEMPORARY LIGHTING SYSTEM	L SUM	1				1					
# X8570215	FULL-ACTUATED CONTROLLER IN EXISTING CABINET	EACH	1				1					
# X8570232	FULL-ACTUATED CONTROLLER AND TYPE SUPER P CABINET	EACH	1				1					
# X8570235	FULL-ACTUATED CONTROLLER AND TYPE SUPER R CABINET (SPECIAL)	EACH	1				1					
# X8620310	REMOVE AND REPLACE BATTERIES FOR UNINTERRUPTABLE POWER SUPPLY, EXTENDED	EACH	1				1					
# X8620200	UNINTERRUPTABLE POWER SUPPLY, SPECIAL	EACH	1				1					
# X8710024	FIBER OPTIC CABLE IN CONDUIT, NO. 62.5/125, MM12F SM24F	FOOT	8320				8320					
# X8760200	ACCESSIBLE PEDESTRIAN SIGNALS	EACH	28				28					
# X8780012	CONCRETE FOUNDATION, TYPE A 12 INCH DIAMETER	FOOT	4				4					
# X8809005	LED SIGNAL FACE, LENS COVER	EACH	46				46					
# X8860107	PREFORMED DETECTOR LOOP	FOOT	264				264					
XX007324	RECYCLING RECEPTACLE	EACH	4						4			

- SPECIALTY ITEM

MODEL Default
FILE Name: p:\work\pwbentley.com\shp-01\Documents\01_Active Projects\MW-CIS-168112005 - Green Bay Road - Phase 02 Design\CAD\Plan_Sheets\168112005-shs-001.dwg



USER NAME = JoelTurk	DESIGNED -	REVISED - 09/09/2024
	DRAWN -	REVISED -
PLOT SCALE = 2.0000' / in.	CHECKED -	REVISED -
PLOT DATE = 7/10/2024	DATE -	REVISED -

**STATE OF ILLINOIS
DEPARTMENT OF TRANSPORTATION**

**SUMMARY OF QUANTITIES
GREEN BAY ROAD**

SCALE: SHEET OF SHEETS STA. TO STA.

F.A.U. RTE.	SECTION	COUNTY	TOTAL SHEETS	SHEET NO.
2744	19-00285-00-R5	COOK	191	20
CONTRACT NO. 61K60			ILLINOIS FED. AID PROJECT	

LEGEND:

- PR BRICK PAVERS
- PR DETECTABLE WARNINGS
- PR PCC BASE COURSE 9"
- PR PCC BASE COURSE WIDENING 9"
- DEPRESSED CURB

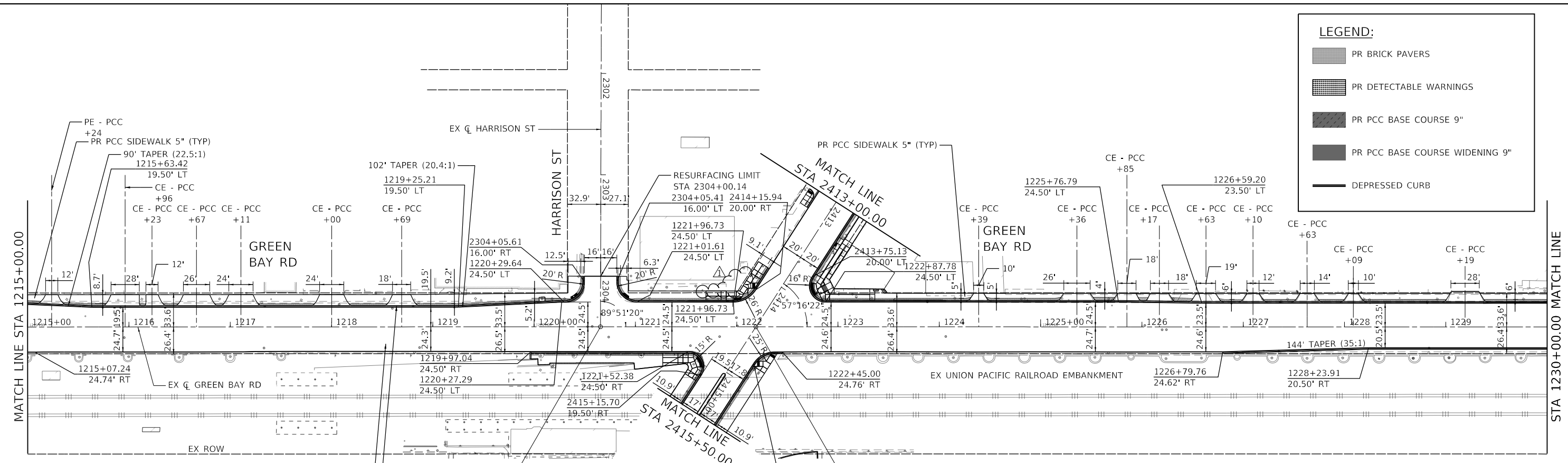

HOT-MIX ASPHALT SURFACE COURSE, MIX "D", IL-9.5, N70, 2" (TYP)
 HOT-MIX ASPHALT BINDER COURSE, IL-19.0, N70, 2.25" (TYP)
 PR COMB. CONC CURB & GUTTER, TYPE B-6.12 (TYP)

EX \bar{C} GREEN BAY ROAD STA 1220+65.50 =
 EX \bar{C} HARRISON STREET STA 2304+50.00

EX \bar{C} GREEN BAY ROAD STA 1222+18.94 =
 EX \bar{C} CENTRAL STREET STA 2414+46.41

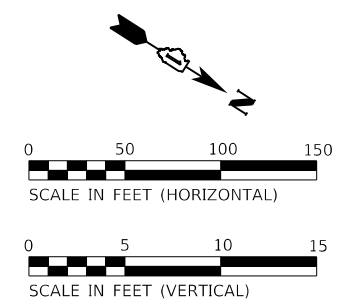

NOTE:
 FOR PE (PRIVATE ENTRANCE) AND CE (COMMERCIAL ENTRANCE) DRIVEWAY THICKNESSES, REFER TO DISTRICT ONE DETAIL BD-02.

MODEL: D:\pwworking\benley.com\khpw\01\Documents\01 Active Projects\MW-CHS-168112005 - Green Bay Road - Phase II Design\CAD\Plan Sheets\168112005-shl-ppp-02.dgn
 FILE NAME: pwworking\benley.com\khpw\01\Documents\01 Active Projects\MW-CHS-168112005 - Green Bay Road - Phase II Design\CAD\Plan Sheets\168112005-shl-ppp-02.dgn

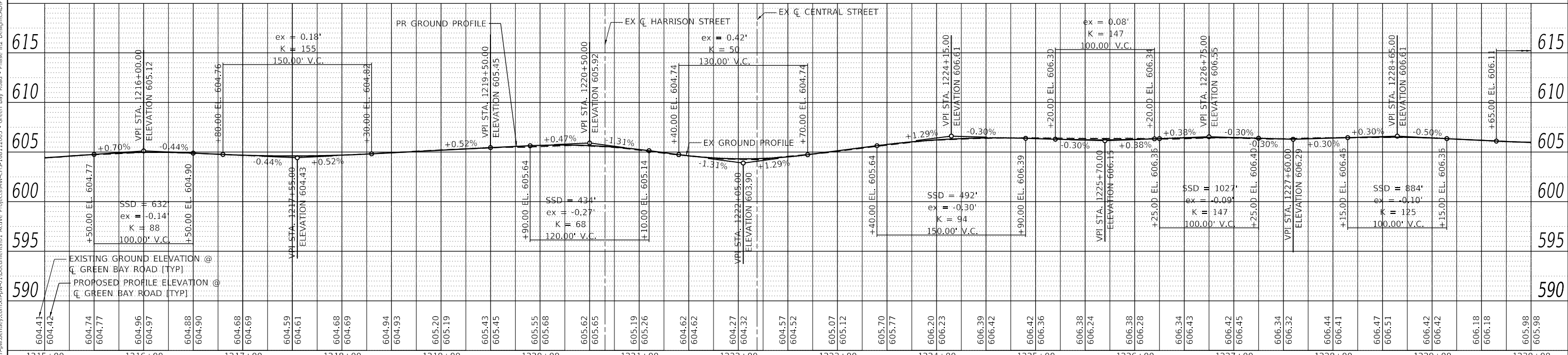

1215+00	1216+00	1217+00	1218+00	1219+00	1220+00	1221+00	1222+00	1223+00	1224+00	1225+00	1226+00	1227+00	1228+00	1229+00	1230+00
604.41	604.42	604.74	604.77	604.96	604.97	604.88	604.90	604.68	604.69	604.59	604.61	604.68	604.69	604.94	604.93
605.43	605.45	605.55	605.68	605.62	605.65	605.19	605.26	604.62	604.62	604.27	604.32	604.57	604.52	605.07	605.12
605.70	605.77	606.20	606.23	606.39	606.42	606.42	606.36	606.38	606.24	606.38	606.28	606.34	606.43	606.42	606.45
606.34	606.43	606.42	606.45	606.34	606.32	606.44	606.41	606.47	606.51	606.42	606.42	606.18	606.18	605.98	605.98

INFRASTRUCTURE ENGINEERING

USER NAME = olivia.elgazar	DESIGNED -	REVISED -
PLOT SCALE = 100.0000' / in.	DRAWN -	REVISED -
PLOT DATE = 7/10/2024	CHECKED -	REVISED -
	DATE -	REVISED -

**STATE OF ILLINOIS
 DEPARTMENT OF TRANSPORTATION**

**ROADWAY PLANS AND PROFILES
 GREEN BAY ROAD**

SCALE: $\frac{1}{4}'' = 50'$ (H); $\frac{1}{8}'' = 20'$ (V)
 SHEET 2 OF 3 SHEETS STA. 1215+00 TO STA. 1230+00

F.A.U. RTE. 2744	SECTION 19-00285-00-R5	COUNTY COOK	TOTAL SHEETS 191	SHEET NO. 35
CONTRACT NO. 61K60				
ILLINOIS FED. AID PROJECT				

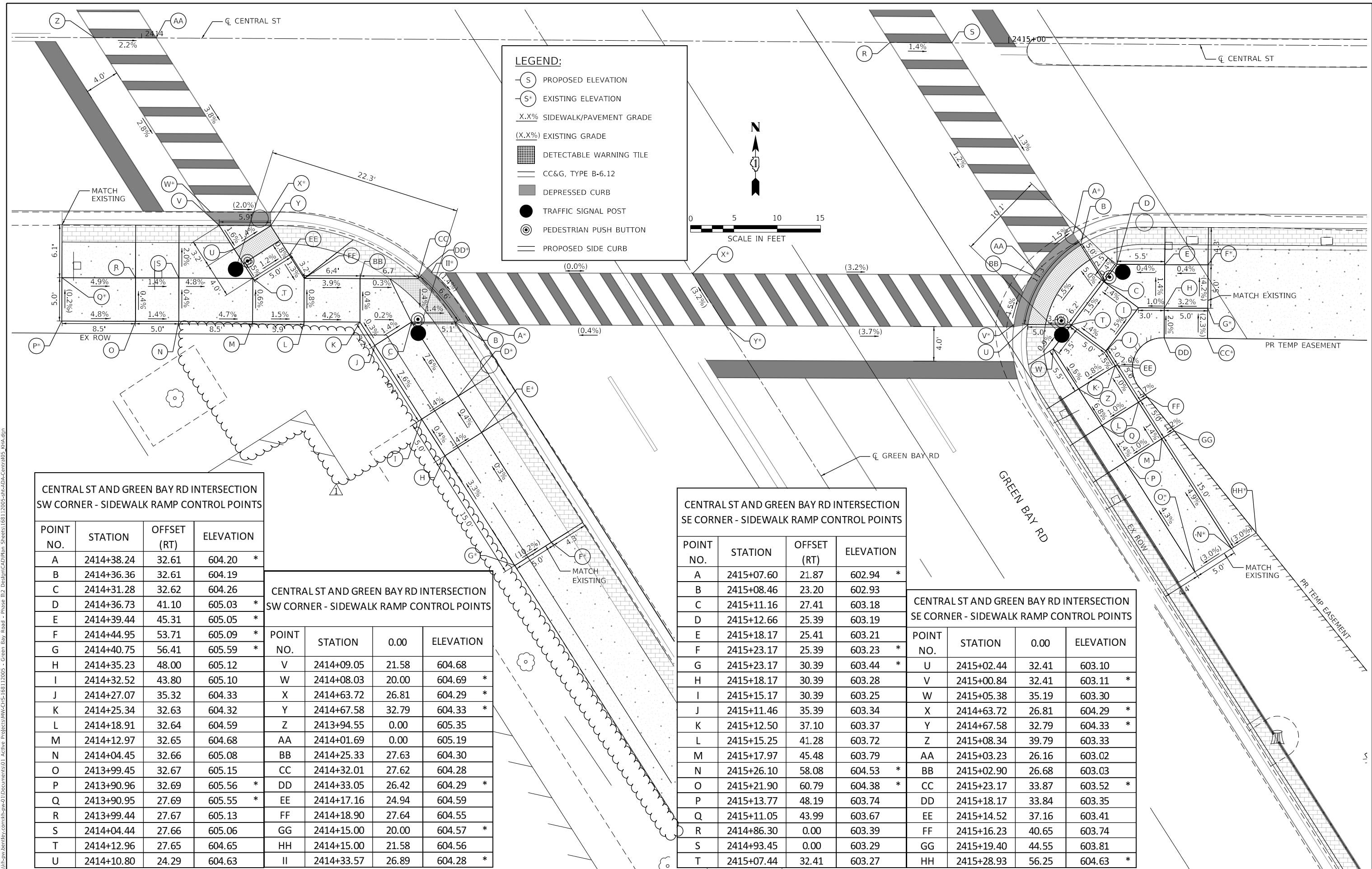

CENTRAL ST AND GREEN BAY RD INTERSECTION
SW CORNER - SIDEWALK RAMP CONTROL POINTS

POINT NO.	STATION	OFFSET (RT)	ELEVATION
A	2414+38.24	32.61	604.20 *
B	2414+36.36	32.61	604.19
C	2414+31.28	32.62	604.26
D	2414+36.73	41.10	605.03 *
E	2414+39.44	45.31	605.05 *
F	2414+44.95	53.71	605.09 *
G	2414+40.75	56.41	605.59 *
H	2414+35.23	48.00	605.12
I	2414+32.52	43.80	605.10
J	2414+27.07	35.32	604.33
K	2414+25.34	32.63	604.32
L	2414+18.91	32.64	604.59
M	2414+12.97	32.65	604.68
N	2414+04.45	32.66	605.08
O	2413+99.45	32.67	605.15
P	2413+90.96	32.69	605.56 *
Q	2413+90.95	27.69	605.55 *
R	2413+99.44	27.67	605.13
S	2414+04.44	27.66	605.06
T	2414+12.96	27.65	604.65
U	2414+10.80	24.29	604.63

CENTRAL ST AND GREEN BAY RD INTERSECTION
SW CORNER - SIDEWALK RAMP CONTROL POINTS

POINT NO.	STATION	0.00	ELEVATION
V	2414+09.05	21.58	604.68
W	2414+08.03	20.00	604.69 *
X	2414+63.72	26.81	604.29 *
Y	2414+67.58	32.79	604.33 *
Z	2413+94.55	0.00	605.35
AA	2414+01.69	0.00	605.19
BB	2414+25.33	27.63	604.30
CC	2414+32.01	27.62	604.28
DD	2414+33.05	26.42	604.29 *
EE	2414+17.16	24.94	604.59
FF	2414+18.90	27.64	604.55
GG	2414+15.00	20.00	604.57 *
HH	2414+15.00	21.58	604.56
II	2414+33.57	26.89	604.28 *

CENTRAL ST AND GREEN BAY RD INTERSECTION
SE CORNER - SIDEWALK RAMP CONTROL POINTS

POINT NO.	STATION	OFFSET (RT)	ELEVATION
A	2415+07.60	21.87	602.94 *
B	2415+08.46	23.20	602.93
C	2415+11.16	27.41	603.18
D	2415+12.66	25.39	603.19
E	2415+18.17	25.41	603.21
F	2415+23.17	25.39	603.23 *
G	2415+23.17	30.39	603.44 *
H	2415+18.17	30.39	603.28
I	2415+15.17	30.39	603.25
J	2415+11.46	35.39	603.34
K	2415+12.50	37.10	603.37
L	2415+15.25	41.28	603.72
M	2415+17.97	45.48	603.79
N	2415+26.10	58.08	604.53 *
O	2415+21.90	60.79	604.38 *
P	2415+13.77	48.19	603.74
Q	2415+11.05	43.99	603.67
R	2414+86.30	0.00	603.39
S	2414+93.45	0.00	603.29
T	2415+07.44	32.41	603.27

CENTRAL ST AND GREEN BAY RD INTERSECTION
SE CORNER - SIDEWALK RAMP CONTROL POINTS

POINT NO.	STATION	0.00	ELEVATION
U	2415+02.44	32.41	603.10
V	2415+00.84	32.41	603.11 *
W	2415+05.38	35.19	603.30
X	2414+63.72	26.81	604.29 *
Y	2414+67.58	32.79	604.33 *
Z	2415+08.34	39.79	603.33
AA	2415+03.23	26.16	603.02
BB	2415+02.90	26.68	603.03
CC	2415+23.17	33.87	603.52 *
DD	2415+18.17	33.84	603.35
EE	2415+14.52	37.16	603.41
FF	2415+16.23	40.65	603.74
GG	2415+19.40	44.55	603.81
HH	2415+28.93	56.25	604.63 *



USER NAME = olivia.elgazar	DESIGNED - KKH	REVISED - 9/6/2024
	DRAWN - KKH	REVISED -
PLOT SCALE = 10.0000 "/td> <td>CHECKED - MRL</td> <td>REVISED -</td>	CHECKED - MRL	REVISED -
PLOT DATE = 7/10/2024	DATE -	REVISED -

STATE OF ILLINOIS
DEPARTMENT OF TRANSPORTATION

INTERSECTION RAMP DETAILS
CENTRAL ST & GREEN BAY RD - SE & SW CORNER

SCALE: 1" = 5' SHEET OF SHEETS STA. TO STA.

F.A.U. RTE.	SECTION	COUNTY	TOTAL SHEETS	SHEET NO.
2744	19-00285-00-R5	COOK	191	88
CONTRACT NO. 61K60				
ILLINOIS FED. AID PROJECT				

MODEL: Default FILE: \\hpc\pwworking\kimley-horn.com\hpc\pwworking\01\Documents\01_Active\Projects\WV\CHS\168112005 - Green Bay Road - Phase II\2_Design\CAD\Plan_Sheets\168112005-shr-DA-Central05_KH.dgn

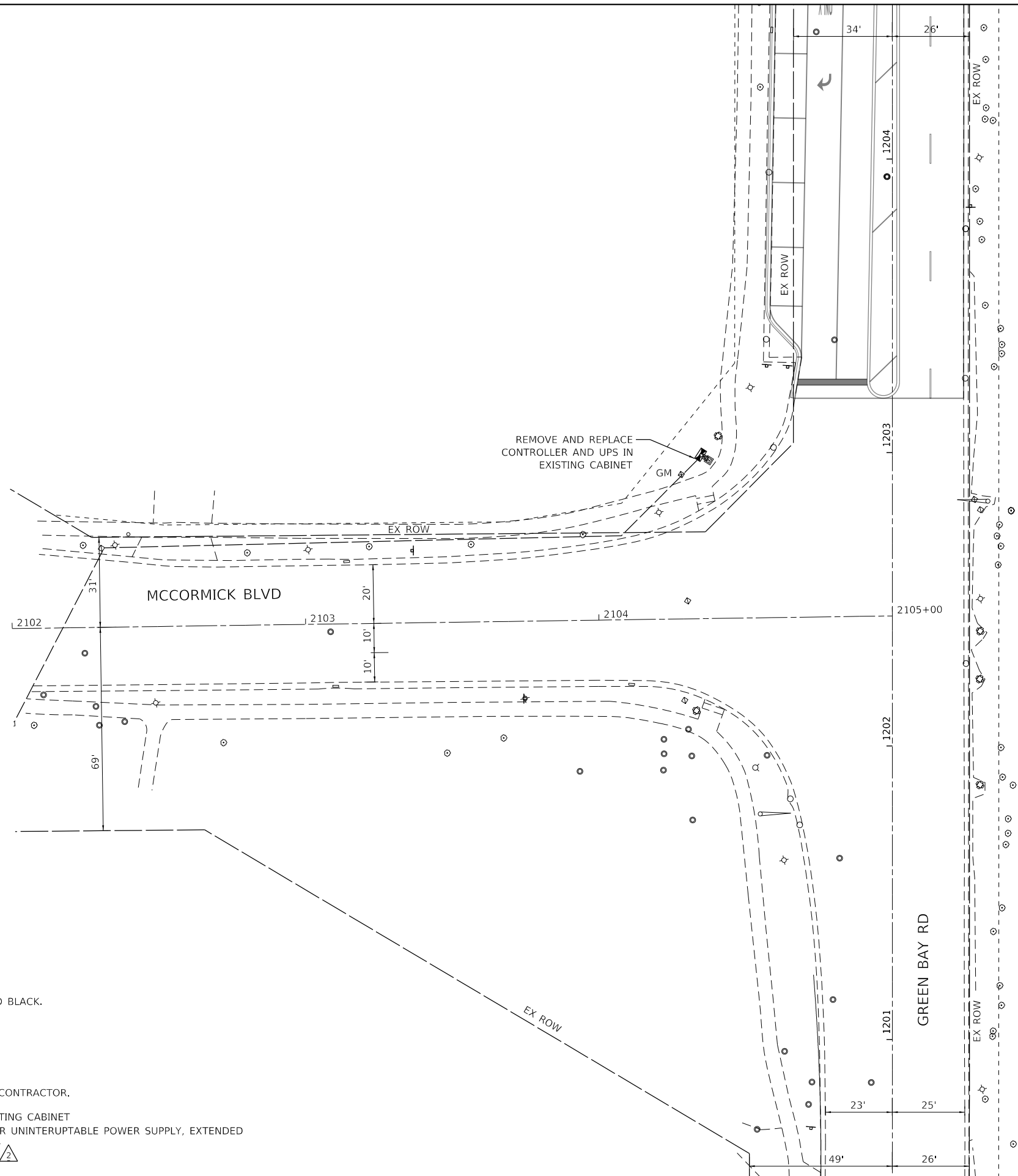

NOTES:

1. ALL TRAFFIC SIGNAL EQUIPMENT SHALL BE PAINTED BLACK.

INSTALLATION NOTES:

THE FOLLOWING ITEMS SHALL BE INSTALLED BY THE CONTRACTOR.

- 1 EACH FULL-ACTUATED CONTROLLER IN EXISTING CABINET
- 1 EACH REMOVE AND REPLACE BATTERIES FOR UNINTERRUPTABLE POWER SUPPLY, EXTENDED
- 1 EACH TRANSCEIVER - FIBER OPTIC

MODEL: Default
 FILE: \\mhc-pw-bentley.com\hpb\p-01\Documents\01 Active Projects\WW\CHS-168112005 - Green Bay Road - Phase II\2 Design\CAD\Plan Sheets\168112005-01-1203-00_KHA.dgn
 © 2014 KIMLEY-HORN AND ASSOCIATES, INC.
 400 WINDFIELD ROAD, SUITE 600
 WARRENVILLE, IL 60550
 PHONE: 630-487-6600
 WWW.KIMLEY-HORN.COM



USER NAME = JoelTurk	DESIGNED -	REVISED -	9/9/2024
PLOT SCALE = 40.0000 ' / in.	DRAWN -	REVISED -	
PLOT DATE = 7/10/2024	CHECKED -	REVISED -	
	DATE -	REVISED -	

**STATE OF ILLINOIS
DEPARTMENT OF TRANSPORTATION**

**PROPOSED TRAFFIC SIGNAL PLAN
GREEN BAY ROAD AND MCCORMICK BOULEVARD**

SCALE: 1" = 20' SHEET OF SHEETS STA. TO STA.

F.A.U. RTE.	SECTION	COUNTY	TOTAL SHEETS	SHEET NO.
2744	19-00285-00-R5	COOK	191	123
CONTRACT NO. 61K60				
ILLINOIS FED. AID PROJECT				

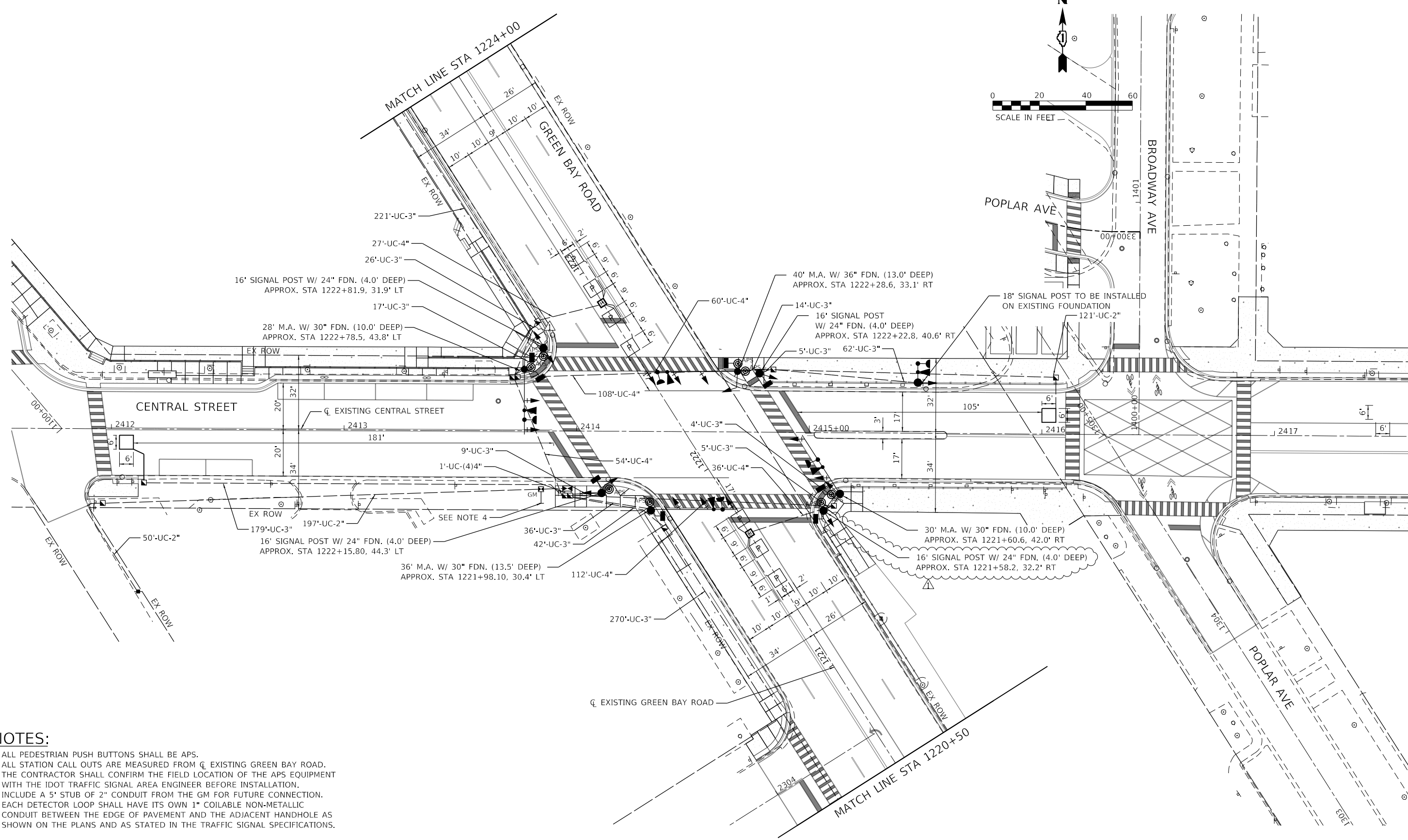
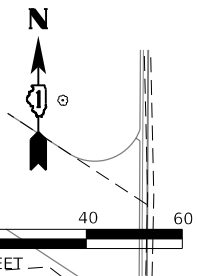

NOTES:

1. ALL PEDESTRIAN PUSH BUTTONS SHALL BE APS.
2. ALL STATION CALL OUTS ARE MEASURED FROM CL EXISTING GREEN BAY ROAD.
3. THE CONTRACTOR SHALL CONFIRM THE FIELD LOCATION OF THE APS EQUIPMENT WITH THE IDOT TRAFFIC SIGNAL AREA ENGINEER BEFORE INSTALLATION.
4. INCLUDE A 5' STUB OF 2" CONDUIT FROM THE GM FOR FUTURE CONNECTION.
5. EACH DETECTOR LOOP SHALL HAVE ITS OWN 1" COILABLE NON-METALLIC CONDUIT BETWEEN THE EDGE OF PAVEMENT AND THE ADJACENT HANDHOLE AS SHOWN ON THE PLANS AND AS STATED IN THE TRAFFIC SIGNAL SPECIFICATIONS.



USER NAME	= JoelTurk
DESIGNED	- XXX
DRAWN	- XXX
CHECKED	- XXX
DATE	-
DESIGNED	-
DRAWN	-
CHECKED	-
DATE	-

DESIGNED	- XXX
REVISION	1
DATE	9/6/2024
DESIGNED	-
DRAWN	-
CHECKED	-
DATE	-
DESIGNED	-
DRAWN	-
CHECKED	-
DATE	-

**STATE OF ILLINOIS
DEPARTMENT OF TRANSPORTATION**

**PROPOSED TRAFFIC SIGNAL PLAN
GREEN BAY ROAD AND CENTRAL STREET**

SCALE: 1" = 20' SHEET 1 OF 2 SHEETS STA. TO STA.

TS 13510			
F.A.U. RTE.	SECTION	COUNTY	TOTAL SHEETS
2744	19-00285-00-RS	COOK	191
			SHEET NO. 132
CONTRACT NO. 61K60			
ILLINOIS FED. AID PROJECT			

MODEL: D:\draft... FILE: MainC... Active Project\MKCHS168112005... Phase 1B2... Green Bay Road...

PROPOSED CONTROLLER SEQUENCE

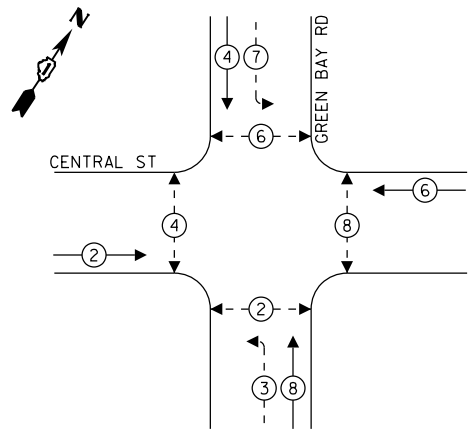

LEGEND:

- ← ⊙ ← PROTECTED PHASE
- ← ⊙ - PROTECTED/PERMITTED PHASE
- ← ⊙ → PEDESTRIAN PHASE

PROPOSED EMERGENCY VEHICLE PREEMPTION SEQUENCE

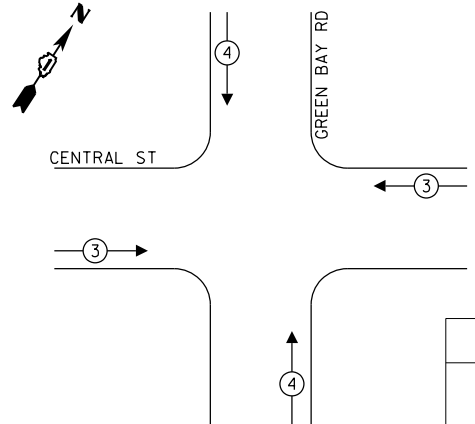

EMERGENCY VEHICLE PREEMPTORS		
EMERGENCY VEHICLE PREEMPTORS	3	4
MOVEMENT	← →	↓ ↑

TRAFFIC SIGNAL ELECTRICAL SERVICE REQUIREMENTS

TYPE	QUANTITY	UNIT WATTAGE	TOTAL WATTAGE
SIGNAL HEAD 1 OR 3-SECTION	15	11	165
4-SECTION	-	14	-
5-SECTION	4	13	52
PROGRAMMABLE 3-SECTION	-	22	-
4-SECTION	-	32	-
5-SECTION	-	28	-
PEDESTRIAN SIGNAL	8	15	120
CONTROLLER	1	150	150
MASTER CONTROLLER	-	100	-
UPS	1	25	25
DETECTION RADAR OR VIDEO	4	20	80
BLANK-OUT SIGN	-	25	-
NETWORK SWITCH II OR III	1	35	35
CELLULAR MODEM	-	15	-
TOTAL UPS SIZING		627	
UPS CHARGING	1	225	225
BATTERY HEATER MAT	1	180	180
CABINET HEATER	1	200	200
FLASHER	4	15	60
LED STREET NAME SIGN	-	120	-
LUMINAIRE	-	240	-
TOTAL SERVICE WIRE SIZING		1292	

ENERGY COSTS TO:
CITY OF EVANSTON
2100 RIDGE AVE
EVANSTON, ILLINOIS 60201

ENERGY SUPPLY: COMPANY: COMED
PHONE: 847-921-7629
ACCOUNT NUMBER: 04590-93148

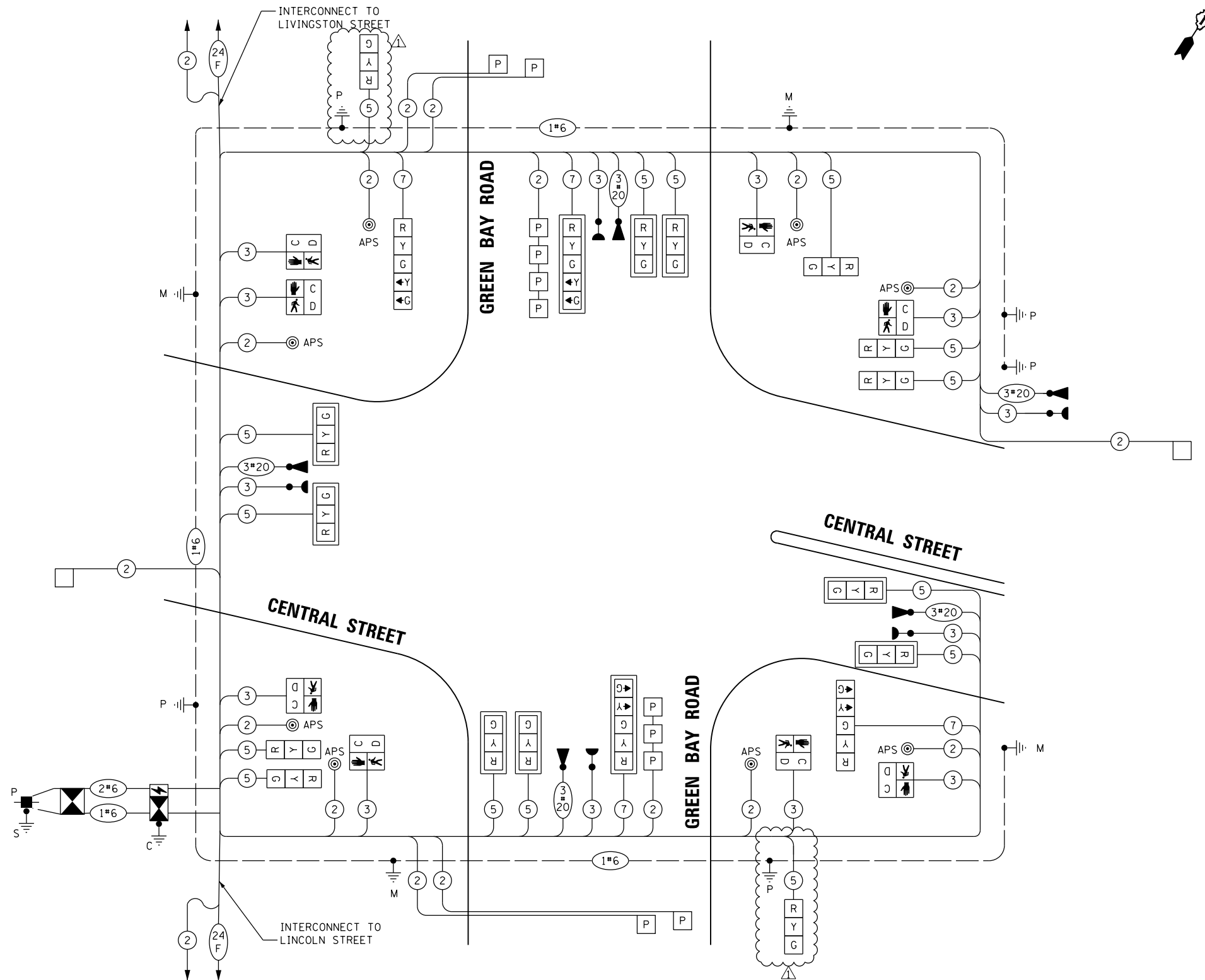

PROPOSED CABLE PLAN

(NOT TO SCALE)

NOTES

- ONLY RED SIGNAL FACES SHALL HAVE A LENS COVER INSTALLED.

STATE OF ILLINOIS
DEPARTMENT OF TRANSPORTATION

CABLE PLAN, PHASE DESIGNATION DIAGRAM,
AND EMERGENCY VEHICLE PREEMPTION SEQUENCE
GREEN BAY ROAD AND CENTRAL STREET

SCALE: SHEET OF SHEETS STA. TO STA.

F.A.U. RTE.	SECTION	COUNTY	TOTAL SHEETS	SHEET NO.
2744	19-00285-00-R5	COOK	191	134
CONTRACT NO. 61K60				

TS 13510

ILLINOIS FED. AID PROJECT

MODEL: Default FILE: N:\Projects\19-00285-00-R5\19-00285-00-R5-001.dwg DATE: 7/10/2024 10:00:00 AM USER: jhorne



© 2024 KIMLEY-HORN AND ASSOCIATES, INC.
400 WINDFIELD ROAD, SUITE 600
WARRENVILLE, IL 60550
PHONE: 630-471-4600
WWW.KIMLEY-HORN.COM

DESIGNED -	REVISION -	DATE -
DRAWN -	REVISION -	DATE -
CHECKED -	REVISION -	DATE -
DATE -	REVISION -	DATE -

SIGN PANEL – TYPE 1 OR TYPE 2

ALL DIMENSIONS ARE IN INCHES UNLESS OTHERWISE NOTED

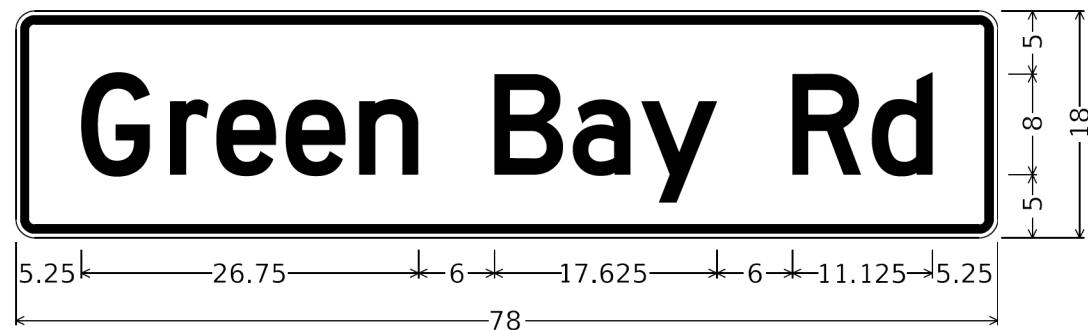

DESIGN SERIES	AREA (SQ FT)	SIGN PANEL TYPE	SHEETING TYPE	QTY. REQUIRED
D	9.75	2	ZZ	2

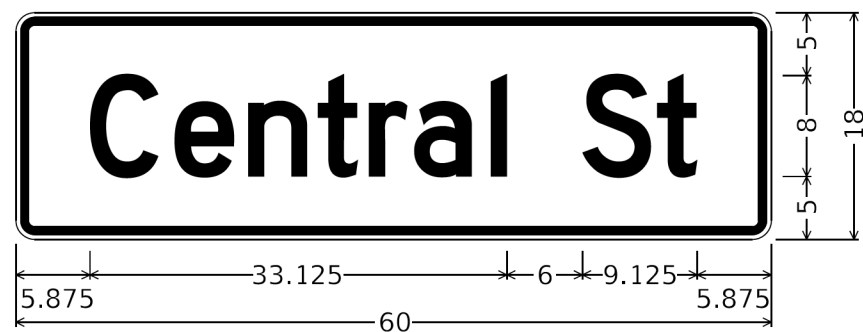

DESIGN SERIES	AREA (SQ FT)	SIGN PANEL TYPE	SHEETING TYPE	QTY. REQUIRED
D	7.5	1	ZZ	2

SCHEDULE OF QUANTITIES

ITEM DESCRIPTION	UNIT	QUANTITY
SIGN PANEL - TYPE 1	SQ FT	15
SIGN PANEL - TYPE 2	SQ FT	20
SERVICE INSTALLATION - GROUND MOUNTED	EACH	1
UNDERGROUND CONDUIT, GALVANIZED STEEL, 2" DIA.	FOOT	547
UNDERGROUND CONDUIT, GALVANIZED STEEL, 3" DIA.	FOOT	677
UNDERGROUND CONDUIT, GALVANIZED STEEL, 4" DIA.	FOOT	401
HANDHOLE	EACH	8
HEAVY-DUTY HANDHOLE	EACH	2
DOUBLE HANDHOLE	EACH	2
MASTER CONTROLLER	EACH	1
TRANSCEIVER - FIBER OPTIC	EACH	1
ELECTRIC CABLE IN CONDUIT, SIGNAL NO. 14 2C	FOOT	2369
ELECTRIC CABLE IN CONDUIT, SIGNAL NO. 14 3C	FOOT	2365
ELECTRIC CABLE IN CONDUIT, SIGNAL NO. 14 5C	FOOT	2150
ELECTRIC CABLE IN CONDUIT, SIGNAL NO. 14 7C	FOOT	688
ELECTRIC CABLE IN CONDUIT, SERVICE, NO. 6 2 C	FOOT	293
ELECTRIC CABLE IN CONDUIT, EQUIPMENT GROUNDING CONDUCTOR, NO. 6 1G	FOOT	1587
TRAFFIC SIGNAL POST, 16 FT.	EACH	4
TRAFFIC SIGNAL POST, 18 FT.	EACH	1
STEEL MAST ARM ASSEMBLY AND POLE, 28 FT.	EACH	1
STEEL MAST ARM ASSEMBLY AND POLE, 30 FT.	EACH	1
STEEL MAST ARM ASSEMBLY AND POLE, 36 FT.	EACH	1
STEEL MAST ARM ASSEMBLY AND POLE, 40 FT.	EACH	1
CONCRETE FOUNDATION, TYPE A	FOOT	16
CONCRETE FOUNDATION, TYPE C	FOOT	4
CONCRETE FOUNDATION, TYPE E 30-INCH DIAMETER	FOOT	34
CONCRETE FOUNDATION, TYPE E 36-INCH DIAMETER	FOOT	13
SIGNAL HEAD, LED, 1-FACE, 3-SECTION, MAST-ARM MOUNTED	EACH	8
SIGNAL HEAD, LED, 1-FACE, 3-SECTION, BRACKET MOUNTED	EACH	7
SIGNAL HEAD, LED, 1-FACE, 5-SECTION, BRACKET MOUNTED	EACH	2
SIGNAL HEAD, LED, 1-FACE, 5-SECTION, MAST-ARM MOUNTED	EACH	2
PEDESTRIAN SIGNAL HEAD, LED, 1-FACE, BRACKET MOUNTED WITH COUNTDOWN TIMER	EACH	8
TRAFFIC SIGNAL BACKPLATE, LOUVERED, FORMED PLASTIC	EACH	10
INDUCTIVE LOOP DETECTOR	EACH	8
DETECTOR LOOP TYPE	FOOT	70
PREFORMED DETECTOR LOOP	FOOT	264
CONFIRMATION BEACON	EACH	5
LIGHT DETECTOR	EACH	5
LIGHT DETECTOR AMPLIFIER	EACH	1
TEMPORARY TRAFFIC SIGNAL INSTALLATION	EACH	1
REMOVE ELECTRIC CABLE FROM CONDUIT	FOOT	7500
REMOVE EXISTING TRAFFIC SIGNAL EQUIPMENT	EACH	1
REMOVE EXISTING HANDHOLE	EACH	3
REMOVE EXISTING DOUBLE HANDHOLE	EACH	1
REMOVE EXISTING CONCRETE FOUNDATION	EACH	8
EMERGENCY VEHICLE PRIORITY SYSTEM LINE SENSOR CABLE, NO. 20 3/C	FOOT	78
FULL-ACTUATED CONTROLLER AND TYPE SUPER R CABINET (SPECIAL)	EACH	1
UNINTERRUPTIBLE POWER SUPPLY, SPECIAL	EACH	1
ACCESSIBLE PEDESTRIAN SIGNALS	EACH	8
LED SIGNAL FACE, LENS COVER	EACH	17
TEMPORARY TRAFFIC SIGNAL TIMING	EACH	1
TRANSCEIVER - FIBER OPTIC	EACH	1

MODEL - Default
 FILE NAME - p:\work\paw_bentley.com\paw-01\Documents\01_Active Projects\1W-CHS-168112005 - Green Bay Road - Phase B2_Design\CAD\Plan_Sheets\168112005-shs-us-pr-sqs-02_KJA.dgn
 © 2014 KIMLEY-HORN AND ASSOCIATES, INC.
 400 WILFIELD ROAD, SUITE 600
 WARRENVILLE, IL 60558
 PHONE: 630-487-6655
 WWW.KIMLEY-HORN.COM



USER NAME = JoelTurk	DESIGNED -	REVISED - 09/09/2024
PLOT SCALE = 2.0000' / in.	DRAWN -	REVISED -
PLOT DATE = 7/10/2024	CHECKED -	REVISED -
	DATE -	REVISED -

**STATE OF ILLINOIS
 DEPARTMENT OF TRANSPORTATION**

**MAST ARM MOUNTED STREET NAME SIGNS AND
 SCHEDULE OF QUANTITIES
 GREEN BAY ROAD AND CENTRAL STREET**

SCALE: N.T.S. SHEET OF SHEETS STA. TO STA.

F.A.U. RTE. 2744	SECTION 19-00285-00-R5	COUNTY COOK	TOTAL SHEETS 191	SHEET NO. 135
			CONTRACT NO. 61K60	
ILLINOIS FED. AID PROJECT				

TS 13510

SIGN PANEL – TYPE 1 OR TYPE 2

ALL DIMENSIONS ARE IN INCHES UNLESS OTHERWISE NOTED

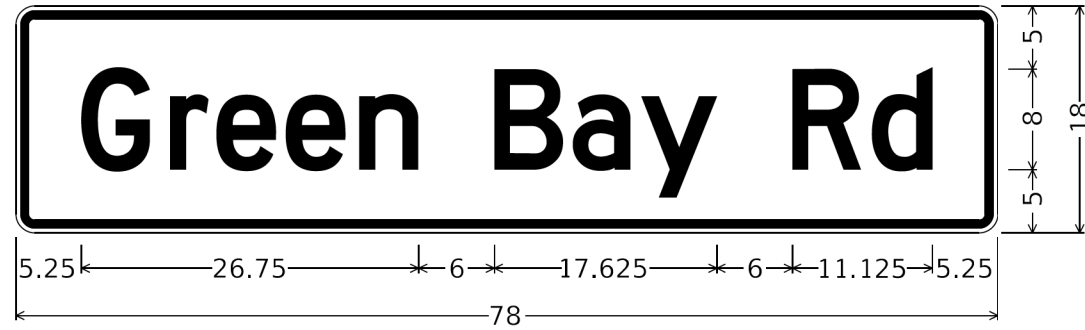

DESIGN SERIES	AREA (SQ FT)	SIGN PANEL TYPE	SHEETING TYPE	QTY. REQUIRED
D	9.75	2	ZZ	2



DESIGN SERIES	AREA (SQ FT)	SIGN PANEL TYPE	SHEETING TYPE	QTY. REQUIRED
D	9	2	ZZ	2

SCHEDULE OF QUANTITIES

ITEM DESCRIPTION	UNIT	QUANTITY
SIGN PANEL - TYPE 1	SQ FT	18
SIGN PANEL - TYPE 2	SQ FT	19.5
UNDERGROUND CONDUIT, GALVANIZED STEEL, 3" DIA.	FOOT	249
UNDERGROUND CONDUIT, GALVANIZED STEEL, 4" DIA.	FOOT	194
FULL-ACTUATED CONTROLLER AND TYPE IV CABINET	EACH	1
ELECTRIC CABLE IN CONDUIT, SIGNAL NO. 14 2C	FOOT	994
ELECTRIC CABLE IN CONDUIT, SIGNAL NO. 14 3C	FOOT	1777
ELECTRIC CABLE IN CONDUIT, SIGNAL NO. 14 5C	FOOT	1719
ELECTRIC CABLE IN CONDUIT, SERVICE, NO. 6 2C	FOOT	100
ELECTRIC CABLE IN CONDUIT, EQUIPMENT GROUNDING CONDUCTOR, NO. 6 1C	FOOT	1216
TRAFFIC SIGNAL POST, 10 FT.	EACH	1
TRAFFIC SIGNAL POST, 16 FT.	EACH	4
STEEL MAST ARM ASSEMBLY AND POLE, 16 FT.	EACH	1
STEEL MAST ARM ASSEMBLY AND POLE, 18 FT.	EACH	1
STEEL MAST ARM ASSEMBLY AND POLE, 20 FT.	EACH	1
STEEL MAST ARM ASSEMBLY AND POLE, 22 FT.	EACH	1
CONCRETE FOUNDATION, TYPE A	FOOT	67
CONCRETE FOUNDATION, TYPE C	FOOT	4
SIGNAL HEAD, LED, 1-FACE, 3-SECTION, MAST-ARM MOUNTED	EACH	6
SIGNAL HEAD, LED, 1-FACE, 3-SECTION, BRACKET MOUNTED	EACH	8
PEDESTRIAN SIGNAL HEAD, LED, 1-FACE, BRACKET MOUNTED WITH COUNTDOWN TIMER	EACH	8
CONFIRMATION BEACON	EACH	5
LIGHT DETECTOR	EACH	5
LIGHT DETECTOR AMPLIFIER	EACH	1
TEMPORARY TRAFFIC SIGNAL INSTALLATION	EACH	1
REMOVE EXISTING TRAFFIC SIGNAL EQUIPMENT	EACH	1
REMOVE EXISTING HANDHOLE	EACH	3
REMOVE EXISTING DOUBLE HANDHOLE	EACH	1
REMOVE EXISTING CONCRETE FOUNDATION	EACH	8
EMERGENCY VEHICLE PRIORITY SYSTEM LINE SENSOR CABLE, NO. 20 3/C	FOOT	783
ACCESSIBLE PEDESTRIAN SIGNALS	EACH	8
LED SIGNAL FACE, LENS COVER	EACH	15
TEMPORARY TRAFFIC SIGNAL TIMING	EACH	1
SERVICE INSTALLATION - POLE MOUNTED	EACH	1
TRANSCEIVER - FIBER OPTIC	EACH	1
INDUCTIVE LOOP DETECTOR	EACH	4
UNINTERUPTABLE POWER SUPPLY, SPECIAL	EACH	1

MODEL: Default FILE: \\miller-pix\hpc\p-bentley.com\hpc-01\Documents\01_Active Projects\MK-CHS-168112005 - Green Bay Road - Phase 02_Design\CAD\Plan_Sheets\168112005-sht-03-sign-03_KVA.dgn



USER NAME = JoelTurk	DESIGNED - XXX	REVISED - 09/09/2024
PLOT SCALE = 2,000' / in.	CHECKED - XXX	REVISED -
PLOT DATE = 7/10/2024	DATE -	REVISED -

**STATE OF ILLINOIS
DEPARTMENT OF TRANSPORTATION**

**MAST ARM MOUNTED STREET NAME SIGNS
AND SCHEDULE OF QUANTITIES
GREEN BAY ROAD AND LIVINGSTON STREET**

F.A.U. RTE.	SECTION	COUNTY	TOTAL SHEETS	SHEET NO.
2744	19-00285-00-R5	COOK	191	140
CONTRACT NO. 61K60				

SCALE: SHEET OF SHEETS STA. TO STA.

ILLINOIS FED. AID PROJECT

