

F.A.P. RTE.	SECTION	COUNTY	TOTAL SHEETS	SHEET NO.
335	119R-2	LAKE	439	126
STA.	432+83.12	TO STA.	470+56.84	
FED. ROAD DIST. NO.	ILLINOIS	FED. AID PROJECT		
		R3-8(MODIFIED)		60B01

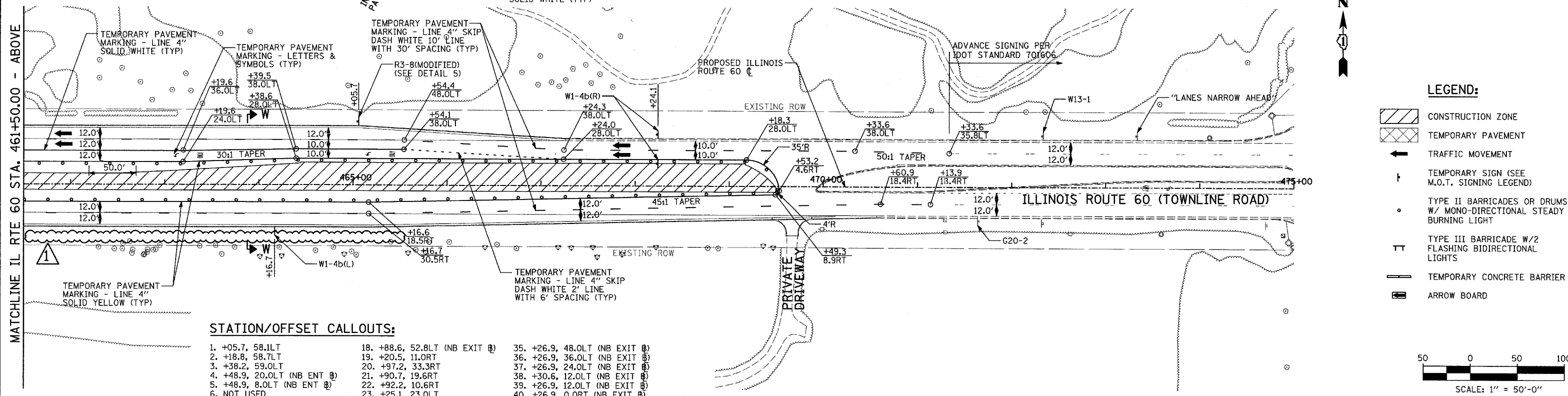

LEGEND:

- CONSTRUCTION ZONE
- TEMPORARY PAVEMENT
- TRAFFIC MOVEMENT
- TEMPORARY SIGN (SEE M.O.T. SIGNING LEGEND)
- TYPE II BARRICADES OR DRUMS W/ MONO-DIRECTIONAL STEADY BURNING LIGHT
- TYPE III BARRICADE W/2 FLASHING BIDIRECTIONAL LIGHTS
- TEMPORARY CONCRETE BARRIER
- ARROW BOARD

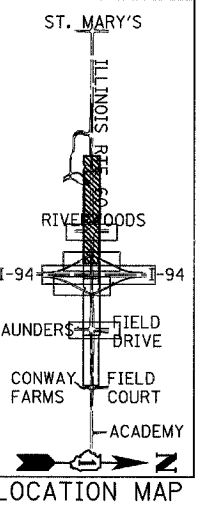
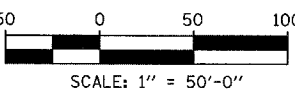

STATION/OFFSET CALLOUTS:

1. +05.7, 58.1LT	18. +88.6, 52.8LT (NB EXIT Ⓢ)	35. +26.9, 48.0LT (NB EXIT Ⓢ)
2. +18.8, 58.7LT	19. +20.5, 11.0RT	36. +26.9, 36.0LT (NB EXIT Ⓢ)
3. +38.2, 59.0LT	20. +97.2, 33.3RT	37. +26.9, 24.0LT (NB EXIT Ⓢ)
4. +48.9, 20.0LT (NB ENT Ⓢ)	21. +90.7, 19.6RT	38. +30.6, 12.0LT (NB EXIT Ⓢ)
5. +48.9, 8.0LT (NB ENT Ⓢ)	22. +92.2, 10.6RT	39. +26.9, 12.0LT (NB EXIT Ⓢ)
6. NOT USED	23. +25.1, 23.0LT	40. +26.9, 0.0RT (NB EXIT Ⓢ)
7. +16.4, 6.6RT (NB ENT Ⓢ)	24. +00.5, 45.2RT	41. +30.6, 0.0RT (NB EXIT Ⓢ)
8. NOT USED	25. +86.3, 73.5RT	42. +98.9, 13.9RT (NB EXIT Ⓢ)
9. +99.6, 30.9RT (NB ENT Ⓢ)	26. +03.3, 57.1RT	43. +03.7, 2.9RT (NB EXIT Ⓢ)
10. +92.6, 16.5RT (NB ENT Ⓢ)	27. +97.6, 36.0LT (NB EXIT Ⓢ)	44. +08.9, 9.0LT (NB EXIT Ⓢ)
11. +59.8, 23.0LT	28. +90.1, 32.0LT (NB EXIT Ⓢ)	45. +65.6, 55.8RT
12. +51.7, 59.1LT	29. +52.2, 59.0LT	46. +63.7, 43.8RT
13. +59.7, 59.0LT	30. +52.2, 47.0LT	47. +63.7, 43.8RT
14. +59.8, 47.0LT	31. +52.2, 23.0LT	
15. +59.8, 35.0LT	32. +52.2, 35.0LT	
16. +82.9, 63.4LT (NB EXIT Ⓢ)	33. +56.5, 24.0LT (NB EXIT Ⓢ)	
17. +71.8, 57.8RT	34. +50.6, 24.0LT (NB EXIT Ⓢ)	

REVISIONS

NAME	DATE

ILLINOIS DEPARTMENT OF TRANSPORTATION
 ILLINOIS RTE 60 OVER I-94
 MAINTENANCE OF TRAFFIC PLAN
 IL RTE 60 STA. 446+50.00 TO 475+00.00
 STAGE 5 - SHEET 2 OF 2

SCALE: 1"=50'-0"
 DATE: MAY 8, 2007
 DRAWN BY: MPG, CBS
 CHECKED BY: JDF

TYLIN INTERNATIONAL

ADDENDUM 1 08/31/07