

F.A.P. RTE.	SECTION	COUNTY	TOTAL SHEETS	SHEET NO.
335	119R-2	LAKE	439	170
STA. 432+83.12		TO STA. 470+56.84		
FED. ROAD DIST. NO.	ILLINOIS	FED. AID PROJECT		

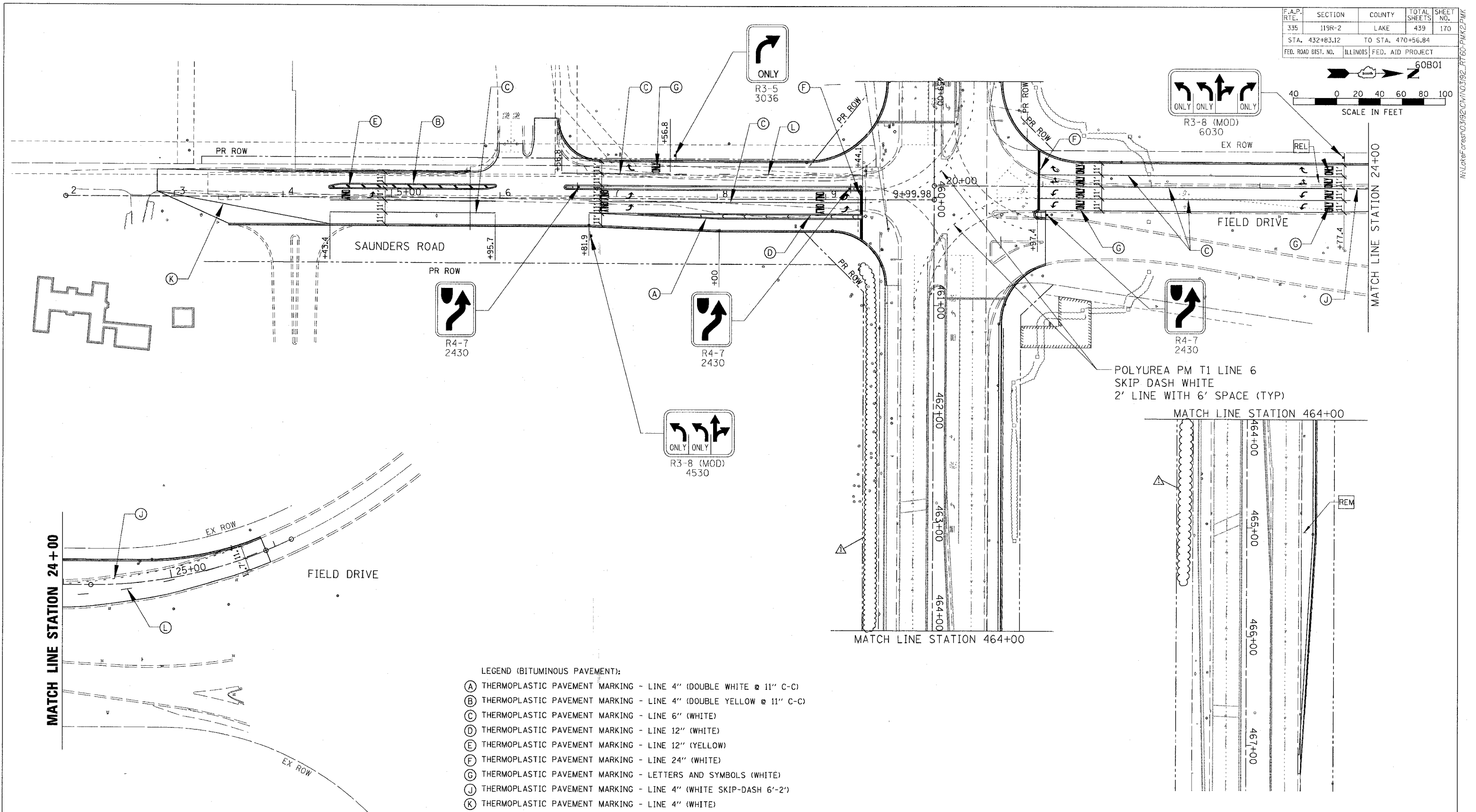
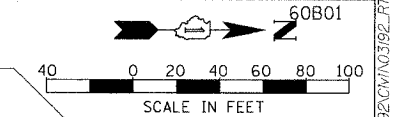

- LEGEND (BITUMINOUS PAVEMENT):
- (A) THERMOPLASTIC PAVEMENT MARKING - LINE 4" (DOUBLE WHITE @ 11" C-C)
  - (B) THERMOPLASTIC PAVEMENT MARKING - LINE 4" (DOUBLE YELLOW @ 11" C-C)
  - (C) THERMOPLASTIC PAVEMENT MARKING - LINE 6" (WHITE)
  - (D) THERMOPLASTIC PAVEMENT MARKING - LINE 12" (WHITE)
  - (E) THERMOPLASTIC PAVEMENT MARKING - LINE 12" (YELLOW)
  - (F) THERMOPLASTIC PAVEMENT MARKING - LINE 24" (WHITE)
  - (G) THERMOPLASTIC PAVEMENT MARKING - LETTERS AND SYMBOLS (WHITE)
  - (J) THERMOPLASTIC PAVEMENT MARKING - LINE 4" (WHITE SKIP-DASH 6'-2')
  - (K) THERMOPLASTIC PAVEMENT MARKING - LINE 4" (WHITE)
  - (L) THERMOPLASTIC PAVEMENT MARKING - LINE 4" (WHITE SKIP-DASH 30'-10')
- REL RELOCATE EXISTING SIGN  
 REM REMOVE EXISTING SIGN

NOTES:  
 SEE PROPOSED SIGNING PLAN SHEET 2 OF 4 FOR PROPOSED SIGNING ALONG IL RTE 60  
 SEE PAVEMENT MARKING AND LANDSCAPING PLAN SHEET 2 OF 6 FOR PAVEMENT MARKING ALONG IL RTE 60

REVISIONS	
NAME	DATE
ADDENDUM	08/31/07

ILLINOIS DEPARTMENT OF TRANSPORTATION  
 ILLINOIS RTE 60 OVER I-94  
 PAVEMENT MARKING AND SIGNING PLAN  
 INTERSECTION OF IL RTE 60  
 AND SAUNDRES RD/FIELD DR  
 SHEET 6 OF 6

SCALE: 1"=40'  
 DATE: 08/31/07

DRAWN BY: GT  
 CHECKED BY: MCW

**CHRISTOPHER B. BURKE ENGINEERING LTD.**  
 8675 West Higgins Road, Suite 600  
 Rosemont, Illinois 60018  
 (847) 823-0500

8/31/2007 2:07:56 PM