

F.A.P. RTE.	SECTION	COUNTY	TOTAL SHEETS	SHEET NO.
335	119R-2	LAKE	439	173
STA. 432+83.12		TO STA. 470+56.84		
FED. ROAD DIST. NO.		ILLINOIS	FED. AID PROJECT	

60B01

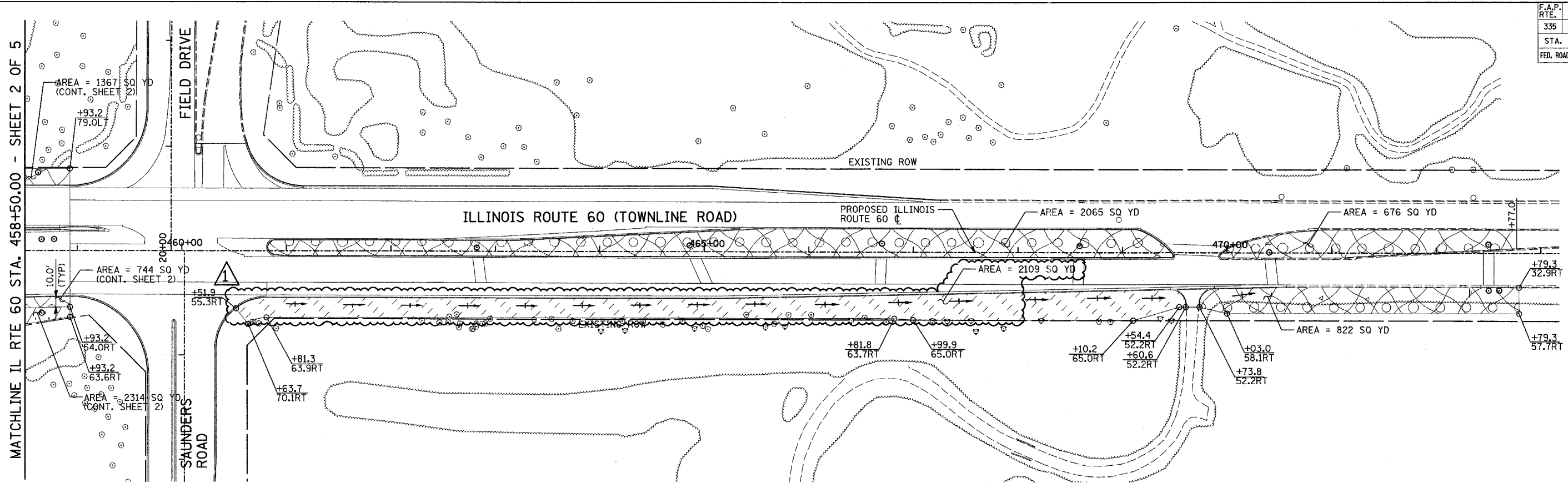

MATCHLINE IL RTE 60 STA. 458+50.00 - SHEET 2 OF 5

LEGEND:

- SEEDING CLASS 2A, 4" TOPSOIL AND NUTRIENTS WITH EROSION CONTROL BLANKET
- SEEDING CLASS 3, 4" TOPSOIL AND NUTRIENTS WITH EROSION CONTROL BLANKET
- SEEDING CLASS 4A, 4" TOPSOIL AND NUTRIENTS WITH EROSION CONTROL BLANKET
- SODDING, 4" TOPSOIL AND NUTRIENTS

NOTES:

1. SEE ALSO LANDSCAPING AND EROSION CONTROL PLAN SHEET 6 OF 6, FOR ADDITIONAL LANDSCAPING.

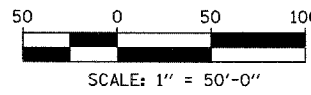
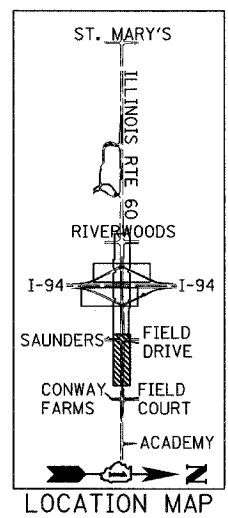

REVISIONS	
NAME	DATE
ADDENDUM 1	08/31/07

ILLINOIS DEPARTMENT OF TRANSPORTATION
 ILLINOIS RTE 60 OVER I-94
 LANDSCAPING PLANS
 IL RTE 60 STA. 458+50.00 TO 470+56.84
 SHEET 3 OF 5

SCALE: 1"=50'-0"
 DATE: MAY 8, 2007
 DRAWN BY: CBS
 CHECKED BY: MPG

TYLIN INTERNATIONAL