

F.A.P. RTE.	SECTION	COUNTY	TOTAL SHEETS	SHEET NO.
335	119R-2	LAKE	439	179
STA. 432+83.12		TO STA. 470+56.84		
FED. ROAD DIST. NO.		ILLINOIS		FED. AID PROJECT

60B01



SIGNING LEGEND:

- - - EXISTING GROUND MOUNTED SIGN
- - - PROPOSED GROUND MOUNTED SIGN
- R1-1 - SEE PROPOSED SIGNING LEGEND AND SCHEDULE



PROPOSED LARGE SIGN PANEL (SEE SIGN PANEL DETAILS AND SCHEDULE)

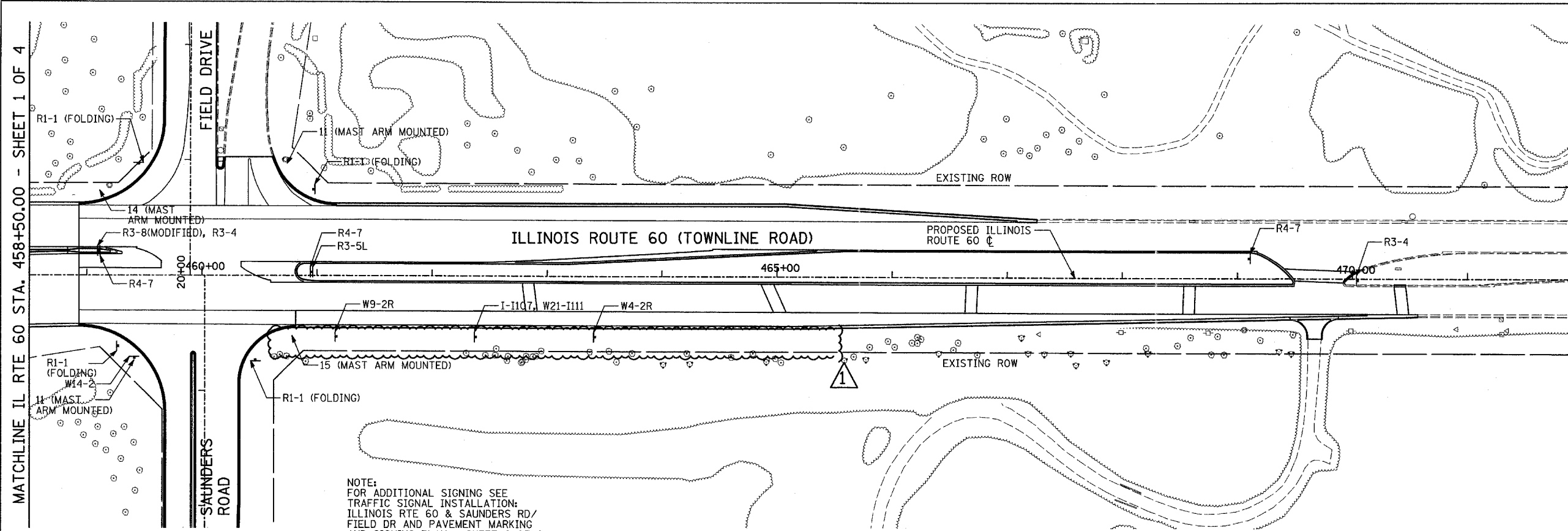

MATCHLINE IL RTE 60 STA. 458+50.00 - SHEET 1 OF 4

NOTE:
FOR ADDITIONAL SIGNING SEE
TRAFFIC SIGNAL INSTALLATION
ILLINOIS RTE 60 & SAUNDERS RD/
FIELD DR AND PAVEMENT MARKING
AND SIGNING PLAN - SHEET 6 OF 6

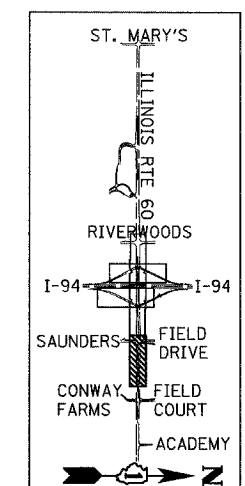

LOCATION MAP

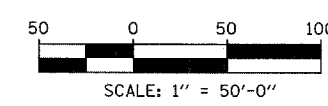

REVISIONS	
NAME	DATE

ILLINOIS DEPARTMENT OF TRANSPORTATION
ILLINOIS RTE 60 OVER I-94

PROPOSED SIGNING PLAN
IL RTE 60 STA. 458+50.00 TO 470+56.84
SHEET 2 OF 4

SCALE: 1"=50'-0"
DATE: MAY 8, 2007
DRAWN BY: AMB
CHECKED BY: MPG

ADDENDUM 1 08/31/07

TYLIN INTERNATIONAL