

F.A.P. RTE.	SECTION	COUNTY	TOTAL SHEETS	SHEET NO.
335	119R-2	LAKE	439	196
STA. 432+83.12		TO STA. 470+56.84		
FED. ROAD DIST. NO.		ILLINOIS FED. AID PROJECT		

60B01

**NOTE:**  
THE TRAFFIC SIGNAL CONTROLLER EQUIPMENT FOR THIS PROJECT SHALL BE "EAGLE" TO MATCH THE EXISTING ADJACENT SYSTEM.

**LEFT ON GREEN ARROW ONLY**

R10-5  
24"X30"  
**SIGN DETAIL**  
N.T.S.  
7 REQUIRED

MATCHLINE ILL-60 STA. 457+79.84 (SEE INSET BELOW)

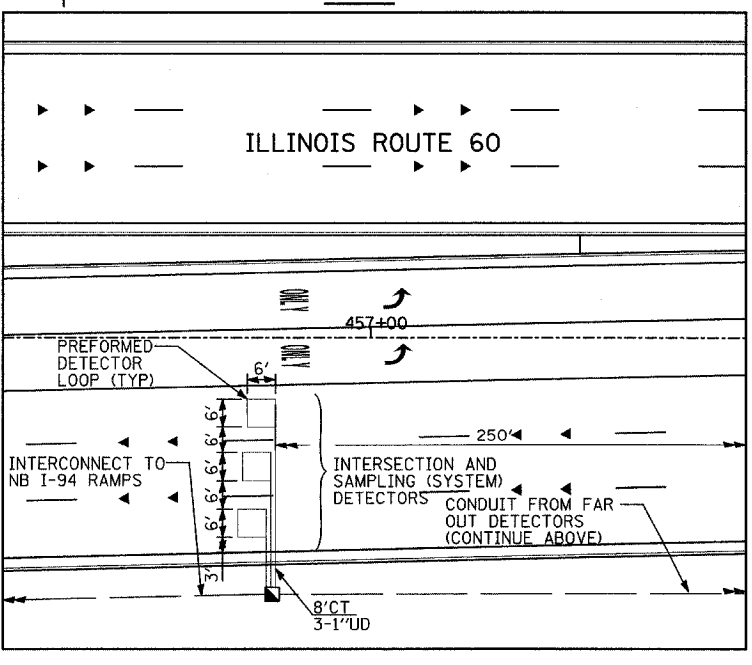

MATCHLINE ILL-60 STA. 457+50.00 (CONT. ABOVE)

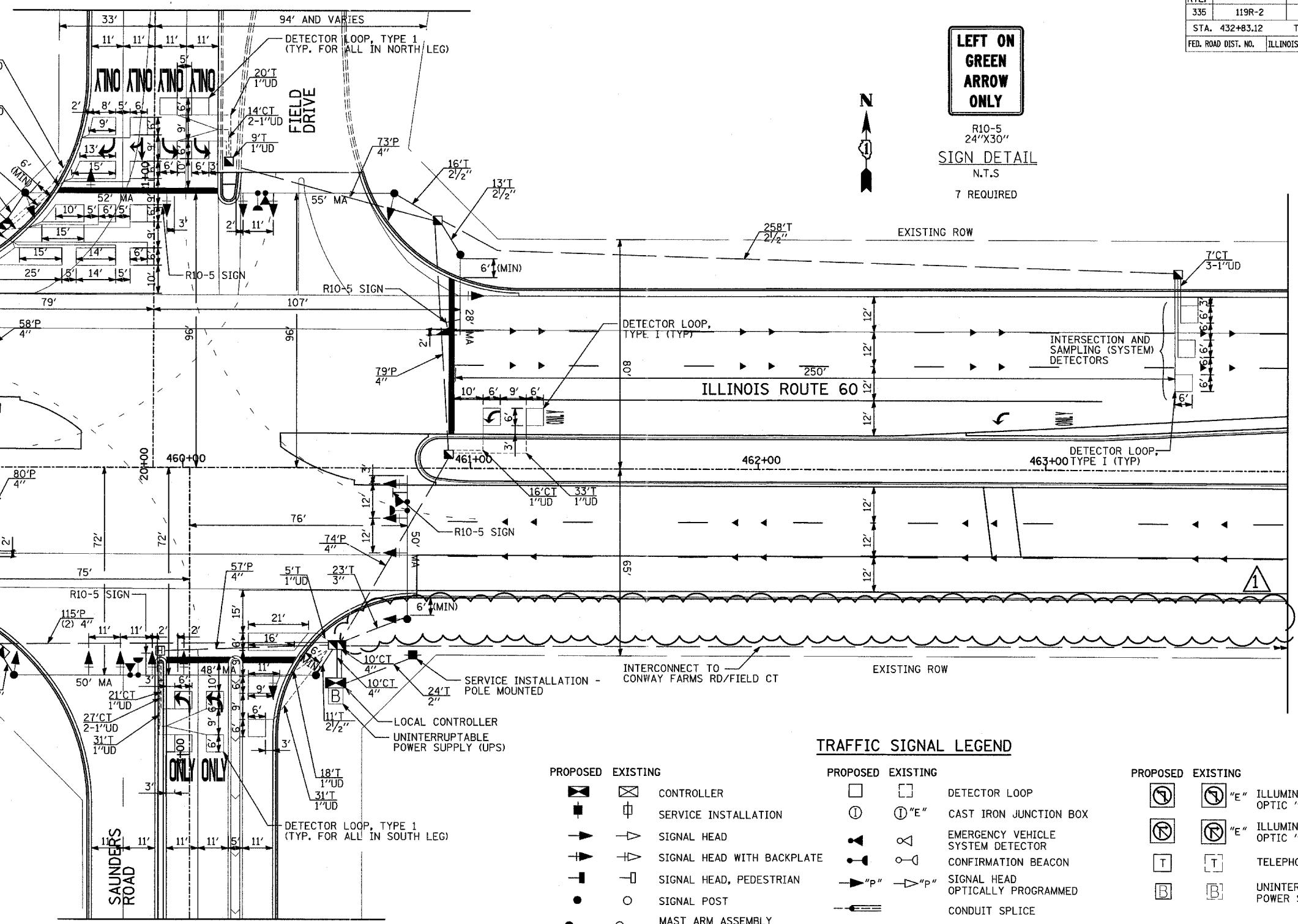

**TRAFFIC SIGNAL LEGEND**

PROPOSED	EXISTING	DESCRIPTION
		CONTROLLER
		SERVICE INSTALLATION
		SIGNAL HEAD
		SIGNAL HEAD WITH BACKPLATE
		SIGNAL HEAD, PEDESTRIAN
		SIGNAL POST
		MAST ARM ASSEMBLY AND POLE, STEEL
		MAST ARM ASSEMBLY AND POLE, ALUMINUM
		COMMON TRENCH
		UNIT DUCT
		HANDHOLE
		HEAVY DUTY HANDHOLE
		DOUBLE HANDHOLE
		G.S. CONDUIT IN TRENCH OR PUSHED
		PEDESTRIAN PUSH-BUTTON DETECTOR
		DETECTOR LOOP
		CAST IRON JUNCTION BOX
		EMERGENCY VEHICLE SYSTEM DETECTOR
		CONFIRMATION BEACON
		SIGNAL HEAD OPTICALLY PROGRAMMED
		WOOD POLE
		RACEWAY FOR MAGNETIC DETECTOR, TYPE I OR TYPE II
		VEHICLE DETECTOR, NON COMPENSATED, MAGNETIC TYPE
		RAILROAD CONTROL CABINET
		TELEPHONE
		UNINTERRUPTIBLE POWER SUPPLY (UPS)

**RESTORATION OF WORK AREA:**  
RESTORATION OF THE TRAFFIC SIGNAL WORK AREA SHALL BE INCLUDED IN THE COST TO THE RELATED PAY ITEMS SUCH AS FOUNDATION, CONDUIT, HANDHOLE, TRENCH AND BACKFILL, ETC., AND NO EXTRA COMPENSATION SHALL BE ALLOWED. ALL ROADWAY SURFACES SUCH AS SHOULDERS, MEDIANS, SIDEWALKS, PAVEMENT, ETC. SHALL BE REPLACED IN KIND. ALL DAMAGE TO MOWED LAWNS SHALL BE REPLACED WITH AN APPROVED SOD. ALL DAMAGE TO UNMOWED FIELDS SHALL BE SEEDING IN ACCORDANCE WITH STANDARD SPECIFICATIONS 250 AND 252 RESPECTIVELY.

REVISIONS	
NAME	DATE

ILLINOIS DEPARTMENT OF TRANSPORTATION  
ILLINOIS RTE 60 OVER I-94  
**TRAFFIC SIGNAL INSTALLATION**  
ILL RTE 60 & SAUNDERS RD/FIELD DR  
SCALE: 1"=20'-0"  
DATE: MAY 8, 2007  
DRAWN BY: CBS  
CHECKED BY: DMJ

TYLIN INTERNATIONAL

ADDENDUM 1 08/31/07