

F.A.P. RTE.	SECTION	COUNTY	TOTAL SHEETS	SHEET NO.
335	119R-2	LAKE	439	301
STA. 432+83.12 TO STA. 470+56.84				
FED. ROAD DIST. NO. ILLINOIS		FED. AID PROJECT		

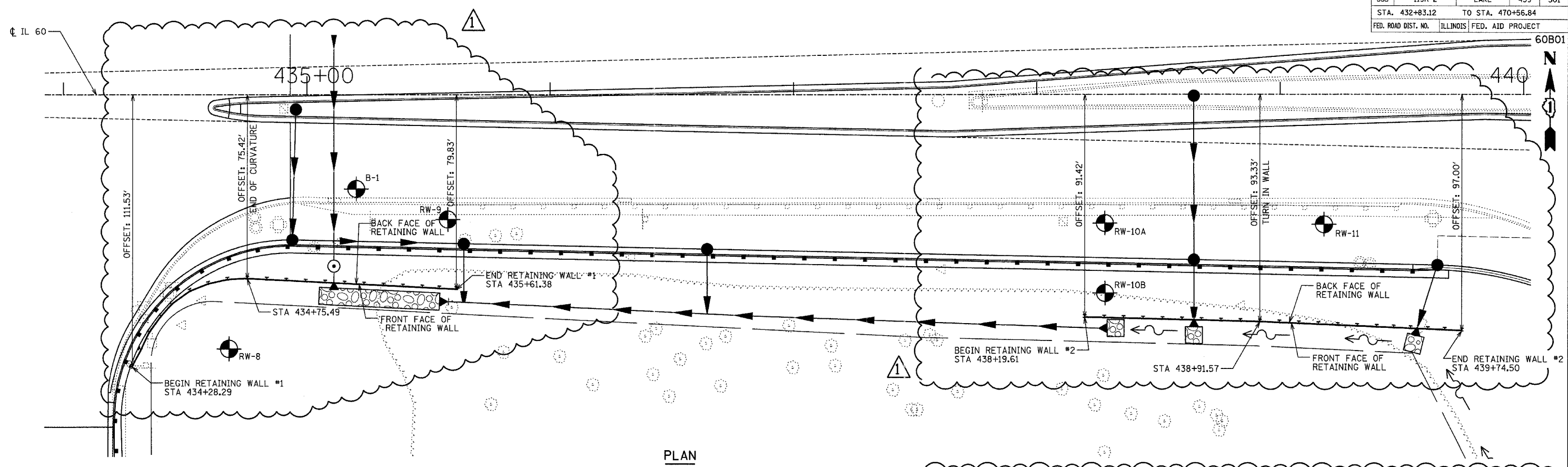

PLAN

FOR ELEVATION VIEW, SEE PLAN AND ELEVATION SHEET

FOR ELEVATION VIEW, SEE PLAN AND ELEVATION SHEET

TYLIN INTERNATIONAL

BILL OF MATERIAL

ITEM	UNIT	TOTAL
STRUCTURE EXCAVATION	CU YD	24
TREATED TIMBER LAGGING	SQ FT	2,053
FURNISHING SOLDIER PILES HP12X53	FOOT	250
FURNISHING SOLDIER PILES HP14X73	FOOT	620
DRIVING SOLDIER PILES	FOOT	870

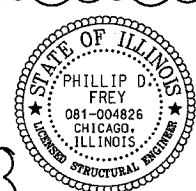

Signed *Phillip D. Frey*
 Phillip D. Frey, S.E. Il. Lic. No. 081-004826
 Expires 11-30-2008. For drawings 301, 301A, 301B, and 301C.
 Date 8-31-07

REVISIONS	
NAME	DATE

ILLINOIS DEPARTMENT OF TRANSPORTATION
 ILLINOIS RTE 60 OVER I-94
 RETAINING WALLS 1 AND 2
 FROM STA 434+28.29 TO STA 435+61.38
 AND STA 438+19.61 TO STA 439+74.50

SCALE: DATE: MAY 8, 2007
 DRAWN BY: DE, MAF
 CHECKED BY: SP, PF