

F.A.P. RTE.	SECTION	COUNTY	TOTAL SHEETS	SHEET NO.
335	119R-2	LAKE	439	46
STA. 432+83.12		TO STA. 470+56.84		
FED. ROAD DIST. NO.		ILLINOIS	FED. AID PROJECT	

60B01

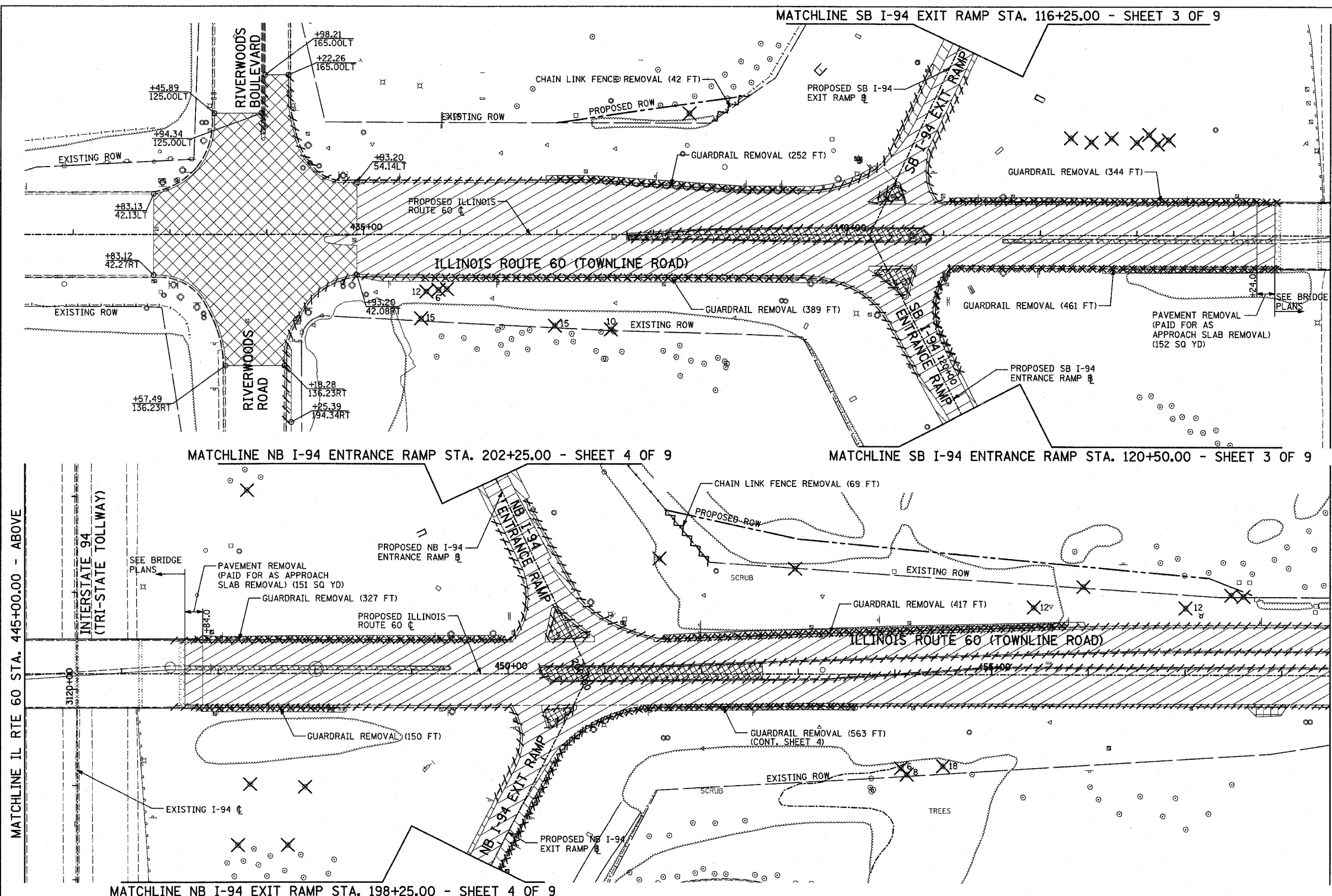

- REMOVAL LEGEND:**
- PAVEMENT REMOVAL
 - PAVED SHOULDER REMOVAL
 - BITUMINOUS SURFACE REMOVAL, 2 3/4"
 - MEDIAN REMOVAL
 - DRIVEWAY PAVEMENT REMOVAL
 - COMB CONC CURB & GUTTER REMOVAL
 - GUARDRAIL REMOVAL
 - CHAIN LINK FENCE REMOVAL
 - LIGHT POLE FOUNDATION REMOVAL (SEE ROADWAY LIGHTING & SURVEILLANCE PLANS)
 - TREE REMOVAL (UNITS) (NO UNIT SHOWN = <6)
- PLAN NOTES:**
- ALL STATION/OFFSET/RADIUS CALLOUTS MEASURED TO EDGE OF PAVEMENT UNLESS OTHERWISE NOTED.

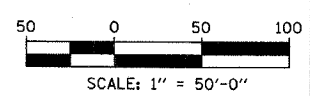
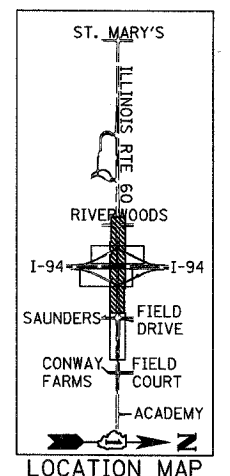

REVISIONS	
NAME	DATE

ILLINOIS DEPARTMENT OF TRANSPORTATION
 ILLINOIS RTE 60 OVER I-94
 EXISTING CONDITIONS AND REMOVAL PLAN
 IL RTE 60 STA. 432+83.12 TO 458+50.00
 SHEET 1 OF 9

SCALE: 1"=50'-0"
 DATE: MAY 8, 2007

DRAWN BY: CBS
 CHECKED BY: MPG

TYLIN INTERNATIONAL

5/17/2007 8:43:01 AM