

F.A.P. RTE.	SECTION	COUNTY	TOTAL SHEETS	SHEET NO.
335	119R-2	LAKE	439	62
STA. 432+83.12 TO STA. 470+56.84		ILLINOIS FED. AID PROJECT		

PLAN	DATE
SURVEYED	
NOTED	
CHECKED	
BY	

PROFILE	DATE
SURVEYED	
NOTED	
CHECKED	
BY	

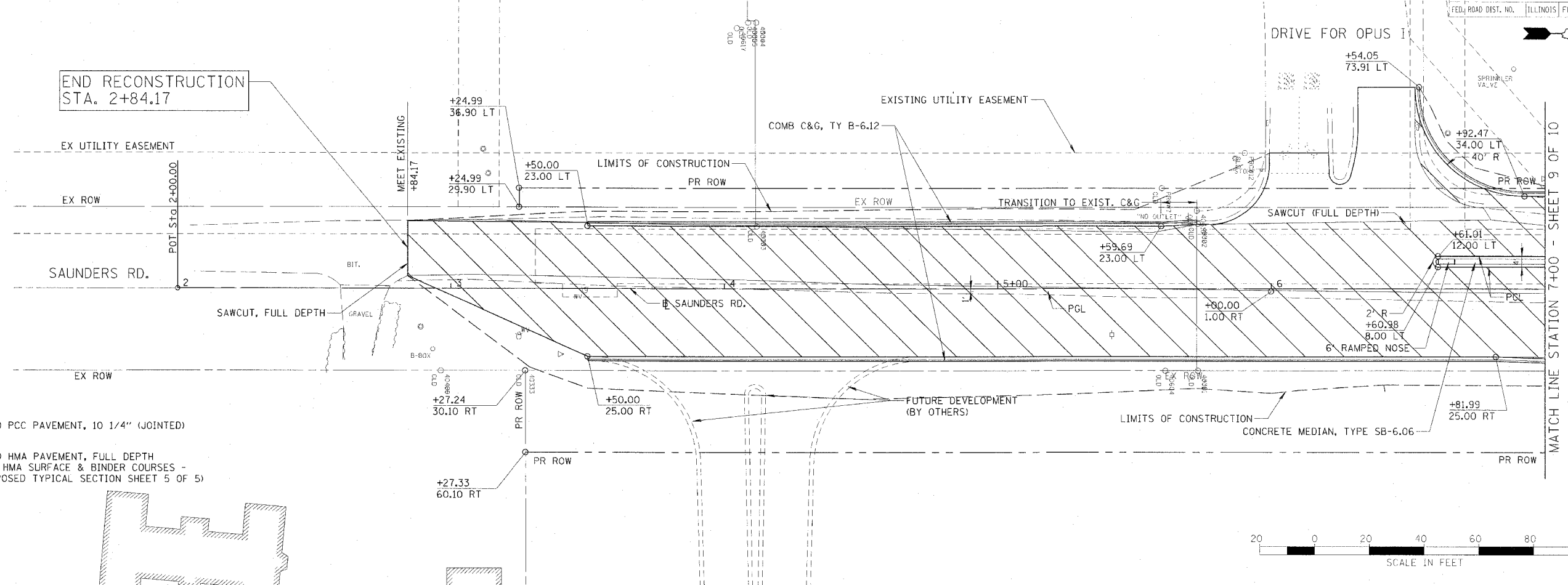

- LEGEND:**
- PROPOSED PCC PAVEMENT, 10 1/4" (JOINTED)
 - PROPOSED HMA PAVEMENT, FULL DEPTH (PAID AS HMA SURFACE & BINDER COURSES - SEE PROPOSED TYPICAL SECTION SHEET 5 OF 5)

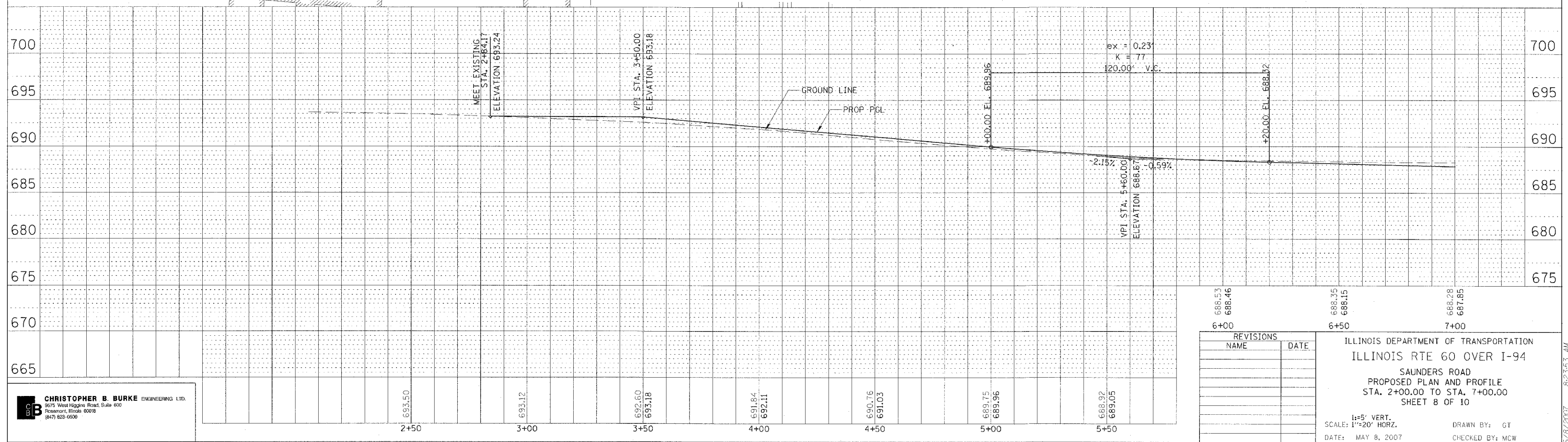

CHRISTOPHER B. BURKE ENGINEERING LTD.
 2570 West Higgins Road, Suite 400
 Rosemont, Illinois 60018
 (847) 823-0500

REVISIONS	
NAME	DATE

ILLINOIS DEPARTMENT OF TRANSPORTATION
 ILLINOIS RTE 60 OVER I-94
 SAUNDERS ROAD
 PROPOSED PLAN AND PROFILE
 STA. 2+00.00 TO STA. 7+00.00
 SHEET 8 OF 10

SCALE: 1"=20' HORZ.
 1"=5' VERT.
 DATE: MAY 8, 2007
 DRAWN BY: GT
 CHECKED BY: MCW

8/23/07
 8:23:53 AM
 W:\User\cristof03192\DWG\13192_SAUNDERS_R1.PLT