

F.A.P. RTE.	SECTION	COUNTY	TOTAL SHEETS	SHEET NO.
335	119R-2	LAKE	439	78
STA. 432+83.12		TO STA. 470+56.84		
FED. ROAD DIST. NO.	ILLINOIS		FED. AID PROJECT	

60B01

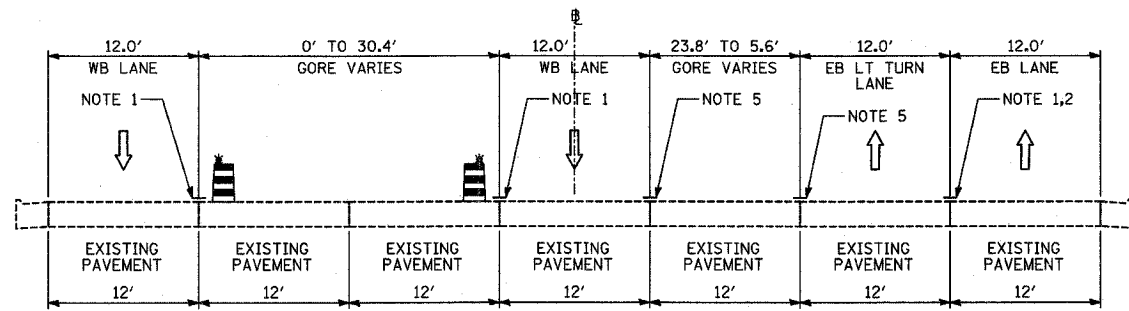

A-A
STAGES 1 & 1A: IL-60; STA. 428+45 TO STA. 433+00

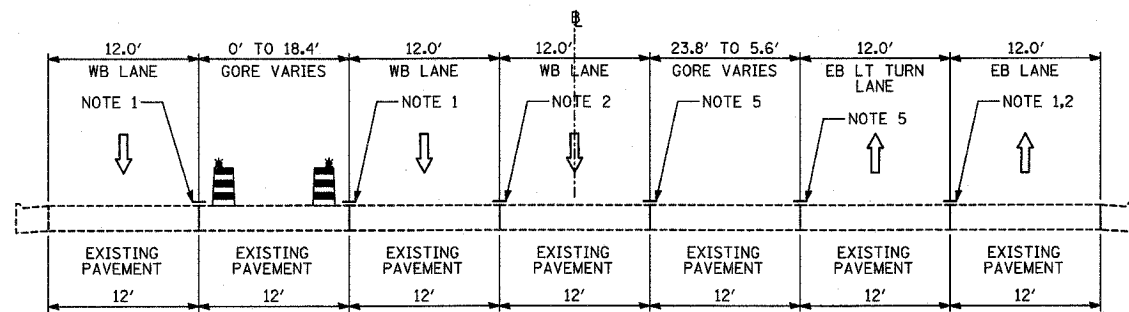

B-B
STAGE 2: IL-60; STA. 428+45 TO STA. 433+00

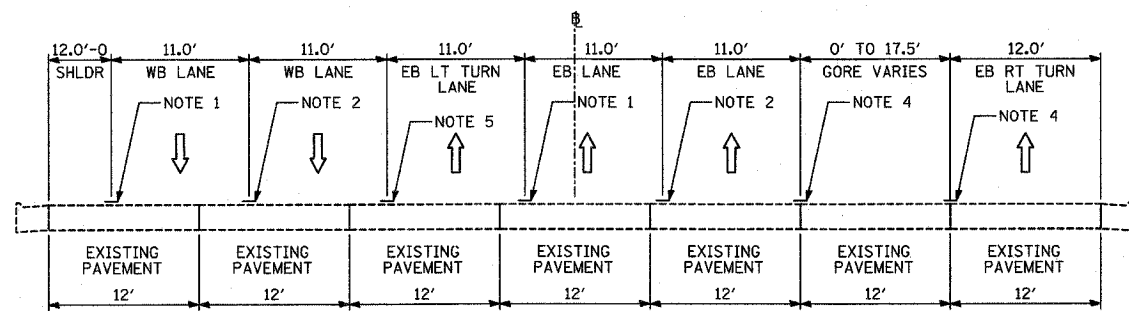

C-C
STAGES 3, 3A, & 4: IL-60; STA. 428+45 TO STA. 433+00

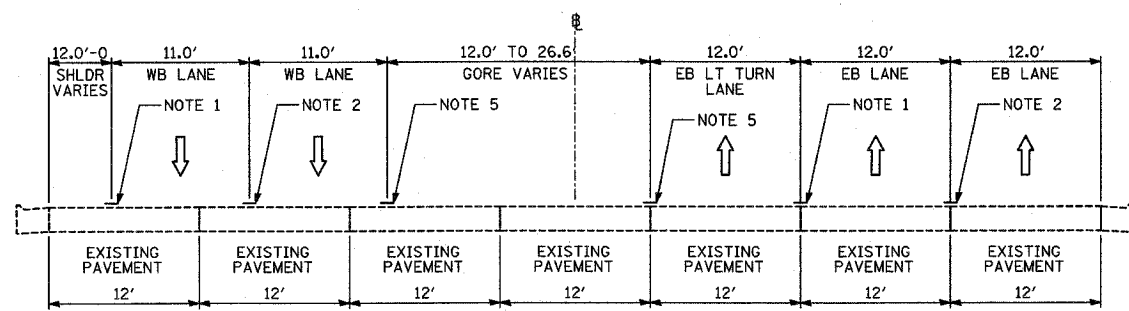

D-D
STAGE 5: IL-60; STA. 428+45 TO STA. 433+00

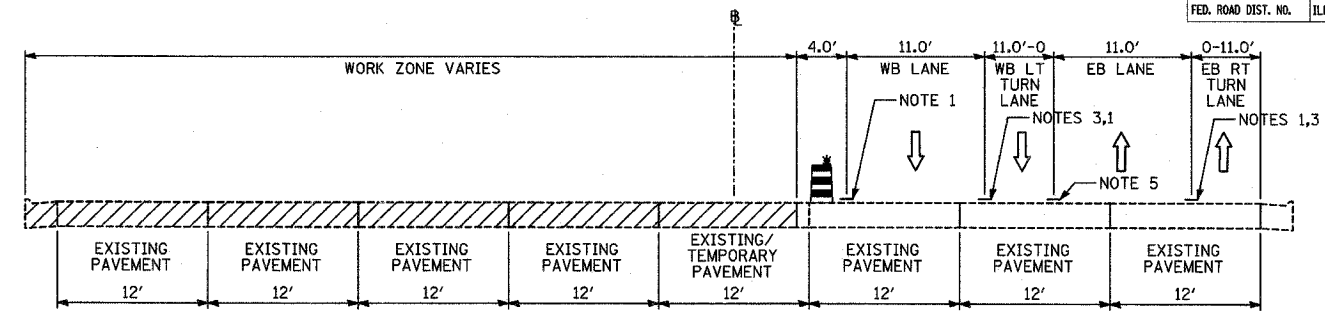

E-E
STAGE 1: IL-60; STA. 434+93 TO STA. 439+20

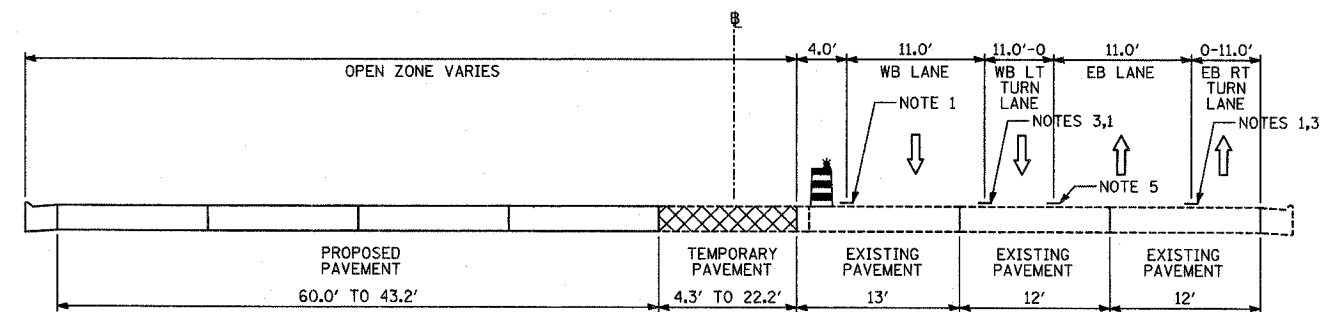

F-F
STAGE 1A: IL-60; STA. 434+93 TO STA. 439+20

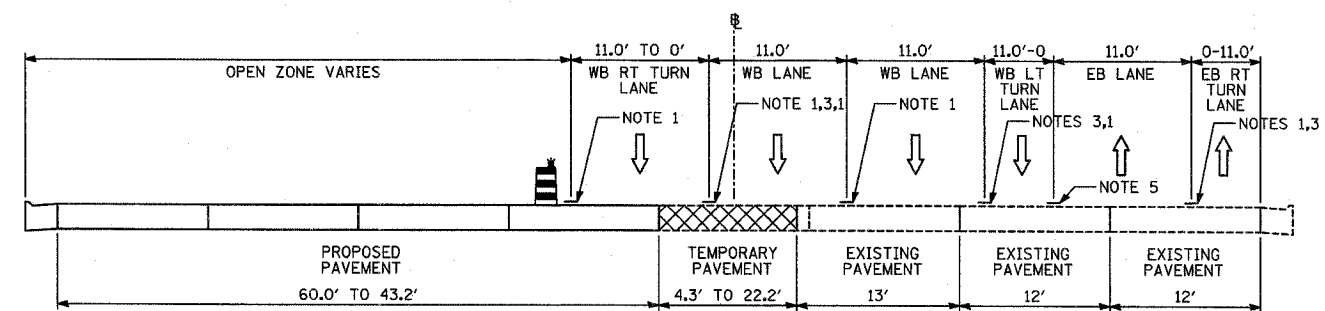

G-G
STAGE 2: IL-60; STA. 434+93 TO STA. 439+20

NOTES:

- 1 - TEMPORARY PAVEMENT MARKING-LINE 4" (SOLID WHITE)
- 2 - TEMPORARY PAVEMENT MARKING-LINE 4" (10'-30' SKIP-DASH WHITE)
- 3 - TEMPORARY PAVEMENT MARKING-LINE 4" (2'-6" SKIP-DASH WHITE)
- 4 - TEMPORARY PAVEMENT MARKING-LINE 8" (SOLID WHITE)
- 5 - TEMPORARY PAVEMENT MARKING-LINE 4" (SOLID DOUBLE YELLOW)
- 6 - EXISTING PAVEMENT MARKING, (SOLID WHITE)
- 7 - EXISTING PAVEMENT MARKING, (SKIP-DASH WHITE)
- 8 - EXISTING PAVEMENT MARKING, (SOLID DOUBLE YELLOW)
- 9 - TEMPORARY PAVEMENT MARKING-LINE 4" (SOLID YELLOW)
- 10 - EXISTING PAVEMENT MARKING, (SOLID YELLOW)

LEGEND:

- TEMPORARY CONCRETE BARRIER (WITH REFLECTORS ON TOP AND SIDE FACING TRAFFIC)
- TRAFFIC MOVEMENT
- DRUM WITH MONO-DIRECTIONAL STEADY BURNING LIGHT
- EXISTING BRIDGE PARAPET (WITH REFLECTORS ON TOP AND SIDE FACING TRAFFIC)
- PAVEMENT REMOVAL AREA
- TEMPORARY PAVEMENT

TYLIN INTERNATIONAL

REVISIONS	
NAME	DATE

ILLINOIS DEPARTMENT OF TRANSPORTATION
ILLINOIS RTE 60 OVER I-94

MAINTENANCE OF TRAFFIC
TYPICAL SECTIONS AND DETAILS
SHEET 1 OF 7

SCALE: NO SCALE
DATE: MAY 8, 2007
DRAWN BY: RTM
CHECKED BY: MFG

05/08/2007 10:24:23 AM