

F.A.P. RTE.	SECTION	COUNTY	TOTAL SHEETS	SHEET NO.
335	119R-2	LAKE	439	87
STA. 432+83.12		TO STA. 470+56.84		
FED. ROAD DIST. NO.		ILLINOIS FED. AID PROJECT		60B01

- LEGEND:**
- CONSTRUCTION ZONE
  - TEMPORARY PAVEMENT
  - TRAFFIC MOVEMENT
  - TEMPORARY SIGN (SEE M.O.T. SIGNING LEGEND)
  - TYPE II BARRICADES OR DRUMS W/ MONO-DIRECTIONAL STEADY BURNING LIGHT
  - TYPE III BARRICADE W/2 FLASHING BIDIRECTIONAL LIGHTS
  - TEMPORARY CONCRETE BARRIER
  - ARROW BOARD
  - M.O.T. APPURTENANCES REMAINING FROM PREVIOUS STAGES

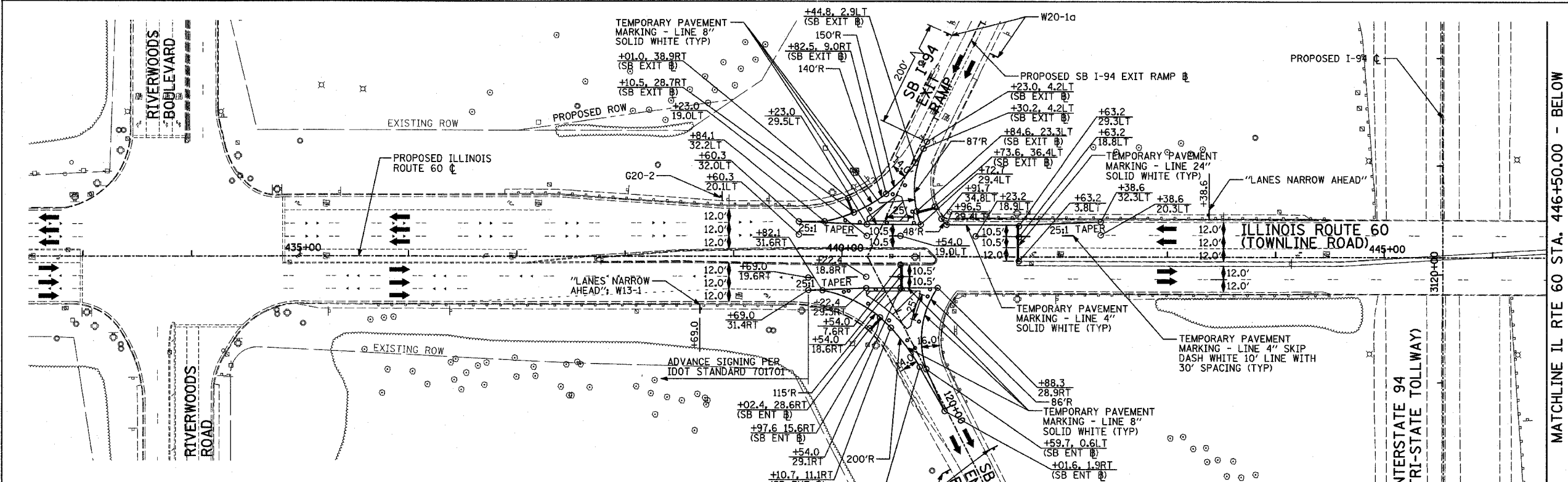

MATCHLINE NB I-94 ENTRANCE RAMP - STA. 202+25.00 - SHEET 2 OF 2

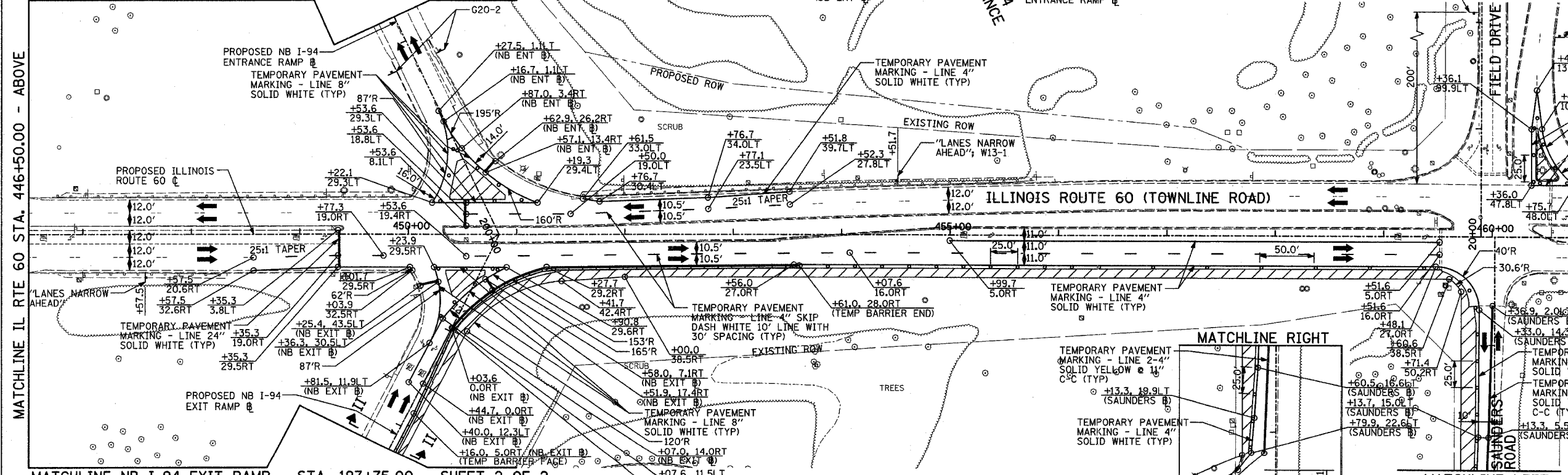

MATCHLINE NB I-94 EXIT RAMP - STA. 197+75.00 - SHEET 2 OF 2

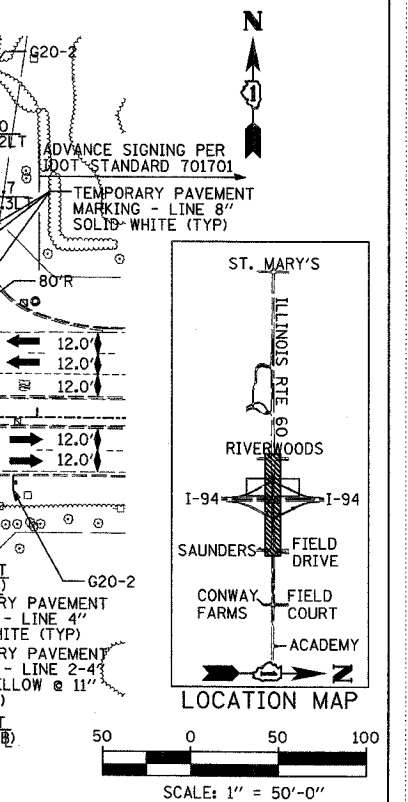

TYLIN INTERNATIONAL

REVISIONS	
NAME	DATE

ILLINOIS DEPARTMENT OF TRANSPORTATION  
 ILLINOIS RTE 60 OVER I-94  
 MAINTENANCE OF TRAFFIC PLAN  
 IL RTE 60 STA. 432+50.00 TO 461+50.00  
 PRE-STAGE A - SHEET 1 OF 2

SCALE: 1"=50'-0"  
 DATE: MAY 8, 2007  
 DRAWN BY: MPG, CBS  
 CHECKED BY: JDF

05/08/2007 10:24:49 AM