

F.A.P. RTE.	SECTION	COUNTY	TOTAL SHEETS	SHEET NO.
335	119R-2	LAKE	439	109
STA. 432+83.12		TO STA. 470+56.84		
FED. ROAD DIST. NO.	ILLINOIS	FED. AID PROJECT		

60B01

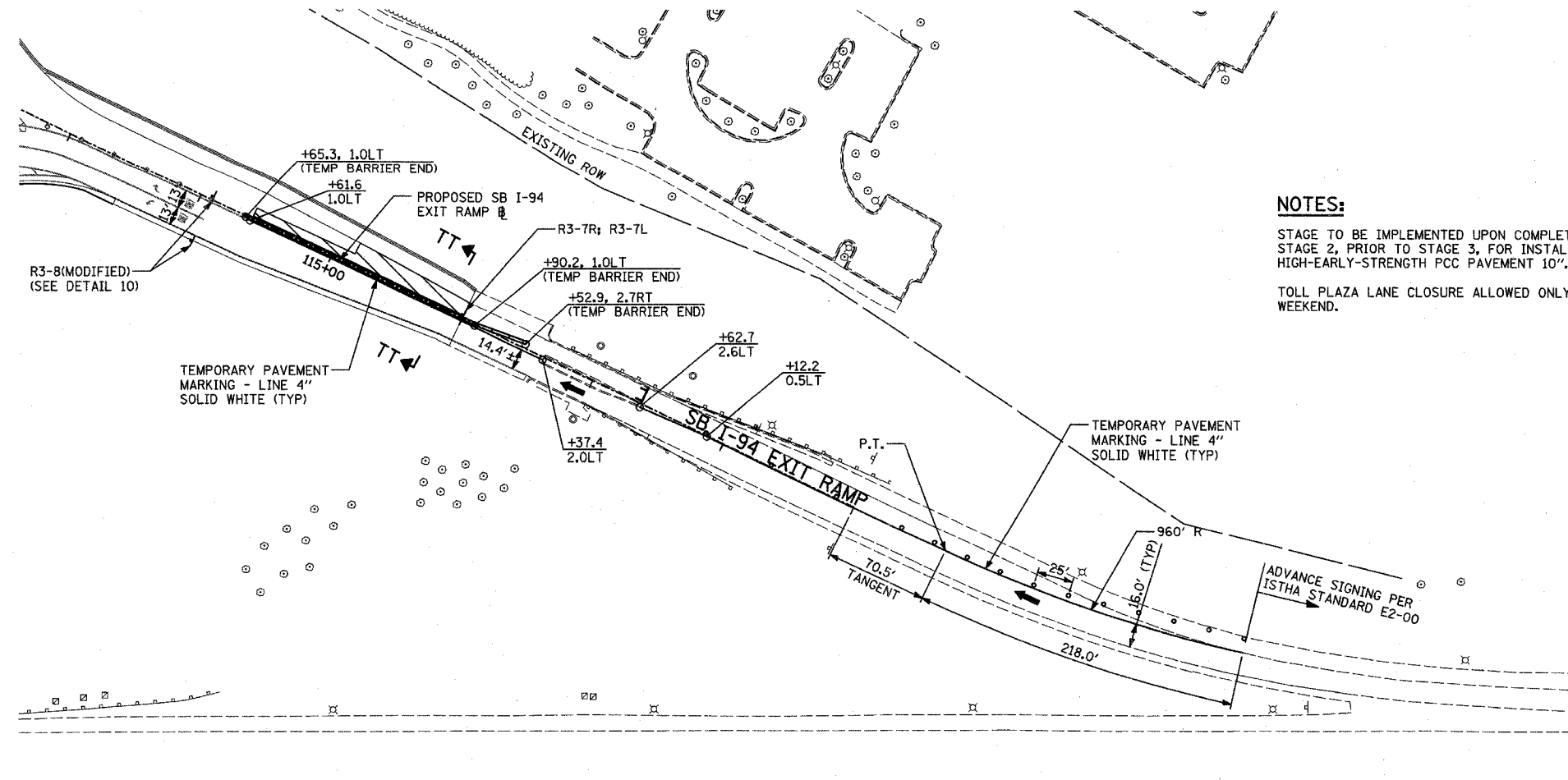

**NOTES:**

STAGE TO BE IMPLEMENTED UPON COMPLETION OF STAGE 2, PRIOR TO STAGE 3, FOR INSTALLATION OF HIGH-EARLY-STRENGTH PCC PAVEMENT 10".  
TOLL PLAZA LANE CLOSURE ALLOWED ONLY ON WEEKEND.

**LEGEND:**

- CONSTRUCTION ZONE
- TEMPORARY PAVEMENT
- TRAFFIC MOVEMENT
- TEMPORARY SIGN (SEE M.O.T. SIGNING LEGEND)
- TYPE II BARRICADES OR DRUMS W/ MONO-DIRECTIONAL STEADY BURNING LIGHT
- TYPE III BARRICADE W/2 FLASHING BIDIRECTIONAL LIGHTS
- TEMPORARY CONCRETE BARRIER
- ARROW BOARD
- M.O.T. APPURTENANCES REMAINING FROM PREVIOUS STAGES

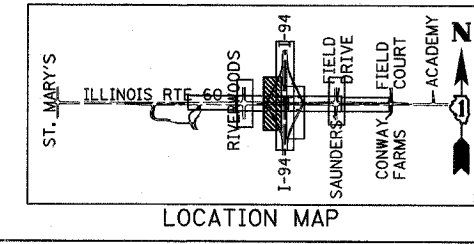
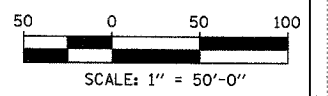

REVISIONS	
NAME	DATE

ILLINOIS DEPARTMENT OF TRANSPORTATION  
ILLINOIS RTE 60 OVER I-94  
MAINTENANCE OF TRAFFIC PLAN  
SOUTHBOUND INTERSTATE 94 EXIT RAMP  
STAGE 2 SUB-STAGE - SHEET 1 OF 1

SCALE: 1"=50'-0"  
DATE: MAY 8, 2007

DRAWN BY: MPG, CBS  
CHECKED BY: JDF

**TYLIN** INTERNATIONAL

05/08/2007 10:28:53 AM