

F.A.P. RTE.	SECTION	COUNTY	TOTAL SHEETS	SHEET NO.
335	119R-2	LAKE	439	140
STA. 432+83.12		TO STA. 470+56.84		
FED. ROAD DIST. NO.	ILLINOIS	FED. AID PROJECT		

60B01

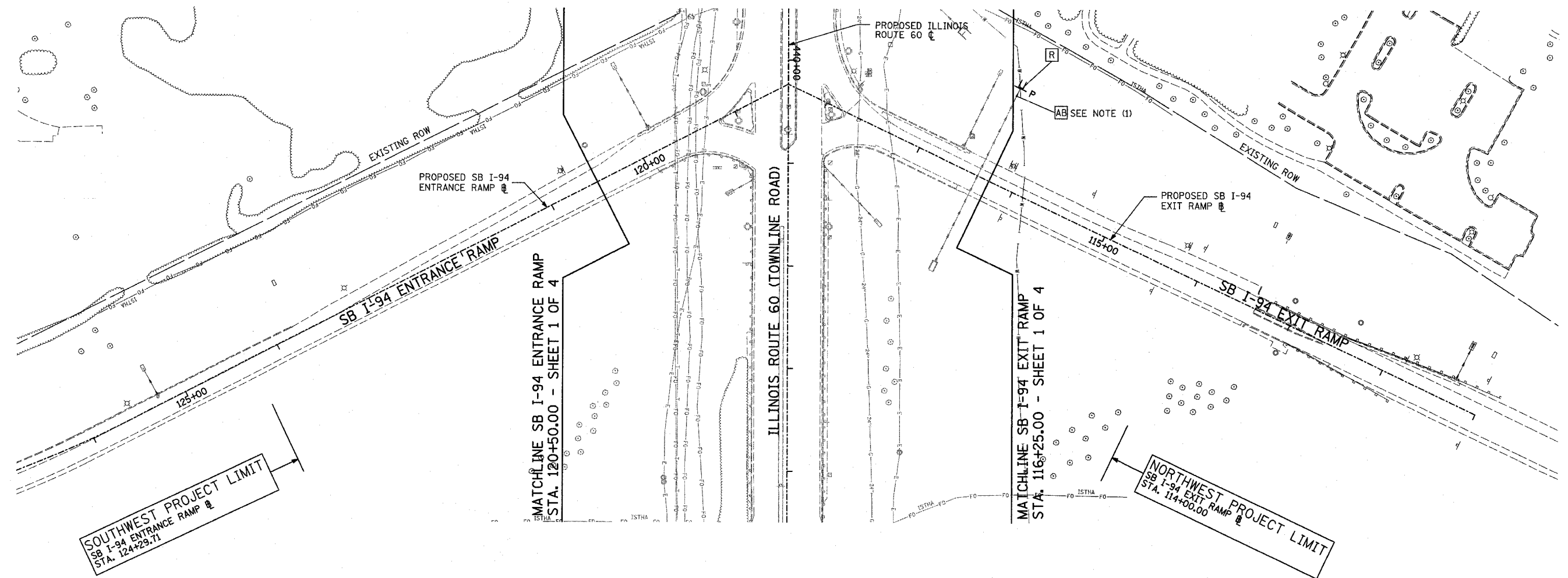

SOUTHWEST PROJECT LIMIT
SB I-94 ENTRANCE RAMP
STA. 124+29.71

MATCHLINE SB I-94 ENTRANCE RAMP
STA. 120+50.00 - SHEET 1 OF 4

MATCHLINE SB I-94 EXIT RAMP
STA. 116+25.00 - SHEET 1 OF 4

NORTHWEST PROJECT LIMIT
SB I-94 EXIT RAMP
STA. 114+00.00

- LEGEND:**
- P SEWER PLUG
 - F.V. FIELD VERIFY
 - //// STORM SEWER REMOVAL
 - END SECTION

- NOTES:**
1. ABANDONED SEWER TO BE FILLED WITH CONTROLLED LOW STRENGTH MATERIAL. SEE SCHEDULE FOR DETAILS.

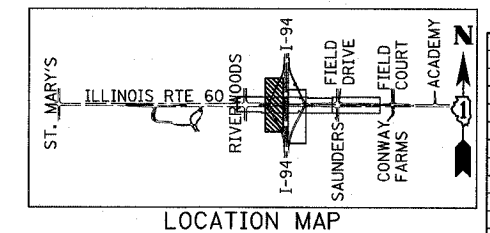
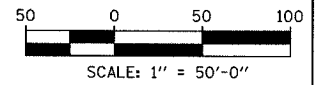

REVISIONS	
NAME	DATE

ILLINOIS DEPARTMENT OF TRANSPORTATION
ILLINOIS RTE 60 OVER I-94
EXISTING UTILITIES AND
DRAINAGE REMOVAL PLAN
SOUTHBOUND INTERSTATE 94 RAMPS
SHEET 3 OF 4

SCALE: 1"=50'-0"
DATE: MAY 8, 2007
DRAWN BY: NSB
CHECKED BY: DA

TYLIN INTERNATIONAL

PA:602-66811-60\paved\60b01.dwg 07-31-07 07:32:30 AM