

F.A.P. RTE.	SECTION	COUNTY	TOTAL SHEETS	SHEET NO.
335	119R-2	LAKE	439	181
STA. 432+83.12		TO STA. 470+56.84		
FED. ROAD DIST. NO.	ILLINOIS	FED. AID PROJECT		

60B01

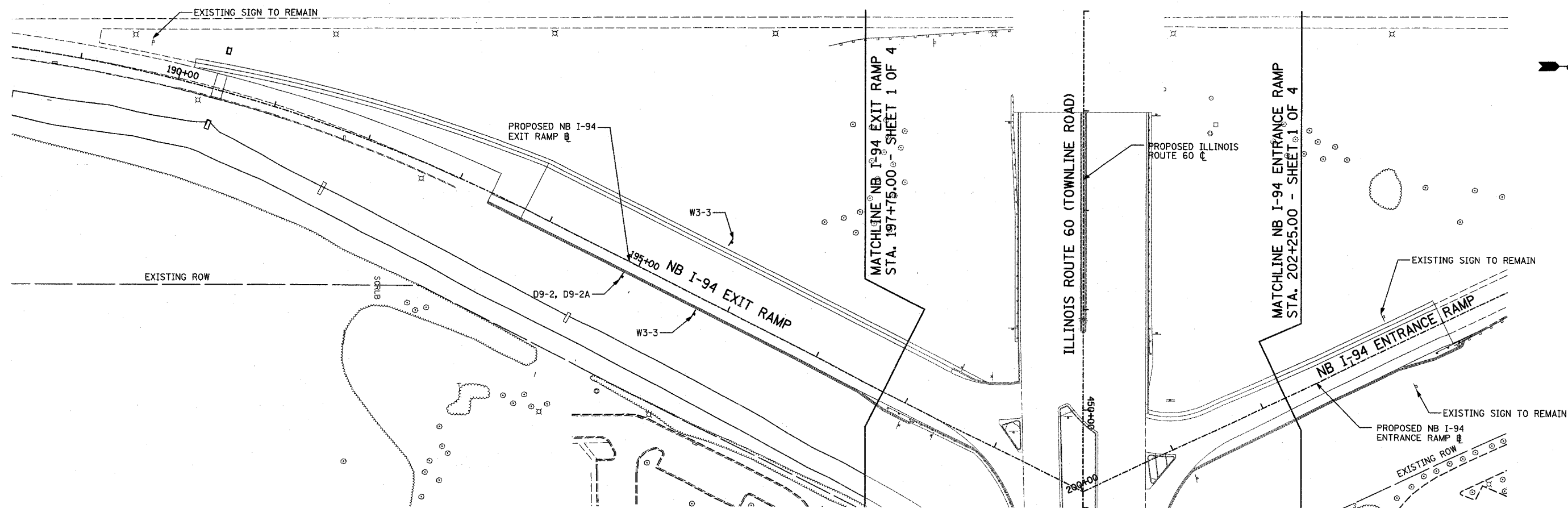

**SIGNING LEGEND:**

- EXISTING GROUND MOUNTED SIGN
- PROPOSED GROUND MOUNTED SIGN
- R1-1 - SEE PROPOSED SIGNING LEGEND AND SCHEDULE



PROPOSED LARGE SIGN PANEL (SEE SIGN PANEL DETAILS AND SCHEDULE)

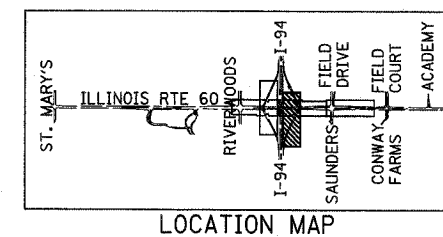
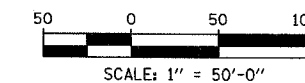

LOCATION MAP

REVISIONS	
NAME	DATE

ILLINOIS DEPARTMENT OF TRANSPORTATION  
ILLINOIS RTE 60 OVER I-94  
PROPOSED SIGNING PLAN  
NORTHBOUND INTERSTATE 94 RAMPS  
SHEET 4 OF 4

SCALE: 1"=50'-0"  
DATE: MAY 8, 2007

DRAWN BY: AMB  
CHECKED BY: MPG

TYLIN INTERNATIONAL

5/6/2007 5:24:57 PM