

F.A.P. RTE.	SECTION	COUNTY	TOTAL SHEETS	SHEET NO.
335	119R-2	LAKE	439	230
STA.		TO STA.		
FED. ROAD DIST. NO.		ILLINOIS FED. AID PROJECT		

60B01

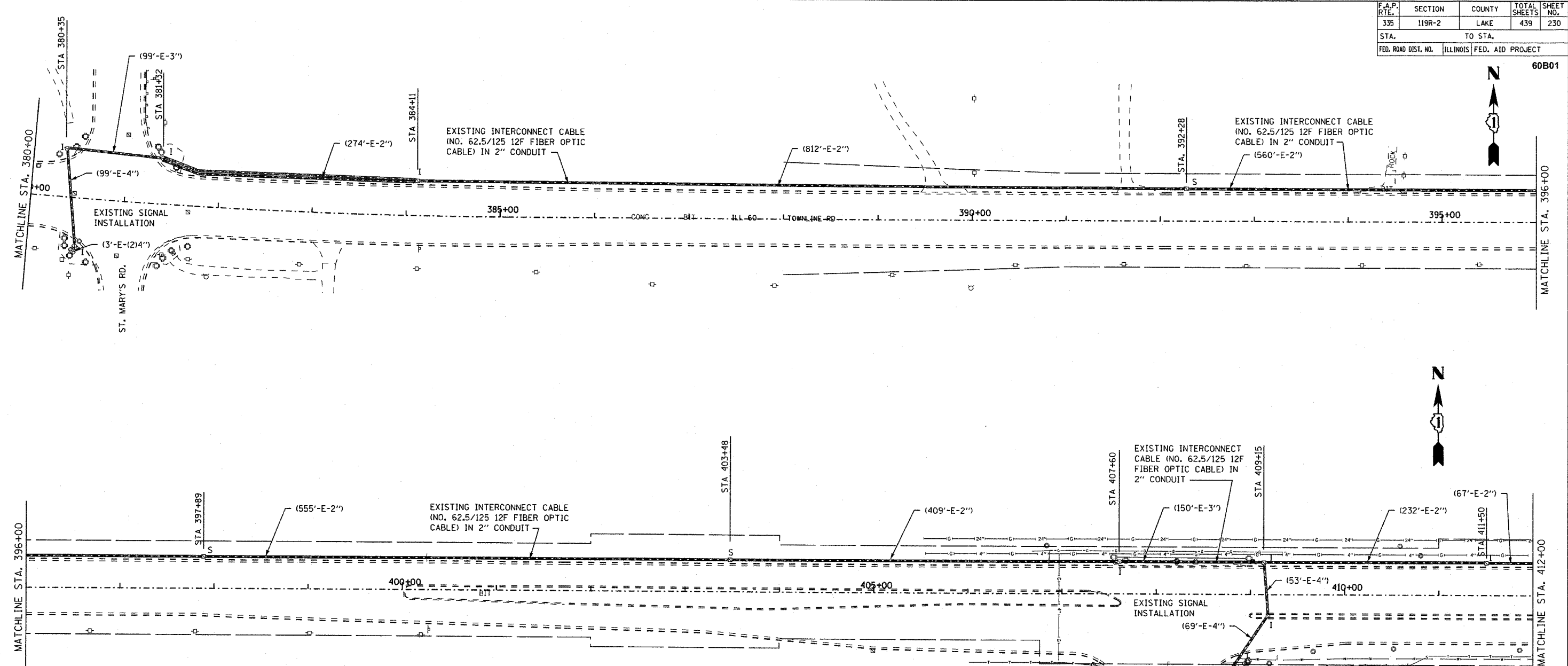

TEMPORARY INTERCONNECT PLAN LEGEND

PROPOSED	EXISTING	DESCRIPTION
		CONTROLLER
		HANDHOLE
		DOUBLE HANDHOLE
		HEAVY DUTY HANDHOLE
		G.S. CONDUIT IN TRENCH OR PUSHED
		DETECTOR LOOP
		COMMON TRENCH
		UNIT DUCT
		SYSTEM
		INTERSECTION
		TELEPHONE
		TEMPORARY WOOD POLE (CLASS 5 OR BETTER) 50 FOOT MIN.
		TEMPORARY OPTIC FIBER 12F INTERCONNECT CABLE (AERIALLY SUSPENDED)
		TEMPORARY FIBER OPTIC 24F DATA CABLE (AERIALLY SUSPENDED)
		TEMPORARY 2/C #4 AND 1/C #6 ELECTRICAL SERVICE WIRE (AERIALLY SUSPENDED)
		SURVEILLANCE CAMERA TO BE RELOCATED
		CCTV FIELD TERMINAL CABINET TO BE RELOCATED

- NOTES:**
- RESTORATION OF WORK AREA: RESTORATION OF THE TRAFFIC WORK AREA SHALL BE INCLUDED IN THE COST OF THE RELATED PAY ITEM SUCH AS FOUNDATION, CONDUIT, HANDHOLE, TRENCH AND BACKFILL, ETC., AND NO EXTRA COMPENSATION SHALL BE ALLOWED. ALL ROADWAY SURFACES SUCH AS SHOULDERS, MEDIANS, SIDEWALKS, PAVEMENT, ETC., SHALL BE REPLACED IN KIND. ALL DAMAGE TO MOWED LAWNS SHALL BE REPLACED WITH AN APPROVED SOD, AND ALL DAMAGE TO UNMOWED FIELDS SHALL BE SEEDED IN ACCORDANCE WITH STANDARD SPECIFICATIONS 252 AND 250 RESPECTIVELY.
 - USE EXISTING FIBER OPTIC 12F CABLE FOR TEMPORARY INTERCONNECT - FROM ST. MARY'S ROAD CONTROLLER CABINET TO RIVERWOODS ROAD CONTROLLER CABINET. ALL STAGES.
 - ALL ITEMS REQUIRED FOR TEMPORARY INTERCONNECT PLAN ARE INCLUDED IN TEMPORARY TRAFFIC SIGNAL INSTALLATION PAY ITEM.
 - THE TRAFFIC SIGNAL CONTROL EQUIPMENT FOR THIS PROJECT SHALL BE "EAGLE" TO MATCH THE EXISTING ADJACENT SYSTEM.
 - TRAFFIC SIGNAL SYSTEM TIMING AND COORDINATION PROGRAM ADJUSTMENTS WILL BE REQUIRED FOR EACH CONSTRUCTION STAGE AT EACH TEMPORARY SIGNAL INTERSECTION AND WILL BE INCLUDED IN THE TEMPORARY TRAFFIC SIGNAL TIMINGS PAY ITEM.

<p>EJM ENGINEERING, INC. 411 South Wells Street Suite 800 Chicago, Illinois 60607</p>	<p>ILLINOIS DEPARTMENT OF TRANSPORTATION</p> <p>TEMPORARY INTERCONNECT PLAN</p> <p>ILL ROUTE 60</p> <p>ST. MARY'S ROAD TO ACADEMY DRIVE</p> <p>STAGES 3, 3A, 4, 5</p>	<p>S.N.</p> <p>SCALE: 1" = 50'-0"</p> <p>DATE: MAY 8, 2007</p>	<p>DESIGNED BY: JM</p> <p>DRAWN BY: PK</p> <p>CHECKED BY: CK</p>										
	<p>REVISIONS</p> <table border="1"> <thead> <tr> <th>NAME</th> <th>DATE</th> </tr> </thead> <tbody> <tr> <td> </td> <td> </td> </tr> <tr> <td> </td> <td> </td> </tr> <tr> <td> </td> <td> </td> </tr> <tr> <td> </td> <td> </td> </tr> </tbody> </table>			NAME	DATE								
	NAME	DATE											
<p>REVISIONS</p>													
<p>REVISIONS</p>													
<p>REVISIONS</p>													