

F.A.P. RTE.	SECTION	COUNTY	TOTAL SHEETS	SHEET NO.
335	119R-2	LAKE	439	372
STA. 432+83.12		TO STA. 470+56.84		
FED. ROAD DIST. NO.	ILLINOIS	FED. AID PROJECT		

NOTE: PRE-STAGE EARTHWORK ADDITIONS/SUBTRACTIONS ARE NOT INCLUDED IN THE EARTHWORK QUANTITIES FOR EACH CROSS SECTION (SEE EARTHWORK SCHEDULE FOR BREAKDOWN OF QUANTITIES BY STAGE)

EARTHWORK QUANTITIES (SF)	
EXCAVATION	= 57.7
UNSUITABLE	= 110.9
EMBANKMENT	= 560.6
EXC.(SPECIAL)	= 22.3

EARTHWORK QUANTITIES (SF)	
EXCAVATION	= 78.2
UNSUITABLE	= 30.9
EMBANKMENT	= 36.9
EXC.(SPECIAL)	= 0.0

PROFILE	DATE
BY	
REVISIONS	
NOTES	
NO.	

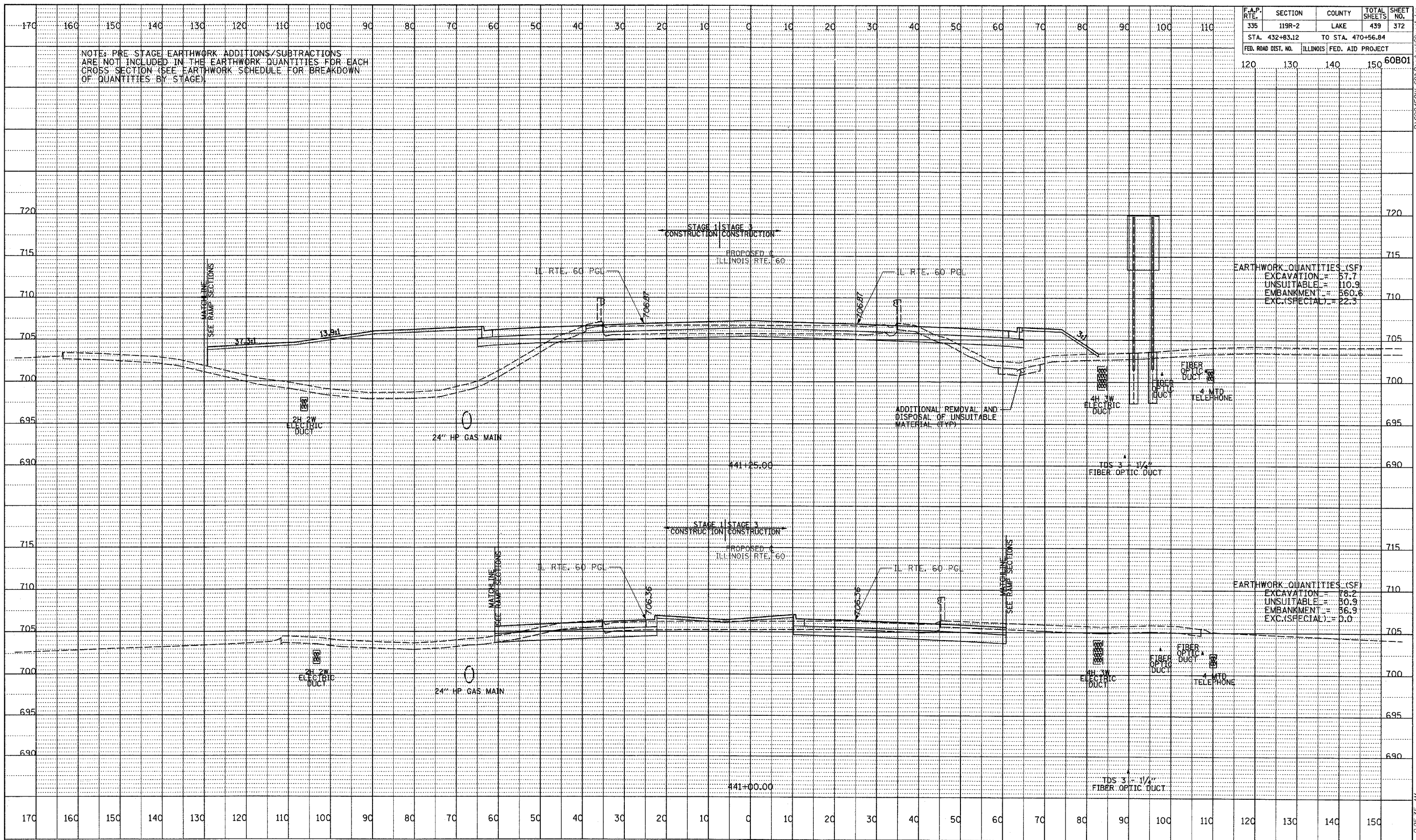

TYL INTERNATIONAL

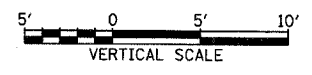
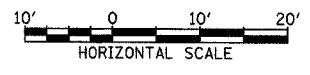

ILLINOIS RTE. 60 (TOWNLINE RD)
STA. 441+00 TO STA. 441+25

PAGE 24 OF 24 (6/16/2007) 9:25:35 AM