

F.A.P. RTE.	SECTION	COUNTY	TOTAL SHEETS	SHEET NO.
335	119R-2	LAKE	439	375
STA. 432+83.12		TO STA. 470+56.84		
FED. ROAD DIST. NO.	ILLINOIS FED. AID PROJECT			
	120	130	140	150

NOTE: PRE-STAGE EARTHWORK ADDITIONS/SUBTRACTIONS ARE NOT INCLUDED IN THE EARTHWORK QUANTITIES FOR EACH CROSS SECTION (SEE EARTHWORK SCHEDULE FOR BREAKDOWN OF QUANTITIES BY STAGE).

60B01

PROFILE	DATE
BY	
REVISION	
CHANGED	
PLOTTED	
NOTE BOOK	
NO.	
STRUCTURE	
NOTATION	
CHRD	

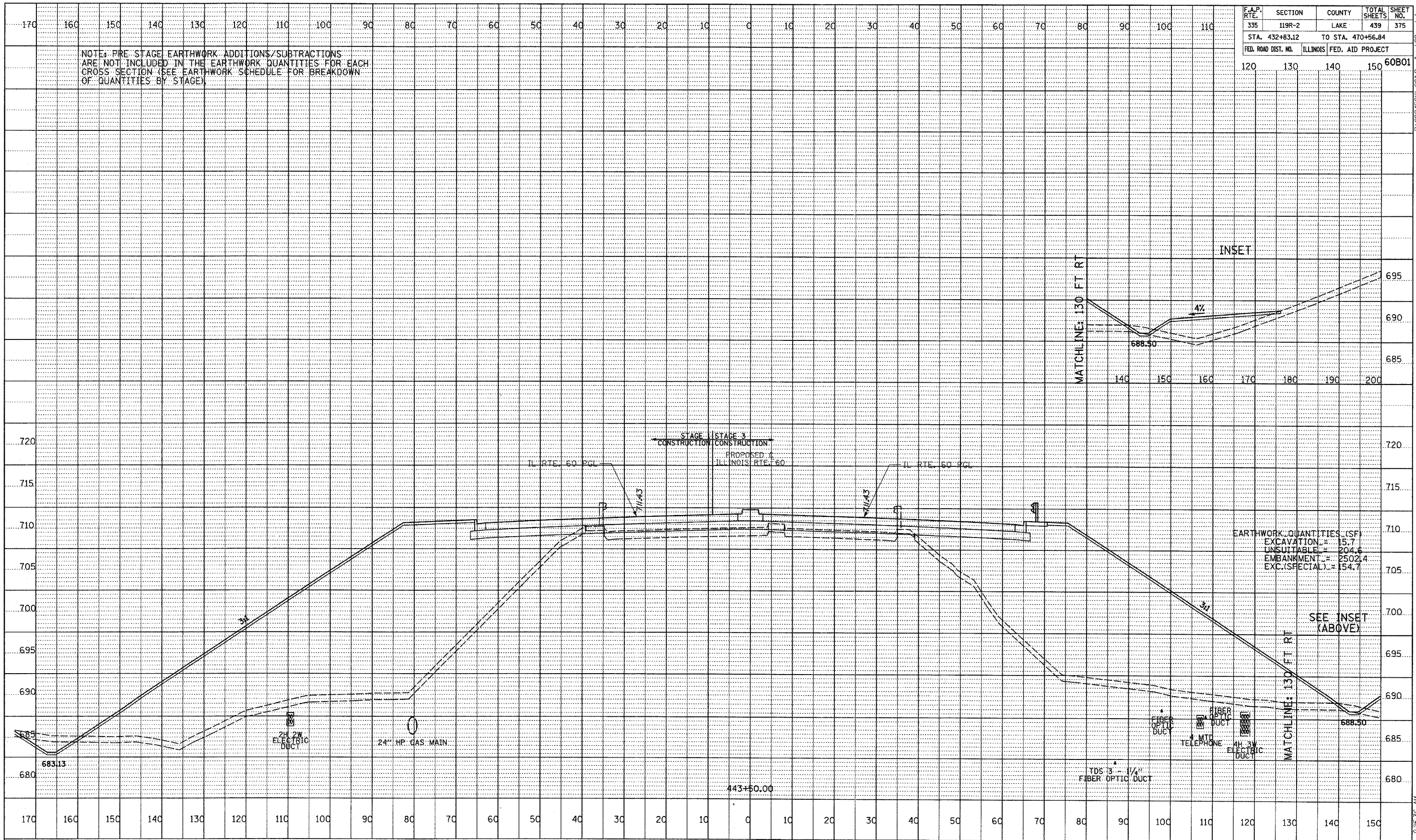

EARTHWORK QUANTITIES (SF)

EXCAVATION	= 5.7
UNSUITABLE	= 204.6
EMBANKMENT	= 2502.4
EXC. (SPECIAL)	= 154.7

SEE INSET (ABOVE)

TYLIN INTERNATIONAL

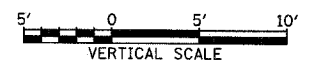
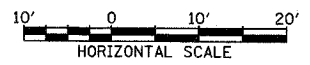

ILLINOIS RTE. 60 (TOWNLIN RD)
STA. 443+50

P:\60245811_60\Drawings\60B01.dwg 5/7/2007 9:25:36 AM