

| | | | | |
|---------------------|----------|-------------------|--------------|-----------|
| F.A.P. RTE. | SECTION | COUNTY | TOTAL SHEETS | SHEET NO. |
| 335 | 119R-2 | LAKE | 439 | 389 |
| STA. 432+83.12 | | TO STA. 470+56.84 | | 60B01 |
| FED. ROAD DIST. NO. | ILLINOIS | FED. AID PROJECT | | |

NOTE: PRE STAGE EARTHWORK ADDITIONS/SUBTRACTIONS ARE NOT INCLUDED IN THE EARTHWORK QUANTITIES FOR EACH CROSS SECTION (SEE EARTHWORK SCHEDULE FOR BREAKDOWN OF QUANTITIES BY STAGE).

| | |
|---------------------------|---------|
| EARTHWORK QUANTITIES (SF) | |
| EXCAVATION | = 96.2 |
| UNSUITABLE | = 141.9 |
| EMBANKMENT | = 429.6 |
| EXC.(SPECIAL) | = 56.4 |

| | |
|---------------------------|---------|
| EARTHWORK QUANTITIES (SF) | |
| EXCAVATION | = 92.7 |
| UNSUITABLE | = 171.2 |
| EMBANKMENT | = 697.1 |
| EXC.(SPECIAL) | = 89.3 |

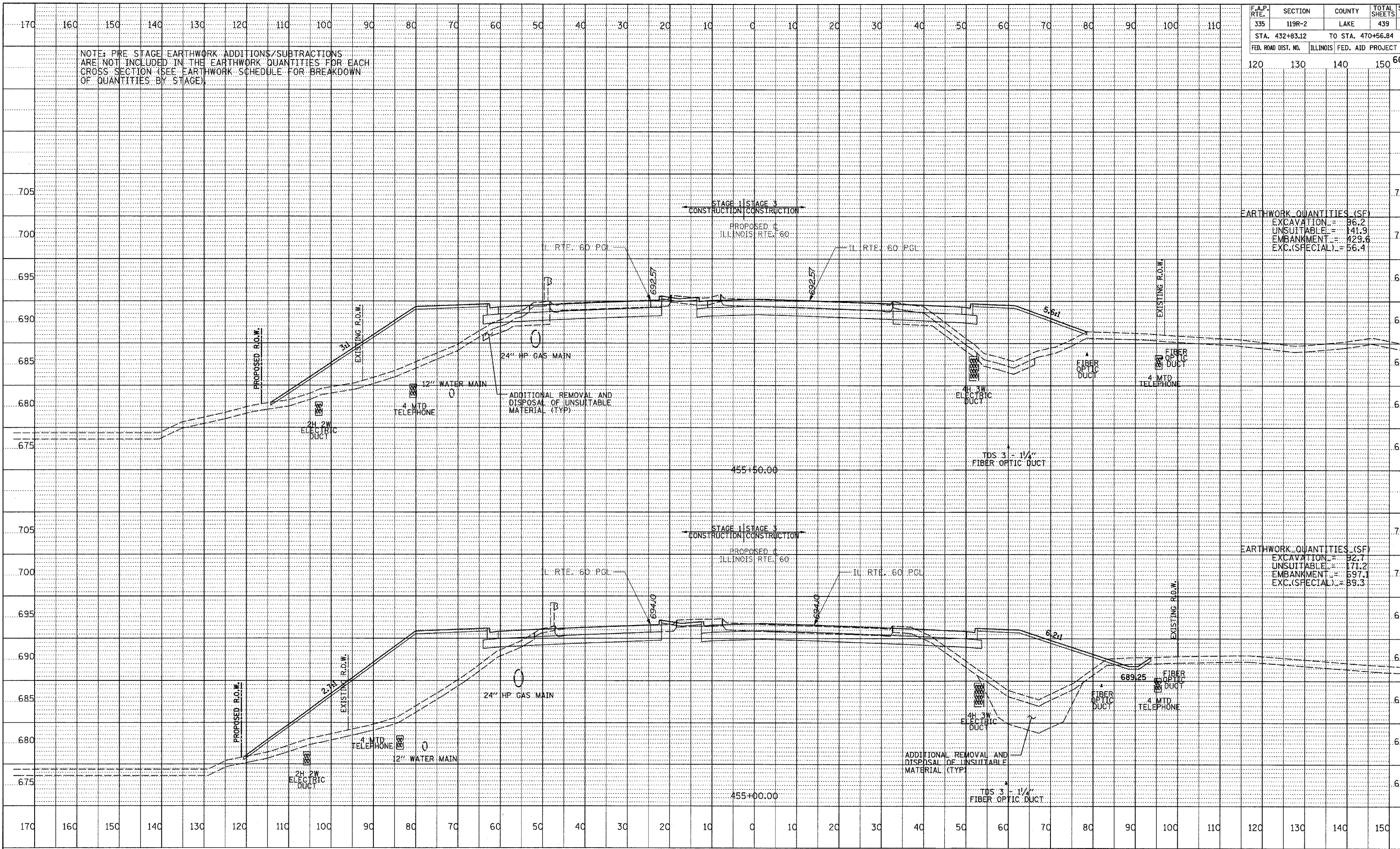

TYLIN INTERNATIONAL

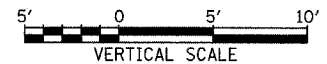

ILLINOIS RTE. 60 (TOWNLIN RD)
STA. 455+00 TO STA. 455+50

6/13/2007 4:38:35 PM