

F.A.P. RTE.	SECTION	COUNTY	TOTAL SHEETS	SHEET NO.
335	119R-2	LAKE	439	391
STA. 432+83.12	TO STA. 470+56.84			
FED. ROAD DIST. NO.	ILLINOIS	FED. AID PROJECT		
120	130	140	150	60B01

NOTE: PRE-STAGE EARTHWORK ADDITIONS/SUBTRACTIONS ARE NOT INCLUDED IN THE EARTHWORK QUANTITIES FOR EACH CROSS SECTION (SEE EARTHWORK SCHEDULE FOR BREAKDOWN OF QUANTITIES BY STAGE)

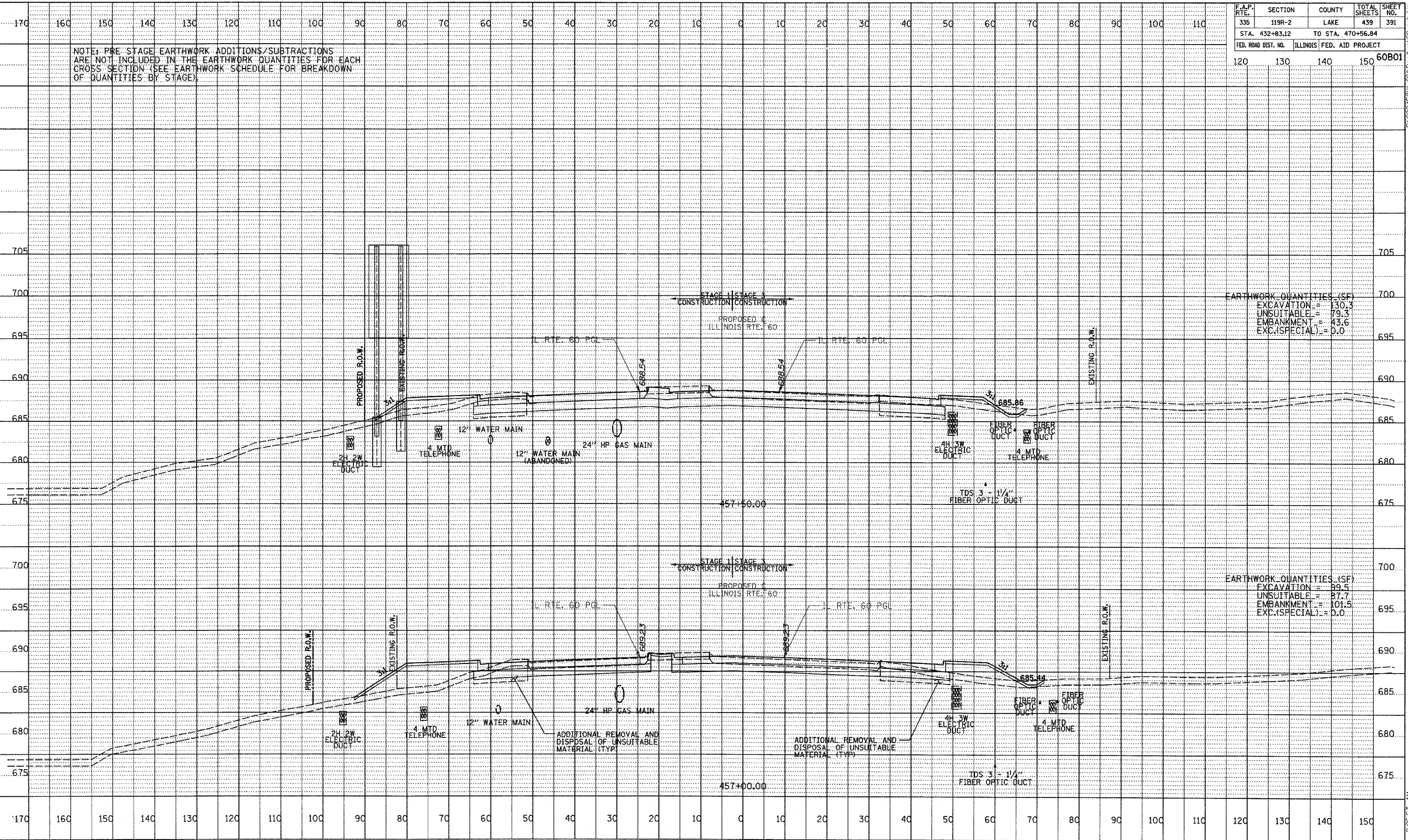

EARTHWORK QUANTITIES (SF)	
EXCAVATION	= 130.3
UNSUITABLE	= 79.3
EMBANKMENT	= 43.6
EXC.(SPECIAL)	= 0.0

EARTHWORK QUANTITIES (SF)	
EXCAVATION	= 99.5
UNSUITABLE	= 87.7
EMBANKMENT	= 101.5
EXC.(SPECIAL)	= 0.0

PROFILE
 DATE _____ BY _____
 REVISIONS
 CHECKED _____
 DATE _____
 NO. _____
 STRUCTURE NOTATIONS CHD

TYLIN INTERNATIONAL

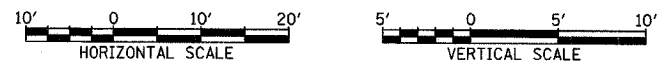

ILLINOIS RTE. 60 (TOWNLIN RD)
 STA. 457+00 TO STA. 457+50

P:\60245611-60\Road\pk60\eshd707 9/25/07 9:25:53 AM