

|                     |          |                   |              |           |
|---------------------|----------|-------------------|--------------|-----------|
| F.A.P. RTE.         | SECTION  | COUNTY            | TOTAL SHEETS | SHEET NO. |
| 335                 | 119R-2   | LAKE              | 439          | 395       |
| STA. 432+83.12      |          | TO STA. 470+56.84 |              |           |
| FED. ROAD DIST. NO. | ILLINOIS | FED. AID PROJECT  |              |           |
|                     | 120      | 130               | 140          | 150       |
|                     |          |                   |              | 60B01     |

NOTE: PRE-STAGE EARTHWORK ADDITIONS/SUBTRACTIONS AND WESTBOUND IL-60 WIDENING EARTHWORK ADDITIONS ARE NOT INCLUDED IN THE EARTHWORK QUANTITIES FOR EACH CROSS SECTION (SEE EARTHWORK SCHEDULES FOR BREAKDOWN OF QUANTITIES BY STAGE AND LOCATION).

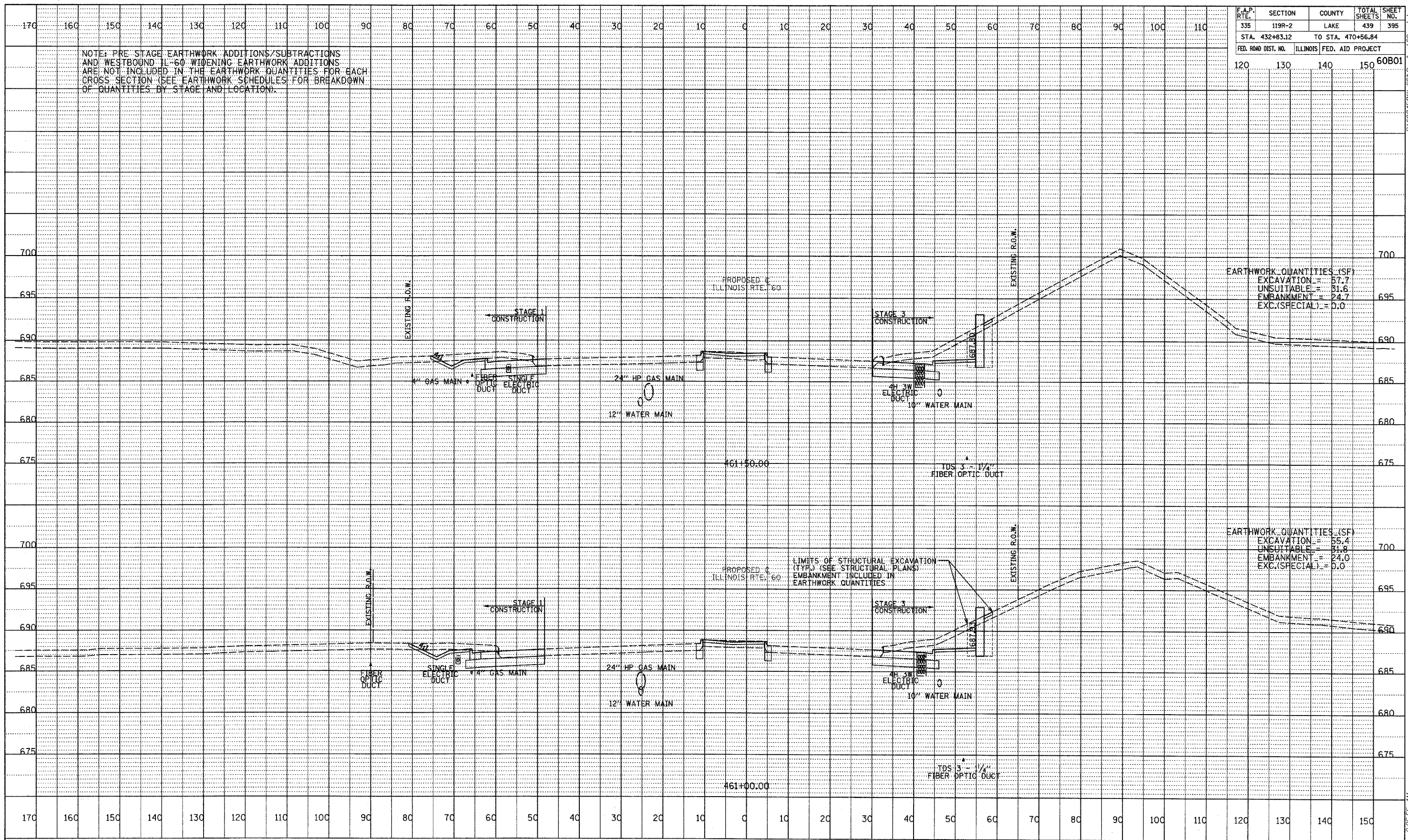

PROFILE  
 DRAWING NO. \_\_\_\_\_  
 DATE \_\_\_\_\_  
 BY \_\_\_\_\_  
 CHECKED \_\_\_\_\_  
 DESIGNED \_\_\_\_\_  
 IN CHARGE \_\_\_\_\_  
 NO. \_\_\_\_\_

TYLINT INTERNATIONAL



ILLINOIS RTE. 60 (TOWNLIN RD)  
 STA. 461+00 TO STA. 461+50

F:\60245811\60\Road\wp60\ss\sdg7 5/7/2007 9:25:55 AM