

PROFILE	DATE
DESIGNED	
PLOTTED	
GRADES CHECKED	
STRUCTURE NOTATIONS CHECKED	
NO.	

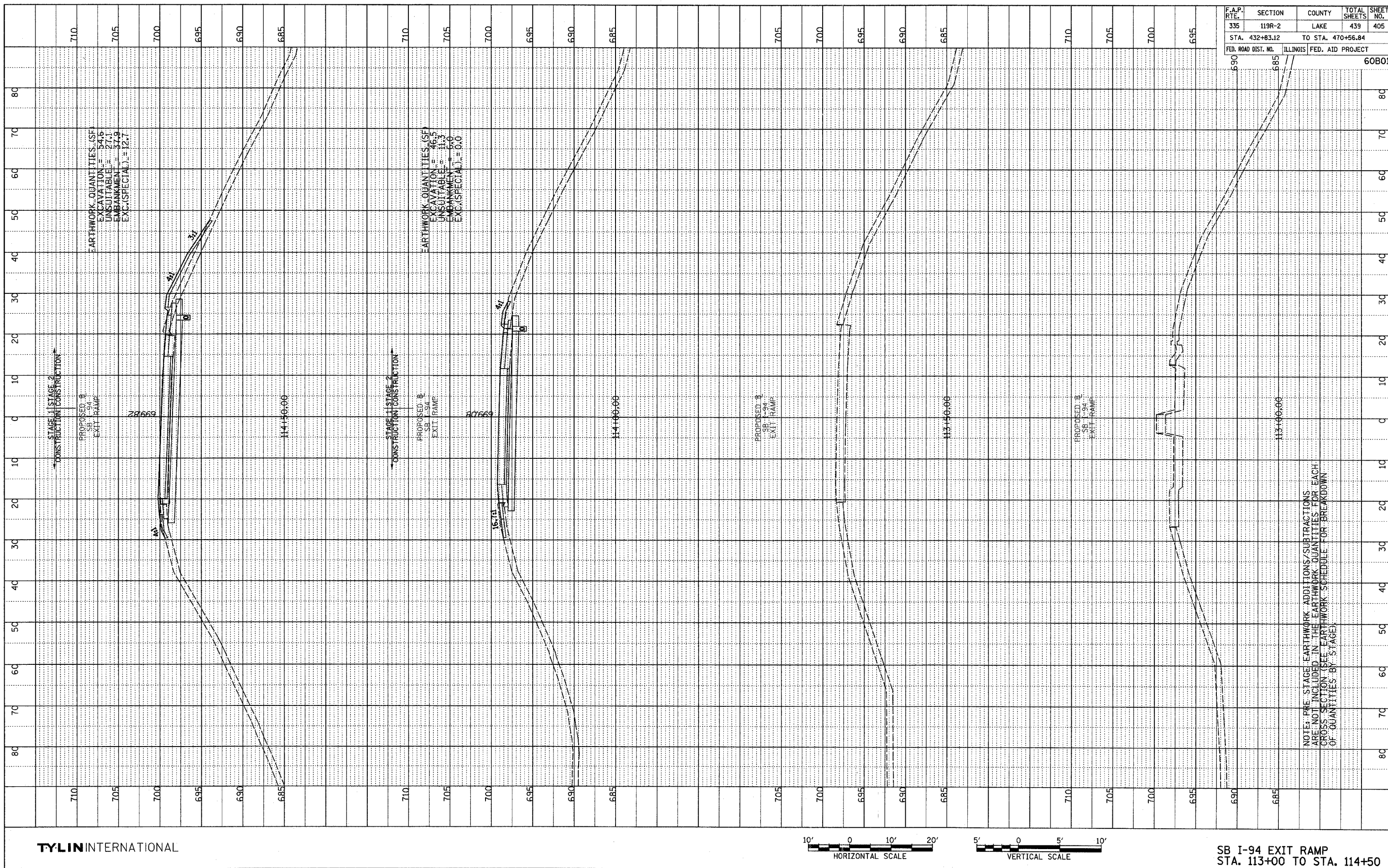

F.A.P. RTE.	SECTION	COUNTY	TOTAL SHEETS	SHEET NO.
335	119R-2	LAKE	439	405
STA. 432+83.12		TO STA. 470+56.84		
FED. ROAD DIST. NO.	ILLINOIS	FED. AID PROJECT		
		60B01		

TYLIN INTERNATIONAL

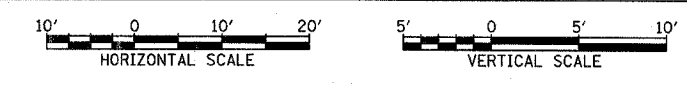

SB I-94 EXIT RAMP
 STA. 113+00 TO STA. 114+50

10-40-2007 5:17:2007
 P:\60245817\F01\road\gpk\60b01\sheet_sbx.dgn