

PROFILE PLOTTED BY DATE
 GRADES CHECKED
 STRUCTURE NOTATIONS OK

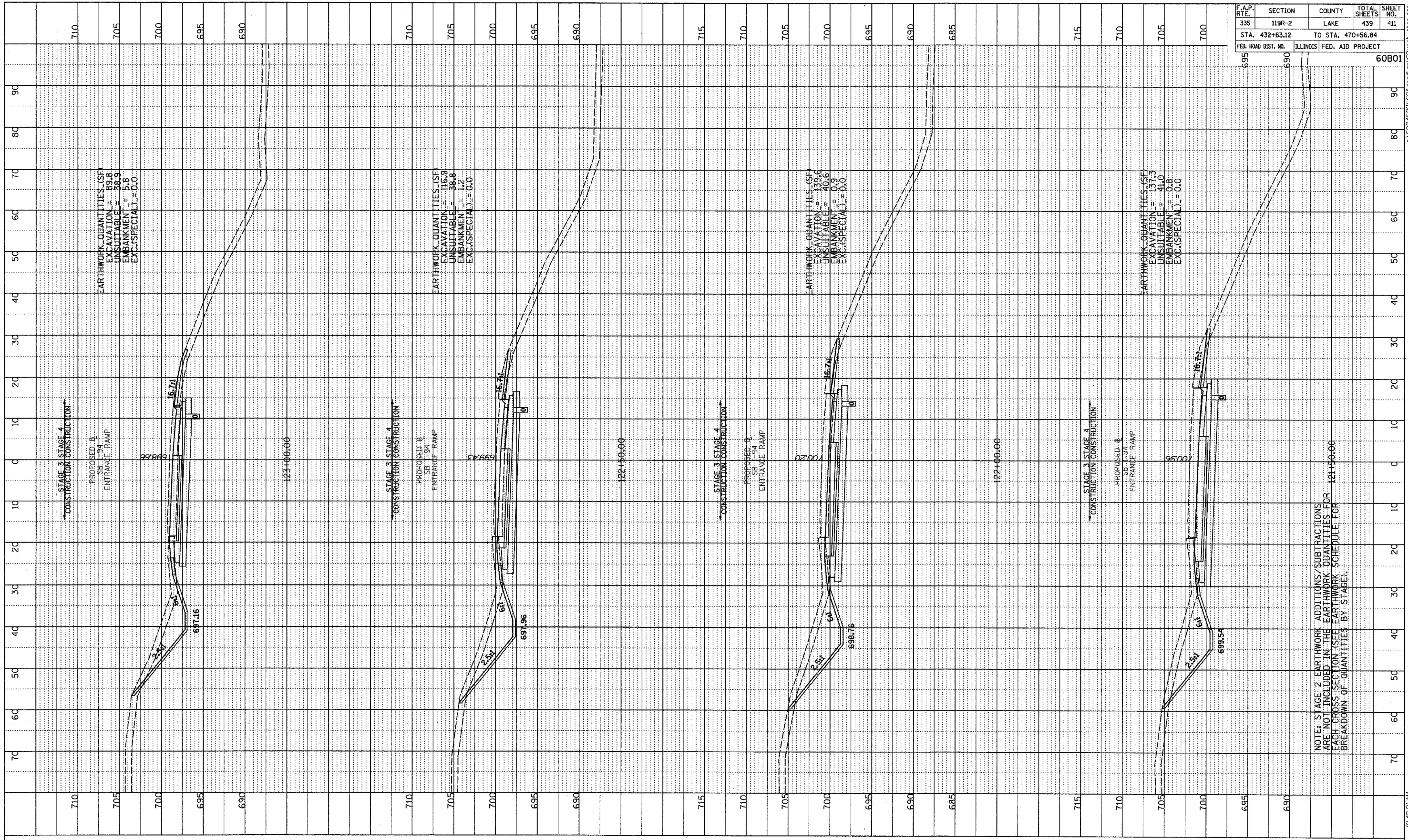

F.A.P. RTE. NO.	SECTION	COUNTY	TOTAL SHEETS	SHEET NO.
335	119R-2	LAKE	439	411
STA. 432+63.12		TO STA. 470+56.84		
FED. ROAD DIST. NO.		ILLINOIS FED. AID PROJECT		60B01

TYLIN INTERNATIONAL

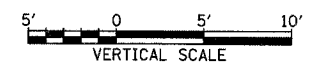
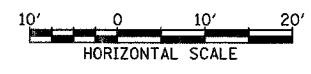

SB I-94 ENTRANCE RAMP
 STA. 121+50 TO STA. 123+00

NOTE: STAGE 2 EARTHWORK ADDITIONS/SUBTRACTIONS ARE NOT INCLUDED IN THE EARTHWORK QUANTITIES FOR EACH CROSS SECTION (SEE EARTHWORK SCHEDULE FOR BREAKDOWN OF QUANTITIES BY STAGE).

5/7/2007 10:40:21 AM P:\60245811-60\Road\gpr60\ssn_sben.dgn