

STATE OF ILLINOIS  
DEPARTMENT OF TRANSPORTATION

ROUTE NO.	SECTION	COUNTY	TOTAL SHEETS	SHEET NO.
F. A. P. 846	4B-1-I-1	WILL	39	5
FED. ROAD DIST. NO. 7	ILLINOIS	FED. AID PROJECT-		

SHEET NO. S3  
SHEETS S20

CONTRACT NO. 60D26

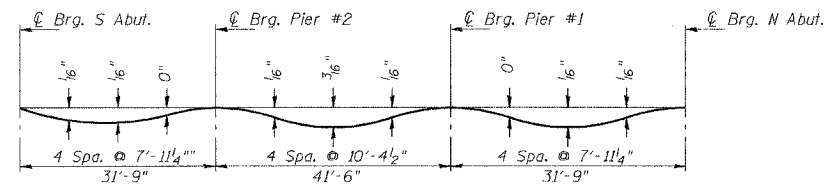

**DEAD LOAD DEFLECTION DIAGRAM**

(Includes weight of concrete only.)

Note: The above deflections are not to be used in the field if the engineer is working from the grade elevations adjusted for dead load deflections as shown on sht. S-4

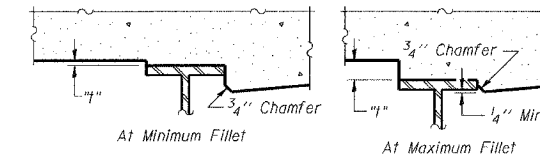

To determine "f": After all structural steel has been erected, elevations of the top flanges of the beams shall be taken at intervals shown below. These elevations subtracted from the "Theoretical Grade Elevations Adjusted for Dead Load Deflection" shown on this sheet, minus slab thickness, equals the fillet heights "f" above top flange of beams.

**FILLET HEIGHTS**

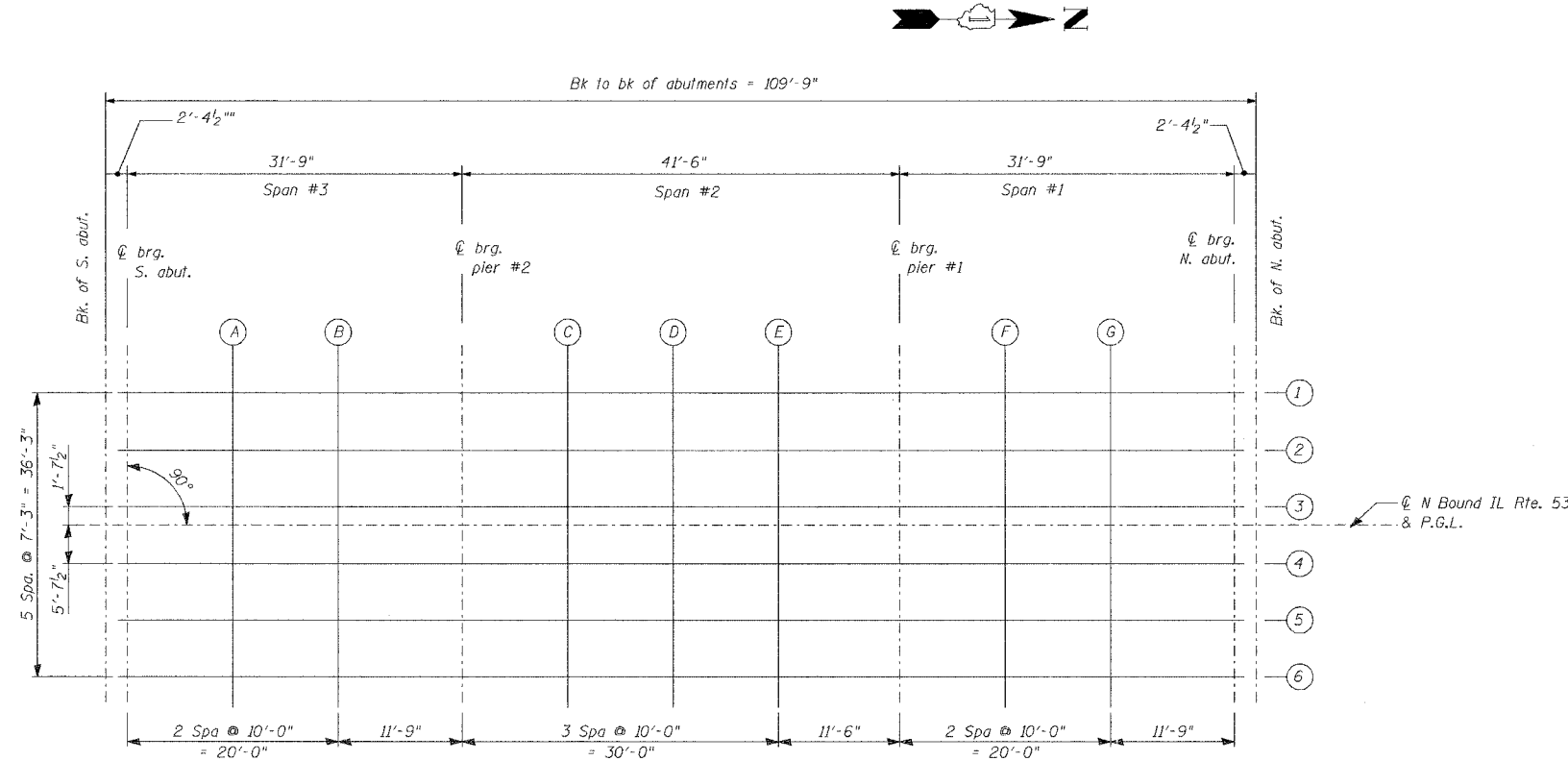

**PLAN**

DESIGNED	NDS/GMK
CHECKED	MTP/SMK/GBC
DRAWN	NDS/DCB
CHECKED	SMK/GBC

THIS SHEET IS FOR  
INFORMATION ONLY

ILLINOIS DEPARTMENT OF TRANSPORTATION  
TOP OF DECK ELEVATION AND  
LAYOUT OF ELEVATION LINES  
FAP 846  
NB IL. ROUTE 53 OVER PRAIRIE CREEK  
STATION 1305+00 SECTION 4-RB  
WILL COUNTY  
STRUCTURE NO. 099-0090  
SCALE: NONE  
DATE: JUNE 2007  
DETA ENGINEERING INC.  
CONSULTING ENGINEERS, CHICAGO, ILLINOIS