

STATE OF ILLINOIS
DEPARTMENT OF TRANSPORTATION

ROUTE NO.	SECTION	COUNTY	TOTAL SHEETS	SHEET NO.
I. A. P. 846	4B-1-1-1	WILL	39	17
FED. ROAD DIST. NO. 7	ILLINOIS	FED. AID PROJECT-		

CONTRACT NO. 60D26

SHEETS S20

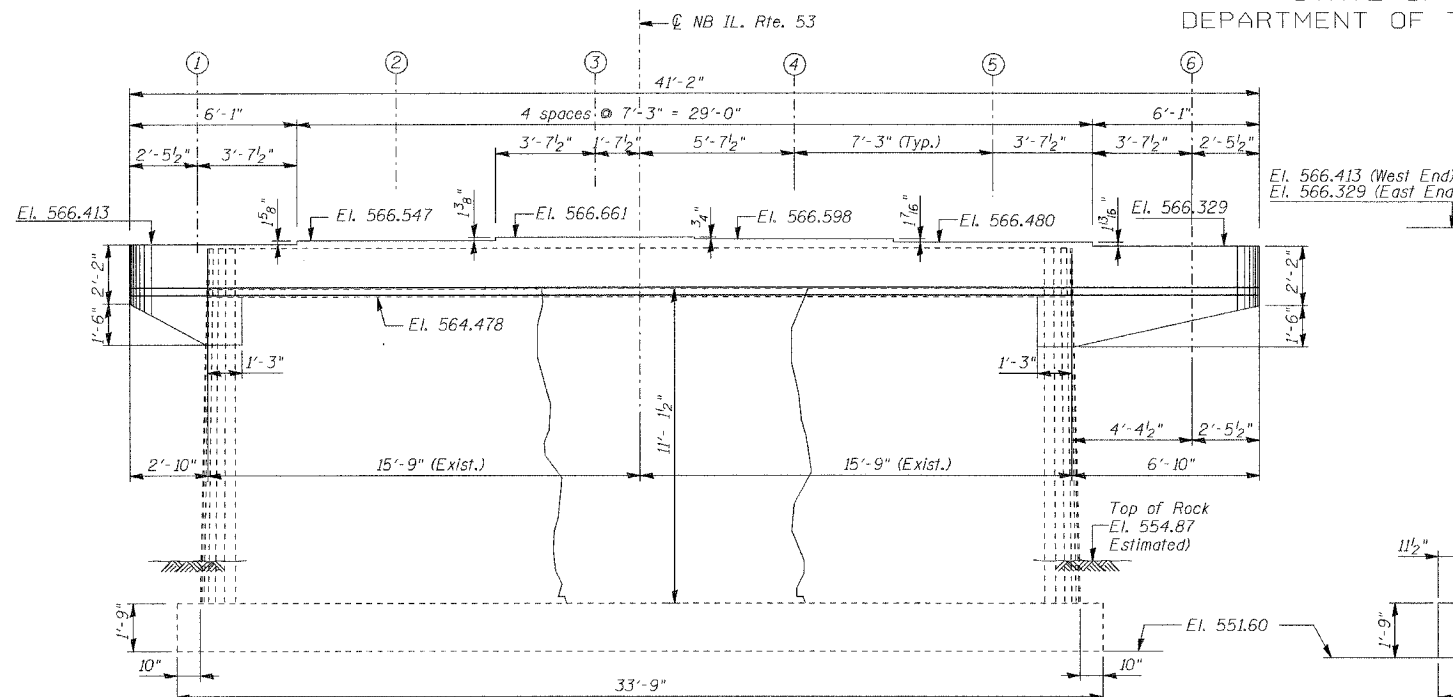

ELEVATION
(SOUTH FACE OF PIER NO. 1)
(LOOKING NORTH)

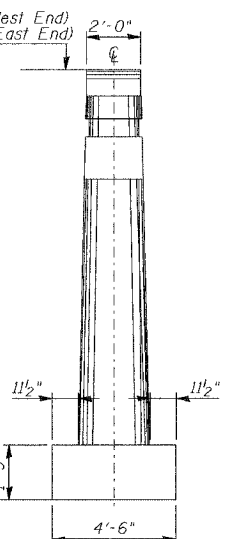

END ELEVATION

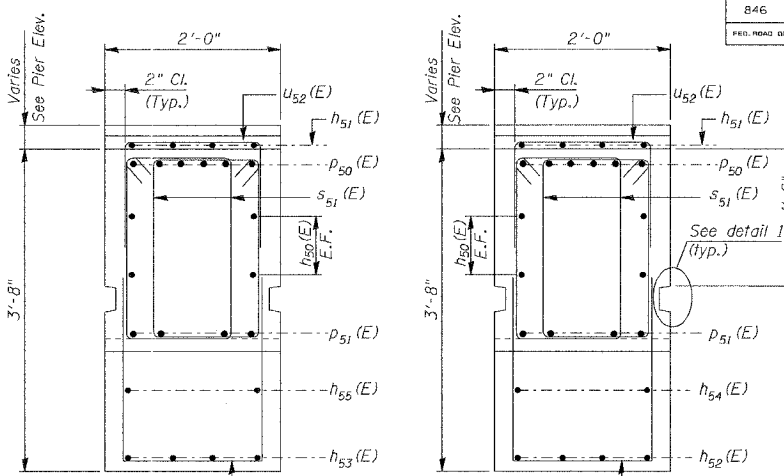

SECTION A-A

SECTION B-B

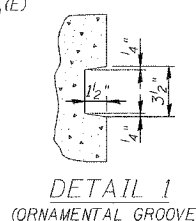

DETAIL 1
(ORNAMENTAL GROOVE)

BILL OF MATERIAL

Bar	No.	Size	Length	Shape
h50(E)	8	#6	21'-10"	
h51(E)	4	#6	23'-5"	
h52(E)	4	#6	8'-11"	
h53(E)	4	#6	5'-1"	
h54(E)	2	#6	5'-7"	
h55(E)	2	#6	4'-3"	
h56(E)	8	#6	2'-4"	
p50(E)	12	#9	25'-4"	
p51(E)	8	#9	22'-8"	
s51(E)	96	#4	6'-9"	
u50(E)	16	#4	5'-9"	
u51(E)	6	#4	7'-8"	
u52(E)	23	#4	3'-8"	
Reinforcement Bars, Epoxy Coated		Pound	2840	
Concrete Structures		Cu. Yd.	7.5	

Reinforcement Bars designated (E) shall be epoxy coated.
Cast steps monolithically with cap.
Space cap reinforcement to miss anchor bolts.

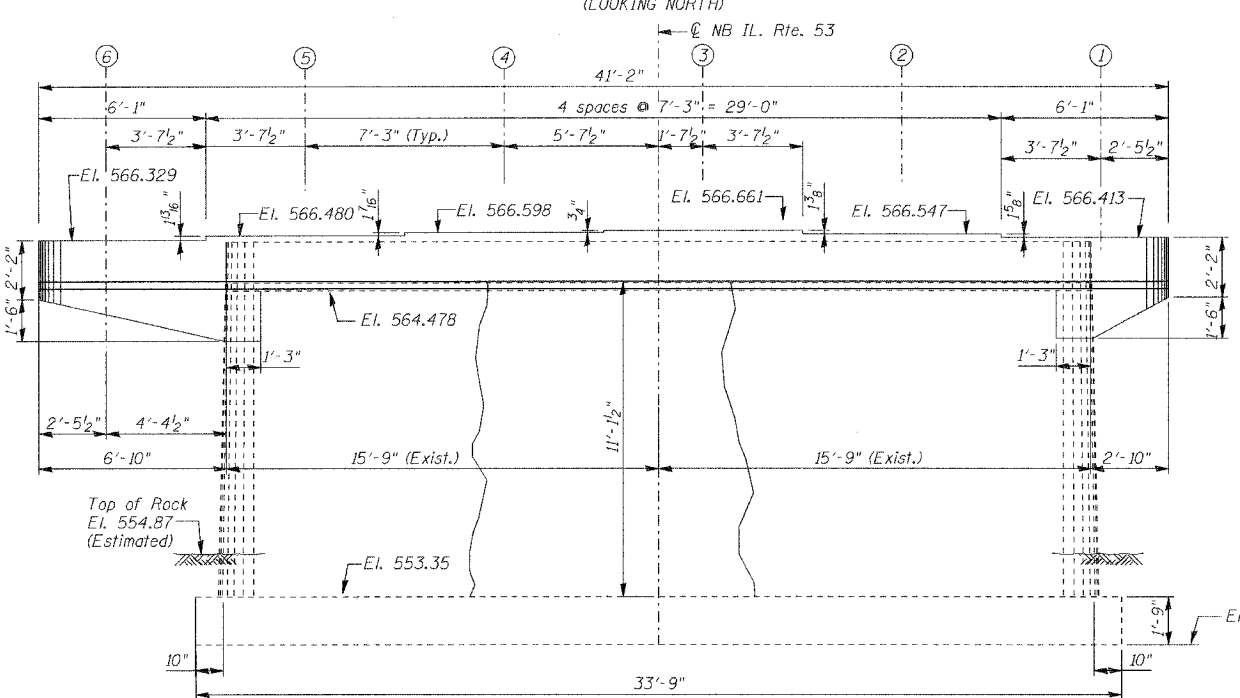

ELEVATION
(NORTH FACE OF PIER NO. 2)
(LOOKING SOUTH)

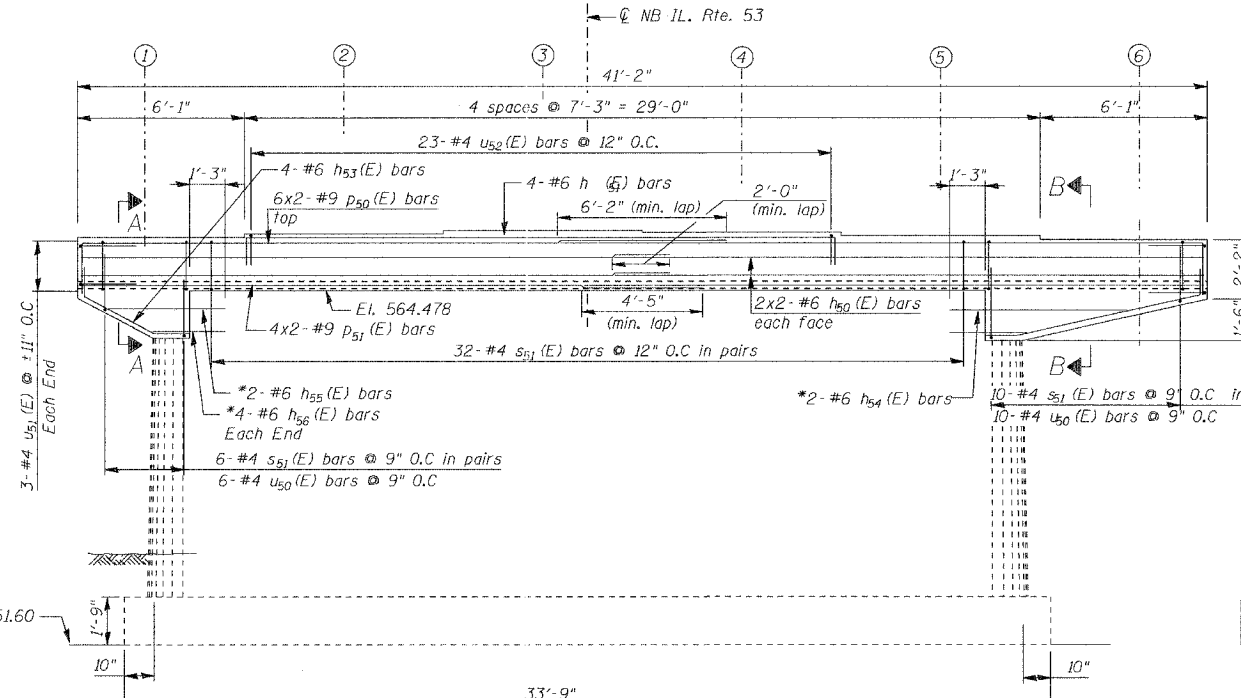

ELEVATION
(LOOKING NORTH)
(SHOWING REINFORCEMENT ONLY)

* Drill and grout #6 h54(E), h55(E) and h56(E) bars in 1" dia. x 15" min. drilled holes according to Article 584 of the Standard Specifications.

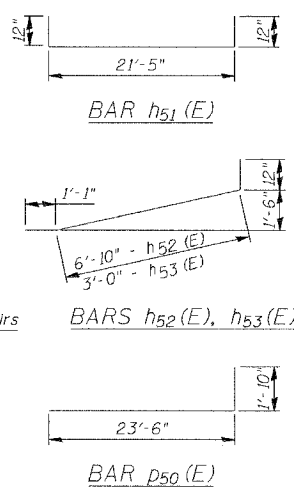

THIS SHEET IS FOR INFORMATION ONLY

LEGEND:

Hairline crack (crack <math>< 1/16''</math> wide)
Not to be sealed

DESIGNED	NDS/GMK
CHECKED	MTP/SMK/GBC
DRAWN	NDS/SMK
CHECKED	SMK/GBC

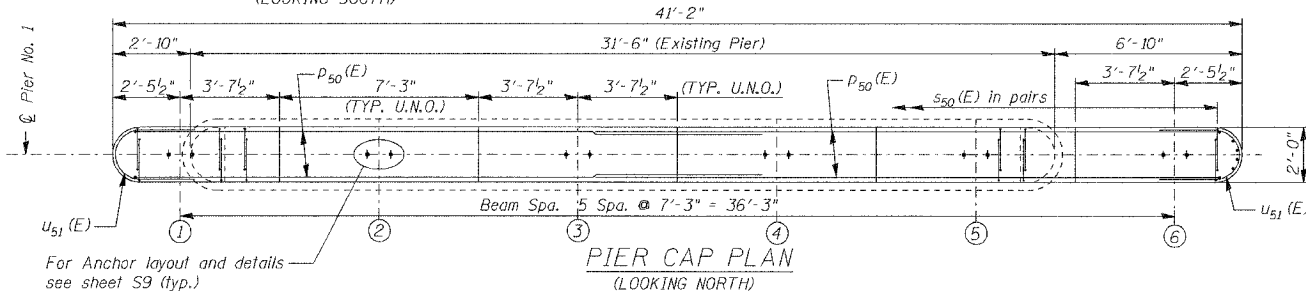

PIER CAP PLAN
(LOOKING NORTH)

For Anchor layout and details see sheet S9 (typ.)

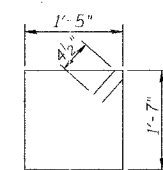

BAR s51(E)

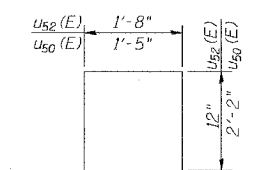

BARS u50(E) and u52(E)

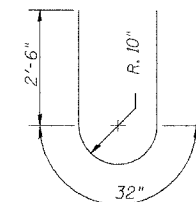

BAR u51(E)

ILLINOIS DEPARTMENT OF TRANSPORTATION

PIER NO. 2
REPAIRS & EXTENSION

FAP 846
NB IL. ROUTE 53 OVER PRAIRIE CREEK
STATION 1305+00 SECTION 4-RB
WILL COUNTY

STRUCTURE NO. 099-0090

SCALE: NONE
DATE: JUNE 2007

DELTA ENGINEERING INC.
CONSULTING ENGINEERS, CHICAGO, ILLINOIS