

Bench Mark:
 BM #3 Elevation = 571.36 (Feet)
 A square cut in northwest wingwall of south bound Illinois route 53 bridge.

Existing Structure:
 The existing structure No. 099-0242 (SB) was built in 1978 under construction route FA-5 and section 4B-1-R. The existing bridge consists of three-spans precast concrete box beam (14 beams) in each span. The structure length is 105'-8" Bk. to Bk. of Abutments and 43'-2" Out to Out Deck. The substructure consists of two abutments, two piers, and two curtain walls between this Bridge and N.B. Bridge (099-0090).
 The piers and abutments are on spread footings over solid rock. The superstructure of existing bridge to be removed and replaced. Traffic shall be detoured by providing cross over away from the structure location, see roadway plans.
 No salvage.

STATE OF ILLINOIS
 DEPARTMENT OF TRANSPORTATION

ROUTE NO.	SECTION	COUNTY	TOTAL SHEETS	SHEET	SHEET NO. S1
F. A. P.	4B-1-R	WILL	39	23	SHEETS S17
FED. ROAD DIST. NO. 7		ILLINOIS	FED. AID PROJECT		

CONTRACT NO. 60D26

DESIGN SPECIFICATIONS

Superstructure:
 2007 AASHTO LRFD Bridge Design Specifications

Substructure:
 AASHTO Standard Specifications For Highway Bridges 17th. Edition 2002

LOADING HL-93 (Struct. Steel,
 Deck & Bearings)

LOADING HS20-44 (Substructure)

Allow 50 psf for future wearing surface.

DESIGN STRESSES

Existing

$f'_c = 3,500$ psi (concrete)
 $f_y = 60,000$ psi (reinforcement)

Proposed

$f'_c = 3,500$ psi (concrete)
 $f_y = 60,000$ psi (reinforcement)
 $f_y = 50,000$ psi (structural steel) (M270 GR.50)
 $f_y = 36,000$ psi (diaphragms) (M270 GR.36)

SEISMIC DATA

Seismic performance category (S.P.C.) = A
 Bedrock acceleration coefficient (A) = .04g
 Site coefficient (s) = 1.0

INDEX OF SHEETS

S1	General Plan & Elevation
S2	General Notes, Total Bill of Material and Section thru Abutment
S3	Top of Deck Elevation and Layout of Elevation Lines
S4	Top of Deck Elevation Tables
S5	Superstructure
S6	Superstructure Details
S7	Framing Plan and Structural Steel Details
S8	Structural Steel Details
S9	Bearing Details
S10	Concrete Removal Details
S11	South Abutment - Repairs and Extension
S12	North Abutment - Repairs and Extension
S13	Pier No. 1 - Repairs
S14	Pier No. 2 - Repairs
S15	Preformed Joint Strip Seal
S16	Cantilever Forming Brackets for Superstructure
S17	Bar Splicer Assembly Details

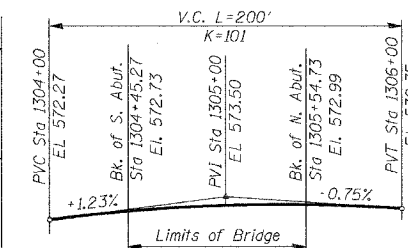
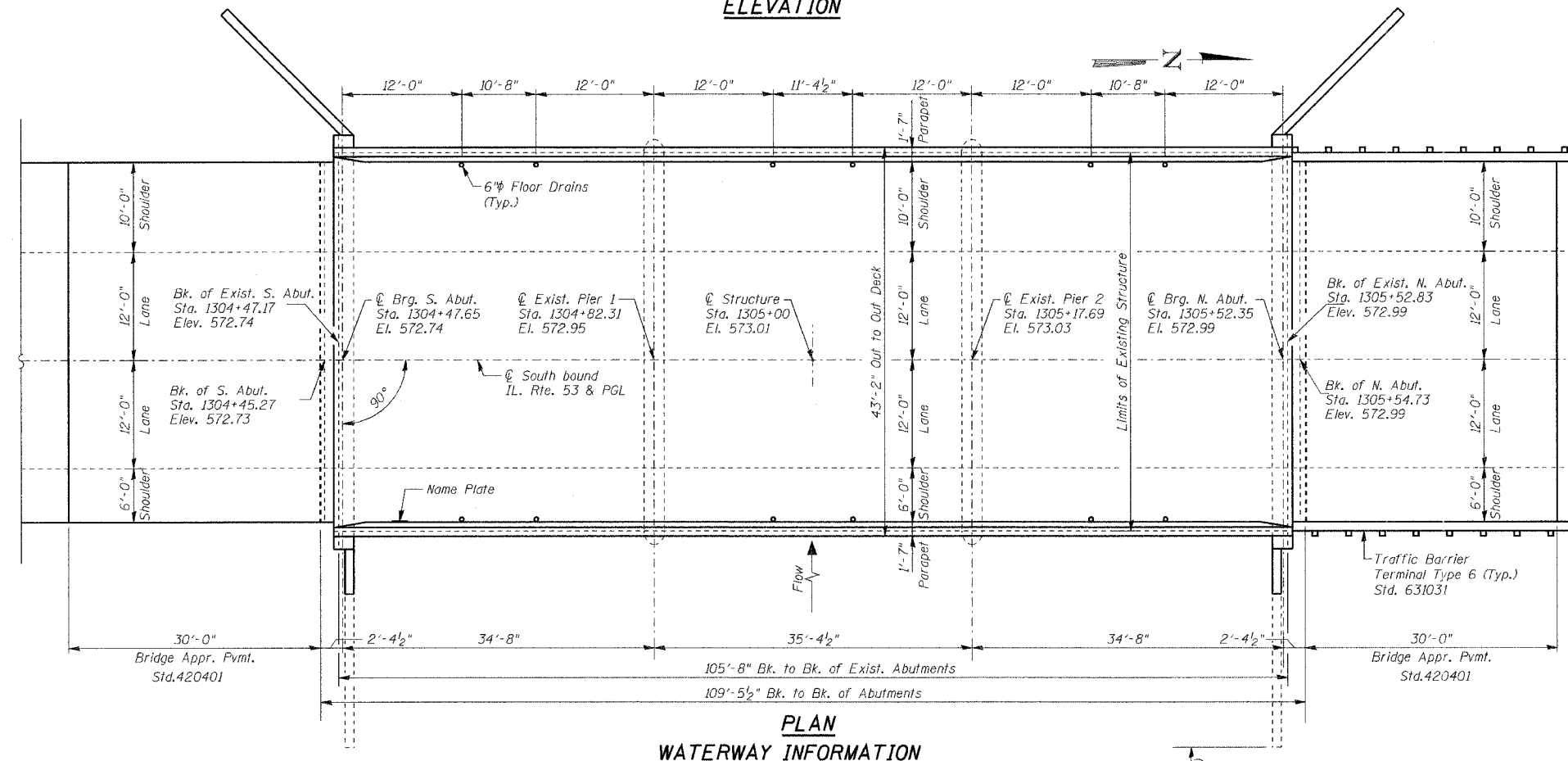
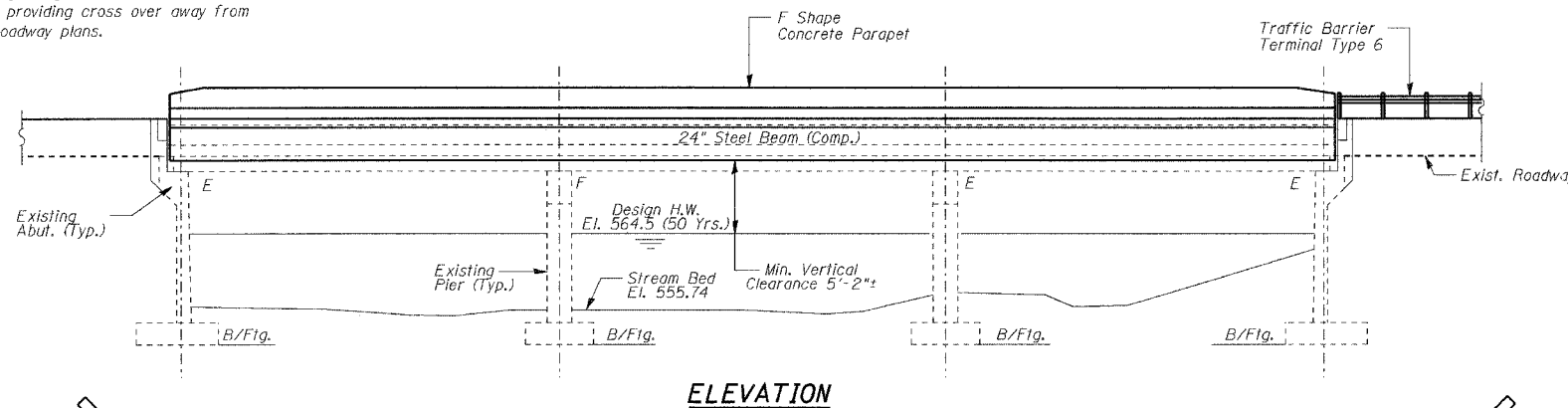

PROPOSED PROFILE GRADE
 (at \odot of SB)

STATION 1305+00
 RE-BUILT 20 BY
 STATE OF ILLINOIS
 F.A.P. 846 SEC. 4B-1-R
 LOADING HL-93 (HS20)
 STR. NO. 099-0242

NAME PLATE

See Std. 515001
 Existing Name Plate shall be cleaned and relocated next to New Name Plate. Cost included with Name Plates.

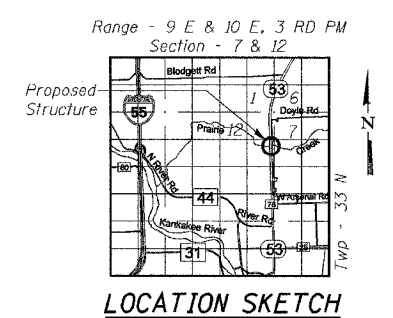

LOCATION SKETCH

WATERWAY INFORMATION

Drainage Area = 45.1 sq.mi Low Grade Elev. 569.7 Ft. \odot Sta. 1301+00

Flood	Freq. Yr.	Q C.F.S.	Opening Sq. Ft.		Nat. H.W.E.	Head - Ft.		Headwater El.	
			Exist.	Prop.		Exist.	Prop.	Exist.	Prop.
Design	50	2910	901	901	564.5	0.1	0.1	564.6	564.6
Base	100	3260	959	959	565.1	0.2	0.2	565.3	565.3
Overlapping									
Max. Calc.	500	4080	1095	1095	566.7	0.3	0.3	567.0	567.0

All elevations are in highway datum.

DESIGNED	NDS/GMK
CHECKED	MTP/SMK/GBC
DRAWN	NDS/GMK
CHECKED	SMK/GBC

APPROVED
 FOR STRUCTURAL ADEQUACY ONLY

Ralph E. Anderson (TST)
 ENGINEER OF BRIDGES AND STRUCTURES



Syed M. Kazi
 Licensed Structural Engineer
 State of Illinois
 License No. 081-004047
 Expires: 11-30-2008

ILLINOIS DEPARTMENT OF TRANSPORTATION

GENERAL PLAN & ELEVATION

FAP 846
 SB IL. ROUTE 53 OVER PRAIRIE CREEK
 STATION 1305+00 SECTION 4B-1-R
 WILL COUNTY

STRUCTURE NO. 099-0242

SCALE: NONE
 DATE: JUNE 2007

DELTA ENGINEERING INC.
 CONSULTING ENGINEERS, CHICAGO, ILLINOIS