

STATE OF ILLINOIS
DEPARTMENT OF TRANSPORTATION

ROUTE NO. 846	SECTION 4B-1-R	COUNTY WILL	DIST. 39	SHEET NO. 25
FED. ROAD DIST. NO. 7		ILLINOIS	FED. AID PROJECT	

SHEET NO. 93
SHEETS 517

CONTRACT NO. 60D26

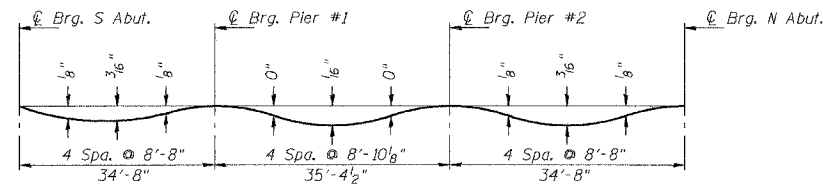

DEAD LOAD DEFLECTION DIAGRAM

(Includes weight of concrete only.)

Note: The above deflections are not to be used in the field if the engineer is working from the grade elevations adjusted for dead load deflections as shown below.

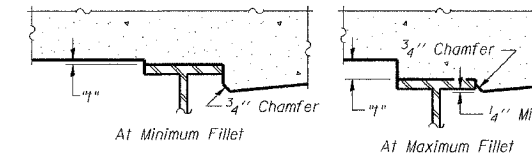

To determine "t": After all structural steel has been erected, elevations of the top flanges of the beams shall be taken at intervals shown below. These elevations subtracted from the "Theoretical Grade Elevations Adjusted for Dead Load Deflection" shown below, minus slab thickness, equals the fillet heights "t" above top flange of beams.

FILLET HEIGHTS

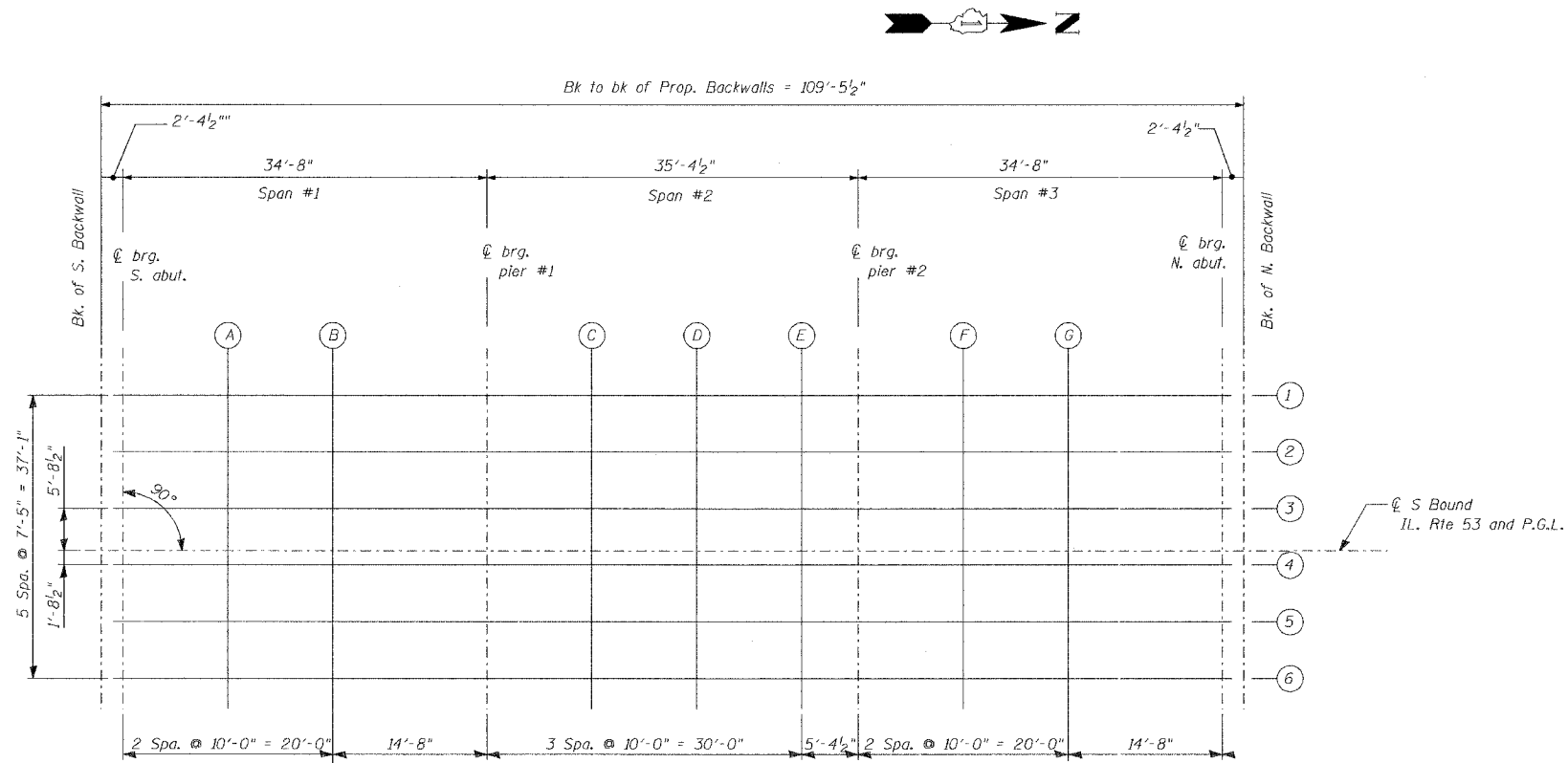

PLAN

DESIGNED	NDS/GMK
CHECKED	MTP/SMK/GBC
DRAWN	NDS/GMK
CHECKED	SMK/GBC

THIS SHEET IS FOR
INFORMATION ONLY

ILLINOIS DEPARTMENT OF TRANSPORTATION
TOP OF DECK ELEVATION AND
LAYOUT OF ELEVATION LINES
FAP 846
SB IL. ROUTE 53 OVER PRAIRIE CREEK
STATION 1305+00 SECTION 4B-1-R
WILL COUNTY
STRUCTURE NO. 099-0242
SCALE: NONE
DATE: JUNE 2007
DETA ENGINEERING INC.
CONSULTING ENGINEERS, CHICAGO, ILLINOIS