

F.A.P. RTE.	SECTION	COUNTY	TOTAL SHEETS	SHEET NO.
332		COOK	54	18
STA. 405+00		TO STA. 420+00		
FED. ROAD DIST. NO. 1 ILLINOIS FED. AID PROJECT				
• (0101,0203B & 0303) RS-10				

REF-  
REF-  
REF-

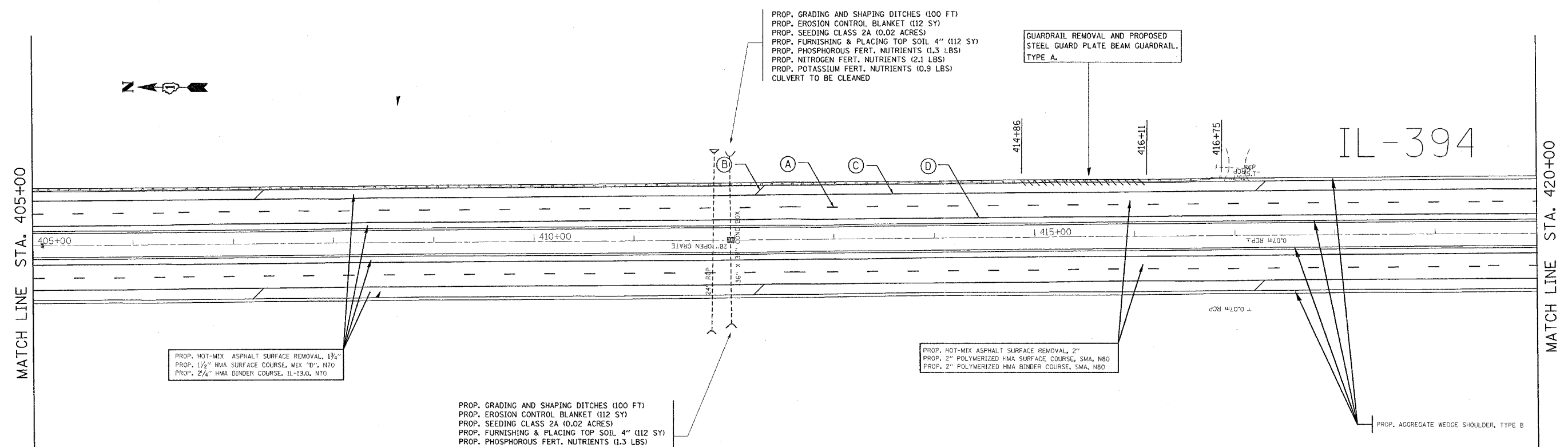

PROP. HOT-MIX ASPHALT SURFACE REMOVAL, 1 3/4"  
PROP. 1 1/2" HMA SURFACE COURSE, MIX "D", NTO  
PROP. 2 1/4" HMA BINDER COURSE, IL-19.0, NTO

PROP. GRADING AND SHAPING DITCHES (100 FT)  
PROP. EROSION CONTROL BLANKET (112 SY)  
PROP. SEEDING CLASS 2A (0.02 ACRES)  
PROP. FURNISHING & PLACING TOP SOIL 4" (112 SY)  
PROP. PHOSPHOROUS FERT. NUTRIENTS (1.3 LBS)  
PROP. NITROGEN FERT. NUTRIENTS (2.1 LBS)  
PROP. POTASSIUM FERT. NUTRIENTS (0.9 LBS)  
CULVERT TO BE CLEANED

GUARDRAIL REMOVAL AND PROPOSED  
STEEL GUARD PLATE BEAM GUARDRAIL,  
TYPE A.

PROP. GRADING AND SHAPING DITCHES (100 FT)  
PROP. EROSION CONTROL BLANKET (112 SY)  
PROP. SEEDING CLASS 2A (0.02 ACRES)  
PROP. FURNISHING & PLACING TOP SOIL 4" (112 SY)  
PROP. PHOSPHOROUS FERT. NUTRIENTS (1.3 LBS)  
PROP. NITROGEN FERT. NUTRIENTS (2.1 LBS)  
PROP. POTASSIUM FERT. NUTRIENTS (0.9 LBS)

PROP. HOT-MIX ASPHALT SURFACE REMOVAL, 2"  
PROP. 2" POLYMERIZED HMA SURFACE COURSE, SMA, N80  
PROP. 2" POLYMERIZED HMA BINDER COURSE, SMA, N80

PROP. AGGREGATE WEDGE SHOULDER, TYPE B

- (A) THERMOPLASTIC PAVEMENT MARKING-LINE 5", WHITE
- (B) THERMOPLASTIC PAVEMENT MARKING-LINE 12", WHITE
- (C) THERMOPLASTIC PAVEMENT MARKING-LINE 4", WHITE
- (D) THERMOPLASTIC PAVEMENT MARKING-LINE 4", YELLOW
- (E) THERMOPLASTIC PAVEMENT MARKING-LINE 8", WHITE
- (F) THERMOPLASTIC PAVEMENT MARKING-LINE 6", WHITE
- (G) THERMOPLASTIC PAVEMENT MARKING-LINE 24", WHITE

REVISIONS	
NAME	DATE

ILLINOIS DEPARTMENT OF TRANSPORTATION  
**IL ROUTE 394**  
 JOE ORR RD TO STEGER RD  
 RESURFACING AND PAVEMENT MARKING PLANS  
 SCALE: VERT. N/A  
 HORIZ. 1" = 50'  
 DATE 7/14/2007  
 DRAWN BY  
 CHECKED BY