

CONTRACT NO. 62481				
F.A.P. RTE.	SECTION	COUNTY	TOTAL SHEETS	SHEET NO.
332		COOK	54	46
STA.		TO STA.		
FED. ROAD DIST. NO.		ILLINOIS FED. AID PROJECT		
• 40101, 02038 & 0303 RS-10				

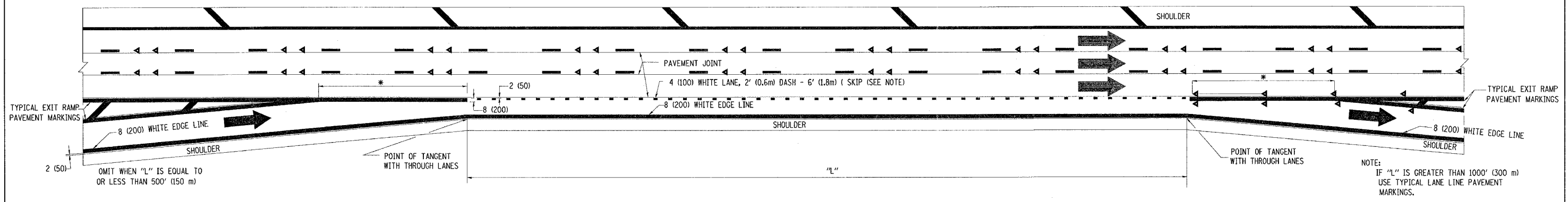

TYPICAL ENTRANCE/EXIT RAMP COMBINATION PAVEMENT MARKINGS

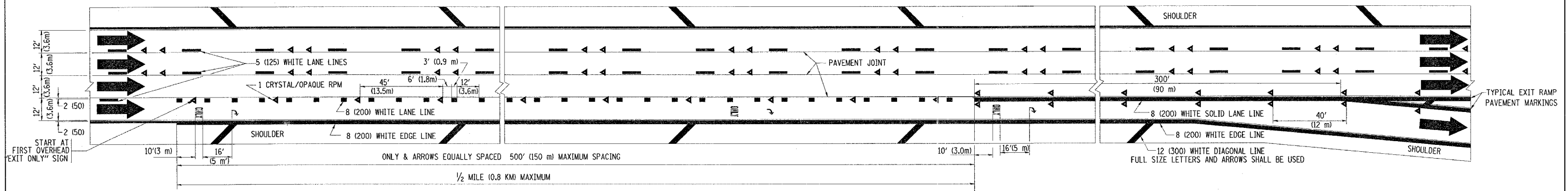

TYPICAL EXIT ONLY LANE PAVEMENT MARKINGS

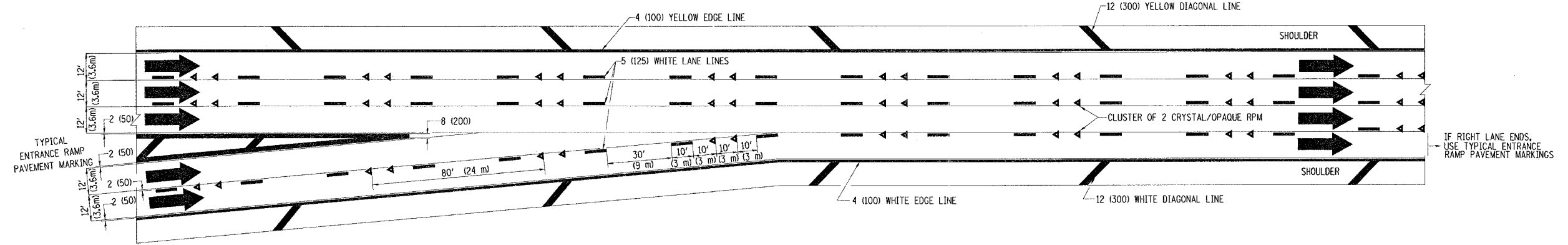

TYPICAL TWO LANE ENTRANCE RAMP PAVEMENT MARKINGS

REVISIONS	
NAME	DATE
DWS	1/90
DWS	5/91
SPB	1/07

ILLINOIS DEPARTMENT OF TRANSPORTATION

MULTI-LANE FREEWAY PAVEMENT MARKING DETAILS

SCALE: NONE
DATE: 7/14/2007

DRAWN BY C.A.D.D.
CHECKED BY
TC12 SHEET 2 OF 2
REVISION DATE: 01/01/07

PLOT DATE = 7/14/2007
FILE NAME = F:\adassad\vc12.dgn
PLOT SCALE = 50:800 / IN.
USER NAME = cconnerm