

ALL DIMENSIONS IN METERS EXCEPT PAY ITEMS AND UNLESS NOTED OTHERWISE

F.A.I. RTE.	SECTION	COUNTY	TOTAL SHEETS	SHEET NO.
80/94	2003-106LS	COOK	59	41
STA.	TO STA.			
FED. ROAD DIST. NO.	ILLINOIS FED. AID PROJECT			
CONTRACT NO. 62699				

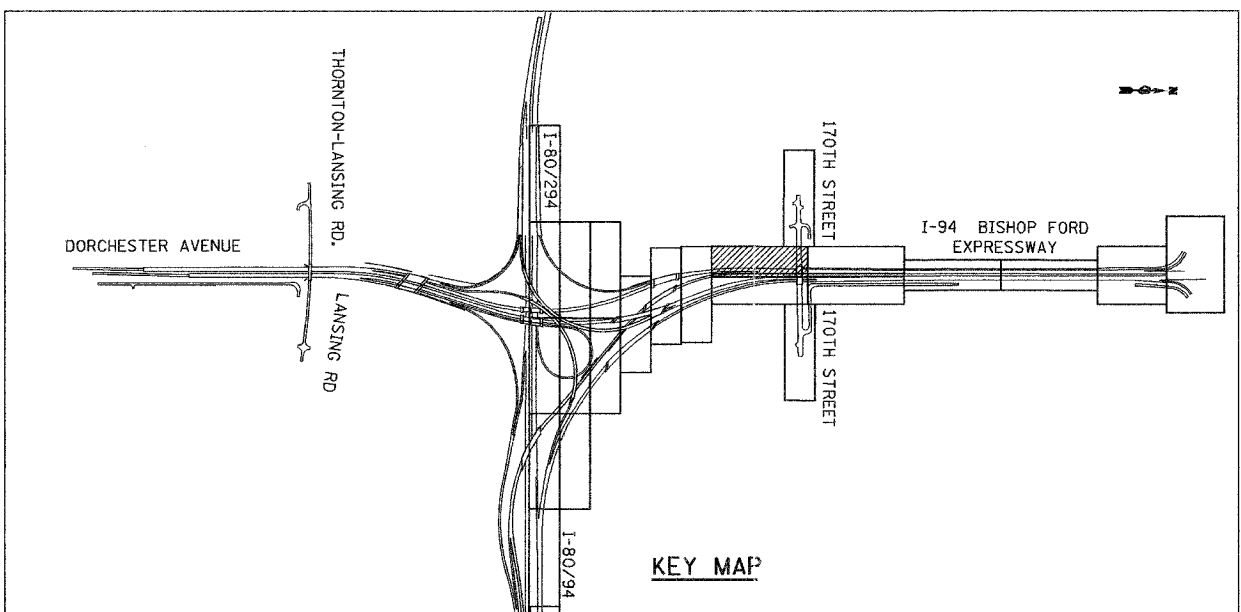
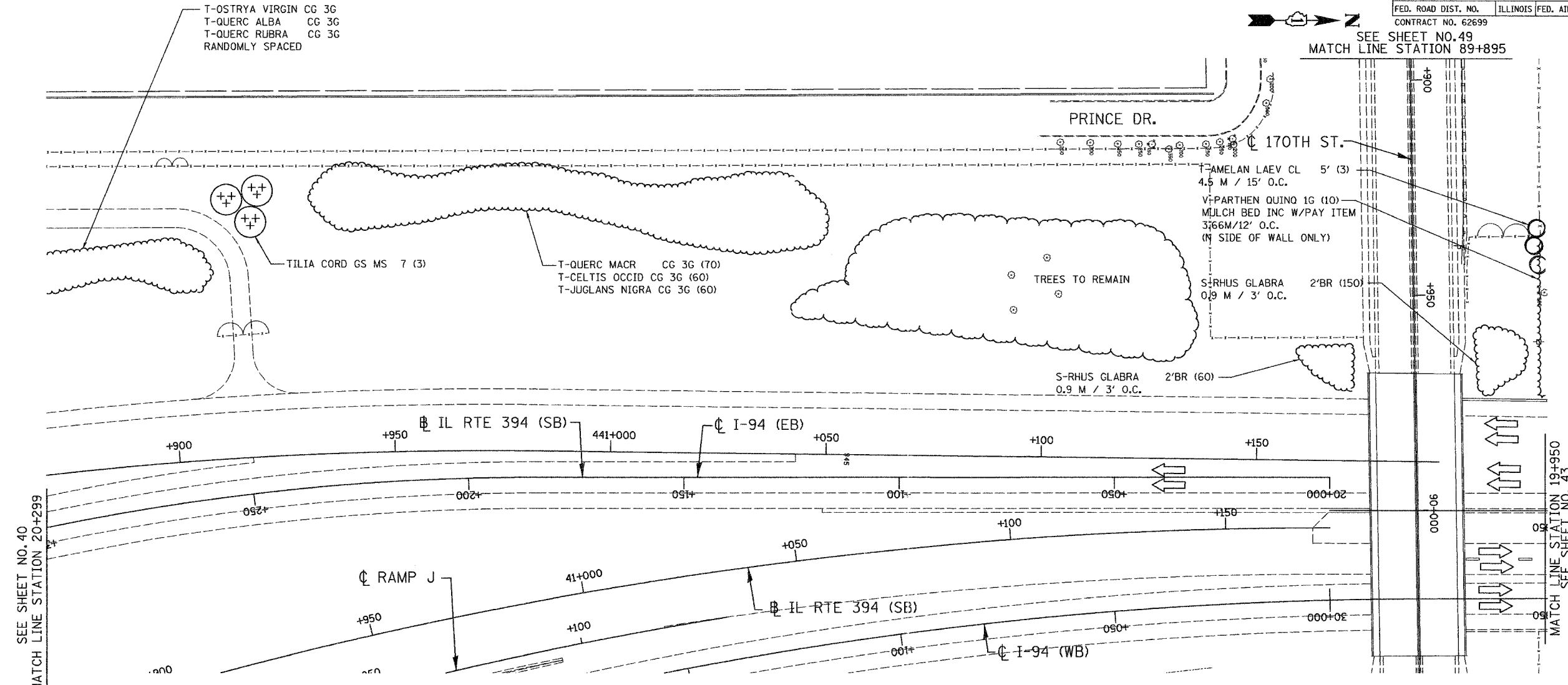

LSNS - 31

ILLINOIS DEPARTMENT OF TRANSPORTATION  
 I-80/94/US 6  
 KINGERY-BORMAN EXPRESSWAY  
 BURNHAM ROAD TO US 41  
**LANDSCAPING PLAN**  
 I-94 BISHOP FORD EXPWAY

REVISIONS	
NAME	DATE

SCALE 1:500  
 DATE 06/07  
 DRAWN BY ACE/CAD  
 CHECKED BY TJW



06/26/07 1:35:07 PM G:\Project\_20\1080\CADD\Contract\WB\LS\_31.rdb