

ALL DIMENSIONS IN METERS EXCEPT PAY ITEMS AND UNLESS NOTED OTHERWISE

F.A.I. RTE.	SECTION	COUNTY	TOTAL SHEETS	SHEET NO.
80/94	2003-106LS	COOK	59	47
STA.		TO STA.		
FED. ROAD DIST. NO.		ILLINOIS FED. AID PROJECT		
CONTRACT NO. 62699				

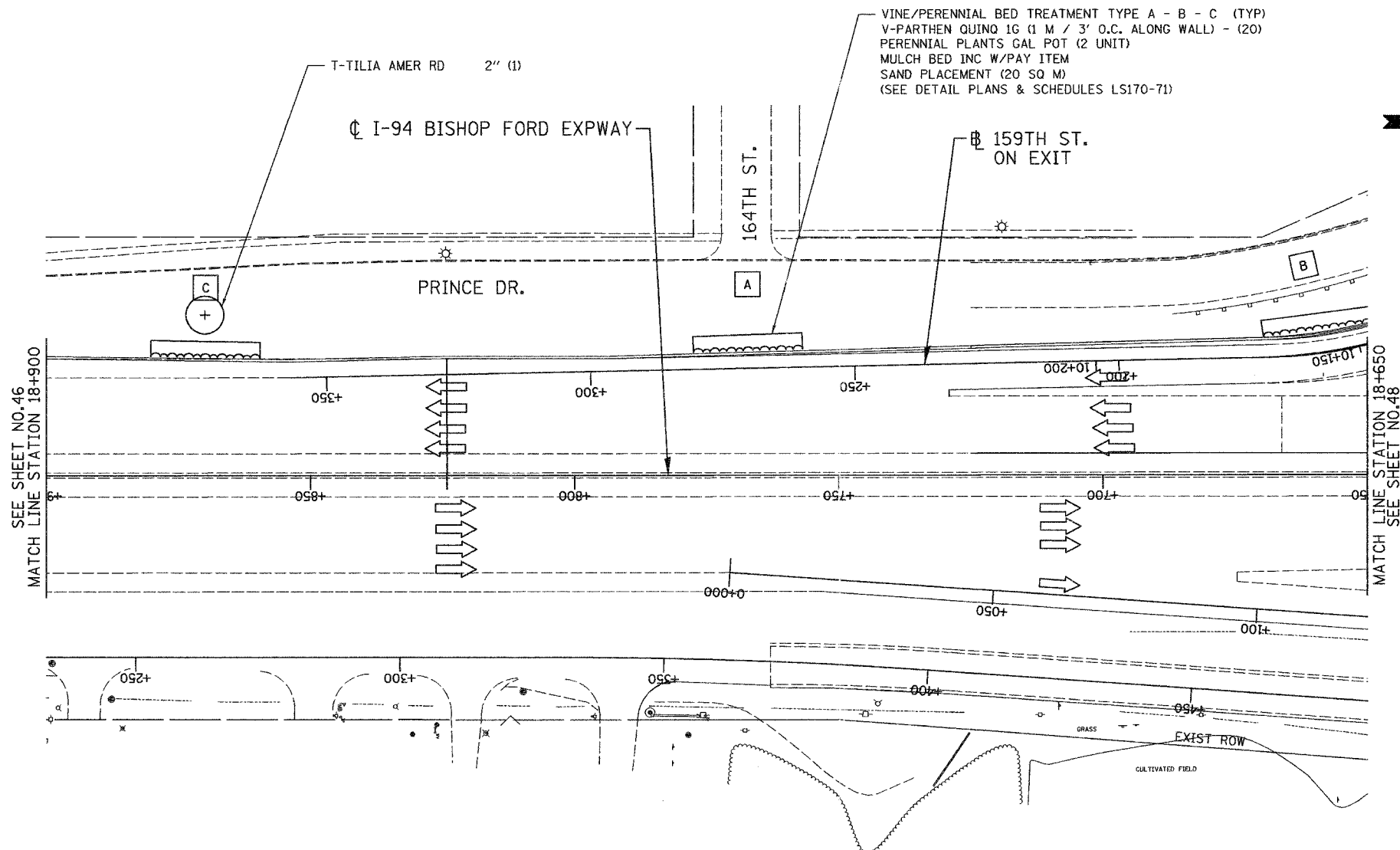

VINE/PERENNIAL BED TREATMENT TYPE A - B - C (TYP)  
 V-PARTHEN QUINO 1G (1 M / 3' O.C. ALONG WALL) - (20)  
 PERENNIAL PLANTS GAL POT (2 UNIT)  
 MULCH BED INC W/PAY ITEM  
 SAND PLACEMENT (20 SQ M)  
 (SEE DETAIL PLANS & SCHEDULES LS170-71)

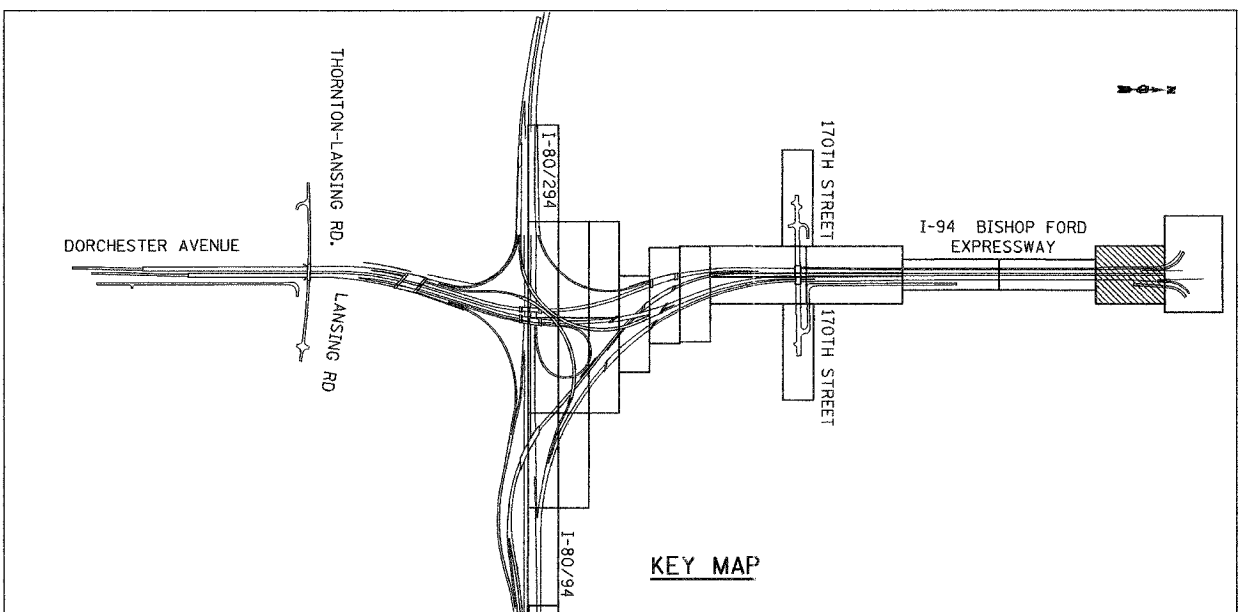

KEY MAP

LSNS - 37

REVISIONS	
NAME	DATE

ILLINOIS DEPARTMENT OF TRANSPORTATION  
 I-80/94/US 6  
 KINGERY-BORMAN EXPRESSWAY  
 BURNHAM ROAD TO US 41  
**LANDSCAPING PLAN**  
**I-94 BISHOP FORD EXPWAY**

SCALE 1:500  
 DATE 06/07  
 DRAWN BY ACE/CAD  
 CHECKED BY TJW



06/26/07 1:37:20 PM  
 g:\Project\20M080\CADD\Contract\WB\LS 37.rdb