

F.A.I. RTE.	SECTION	COUNTY	TOTAL SHEETS	SHEET NO.
80/94	2003-089I	COOK	59	53
STA.		TO STA.		
FED. ROAD DIST. NO.		ILLINOIS	FED. AID PROJECT	

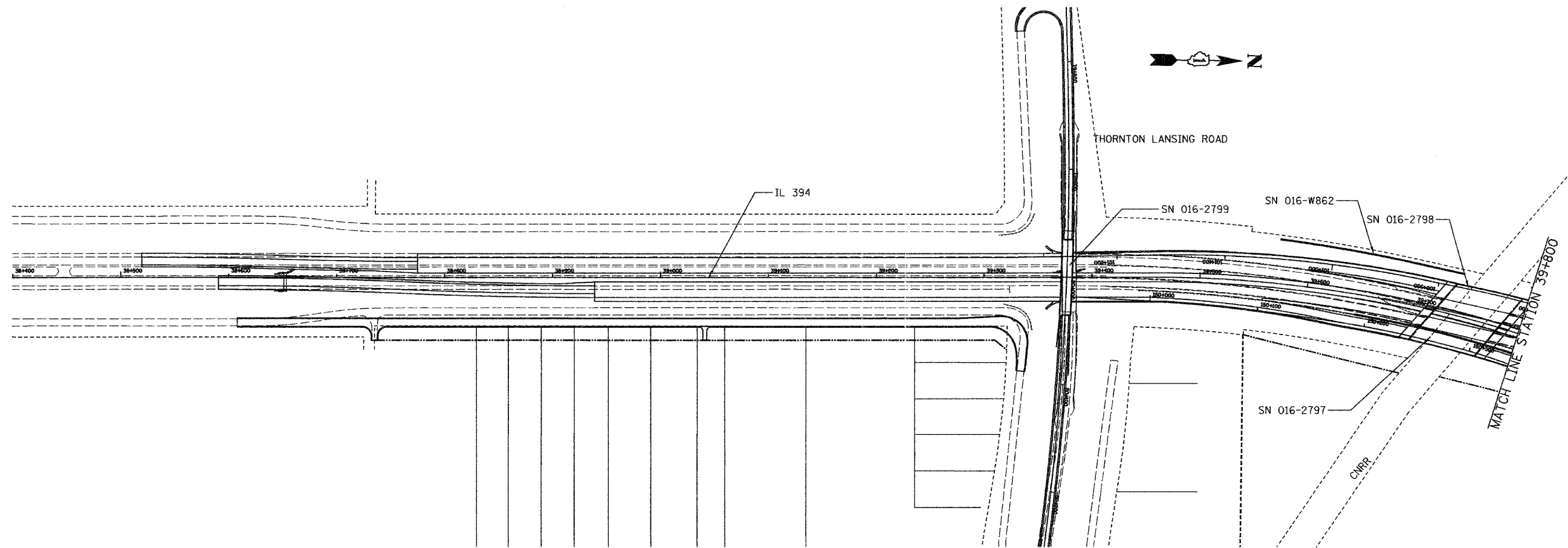

FOR INFORMATION ONLY

REVISIONS	
NAME	DATE

ILLINOIS DEPARTMENT OF TRANSPORTATION  
 I-80/94/US 6 (KINGERY EXPRESSWAY)  
 ROADWAY LIGHTING  
 AND TRAFFIC SURVEILLANCE

**STRUCTURE LOCATION PLAN**  
**STA. 38+400 TO 39+800**

SCALE 1:2000 DRAWN BY ACE/CAD  
 DATE 12/03 CHECKED BY TJW

**AMERICAN**  
 CONSULTING ENGINEERS