

| F.A.S. RTE. | SECTION | COUNTY | TOTAL SHEETS | SHEET NO. |
|---|----------|--------|--------------|-----------|
| 220 | 23-BR1 I | MERCER | 50 | 48 |
| STA. 99+71 TO STA. 109+76 | | | | |
| FED. ROAD DIST. NO. 7 ILLINOIS FED. AID PROJECT | | | | |

140 130 120 110 100 90 80 70 60 50 40 30 20 10 0 10 20 30 40 50 60 70 80 90 100 110 120

FINAL SURVEY NOTE BOOK NO. _____
 DATE _____
 BY _____
 CHECKED _____
 REVISIONS _____
 PLOTTED _____
 TEMPLATE _____
 AREAS CHECKED _____

ORIGINAL SURVEY NOTE BOOK NO. _____
 DATE _____
 BY _____
 CHECKED _____
 REVISIONS _____
 PLOTTED _____
 TEMPLATE _____
 AREAS CHECKED _____

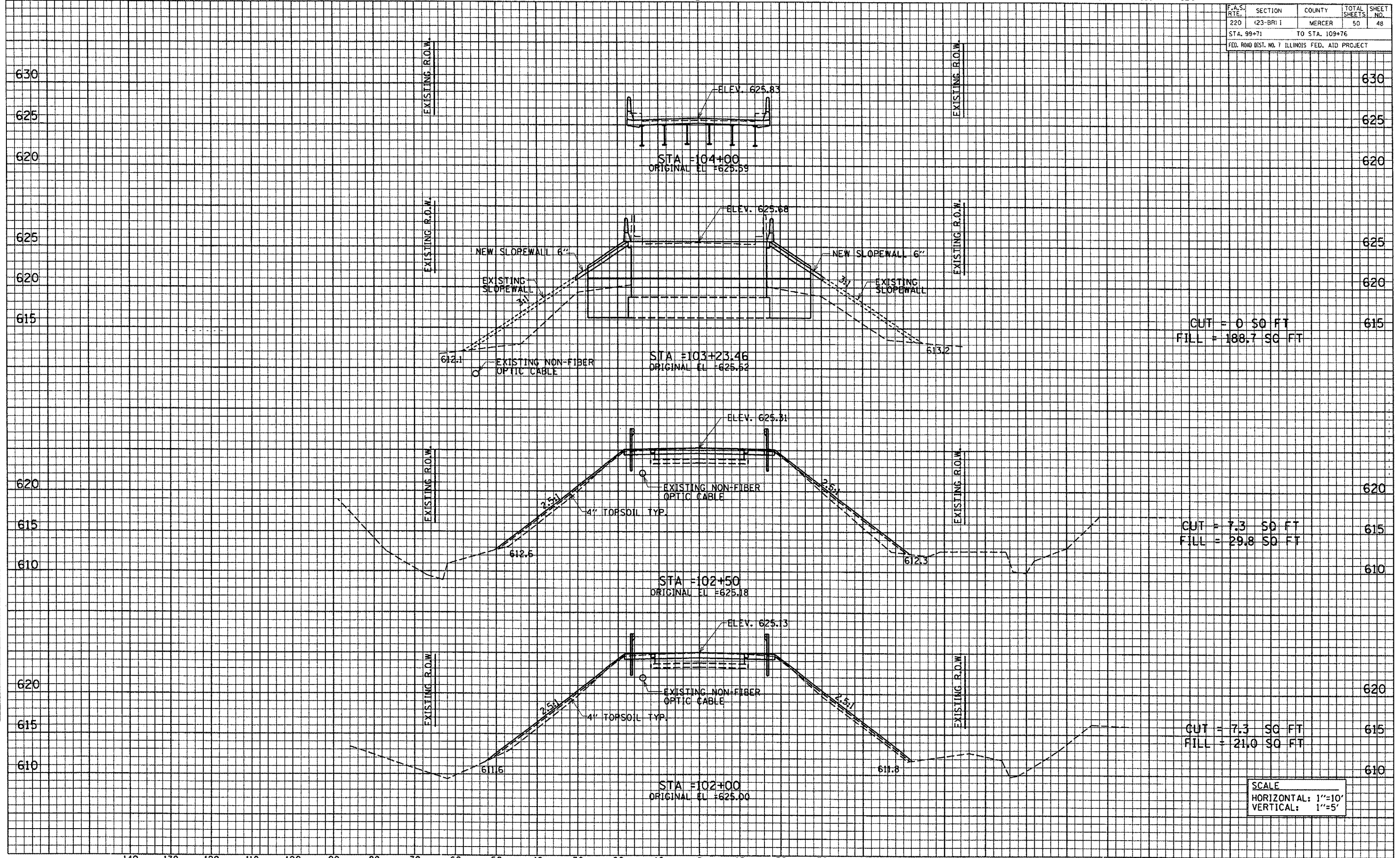

CUT = 0.50 FT
 FILL = 188.7 SQ FT

CUT = 7.3 SQ FT
 FILL = 29.8 SQ FT

CUT = 7.3 SQ FT
 FILL = 21.0 SQ FT

SCALE
 HORIZONTAL: 1"=10'
 VERTICAL: 1"=5'

140 130 120 110 100 90 80 70 60 50 40 30 20 10 0 10 20 30 40 50 60 70 80 90 100 110 120 130 140