

**ELEVATION**  
(Looking Towards I-74)

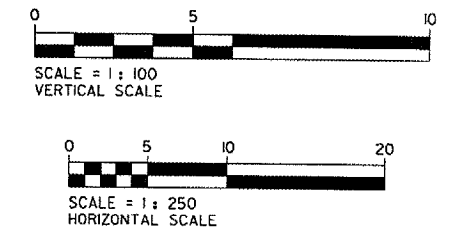

- NOTES:**
- The Contractor has the option to clear the trees within a width of 4 m centered about the centerline of the Noise Abatement Wall. The groundline in this area shall be restored to the original elevation after the construction of the wall.
  - Any tree removal outside the 4 m width mentioned in Note 1, can be done only after written approval by the Engineer.
  - 100 mm  $\phi$  Drainage Holes shall be field drilled through wall panels as required to facilitate surface drainage with a maximum of one hole per panel. Location to be determined by the Engineer. (See sheet 16).
  - For Proposed Storm Sewer, see sheet 12.

**LEGEND**

- Existing Tree Line
- Existing Individual Tree ( $\phi > 150$  mm)
- Existing Fence
- Existing Storm Sewer
- Boring Location
- Limits of Erosion Barrier
- Limits of Clearing & Landscaping
- Drilled Shaft Center
- Existing Right of Way
- Chain Link Fence Removal
- Existing Electric Pole
- High Mast Light Pole
- Seeding, Class 2
- Temporary Easement

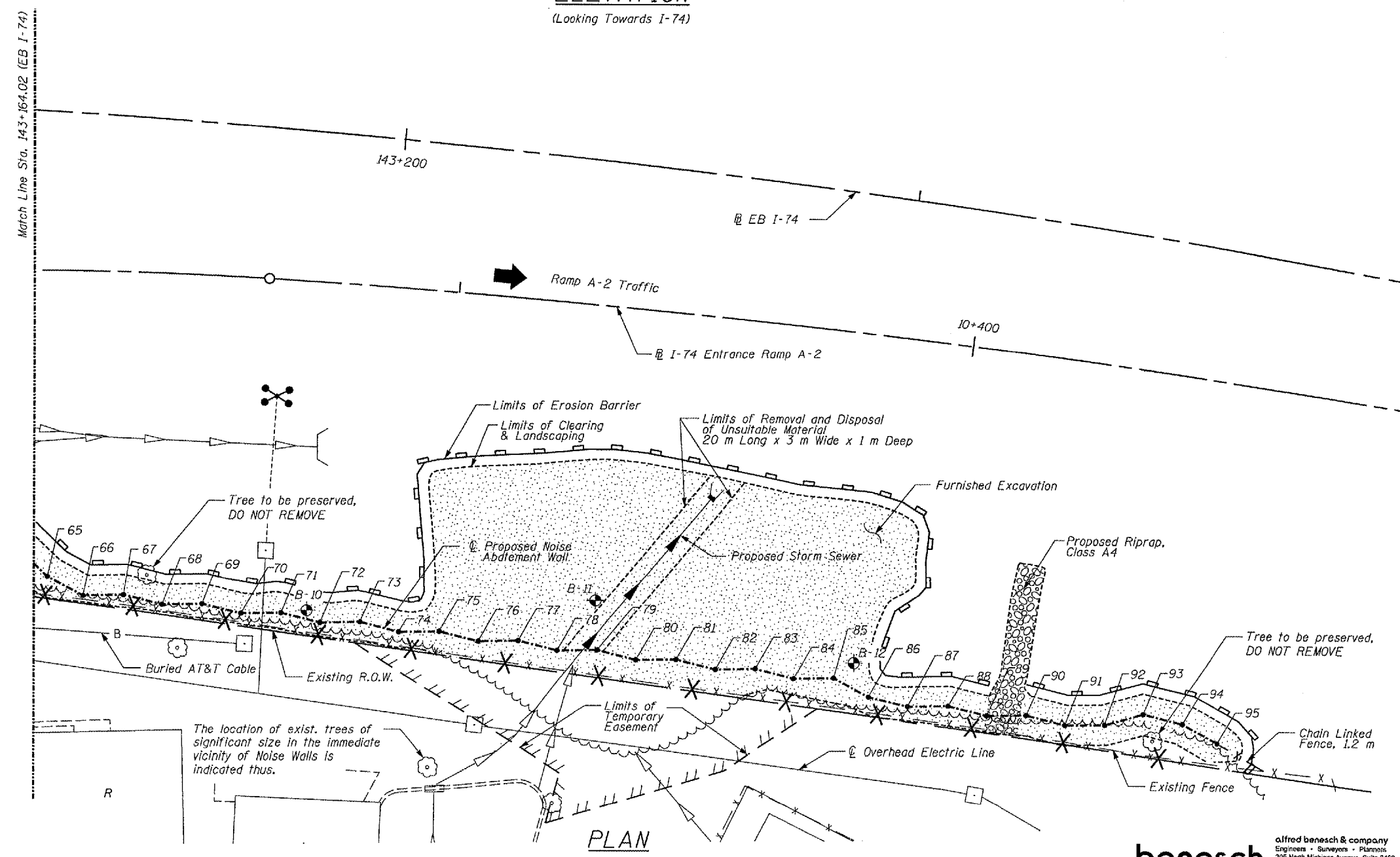

**PLAN**



REVISIONS	
NAME	DATE

**benesch**  
alfred benesch & company  
Engineers - Surveyors - Planners  
235 North Michigan Avenue, Suite 2400  
Chicago, Illinois 60601  
312-585-0450  
JOB NO. 3573

ILLINOIS DEPARTMENT OF TRANSPORTATION  
**GENERAL PLAN & ELEVATION 3**  
**NOISE ABATEMENT WALL**  
F.A.I. RTE. 74 (I-74)  
SECTION D4 I-74 NOISE WALL 2008  
PEORIA COUNTY  
STA. 142+916.64 TO STA. 143+287.69  
STRUCTURE NUMBER 072-8554

6/22/2007 1:21:35 PM c:\projects\data\3573\noisewalls\walla2\plans\3573nw\_gpa3.dgn