

F.A.P. RTE.	SECTION	COUNTY	TOTAL SHEETS	SHEET NO.
666	SP-2, RS-4	SANGAMON	80	62
STA.		TO STA.		
FED. ROAD DIST. NO.		ILLINOIS FED. AID PROJECT		

TRAFFIC SIGNAL QUANTITIES

LOCATION: 9TH & ENOS ST.

QUANTITY	UNIT	ITEM
540.0	FOOT	DETECTOR LOOP, TYPE 1

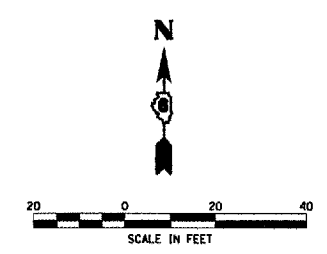
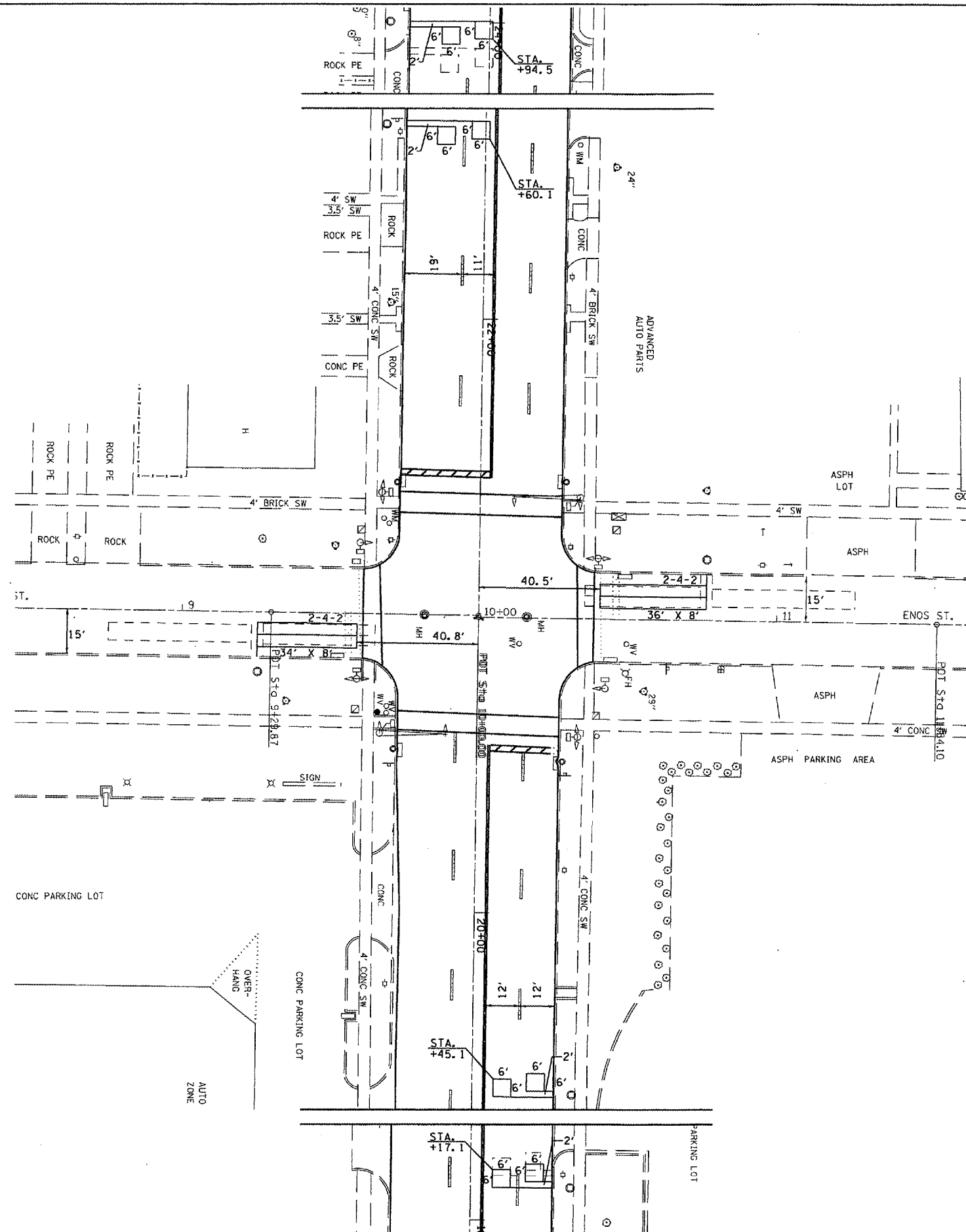

REVISIONS	
NAME	DATE

ILLINOIS DEPARTMENT OF TRANSPORTATION

TRAFFIC SIGNAL PLAN

FAP ROUTE 666 (I-55 BUS/9TH STREET)

NINTH STREET AT ENOS STREET

SCALE: VERT. _____

DATE _____

DRAWN BY _____

CHECKED BY _____

PLOT DATE = #DATE#
 FILE NAME = #FILE#
 PLOT SCALE = #SCALE#
 USER NAME = #USER#