











FAP RTE	SECTION	COUNTY	TOTAL SHEETS	SHEET NO.
753	128(BR-1)	MORGAN	40	16
STA. 723+00.00		TO STA. 731+00.00		
FED. ROAD DIST. NO.		ILLINOIS	FED. AID PROJECT	

**LEGEND**

-  WORK AREA
-  SIGN
-  TYPE III BARRICADE
-  DRUM WITH STEADY BURNING LIGHT
-  TRAFFIC SIGNAL
-  TYPE C BIDIRECTIONAL REFLECTOR
-  TEMPORARY CONCRETE BARRIER (STD 704001)
-  IMPACT ATTENUATOR
-  STEADY BURNING LIGHTS AND DOUBLE VERTICAL PANELS
-  DOUBLE VERTICAL PANEL

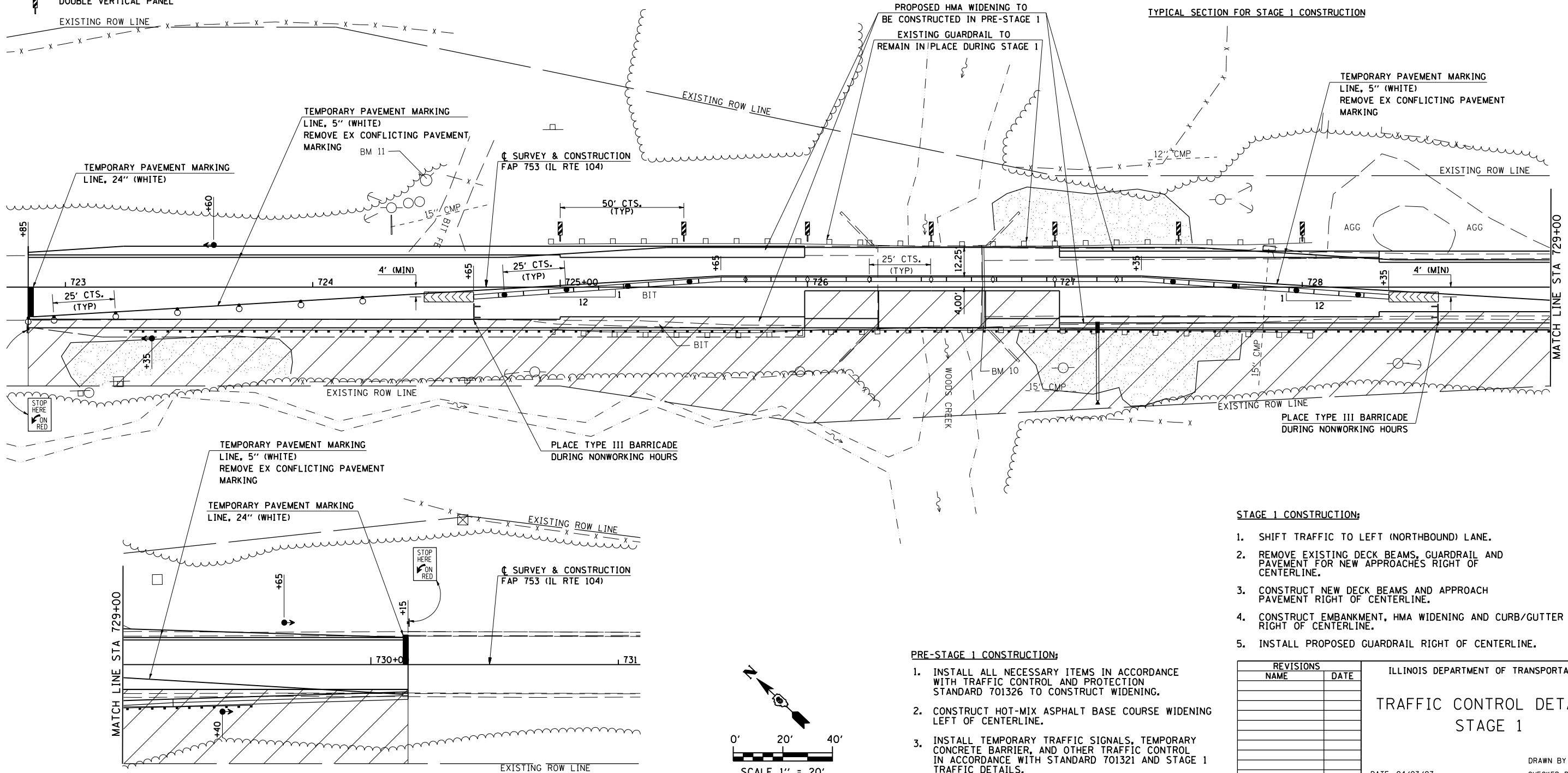
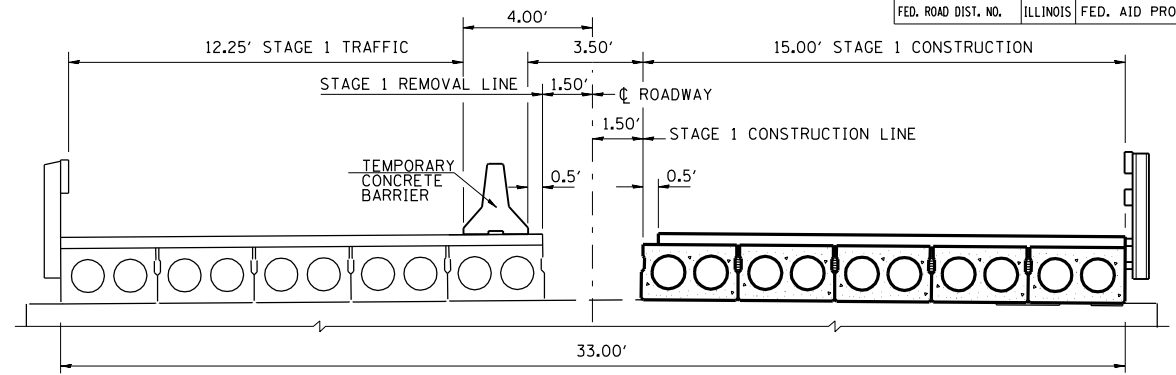
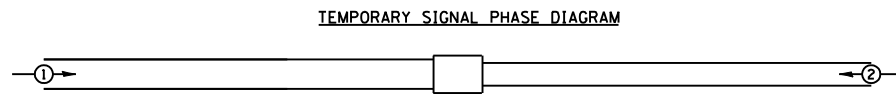

- STAGE 1 CONSTRUCTION:**
- SHIFT TRAFFIC TO LEFT (NORTHBOUND) LANE.
  - REMOVE EXISTING DECK BEAMS, GUARDRAIL AND PAVEMENT FOR NEW APPROACHES RIGHT OF CENTERLINE.
  - CONSTRUCT NEW DECK BEAMS AND APPROACH PAVEMENT RIGHT OF CENTERLINE.
  - CONSTRUCT EMBANKMENT, HMA WIDENING AND CURB/GUTTER RIGHT OF CENTERLINE.
  - INSTALL PROPOSED GUARDRAIL RIGHT OF CENTERLINE.

- PRE-STAGE 1 CONSTRUCTION:**
- INSTALL ALL NECESSARY ITEMS IN ACCORDANCE WITH TRAFFIC CONTROL AND PROTECTION STANDARD 701326 TO CONSTRUCT WIDENING.
  - CONSTRUCT HOT-MIX ASPHALT BASE COURSE WIDENING LEFT OF CENTERLINE.
  - INSTALL TEMPORARY TRAFFIC SIGNALS, TEMPORARY CONCRETE BARRIER, AND OTHER TRAFFIC CONTROL IN ACCORDANCE WITH STANDARD 701321 AND STAGE 1 TRAFFIC DETAILS.

REVISIONS	
NAME	DATE

ILLINOIS DEPARTMENT OF TRANSPORTATION  
**TRAFFIC CONTROL DETAILS**  
**STAGE 1**  
 DRAWN BY JCW  
 CHECKED BY JRB  
 DATE: 04/03/07

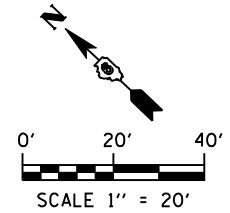

PLOT DATE = 7/2/2007  
 FILE NAME = c:\p\projects\651707\hutchison\_f.m\2447-bmot.dgn  
 PLOT SCALE = 42.3525 / IN.  
 USER NAME = laughlin-1