

Bench Mark: Chiseled square on northeast wingwall of S.N. 034-0061, 17.3 ft. Left of Sta. 607+89.50, Elevation 597.73

Existing Structure: S.N. 034-0061 was built in 1982 under F.A.P. Route 685, Section 115 BR. A 5" concrete overlay was provided in 1998 under F.A.P. Route 685, Section (115BR). The existing structure is a three span 17" x 36" and 17" x 48" PPC-deck beam bridge on pile bent abutments and encased pile bent piers with steel H-piles, 89'-1" back to back abutments, 34'-0" out to out, with a 10 degree skew ahead left.

The existing deck beams and bridge railing are to be removed and replaced. Traffic to be maintained utilizing stage construction.

No Salvage.

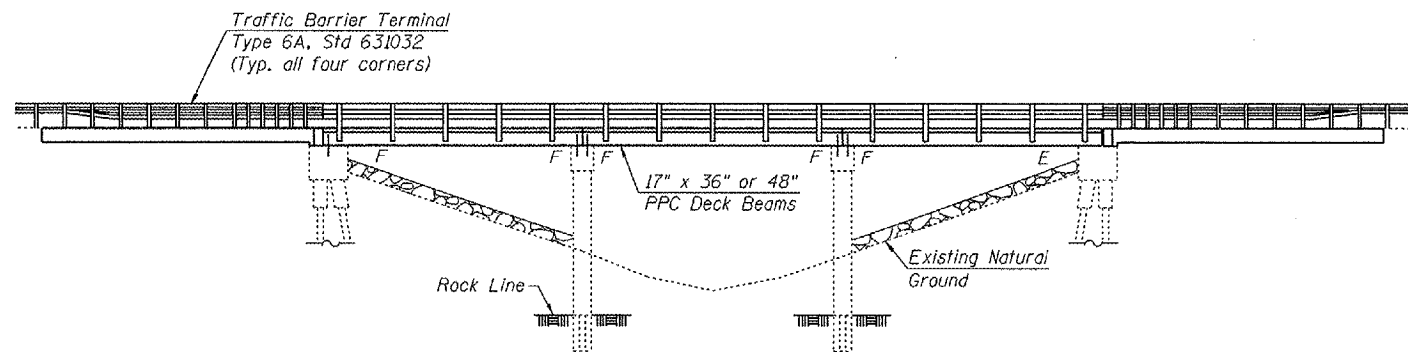

ELEVATION

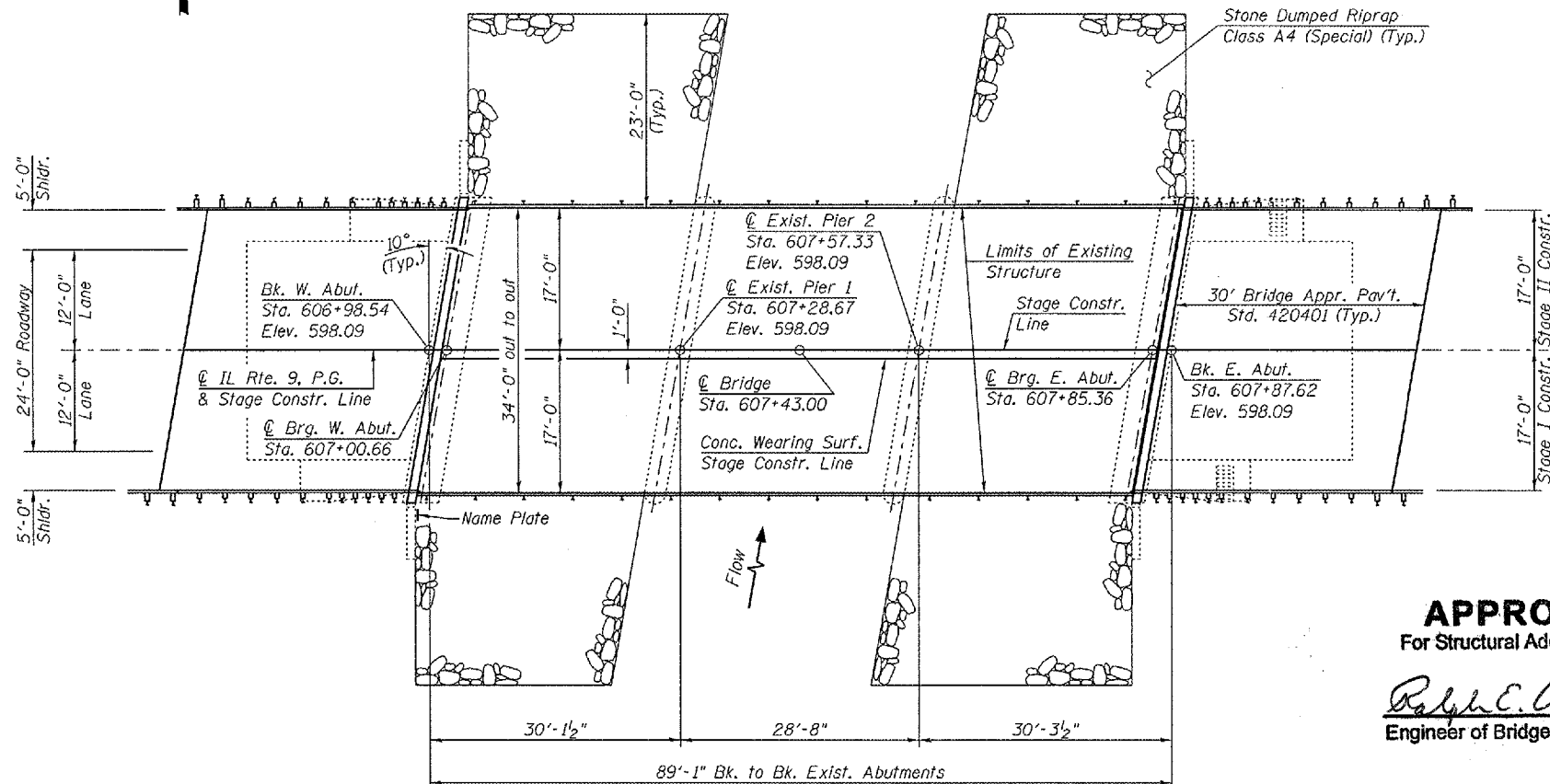

PLAN

INDEX OF SHEETS

1. General Plan
2. General Data
3. Stage Construction Details
4. Steel Railing, Type SM
5. Superstructure
6. Superstructure Details-1
7. Superstructure Details-2
8. Superstructure Details-3
9. Superstructure Details-4
10. Concrete Removal
11. West Abutment
12. East Abutment
13. Piers
14. Bar Splicer Assembly Details
15. Temporary Concrete Barrier
16. Concrete Repair
17. Temporary Support System



Michael J. Haley 7/18/2007  
Date  
Michael T. Haley  
Licensed Structural Engineer  
State of Illinois No. 81-5991  
Expires 11/30/2008

ROUTE NO.	SECTION	COUNTY	TOTAL SHEETS	SHEET NO.	SHEET NO. 1
F.A.P. 685	115 BR-1	HANCOCK	44	19	17 SHEETS
FED. ROAD DIST. NO. 7	ILLINOIS	FED. AID PROJECT			

Contract #72A90

LOADING HS20-44 (NEW CONSTRUCTION)  
No allowance for future wearing surface.

DESIGN SPECIFICATIONS (NEW CONSTRUCTION)  
2002 AASHTO

DESIGN STRESSES

FIELD UNITS  
f'c = 5,000 psi (Concrete Wearing Surface)  
f'c = 3,500 psi (Concrete)  
fy = 60,000 psi (Reinforcement)

PRECAST PRESTRESSED UNITS

f'c = 5,000 psi  
f'ci = 4,000 psi  
f's = 270,000 psi (1/2" low lax. strands)  
f'si = 201,960 psi (1/2" low lax. strands)

STATION 607+43.00  
REBUILT 20 BY  
STATE OF ILLINOIS  
F.A.P. RT. 685 SEC. 115 BR-1  
LOADING HS20  
STRUCTURE NO. 034-0061

NAME PLATE

(See Std. 515001)

Existing Name Plate shall be cleaned and relocated adjacent to new Name Plate. Cost included with Name Plates.

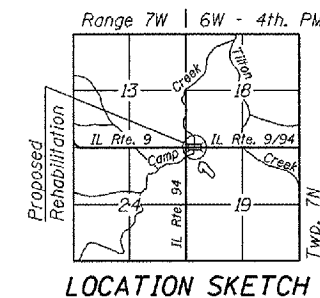
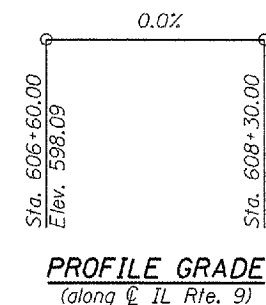

APPROVED  
For Structural Adequacy Only

Ralph C. Anderson  
Engineer of Bridges & Structures

LIN ENGINEERING, LTD.  
Consulting Engineers  
Getham, Illinois

Designed By: DLS  
Checked By: MTH  
Date: 04/2007

REVISIONS	
NAME	DATE

ILLINOIS DEPARTMENT OF TRANSPORTATION  
GENERAL PLAN  
IL ROUTE 9 OVER  
CAMP CREEK  
F.A.P. ROUTE 685 - SECTION 115 BR-1  
HANCOCK COUNTY  
STA. 607+43.00  
STRUCTURE NO. 034-0061