



| | | |
|------|----------|------|
| PLAN | REVISION | DATE |
| NO. | BY | |
| NO. | BY | |
| NO. | BY | |
| NO. | BY | |
| NO. | BY | |
| NO. | BY | |
| NO. | BY | |
| NO. | BY | |
| NO. | BY | |

| | | |
|---------|----------|------|
| PROFILE | REVISION | DATE |
| NO. | BY | |
| NO. | BY | |
| NO. | BY | |
| NO. | BY | |
| NO. | BY | |
| NO. | BY | |
| NO. | BY | |
| NO. | BY | |
| NO. | BY | |

SEC. 3, T16N, R2E, 3RD P.M.

DAVITA DIALYSIS CENTER

| | | | | |
|---------------------|--------------|------------------|--------------|-----------|
| CONTRACT NO. 74166 | | | | |
| FAP RTE | SECTION | COUNTY | TOTAL SHEETS | SHEET NO. |
| 716 | (130BR-1)B-1 | MACON | 95 | 15 |
| STA. 71+00 | | TO STA. 73+00 | | |
| FED. ROAD DIST. NO. | ILLINOIS | FED. AID PROJECT | | |

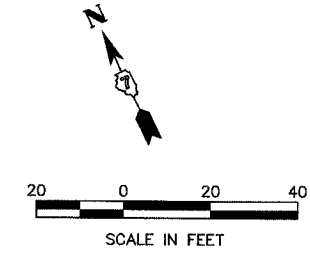

MATCH LINE STA 71+00
SEE SHT. 13 FOR CONT.

SEE SHEET 32 FOR DETAILS OF MCKINLEY AVE. INTERSECTION

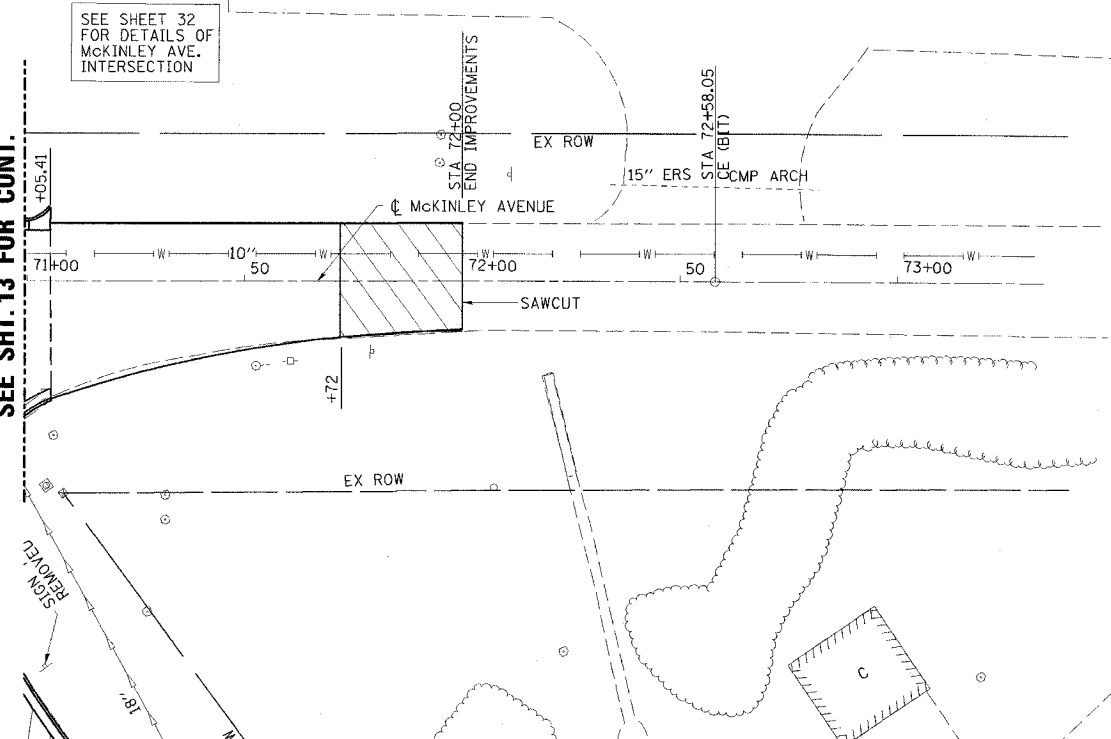

BENCHMARK 4707-1 EL 628.10 (NAVD 88)
CHISELED SQUARE TOP SE WINGWALL OF SN 058-0056
APPROXIMATELY 350' NORTH OF OVERHEAD RAILROAD
BRIDGE, STA. 135+57.43, 42.28' RT.

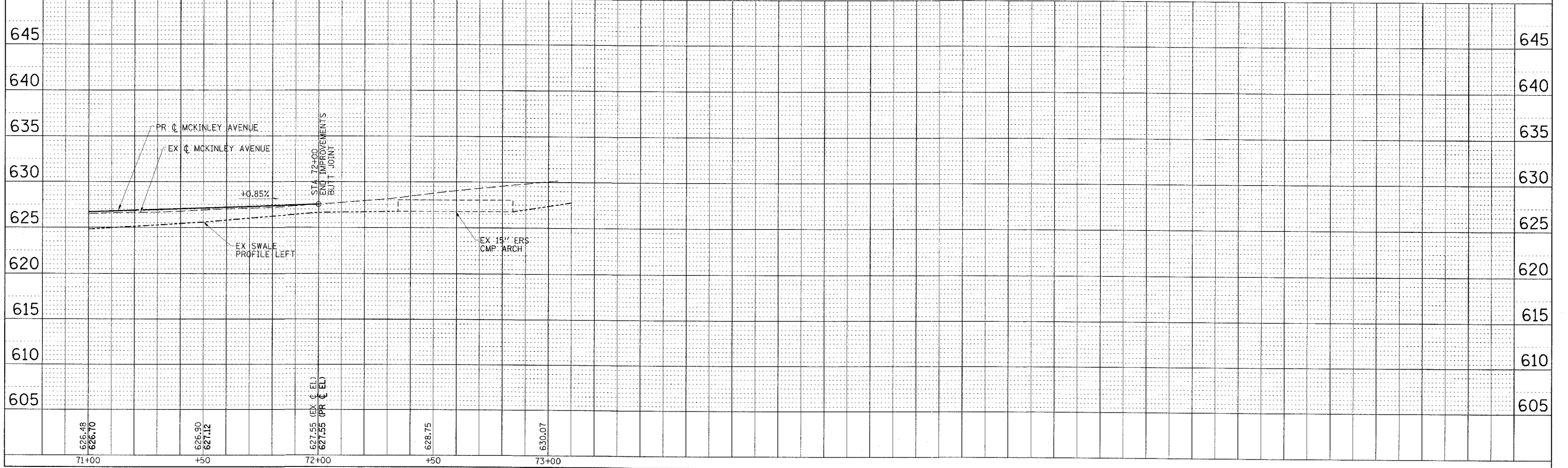

MCKINLEY AVENUE PLAN AND PROFILE
STA 71+00 TO STA 73+00